

SAMSUNG  
ELECTRONICS



# QUICK START GUIDE

EO-BG93••

SAMSUNG  
LEVEL



Printed in Korea  
GH68-00000A Rev.1.0  
E Type 04/2016

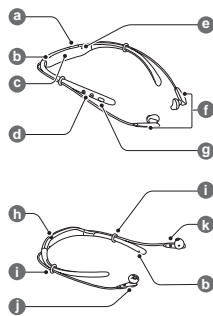

Copyright © 2015 Samsung Electronics  
 Bluetooth® is a registered trademark of  
 Bluetooth SIG, Inc. worldwide.

- Please read this manual before using the device to ensure safe and proper use.
- Images may differ in appearance from the actual product. Content is subject to change without prior notice. You can access the full user manual for more information. Visit [www.samsung.com](http://www.samsung.com) to view device information, the user manual, and more.

**Device layout**

<b>a</b>	Charger port	<b>g</b>	Multifunction/Talk button
<b>b</b>	Microphone	<b>h</b>	Power switch
<b>c</b>	Neckband (Vibration area)	<b>i</b>	Rubber o-ring
<b>d</b>	Volume button	<b>j</b>	Left earphone
<b>e</b>	Notification light	<b>k</b>	Right earphone
<b>f</b>	Magnet		

**Charging the battery**

Before using the headset for the first time, you must charge the battery.  
Open the charging port cover and connect the headset to a charger.



- Chargers are sold separately.
- The charger should remain close to the electric socket and easily accessible while charging.
- The socket-outlet shall be installed near the equipment and shall be easily accessible.

### Turning the headset on or off

Slide the Power switch to turn on or off the headset.



When you turn on the headset for the first time, it enters Bluetooth pairing mode.

### Connecting devices via Bluetooth

You can receive incoming calls or listen to multimedia files when your headset is connected to Bluetooth-enabled devices.

1. Turn on the headset, and then press and hold the Multifunction button for about three seconds to enter Bluetooth pairing mode. The notification light flashes red and blue.
2. On your other device, activate the Bluetooth feature and tap **Samsung Level U ANC** from the list.

### Connecting additional devices

The headset can connect to up to two Bluetooth-enabled devices at the same time. For more information, refer to the user manual.

### **Safety information**

Read all safety information before using the device to ensure safe and proper use. To view the full safety information, refer to the Samsung website.

**The headset contains magnets in its earbuds. The American Heart Association (US) and the Medicines and Healthcare Products Regulatory Agency (UK) both warn that magnets can affect the operation of implanted pacemakers, cardioverters, defibrillators, insulin pumps or other electro medical devices (collectively, "Medical Device") within the range of 15 cm (6 inches). If you are a user of any of these Medical Devices, DO NOT USE THE HEADSET UNLESS YOU HAVE CONSULTED WITH YOUR PHYSICIAN**

**Use manufacturer-approved batteries, chargers, accessories, and supplies**

**Do not touch the device with wet hands**

**Do not drop or cause an impact to the charger or the device**

**Do not bend or twist the device excessively**

The device can be used in locations with an ambient temperature of 0°C to 35°C. You can store the device at an ambient temperature of -20°C to 50°C. Using or storing the device outside of the recommended temperature ranges may damage the device or reduce the battery's lifespan

Do not allow children or animals to chew or suck the device

Do not disassemble, modify, or repair your device

Do not use a headset while driving or riding. Doing so may distract your attention and cause an accident, or may be illegal depending on your region



To prevent possible hearing damage when using a headset, do not listen to sound at high volume for long periods.

#### Correct disposal



This marking on the product, accessories or literature indicates that the product and its electronic accessories (e.g. charger, headset, USB cable) should not be disposed of with other household waste. This product is RoHS compliant.



This marking on the battery, manual or packaging indicates that the batteries in this product should not be disposed of with other household waste.



#### Removing the battery

- To remove the battery, you **must** visit an authorised service centre with the provided instructions.
  - For your safety, you **must not attempt to remove** the battery. If the battery is not properly removed, it may lead to damage to the battery and device, cause personal injury, and/or result in the device being unsafe.
  - Samsung does not accept liability for any damage or loss (whether in contract or tort, including negligence) which may arise from failure to precisely follow these warnings and instructions, other than death or personal injury caused by Samsung's negligence.
1. Remove the rubber cover from the left side of the neckband by pulling it from the end of the left neckband. Then, remove the left neckband.
  2. Separate the earphone cable from the neckband cover.
  3. Remove the neckband cover.
  4. Disconnect the battery connector.
  5. Lift the battery and cut the cables.
  6. Remove the battery.

SAMSUNG  
ELECTRONICS



#### Declaration of Conformity

##### Product details

For the following  
Product : Bluetooth Stereo Headset  
Model(s) : EO-BG935



##### Declaration & Applicable standards

We hereby declare, that the product above is in compliance with  
the essential requirements of the R&TTE Directive (1999/5/EC)  
by application of:

SAFETY EN 60950-1 : 2006 + A11 : 2009 + A1 : 2010 + A12 : 2011  
SAR EN 62479 : 2010  
EMC EN 301 489-1 V1.9.2 (09-2011)  
EN 301 489-17 V2.2.1 (09-2012)  
RADIO EN 300 328 V1.8.1 (06-2012)

and the Directive (2011/65/EU) on the restriction of the use  
of certain hazardous substances in electrical and electronic  
equipment by application of EN 50581:2012.

##### Representative in the EU

Samsung Electronics Euro QA Lab.  
Blackbushe Business Park  
Saxony Way, Yateley, Hampshire  
GU46 6GG, UK

2016.00.00 Stephen Colclough / EU Representative  
(Place and date of issue)

(Name and signature of authorised person)

\* This is not the address of Samsung Service Centre. For the address or  
the phone number of Samsung Service Centre, see the warranty card or  
contact the retailer where you purchased your product.