

Quick Start Guide
SM-R600

Printed in Korea
GH68-48612B Rev.1.0
English (EU), 07/2017



Package contents

- Gear
 - Charger dock
 - Band
 - Quick start guide
- ✎ The items supplied with the Gear and any available accessories may vary depending on the region or service provider.
- The supplied items are designed only for this Gear and may not be compatible with other devices.

2

Device layout

To turn on the Gear, press and hold the Home key (Power key) for a few seconds.

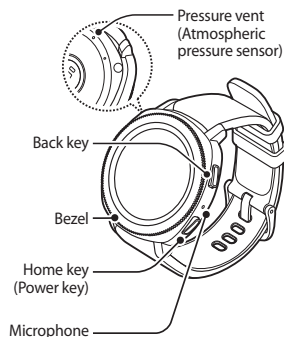

3

- ⚠ Do not insert sharp objects into the pressure vent (atmospheric pressure sensor). Inner components of the Gear can be damaged.

Charging the battery

Before using the device for the first time, you must charge the battery.

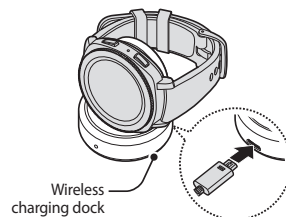

- ⚠ Use only Samsung-approved chargers.

4

- ✎ Before charging the Gear, remove the rubber cover from the wireless charging dock.
- The charger should remain close to the electric socket and be easily accessible while charging.

Connecting the Gear to a mobile device

To connect your Gear to a mobile device, install the Samsung Gear app on the mobile device. Depending on your mobile device, you can download the Samsung Gear app from the following places:

- Samsung Android devices: **Galaxy Apps, Play Store**

5

- Other Android devices: **Play Store**
- iOS devices: **App Store**

Gear

- 1 Turn on the Gear.
- 2 Select a language to use and tap **NEXT**.

A screen will appear about downloading and installing the Samsung Gear app.

- ✎ If you want to use your Gear without connecting it to a mobile device, tap **?**, scroll down the screen, and then tap **here**.
- Visit www.samsung.com to view legal notices provided when setting Without phone connection mode for the first time.

6

Mobile device

- 3 Launch **Samsung Gear**. If necessary, update the Samsung Gear app to the latest version.
- 4 Tap **START THE JOURNEY**.
- 5 Select your Gear type on the screen. If you cannot find your Gear type, tap **MINE'S NOT HERE**.
- 6 Tap **TURN ON** when the Bluetooth activation request window appears.
- 7 Follow the on-screen instructions to complete the connection.

7

If your device is frozen and unresponsive, press and hold the Home key (Power key) for more than 7 seconds to restart it.

Declaration of Conformity

Samsung Electronics declares that this device complies with the essential requirements and relevant provisions of Directive 2014/53/EU.

Go to www.samsung.com/mobile_doc to view the Declaration of Conformity.

Samsung Electronics (UK) Ltd, Euro QA Lab.
Blackbushe Business Park, Saxony Way, Yateley,
Hampshire. GU46 6GG, United Kingdom

Some content may differ from your device depending on the region, service provider, or software version, and is subject to change without prior notice.

8

When the devices are connected, an on-screen tutorial will appear on the Gear's screen.

- ✎ Connection methods may vary depending on your mobile device and software version.
- Supported mobile devices and features may vary depending on your region, service provider, and device manufacturer. Visit www.samsung.com to see a list of compatible devices.

Turning the screen on and off

To turn on the screen, rotate the bezel. Or, press the Home key or the Back key.

To turn off the screen, cover it with your palm.

Using the bezel

Rotate the bezel to scroll through the screens or to highlight items.

When a call comes in, rotate the bezel to receive or reject the incoming call.

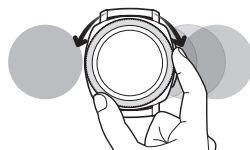

9

Switching the screen

To return to the previous screen, press the Back key.

To open the Apps screen, press the Home key on the Watch screen.

To return to the Watch screen, press the Home key.

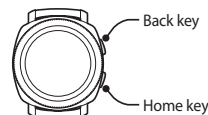

10

Replacing the band

Slide the band's spring bar inwards **(1)** and pull the band away from the Gear's body **(2)**.

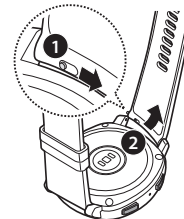

11

Insert one end of the spring bar into the Gear's lug **(1)**, slide the spring bar inwards **(2)**, and connect the band.

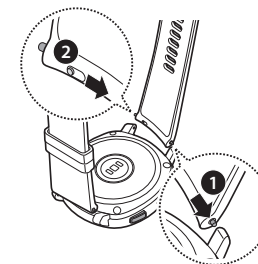

12

Using the call function

On your Gear, directly make or receive calls. You can have phone conversations via the connected Bluetooth headset.

Answering a call

When a call comes in, drag outside the large circle. Alternatively, rotate the bezel clockwise.

Making a call

- 1 Tap (**Phone**) on the Apps screen.
- 2 Tap , select a contact, and then tap . Alternatively, tap , enter a number using the keypad, and then tap .

13

Accessing more information

To view the full user manual, launch **Samsung Gear** on you mobile device and tap → **User manual**.

Visit www.samsung.com to view device information, the user manual, and more.

- The method for accessing the user manual from the Samsung Gear app may vary depending on your mobile device.
- The user manual may not be available depending on the web browser or service provider.

14

Notice for measuring the heart rate

When measuring your heart rate, wear the Gear securely on your wrist towards the elbow to avoid touching the wrist bone stuck out. Do not fasten the Gear too tightly.

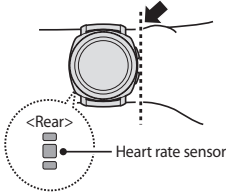

15

- The accuracy of the heart rate sensor can be affected depending on the user's movements, personal physiology, and the measurement conditions and surroundings. Take heart rate measurements when you are seated and relaxed.
- Do not look directly at the heart rate sensor's lights. Doing so may impair your vision.
- If your device becomes hot to the touch, please remove it until it cools. Exposing skin to a hot surface of the device for a long time may cause skin burn.

16

THIS DEVICE AND ANY SOFTWARE, SERVICE, FUNCTION PROVIDED THEREIN IS SOLELY INTENDED FOR FITNESS AND WELLNESS PURPOSES ONLY AND IS NOT INTENDED FOR USE IN THE DIAGNOSIS OF DISEASE OR OTHER CONDITIONS, OR IN THE CURE, MITIGATION, TREATMENT OR PREVENTION OF DISEASE.

Any information that is obtained from use of the Gear or the Fit Software or any application preloaded within may not be suitable, accurate, complete or reliable.

17

Correct disposal

This marking on the product, accessories or literature indicates that the product and its electronic accessories (e.g. charger, headset, USB cable) should not be disposed of with other household waste. This product is RoHS compliant.

This marking on the battery, manual or packaging indicates that the batteries in this product should not be disposed of with other household waste.

For information on Samsung's environmental commitments and product-specific regulatory obligations, e.g. REACH, WEEE, Batteries, visit samsung.com/uk/aboutsamsung/samsungelectronics/corporatecitizenship/data_corner.html

18

Safety information

Read all safety information before using the device to ensure safe and proper use.

Warning

Follow the warning information provided below to prevent incidents such as fire or explosion

- Do not expose the device to physical impact or damage.
- Use manufacturer-approved chargers, accessories, and supplies.
- Prevent the multipurpose jack and battery terminals from contacting conductive elements, such as metal or liquids.
- If any part of the device is cracked or broken, stop using the device immediately and take it to a Samsung Service Centre.
- Do not turn on or use the device when the battery compartment is exposed.

19

Follow the warnings below to prevent injury to people or damage to the device

- Do not allow children or animals to chew or suck the device.
- The device can be used in locations with an ambient temperature of 0 °C to 35 °C. You can store the device at an ambient temperature of -20 °C to 50 °C. Using or storing the device outside of the recommended temperature ranges may damage the device or reduce the battery's lifespan.
- Do not use your device in a hot environment or near fire.
- Comply with all safety warnings and regulations regarding mobile device usage while operating a vehicle.
- Do not wear the device too tightly. Make sure to keep the device clean and dry. Though this device has met international safety standards, some people may experience skin irritation if they are allergic to certain substances.

20

To prevent possible hearing damage when using a headset, do not listen to sound at high volume for long periods.

To view the full safety information including device and battery disposal instructions, launch **Samsung Gear** on you mobile device and tap → **User manual**.

Maintaining water and dust resistance

Your device supports water- and dust-resistance. Follow these tips carefully to maintain the water- and dust-resistance of your device. Failure to do so may result in damage to your device.

- Do not immerse the device in water deeper than 1.5 m or keep it submerged for more than 30 minutes.
- Do not expose the device to **water moving with force**.

21

- When you are wearing the device, avoid taking a shower or going swimming.
- If the device or your hands are wet, dry them thoroughly before handling the device.
- If the device is exposed to clean water, dry it thoroughly with a clean, soft cloth. If the device is exposed to other liquids, such as salt water, ionised water, or alcoholic beverage, rinse it with clean water and dry it thoroughly with a clean, soft cloth. If you do not follow these instructions, the device's performance and appearance may be affected.
- If the device is dropped or receives an impact, the water- and dust-resistant features of the device may be damaged.
- If the device has been immersed in water or the microphone or speaker is wet, sound may not be heard clearly during a call. Wipe the device with a dry cloth or dry it thoroughly before using it.
- The touchscreen and other features may not work properly if the device is used in water.

22

Your device has been tested in a controlled environment and certified to be water- and dust-resistant in specific situations (meets requirements of classification IP68 as described by the international standard IEC 60529 - Degrees of Protection provided by Enclosures [IP Code]; test conditions: 15 - 35 °C, 86 - 106 kPa, 1.5 metre, 30 minutes). Despite this classification, it is still possible for your device to be damaged in certain situations.

23

Specific Absorption Rate (SAR) certification information

THIS DEVICE MEETS INTERNATIONAL GUIDELINES FOR EXPOSURE TO RADIO WAVES

SAR

www.sar-tick.com

Your mobile is designed not to exceed the limits for exposure to radio waves recommended by international guidelines. The guidelines were developed by an independent scientific organisation (ICNIRP) and include a substantial safety margin designed to assure the safety of all persons, regardless of age and health.

The radio wave exposure guidelines use a unit of measurement known as the Specific Absorption Rate, or SAR. The SAR limit for mobile devices is 2.0 W/kg for Head and Body, 4.0 W/kg for Limb. The highest SAR values under the ICNIRP guidelines for this device model are:

24

SAR values for European countries: The SAR values below are only for devices developed for use in European countries.

Maximum SAR for this model and conditions under which it was recorded	
Limb SAR	X.XXX W/kg
Front of face SAR	X.XXX W/kg

(Head SAR limit is also applicable for the front of face SAR.) Front of face SAR testing has been carried out at a separation distance of X.X cm. To meet RF exposure guidelines during Front of face operation, the device should be positioned at least this distance away from your face.

For SAR values for all other countries: For SAR values specific to your model, visit www.samsung.com/sar and search for your region and device with the model number.

25

Removing the battery

- To remove the battery, contact an authorised service centre. To obtain battery removal instructions, please visit www.samsung.com/global/ecodesign_energy.
- For your safety, you **must not attempt to remove** the battery. If the battery is not properly removed, it may lead to damage to the battery and device, cause personal injury, and/or result in the device being unsafe.
- Samsung does not accept liability for any damage or loss (whether in contract or tort, including negligence) which may arise from failure to precisely follow these warnings and instructions, other than death or personal injury caused by Samsung's negligence.

26

Band and mode	Output power
Wi-Fi 2.4 GHz	20 dBm
Bluetooth 2.4 GHz	20 dBm
MST 3-6 kHz	H field of 21 A/m at 0 m
NFC 13.56 MHz	H field of 42 dBuA/m at 10 m
Wireless Charging 120 kHz-148.4 kHz	H field of 37.7 dBuA/m at 10 m
Wireless Charging 148.5 kHz-190 kHz	H field of -5 dBuA/m at 10 m

27

FCC Warning Statement

FCC Part 15.19

This device complies with part 15 of the FCC Rules. Operation is subject to the following two conditions: (1) this device may not cause harmful interference, and (2) this device must accept any interference received, including interference that may cause undesired operation.

FCC Part 15.21

Any changes or modifications (including the antennas) to this device that are not expressly approved by the manufacturer may void the user's authority to operate the equipment.

FCC Radiation Exposure Statement

This equipment complies with FCC Radiation exposure limits set forth for an uncontrolled environment. This device and its antenna must not be co-located or operating in conjunction with any other antenna or transmitter.

This equipment should be installed and operated with a minimum distance of 20cm between the radiator and your body.

IC Warning Statement

This device complies with Industry Canada licence-exempt RSS standard(s).

Operation is subject to the following two conditions: (1) this device may not cause interference, and (2) this device must accept any interference, including interference that may cause undesired operation of the device.

Le présent appareil est conforme aux CNR d'Industrie Canada applicables aux appareils radio exempts de licence. L'exploitation est autorisée aux deux conditions suivantes : (1) L'appareil ne doit pas produire de brouillage, et (2) L'utilisateur de l'appareil doit accepter tout brouillage radioélectrique subi, même si le brouillage est susceptible d'en compromettre le fonctionnement.

IC Radiation Exposure Statement

This equipment complies with IC RF Radiation exposure limits set forth for an uncontrolled environment. This device and its antenna must not be co-located or operating in conjunction with any other antenna or transmitter.

This equipment should be installed and operated with a minimum distance of 20cm between the radiator and your body.

Cet équipement est conforme aux limites établies par Industrie Canada en matière d'exposition aux radiofréquences dans un environnement non contrôlé. Cet appareil et son antenne ne doivent pas être colocalisés ou fonctionner en conjonction avec tout autre antenne ou émetteur.

Cet équipement doit être installé et utilisé avec une distance minimale de 10cm entre le radiateur et votre corps.