



# DIGITAL HOME CINEMA SYSTEM

## HT-DB390

THIS APPLIANCE IS MANUFACTURED BY:

### Instruction Manual



## **User's Manual Information**

### **Acknowledging Special Precautions and the FCC Industry Canada Notice Cautions**

Modifications not expressly approved by the party responsible for compliance could void the user's authority to operate the equipment.

### **FCC compliance Information**

This device complies with part 15 of FCC Rules.

Operation is subject to the following two conditions:

1. This device may not cause harmful interference, and
2. This device must accept any interference received.

Including interference that may cause undesired operation.

### **Information to User**

This equipment has been tested and found to comply with the limits for a Class B digital device, Pursuant to part 15 of the FCC Rules. These limits are designed to provide reasonable protection against harmful interference in a residential installation.

This equipment generates, uses and can radiate radio Frequency energy and, if not installed and used in accordance with the instructions, may cause harmful interference to radio communications.

However, there is no guarantee that interference will not occur in a particular installation. If this equipment does cause harmful interference to radio or television reception, which can be determined by turning the equipment off and on, the user is encouraged to try to correct the interference by one or more of the following measures:

- Reorient or relocate the receiving antenna.
- Increase the separation between the equipment and receiver
- Connect the equipment into an outlet on a circuit different from that to which the receiver is connected.
- Consult the dealer or an experienced radio/TV technician for help.

# Safety Warnings

**CLASS 1 LASER PRODUCT  
KLASSE 1 LASER PRODUKT  
LUOKAN 1 LASER LAITE  
KLASS 1 LASER APPARAT  
PRODUCTO LASER CLASE 1**



**CAUTION:**  
TO REDUCE THE RISK OF ELECTRIC SHOCK, DO NOT REMOVE REAR COVER. NO USER SERVICEABLE PARTS INSIDE. REFER SERVICING TO QUALIFIED SERVICE PERSONNEL.

## CLASS 1 LASER PRODUCT

This Compact Disc player is classified as a CLASS 1 LASER product.

## Wiring the Main Power Supply Plug(UK Only)

### IMPORTANT NOTICE

The main lead on this equipment is supplied with a moulded plug incorporating a fuse. The value of the fuse is indicated on the pin face of the plug and if it requires replacing, a fuse approved to BS1362 of the same rating must be used.

Never use the plug with the fuse cover removed. If the cover is detachable and a replacement is required, it must be of the same colour as the fuse fitted in the plug. Replacement covers are available from your dealer.

If the fitted plug is not suitable for the power points in your house or the cable is not long enough to reach a power point, you should obtain a suitable safety approved extension lead or consult your dealer for assistance.

However, if there is no alternative to cutting off the plug, remove the fuse and then safely dispose of the plug. Do not connect the plug to a main socket as there is a risk of shock hazard from the bared flexible cord.

Never attempt to insert bare wires directly into a main socket. A plug and fuse must be used at all times.

### IMPORTANT

The wires in the main lead are coloured in accordance with the following code:-

**BLUE = NEUTRAL      BROWN = LIVE**

As these colours may not correspond to the coloured markings identifying the terminals in your plug, proceed as follows:-

The wire coloured BLUE must be connected to the terminal marked with the letter N or coloured BLUE or BLACK.

The wire coloured BROWN must be connected to the terminal marked with the letter L or coloured BROWN or RED.

**WARNING: DO NOT CONNECT EITHER WIRE TO THE EARTH TERMINAL WHICH IS MARKED WITH THE LETTER E OR BY THE EARTH SYMBOL , OR COLOURED GREEN OR GREEN AND YELLOW.**

# Precautions

Use of controls, adjustments or performance of procedures other than those specified herein may result in hazardous radiation exposure.

### CAUTION-INVISIBLE LASER RADIATION WHEN OPEN AND INTERLOCKS DEFEATED, AVOID EXPOSURE TO BEAM.

 This symbol indicates that dangerous voltage which can cause electric shock is present inside this unit.

 This symbol alerts you to important operating and maintenance instructions accompanying the unit.

**WARNING:** To reduce the risk of fire or electric shock, do not expose this appliance to rain or moisture.

**CAUTION:** TO PREVENT ELECTRIC SHOCK, MATCH WIDE BLADE OF PLUG TO WIDE SLOT, FULLY INSERT.

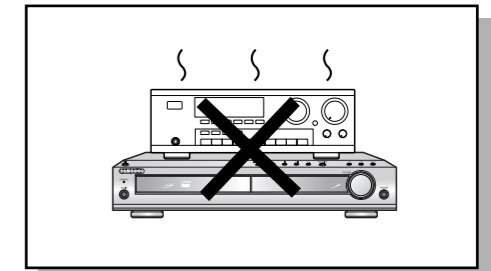
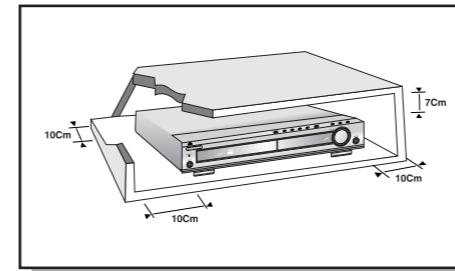

Ensure that the AC power supply in your house complies with the identification sticker located on the back of your player. Install your player horizontally, on a suitable base (furniture), with enough space around it for ventilation (3~4inches). Make sure the ventilation slots are not covered. Do not stack anything on top of the player. Do not place the player on amplifiers or other equipment which may become hot. Before moving the player, ensure the disc tray is empty. This player is designed for continuous use. Switching off the DVD player to the stand-by mode does not disconnect the electrical supply. In order to disconnect the player completely from the power supply, remove the main plug from the wall outlet, especially when left unused for a long period of time.

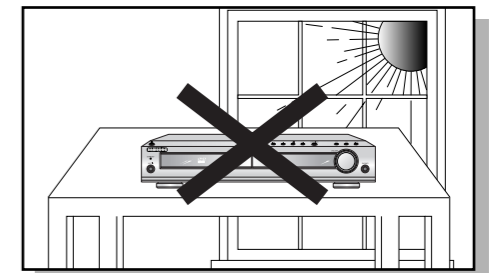
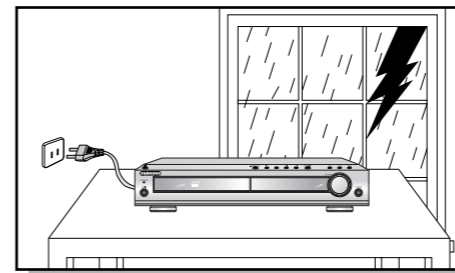

During thunderstorms, disconnect AC main plug from the wall outlet. Voltage peaks due to lightning could damage the unit.

Do not expose the unit to direct sunlight or other heat sources. This could lead to overheating and malfunction of the unit.

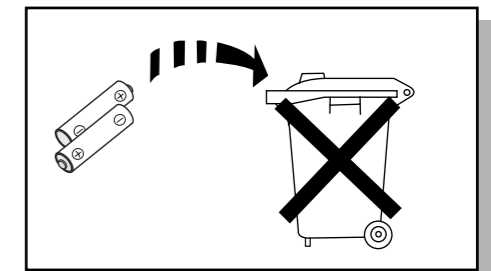
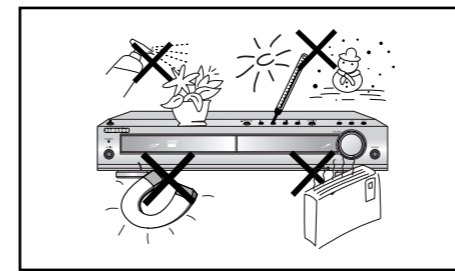

Protect the player from moisture(i.e. vases), and excess heat(e.g.fireplace) or equipment creating strong magnetic or electric fields (i.e.speakers...). Disconnect the power cable from the AC supply if the player malfunctions. Your player is not intended for industrial use.

The battery used with this product contain chemicals that are harmful to the environment. Do not dispose of batteries in the general household trash.

Use of this product is for personal use only.

Condensation may occur if your player or disc have been stored in cold temperatures.

If transporting the player during the winter, wait approximately 2 hours until the unit has reached room temperature before using.

# Features

## ● Multi-Disc Playback & AM/FM Tuner

The HT-DB350 combines the convenience of multi-disc playback capability, including DVD, VCD, CD, MP3-CD, CD-R, CD-RW, and DVD-RW, with a sophisticated AM/FM tuner, all in a single player.

## ● Built-in 5.1-Channel Amplifier

The HT-DB350 comes with a built-in 5.1-channel amplifier, allowing you to enjoy dynamic sound.

## ● Super Digital Sound Master

Equipped with a new digital audio technology (auto sound calibration, magic sound field, and magic headphone) developed in cooperation with DiMagic Co., Ltd. in Japan, you can enjoy a more lively and high-sensitive sound.



## ● Sound Logo

When power is turned on, a sound logo is output from speakers to notify the user that the unit is optimized for disc playback.

## ● TV Screen Saver Function

The HT-DB350 automatically brightens and darkens the brightness of the TV screen after 2 minutes in the stop or pause mode. The HT-DB350 automatically switches itself into the power saving mode after 20 minutes in the screen saver mode.

## ● Power Saving Function

The HT-DB350 automatically shuts itself off after 20 minutes in the stop or pause mode.

## ● Customized TV Screen Display

The HT-DB350 allows you to select your favorite image during JPEG, DVD, or VCD playback and set it as your background wallpaper.

# Contents

## ● PREPARATION

Safety Warnings.....	1
Precautions.....	2
Features.....	3
Notes on Discs.....	5
Description.....	7

## ● CONNECTIONS

Connecting the Speakers.....	11
Connecting the FM and AM(MW/LW) Antennas.....	15
Connecting the Video to TV.....	16
Connecting External Components.....	17
Before Using Your DVD Player.....	19

## ● OPERATION

Disc Playback.....	21
Displaying Disc Information.....	22
Fast/Slow Playback.....	23
Skipping Scenes/Songs.....	24
Repeat Playback.....	25
A-B Repeat Playback.....	26
Angle Function.....	27
Zoom Function.....	28
Selecting Audio/Subtitle Language.....	29
Moving Directly to a Scene/Song.....	30
Using Disc Menu.....	31
Using the Title Menu.....	32

## ● SETUP

Setting the Language.....	33
Setting TV Screen type.....	35
Setting Parental Controls (Rating Level).....	37
Setting the Password.....	39
Setting the Wallpaper.....	41
Setting the Speaker Mode.....	43
Setting the Test Tone.....	44
Setting the Delay Time.....	45
Setting the Audio Quality.....	47
Setting the DRC (Dynamic Range Compression).....	49
Auto Sound Calibration Setup.....	51
Magic Sound Field Mode.....	53
Dolby Pro Logic II Mode.....	55
Dolby Pro Logic II Effect.....	56

## ● RADIO OPERATION

Listening to Radio.....	57
Presetting Stations.....	58
About RDS broadcasting.....	59

## ● MISCELLANEOUS

Convenient Functions.....	61
Operating the TV with the Remote Control.....	63
Before Calling for Service.....	65
Cautions on Handling and Storing Discs.....	67
Specifications.....	68
Notes on Terminology.....	69
Memo.....	70

# Notes on Discs



**DVD (Digital Versatile Disc)** offers fantastic audio and video, thanks to Dolby Digital surround sound and MPEG-2 video compression technology. Now you can enjoy these realistic effects in the home, as if you were in a movie theater or concert hall.



DVD players and the discs are coded by region. These regional codes must match in order for the disc to play. If the codes do not match, the disc will not play. The Region Number for this player is given on the rear panel of the player. (Your DVD player will only play DVDs that are labeled with identical region codes.)

## Playable Discs

Disc Type	Mark (Logo)	Recorded Signals	Disc Size	Max. Playing Time
DVD		Audio + Video	12cm	Approx. 240 min. (single-sided) Approx. 480 min. (double-sided)
			8cm	Approx. 80 min. (single-sided) Approx. 160 min. (double-sided)
VIDEO-CD		Audio + Video	12cm	74 min.
			8cm	20 min.
AUDIO-CD		Audio	12cm	74 min.
			8cm	20 min.

## Do not use the following types of disc!

- LD, CD-G, CD-I, CD-ROM and DVD-ROM cannot be played on this player. If such discs are played, a "WRONG DISC FORMAT" message appears on the TV screen.
- DVD discs purchased abroad may not play on this player. If such discs are played, a "WRONG REGION CODE" message appears on the TV screen.

## Copy Protection

- Many DVD discs are encoded with copy protection. Because of this, you should only connect your DVD player directly to your TV, not to a VCR. Connecting to a VCR results in a distorted picture from copy-protected DVD discs.
- This product incorporates copyright protection technology that is protected by methods claims of certain U.S. patents and other intellectual property rights owned by Macrovision Corporation and other rights owners. Use of this copyright protection technology must be authorized by Macrovision Corporation, and is intended for home and other limited viewing uses only unless otherwise authorized by Macrovision Corporation. Reverse engineering or disassembly is prohibited.

## Disc Recording Format

### CD-R Discs

- Depending on the disc recording device (CD-Recorder or PC ) and the condition of the disc, some CD-R discs may not be playable.
- Use a 650MB/74 minute CD-R. Avoid CD-R media, as they may not be playable.
- If possible, do not use CD-RW (Rewritable) media, as they may not be playable.
- Only the CD-Rs that are properly "closed" can be fully played. If the session is closed but the disc is left open, you may not be able to fully play the disc.

### CD-R MP3 Discs

- Only CD-R discs with MP3 files in ISO 9660 or Joliet format can be played.
- MP3 file names should be 8 characters or less in length and contain no blank spaces or special characters ( / = + ).
- Use discs recorded with a compression/decompression data rate greater than 128Kbps.
- Only files with the ".mp3" and ".MP3" extensions can be played.
- Only a consecutively written Multisession disc can be played. If there is a blank segment in the Multisession disc, the disc can be played only up to the blank segment.
- If the disc is not closed, it will take longer to begin playback and not all of the recorded files may be played.
- For files encoded in Variable Bit Rate (VBR) format, i.e. files encoded in both low bit rate and high bit rate (e.g., 32Kbps ~ 320Kbps), the sound may skip during playback.
- If more than 500 tracks are recorded on a single CD, a maximum of 500 tracks can be played.
- If more than 300 folders are recorded on a single CD, a maximum of 300 folders can be played.

#### What is MP3?

MP3 is short for MPEG-1 Audio Layer 3 and MPEG is an acronym for Moving Pictures Experts Group. MP3 is a file format with compression ratio of 1:12 (128 Kbps\*) That is, you can use MP3 format to record about 12 times the usual amount of data on a regular CD.

### CD-R JPEG Discs

- Only files with the ".jpeg" and ".JPEG" extensions can be played.
- If the disc is not closed, it will take longer to start playing and not all of the recorded files may be played.
- Only CD-R discs with JPEG files in ISO 9660 or Joliet format can be played.
- JPEG file names should be 8 characters or less in length and contain no blank spaces or special characters ( / = + ).
- Only a consecutively written multisession disc can be played. If there is a blank segment in the multisession disc, the disc can be played only up to the blank segment.
- A maximum of 9,999 images can be stored on a single CD.
- When playing a Kodak/Fuji Picture CD, only the JPEG files in the picture folder can be played.
- Picture discs other than Kodak/Fuji Picture CDs may take longer to start playing or may not play at all.

# Description

## —Front Panel—

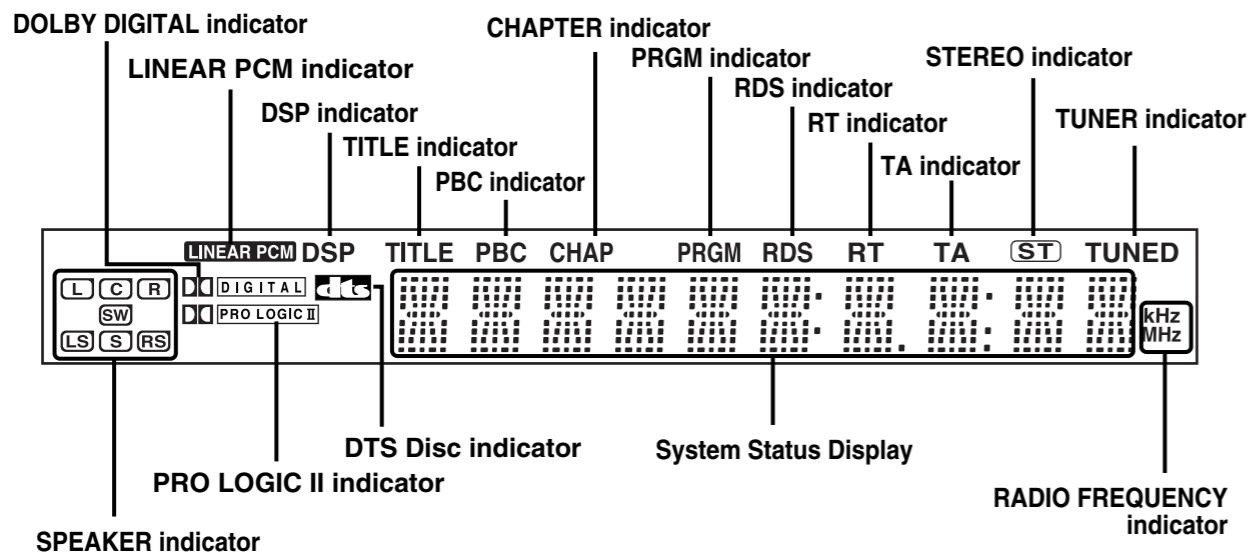
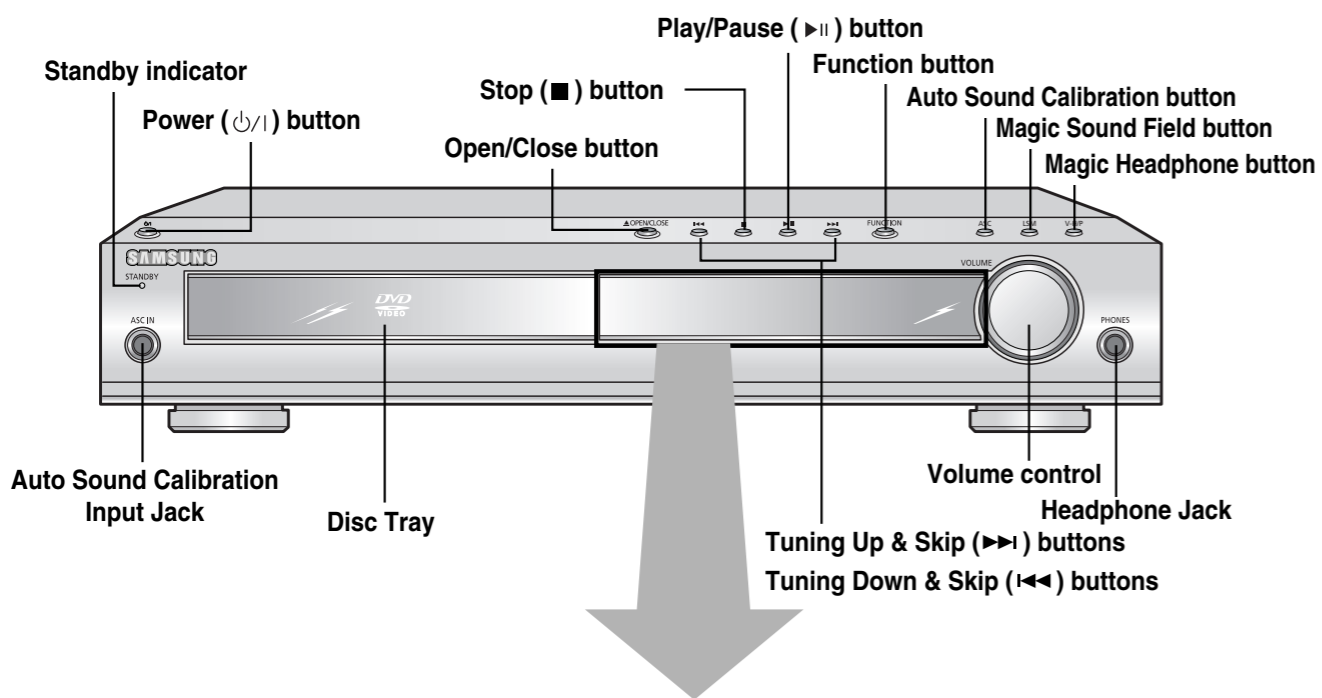

## —Rear Panel—

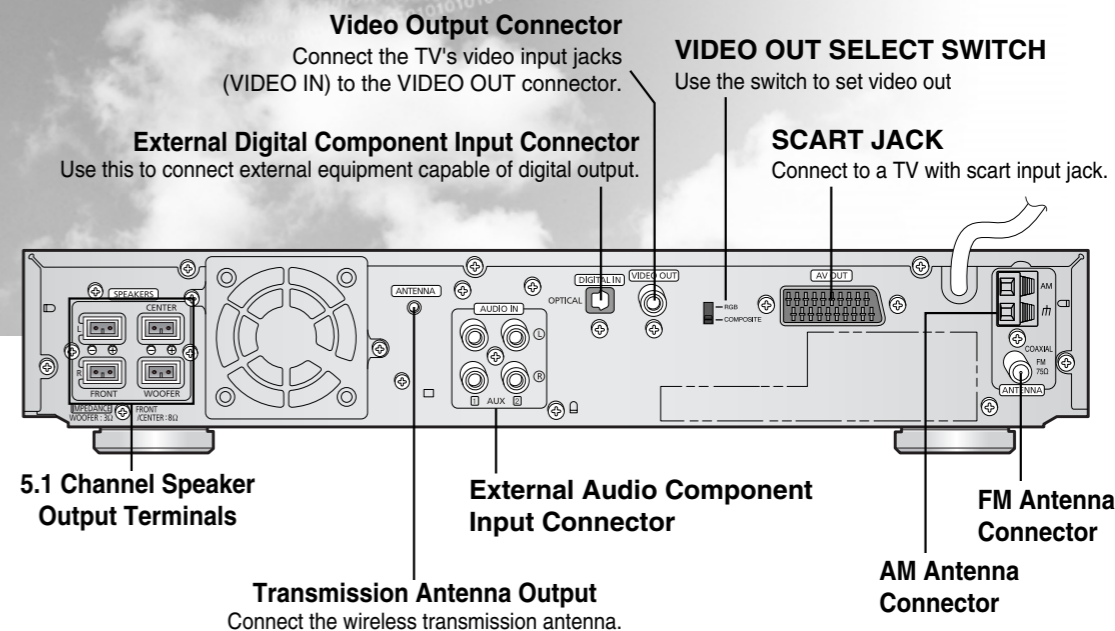

## Accessories

\*The wireless receiving antenna is built into the wireless rear amplifier.

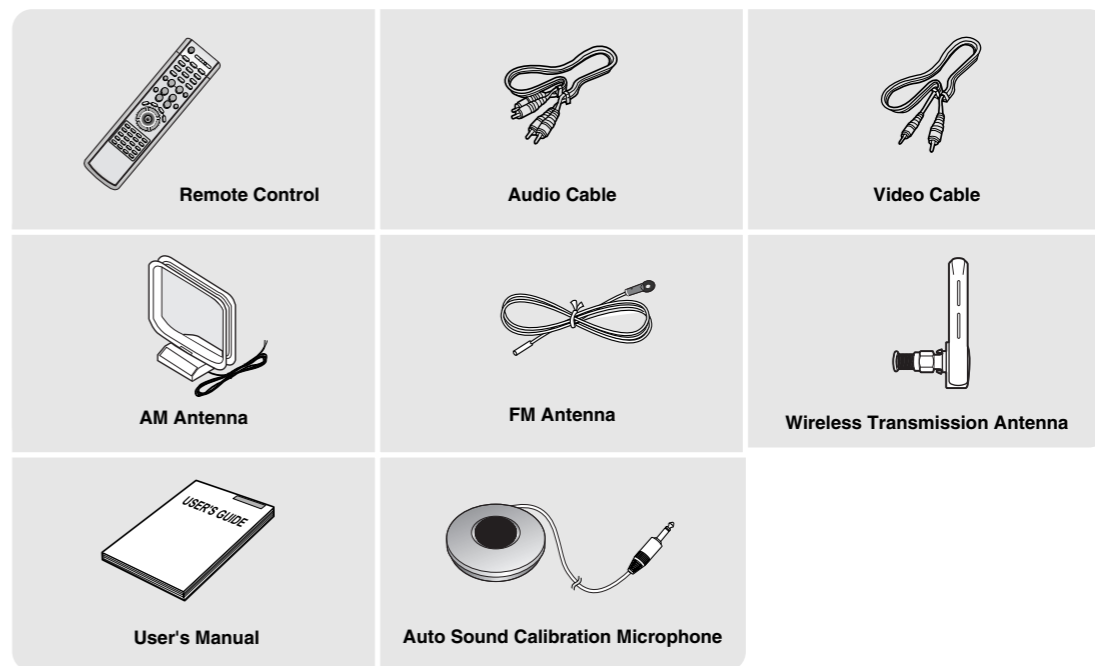

# Description

## —Remote Control—

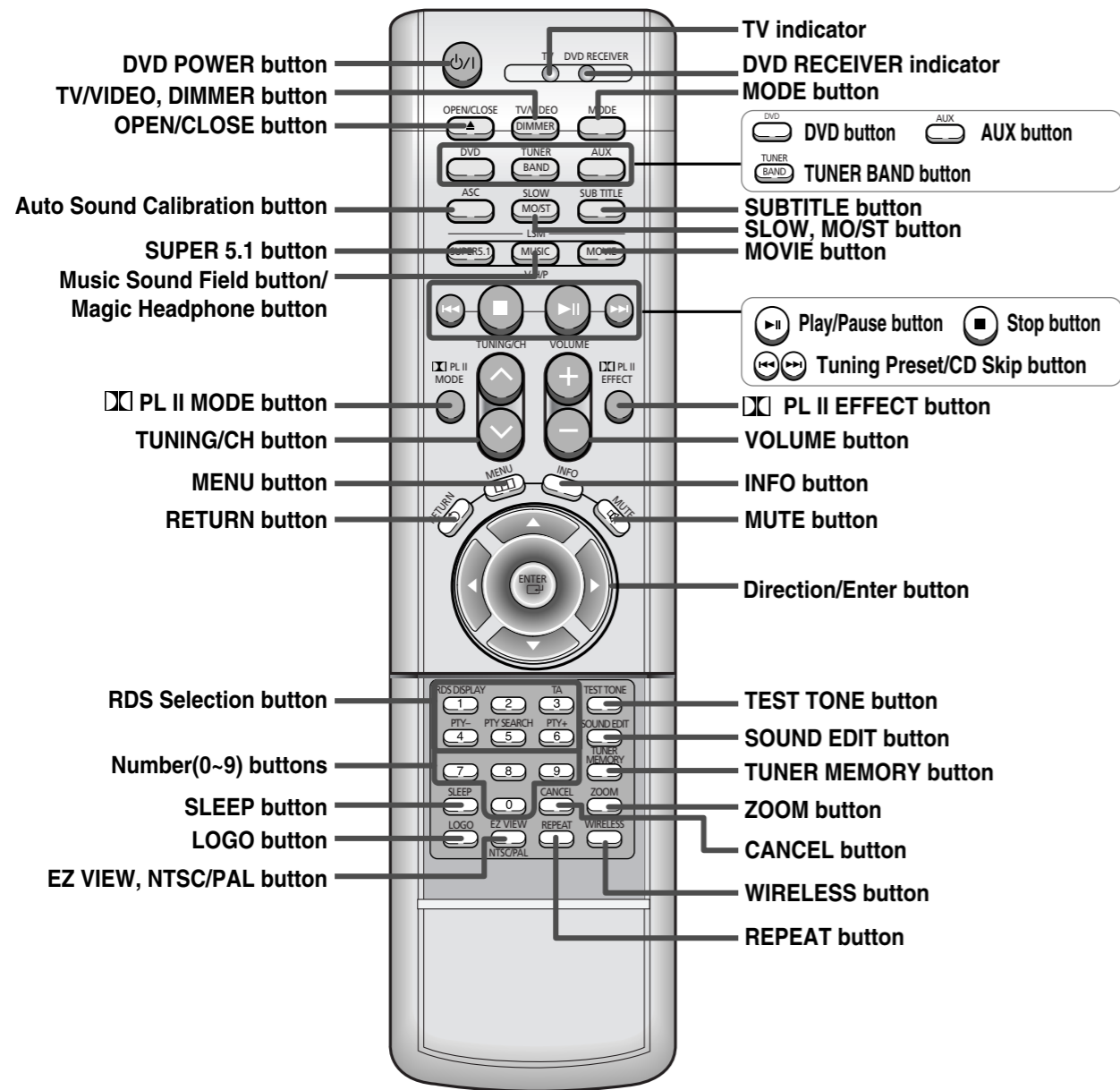

## Insert Remote Batteries

**1** Remove the battery cover on the back of the remote by pressing down and sliding the cover in the direction of the arrow.

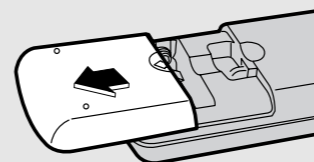

**2** Insert two 1.5V AAA batteries, paying attention to the correct polarities (+ and -).

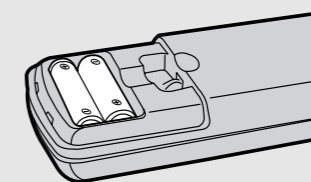

**3** Replace the battery cover.

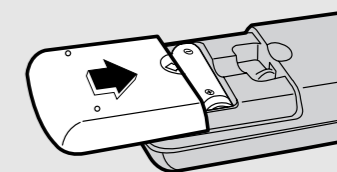

### Caution

Follow these precautions to avoid leaking or cracking cells:

- Place batteries in the remote control so they match the polarity:(+) to (+)and (-)to (-).
- Use the correct type of batteries.Batteries that look similar may differ in voltage.
- Always replace both batteries at the same time.
- Do not expose batteries to heat or flame.

## Range of Operation of the Remote Control

The remote control can be used up to approximately 23 feet/7 meters in a straight line. It can also be operated at a horizontal angle of up to 30° from the remote control sensor.

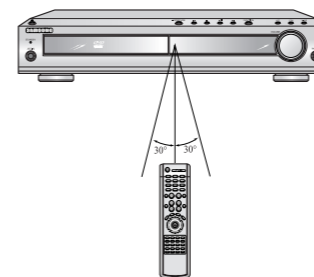

To open the remote control cover, push the top of the cover, then slide downward.

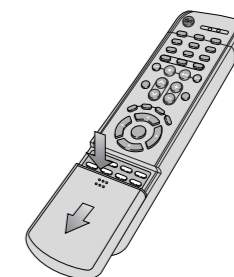

# Connecting the Speakers

Before moving or installing the product, be sure to turn off the power and disconnect the power cord.

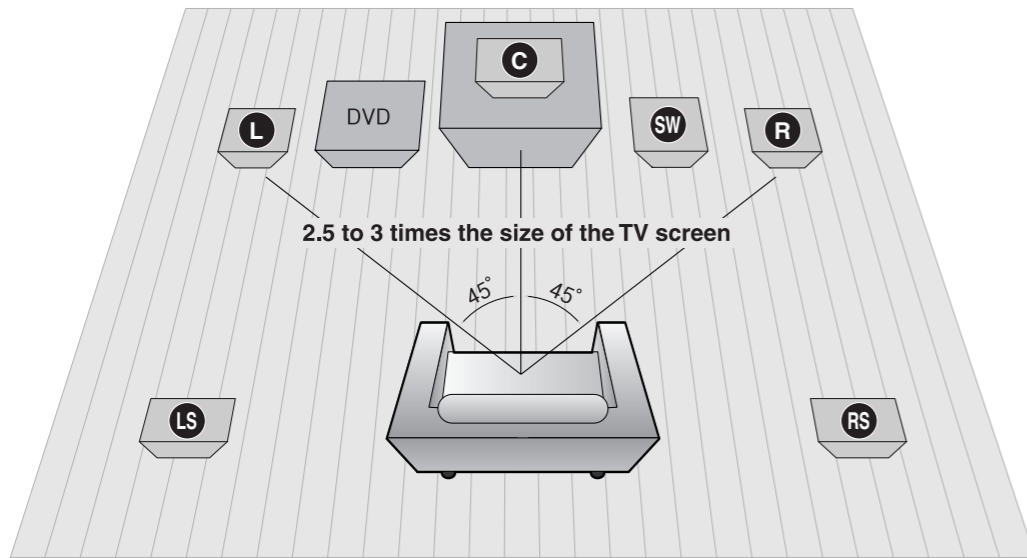

## Position of the DVD Player

- Place it on a stand or cabinet shelf, or under the TV stand.

## Front Speakers **L R**

- Place these speakers in front of your listening position, facing inwards (about 45°) toward you.
- Place the speakers so that their tweeters will be at the same height as your ear.
- Align the front face of the front speakers with the front face of the center speaker or place them slightly in front of the center speakers.

## Center Speaker **C**

- It is best to install it at the same height as the front speakers.
- You can also install it directly over or under the TV.

## Selecting the Listening Position

The listening position should be located about 2.5 to 3 times the distance of the TV's screen size away from the TV. Example: For 32" TVs 2~2.4m (6~8feet)  
For 55" TVs 3.5~4m (11~13feet)

## Rear Speakers **LS RS**

- Place these speakers behind your listening position.
- If there isn't enough room, place these speakers to face each other.
- Place them about 60 to 90cm (2 to 3feet) above your ear, facing slightly downward.

\* Unlike the front and center speakers, the rear speakers are used to handle mainly sound effects and sound will not come from them all the time.

## Subwoofer **SW**

- The position of the subwoofer is not so critical. Place it anywhere you like.
- Usually, it is placed by a corner near the front speakers.

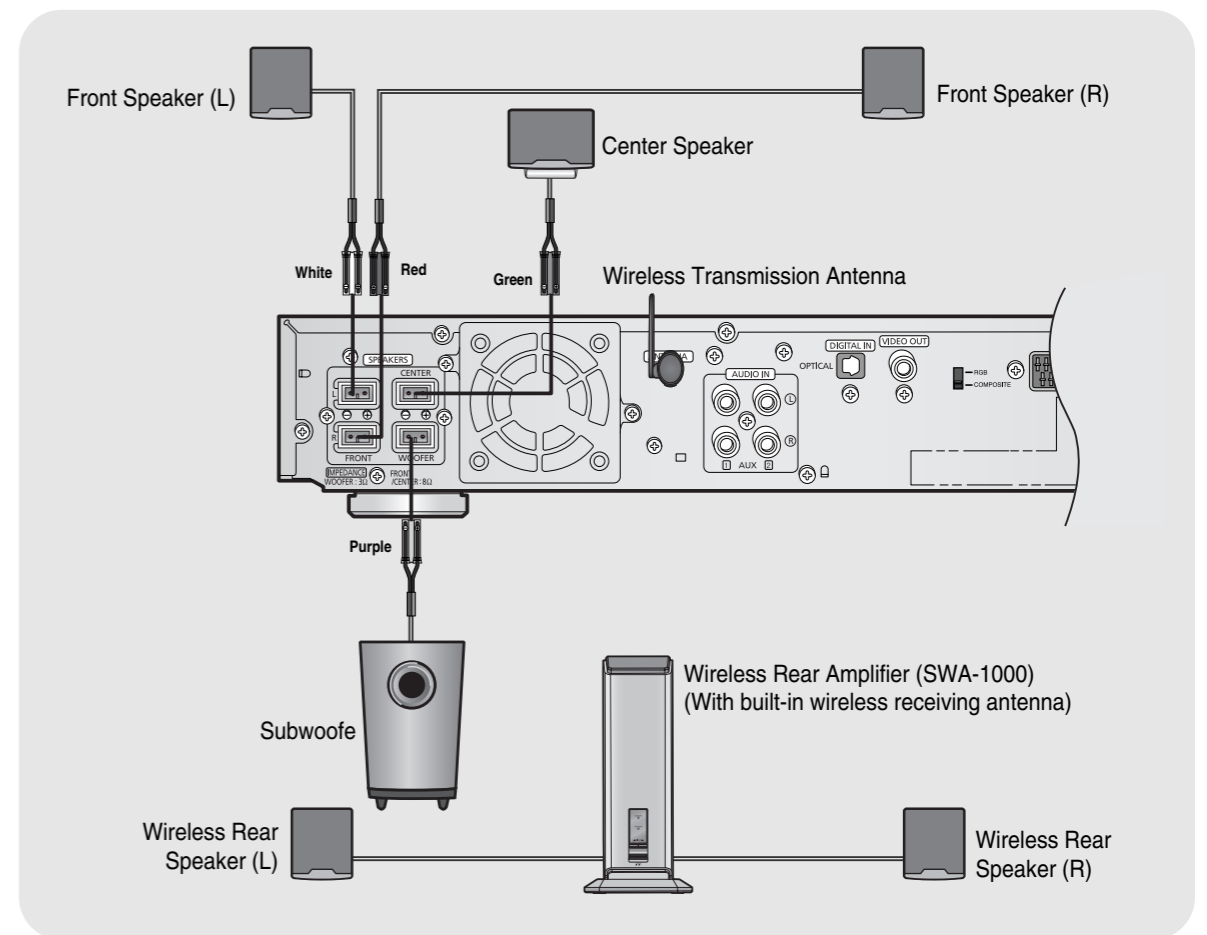

## Back of the Speakers

- Press down the terminal tab on the back of the speaker.

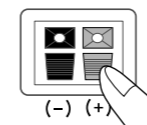

- Insert the wire into the terminal and release the terminal tab.

- Insert the black wire into the black (-) terminal and the gray wire into the gray (+) terminal.
- Make sure the polarities (+ and -) are correctly.

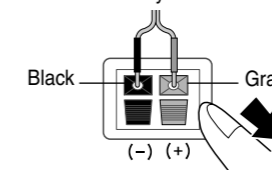

## Back of the Main Unit

- Connect the connecting jacks to the back of the DVD player.

- Make sure the colors of the speaker terminals match the colors of the connecting jacks.
- Make sure the polarities (+ and -) are correctly.

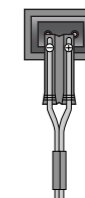

## Installing the Center Speaker to the Stand

- Place the center speaker on the stand.
- Insert the bolt into the hole on the back of the speaker and use a crosshead screwdriver to tighten the bolt.

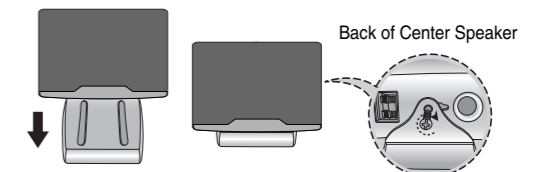



## Connecting Wireless Rear Speakers

- 1 Connect your pair of wireless rear speakers, (L) and (R), to the wireless rear amplifier.
- 2 Insert the power plug into an outlet, and then press the POWER button on the front panel.
  - The Power Standby indicator will light up.

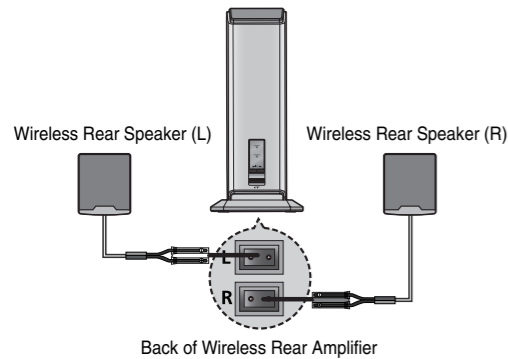

### Caution

- Do not connect the wireless rear speakers to the speaker outputs on the back of the main unit. Malfunction may result.
- The wireless receiving antenna is built into the wireless rear amplifier. Keep the unit away from water and moisture.
- For optimal listening performance, make sure that the area around the proposed wireless rear amplifier location is clear of any obstructions.

## Connecting the Wireless Transmission Antenna to the Main Unit

- 1 Connect the wireless transmission antenna to the back of the main unit and tighten the nut by hand.
- 2 Raise the wireless transmission antenna a full 90 degrees.

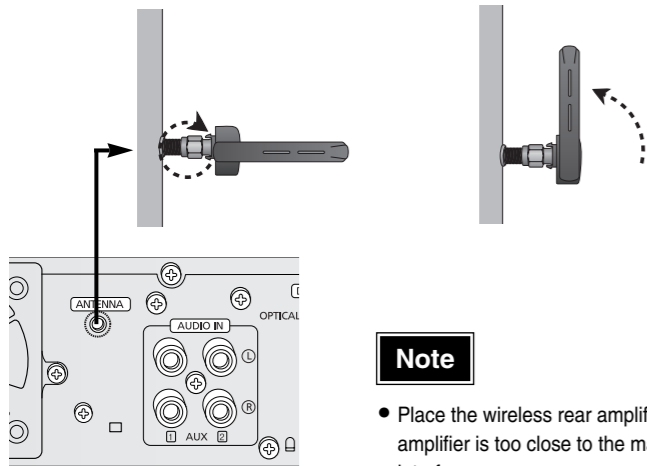

### Caution

- Do not apply a strong shock to the wireless transmission antenna. Breakage may result.
- Do not touch the wireless transmission antenna during operation. Noise or interference to communications may result.

### Note

- Place the wireless rear amplifier at the rear of the listening position. If the wireless rear amplifier is too close to the main unit, some sound interruption may be heard due to interference.
- If you use a device such as a microwave oven, wireless LAN Card, Bluetooth equipment, or any other device that uses the same frequency (2.4GHz) near the system, some sound interruption may be heard due to interference.
- The transmission distance of radio wave is about 33 feet but may vary depending on your operating environment. If a steel-concrete wall or metallic wall is between the main unit and the wireless rear amplifier, the system may not operate at all because the radio wave cannot penetrate metal.

## Resetting Wireless Communication

Reset the system if a communication failure occurs or if the synchronizing signal indicator does not light up and the "REAR CHK" message blinks on the main unit's display because the wireless rear amplifier is not recognized. Reset the system while the main unit and the wireless rear amplifier (SWA-1000) are in Power Standby mode.

- 1 With the main unit turned off, press and hold the remote control's **WIRELESS** for 4 seconds.
  - Press the button until the volume control indicator lights up blue. (The indicator will turn off in 1 second.)
- 2 With the wireless rear amplifier turned on, use a ball point pen or a pair of tweezers to press the **RESET** button on the back of the unit 2 to 3 times.
- 3 Turn on the main unit.
  - The wireless rear amplifier's synchronizing signal indicator will light up.
  - If Power Standby mode continues, repeat Steps 1 to 3 above.

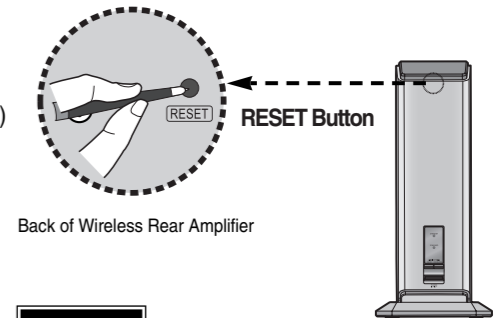

### Caution

- Sound will be heard from the wireless rear speakers in DVD 5.1-CH or Dolby Pro Logic II mode only.
- In 2-CH mode, no sound will be heard from the wireless rear speakers.

## Turning On the Mood Light

You can turn on or off the mood light on the wireless rear amplifier as well as change the color of the light to one of the 7 different colors according to your preference or your room atmosphere.

- 1 Press the **POWER** button.
  - The Power Standby indicator on the front panel will light up and the mood light will turn on.
- 2 Press the **COLOR MODE** button.
  - Each time the button is pressed, the color changes as follows: Blue → Light Green → Red → Sky Blue → Yellow → Pink → White.

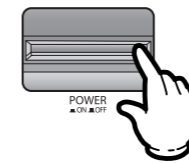

## Turning Off the Mood Light

- **In Power Standby mode, press the ON/OFF button.** Only the mood light can be turned on or off. The mood light will light up or turn off with the last color selected.
- **Press the POWER button.** The wireless rear amplifier and the mood light will turn off. If the POWER button is pressed again, the mood light will always light up blue.

# Connecting the FM and AM(MW/LW) Antennas

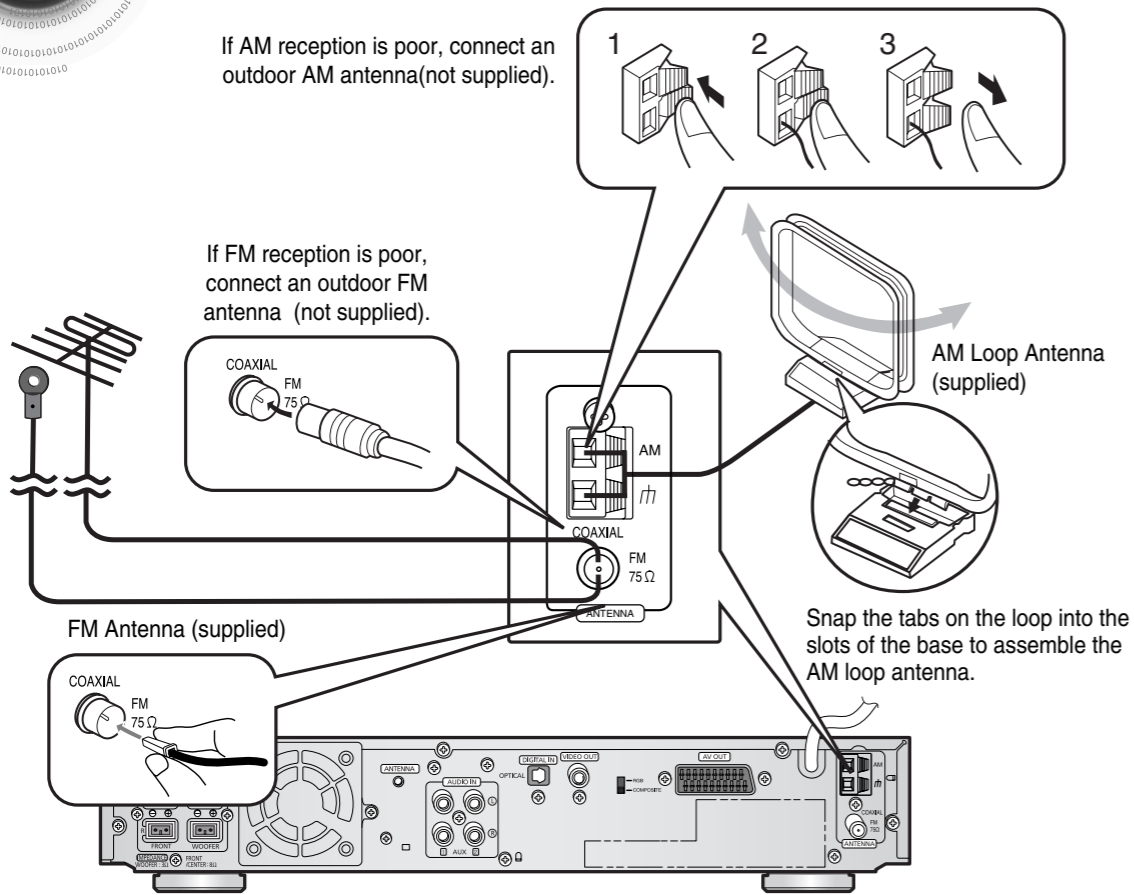

## FM antenna connection

1. Connect the FM antenna supplied to the FM 75Ω COAXIAL terminal as a temporary measure.
2. Slowly move the antenna wire around until you find a location where reception is good, then fasten it to a wall or other rigid surface.

- If reception is poor, connect an outdoor antenna. Before attaching a 75Ω coaxial cable (with a standard type connector), disconnect the supplied FM antenna.

## Cooling Fan

The cooling fan dissipates the heat generated inside the unit so that the unit can be operated normally. The cooling fan is activated automatically to supply cool air to the unit.

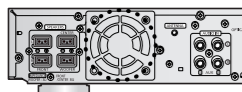

Please observe the following cautions for your safety.

- Make sure the unit is well-ventilated. If the unit has poor ventilation, the temperature inside the unit could rise and may damage it.
- Do not obstruct the cooling fan or ventilation holes. (If the cooling fan or ventilation holes are covered with a newspaper or cloth, heat may build up inside the unit and fire may result.)

# Connecting the Video to TV

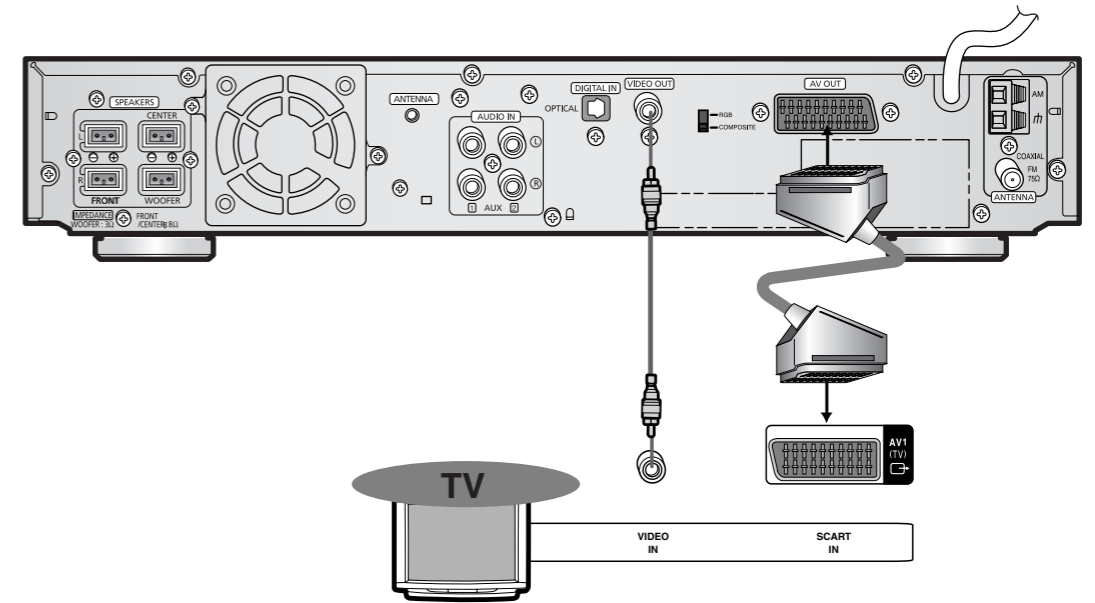

## Composite Video (Good Quality)

Connect the supplied video cable from the VIDEO OUT jack on the back panel of the system to the VIDEO IN jack on your television.

## Scart (Best Quality)

If your television is equipped with an SCART input, connect an Scart Jack (not supplied) from the AV OUT jack on the back panel of the system to the SCART IN jack on your television.

## For using the SCART cable

- If Scart is equipped for your TV, set RGB-COMPOSITE selector of the center unit to RGB. You can get a better picture quality by using Scart setting.
- If Scart (RGB Input) is not equipped for your TV, set RGB-COMPOSITE selector to COMPOSITE.

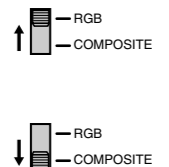

## Note

- On the rear panel SCART cable is indicated as "AV OUT."

# Connecting External Components

## Connecting an External Digital Component

Example: Digital signal components such as a DVD or CD Recorder.

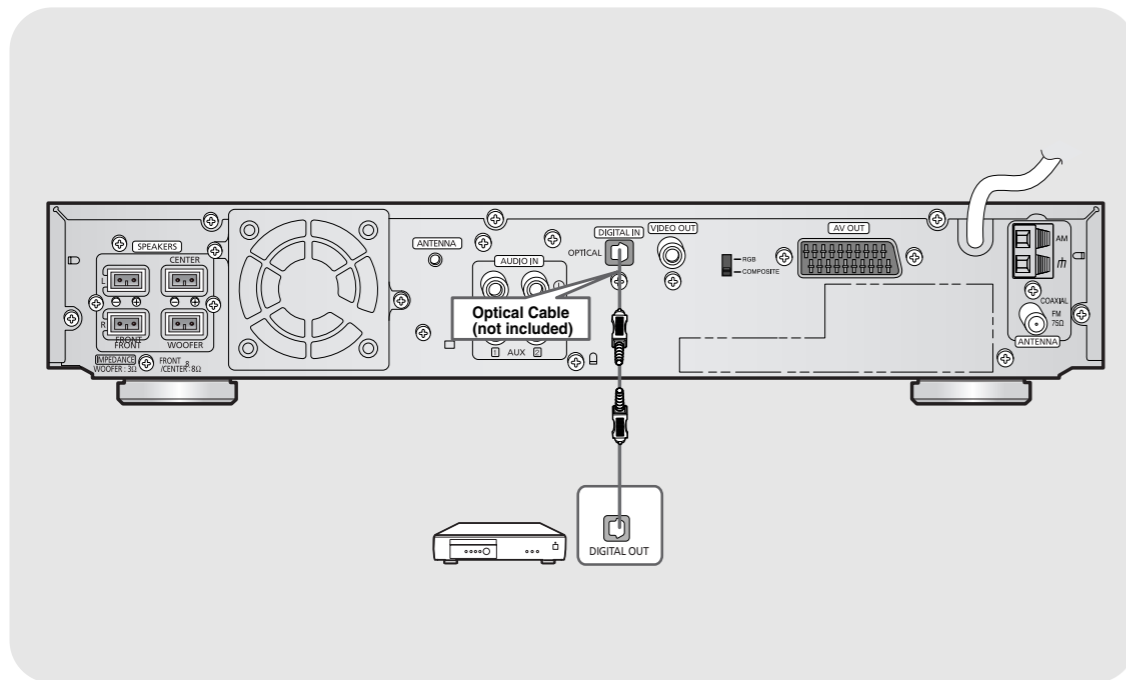

- 1 Connect the Digital Input (OPTICAL) to the Digital Output on the external digital component.
- 2 Press **AUX** on the remote control to select 'DIGITAL IN'.
  - Each time the button is pressed, the selection changes as follows: DIGITAL IN → AUX 1 → AUX 2.
  - You can also use the **FUNCTION** button on the main unit. The mode switches as follows: DVD/CD → DIGITAL IN → AUX1 → AUX2 → FM → MW → LW.

## Connecting an External Analog Component

Example: Analog signal components such as a VCR, Camcorder, and TV.

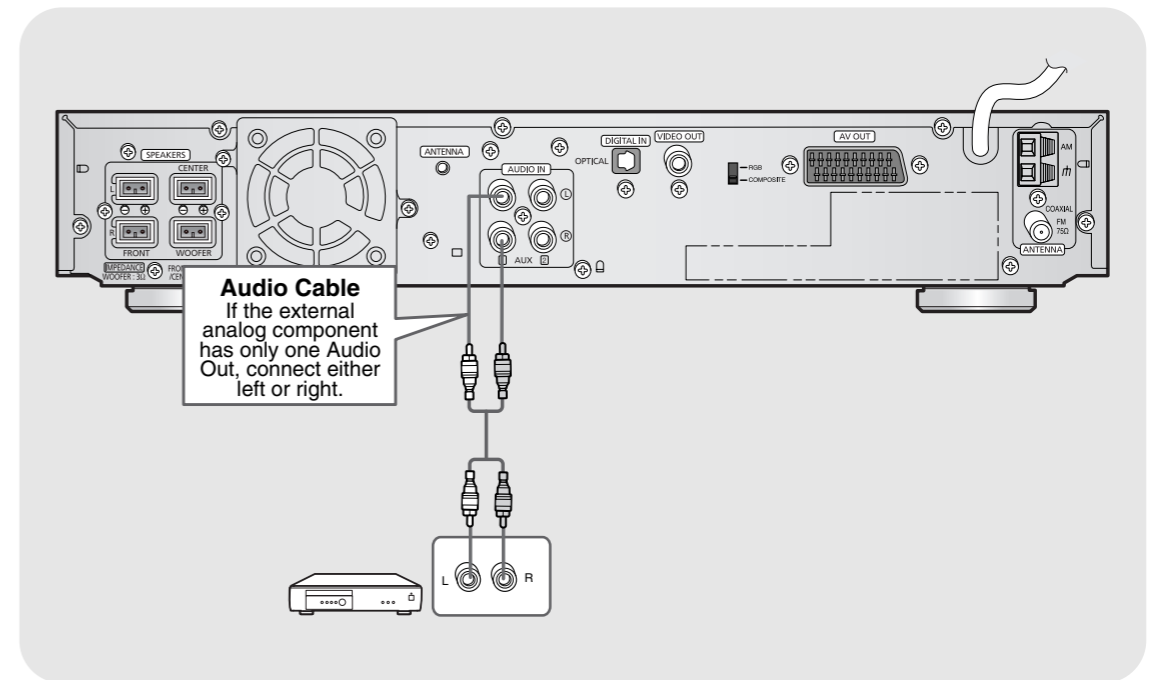

- 1 Connect Audio In on the DVD player to Audio Out on the external analog component.
  - Be sure to match connector colors.
- 2 Press **AUX** on the remote control to select AUX 1 or AUX 2.
  - Each time the button is pressed, the selection changes as follows: DIGITAL IN → AUX 1 → AUX 2.
  - You can also use the **FUNCTION** button on the main unit. The mode switches as follows: DVD/CD → DIGITAL IN → AUX1 → AUX2 → FM → MW → LW.

# Before Using Your DVD Player

Your DVD player is capable of playing DVD, VCD, CD, MP3 and JPEG discs. Depending on the disc you are using, these instructions may vary slightly. Read the instructions carefully before using.

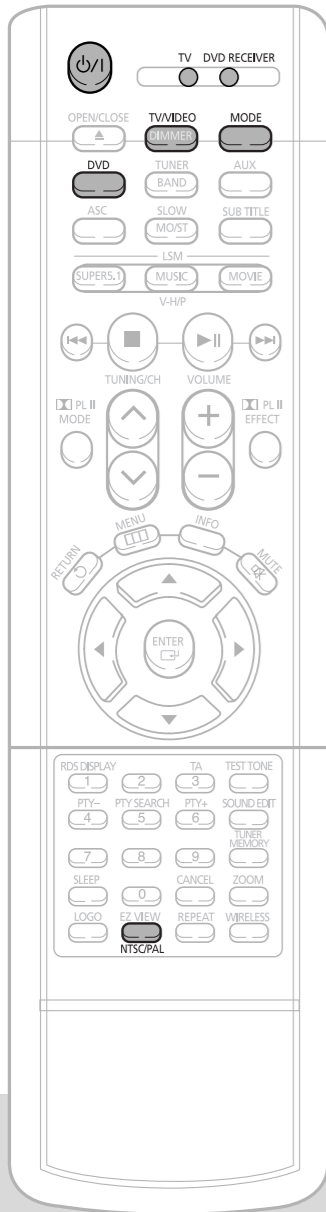

**1** Plug the power cord into the AC power supply.

**4** Press **TV/VIDEO** button to select VIDEO mode.



**2** Press the **MODE** button so that the TV indicator on the remote control flashes.

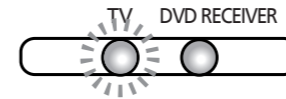

**5** Press the **MODE** button so that the DVD RECEIVER indicator on the remote control flashes.

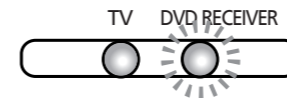

**3** Press the **POWER** button to turn on the TV.



**6** Press **DVD** button to select DVD/CD mode.

## Selecting the Video Format

Turn off the main unit and then press **NTSC/PAL**.

- By default, the video format is set to "PAL".
- Each time the button is pressed, the video format switches between "NTSC" and "PAL".
- Each country has a different video format standard.
- For normal playback, the video format of the disc must be the same as the video format of your TV.

## To Operate the TV and DVD Player with a Single Remote Control

Press **MODE** button.

- Each time the button is pressed, the TV indicator (red) and the DVD Receiver indicator (green) will flash alternately.
- You can operate the TV while the TV indicator is flashing and the DVD player while the DVD indicator is flashing.
- Buttons Enabled for TV Operation: POWER, CHANNEL, VOLUME, TV/VIDEO, and Numeric (0-9) buttons.
- By default, the remote control is set to work with Samsung TVs. See page 63 for more information on the operation of the remote control.

# Disc Playback

**1** Press **OPEN/CLOSE** button to open the disc tray.

**2** Load a disc.  
 • Place a disc gently into the tray with the disc's label facing up.

**3** Press **OPEN/CLOSE** button to close the disc tray.

DVD VCD CD

• Playback starts automatically.

MP3 JPEG

• Playback starts automatically.  
 • If the TV is on, a list of MP3s on the CD will appear on the TV screen.



- Note**
- Depending on the content of the disc, the initial screen may appear different.
  - Depending on the recording mode, some MP3-CDs cannot be played.
  - Table of contents of a MP3-CD varies depending on the MP3 track format recorded on the disc.

To stop playback, press **STOP** during playback.

- If pressed once, "PRESS PLAY" is displayed and the stop position will be stored in memory. If **PLAY/PAUSE** (▶||) button or **ENTER** button is pressed, playback resumes from the stop position. (This function works only with DVDs.)
- If pressed twice, "STOP" is displayed, and if **PLAY/PAUSE** (▶||) button is pressed, playback starts from the beginning.

To temporarily pause playback, press **PLAY/PAUSE** during playback.

- To resume playback, press **PLAY/PAUSE** button again.

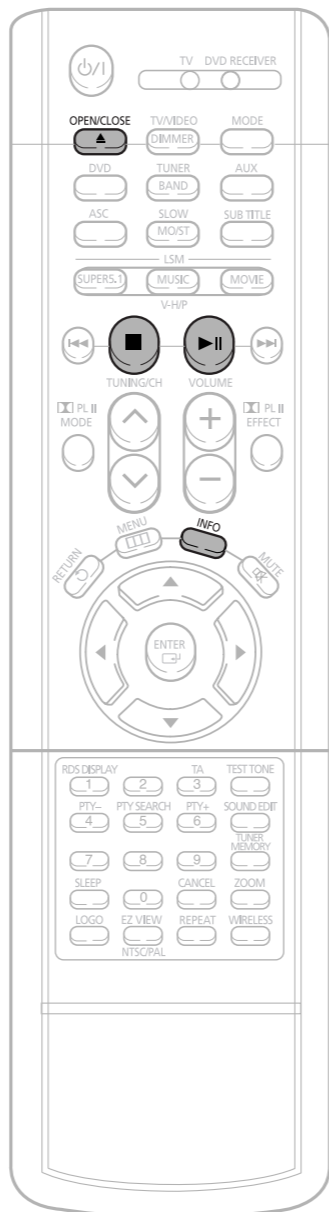

# Displaying Disc Information

You can view playback information on the disc on the TV screen.

Press **INFO** button.

- Each time the button is pressed, the display changes as follows:

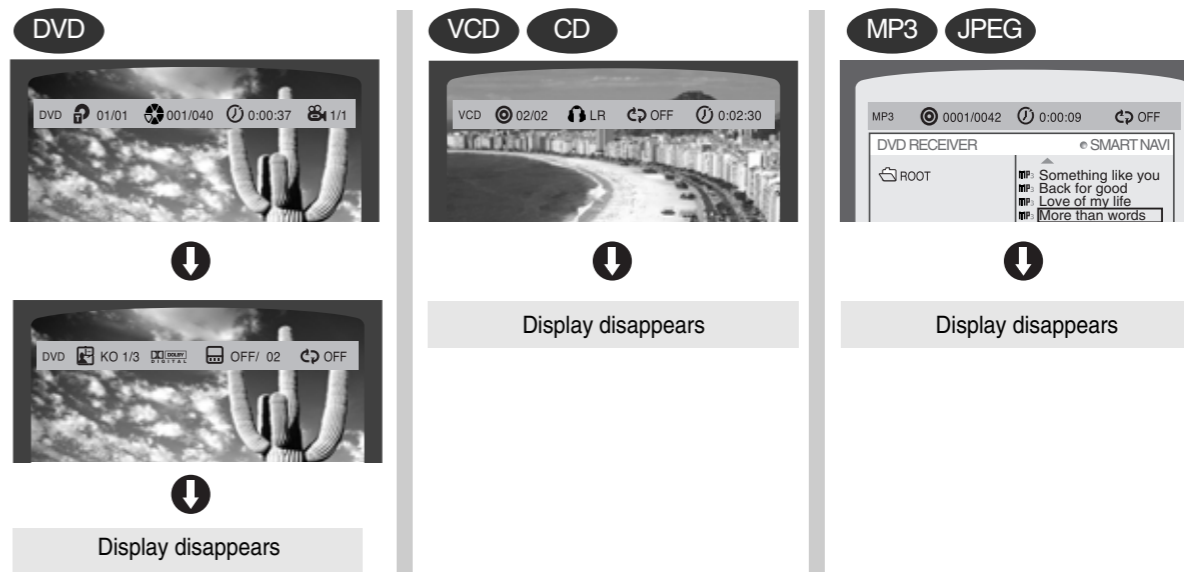

**Note**

- Depending on the disc, the disc information display may appear different.
- Depending on the disc, you can also select DTS, DOLBY DIGITAL, or PRO LOGIC.

- **What is a Title?**  
A movie contained in a DVD disc.
- **What is a Chapter?**  
Each title on a DVD disc is divided into several smaller sections called "chapters".
- **Hand icon appears on the TV screen!**  
If this symbol appears on the TV screen while buttons are being operated, that operation is not possible with the disc currently being played.
- **What is a Track (File)?**  
A section of video or a music file recorded on a VCD, CD, or MP3-CD.

**Screen Display**

DVD	DVD display	MP3	MP3 CD display	TRACK (FILE) display	AUDIO LANGUAGE display	DOLBY DIGITAL	DOLBY DIGITAL display
VCD	VCD display	TITLE display	ELAPSED TIME display	SUBTITLE display	ANGLE display		
CD	CD display	CHAPTER display	REPEAT PLAYBACK display	LR	STEREO (L/R) display		

# Fast/Slow Playback

## Fast Playback DVD VCD CD MP3

Press and hold **⏮⏭**.

- Each time the button is held down during playback, the playback speed changes as follows:

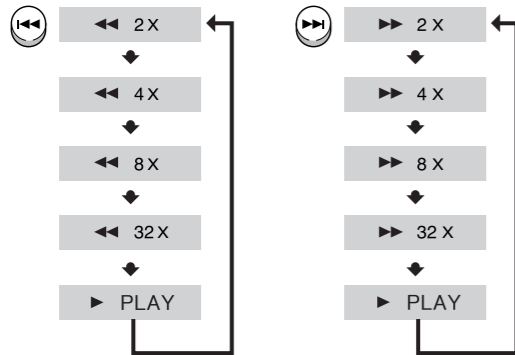

## Slow Playback

Press **SLOW** button.

- Each time the button is pressed during playback, the playback speed changes as follows:

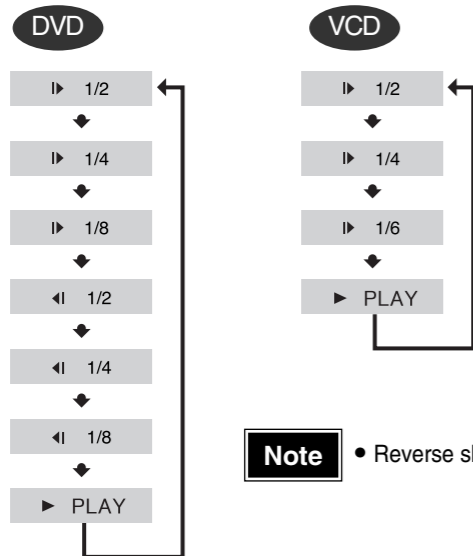

**Note** • Reverse slow playback does not work with VCDs.

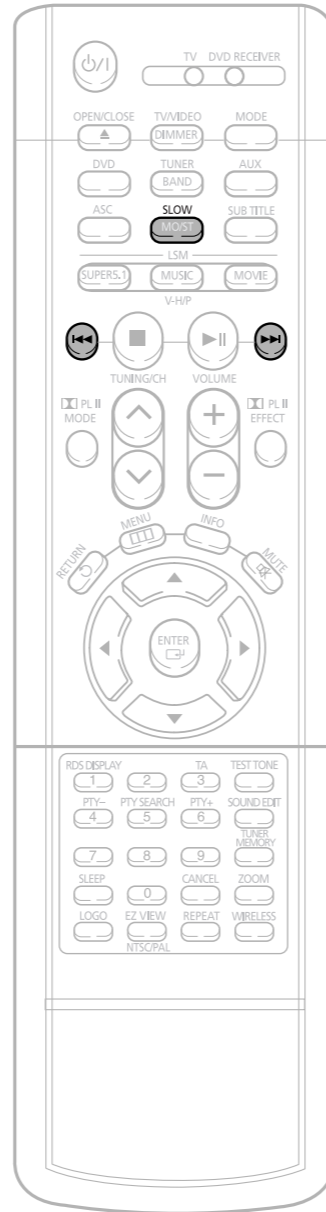

# Skipping Scenes/Songs

## DVD VCD MP3

Briefly press **⏮⏭**.

- Each time the button is pressed briefly during playback, the previous or next chapter, track, or directory (file) will be played.
- But, you cannot skip chapters consecutively.



- When watching a VCD with a track longer than 15 minutes, each time **⏮⏭** is pressed, playback will skip back or forward 5 minutes.

### Note

- During fast playback of a CD or MP3-CD, sound is heard only at 2x speed, and not at 4x, 8x, and 32x speeds.
- No sound is heard during slow playback and step motion playback.

# Repeat Playback

Repeat playback allows you to repeatedly play a chapter, title, track (song), or directory (MP3 file).

DVD VCD CD MP3 JPEG

Press **REPEAT** button.

- Each time the button is pressed during playback, the repeat playback mode changes as follows:

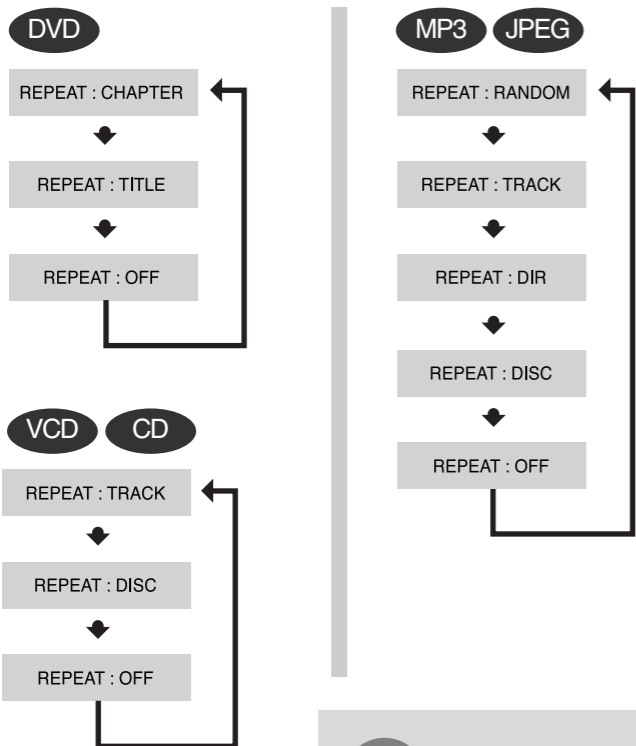

## Repeat Playback Options

- CHAPTER**  
Repeatedly plays the selected chapter.
- TITLE**  
Repeatedly plays the selected title.
- RANDOM**  
Plays tracks in random order. (A track that has already been played may be played again.)
- TRACK**  
Repeatedly plays the selected track.
- FOLDER**  
Repeatedly plays all tracks in the selected folder.
- DISC**  
Repeatedly plays the entire disc.
- OFF**  
Cancels Repeat Playback.

## To Select a Repeat Playback Mode in the Disc Information Screen

- 1 Press **INFO** button twice.
- 2 Press Cursor **▶** button to move to REPEAT PLAYBACK display.
- 3 Press Cursor **▼** button to select the desired Repeat Playback mode.
- 4 Press **ENTER** button.

\* For MP3 and JPEG discs, you cannot select Repeat Play from the information display screen.

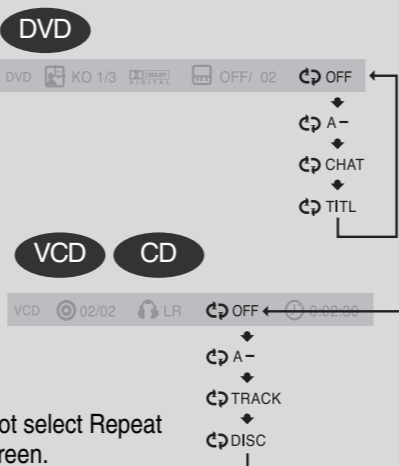

### Note

- Repeat playback operation is not possible with version 2.0 VCD discs if PBC is turned on. To use Repeat Playback on a VCD with PBC, you should set the PBC to OFF in the disc menu. (See page 31.)

# A-B Repeat Playback

DVD VCD CD

- 1 Press **INFO** button twice.

- For a VCD or CD, press **INFO** button once.



- 2 Press Cursor **▶** button to move to REPEAT PLAYBACK display.



- 3 Press Cursor **▲**, **▼** buttons to select 'A-' and then press **ENTER** button at the beginning of the segment.

- When **ENTER** button is pressed, the selected position will be stored in memory.

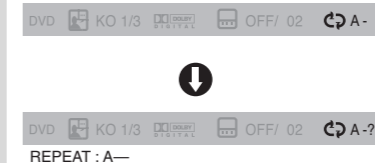

- 4 Press **ENTER** button at the end of the segment.

- The specified segment will be played repeatedly.



- To return to normal playback, press Cursor **▲**, **▼** buttons to select **OFF**.

### Note

- The A-B Repeat function will not work on an MP3 or JPEG disc.

