

User Manual

Model : SCS-26UC4

Federal Communication Commission Interference Statement

This equipment has been tested and found to comply with the limits for a Class B digital device, pursuant to Part 15 of the FCC Rules. These limits are designed to provide reasonable protection against harmful interference in a residential installation. This equipment generates, uses and can radiate radio frequency energy and, if not installed and used in accordance with the instructions, may cause harmful interference to radio communications. However, there is no guarantee that interference will not occur in a particular installation. If this equipment does cause harmful interference to radio or television reception, which can be determined by turning the equipment off and on, the user is encouraged to try to correct the interference by one of the following measures:

- Reorient or relocate the receiving antenna.
- Increase the separation between the equipment and receiver.
- Connect the equipment into an outlet on a circuit different from that to which the receiver is connected.
- Consult the dealer or an experienced radio/TV technician for help.

FCC Caution: To assure continued compliance, (example - use only shielded interface cables when connecting to computer or peripheral devices). Any changes or modifications not expressly approved by the party responsible for compliance could void the user's authority to operate this equipment. This device complies with Part 15 of the FCC Rules. Operation is subject to the following two conditions: (1) This device may not cause harmful interference, and (2) this device must accept any interference received, including interference that may cause undesired operation







FCC RF Radiation Exposure Statement:

This equipment complies with FCC RF radiation exposure limits set forth for an uncontrolled environment. This equipment should be installed and operated with a minimum distance of 20 centimeters between the radiator and your body. This transmitter must not be co-located or operating in conjunction with any other antenna or transmitter.

SAFETY CONCERNS

The purpose of the Safety Concerns section is to ensure the safety of users and prevent property damage. Please read this document carefully for proper use.

Conventions/Symbols

	Warning Provides information or instructions that the reader should follow in order to avoid personal injury or fatality.		Caution Indication of a general caution.
	Caution Provides information or instructions that the reader should follow in order to avoid a service failure or damage to the system.		Restriction Indication for prohibiting an action for a product.
	Note Indicates additional information as a reference.		Instruction Indication for commanding a specifically required action.

WARNING

Power



Insert power cord tightly and fully into the outlet.

Failure to do so may cause fire.

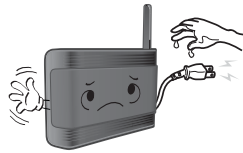

Do not touch the UbiCell or power plug with wet hands.

Failure to do so may cause electric shock.

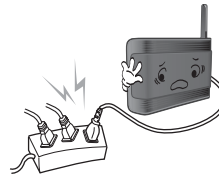

Do not connect many devices to a single outlet.

Failure to do so may cause electric shock.

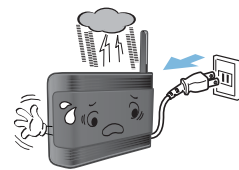

Pull out the power plug when the UbiCell is not used for a long time or bad weather condition.

Failure to do so may cause fire or electric shock.

Installation/Maintenance



Do not use or keep flammable spray or materials near the UbiCell.

Failure to do so may cause fire or explosion.



Do not install in humid or dusty area and near a heating devices (heater or light for cigarette). Install in the place well ventilated.

Failure to do so may cause fire or electric shock.



Do not put instruments that contain water such as vases, cups, cosmetics, and medicines, or small metals near the UbiCell.

Moisture in the UbiCell can cause a fire and electric shocks.

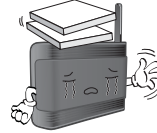

Do not put heavy materials on the UbiCell.

Failure to do so may cause the damage to the parts of the UbiCell or fire.



Turn off the power and unplug the power cable, and then contact the service center if unusual sound, smell, or smoke comes out.

Failure to do so may cause fire or electric shock.



CAUTION

Installation/Maintenance

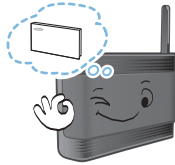

Accurately install and properly use the product according to the manual.

This is to prevent malfunctions and reductions in product lifetime.

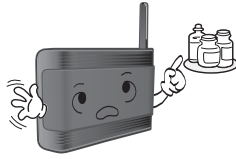

Do not spray water directly or do not use chemical solvents such as wax, benzene, alcohol, thinner, mosquito spray, aerosol, lubricant, and detergent.

Failure to do so may cause the damage to the product.

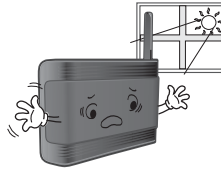

Do not install the UbiCell on an unstable surface or near the direct rays of sunlight.

It may cause severe damage to the parts of the UbiCell, and your UbiCell may not work properly.



Do not separate, repair or remodel the UbiCell arbitrarily.

If a repair is needed, please contact where the UbiCell was purchased or call the Service Center.



Do not place the product on unstable support and always be in an upright position.

This is to protect the product from falling and damage from the rise of inside temperature.

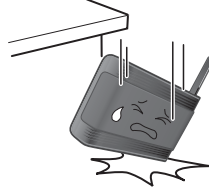

Do not give a shock to the UbiCell.

The UbiCell can be damaged.



Do not cover the UbiCell.

Doing so may cause product malfunction resulting from the rise of inside temperature.

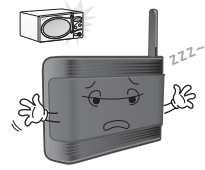

Do not install the UbiCell near the products which release electromagnetic waves such as microwaves, hair driers or vacuum cleaners.

If they are too close, GPS signal can not be normally received.

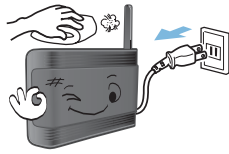

Clean the UbiCell with a soft and dry cloth when cleaning.

Failure to do so may cause the damage to the product.

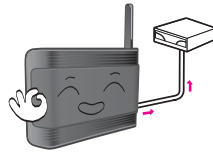

Check the maximum length of the cable and install it near the router.

Failure to do so may cause malfunction of this product.



The UbiCell must be placed more than 50 cm apart from the other LAN devices.

RF signal interference may have a bad effect on the other LAN devices.

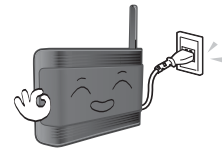

Please use a refined accessory and a charger provided or activated by Samsung Electronics.

The use of another accessory and a charger may cause the critical damage to the product.

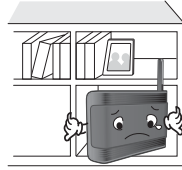

Install the product in an area with good ventilation. Install the UbiCell at a distance of more than 30 cm from the walls or other products.

Not doing so may cause product malfunction resulting from the rise of inside temperature.

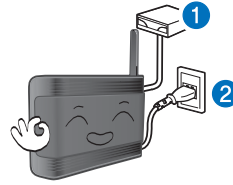

Ethernet cable connector (RJ-45) should be plugged before plugging a DC power cable.

Not doing so may cause product malfunction.

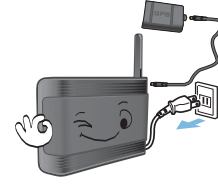

When detaching the GPS antenna from the UbiCell to receive superior GPS signal, connect extension cable to GPS antenna after pulling out the power plug.

Failure to do so may cause the damage to the product.

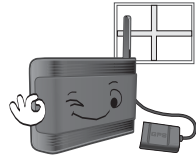

GPS antenna detached from the UbiCell always should be located indoors.

If not, GPS antenna can be damaged, or cannot normally receive GPS signal.



If the UbiCell does not work for a long time, check the state of LED and call customer service.

This is to prevent malfunctions and reductions in product lifetime.

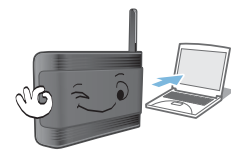

The UbiCell should be registered first.

Your UbiCell will not be able to function if the instruction is violated.

TABLE OF CONTENTS

SAFETY CONCERNS	1
Conventions/Symbols	<u>3</u>
Warning.....	<u>4</u>
Caution	<u>6</u>
PREPARATION	13
Congratulations!.....	<u>13</u>
About This Guide	<u>13</u>
What's in the box	<u>14</u>
Names and Functions of each part.....	<u>15</u>
LED.....	<u>15</u>
Connector.....	<u>16</u>
Registering your UbiCell	<u>19</u>
OVERVIEW	20

INSTALLING YOUR UBICELL	<u>21</u>	
TROUBLESHOOTING	<u>25</u>	
ANNEX A	<u>27</u>	
Product Specifications	<u>27</u>	

PREPARATION

Congratulations!

The UbiCell ensures that you and your family have reliable wireless telephone service while in your home or small business.

You only have to install the UbiCell in your home or small business, and register.
The UbiCell will be functioned normally through the UbiCell Manager (UCM).

About This Guide

This user guide provides instructions for the use of the UbiCell. Please take the time to make sure of this guide to become familiar with the operation of your UbiCell and the benefits this new UbiCell can provide. Keep this guide handy. You may need to look up instructions for infrequently used features.

What's in the box

After purchasing this product, check if the items below are all included in the package.
If any item is missing or damaged, contact your dealer:



UbiCell

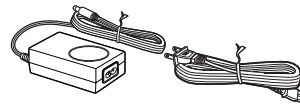

Power Supply and Cord



Ethernet Cable



User Guide

Names and Functions of each part

The UbiCell is very simple. On one end it has connectors for power and LAN.
On the other end the UbiCell has four LED indicators to let you know its status.

LED

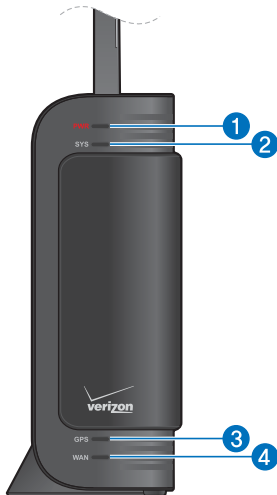

Name	Description
1 PWR	When powering on the UbiCell, it turns blue.
2 SYS	When the UbiCell normally works, It turns blue. When the alarm occurs, it turns red.
3 GPS	When GPS signal is normally received, it turns blue. When the internal GPS antenna is not able to detect a stable GPS signal and cannot validate accurate time and location information, it turns red.
4 WAN	When the Ethernet cable is normally connected, it turns blue. When there is data traffic, it turns blinking blue.

Connector



Name	Description
① Antenna	Provides omni-directional transmission and reception of signals between the UbiCell and communicating mobile station.
② PWR	Connects the power cable.
③ WAN	Connects the Ethernet cable.



NOTE

If the UbiCell is installed in places where GPS signals cannot be received, detach the GPS antenna from the UbiCell. Extension cable for GPS antenna is sold separately.



Power off

When detaching the GPS antenna from the UbiCell to receive superior GPS signal, connect extension cable to GPS antenna after pulling out the power plug.



The GPS antenna detached from the UbiCell

The GPS antenna detached from the UbiCell always should be located indoors.

The GPS antenna detached from the UbiCell must be laid in a horizontal position, as close to a window as possible. Laying it on a window is ideal. To be certain of keeping the antenna horizontal, you may wish to tape it down, but do not use duct tape. The window should not have metal blinds, nor metallic solar film.

The extension cable that is connected between the UbiCell and detached GPS antenna is 7 meters (about 23 feet) long, providing plenty of flexibility in locating both it and the UbiCell.

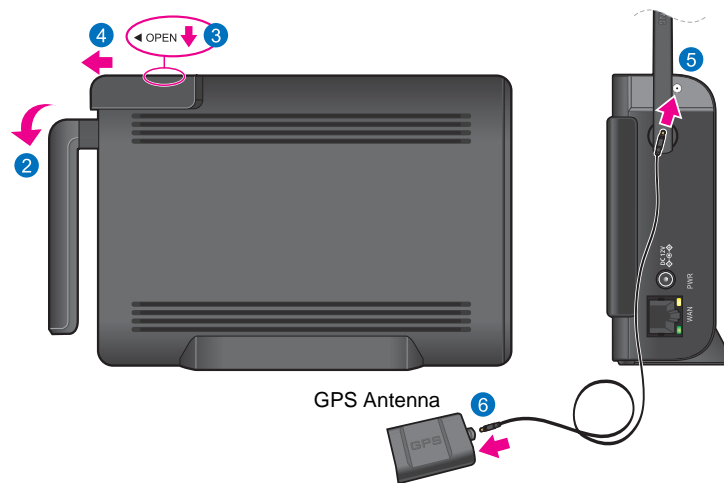

- 1) Turn off the base station.
- 2) Rotate the antenna down to provide access to the GPS antenna's protective cover.
- 3) Firmly press down on the Open button (top of station)
- 4) Slide the protective cover back to expose the internal GPS mini-coax connector.
- 5) Connect and secure the GPS antenna to the exposed port by using the GPS cable.
- 6) Connect and secure the terminal end of the same mini-coax cable to the port on the GPS antenna.

Registering your UbiCell

Before installing your UbiCell you need to register.



Registering

Your UbiCell will not be able to function if the instruction is violated.
Your UbiCell should be registered first.

OVERVIEW

The UbiCell is a system that performs the radio interface with Mobile Stations (MS), and exchanges radio subscriber data and signal data with the MSs under CDMA2000 standards.

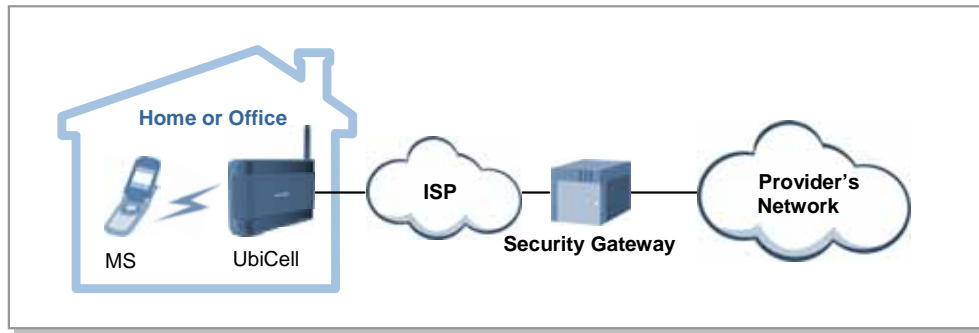

INSTALLING YOUR UBICELL

If possible, place the UbiCell in a high location such as on top of a book shelf or tall cabinet.
For best results place the UbiCell in a room with a window.

Make sure your DSL modem or cable modem and broadband router are on and working properly.

When your UbiCell is operating, you had better stay at a distance of more than 20 cm from the UbiCell.



Installation Environment

Refer to the 'Environment Standard' of 'ANNEX' for the conditions of the environment which make the UbiCell normally work.



Installing your UbiCell

- 1) Your UbiCell always should be in an upright position.
- 2) Install the UbiCell at a distance of more than 30 cm from the walls or other products.
- 3) The adjustable antenna rotates only 180 degrees.
Rotating it beyond that angle may damage the antenna.

Connecting Ethernet Cables and Power

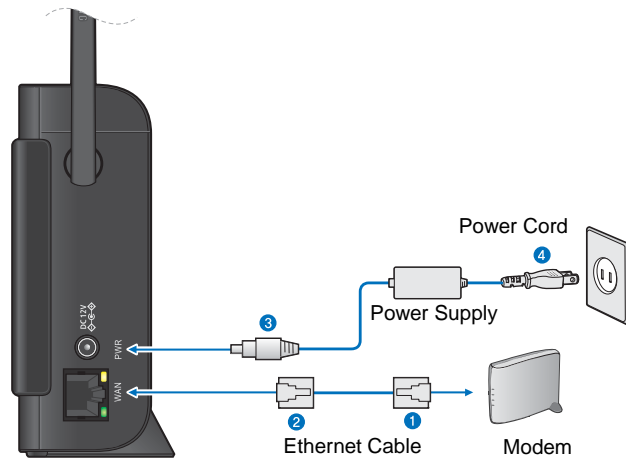

- 1) Connect one end of the included Ethernet cable to an open port on the modem.
- 2) Connect the other end to the WAN port located at the rear of the UbiCell.
- 3) Plug the power supply connector into the PWR connector located at the rear of the UbiCell.

- 4) Insert one end of the power cord into the power supply and then plug the other end into an available power outlet.



Ethernet Cable

- 1) Check the maximum length of the cable and install it near the router.
- 2) Ethernet cable connector (RJ-45) should be plugged before plugging a DC power cable.



Connecting the power

- 1) Please use a refined accessory and a charger provided or activated by Samsung Electronics.
- 2) Use only the power supply and cord that are included in the package. Using any other power source may damage the UbiCell.

Checking the LED



The 'PWR' LED on the front of the UbiCell should lit up blue when power is connected normally. Over the next few minutes the 'WAN' LED, the 'GPS' LED, and the 'SYS' LED should all lit up blue. (If after 10 minutes any of the LEDs is not lit up, or is lit up red, see the 'Troubleshooting' instructions on the next page.)

That's all there is to it. You can now make and receive calls with your existing handset using the UbiCell.

TROUBLESHOOTING

In the unlikely event that you have problems, check the following:

Trouble	Solution
The PWR LED is not lit	<ul style="list-style-type: none">- Make sure that one end of the power cord is securely connected to an active outlet and that the other end is properly connected to the power supply.- Make sure the power supply connector is securely inserted into the rear PWR connector on the back of the UbiCell.
The SYS LED lights up red	<p>The UbiCell was unable to register. A red System LED indicates a system error was detected. Contact Samsung Customer Service.</p>
The WAN LED lights up red	<ul style="list-style-type: none">- A red light indicates that the WAN port is receiving power but has not detected a valid Ethernet connection.- Confirm that both ends of the Ethernet cable are securely plugged into the WAN port on the UbiCell and into an open port on the router(or modem).

Trouble	Solution
<p>The GPS LED still does not light up blue 10 minutes after plugging-in the UbiCell</p>	<ul style="list-style-type: none"> - The internal GPS antenna is either unable to obtain or having difficulty obtaining a GPS signal. - Move the UbiCell a location with fewer surrounding obstructions. The new location should be in a more open area and closer to a window, if possible. - If relocation does not resolve the issue, detach the GPS antenna from the UbiCell to use it as an external GPS antenna. - Make sure the power is properly configured and securely connected to the rear of the UbiCell. - If the preceding fails, remove the power cord from the wall outlet, and then remove the power supply connector from PWR connector at the rear of the UbiCell for at least 10 seconds. - Reconnect the power supply connector to the PWR connector, plug the power cord into the wall outlet. This allows the UbiCell to initiate its startup sequence where it detects the Ethernet connection, GPS signal, and communication with the system.

If the above suggestions did not correct the problem, or you encounter a problem that is not listed here, you can get additional assistance by calling Samsung customer service.

ANNEX A

Product Specifications

The specifications of the UbiCell are as follows:

Capacity

The capacity of the UbiCell is described as follows:

Category	Specification
Maximum Number of Frequencies	1 FA
Sector	Omni
Maximum Number of Channels	4 CEs

Transmitter/Receiver Specification

The specification of the transmitter and receiver of the UbiCell is described as follows:

The items that are not included in the following table should meet the IS-95A/B, IS-2000 standard.

Item		Specification
Transmission	Tx Frequency	1,930~1,990 MHz or 869~894 MHz
	Channel Bandwidth	1.25 MHz
	Power	50 mW/carrier
	Modulation	QPSK
Reception	Rx Frequency	1,850~1,910 MHz or 824~849 MHz
	Channel Bandwidth	1.25 MHz
	Sensitivity	-119 dBm (1.9 G) or -117 dBm (800 M)

Unit Specification

The specification of the UbiCell is described as follows:

Category	Specification
Size (H x W x D, mm)	144.0 x 204.4 x 42.2
Weight (g)	955 (580+ 375[adapter & cables]) ± 40

Power

The specification of the UbiCell power is described as follows.

The UbiCell meets the power safety criterion defined in UL60950-1 and EN60950-1.

Category	Specification
Input Voltage	AC 110 V
Voltage Variation Range (Tolerable error of commercial electric power source)	100~250 VAC

A blank sheet of lined paper with a rounded rectangular writing area. The writing area is defined by a thin gray border and contains 20 horizontal dashed lines for writing. The lines are evenly spaced and extend across the width of the writing area. The corners of the writing area are rounded.