

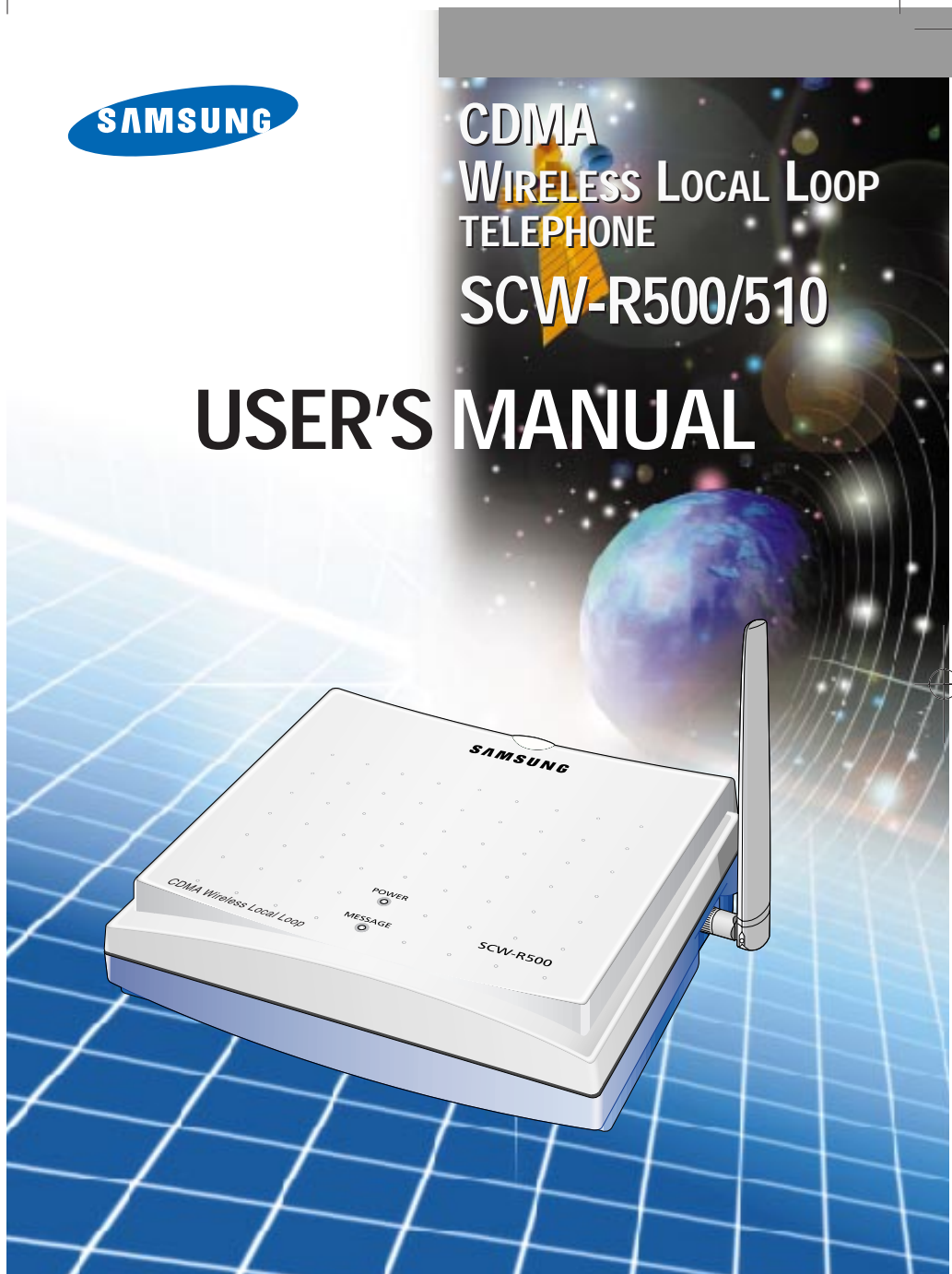

**CDMA
WIRELESS LOCAL LOOP
TELEPHONE
SCW-R500/510**

USER'S MANUAL

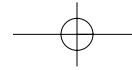



Description

The Fixed Wireless Terminal(FWT)s are next generation telecommunication terminals that provide the economic efficiency of wireless and integrated service of wireline.

Samsung SCW-R500 & SCW-R510 terminals connect traditional wired telephones to a wireless base station which delivers the call to the public telephone network, instead of direct wired connection the network.

Due to its wireless characters : the user can easily install the terminal and can relocate it anywhere within the serviced local area. It is especially very convenient to use in areas where the wired telephone installation is difficult.

The terminals will offer you with such clear digital voice quality and various network service features that you will not know the difference with a conventional telephone.

The terminal was designed to either be used on a desk or attached to the wall.

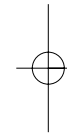
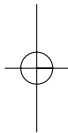

FEATURES

<p>1 Incoming Call Light</p> <p>2 Received Signal Strength Indicator</p>	<p>3 Adjusting Volume</p> <p>4 External Power Supply(optional)</p>
--	--

TABLE OF CONTENTS

Safety Precautions-----2

FCC NOTE-----3

Checking Parts-----4

Terminal Information -----5

Setting Up Your Terminal -----6

Basic Operation

Making Calls-----12

Receiving Calls -----12

Advanced Features

Adjusting Volume -----14

Terminal Reset -----14

Restricting use of the phone-----15

Setting Warning Beeps-----15

Changing the Lock Code-----16

Optional Features

Call Waiting -----18

Three-Way Calling -----18

Call Forwarding-----18

Caller ID -----18

Voice Mail Service -----18

Miscellaneous

Menu Options Table -----20

Troubleshooting -----22

Specifications-----23

SAFETY PRECAUTIONS

- 1** Avoid places where there are dust, gas or fire.
- 2** Do not shake, hit or impact the phone.
- 3** If you wish to cleanse the outside of the terminal, use only a soft, dry cloth. Such chemicals as alcohol, benzine or acetone can damage the surface of the terminal.
- 4** Do not twist or pull the cord out of the terminal.
- 5** Do not disassemble the FWT as you please.
- 6** DO NOT use the power adaptor if:
 - The power cord is damaged.
 - The terminal has been dropped or damaged in any way.
- 7** Use only the SAMSUNG provided adaptor. Do not use the SAMSUNG adaptor for any other usage.
- 8** Use only the SAMSUNG provided antenna. Do not use the antenna for any other usage.
- 9** Do not install the terminal near water, for example, near a bath tub, sink, wet basement, or swimming pool.
- 10** Do not allow children to play with any radio equipment containing a transmitter. Children could hurt themselves or others (by poking themselves or others in the eye with the antenna, for example). Children could also damage the FWT.

NOTE : The input voltage and the shape of the plug on this terminal may vary from country to country.

FCC NOTE

**This device complies with part 15 of the FCC rules.
Operation is subject to the following two conditions:**

- 1) The device may not cause harmful interference.**
- 2) This device must accept any interference received, including interference that may cause undesired operation. Privacy of communication may not be ensured when using this phone.**

CHECKING PARTS

Once you have unpacked your consumer package, check to make sure that you have all the parts shown below.
If any piece is missing or broken, please call your dealer.

- | | |
|--|--|
| 1 FWT Terminal | 4 Antenna |
| 2 AC Adaptor | 5 User's Manual, Quick Reference Card |
| 3 Wall Mountable Bracket
Wall Mounting Screws and Caps | 6 External Power Supply(Optional) |

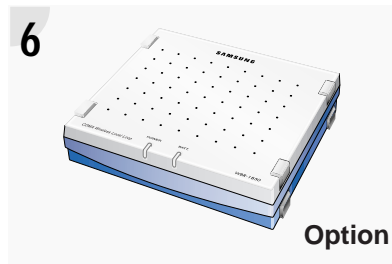
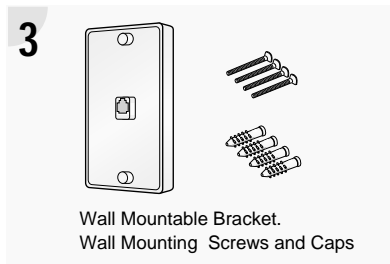
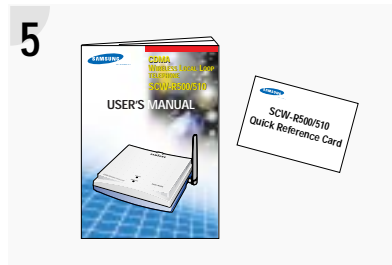
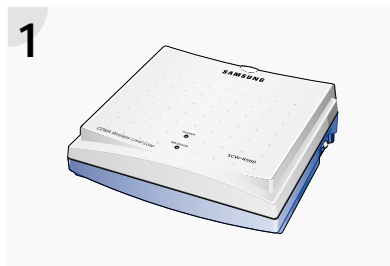

TERMINAL INFORMATION

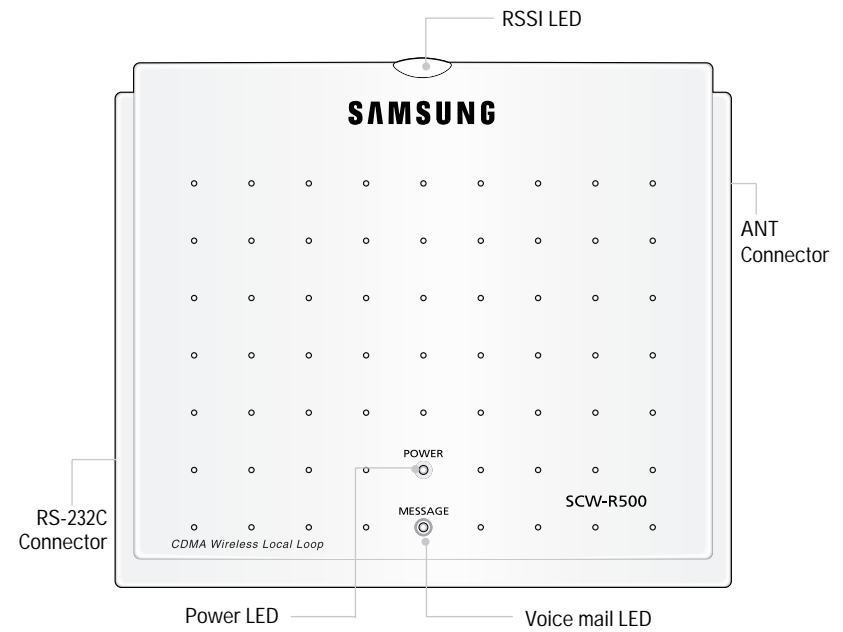
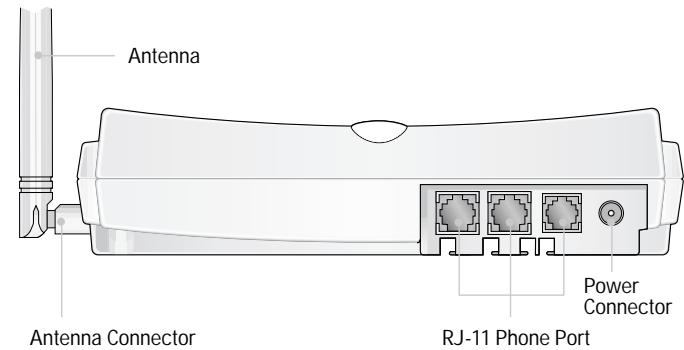

SETTING UP YOUR TERMINAL

This FWT SCW-R500/R510 operates by receiving electricity from an electrical outlet or external power supply.

- 1 Connect the terminal mounted Antenna on the side of the terminal.
- 2 Connect a conventional wired telephone to a RJ-11 phone port.
(SCW-R500: 3 RJ-11 phone ports / SCW-R510: 2 RJ-11 phone port)
Use the telephone compatible to FCC part 68 as possible, otherwise it may not work properly.
FWT works only tone dialing.
- 3 Plug the AC adaptor output into the rear DC 9V jack of the Terminal.
- 4 Plug the AC adaptor plug into an appropriate electrical outlet.
- 5 Connect a G3 analog facsimile machine to a dedicated RJ-11 port.
(only for SCW-R510)
✎ The usage of RS-232C connector on the base of the FWT is not user but dealer's maintenance.

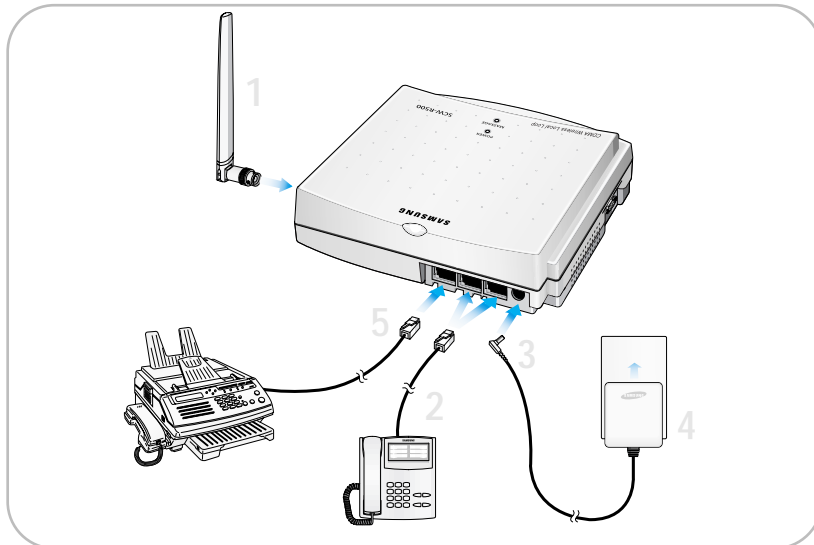

Setting up your terminal

How to install External Power Supply(option)

- 1 Connect the DC power cable to External power supply.
- 2 Connect the DC power cable to FWT.
- 3 Connect the AC power connector to External power supply.
- 4 Plug the AC power connector to wall outlet.
- 5 Connect a wired telephone to a RJ-11 phone port

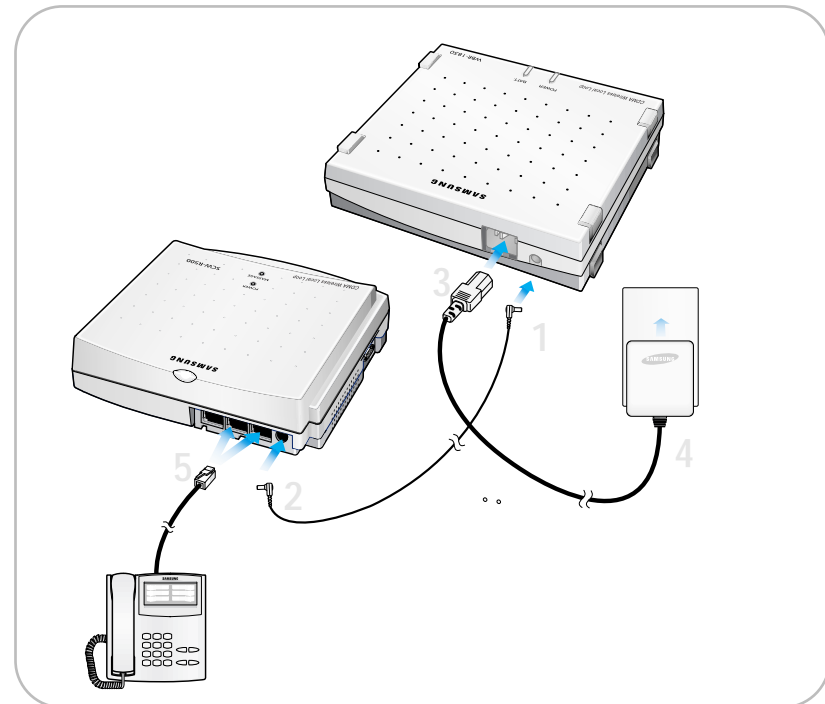

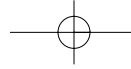

Setting up your terminal

Screws and Caps are provided for mounting the unit on a wall. Screws and Caps are recommended for most wall surface. For wooden wall installations, only the screws are required.

- 1 Mark four mounting hole locations on the wall.
- 2 Drill four holes at the marked location.
- 3 If not using Caps, drill four holes in the wood.
If using Caps, drill four holes at the marked location.
Insert the Caps into the holes and tap the Cap heads flush against the wall.
- 4 Remove wall mountable bracket cover from wall mountable bracket.
- 5 Attach the wall mountable bracket.
- 6 Tighten the screws firmly.
- 7 Put a cover to wall mountable bracket.
- 8 Plug in the RJ-11 Phone Port and Power Connector and route the cords in a groove.
- 9 Screw the antenna into antenna connector.
- 10 Install the FWT onto the wall mountable bracket hook.

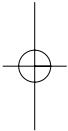

Setting up your terminal

FWT Wall Mount Installation

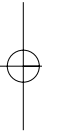
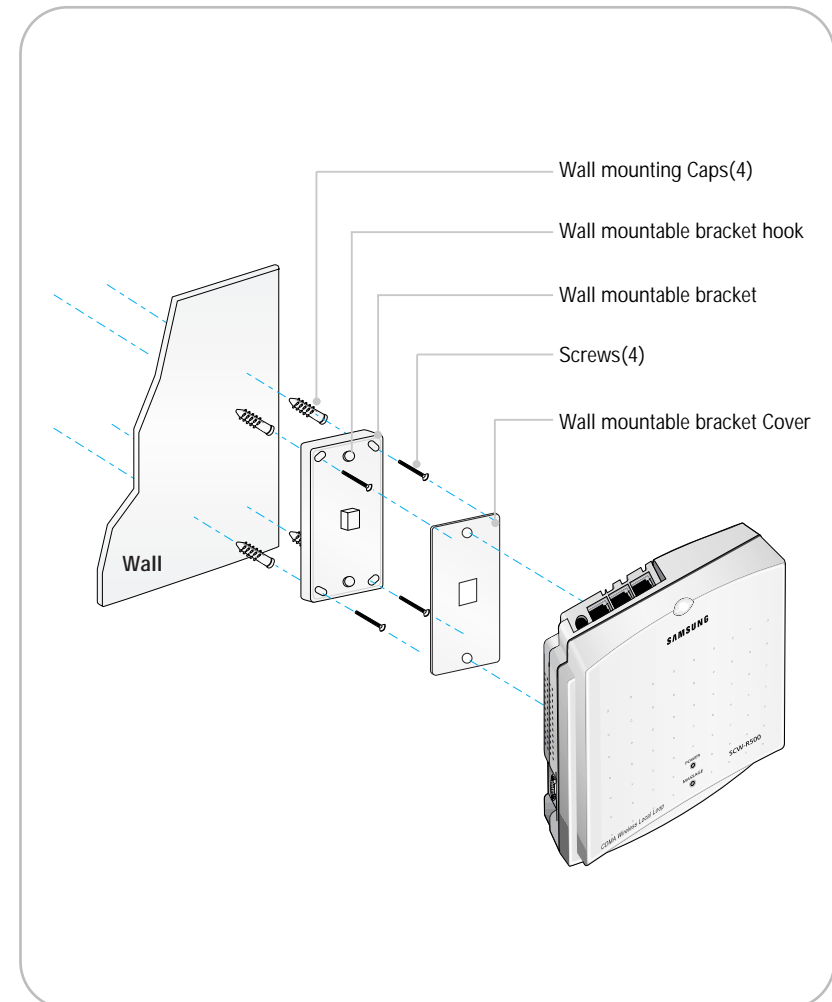

Setting up your terminal

LED indications are described in the following table:

LED	Color	Condition	Meaning
Power	-	Off	No Power is being supplied the terminal.
	RED	On	Normal operation.
RSSI	RED	On	No service condition. In this case, contact your dealer.
	ORANGE	On	Voice through the line is not clear but a call is available.
		Blinking	Incoming call
	GREEN	On	Best service condition.
Blinking		Incoming call	
Voice Mail	-	Off	Normal operation without any voice mail message.
	GREEN	On	You have voice mail message. Contact your service provider to activate Message Service.

Sound indications are described in following table:

Type	Condition	Meaning
Normal dial tone	20sec on; 300msec off	The FWT is in-service with adequate receive signal.
No Service tone	1.5sec on; 800 msec off	FWT is not capable of making or receiving calls.
Outgoing call restriction tone	800 msec on; 200 msec off	FWT is not capable of making calls but is capable of receiving calls.
Voice mail tone	three times (100msec on;100msec off)	You have voice mail message.

Basic Operation

Making Calls
Receiving Calls

MAKING CALLS

- 1 First, check to see that your FWT Phone is turned on.
If the Power LED is lit, that means the power is on.
- 2 Pick up the handset.
 - You hear a dial tone.
- 3 Using the number keypad, dial the desired telephone number.
✍ **When you finish inputting phone number, you have to press (#) button.**
If you don't press (#) button, A call is not connected.
- 4 When the other person answers, begin your conversation.
- 5 To end the call, replace the handset.

NOTE:

- You can dial by 32 digit including (#) .
- You can dial **emergency call** by pressing and holding (#) without inputting any digits.
You can't change the emergency call number.

RECEIVING CALLS

The terminal signals the telephone(s) to ring when an incoming call is detected. Pick up the telephone handset and begin talking into the microphone on the handset.

- To disconnect when you're through, replace the handset.

NOTE:

- Be sure the phone's ringer is enabled.
- If you heard incoming call in picking up the handset, you can receive the call by pressing any digit key.

Advanced Feature

Adjusting Volume

Terminal Reset

Restricting Use of the Phone

Setting Warning Beeps

Changing the Lock Code

9
WXYZ

um-

#

ADJUSTING VOLUME

You can control the sound volume on your phone.

- 1 Pick up the handset.
- 2 Press * and * .
- 3 Press 5_{JKL} .
- 4 * (up) or # (down).

NOTE: This feature is automatically set after 3 seconds.
You will hear confirmation beep.

TERMINAL RESET

Resets the terminal back to the initial service status of factory pre-programmed state. This feature can be disabled and enabled through simple keypad number code entry.

- 1 Pick up the handset.
- 2 Press * and * .
- 3 Press 4_{GHI} .
- 4 Press # .
- 5 Enter 4 digits Lock Code Number.
(The default lock code is preset to 0000 at the factory.)
NOTE : If the code is correct, it sounds confirmation beep.
If not, it returns to the stand by mode with error beep.
- 6 Press * .

RESTRICTING USE OF THE PHONE

Used when you wish to block outgoing calls from being made, but still wish to receive incoming calls at any time. This feature can be disabled and enabled through simple keypad number code entry.

- 1 Pick up the handset.
- 2 Press * and * .
- 3 Press 3_{DEF} .
- 4 Press # .
- 5 Enter 4 digits Lock Code Number.
(The default lock code is preset to 0000 at the factory.)
NOTE: If the code is correct, it sounds confirmation beep.
If not, it returns to the stand by mode with error beep.
- 6 * set outgoing call restrict.
release outgoing call restrict.

SETTING WARNING BEEPS

A discrete tone is generated after each minute interval into the call conversation to notify you that a minute has passed since the beginning of the call or after the previous time of discrete tone, regardless of when you make or receive a call.

- 1 Pick up the handset.
- 2 Press * and * .
- 3 Press 1 .
- 4 * set 1-Minute Alert.
cancel 1-Minute Alert.

CHANGING THE LOCK CODE

Used when you wish to change the lock code of the terminal. The programmed lock code prevents the terminal from being operational to any other people without your permission. This feature can be disabled and enabled through simple keypad number code entry. When you first buy the phone, the lock number is 0000.

- 1 Pick up the handset.
- 2 Press * and * .
- 3 Press 2 .
- 4 Press # .
- 5 Enter 4 digits Lock Code Number.
(The default lock code is preset to 0000 at the factory.)
NOTE: If the code is correct, it sounds confirmation beep.
If the code is incorrect, it returns to the standby mode with error beep.
- 6 Enter 4 digits new Lock Code Number.
It sounds confirmation beep.
- 7 Enter 4 digits new Lock Code Number again.
If it is different from the new Lock code you entered in the beginning, it returns to the standby mode with error beep.
- 8 Press * to store new Lock Code.
If you press another key, it returns to the standby mode with error beep.
NOTE: If it is correct, it sounds confirmation beep.

Optional Features

- Call Waiting
- Three-Way Calling
- Call Forwarding
- Caller ID
- Voice Mail Service

OPTIONAL FEATURES

Call Waiting

Call Waiting is a feature which enables you to be alerted to a second incoming call while you are on the first call of your telephone. You have the option of responding to the second call while putting the first call on hold or you can disable the Call Waiting option during a particular call. Contact your service provider to activate or deactivate Call Waiting.

Three-Way Calling

Three-Way Calling is a feature that enables you to set up a three-way conversation with two other different-numbered users. Contact your service provider to activate or deactivate Three-Way Calling.

Call Forwarding

Call Forwarding is a feature that enables you to forward all your incoming calls to another phone number, even if your telephone is turned off. You can still make calls from your telephone even when Call Forwarding is activated. Contact your service provider to activate or deactivate Call Forwarding.

Caller ID

Caller ID is a feature which notifies you who is calling by displaying the caller's number on the telephone's LCD when an incoming call come through with a ring. This feature is available only with a telephone that has an LCD display on it. Contact your service provider to activate or deactivate Caller ID.

Voice Mail Service

Voice Mail Service is a feature that allows the terminal to receive voice mail and forward it to your telephone when you press a certain sequence of keypad number. Contact your service provider to activate or deactivate Voice Mail Service.

Miscellaneous

Menu Options Table

Troubleshooting

Specifications

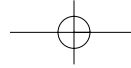

MENU OPTIONS TABLE

	I	II	III	IV	V	VI	VII	Explanation
1. Setting warning beeps	* , *	1	* Set # release					Decides whether alert beep should sound at one minute intervals when you make or receive a call.
2. Changing the lock code	* , *	2 ABC	#	Lock code 4 digits input	New lock code 4 digits input	New lock code 4 digits input	*	Used when you change the lock code of the phone.
3. Restricting outgoing call	* , *	3 DEF	#	Lock code 4 digits input	* Set # release			Used when you limit use of the outgoing calls.
4. Terminal Reset	* , *	4 GHI	#	Lock code 4 digits input	*			Return phone to factory settings.
5. Adjusting Volume	* , *	5 JKL	* up # down	Wait 3 seconds				Adjusts the Volume of phone.

* The lock code is preset to 0000 at the factory.

TROUBLESHOOTING

- **Troubleshoot the conventional wired telephone**

In the event you are unable to place or receive telephone calls, first be sure that the connection wire is properly connected to the RJ-11 phone port on the terminal and to the RJ-11 port of the telephone. If unsure whether or not the telephone is operational, connect a telephone which is known to be operational to the terminal.

If service is available with the operational telephone, replace or repair your telephone equipment. If service is still not available, then follow instructions under "Troubleshoot the Fixed Wireless Terminal".

- **Troubleshoot the Fixed Wireless Terminal**

Check for the appropriate power indication on the LED. If no power, check the Adaptor(or External Power Supply)connection between the electrical outlet and the terminal. Check for the appropriate Received Signal Strength Indication(RSSI), Power, and Message Indication through the designated LED, respectively.

SPECIFICATIONS

Frequency Range	Tx : 825-849 MHz Rx : 870-894 MHz
Channel Bandwidth	CDMA 1.25 MHz
Multi Connection	Supports 5 REN
RJ-11 Phone Port	SCW-R500 : 3 SCW-R510 : 2
RJ-11 Analog Fax Port	SCW-R510 : 1
Power Supply	DC 9V 1.2A
Temperature of operation	-20°C ~ +50°C
Relative humidity	5% ~ +95%
Temperature of storage	-25°C ~ +75°C
Dimension	200x170x48.5 (mm) 7.9x6.7x1.9 (in.)
Weight (without external adaptor)	495g / 1.1 lb.