

* Some of the contents in this manual may differ from your phone, depending on the software installed or your service provider.



**TRI BAND
GPRS TELEPHONE
SGH-S200**



Printed in Korea

Code No.: GH68-xxxxxA

World Wide Web

<http://www.samsungmobile.com>

English. 10/2002. Rev. 1.0

Contents

Important Safety Precautions	7
Unpacking	9
Your Phone	10
Phone Layout.....	10
Display	13
Service Light	16
Getting Started	17
Installing the SIM Card	17
Charging the Battery	19
Switching the Phone On or Off	23
Call Functions	24
Making a Call.....	24
Adjusting the Volume	26
Answering a Call	27
Viewing Missed Calls.....	28
Switching Quickly to Silent Mode	30
Selecting Functions and Options	31
Example: Setting the Display Language.....	33
Phonebook	35
Storing a Number with a Name	35
Using Phonebook Entry Options.....	37
Searching for and Dialling a Number in the Phonebook	39
Editing a Caller Group	41
Speed-Dialling	42
Checking Memory Status.....	43

Entering Text 44

Changing the Text Input Mode	45
Using the T9 Mode	46
Using the Upper/Lower-Case Character Mode....	47
Using the Symbol Mode.....	49
Using the Number Mode.....	49

Options During a Call 50

Putting a Call on Hold	50
Switching the Microphone Off (Mute)	51
Muting/Sending Key Tones	52
Searching for a Number in the Phonebook	52
Using the SMS Service	53
Answering a Second Call	53
Making a Multiparty Call	54

Using the Menus..... 56

Accessing Menu Functions by Scrolling	56
Accessing Menu Functions by Using Shortcuts ...	57
List of Menu Functions	57

Messages 62

Read Messages (<i>Menu 1.1</i>)	62
Write Messages (<i>Menu 1.2</i>)	64
Templates (<i>Menu 1.3</i>)	66
Setup (<i>Menu 1.4</i>).....	66
Broadcast (<i>Menu 1.5</i>).....	68
Voice Mail (<i>Menu 1.6</i>).....	69
My Contents (<i>Menu 1.7</i>).....	70
Memory Status (<i>Menu 1.8</i>).....	70

Call Records 71

Missed Calls (<i>Menu 2.1</i>).....	71
Received Calls (<i>Menu 2.2</i>).....	71
Dialled Calls (<i>Menu 2.3</i>).....	72
Call Time (<i>Menu 2.4</i>).....	72
Call Cost (<i>Menu 2.5</i>)	73

Sound Settings..... 74

Ring Tone (<i>Menu 3.1</i>).....	74
Ring Volume (<i>Menu 3.2</i>)	74
Alert Type (<i>Menu 3.3</i>)	75
Keypad Tone (<i>Menu 3.4</i>).....	75
Message Tone (<i>Menu 3.5</i>).....	76
Extra Tones (<i>Menu 3.6</i>)	77

Phone Settings..... 78

Infrared Activate (<i>Menu 4.1</i>)	78
My Settings (<i>Menu 4.2</i>)	79
Greeting Message (<i>Menu 4.3</i>)	80
Own Number (<i>Menu 4.4</i>).....	80
Language (<i>Menu 4.5</i>)	81
Security (<i>Menu 4.6</i>).....	81
Display Settings (<i>Menu 4.7</i>).....	84
Extra Settings (<i>Menu 4.8</i>)	86
Short Cut (<i>Menu 4.9</i>)	87
Reset Settings (<i>Menu 4.10</i>)	87

Organiser 88

Calendar (<i>Menu 5.1</i>).....	88
To Do List (<i>Menu 5.2</i>).....	90
Time & Date (<i>Menu 5.3</i>)	93
Alarm (<i>Menu 5.4</i>)	94
Calculator (<i>Menu 5.5</i>).....	95
Currency Exchange (<i>Menu 5.6</i>)	96

Network Services 97

Call Diverting (<i>Menu 6.1</i>)	97
Call Barring (<i>Menu 6.2</i>)	99
Call Waiting (<i>Menu 6.3</i>)	101
Network Selection (<i>Menu 6.4</i>).....	102
Caller ID (<i>Menu 6.5</i>)	103
Closed User Group (CUG) (<i>Menu 6.6</i>)	103
Band Selection (<i>Menu 6.7</i>)	105

Funbox	106
Games (<i>Menu 7.1</i>)	106
WAP Browser (<i>Menu 7.2</i>)	106
Downloads (<i>Menu 7.3</i>)	106
Solving Problems	109
Access Codes	112
Phone Password	112
PIN	113
PUK	113
PIN2	114
PUK2	114
Barring Password	115
Health and Safety Information	116
Exposure to Radio-Frequency Energy (SAR Information)	116
Precautions When Using Batteries	118
Road Safety	120
Operating Environment	122
Potentially Explosive Atmospheres	124
Emergency Calls	125
Other Important Safety Information	126
Care and Maintenance	127
Glossary	129
Index	134

FCC RF EXPOSURE INFORMATION

WARNING! *Read this information before using your phone*



In August 1996 the Federal Communications Commission (FCC) of the United States with its action in Report and Order FCC 96-326 adopted an updated safety standard for human exposure to radio frequency electromagnetic energy emitted by FCC regulated transmitters. Those guidelines are consistent with the safety standard previously set by both U.S. and international standards bodies. The design of this phone complies with the FCC guidelines and these international standards.



Use only the supplied or an approved antenna. Unauthorized antennas, modifications, or attachments could impair call quality, damage the phone, or result in violation of FCC regulations.

Do not use the phone with a damaged antenna. If a damaged antenna comes into contact with the skin, a minor burn may result. Please contact your local dealer for replacement antenna.

Body-worn Operation

This device was tested for typical body-worn operations with the back of the phone kept 1.5 cm. from the body. To maintain compliance with FCC RF exposure requirements, use only belt-clips, holsters or similar accessories that maintain a 1.5 cm. separation distance between the user's body and the back of the phone, including the antenna, whether extended or retracted. The use of belt-clips, holsters and similar accessories should not contain metallic components in its assembly. The use of accessories that do not satisfy these requirements may not comply with FCC RF exposure requirements, and should be avoided.

Important Safety Precautions

Read these guidelines before using your wireless phone. Failure to comply with them may be dangerous or illegal. For more detailed safety information, see "Health and Safety Information" on page 116.

Road Safety at All Times

Do not use a hand-held phone while driving; park the vehicle first.

Switching Off When Refuelling

Do not use the phone at a refuelling point (service station) or near fuels or chemicals.

Switching Off in Aircraft

Wireless phones can cause interference. Using them in aircraft is both illegal and dangerous.

Switching Off in Hospitals

Switch off your phone near medical equipment. Follow any regulations or rules in force.

Interference

All wireless phones may be subject to interference, which could affect their performance.

Special Regulations

Meet any special regulations in force in any area and always switch off your phone whenever it is forbidden to use it, or when it may cause interference or danger (in a hospital for example).

Radio Frequency Exposure

The design of this phone complies with European Union (EU) requirements relating to radio frequency (RF) exposure. To maintain compliance with these requirements, use only Samsung-supplied or approved accessories. Use of non-approved accessories may violate the requirements.

Sensible Use

Use only in the normal position (held to the ear). Avoid unnecessary contact with the antenna when the phone is switched on.

Accessories and Batteries

Use only Samsung-approved accessories and batteries.

Qualified Service

Only qualified service personnel may install or repair your phone.

Unpacking

Your package contains the following items:



Handset

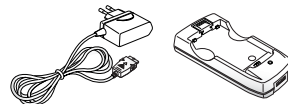

Travel Adapter/
Battery Charger



Battery



Ear-Microphone

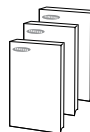

User's Manual



Hand Strap

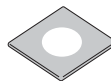

Software CD-ROM

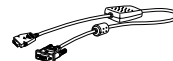

Data Cable

In addition, you can obtain the following accessories for your phone from your local Samsung dealer:

- Desktop charger
- Ear-microphone
- Simple hands-free kit
- Car holder

Your Phone

Phone Layout

The following illustrations show the main elements of your phone.

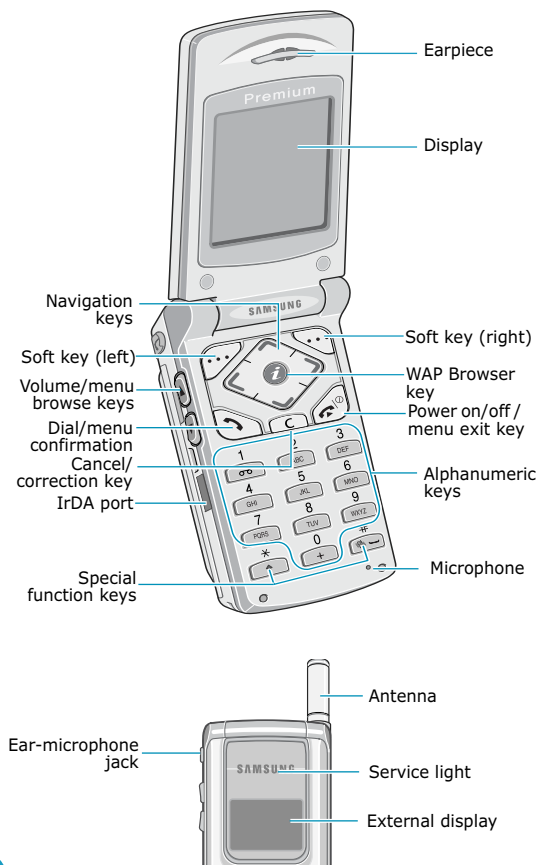

Key Description



In menu mode, scroll through the menu options and Phonebook memory.

In idle mode, allow you to access your favourite menu options directly; for more information on shortcuts, see page 87.



In menu mode, return to the previous menu level and select the current menu respectively.

When entering text, move the cursor left and right respectively.

In idle mode, allow you to access your favourite menu options directly; for more information on shortcuts, see page 87.



(soft keys)

Perform the functions indicated by the text above them, on the bottom line of the display.



In idle mode, launches the WAP (Wireless Application Protocol) Browser directly.



Deletes characters from the display.

In menu mode, returns to the previous menu level.

Key

Description (continued)



Makes or answers a call.

When held down in idle mode, recalls the last number dialled or received.

In menu mode, selects a menu function or stores information that you have entered, such as a name, in the phone or SIM memory.



Ends a call. Also switches the phone on and off when held down.

In menu mode, cancels your input and returns to the idle mode.



When held down in idle mode, accesses your voice mail.



Enter numbers, letters and some special characters.



Enter special characters.

Perform various functions.



(on the side of the phone)
During a call, adjust the earpiece volume.

In idle mode, adjust the key volume.

In menu mode, scroll through the menu options and Phonebook memory.

Display

Display Layout

The display comprises three areas.

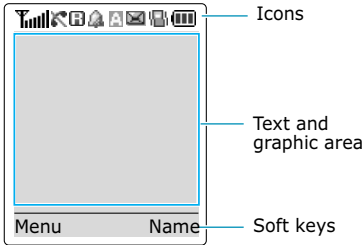

Area	Description
First line	Displays various icons (see page 14).
Middle lines	Display messages, instructions and any information that you enter (number to be dialled, for example).
Last line	Shows the functions currently assigned to the two soft keys.

Icons

Icon Description



Shows the received signal strength. The greater the number of bars, the stronger the signal.



Appears when a call is in progress.



Appears when you are connected to the GPRS network.



Appears when you are out of your home area and have registered with a different network; for example, when travelling in other countries.



Appears when you set an alarm to ring at a specified time.



Appears when you are entering text to indicate the current text input mode.



Appears when a new text message has been received.



Appears when a new voice mail message has been received.



Appears when silent mode is active or you set the **Alert Type** menu option (**Menu 3.3**) so that the phone vibrates when you receive a call; for further details, see page 75.



Appears when the IrDA port is active. For details, see page 78.

Icon Description



Appears when mute mode is active.



Shows the level of your battery. The more bars you see, the more power you have left.

Backlight

A backlight illuminates the display and keypad. When you press any key or open the folder, the backlight lights on. It turns off if no key is pressed within a given period of time, depending on the **Back Light** menu option (**Menu 4.7.2**).

To specify the length of time for which the backlight is active, set the **Back Light** menu option (**Menu 4.7.2**); see page 84 for further details.

You can also set the phone to use the backlight only during a specified period of time, in the **Auto Light** menu option (**Menu 4.7.3**); see page 85 for further details.

External Display

Your phone has an external display on the folder. It indicates when you have an incoming call or a message. It also alerts you when you have set an alarm at the specified time by showing its backlight and corresponding icon on it.

When the folder is closed, the display is off so that you can use it as a mirror. If you want to turn the display on, press and hold the **▲** or **▼** key on the left side of the phone.

When a call comes in or you open the folder, the display automatically turns on.

Service Light

The service light is above the external display of the phone. It flashes when services are available on the phone.

To activate or deactivate use of the service light, set the **Service Light** menu option (**Menu 4.7.4**); see page 85 for further details.

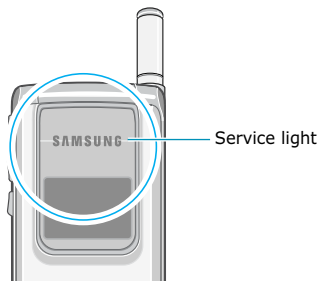

Getting Started

Installing the SIM Card

When you subscribe to a cellular network, you are provided with a plug-in SIM card loaded with your subscription details, such as your PIN, any optional services available and so on.

Important! The plug-in SIM card and its contacts can be easily damaged by scratches or bending, so be careful when handling, inserting or removing the card.

Keep all SIM cards out of the reach of small children.

1. If necessary, switch off the phone by holding down the  key until the power-off image displays.
2. Remove the battery. To do so:
 - ① Pull the battery lock above the battery toward the top of the phone and hold it in that position.
 - ② Lift the battery away, as shown.

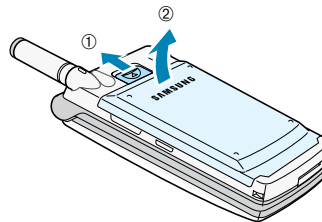

- Slide the SIM card into the SIM card socket so that it locks the card in position.

Make sure that the cut corner is bottom right and the gold contacts of the card face into the phone.

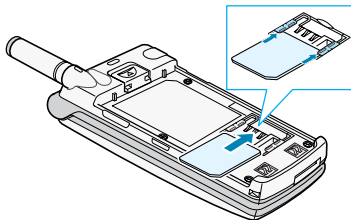

Note: When you need to remove the SIM card, slide it, as shown, and take it out of the socket.

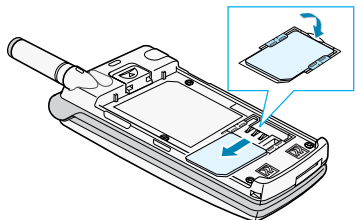

- Place the battery so that the tabs on the end align with the slot at the bottom of the phone.

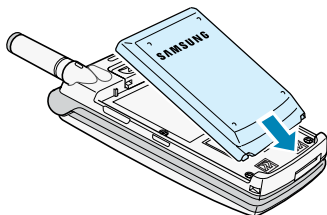

- Push the battery down until it clicks into place.

Make sure that the battery is properly installed before switching the phone on.

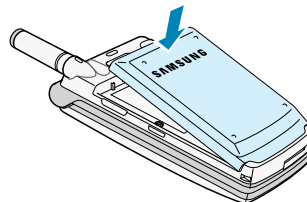

Charging the Battery

Your phone is powered by a rechargeable Li-ion battery. A travel adapter and a battery charger come with your phone. Use only approved batteries and chargers. Ask your local Samsung dealer for further details.

Note: You must fully charge the battery before using your phone for the first time. A discharged battery is fully recharged in approximately 200 minutes.

Using the Travel Adapter

The travel adapter allows you to use the phone while the battery is charging, but this will cause the phone to charge more slowly.

1. With the battery in position on the phone, connect the lead from the travel adapter to the bottom of the phone.

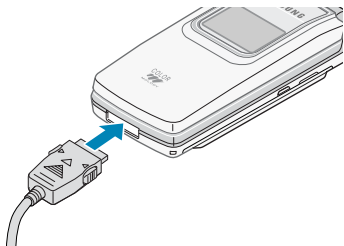

2. Connect the adapter to a standard AC wall outlet.
3. When charging is finished, disconnect the adapter from the power outlet and from the phone by pressing the gray tabs on both sides of the connector and pulling the connector out.

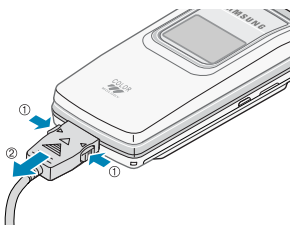

Using the Battery Charger

Using the battery charger, you can charge the battery alone.

1. Insert the battery into the charger, ensuring that the terminals on the battery are in contact with those on the charger. Press the battery down until it clicks into place.

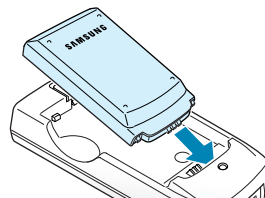

2. Plug the connector of the travel adapter into the jack at the bottom of the charger.

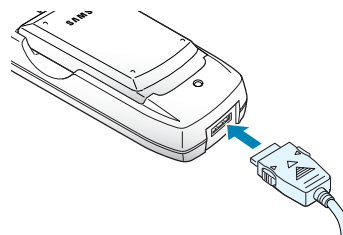

3. Plug the adapter into a standard AC wall outlet.

The LED on the charger will indicate the charging progress with the following colours:

- Red: the battery is charging.
- Green: the battery is completely charged.
- Yellow: the battery is not correctly plugged in or operating in a too high or too low temperature.

4. When charging is finished, unplug the adapter from both the power outlet and the charger.

5. Take the battery out of the charger.

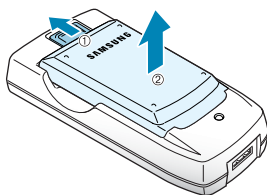

Low Battery Indicator

When the battery is weak and only a few minutes of talk time remain, you will hear a warning tone and a message will be repeated at regular intervals on the display:



If the battery level gets too low, the phone turns off automatically.

Switching the Phone On or Off

1. Open the folder.
2. Hold down the  key until the phone switches on.
3. If the phone asks you to enter the phone password, enter the password and press the **OK** soft key. The phone password is preset to "00000000" at the factory. For further details, see page 112.
4. If the phone asks for a PIN, enter the PIN and press the **OK** soft key. For further details, see page 113.

The phone searches for your network and when it finds the network, the idle screen, illustrated below, appears on each display. Now, you can make or receive a call.

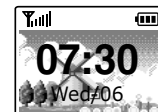
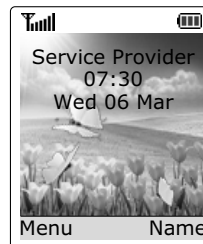

Note: The display language is preset to English at the factory. To change the language, use the **Language** menu option (**Menu 4.5**); for further details, refer to page 81.

5. When you wish to switch the phone off, hold down the  key until the power-off image is displayed.



Call Functions

Making a Call





When the idle screen is displayed, enter the area code and phone number, and press the  key.

Note: If you have checked the **Auto Redial** option in the **Extra Settings** menu (**Menu 4.8**), the phone automatically redials up to ten times when the person does not answer the call or is already on the phone; see page 86 for further details.

Making an International Call

1. Press and hold down the  key.
The + character appears.
2. Enter the country code, area code and phone number and press the  key.

Correcting the Number

To clear...	Press...
the last digit displayed	the  key.
any other digit in the number	the  or  key until the cursor is immediately to the right of the digit to be cleared. Press the  key. You can also insert a missing digit simply by pressing the appropriate key.
the whole display	and hold down the  key for more than one second.





Ending a Call

When you have finished your call, briefly press the  key.

Redialling the Last Number

The phone stores the numbers you dialled, received or missed if the caller is identified; see "Call Records" on page 71 for further details.

To recall any of these numbers:

1. If you have typed any characters on the display, clear the display by holding down the  key for more than one second.
2. Press the  key to display a list of the last numbers in the order in which the calls were made.
3. Use the  and  keys to scroll through the numbers until the required number highlights.

4. To...	Press the...
dial the number highlighted	 key.
edit the number highlighted	Edit soft key. Change the number as required, referring to "Correcting the Number" on page 24 for further details.

Making a Call from the Phonebook

You can store the phone numbers that you use regularly in the SIM card or the phone's memory, which are collectively called the Phonebook. Simply select the required name to recall the associated number. For further details on the Phonebook features, refer to page 35.

Adjusting the Volume

During a call, if you want to adjust the earpiece volume, use the ▲ and ▼ keys on the left side of the phone.

Press the ▲ key to increase and the ▼ key to decrease the volume.



In idle mode with the folder open, you can adjust the key volume using the ▲ and ▼ keys.

Answering a Call

When someone calls you, the phone alerts you by ringing and displaying the following screen:



If the caller can be identified, the caller's phone number or name, if stored in your Phonebook, is displayed.

1. If necessary, open the folder. Press the key or the **Accept** soft key to answer the incoming call.

If the **Anykey Answer** option in the **Extra Settings** menu (**Menu 4.8**) is checked, you can press any key to answer a call, except for the key, and the **Reject** soft key (see page 86).

If the **Active Folder** option in the **Extra Settings** menu (**Menu 4.8**) is checked, you can answer the call simply by opening the folder (see page 86).

Note: To reject an incoming call, press and hold the volume keys on the left side of the phone without opening the folder.

2. End the call by closing the folder or pressing the key.

Note: You can answer a call while using the Phonebook or menu features.

Viewing Missed Calls



If you are unable to answer a call for any reason, you can find out who is calling you, if this service is available. So that you can call the person back, if necessary.

The number of missed calls displays on the idle screen immediately after a call is missed.

To view the missed call immediately:



1. If the phone is closed, open the folder.
2. Press the **View** soft key.

The number corresponding to the most recent missed call displays, if available.

3. To....	Press the...
scroll through the missed calls	 or  key.
call the number displayed	 key.
edit or delete a missed call number	Select soft key (see the following page).



Editing a Missed Call Number

Note: If the number corresponding to the missed call is not available, the **Edit Number** option is not displayed.

1. Press the **Options** soft key.
2. Press the  or  key to highlight the **Edit Number** option.
3. Press the **Select** soft key.
4. Change the number as required.

5. To...	Press the...
call the number	 key.
store the number	Save soft key and enter the name and location required (for further details, refer to page 35).

Deleting a Missed Call



1. Press the **Options** soft key.
2. If necessary, press the  or  key to highlight the **Delete** option.
3. Press the **Select** soft key.

You can press the  key at any time to exit the Missed Call feature.

Note: You can access the Missed Call feature at any time by selecting the **Missed Calls** menu option (**Menu 2.1**); for further details, see page 71.



Switching Quickly to Silent Mode

Silent Mode is convenient when discretion is required and you wish to stop the phone from making any noise, in a theatre for example.



In idle mode, to switch your phone quickly to silent mode, simply press and hold down the  key until the "Silent Mode" message and vibration icon () are displayed.

In silent mode, your phone changes the sound settings as follows.

Option	New Setting
Alert Type (Menu 3.3)	Vibration
Keypad Tone (Menu 3.4)	OFF
SMS Tone (Menu 3.5.1)	Light Only
Error Tone (Menu 3.6.1)	OFF

To exit the silent mode and reactivate the previous Sound Settings, press and hold the  key again until "Exit Silent Mode" appears. The vibration icon () is no longer displayed.

Selecting Functions and Options

Your phone offers a set of functions that allow you to customise it. These functions are arranged in menus and sub-menus, accessed via the two soft keys marked  and . Each menu and sub-menu allows you to view and alter the settings of a particular function.

The roles of the soft keys vary according to the current context; the label on the bottom line of the display just above each key indicates its current role.

Example:

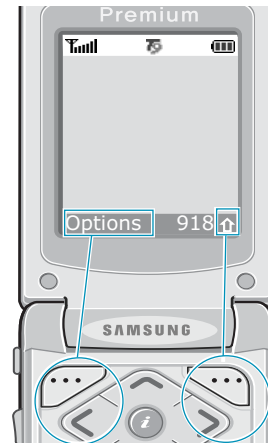

Press the left soft key to access the available options.

Press the right soft key to change the text input mode.

To view the various functions/options available and select the one required:

1. Press the appropriate soft key.

2. **To...**

select the:

- Function displayed
- Option highlighted

view the next function or highlight the next option in a list

move back to the previous function or option in a list

move back up one level in the structure

exit the structure without changing the settings

Press the...

Select soft key or the **>** key.

↵ key or **↓** key on the left side of the phone.

↶ key or **↑** key on the left side of the phone.

< key, **↶** soft key or **⏮** key.

☎/⊗ key.

In some functions, you may be asked for a password or PIN. Enter the required code and press the **OK** soft key.

Example: Setting the Display Language

1. When the idle screen displays, press the **Menu** soft key to access the menus.

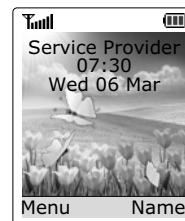

2. Scroll through the menus until you reach the **Phone Settings** menu, by pressing the **↶** or **↵** key.



3. To select the **Phone Settings** menu, press the **Select** soft key or the **>** key.



If the menu name is too long for the display, it is scrolled when highlighted.

4. Scroll through the sub-menus until you reach the **Language** sub-menu, by pressing the **Up** or **Down** key.



Shows the current setting

5. To view the languages available, press the **Select** soft key or the **Right** key. The current setting is highlighted.

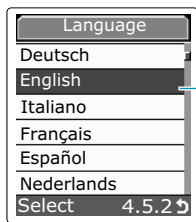

Current language

6. Scroll through the list of languages until the appropriate one is highlighted, by pressing the **Up** or **Down** key.
7. Press the **Select** soft key or the **Right** key to confirm your selection.
8. Press the **Left** or **Left** key twice to exit the menu structure.

Phonebook

You can store phone numbers and their corresponding names in the memory of your SIM card. In addition, you can store up to 500 numbers in the phone memory. The SIM card and phone memories, although physically separate, are used as a single entity, called the Phonebook.

Storing a Number with a Name

There are two ways to store a number:

- Using the **Save** soft key in idle mode
- Using the **New Entry** option in the Phonebook menu

Storing a Number in Idle mode

As soon as you start to enter a number, **Save** appears above the left soft key to allow you to store the number in the Phonebook.

1. Enter the number you want to store.

Note: If you make a mistake while entering a number, correct it using the **Left** key. For further details, refer to page 24.

2. To save the number, press the **Save** soft key.
3. Select an icon to identify the category of number to be stored. Three categories are available: (mobile phone number), (office number) and (home number). To select the category, press the **Left** or **Right** key, followed by the **Select** soft key.

4. Enter a name and press the **OK** soft key.

The maximum length of a name depends on your SIM card. For information on how to enter characters, see page 44.

The phone now displays the first free location in the last memory used to save a number and name. If that memory is full, the first free location in the other memory is displayed.



Note: If you change phones, any numbers stored in your SIM card memory will automatically be available with the new phone, whereas any numbers stored in the phone memory must be restored.

5. Press the right soft key, labelled **To Card** or **To Phone** to toggle between the phone and card memories.
6. If you do not want to save the number and name in the suggested location, press the  key to clear the location number and enter your preferred location by pressing the number keys.
7. Press the **OK** soft key to store the name and number.

After storing, the phone displays the Phonebook entry or name just created.

- | | |
|---------------------------|---|
| 8. To... | Press the... |
| use the entry options | Options soft key. |
| return to the idle screen |  /∅ key. |

Storing a Number Using the Phonebook Menu

1. When the idle screen is displayed, press the **Name** soft key.
2. Scroll to **New Entry** by pressing the  or  key and press the **Select** soft key.



3. Select an icon to identify the category of the number to be stored.

Note: The E-mail icon () is available in this step. It allows you to save an E-mail address instead of a phone number.

4. Continue the procedure from Step 4 on page 36 to store the number.



Using Phonebook Entry Options

While accessing any Phonebook entry, press the **Options** soft key to access the options for the entry.

To...	Press the...
select the highlighted option	Select soft key or the > key.
highlight a different option	 or  key until the required option is highlighted.

The following options are available:

Paste: allows you to paste the selected number into the normal dialling mode. Use this option to dial a number similar to one in the Phonebook, a different extension in the same office, for example.

Use the  key to change the number as required; refer to page 24 for further details. When you are ready to dial, press the  key.

Edit: allows you to edit the selected name and number.

Erase: allows you to erase the selected name and number from the Phonebook. You are asked to confirm that you wish to erase the name and number by pressing the **Yes** soft key.

Copy: allows you to copy the selected number to another location. Use this option to store a number similar to one already in the memory; once copied, edit the number and store it in the Phonebook.

Caller Group: allows you to organise your Phonebook entries in up to 10 caller groups so that the phone alerts you in a specific way when a person from one of your groups calls you. Select one of the ten groups available.

To remove an entry from a group, select the **No Group** option.

For more information on how to change caller group properties, see page 41.

Add Entry: allows you to add a new number in a different category (mobile, office, home or E-mail) to the currently selected name. A Phonebook entry or name can contain up to four number, one in each category.



Searching for and Dialling a Number in the Phonebook

After storing numbers in the Phonebook, you can search for them in two ways: by name and by caller group.

Searching for a Number by Name

1. When the idle screen is displayed, press the **Name** soft key.
2. Press the **Select** soft key when **Search** highlights. You are asked to enter a name.
3. Enter the first few letters of the name that you wish to find.

The Phonebook entries are listed, starting with the first entry matching your input. This entry is also highlighted.



- | | |
|--|---|
| 4. To... | Press the... |
| view the highlighted entry | View soft key. |
| select a different entry |  or  key until the required entry is highlighted. |
| look for a name starting with a different letter | key labelled with the required letter. |

- Once you have found the required entry, press the  key to dial the number, or press the **Options** soft key to access the Phonebook entry options; for further details, see page 37.

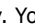

Searching for a Number by Caller Group

- When the idle screen is displayed, press the **Name** soft key.
- Scroll to **Group Search** by pressing the  or  key and press the **Select** soft key. You are asked to enter a group name.
- Enter the first few letters of the group name that you wish to find.



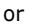

The caller groups are listed, starting with the first group matching your input. The group also highlights.

- Scroll to the required group by pressing the  or  key and press the **View** soft key.

The Phonebook entries in the selected caller group are listed.

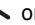
- | | |
|----------------------------|---|
| To... | Press the... |
| view the highlighted entry | View soft key. |
| select a different entry |  or  key until the required entry highlights. |
- Once you have found the required entry, press the  key to dial the number, or press the **Options** soft key to access the Phonebook entry options; for further details, see page 37.

Editing a Caller Group

- When the idle screen is displayed, press the **Name** soft key.
- Scroll to **Group Edit** by pressing the  or  key and press the **Select** soft key.
- Enter the first few letters of the required group name or scroll through the group list by pressing the  or  key.
- When the required group highlights, press the **Options** soft key.



- Select each option and change the settings, as required. The following options are available:

Call ring tone: allows you to select a ring tone to be used when you receive a voice call from a person in the group.

SMS tone: allows you to select a ring tone to be used when you receive a text message from a person in the group.

Graphic: allows you to select a graphic icon to be displayed when you receive a voice call from a person in the group.





Group Name: allows you to assign a name to the group; for further details on how to enter characters, see page 44.

- When you finish changing the settings, press the  or  key.



Speed-Dialling

Once you have stored phone numbers in the SIM card, you can set up to eight speed-dial entries and then dial them easily whenever you want, simply by pressing the associated number key.

Setting Up Speed-Dial Entries

1. When the idle screen is displayed, press the **Name** soft key.
2. Scroll to **Speed Dial** by pressing the  or  key and press the **Select** soft key.
3. Select the key to which you wish to assign the speed-dialling feature, from  to  keys, and press the **OK** soft key.

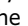
Note: If you have already assigned a number to the key, the **Options** soft key replaces the **OK** soft key. Go to Step 6.



4. Select the required Phonebook entry from the list and press the **View** soft key.
5. Select the required number if the entry has more than one number, by pressing the  or  key and press the **Select** soft key.
6. Once you have assigned a number to the selected key, four options are available:

Change: allows you to assign a different number to the key.

Erase: allows you to clear the setting so that no number is assigned to the key.

Erase All: allows you to clear the settings for all keys so that no numbers are assigned to any of the keys.

Number: allows you to view the number assigned to the key.

7. When you finish setting the options, press the  or  key.

Speed-Dialling from the Phonebook

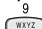
To speed-dial the numbers assigned to keys,  to , press and hold down the appropriate key.

Note: Memory location 1 is reserved for your Voice Mail server number.

Checking Memory Status

You can check how many names and numbers are stored in the Phonebook; SIM card and phone memories. You can also see the capacity of both memories.

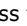
1. When the idle screen is displayed, press the **Name** soft key.
2. Select the **Memory Status** option.
3. Press the  or  keys to view the number of the existing and remaining entries in the card and phone memories.

Entering Text

When using your phone, you will often need to enter text. For example, when storing a name in the Phonebook, creating your personal greeting or scheduling events in your calendar. You can enter alphanumeric characters by using your phone's keypad.

Your phone has the following text input modes.

• T9 mode

This mode allows you to enter words with only one keystroke per letter. Each key on the keypad has more than one letter – when you press the  key once, J, K or L displays. The T9 mode automatically compares your keystrokes with an internal linguistic dictionary to determine the correct word, thus requiring far fewer keystrokes than the traditional upper/lower-case character modes.

• Upper/lower-case character modes

These modes allow you to enter letters by pressing the key labelled with the required letter once, twice, three or four times until the letter displays.

• Symbol mode

This mode allows you to enter various symbols and special characters.

• Number mode

This mode allows you to enter numbers.

Changing the Text Input Mode

When you are in a field that allows characters to be entered, you will notice the text input mode indicator on the display.

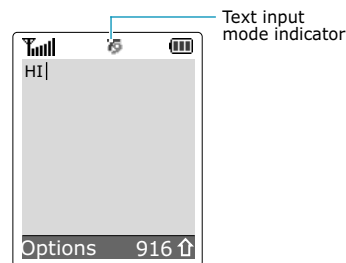

To select the...

T9 mode

Upper-case character mode

Lower-case character mode

Number mode

Symbol mode

Press the soft key until...

 displays.
See page 46.

 displays.
See page 47.

 displays.
See page 47.

 displays.
See page 49.

 displays.
See page 49.

Using the T9 Mode

The T9 predictive text input mode allows you to key in any character using single keystrokes. This text input mode is based on a built-in dictionary.

- When you are in the T9 predictive text input mode, start entering a word by pressing keys ²_{ABC} to ⁹_{WXYZ}. Press each key only once for one letter.

Example: to enter *HELLO* in the T9 mode, press ⁴_{GHI}, ³_{DEF}, ⁵_{JKL}, ⁵_{JKL} and ⁶_{MNO}.

The word that you are typing appears on the display. It may change with each key that you press.

- Enter the whole word before editing or deleting the keystrokes.
- If the word is correct, start entering the next word.

Otherwise, press the ⁰₊, [^] or ^v key repeatedly to display alternate word choices for the keys that you have pressed.

Example: both *OF* and *ME* have the sequence ⁶_{MNO}, ³_{DEF}. The phone displays the most commonly used choice first.

- Complete each word with a space by pressing the [#]_↵ key.
- To type words not found in the T9 mode, change the text input mode to the upper/lower-case character input mode.

- To enter full stops, hyphens or apostrophes, press the ¹_σ key. The T9 mode applies grammar rules to ensure that the correct punctuation is used.

Example: ¹_σ is used twice to display two punctuation marks:

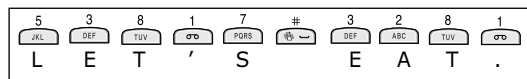

- To shift the case in the T9 mode, use the [#]_↵ key.
- You can move the cursor by using the [<] and [>] keys. To delete letters, press the ^C key. Press and hold down the ^C key to clear the display.

Using the Upper/Lower-Case Character Mode





Use the ¹_σ to ⁰₊ keys to enter your text.

- Press the keys labelled with the required letter:
 - Once for the first letter
 - Twice for the second letter
 - And so on
- Select the other letters in the same way.

Note: The cursor moves to the right when you press a different key. When entering the same letter twice or a different letter on the same key, just wait for a few seconds for the cursor to move right automatically, and then select the next letter.

Refer to the table below for more information about the characters available.

Key	Characters in the Order Displayed	
	Upper Case	Lower Case
1	Space . 1 ! ? & i ÷ §	. % @ _ £ \$ ¥ ¤ §
2	A B C 2 Ä Å Æ Ç Γ	a b c 2 à á â ã æ ã
3	D E F 3 É Δ Φ	d e f 3 è é é Φ
4	G H I 4 Θ Ψ	g h i 4 ì Ψ
5	J K L 5 Λ	j k l 5 Λ
6	M N O 6 Ñ Ø Ö Ö	m n o 6 ñ ø ò ö
7	P Q R S 7 Π Σ Ξ	p q r s 7 β Σ Ξ
8	T U V 8 Ü ü	t u v 8 ù ü
9	W X Y Z 9 Ω	w x y z 9 Ω
0	0 * # , ; ' " =	/ : - + () < >

- To insert a space, press the  key.
- You can move the cursor by using the  and  keys. To delete letters, press the  key. Press and hold down the  key to clear the display.

Using the Symbol Mode

The Symbol mode enables you to insert symbols into a text message.

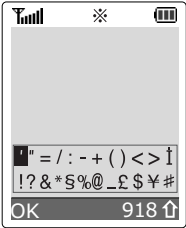

Use the navigation keys to scroll to the desired symbol and then press **OK** soft key to insert the highlighted symbol into your message.

Using the Number Mode

The Number mode enables you to enter numbers into a text messages. Press the keys corresponding to the desired digits, and manually switch back to the text input mode of choice.

Options During a Call

Your phone provides a number of control functions that you can use during a call.

Putting a Call on Hold

You can place the current call on hold whenever you want. You can make another call while you have a call in progress if your network supports this service. If you have an active call and a call on hold, you may alternate between the two calls, changing the one on hold to active and placing the other on hold.

To place a call on hold, simply press the **Hold** soft key. You can reactivate the call whenever you want, by pressing the **Unhold** soft key.

To make a call while you have a call in progress:

1. Key in the phone number that you wish to dial or look it up in the phonebook.
2. Press the  key to dial the second call.
The first call is automatically put on hold.

Or alternatively,

1. Put the current call on hold by pressing the **Hold** soft key.
2. Make the second call in the normal way.

To switch between the two calls, simply press the **Swap** soft key.

The current call is placed on hold and the call on hold is reactivated so that you can continue conversing with the other party.

When you have finished, end each call normally by pressing the  key.

Switching the Microphone Off (Mute)

You can temporarily switch your phone's microphone off so that the other party cannot hear you.

Example: You wish to say something to another person in the room but do not want the other party to hear you.

To switch the microphone off temporarily:

1. Press the **Options** soft key.
2. If necessary, press the  key to highlight the **Mute** option.
3. Press the **OK** soft key.

The other party can no longer hear you.

To switch the microphone back on:

1. Press the **Options** soft key.
2. If necessary, press the  key to highlight the **Unmute** option.
3. Press the **OK** soft key.

The other party can hear you again.

Muting/Sending Key Tones

These options allow you to turn the key tones off or on. If the **Mute keys** option is selected, your phone does not transmit the key tones. It allows you to press keys without hearing annoying key tones during a call.

Note: To communicate with answering machines or computerised telephony systems, the **Send keys** option must be selected.

Searching for a Number in the Phonebook

You can search for a number in the Phonebook during a call.

1. Press the **Options** soft key.
2. Press the  key to highlight the **Phonebook** option.

3. Press the **OK** soft key.

The Phonebook entries are listed.

4. Enter the name that you wish to find.

If you enter the first few letters of the name, the Phonebook entries are listed, starting with the first entry matching your input. The entry also highlights.

5. To view the highlighted entry, press the **View** soft key.

For more information on the Phonebook feature, refer to page 35.

Using the SMS Service

If you receive an SMS (Short Message Service) message during a call, the message icon () flashes on the display. The **SMS Service** option enables you to use this feature.

Read Messages: allows you to read the messages that you have received.

Write Messages: allows you to write a message.

For further details on the SMS service, refer to page 62.

Answering a Second Call

You can answer an incoming call while you have a call in progress, if your network supports this service and you have set the **Call Waiting** menu option (**Menu 6.3**) to **Activate** (see page 101). You will be notified of an incoming call by a call waiting tone.

To answer a call while you have a call in progress:

1. Press the  key to answer the incoming call. The first call is automatically put on hold.

2. To switch between the two calls, press the **Swap** soft key.

To end the call on hold, press the **Options** soft key and select the **End Held Call** option.

3. To end the current call, press the  key.

Making a Multiparty Call



A multiparty call is a network service that allows up to six people to take part simultaneously in a multiparty or conference call. For more information, contact your service provider.

Setting up the Multiparty Call

1. Call the first participant in the normal way.
2. Call the second participant in the normal way. The first call is automatically put on hold.
3. To join the first participant to the multiparty call, press the **Options** soft key and select the **Join** option.
4. To add a new person to the multiparty call, call the person in the normal way, and then press the **Options** soft key and select the **Join** option.

You can add incoming callers by answering the call and pressing **Options**, followed by **Join**. Repeat as required.

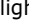
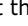
Having a Private Conversation With One Participant

1. Press the **Options** soft key and choose the **Select one** option.
The list of call participants appears.
2. Highlight the required person, by pressing the  or  key, followed by the **Select** soft key or the  key.

3. Select the **Private** option.

Now you can talk privately with that person. The other participants can still converse with each other.



4. To return to the multiparty call, press the **Options** soft key and select **Join**.

All the multiparty call participants can now hear each other.

Dropping One Participant

1. Press the **Options** soft key and choose the **Select one** option.

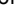
The list of call participants appears.

2. Select a person from the list by pressing the  or  key, followed by the **Select** soft key or the  key.
3. Select **Remove**.

The call ends with that participant, but you can continue to talk with the other participants.





4. End the multiparty call by closing the phone or pressing the  key.

Using the Menus







The phone offers a range of functions that allow you to tailor it to your needs. These functions are arranged in menus and sub-menus.

The menus and sub-menus can be accessed by scrolling with the navigation keys or by using the shortcuts.

Accessing Menu Functions by Scrolling

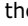
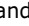
1. In idle mode, press the **Menu** soft key to access menu mode.
2. Scroll with the  or  key to reach the required main menu, **Phone Settings** for example. Press the **Select** soft key or the  key to enter the menu.
3. If the menu contains any sub-menus, **Language** for example, you can access them by scrolling with the  or  key and pressing the **Select** soft key.



If the menu that you have selected contains further options, repeat this step.

- | | |
|---|---|
| 4. To... | Press the... |
| scroll through the menus |  or  key or use the  and  keys on the left side of the phone. |
| confirm the chosen setting | Select soft key or the  key. |
| return to the previous menu level |  soft key or the  key. |
| exit the menu without changing the settings |  /ⓘ key. |

Accessing Menu Functions by Using Shortcuts

The menu items, menu, sub-menus and options, are numbered and can be accessed quickly by using their shortcut number. The shortcut number is shown in the bottom right next to the  soft key on the display. Simply press the **Menu** soft key and key in the required number.

Example: Accessing the **Language** option.

1. Press the **Menu** soft key.
2. Press  for **Phone Settings**.
3. Press  for **Language**.

The languages available displays directly.

Note: The numbers assigned to each menu option are indicated in the list on page 57. They may not match the menu number on the phone, depending on the services supported by your SIM card.

List of Menu Functions

The following illustration shows the menu structure available and indicates the:

- Number assigned to each option
- Page on which you can find a description of each feature

Note: If you use a SIM AT card that provides additional services, the **SIM AT** menu (**8**) displays first when you press the **Menu** soft key to enter menu mode. For further details, refer to your SIM card instructions.

1. Messages (see page 62)

- 1.1 Read Messages
 - 1.1.1 Inbox
 - 1.1.2 Outbox
- 1.2 Write Messages
- 1.3 Templates
- 1.4 Setup
 - 1.4.1 Setting 1*
 - 1.4.2 Setting 2*
 - 1.4.3 Setting 3*
 - 1.4.4 Common Setting
- 1.5 Broadcast
 - 1.5.1 Read
 - 1.5.2 Receive
 - 1.5.3 Channel List
 - 1.5.4 Language
- 1.6 Voice Mail
 - 1.6.1 Connect to Voice Server
 - 1.6.2 Voice Server Number
- 1.7 My Contents
 - 1.7.1 My EMS Melody
 - 1.7.2 My EMS Picture
 - 1.7.3 My EMS Animation
- 1.8 Memory Status
 - 1.8.1 SIM memory
 - 1.8.2 PHONE memory
 - 1.8.3 CB memory

2. Call Records (see page 71)

- 2.1 Missed Calls
- 2.2 Received Calls
- 2.3 Dialed Calls
- 2.4 Call Time
 - 2.4.1 Last Call Time
 - 2.4.2 Total Sent
 - 2.4.3 Total Received
 - 2.4.4 Reset Timers

2. Call Records (continued)

- 2.5 Call Cost*
 - 2.5.1 Last Call Cost
 - 2.5.2 Total Cost
 - 2.5.3 Max Cost
 - 2.5.4 Reset Counters
 - 2.5.5 Set Max Cost
 - 2.5.6 Price/Unit

3. Sound Settings (see page 74)

- 3.1 Ring Tone
- 3.2 Ring Volume
- 3.3 Alert Type
- 3.4 Keypad Tone
- 3.5 Message Tone
 - 3.5.1 SMS Tone
 - 3.5.2 SMS-CB Tone
- 3.6 Extra Tones
 - 3.6.1 Error Tone
 - 3.6.2 Minute Minder
 - 3.6.3 Connect Tone

4. Phone Settings (see page 78)

- 4.1 Infrared Activate
- 4.2 My Settings
 - 4.2.1 Wallpaper
 - 4.2.2 Colour Theme
 - 4.2.3 Menu Style
- 4.3 Greeting Message
- 4.4 Own Number
- 4.5 Language
- 4.6 Security
 - 4.6.1 PIN Check
 - 4.6.2 Change PIN
 - 4.6.3 Phone Lock
 - 4.6.4 Change Password
 - 4.6.5 SIM Lock
 - 4.6.6 FDN Mode*
 - 4.6.7 Change PIN2*

* Shown only if supported by your SIM card.

* Shown only if supported by your SIM card.

4. Phone Settings *(continued)*

- 4.7 Display Settings
 - 4.7.1 Contrast
 - 4.7.2 Back Light
 - 4.7.3 Auto Light
 - 4.7.4 Service Light
 - 4.7.5 Graphic Logo
- 4.8 Extra Settings
 - 4.8.1 Auto Redial
 - 4.8.2 Active Folder
 - 4.8.3 Anykey Answer
- 4.9 Short Cut
- 4.10 Reset Settings

5. Organiser *(see page 88)*

- 5.1 Calendar
- 5.2 To Do List
- 5.3 Time & Date
 - 5.3.1 Set Time
 - 5.3.2 Set Date
 - 5.3.3 World Time
 - 5.3.4 Time Format
- 5.4 Alarm
- 5.5 Calculator
- 5.6 Currency Exchange

6. Network Services *(see page 97)*

- 6.1 Call Diverting
 - 6.1.1 Divert Always
 - 6.1.2 Busy
 - 6.1.3 No Reply
 - 6.1.4 Unreachable
 - 6.1.5 Cancel All
- 6.2 Call Barring
 - 6.2.1 All Outgoing
 - 6.2.2 International
 - 6.2.3 International Except to Home
 - 6.2.4 All Incoming
 - 6.2.5 Incoming While Abroad
 - 6.2.6 Cancel All
 - 6.2.7 Change Barring Password

6. Network Services *(continued)*

- 6.3 Call Waiting
 - 6.3.1 Voice Calls
 - 6.3.2 Data Calls
 - 6.3.3 Cancel All
- 6.4 Network Selection
 - 6.4.1 Automatic
 - 6.4.2 Manual
- 6.5 Caller ID
 - 6.5.1 Default
 - 6.5.2 Hide Number
 - 6.5.3 Send Number
- 6.6 Closed User Group
 - 6.6.1 Index List
 - 6.6.2 Outside Access
 - 6.6.3 Default Group
 - 6.6.4 Deactivate*
- 6.7 Band Selection

7. Funbox *(see page 106)*

- 7.1 Games
- 7.2 WAP Browser
- 7.3 Downloads
 - 7.3.1 Games & More
 - 7.3.2 Sounds
 - 7.3.3 Pictures
 - 7.3.4 DNS Setting

*Shown only if the Closed User Group Feature is active.

Messages

The SMS (Short Message Service) function is a network service that may not be supported by your network. You can send messages by a text, fax, Email and paging messaging systems, provided that these services are supported by your network. To send text messages by phone, you must obtain the number of the SMS centre from your service provider.

When the message icon (✉) appears, you have received new text messages. If the message memory is full, an error message displays and you cannot receive any new messages. Use the **Delete** option in the **Read Messages** menu (**Menu 1.1**) to delete obsolete messages.

Read Messages *(Menu 1.1)*

Two message boxes are available.

Inbox: used to store the messages that you have received.

Outbox: used to store the messages that you have already sent or will send.

Reading a Message

1. Select the required box and press the **Select** soft key.

The list of messages in the box displays with the sender or recipient's phone number or name, if it is available in your Phonebook.

2. Select the required message and press the **View** soft key to view the message contents.

3. To scroll through the message, press the **^** or **v** key.

While reading a message, you can choose the following options by pressing the **Options** soft key.

Delete: allows you to delete obsolete messages.

Text Reply (inbox only): allows you to reply to the sender by sending a text message. You can also change the SMS centre number, if required.

Call Back (inbox only): allows you to call the sender back.

Cut Number: allows you to extract a number from the message, if it has one, so that you can call the number or save it in your Phonebook.

Send: allows you to send a message that you have received or saved. For more information on how to send a message, see page 64.

Edit Message: allows you to edit a message.

Select Objects: allows you to save the objects, such as sounds or images, from the message into your phone. You can use the objects when writing a message; for details, see page 65.

Note: The options available vary, depending on the message status (new/old, not sent or sent for example).

Write Messages *(Menu 1.2)*

In this menu, you can write and send a text message.

Note: You can enter up to 918 alphanumeric characters for your message. If you add objects to the message, the number of characters you can enter will be decreased.

Creating a Simple Text Message

1. Create your message.

Note: For more information about entering characters, refer to page 44.

2. When you finish entering the message, press the **Options** soft key. The following options are available:

Send Only: allows you to send the message. The message is deleted after sending.

Save and Send: allows you to save a copy of the message and then send the message to the required destination. You can read the message in your outbox using the **Read Messages** option.

Save Only: allows you to save the message so that it can be sent later. You can read the message in your outbox using the **Read Messages** option.

For more information about the **Text Formatting**, **Add Objects**, **Add Templates**, and **Language** options, see page 65.

3. Select **Send Only** or **Save and Send**, and press the **Select** soft key.

If you want just to save the message, select **Save Only**. After saving the message, the phone returns to the **Messages** menu.

4. Enter a destination number and press the **OK** soft key. The message is sent.

Creating a Message using the Options

1. Create a message.
2. Press the **Options** soft key.
3. Select one of the following options as required by using the **^** and **v** keys and pressing the **Select** soft key.

Text Formatting: allows you to format the style of the text. For the **Size** attribute, the **Normal**, **Large** and **Small** sizes are available. For the **Underline** and **Strikethrough** attributes, select **On** or **Off**. The attributes can be combined.



Add Objects: allows you to add the required sound, melody picture or animation to the message. Select the category of the object to be added. In each category, you can select the various factory-set items or choose an item received from other sources, such as the Internet or other phones.

Add Templates: allows you to apply one of the preset message templates to the text. Select one of the five messages predefined in the **Templates** menu option (**Menu 1.3**); for further details, see page 66.

Language: allows you to change the language to be used in the T9 input mode. Select the language to be used.

4. Complete the message, and send or save it by following the procedure from Step 2 on page 64.

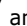
Templates *(Menu 1.3)*

Using this menu, you can preset up to five messages that you use most frequently. Scroll through the template list using the  and  keys. When the required message template highlights, press the **Options** soft key.

Edit: allows you to write a new message or edit the selected message.

Note: For further information on how to enter characters, refer to page 44.

Send Message: allows you to recall the selected message. Once you have completed the message, you can send, save and send, or simply save it. For further details on how to send a message, see page 64.

Delete: allows you to delete the selected message. You are asked to confirm the deletion by pressing the **Yes** soft key.

Setup *(Menu 1.4)*

In this menu, you can set up default SMS information. A setting group is a collection of settings required to send messages. The number of setting groups available depends on the capacity of your SIM card.

Setting x (where **x** is the setting group number): each group has its own sub-menu.

Service Centre: allows you to store or change the number of your SMS centre, which is required when sending messages. You must obtain this number from your service provider.

Default Type: allows you to set the default message type-Text, Fax, Email and Paging. The network can convert the messages into the selected format.

Default Validity: allows you to set the length of time for which your text messages are stored at the message centre while attempts are made to deliver them.

Setting Name: allows you to give a name to the setting group currently being defined.

Common Setting: The following four options are available:

Reply Path: allows the recipient of your SMS message to send you a reply message via your message centre, if your network supports with this service.

Delivery Reports: allows you to activate or deactivate the report function. When this function is activated, the network informs you whether your message has been delivered or not.

Bearer Selection: allows you to choose between **GSM** and **GPRS**.

Wap Push: allows you to select whether you receive Web messages from the server or not. Select **Never** if you do not want to receive any messages, **Always** to receive all messages, and **SMS-C Specific** to receive messages from a specific SMS centre.

Broadcast (Menu 1.5)

This network service allows you to receive text messages on various topics, such as the weather or traffic. Messages display immediately they are received, provided that:

- the phone is in idle mode
- the **Receive** option is set to **Enable**
- the message channel is currently active in the channel list

The following options are available:

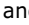
Read: lets you view the received message.
Volatile displays the messages from the network, but loses its contents as soon as the phone is switched off. Scroll through the message by using the  and  keys. While reading a message, press the **Save** soft key to store the message in the **Archive** box for later retrieval.

Receive: allows you to enable or disable the reception of broadcast messages.

Channel List: allows you to indicate the channels from which you wish to receive broadcast messages. The following options are available.

Select: use to enable or disable channels in the list by marking or unmarking them respectively. A check mark displays in front of each selected channel.

Add Channel: use to enter the ID and title for a new channel.

Delete: use to remove a channel from the list.

Edit: use to change the ID and title of an existing channel.

Language: allows you to select your preferred language to display cell broadcast messages.

Please contact your service provider for more information.

Voice Mail (Menu 1.6)

This menu provides you with a way of accessing your voice mailbox, if your network supports this service.

The following options are available:

Connect to Voice Server: before using this feature, you must enter the voice server number obtained from your service provider (see menu option **1.6.2**). You can then select this option and simply press the **OK** soft key to listen to your messages.

To quickly connect to the voice server, press and hold down the  key in idle mode.

Voice Server Number: allows you to change the voice mail server number, if necessary.

To...	Press the...
enter the server number	corresponding numeric keys.
correct a digit	 key.
move the cursor to the left/right without clearing the digit	< or > key.

Note: Voice Mail is a network feature. Please contact your service provider for more information.

My Contents *(Menu 1.7)*

After saving any objects received in messages into your phone memory, using the **Select Object** option (see page 63), you can see the objects in this menu.

To delete the objects in this menu, press the **Delete** soft key.

You can forward the objects to other people by including message and/or use them for your ring tone or background them in a image.

Three categories of objects are available:

- **My EMS Melody**
- **My EMS Picture**
- **My EMS Animation**

Memory Status *(Menu 1.8)*

This menu shows how many messages are currently stored in the SIM, phone and CB memories.

Call Records

In this menu, you can view the following phone calls that are:

- missed
- received
- dialled

Note: You can access all numbers in the three types of call records by pressing the  key in idle mode.

Missed Calls *(Menu 2.1)*

This option lets you view the last 20 numbers of the calls you received, but did not answer.

The number and name, if available, display together with the date and time at which the call was received. By pressing the **Options** soft key, you can:

- edit the number, if available, and dial it or save it in the Phonebook
- delete the call from the list

Received Calls *(Menu 2.2)*

This option lets you view the last 20 numbers at the calls received.

The number and name, if available, display together with the date and time at which the call was received. By pressing the **Options** soft key, you can:

- edit the number, if available, and dial it or save it in the Phonebook
- delete the call from the list

Dialled Calls *(Menu 2.3)*

This option lets you view the last 20 numbers you dialled.

The number and name, if available, display together with the date and time at which the call was made. By pressing the **Options** soft key, you can:

- delete the number
- edit the number and save it in the Phonebook

Call Time *(Menu 2.4)*

This option lets you view the timers for calls made and received.

The following timers are available:

Last Call Time: length of the last call.

Total Sent: total length of all calls made since the timer was last reset.

Total Received: total length of all calls received since the timer was last reset.

Reset Timers: option used to reset the call timers; you must first enter the phone password (see page 112) and then press the **OK** soft key.

Note: The actual time invoiced for calls by your service provider may vary, depending on network features, rounding-off for billing purposes and so forth.

Call Cost* *(Menu 2.5)*

This network feature lets you view the cost of calls.

The following options are available:

Last Call Cost: cost of the last call made.

Total Cost: total cost of all calls made since the cost counter was last reset. If the total cost exceeds the maximum cost set in the **Set Max Cost** option, you can no longer make any calls until you reset the counter.

Max Cost: maximum cost set in the **Set Max Cost** option (see below).

Reset Counters: option used to reset the cost counter; you must first enter your PIN2 (see page 114) and then press the **OK** soft key.

Set Max Cost: option used to enter the maximum cost that you authorise for your calls.

Price/Unit: option used to set the cost of one unit; this price per unit is applied when calculating the cost of your calls.

* Shown only if supported by your SIM card.

Sound Settings

You can use the Sound Settings feature to customise various settings, such as the:

- ring melody, volume and type
- sounds made when you press a key, make an error or receive a message

Note: When the phone is in silent mode (see page 30), you cannot change the sound settings.





Ring Tone *(Menu 3.1)*

This option allows you to select the required ring melody.

You can choose between many different melodies. Each time you select a melody, it displays for a few seconds. If you have downloaded any sounds from the Internet or EasyGPRS programme or received any ring tone messages, you can view the list in this menu.

Ring Volume *(Menu 3.2)*

This option allows you to adjust the ring volume to one of five levels.

Use the  and  keys or the  and  keys on the left side of the phone.

Alert Type *(Menu 3.3)*

This option allows you to specify how you are to be informed of any incoming calls.

The following options are available:

Light only: only the backlight is switched on; the phone neither rings nor vibrates.

Melody: the phone rings using the ring melody selected in the **Ring Tone** menu option (**Menu 3.1**); see page 74.

Vibration: the phone vibrates but does not ring.

Vibra+Melody: the phone first vibrates three times and then starts ringing.

Keypad Tone *(Menu 3.4)*

This option allows you to select the tone that the keypad generates when you press a key.

The following options are available:

OFF: the keys do not make any sound.

Tone: each key, when pressed, makes a different sound.

Beep: each key, when pressed, makes the same sound.

Message Tone *(Menu 3.5)*

This option allows you to select how the phone informs you that a new message has been received.

SMS Tone

This option allows you to select how the phone informs you that a new SMS message has been received.

The following options are available:

OFF: the phone does not use the SMS tone.

Light Only: the service light at the top of the phone flashes.

Vibration: the phone vibrates.

Single Beep: the phone beeps once.

SMS Tone1~10: the phone uses an SMS tone. You are provided with ten SMS tones.

SMS CB Tone

This option allows you to select how the phone informs you that a new cell broadcast (CB) message has been received.

The following options are available:

OFF: the phone does not use the CB tone.

Light Only: the service light at the top of the phone flashes.

Vibration: the phone vibrates.

Single Beep: the phone beeps once.

SMS CB Tone1~10: the phone uses a CB tone. You are provided with ten CB tones.

Extra Tones *(Menu 3.6)*

You can customise various other tones used by the phone.

To turn a given tone...

Press the...

on

ON soft key.
A check mark is displayed in front of the option.

off

OFF soft key again.
The check mark is no longer displayed.

The following options are available:

Error Tone: sets whether the phone informs you that you make a mistake or not.

Minute Minder: sets whether the phone must beep every minute during an outgoing call to keep you informed of the length of your call.

Connect Tone: sets your phone to beep when the person you are calling answers the phone.

Phone Settings

Many different features of your phone can be customised to suit your preferences. All of these features are accessed in the **Phone Settings** menu.

Infrared Activate *(Menu 4.1)*

This feature allows you to send or receive data/fax through the infrared port. To use an infrared connection, you must:

- configure and activate an IrDA-compliant infrared port on your PC
- activate the infrared feature on the phone; the IrDA icon () appears on the top line of the display
- align the IrDA port on the phone with the IrDA port on your computer

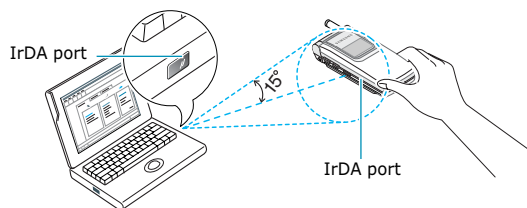

The connection is ready for data transmission.

If there is no communication between your phone and the IrDA-compliant device within 30 seconds of activating the feature, it is automatically deactivated.

Note: For the best performance, it is highly recommended that you use the data link cable supplied in your SGH-S200 kit.



My Settings *(Menu 4.2)*

You can change the background image and the colour of the components on the display according to your preference.

Wallpaper

This option allows you to change the background image to be displayed in idle mode.

To change the background image:

1. Scroll through the list by pressing the  or  key.

You have various preset images available. You can also select the blank background and any images downloaded from the Internet or the EasyGPRS programme.

2. Press the **Select** soft key when the required image highlights.

The selected image displays.

3. After viewing the image, press the **Select** soft key to display it on the idle screen.

Colour Theme

You can change the colour setting of the display components, such as text, soft key display area or the menu names and icons. Five different colour settings are available.



Select the required setting and press the **Select** soft key, followed by **OK** to confirm the highlight colour and colour theme.

Menu Style

This option allows you to select the menu display style. You can choose between **Folder Style** and **Nature Style**.

Greeting Message *(Menu 4.3)*

This option allows you to set a greeting to be displayed briefly when the phone is switched on. When you select this menu option, the current message is displayed.

To...	Press the...
clear the existing message	 key and hold it down until the message is cleared.
enter a new message	appropriate alphanumeric keys.
change the text input mode	 soft key.

For further details on how to enter characters, refer to page 44.

Own Number *(Menu 4.4)*

This feature allows you to:

- assign a name to each of your own phone numbers registered on your SIM card
- edit the names and numbers

This function is a memory aid, which you can use to check your own phone numbers if you need to do so.

Any changes made here do not in any way affect the actual subscriber numbers on your SIM card.

Language *(Menu 4.5)*

You can select a display language. When the language option is set to **Automatic**, the language is automatically selected according to the language of the SIM card used.

Security *(Menu 4.6)*

The Security feature enables you to restrict the use of your phone to:

- the people of your choice
- the types of calls of your choice

Various codes and passwords are used to protect the features of your phone. They are described in the following sections (see also pages 112-115).

PIN Check

When the PIN Check feature is enabled, you must enter your PIN each time you switch the phone on. Consequently, any person who does not have your PIN cannot use your phone without your approval.

Note: Before disabling the PIN Check feature, you must enter your PIN.

To change your PIN, refer to the **Change PIN** menu option (**Menu 4.6.2**).

The following options are available:

Disable: the phone connects directly to the network when you switch it on.

Enable: you must enter the PIN each time the phone is switched on.

Change PIN

This feature allows you to change your current PIN to a new one, provided that the PIN Check feature is enabled. You must enter the current PIN before you can specify a new one.

Once you have entered a new PIN, you are asked to confirm it by entering it again.

Phone Lock

When the Phone Lock feature is enabled, the phone is locked and you must enter the 8-digit phone password each time the phone is switched on.

The password is preset to "00000000" at the factory. To change the phone password, refer to the **Change Password** menu option (**Menu 4.6.4**) below.

Once the correct password has been entered, you can use the phone until you switch it off.

The following options are available:

Disable: you are not asked to enter the phone password when you switch the phone on.

Enable: you are required to enter the phone password when you switch the phone on.

Change Password

The Change Password feature allows you to change your current phone password to a new one. You must enter the current password before you can specify a new one.

The password is preset to "00000000" at the factory. Once you have entered a new password, you are asked to confirm it by entering it again.

SIM Lock

When the SIM Lock feature is enabled, your phone only works with the current SIM. You must enter the SIM lock code.

Once you have entered the lock code, you are asked to confirm it by entering it again.

To unlock the SIM, you must enter the SIM lock code.

FDN Mode

The FDN (Fixed Dial Number) mode, if supported by your SIM card, allows you to restrict your outgoing calls to a limited set of phone numbers.

The following options are available:

Disable: you can call any number.

Enable: you can only call phone numbers stored in the Phonebook. You must enter your PIN2.

Note: Not all SIM cards have a PIN2. If your SIM card does not, this menu option is not displayed.

To change your PIN2, refer to the **Change PIN2** menu option (**Menu 4.6.7**) below.

Change PIN2

The Change PIN2 feature allows you to change your current PIN2 to a new one. You must enter the current PIN2 before you can specify a new one.

Once you have entered a new PIN2, you are asked to confirm it by entering it again.



Note: Not all SIM cards have a PIN2. If your SIM card does not, this menu option is not displayed.

Display Settings *(Menu 4.7)*

Contrast

This option allows you to adjust the brightness of the display screens to make them lighter or darker.

To adjust the display contrast:

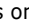
1. Select the LCD to be adjusted, **Main LCD** or **Front LCD**, and press the **Select** soft key.
2. Adjust the contrast by using the  and  keys or the  and  keys on the left side of the phone.
3. When you are satisfied, press the **OK** soft key to save the selection.

Back Light

You can select whether or not the phone uses the backlight. A marginal increase in standby/talk time can be achieved by turning the backlight off.

The following options are available:

OFF: the backlight is not used.

Short: the backlight comes on when you press a key or receive a call and switches off 10 seconds after the last key is pressed.

Long: the backlight comes on when you press a key or receive a call and switches off 20 seconds after the last key is pressed.

Auto Light

Using this feature, you can specify the time for which the backlight is to be used. This feature helps conserve your battery power.

The following options are available:

Disable: the backlight is used according to the setting in the **Back Light** menu option (**Menu 4.7.2**); see page 84.

Enable: the backlight is used only during the specified period of time. Set the required length of time in hours and minutes, using the appropriate number keys.

Service Light

This option allows you to select whether or not the service light on the top of the phone is used or in which colour it flashes.

Select the required colour from red, green, blue, yellow, cyan, violet and white. When the phone is ready for use, the service light will flash in the appropriate colour.

If you do not wish to use the service light, select **Off**.

Graphic Logo

This option allows you to display your operator's logo instead of its name.

On: the operator logo stored in your phone is displayed in idle mode; if no logo has been stored, the operator name is displayed.

Off: the operator name is displayed in idle mode.

Extra Settings *(Menu 4.8)*

You can turn the automatic redialling or answering features on or off.

To turn a feature...	Press the...
on	ON soft key. A check mark is displayed in front of the option.
off	OFF soft key. The check mark is no longer displayed.

The following options are available:

Auto Redial: when this option is checked, the phone makes up to ten attempts to redial a phone number after an unsuccessful call.

Note: The interval between two call attempts varies.

Active Folder: when this option is checked, you can simply open the folder to answer a call.

When it is unchecked, you must open the folder and press a key, depending on the setting of the **Anykey Answer** option (see below).

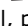

Anykey Answer: when this option is checked, you can answer an incoming call by pressing any key, except the /☎ key and the **Reject** soft key. To reject the call, press the /☎ key or the **Reject** soft key.

When this option is unchecked, you can only press the  key or **Accept** soft key.

Short Cut *(Menu 4.9)*

The navigation keys can be used as shortcut keys. When held down in idle mode, they allow you to access specific menu options directly.

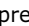
To assign a shortcut to a key:

1. Select the key to be used as a shortcut key by pressing the  or  key, followed by the **Select** soft key.

Key up ()

Key down ()

Key right ()

Key left ()

2. Select the menu option to be assigned to the key by pressing the  or  key.

Note: To deactivate a shortcut key, select the **None** option.

3. Press the **Select** soft key to save the selection.

Reset Settings *(Menu 4.10)*

You can easily reset your phone to its default settings. To reset your phone:

1. Select the **Reset Settings** menu option.
2. Enter the 8-digit phone password and press the **OK** soft key.

Note: The password is preset to "00000000." To change this password, refer to page 82.

Organiser

The Organiser feature enables you to:

- view the calendar and organise your schedule.
- define a list of things to do.
- set the current date and time.
- set an alarm so that the phone rings at a specific time to remind you of an appointment, for example.
- use the phone as a calculator for basic mathematical equations or currency exchange operations.

Calendar *(Menu 5.1)*

With the Calendar feature, you can:

- consult the calendar
- write memos to keep track of your schedule and trigger an alarm if necessary

Consulting the Calendar

When you select the **Calendar** menu option (**Menu 5.1**), the calendar displays. The following options are available when you press the **Options** soft key.

Search all: displays all of the memos, regardless of the day and starting with the oldest. To scroll through the memos, press the **▲** or **▼** key.

Delete all: allows you to delete all of the memos. You are asked to confirm your action.

Go to date: allows you to go to a specific date.

Exit: exits the Calendar feature and returns to idle mode.

Writing a Memo

To write or edit a memo on a specific date:

1. Select the required date in the calendar, using the navigation keys.

Note: To skip to the previous or next month, press the **▲** and **▼** keys on the left side of the phone.

2. Press the **Select** soft key.

An empty memo screen displays to allow you to enter your memo.

3. Enter your memo and then press the **OK** soft key.

Note: For further details on how to enter characters, refer to page 44.

You are asked if you wish to set an alarm.

4. If you want an alarm to ring on the chosen day, press the **Yes** soft key. Otherwise, press the **No** soft key.
5. If you pressed the **Yes** soft key, set the time for the alarm and press the **OK** soft key. The colour of the date is changed to green to indicate that a memo exists.

Editing a Memo

If you select a day for which a memo already exists, you can press the **Edit** soft key to edit the memo displayed.

Note: For further details about how to enter characters, refer to page 44.

Once you have finished editing the memo, press the **OK** soft key. The following options are available when you press the **Options** soft key:

Alarm: allows you to set an alarm to ring on the chosen day.

Erase: allows you to delete the memo.

Copy to: allows you to copy the memo to another date and/or time.

Move to: allows you to change the date and/or time of the memo.

To Do List *(Menu 5.2)*

This feature allows you to:

- Enter a list of tasks to be done.
- Assign a priority and a deadline to each task.
- Sort the tasks by priority and status mark.

Creating the To Do List

1. Press the **New** soft key.

2. Enter the first task.

Note: You can enter up to 40 characters. For further details on how to enter characters, see page 44.

3. Press the **OK** soft key.

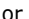
4. Select high, normal or low priority using the  or  key and press the **Select** soft key.

5. Enter your deadline.

If you do not want to set a deadline, press the **Skip** soft key.

6. Press the **OK** soft key.

Editing the To Do List

If tasks are already defined in the To Do List when you select the **To Do List** menu option (**Menu 5.2**), the current contents are displayed with the status mark and priority; three stars for high, two for normal and one for low.

The following options are available:

To...	Then...
view the details for a specific task	<ul style="list-style-type: none"> • highlight the task. • press the View soft key.
change the status of a specific task	<ul style="list-style-type: none"> • highlight the task. • press the  key to mark the task as completed as of the current date and time. <p>or</p> <ul style="list-style-type: none"> • highlight the task. • press the Options soft key. • select the Mark option. • select the appropriate status (Done or Undo).
create a new task	<ul style="list-style-type: none"> • press the Options soft key. • select the New option. • enter the text, priority and deadline for the task.

To...	Then...
edit an existing task	<ul style="list-style-type: none"> highlight the task. press the Options soft key. select the Edit option. change the text, priority and deadline for the task.
sort the existing tasks by priority or status	<ul style="list-style-type: none"> press the Options soft key. select the Sort option. select the sort criterion (High, Low, Done or Undo).
copy a task	<ul style="list-style-type: none"> highlight the task. press the Options soft key. select the Copy option. change the text, priority and deadline for the task as required.
copy a task to the calendar	<ul style="list-style-type: none"> highlight the task. press the Options soft key. select the Copy to calendar option. change the text and deadline for the task and set the alarm as required.
delete a task	<ul style="list-style-type: none"> highlight the task. press the Options soft key. select the Delete option.
delete all tasks	<ul style="list-style-type: none"> press the Options soft key. select the Delete all option. confirm the deletion by pressing OK.
exit the To Do list	<ul style="list-style-type: none"> press the Options soft key. select the Exit option.

Time & Date *(Menu 5.3)*

This option allows you to change the current time and date displayed. You can also use this option to find out what time it is and another part of the world.

The following options are available:

Set Time: allows you to enter the current time. You can choose the time format in the **Time Format** menu option (**Menu 5.3.4**).

Note: Before setting the time, you must specify your time zone, in the **World Time** menu option (**Menu 5.3.3**).

Set Date: allows you to enter the day, month and year.

World Time: allows you to find out what time it is and another part of the world, using the **<** and **>** keys.

The screen shows the:

- city name.
- current date and time.
- time difference between the selected city and your city if you have set the local time (see below for further details) or GMT (by default).

To select your time zone:

- Select the city corresponding to your time zone by pressing the **<** or **>** key one or more times. The local date and time are displayed.
- Press the **Set** soft key.

Time Format: allows you to change the time format to **24 Hours** or **12 Hours**.

Alarm *(Menu 5.4)*

This feature allows you to:

- set the alarm to ring at a specific time
- set the phone to switch on automatically and ring the alarm even if the phone is switched off (**Autopower** menu option set to **Enable**)

The following options are available:

Once Alarm: the alarm rings only once and is then deactivated.

Daily Alarm: the alarm rings every day at the same time.

Morning Call: the alarm rings to wake you up in the morning.

To set an alarm:

1. Choose the type of alarm to be set.
2. Enter the required time and day of the week, if applicable.
3. Press the **OK** soft key.
4. If you select **Morning Call** in Step 1, select the repeat option: **Monday to Friday** or **Monday to Saturday**.

Remove Alarm: deactivates all alarm settings.

Autopower: if this option is set to **Enable**, the alarm will ring at the specified time, even when the phone is switched off.

If the menu option is set to **Disable** and the phone is switched off at the specified time, the alarm does not ring.

To stop the alarm when it rings, open the phone and press the **Exit** soft key.

When setting or viewing an alarm, the following options are available when you press the **Options** soft key:

Remove Alarm: deactivates the current alarm.

Alarm Sound Set: allows you to select the alarm melody.



Calculator *(Menu 5.5)*

With this feature, you can use the phone as a calculator. The calculator provides the basic arithmetic functions; addition, subtraction, multiplication and division.

Using the Calculator

1. Enter the first number using the numeric keys.
2. Press the right soft key until the required arithmetic symbol appears: **+** (addition), **-** (subtraction), ***** (multiplication), **/** (division).
3. Enter the second number.
4. Repeat Steps 1 to 3 as many times as required.

Notes:

- To erase any mistakes and clear the display, press the  key.
 - To include a decimal point or a bracket, press the left soft key until the required symbol is displayed.
5. To calculate the result, press the  key.

Currency Exchange *(Menu 5.6)*

Using this menu option, you can make currency conversions.

1. Enter the current exchange rate of your source currency and press the **OK** soft key.

You can insert a decimal point by pressing the  key.

2. Enter the amount for which you wish to conduct the currency conversion and press the **OK** soft key.

The exchange rate amount you entered and equivalent value are displayed.

3. Press the **Exit** soft key to exit the currency convertor.

Network Services

These menu functions are network services. Please contact your service provider to check their availability and subscribe to them, if you wish.

Call Diverting *(Menu 6.1)*

This network service enables incoming calls to be rerouted to the number that you specify.

Example: You may wish to divert your business calls to a colleague while you are on holiday.

Call diverting can be set up in the following ways:

Divert Always: all calls are diverted.

Busy: calls are diverted if you are already on another call.

No Reply: calls are diverted if you do not answer the phone.

Unreachable: calls are diverted if you are not in an area covered by your service provider.





Cancel All: all call diverting options are cancelled.

You can specify individual diverting options for each of the following call types:

- Voice calls only
- Data calls only

Example: You can divert voice calls to your colleague if you are already using the phone.

To set your call diverting options:

1. Select the type of call diverting required by pressing the  or  key until the appropriate option highlights, and then press the **Select** soft key.
2. Select the type of calls to be diverted by pressing the  or  key until the appropriate option highlights and then press the **Select** soft key.

The current status displays. If the option has already been set, the number to which the calls are diverted displays.

- | | |
|---------------------------|--|
| 3. To... | Press the... |
| activate call diverting | Activate soft key.
Go to Step 4. |
| change the call number | Change soft key.
Go to Step 4. |
| deactivate call diverting | Remove soft key. |

4. Enter the number to which the calls are to be diverted and press **OK**.
To enter an international code, press the  key until the **+** sign displays.

The phone sends your settings to the network and the network's acknowledgement displays.

You can deactivate all call diverting settings by selecting the **Cancel All** option.

Call Barring *(Menu 6.2)*

The call barring network service allows you to restrict your calls.

Call barring can be set up in the following ways:

All Outgoing: calls cannot be made.

International: international calls cannot be made.

International Except to Home: when abroad, calls can be made only to numbers within the current country and to your home country, which is the country where your home network provider is located.

All Incoming: calls cannot be received.



Incoming While Abroad: calls cannot be received when you are using your phone outside of your home service area.

Cancel All: all call barring settings are deactivated; calls can be made and received normally.

You can specify individual barring options for each of the following call types:

- Voice calls only
- Data calls only

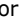
To set your call barring options:

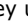
1. Select the type of call barring required by pressing the  or  key until the appropriate option highlights and then press the **Select** soft key.
2. Select the type of calls to be barred by pressing the  or  key until the appropriate option highlights and then press the **Select** soft key.
3. Press the **Activate** soft key to confirm your settings.
4. Enter your call barring password supplied by your service provider.

The phone sends your settings to the network and the network's acknowledgement displays.

To deactivate specific call barring settings:

1. Select the call barring option to be deactivated.
2. Select the type of call to which this option applies.
3. Press the **Deactivate** soft key.
4. Enter your call barring password supplied by your service provider.

The phone sends your settings to the network and the network's acknowledgement displays

You can also deactivate all call barring settings by selecting the **Cancel All** option.

Change Barring Password: you can set and change the call barring password obtained from your service provider using this option. You must enter the current password before you can specify a new one.

Once you have entered a new password, you are asked to confirm it by entering it again.

Call Waiting *(Menu 6.3)*

This network service enables you to be informed when someone is trying to reach you during another call.

You can specify individual call waiting options for each of the following call types:

- Voice calls only
- Data calls only

To set your call waiting options:

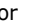
1. Select the type of calls to which the call waiting option is to be applied by pressing the  or  key until the appropriate option highlights and then press the **Select** soft key.

The screen informs you whether call waiting is activated or deactivated.

2. You can activate or deactivate the call waiting feature as necessary by using the **Activate** or **Deactivate** soft key respectively.

To return to the previous screen, press the **Exit** soft key.



You can also deactivate all call waiting settings by selecting the **Cancel All** option.

Network Selection *(Menu 6.4)*

The Network Selection feature enables you to automatically or manually select the network used when roaming outside of your home area.



Note: You can select a network other than your home network only if it has a valid roaming agreement with your home network.

To indicate automatically or manually select the network when roaming:

1. When **Network Selection** displays, press the **Select** soft key.
2. Press the  or  key until the appropriate option highlights and then press the **OK** soft key.

If you select **Automatic**, you are connected to the first available network when roaming.

If you select **Manual**, the phone scans for the available networks. Go to Step 3.

3. Press the  or  key until the preferred network highlights and then press the **OK** soft key.

You are connected to that network.

Caller ID *(Menu 6.5)*

You can prevent your phone number from being displayed on the phone of the person being called.

Note: Some networks do not allow the user to change this setting.

The following options are available:

Default: the default setting provided by the network is used.

Hide Number: your number is not displayed on the other person's phone.

Send Number: your number is sent each time you make a call.

Closed User Group (CUG) *(Menu 6.6)*

This network service allows incoming and outgoing calls to be restricted to a selected user group. You may be a member of up to ten user groups. For details on how to create, activate and use a closed user group, contact your service provider.

Example: A company lends SIM cards to its employees and wants to restrict outgoing calls to members of the same team.

Activating a Closed User Group

If you select the **Closed User Group** menu, you can enter the CUG function. You can now access the following options after pressing the **Select** soft key.

Index List: lets you list, add or delete CUG index numbers. The list of current CUG indexes appears.

Add a new CUG index as advised by your service provider or delete a selected group.

To...	Press the...
scroll the through the existing CUG indexes	^ or v key.
add a new CUG index	Options soft key, select the Add option and enter the index.
delete a CUG index	Options soft key and select the Delete option.
activate a CUG index	Options soft key and select the Activate option.

Outside Access: lets you enable or disable calls to numbers other than those nominated for the Closed User Group. This feature depends on the nature of your CUG subscription. Please check with your service provider.

Default Group: you may communicate a default CUG to your service provider. If you have done so, you can enable the **Default Group** option on your phone. When making a call, you are given the option of using your default CUG, instead of selecting one from the list.

Deactivate: deactivates the CUG function. This menu appears only when the default group is enabled or a CUG index is selected.

Band Selection *(Menu 6.7)*

For the phone to make and receive phone calls, it must register with one of the available networks. Your phone can handle any of the following types of network:

- GSM 900
- GSM 1800
- Combined GSM 900/1800
- GSM 1900



The country where you purchased your phone determines the default band that it uses. When you travel abroad, you must remember to change to an appropriate band.

1. When **Band Selection** displays, press the **Select** soft key.
2. Press the ^ or v key until the appropriate option (**GSM 900/1800** or **GSM 1900**) highlights and press the **OK** soft key.

When you select a new band, your phone displays a confirmation message and then automatically searches for all of the available networks. Your phone registers with a preferred network within the selected band.

The **Funbox** menu contains several fun options.

Games *(Menu 7.1)*

You can enjoy three games with your phone. Scroll to the required game, using the  and  keys and press the **Select** soft key. For further details on the game, refer to the on-screen help.

WAP Browser *(Menu 7.2)*

Your phone is equipped with a WAP Browser to allow you to access and navigate the Wireless Web.

For further details on the **WAP Browser** menu, refer to the WAP Browser User's Manual supplied with your phone.

Downloads *(Menu 7.3)*

You can download MIDlets (Java applications running on mobile phones) from various sources using the WAP Browser and store them in your phone. You can view the list of MIDlets stored on the Games & More screen.

Note: Java services may be unavailable depending upon the service provider.

Games & More

This menu option allows you to launch a MIDlet and access various menu options.

For more details on how to download MIDlets in the WAP Browser, refer to the WAP Browser User's Manual supplied with your phone.

Launching a MIDlet

To launch a MIDlet:

1. From the Downloads screen, select the Games & More option.
2. Scroll to the desired MIDlet and press the **Launch** soft key.

Using the Menus

From the Main Screen press the **Menu** soft key to access the following options.

Info*: displays information about the selected MIDlet, such as the file size, application version, vendor, and the location of the jad file, which is the MIDlet description file.

Remove*: removes the selected MIDlet. When the confirmation message appears, press the **Remove** soft key. To cancel your selection, press the **Cancel** soft key.

Update*: accesses the server and updates the selected MIDlet.

Entering Text

When entering URL addresses, the following five input modes are available.

ABC: allows you to enter upper-case English characters.

abc: allows you to enter lower-case English characters.

123: allows you to enter numbers.

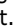
Sym: allows you to enter symbols. After highlighting the required symbol by pressing the navigation keys, press the  key to insert it.

* Shown only when a MIDlet has been downloaded.

: allows you to enter English characters using the T9 mode. For details about this mode, see page 46.

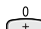
Note: To change case, press the  key.

To change the text input mode, press the  key until the appropriate indicator appears on the soft key area of the display.

Sounds

In this menu, you can view the list of sounds downloaded from the server. You can set the downloaded sounds as the current ring tone, but cannot send the sounds to other phones.

When the memory is full, a warning message displays and the phone rejects additional sounds until you erase obsolete ones.

Pictures

In this menu, you can view the list of pictures downloaded from the server. You can set the downloaded pictures as the current background image, but cannot send them to other phones.

When the memory is full, a warning message displays and the phone rejects additional pictures until you erase obsolete ones.

DNS Setting

The DNS (Domain Name Server) address of the Java server is preset at the factory, but sometimes you may need to change it. In this menu, you can determine whether the address is automatically updated or not.

Automatic: the server automatically transmit the address to the phone if it is changed.

Manual: you can manually change the address.

Solving Problems

Before contacting the after-sales service, perform the following simple checks. They may save you the time and expense of an unnecessary service call.

When you switch your phone on, the following messages may appear

Insert SIM Card

- Check that the SIM card is correctly installed.

Phone Locked Enter Password

- The automatic locking function has been enabled. You must enter the phone's password before you can use the phone.

Enter PIN

- You are using your phone for the first time. You must enter the Personal Identification Number supplied with the SIM card.
- The option requiring that the PIN be entered each time the phone is switched on was enabled. You must enter your PIN and then disable this option if so required.

Enter PUK

- The PIN code was entered wrongly three times in succession and the phone is now blocked. Enter the PUK supplied by your network operator.

“No service,” “Network failure” or “Not done” is displayed

- The network connection was lost. You may be in a weak signal area (in a tunnel or surrounded by buildings). Move and try again.
- You are trying to access an option for which you have not taken out a subscription with your service provider. Contact the service provider for further details.

You have entered a number but it was not dialled

- Have you pressed the  key?
- Are you accessing the right cellular network?
- You may have set an outgoing call barring option.

Your correspondent cannot reach you

- Is your phone switched on (the  key pressed for more than one second)?
- Are you accessing the right cellular network?
- You may have set an incoming call barring option.



Your correspondent cannot hear you speaking

- Have you switched off the microphone?
- Are you holding the phone close enough to your mouth? The microphone is located at the bottom of the phone.

The phone starts beeping and “Warning** Low Battery” flashes on the display**

- The battery is insufficiently charged. Replace the battery and recharge it.

The audio quality of the call is poor

- Check the signal strength indicator on the display (); the number of bars indicates the signal strength from strong () to weak ().
- Try moving the phone slightly or moving closer to a window if you are in a building.

No number is dialled when you recall a Phonebook entry

- Check that the number has been stored correctly, by using the Phonebook Search feature.
- Re-store the number, if necessary.

If the above guidelines do not enable you to solve the problem, take a note of:

- The model and serial numbers of your phone
- Your warranty details
- A clear description of the problem

Then contact your local dealer or Samsung after-sales service.

Access Codes

There are several access codes that are used by your phone and its SIM card. These codes help you protect the phone against unauthorised use.

When requested for any of the codes explained below, key in the appropriate code (displayed as asterisks) and press the **OK** soft key. If you make a mistake, press the  key one or more times until the incorrect digit is cleared and then continue entering the correct code.

The access codes, except for the PUK and PUK2 codes can be changed using **Security** menu options (**Menu 4.6**). See page 81 for further details.

Important! Avoid using access codes resembling emergency numbers, such as 112, so that you do not dial an emergency number accidentally.

Phone Password

The Phone Lock feature uses the phone password to protect your phone against unauthorised use. The phone password is supplied with the phone and is preset to 00000000 at the factory.

To...	Refer to...
activate/deactivate the Phone Lock feature	Page 82 (Menu 4.6.3).
change the phone password	Page 82 (Menu 4.6.4).

PIN

The **P**ersonal **I**dentification **N**umber or PIN (4 to 8 digits) protects your SIM card against unauthorised use. It is usually supplied with the SIM card.

If you enter an incorrect PIN three times in succession, the code is disabled and cannot be used until you re-enable it by entering the PUK (see below).

To...	Refer to...
activate/deactivate the PIN Check feature	Page 81 (Menu 4.6.1).
change the PIN	Page 82 (Menu 4.6.2).

PUK

The 8-digit PUK (**P**ersonal **U**nblocking **K**ey) is required to change a disabled PIN. The PUK may be supplied with the SIM card. If not, or you have lost it, contact your service provider.

To re-enable your PIN:

1. Key in the PUK and press the **OK** soft key.
2. Enter a new PIN of your choice and press the **OK** soft key.
3. When the **Confirm New PIN** message displays, key in the same code again and press the **OK** soft key.

If you enter an incorrect PUK ten times in succession, the SIM card becomes invalid. Contact your service provider for a new card.

PIN2

The PIN2 (4 to 8 digits), supplied with some SIM cards, is required to access specific functions, such as setting the maximum cost of a call. These functions are available if supported by your SIM card.

If you enter an incorrect PIN2 three times in succession, the code is disabled and you cannot access the functions until you re-enable it by entering the PUK2.

To change the PIN2, refer to page 83 (**Menu 4.6.7**).

PUK2

The 8-digit PUK2 (**P**ersonal **U**nblocking **K**ey **2**), supplied with some SIM cards, is required to change a disabled PIN2. If you lose the code, contact your service provider.

To re-enable your PIN2:

1. Key in the PUK2 and press the **OK** soft key.
2. Enter a new PIN2 of your choice and press the **OK** soft key.
3. When the **Confirm PIN2** message displays, key in the same code again and press the **OK** soft key.

If you enter an incorrect PUK2 ten times in succession, you will not be able to access the functions requiring the PIN2. Contact your service provider for a new card.

Barring Password

The 4-digit barring password is required when you use the Call Barring function. You obtain the password from your service provider when you subscribe to this function. See page 101 for further details.

Health and Safety Information

Exposure to Radio-Frequency Energy (SAR Information)

This phone meets European Union (EU) requirements concerning exposure to radio waves.

Your mobile phone is a radio transmitter and receiver. It is designed and manufactured, so as not to exceed the limits for exposure to radio-frequency (RF) energy, as recommended by the EU Council. These limits are part of comprehensive guidelines and establish permitted levels of RF energy for the general population. The guidelines were developed by independent scientific organisations through periodic and thorough evaluation of scientific studies. The limits include a substantial safety margin designed to ensure the safety of all persons, regardless of age and health.

The exposure standard for mobile phones employs a unit of measurement known as SAR (Specific Absorption Rate). The SAR limit recommended by the EU Council is 2.0W/kg.*

SAR tests are conducted using standard operating positions with the phone transmitting at its highest certified power level in all tested frequency bands. Although the SAR is determined at the highest certified power level, the actual SAR level of the phone while operating can be well below the maximum value. This is because the phone is designed to operate at multiple power levels so as to use only the power required to reach the network. In general, the closer you are to a base station, the lower the power output of the phone.

The highest SAR value for this model phone when tested for compliance against the standard was 1.440 W/kg. While there may be differences between the SAR levels of various phones and various positions, they all meet the EU requirements for RF exposure.

* The SAR limit for mobile phones used by the public is 2.0 watts/kilogram (W/kg) averaged over ten gram of body tissue. The limit incorporates a substantial margin of safety to give additional protection for the public and to account for any variations in measurements. The SAR values may vary depending on national reporting requirements and the network band.

Precautions When Using Batteries

Your phone is powered by a rechargeable Li-ion standard battery.

- Never use any charger or battery that is damaged in any way.
- Use the battery only for its intended purpose.
- If you use the phone near the network's base station, it uses less power; talk and standby time are greatly affected by the signal strength on the cellular network and the parameters set by the network operator.
- Battery charging time depends on the remaining battery charge and the type of battery and charger used. The battery can be charged and discharged hundreds of times, but it will gradually wear out. When the operation time (talk time and standby time) is noticeably shorter than normal, it is time to buy a new battery.
- If left unused, a fully charged battery will discharge itself over time.
- Use only Samsung-approved batteries and recharge your battery only with Samsung-approved chargers. When a charger is not in use, disconnect it from the power source. Do not leave the battery connected to a charger for more than a week, since overcharging may shorten its life.
- Extreme temperatures will affect the charging capacity of your battery: it may require cooling or warming first.

- Do not leave the battery in hot or cold places, such as in a car in summer or winter conditions, as you will reduce the capacity and life-time of the battery. Always try to keep the battery at room temperature. A phone with a hot or cold battery may temporarily not work, even when the battery is fully charged. Li-ion batteries are particularly affected by temperatures below 0 °C (32 °F).
- Do not short-circuit the battery. Accidental short circuiting can occur when a metallic object (coin, clip or pen) causes a direct connection between the + and - terminals of the battery (metal strips on the battery), for example when you carry a spare battery in a pocket or bag. Short-circuiting the terminals may damage the battery or the object causing the short-circuit.
- Dispose of used batteries in accordance with local regulations. Always recycle. Do not dispose of batteries in a fire.

Road Safety

Your wireless phone gives you the powerful ability to communicate by voice, almost anywhere, anytime. But an important responsibility accompanies the benefits of wireless phones, one that every user must uphold.

When driving a car, driving is your first responsibility. When using your wireless phone behind the wheel of a car, practice good common sense and remember the following tips.

1. Get to know your wireless phone and its features, such as speed dial and redial. If available, these features help you to place your call without taking your attention off the road.
2. When available, use a hands-free device. If possible, add an extra layer of convenience and safety to your wireless phone with one of the many hands-free accessories available today.
3. Position your wireless phone within easy reach. Be able to access your wireless phone without removing your eyes from the road. If you get an incoming call at an inconvenient time, let your voice mail answer it for you.
4. Let the person you are speaking with know you are driving; if necessary, suspend the call in heavy traffic or hazardous weather conditions. Rain, sleet, snow, ice and even heavy traffic can be hazardous.
5. Do not take notes or look up phone numbers while driving. Jotting down a To Do list or flipping through your Phonebook takes your attention away from your primary responsibility, driving safely.
6. Dial sensibly and assess the traffic; if possible, place calls when you are not moving or before pulling into traffic. Try to plan calls when your car will be stationary. If you need to make a call while moving, dial only a few numbers, check the road and your mirrors, then continue.
7. Do not engage in stressful or emotional conversations that may be distracting. Make the people with whom you are talking aware that you are driving and suspend conversations that have the potential to divert your attention from the road.
8. Use your wireless phone to call for help. Dial the emergency number in the case of fire, traffic accident or medical emergencies. Remember, it is a free call on your wireless phone!
9. Use your wireless phone to help others in emergencies. If you see a car accident, crime in progress or other serious emergency where lives are in danger, call the emergency number, as you would want others to do for you.
10. Call roadside assistance or a special non-emergency wireless assistance number when necessary. If you see a broken-down vehicle posing no serious hazard, a broken traffic signal, a minor traffic accident where no one appears injured, or a vehicle you know to be stolen, call roadside assistance or any other special non-emergency wireless number.

Operating Environment

Remember to follow any special regulations in force in any area and always switch off your phone whenever it is forbidden to use it, or when it may cause interference or danger.

When connecting the phone or any accessory to another device, read its user's guide for detailed safety instructions. Do not connect incompatible products.

As with other mobile radio transmitting equipment, users are advised that for the satisfactory operation of the equipment and for the safety of personnel, it is recommended that the equipment should only be used in the normal operating position (held to your ear with the antenna pointing over your shoulder).

Electronic Devices

Most modern electronic equipment is shielded from radio frequency (RF) signals. However, certain electronic equipment may not be shielded against the RF signals from your wireless phone. Consult the manufacturer to discuss alternatives.

Pacemakers

Pacemaker manufacturers recommend that a minimum distance of 15 cm (6 inches) be maintained between a wireless phone and a pacemaker to avoid potential interference with the pacemaker. These recommendations are consistent with the independent research and recommendations of Wireless Technology Research.

Persons with pacemakers:

- Should always keep the phone more than 15 cm (6 inches) from their pacemaker when the phone is switched on
- Should not carry the phone in a breast pocket
- Should use the ear opposite the pacemaker to minimise potential interference

If you have any reason to suspect that interference is taking place, switch off your phone immediately.

Hearing Aids

Some digital wireless phones may interfere with some hearing aids. In the event of such interference, you may wish to consult your hearing aid manufacturer to discuss alternatives.

Other Medical Devices

If you use any other personal medical devices, consult the manufacturer of your device to determine if it is adequately shielded from external RF energy. Your physician may be able to assist you in obtaining this information. Switch off your phone in health care facilities when any regulations posted in these areas instruct you to do so. Hospitals or health care facilities may be using equipment that could be sensitive to external RF energy.

Vehicles

RF signals may affect improperly installed or inadequately shielded electronic systems in motor vehicles. Check with the manufacturer or its representative regarding your vehicle.

You should also consult the manufacturer of any equipment that has been added to your vehicle.

Posted Facilities

Switch off your phone in any facility where posted notices require you to do so.

Potentially Explosive Atmospheres

Switch off your phone when in any area with a potentially explosive atmosphere and obey all signs and instructions. Sparks in such areas could cause an explosion or fire resulting in bodily injury or even death.

Users are advised to switch off the phone while at a refuelling point (service station). Users are reminded of the need to observe restrictions on the use of radio equipment in fuel depots (fuel storage and distribution areas), chemical plants or where blasting operations are in progress.

Areas with a potentially explosive atmosphere are often but not always clearly marked. They include below deck on boats, chemical transfer or storage facilities, vehicles using liquefied petroleum gas (such as propane or butane), areas where the air contains chemicals or particles, such as grain, dust or metal powders, and any other area where you would normally be advised to turn off your vehicle engine.

Emergency Calls

This phone, like any wireless phone, operates using radio signals, wireless and landline networks as well as user-programmed functions, which cannot guarantee connection in all conditions. Therefore, you should never rely solely on any wireless phone for essential communications (medical emergencies, for example).

Remember, to make or receive any calls the phone must be switched on and in a service area with adequate signal strength. Emergency calls may not be possible on all wireless phone networks or when certain network services and/or phone features are in use. Check with local service providers.

To make an emergency call, proceed as follows.

1. If the phone is not on, switch it on.
2. Key in the emergency number for your present location (for example, 112 or any other official emergency number). Emergency numbers vary by location.
3. Press the  key.

If certain features are in use (call barring, for example), you may first need to deactivate those features before you can make an emergency call. Consult this document and your local cellular service provider.

When making an emergency call, remember to give all the necessary information as accurately as possible. Remember that your phone may be the only means of communication at the scene of an accident; do not cut off the call until given permission to do so.

Other Important Safety Information

- Only qualified personnel should service the phone or install the phone in a vehicle. Faulty installation or service may be dangerous and may invalidate any warranty applicable to the device.
- Check regularly that all wireless phone equipment in your vehicle is mounted and operating properly.
- Do not store or carry flammable liquids, gases or explosive materials in the same compartment as the phone, its parts or accessories.
- For vehicles equipped with an air bag, remember that an air bag inflates with great force. Do not place objects, including both installed or portable wireless equipment in the area over the air bag or in the air bag deployment area. If wireless equipment is improperly installed and the air bag inflates, serious injury could result.
- Switch off your phone before boarding an aircraft. The use of wireless phones in aircraft may be dangerous to the operation of the aircraft, and is illegal.
- Failure to observe these instructions may lead to the suspension or denial of telephone services to the offender, or legal action, or both.

Care and Maintenance

Your phone is a product of superior design and craftsmanship and should be treated with care. The suggestions below will help you fulfill any warranty obligations and allow you to enjoy this product for many years.

- Keep the phone and all its parts and accessories out of the reach of small children's.
- Keep the phone dry. Precipitation, humidity and liquids contain minerals that will corrode electronic circuits.
- Do not touch the phone with a wet hand while it is charging. Doing so may cause an electric shock to you or damage to the phone.
- Do not use or store the phone in dusty, dirty areas, as its moving parts may be damaged.
- Do not store the phone in hot areas. High temperatures can shorten the life of electronic devices, damage batteries, and warp or melt certain plastics.
- Do not store the phone in cold areas. When the phone warms up to its normal operating temperature, moisture can form inside the phone, which may damage the phone's electronic circuit boards.
- Do not drop, knock or shake the phone. Rough handling can break internal circuit boards.
- Do not use harsh chemicals, cleaning solvents or strong detergents to clean the phone. Wipe it with a soft cloth slightly dampened in a mild soap-and-water solution.

- Do not paint it. Paint can clog the device's moving parts and prevent proper operation.
- Use only the supplied or an approved replacement antenna. Unauthorised antennas or modified accessories may damage the phone and violate regulations governing radio devices.
- If the phone, battery, charger or any accessory is not working properly, take it to your nearest qualified service facility. The personnel there will assist you, and if necessary, arrange for service.

Glossary

To help you understand the main technical terms and abbreviations used in this booklet and take full advantage of the features on your mobile phone, here are a few definitions.

Active Folder

Ability to answer a call simply by opening the phone.

Call Barring

Ability to restrict outgoing and incoming calls.

Call Diverting

Ability to reroute calls to another number.

Call Holding

Ability to put one call on standby while answering or making another call; you can then switch between the two calls, as required.

Call Waiting

Ability to inform users that they have an incoming call when engaged on another call.

GPRS (General Packet Radio Service)

New non-voice value-added service that allows information to be sent and received across a mobile telephone network. GPRS guarantees continuous connection to the Internet for mobile phone and computer users. It is based on the Global System for Mobile Communication (GSM) circuit-switched cellular phone connections and the Short Message Service (SMS).

GSM (Global System for Mobile Communication)

International standard for cellular communication, guaranteeing compatibility between the various network operators. GSM covers most European countries and many other parts of the world.

Java

Programming language generating applications that can run on all hardware platforms, whether small, medium or large, without modification. It has been promoted for and geared heavily to the Web, both for public Web sites and Intranets. When a Java program runs from a Web page, it is called a *Java applet*. When it is run on a mobile phone or pager, it is called a *MIDlet*.

Line Identification Services (Caller ID)

Services allowing subscribers to view or block the telephone numbers of callers.

Multiparty Calling

Ability to establish a conference call involving up to five additional parties.

Phone Password

Security code used to unlock the phone when you have selected the option to lock it automatically each time it switches on.

PIN (Personal Identification Number)

Security code that protects the phone against unauthorised use. The PIN is supplied by the service provider with the SIM card. It may be a four to eight-digit number and can be changed, as required.

PUK (PIN Unblocking Key)

Security code used to unlock the phone when an incorrect PIN has been entered three times in succession. The eight-digit number is supplied by the service provider with the SIM card.

Roaming

Use of your phone when you are outside your home area (when travelling for example).

SDN (Service Dialling Numbers)

Telephone numbers supplied by your network provider and giving access to special services, such as voice mail, directory inquiries, customer support and emergency services.



SIM (Subscriber Identification Module)

Card containing a chip with all the information required to operate the phone (network and memory information, as well as the subscriber's personal data). The SIM card fits into a small slot on the back of the phone and is protected by the battery.

SMS (Short Message Service)

Network service sending and receiving messages to and from another subscriber without having to speak to the correspondent. The message created or received can be displayed, received, edited or sent.

Soft Keys

Two keys marked  and  on the phone, the purpose of which:

- Varies according to the function that you are currently using
- Is indicated on the bottom line of the display just above the corresponding key

Tri Band

Ability to handle any of the following types of network: GSM 900, GSM 1800, combined GSM 900/1800 and GSM 1900 MHz bands, for greater call success and wider roaming.

Your phone automatically searches for the last network used. If, for any reason, this network is unavailable, your phone will attempt to register with a different network.

Voice Mail

Computerised answering service that automatically answers your calls when you are not available, plays a greeting (optionally in your own voice) and records a message.

Index

A

Access codes • 112
 Accessories • 9
 Active folder • 86
 Alarm (5.4) • 94
 Alert type (3.3) • 75
 Answering
 a call • 27
 a second call • 53
 Anykey Answer • 86
 Auto light • 85
 Auto power alarm • 94
 Auto redial (4.5) • 86

B

Background image • 79
 Backlight • 15, 84
 Band selection (6.7) • 105
 Barring
 calls (6.2) • 99
 password • 101, 115
 Battery
 charging • 19
 low battery indicator
 • 22
 precautions • 118
 Battery charger • 21
 Broadcast (1.5) • 68

C

Calculator (5.5) • 95
 Calendar (5.1) • 88
 Caller
 ID (6.5) • 103
 Calls
 answering
 a call • 27
 a second call • 53
 barring (6.2) • 99
 cost (2.5) • 73
 dialled (2.3) • 72
 diverting (6.1) • 97
 emergency • 125
 ending • 25

holding • 50
 international • 24
 making • 24
 missed • 28, 71
 multiparty • 54
 received (2.2) • 71
 records (2) • 71
 redialling automatically
 • 86
 time (2.4) • 72
 via phonebook • 39
 waiting (6.3) • 53, 101
 Card
 installing the SIM • 17
 Care • 127
 Changing
 barring password • 101
 password (4.6.4) • 82
 PIN (4.6.2) • 82
 PIN2 (4.6.7) • 83
 Characters
 changing mode • 45
 entering • 44
 Charging battery • 19
 Closed User Group (6.6)
 • 103
 Colour Theme • 79
 Conference call • 54
 Connect
 to voice server • 69
 tone • 77
 Contrast (4.7.1) • 84
 Copying
 memos • 90
 phonebook number • 38
 task • 92
 Correcting numbers • 24
 Cost of call • 73
 CUG • 103
 Currency exchange (5.6)
 • 96

D

Date setting (5.3.2) • 93

Deleting

memos • 90
 messages • 63
 missed calls • 29
 phonebook number • 38
 tasks • 92
 Dialled calls (2.3) • 72
 Display
 contrast • 84
 icons • 14
 layout • 13
 setting language • 81
 Diverting calls (6.1) • 97
 Downloads (7.3) • 106

E

Earpiece volume • 26
 Editing
 memos • 89
 messages • 63
 missed calls • 29, 71
 phonebook number • 38
 tasks • 92
 to do list • 91
 Emergency calls • 125
 Error tone • 77

F

FDN mode (4.6.6) • 83
 Fixed Dial Number mode • 83
 Fun Box (7) • 106
 Functions
 selecting • 31

G

Game (7.1) • 106
 Greeting message (4.3) • 80
 Groups
 user • 103

H

Holding calls • 50

I

Icons
 description • 14
 Identifying a caller • 27
 Infrared Activate (4.1) • 78
 Internet • 106
 IrDA port • 78

K

Key tones
 adjusting volume • 26
 muting • 52
 selecting (3.4) • 75
 sending • 52
 Keypad tone (3.4) • 75
 Keys
 description • 11
 location • 10
 shortcut • 87

L

Language (4.5) • 81
 Last number, redial • 25
 Length of calls • 72, 77
 Letters
 changing mode • 45
 entering • 44
 Light
 backlight • 15, 84
 service • 16, 85
 Locking
 phone (4.6.3) • 82
 SIM card (4.6.5) • 83
 Low battery indicator • 22
 Lower-case characters
 entering • 47

M

Maintenance • 127
 Memory status
 message (1.8) • 70
 phonebook • 43

Memos
 copying • 90
 deleting • 90
 editing • 89
 writing • 89

Menus
 accessing by scroll • 56
 accessing by shortcuts
 • 57
 list • 57

Message tone (3.5) • 76

Messages
 broadcast (1.5) • 68
 reading (1.1) • 62
 setup (1.4) • 66
 templates (1.3) • 66
 voice mail (1.6) • 69
 writing (1.2) • 64

Microphone mute • 51

Minute minder • 77

Missed calls (1.1) • 28, 71

Morning call • 94

Multiparty calls
 dropping • 55
 making • 54
 private conversation
 • 54

Muting
 key tones • 52
 microphone • 51

My contents (1.7) • 70

N

Names
 entering • 44
 searching/dialling • 39
 storing • 35

Network selection (6.4)
 • 102

Network services (7) • 97

Numbers
 copying phonebook • 38
 correcting • 24
 erasing • 38
 fixed dial • 83
 own • 80
 pasting phonebook • 38
 searching/dialling • 39
 storing • 35

O

Options
 selecting • 31

Organiser (5) • 88

Own number (4.4) • 80

P

Password
 barring
 changing • 101
 code • 115
 phone
 changing • 82
 code • 112

Phone
 lock (4.6.3) • 82
 password • 112
 settings (4) • 78

Phonebook
 copying • 38
 editing • 38
 erasing • 38
 options • 37
 pasting • 38
 searching/dialling • 39
 speed-dialling • 42
 storing numbers/names
 • 35

PIN
 changing • 82
 checking • 81
 code • 113

PIN2

 changing • 83
 code • 114

Problem solving • 109

PUK • 113

PUK2 • 114

R

Read messages (1.1) • 62

Received calls (2.2) • 71

Redialling
 automatically • 86
 last number • 25

Reset setting (4.10) • 87

Ring

tone (3.1) • 74
 type (3.3) • 75
 volume (3.2) • 74

Roaming • 102

S

Safety
 information • 116
 precautions • 7

Schedule • 88

Searching in phonebook • 39

Security (6) • 97

Selecting functions/options
 • 31

Sending
 key tones • 52
 messages • 64

Service light • 16, 85

Setting
 alarm (5.4) • 94
 date (5.3.2) • 93
 language (4.5) • 81
 time (5.3.1) • 93

Shortcut (4.9) • 87

Silent mode • 31

SIM card
 installing • 17
 locking • 83

SIM Lock (4.6.5) • 83

SMS
 message icon • 62
 setup • 66
 using • 53, 62

Soft keys • 31

Solving problems • 109

Sound settings (3) • 74

Speed-dialling • 42

Switching on/off
 microphone • 51
 phone • 23

T

T9 mode • 46

Tasks
 defining • 90
 editing • 91

Templates (2.3) • 66

Text
 changing mode • 45
 entering • 44

Time

 call • 72
 format (5.3.4) • 93
 setting (5.3.1) • 93
 world (5.3.3) • 93

To do list (5.2) • 90

Tone

 connect • 77
 error • 77
 keypad • 75
 message • 76
 ring • 74

Travel adapter • 19

U

Unpacking • 9

Upper-case characters
 entering • 47

User group • 103

V

Vibration • 75

Voice mail (1.6) • 69

Voice server • 69

Volume
 adjusting • 26
 selecting the ring • 74

W

Waiting call • 53, 101

WAP Browser (7.2) • 106

World time (5.3.3) • 93

Write messages (2.2) • 64

Writing memos • 89









Tri Band SGH-S200 GPRS Telephone Quick Reference Card

Access the Menu Functions	<ol style="list-style-type: none"> ① Press the Menu soft key. ② Scroll with the ▲ and ▼ keys through the list of the menus until you reach the required menu. ③ Press the Select soft key. ④ Scroll with the ▲ and ▼ keys through the list of the options until the required one is selected. ⑤ Press the Select soft key.
---------------------------	--

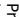
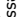
- Each of the two soft keys (**☐** and **☐**) perform the function indicated by the text above it (bottom line on the display).

Switch On/Off	Press and hold the ☐ key.
Make a Call	<ol style="list-style-type: none"> ① Key in the number. ② Press the ☐ key.
End a Call	Briefly press the ☐ key.
View Missed Calls Immediately After Missing Them	<ol style="list-style-type: none"> ① Open the phone and press the View soft key. ② Scroll with the ▲ and ▼ keys through the missed calls. ③ To return the call, press the ☐ key.

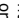

Answer a Call	Open the phone or Press the  key.	Store Numbers in the Phonebook	<ol style="list-style-type: none"> ① Key in the number. ② Press the Save soft key. ③ Select an icon for label. ④ Press the Select soft key. ⑤ Enter the name. ⑥ Press the OK soft key. ⑦ If necessary, change the location. ⑧ Press the OK soft key. ⑨ Press the  key to return to idle mode.
Adjust the Volume	Press the  or  key on the left side of the phone.		
Choose the Alert Type	<ol style="list-style-type: none"> ① Select the Alert Type menu option (3.3). ② Select an option: <ul style="list-style-type: none"> • Light only • Melody • Vibration • Vibra+Melody ③ Press the Select soft key. 	Search for a Number in the Phonebook	<ol style="list-style-type: none"> ① Press the Name soft key. ② Select the Search option. ③ Enter the start of the name. ④ To scroll through the names, press the  or  key. ⑤ Press the View soft key. ⑥ To scroll through the numbers, press the  or  key. ⑦ Press the  key to dial.

* Some of the contents in this manual may differ from your phone,
depending on the software installed or your service provider.



SGH-S200

WAP Browser

User's Manual



Printed in Korea

Code No.: GH68-xxxxxA

English. 10/2002. Rev. 1.0

World Wide Web

<http://www.samsungmobile.com>



What is WAP?

WAP (Wireless Application Protocol) is the gateway to a new world of mobile data. It provides a universal standard, enabling you to access Web-based interactive information services and applications directly from your mobile phone.

Contents

About the WAP Browser	4
Setting Up the WAP Browser	5
Accessing the WAP Browser	5
Configuring the WAP Browser	7
Getting Started	10
Starting the WAP Browser	10
Exiting the WAP Browser	10
Using the WAP Browser	11
Using the Soft Keys	11
Navigating the WAP Browser	11
Entering Text, Numbers or Symbols	12
Using the WAP Browser Menus	13
Using and Selecting Menu Options	13
Reload	13
Home	13
Go to URL	14
Show URL	14
Edit Home	15



About the WAP Browser



Your phone comes equipped with a WAP (Wireless Application Protocol) Browser which makes it possible for you to access the Wireless Web.

The WAP Browser allows you to:

- access up-to-the-minute information via your phone
- view specially designed text versions of popular Internet sites including Yahoo!®, CNN MobileSM and the Weather Channel®

Browsing the Wireless Web using your phone is unlike using your computer, in that site providers have:

- selected only the critical aspects of their site for wireless phone users
- removed most graphics

Each time you start the WAP Browser, the phone connects to the Wireless Web and the service indicator icon ( or ) appears on the display to inform you that you are:

- are connected to the Wireless Web
- will be billed accordingly (rates vary according to your service option)

The WAP Browser ends the network connection after a certain period of inactivity and automatically reconnects as necessary. For this reason, you may find that you are billed for several network connections within a single session. This is normal and is designed to minimise your bill.

Setting Up the WAP Browser



Before using the WAP Browser, you must set the parameters for the proxy server used by your service provider.

Accessing the WAP Browser

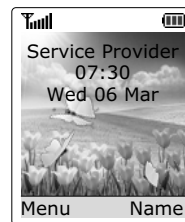

To access the WAP Browser menu:

1. When the idle screen displays, press the **Menu** soft key to enter menu mode.





2. Press the  or  key one or more times until the **Funbox** menu option displays, and then press the **Select** soft key. You can also press the  key directly.

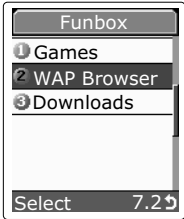

3. Press the  or  key one or more times to highlight **WAP Browser**, and then press the **Select** soft key. You can also press the  key directly.



4. Press the  or  key one or more times to highlight the required option and then press the **Select** soft key.

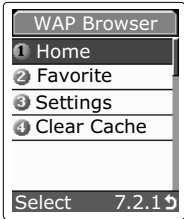





Option	Description
Home	Connects the phone to the network and loads the homepage of the Wireless Web service provider.
Favorite	Allows you to store the URL addresses of your favourite Web sites. You can access this menu directly by pressing and holding down the  key while using the WAP Browser.

Option	Description
Favorite (continued)	To store a URL address, select an empty location and enter the address. Three submenus are available. Select Goto URL to access the site quickly, Edit to edit the selected address and Erase to delete the selected address.
Settings	Allows you to set up five proxy servers for the WAP Browser.
Clear	Clears the information stored in the cache (the phone's temporary memory used to store the most recently accessed Web pages).

Configuring the WAP Browser

To configure the WAP Browser:

1. In the WAP Browser menu, highlight **Settings** using the  and  keys, and then press the **Select** soft key. You can also press the  key directly.
2. Select a proxy server and enter the parameters required. Contact your service provider for details.

Parameter	Description
Profile Name	Name that you wish to assign to the HTTP proxy server.
Homepage URL	Address of your startup homepage. When the default homepage displays, you can delete it using the  key and enter your own choice.

Parameter	Description
Security	Data transmission mode. Choose Secure to protect your data against unauthorised access; otherwise, choose Non-Secure .
IP Address	WAP gateway address required to connect to the Internet.
Bearer	Bearer to be used for each type of network address accessed: GPRS or Data .

The remaining options depend on the **Bearer** setting, as indicated below.

*When the bearer is set to **Data***

Parameter	Description
Login Name	PPP server login ID.
Password	PPP server password.
Dial-up Number	PPP server phone number.
Data Call Type	Data call type: Analogue or ISDN .

*When the bearer is set to **GPRS***



Parameter	Description
User Name	User ID required to connect to the GPRS network.
Password	Password required to connect to the GPRS network.
APN	Access point name used for the address of the GPRS network gateway.

Note: The WAP Browser settings may vary, depending on the service provider. Contact your service provider for more information.

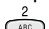

3. After selecting each of these settings, a dialogue box displays; you can either enter the information required or choose between given options. When you are satisfied with your input, press the **OK** soft key.
4. When you have finished configuring the WAP Browser, press the /ⓘ key or the right soft key.

Getting Started

Starting the WAP Browser

To start the WAP Browser when the idle screen displays, press the **i** key or press the **Menu** soft key, followed by the ,  and  keys.

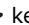
A connection is established with your service provider and the corresponding homepage displays.

The content of the WAP Browser startup homepage depends on your Wireless Web service provider. To scroll through the screen, use the  and  keys.



Note: To access the startup homepage from any other screen in the WAP Browser, use the **Home** option. For more information on the WAP Browser menus, refer to page 13.

Exiting the WAP Browser

To exit the browser at any time, simply press the /0 key or press and hold down the **i** key.

Using the WAP Browser

Using the Soft Keys

A bar containing browser commands is located at the bottom of the WAP Browser display. The soft keys   below the bar are used to execute these commands. The two keys are called soft keys because their function changes depending on the WAP Browser application in use.

Navigating the WAP Browser

To...



scroll through and select browser items

select a numbered item

return to the previous page

return to the startup homepage

Then...

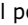
Press the  or  key until the  symbol points to the required item, and then press the **OK** soft key to confirm the selection.







Press the corresponding numeric key.

Press the **Back** soft key or the  key.

Select the **Home** menu option; for more information on this option, refer to page 13.

Entering Text, Numbers or Symbols

When you are prompted to enter text, the current text entry mode is indicated on the screen. The following modes are available:





Mode	Description
	Allows you to enter letters in the alphabet. Press the corresponding key until the required letter displays.
	Allows you to enter numbers.
Note:	To enter symbols, press the  key repeatedly until the required symbol displays.
To...	Then...
change modes	Press the  key one or more times.
enter a space	Press the  key.
edit text	<ul style="list-style-type: none">• Set the cursor to the right of the character(s) to be corrected.• Press the  key as required.• Enter the correct character(s).

Using the WAP Browser Menus

Using and Selecting Menu Options

Various menu options are available when you are using the WAP Browser to navigate the Wireless Web.

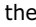
To access a menu option:

1. Press and hold down the  key.
A menu displays.
2. Highlight the required menu option by pressing the  and  keys.
3. Select the option by pressing the **Select** soft key.
4. If necessary, select the secondary option using the  and  keys, and press the **Select** soft key to confirm.

Note: The menus may vary, depending on your version of the WAP Browser.

Reload

This option reloads the current page.

Home

This option takes you back at any time to the homepage of the Wireless Web service provider.

Go to URL

This option allows you to manually enter the URL address of the required Web page.

After entering an address, press the **OK** soft key to go there directly.

Show URL

This feature displays the URL address of the site to which you are currently connected. It also enables you to declare the current site as the startup homepage.

To...

declare the current page as your startup homepage

set a bookmark for the current page

cancel your setting

Press the...

Option soft key, select the **Save to Home** option and press **Select**.

Option soft key, select the **Save to Bookmark** option and press **Select**.

Back soft key.

Edit Home

With this feature, you can change the startup homepage manually.

To change the homepage, enter the required URL and press the **OK** soft key.

For more information on entering text, numbers or symbols, refer to page 12.