



SGH-T899M

User Guide

About this manual

This device provides high quality mobile communication and entertainment using Samsung's high standards and technological expertise. This user manual is specially designed to detail the device's functions and features.

- Please read this manual before using the device to ensure safe and proper use.
- Descriptions are based on the device's default settings.
- Images and screenshots may differ in appearance from the actual product.
- Content may differ from the final product, or from software provided by service providers or carriers, and is subject to change without prior notice. For the latest version of the manual, refer to the Samsung website, www.samsung.com.
- Available features and additional services may vary by device, software, or service provider.
- Applications and their functions may vary by country, region, or hardware specifications. Samsung is not liable for performance issues caused by applications from any provider other than Samsung.
- Samsung is not liable for performance issues or incompatibilities caused by edited registry settings or modified operating system software. Attempting to customise the operating system may cause the device or applications to work improperly.
- Software, sound sources, wallpapers, images, and other media provided with this device are licensed for limited use. Extracting and using these materials for commercial or other purposes is an infringement of copyright laws. Users are entirely responsible for illegal use of media.
- You may incur additional charges for data services, such as messaging, uploading and downloading, auto-syncing, or using location services. To avoid additional charges, select an appropriate data tariff plan. For details, contact your service provider.
- Default applications that come with the device are subject to updates and may no longer be supported without prior notice. If you have questions about an application provided with the device, contact a Samsung Service Centre. For user-installed applications, contact service providers.
- Modifying the device's operating system or installing softwares from unofficial sources may result in device malfunctions and data corruption or loss. These actions are violations of your Samsung licence agreement and will void your warranty.

Instructional icons



Warning: situations that could cause injury to yourself or others



Caution: situations that could cause damage to your device or other equipment



Note: notes, usage tips, or additional information

Copyright

Copyright © 2012 Samsung Electronics

This guide is protected under international copyright laws.

No part of this guide may be reproduced, distributed, translated, or transmitted in any form or by any means, electronic or mechanical, including photocopying, recording, or storing in any information storage and retrieval system, without the prior written permission of Samsung Electronics.

Trademarks

- SAMSUNG and the SAMSUNG logo are registered trademarks of Samsung Electronics.
- Bluetooth® is a registered trademark of Bluetooth SIG, Inc. worldwide.
- Wi-Fi®, Wi-Fi CERTIFIED™, and the Wi-Fi logo are registered trademarks of the Wi-Fi Alliance.
- All other trademarks and copyrights are the property of their respective owners.

Table of Contents

Getting started

- 6 Device layout
- 7 Buttons
- 8 Package contents
- 9 Installing the SIM or USIM card and battery
- 12 Charging the battery
- 14 Inserting a memory card
- 16 Turning the device on and off
- 16 Holding the device
- 17 Locking and unlocking the device
- 17 Adjusting the volume
- 17 Switching to silent mode

Basics

- 18 Indicator icons
- 19 Using the touch screen
- 21 Rotating the screen
- 22 Start screen
- 22 Using applications
- 23 Applications screen
- 24 Help+Tips
- 24 Entering text
- 25 Connecting to a Wi-Fi network
- 26 Setting up accounts
- 27 Transferring files
- 28 Securing the device

- 28 Updating the device

Communication

- 29 Phone
- 32 People
- 34 Messaging
- 35 Email
- 36 ChatON

Web & network

- 37 Internet Explorer
- 38 Bluetooth

Media

- 40 Music+Videos
- 41 Camera
- 45 Photos
- 47 Live Wallpaper
- 47 Photo Editor
- 48 Now

Application & media stores

- 49 Store
- 50 Games
- 50 Music Hub

Utilities

- 51 OneNote
- 53 Calendar
- 54 Family Story
- 55 MiniDiary
- 56 Office
- 57 Alarms
- 58 Calculator
- 58 Wallet

Travel & local

- 59 Maps

Settings

- 60 About Settings
- 60 system
- 69 applications

Troubleshooting

Getting started

Device layout

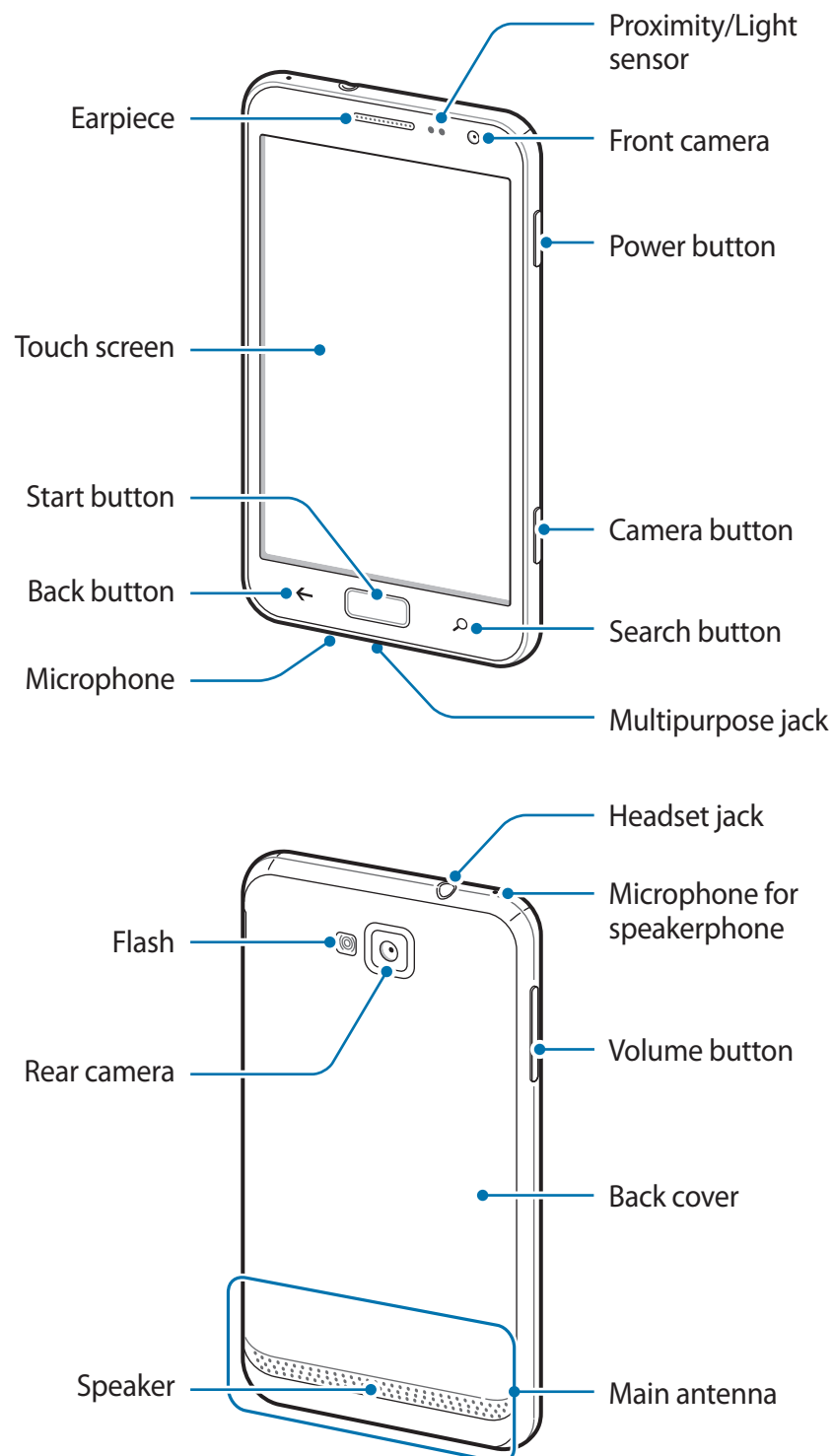







The microphone at the top of the device is active when you use the speakerphone.



- Do not cover the antenna area with your hands or other objects. This may cause connectivity problems or drain the battery.
- Do not use a screen protector. This causes sensor malfunctions.
- Do not allow water to contact the touch screen. The touch screen may malfunction in humid conditions or when exposed to water.

Buttons

Button	Function
 Power	<ul style="list-style-type: none"> • Press and hold to turn the device on or off. • Press and hold for 9-10 seconds to reset the device if it has fatal errors or hang-ups, or freezes. • Press to lock or unlock the device. The device goes into lock mode when the touch screen turns off.
 Back	<ul style="list-style-type: none"> • Tap to return to the previous screen.
 Start	<ul style="list-style-type: none"> • Press to return to the Start screen.
 Search	<ul style="list-style-type: none"> • Tap to launch Bing search.
 Volume	<ul style="list-style-type: none"> • Press to adjust the device volume.
 Camera	<ul style="list-style-type: none"> • Press to launch Camera.

Package contents

Check the product box for the following items:

- Device
- Battery
- Quick start guide



Use only Samsung-approved software. Pirated or illegal software may cause damage or malfunctions, which are not covered by the warranty.



- The items supplied with the device and any available accessories may vary depending on the region or service provider.
- The supplied items are designed only for this device and may not be compatible with other devices.
- Appearances and specifications are subject to change without prior notice.
- You can purchase additional accessories from your local Samsung retailer. Make sure they are compatible with the device before purchase.
- Other accessories may not be compatible with your device.
- Use only Samsung-approved accessories. Malfunctions caused by using unapproved accessories are not covered by the warranty service.
- Availability of all accessories is subject to change depending entirely on manufacturing companies. For more information about available accessories, refer to the Samsung website.

Installing the SIM or USIM card and battery

Insert the SIM or USIM card provided by the mobile telephone service provider, and the included battery.



Only microSIM cards work with the device.

1 Remove the back cover.

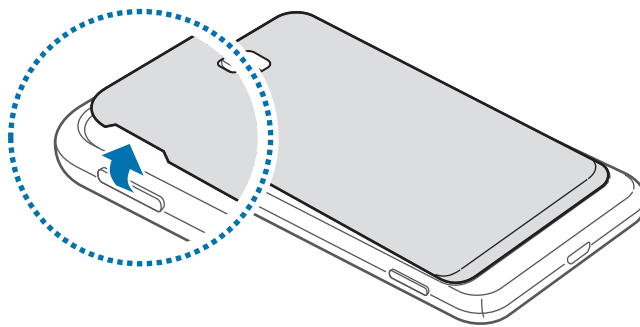

- Be careful not to damage your fingernails when you remove the back cover.
- Do not bend or twist the back cover excessively. Doing so may damage the cover.

2 Insert the SIM or USIM card with the gold-coloured contacts facing downwards.

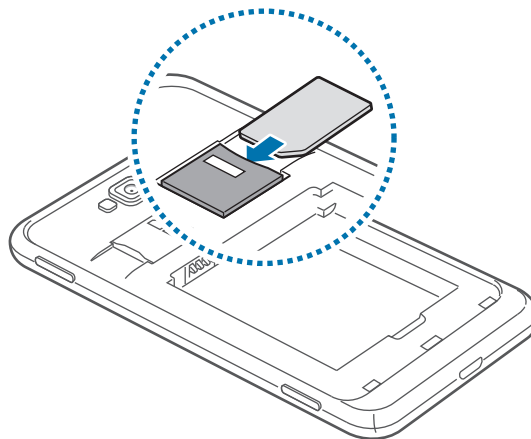

3 Push the SIM or USIM card into the slot until it locks in place.



- Do not insert a memory card into the SIM card slot. If a memory card happens to be lodged in the SIM card slot, take the device to a Samsung Service Centre to remove the memory card.
- Use caution not to lose or let others use the SIM or USIM card. Samsung is not responsible for any damages or inconveniences caused by lost or stolen cards.

4 Insert the battery.

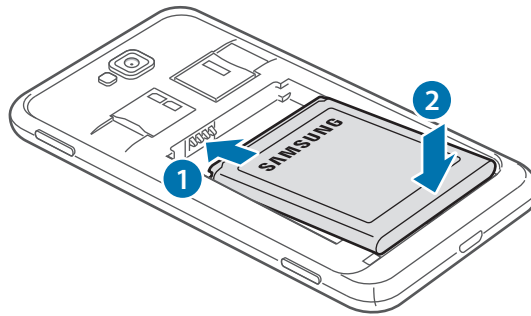

5 Replace the back cover.

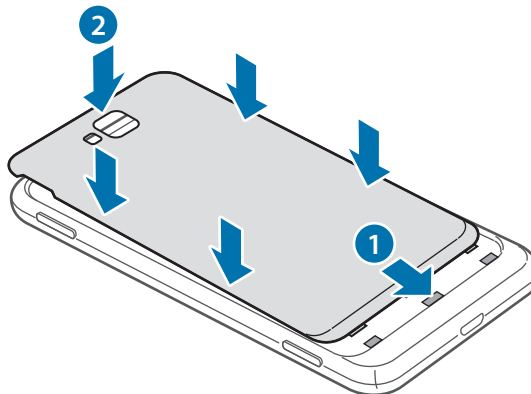

Removing the SIM or USIM card and battery

- 1 Remove the back cover.
- 2 Pull out the battery.

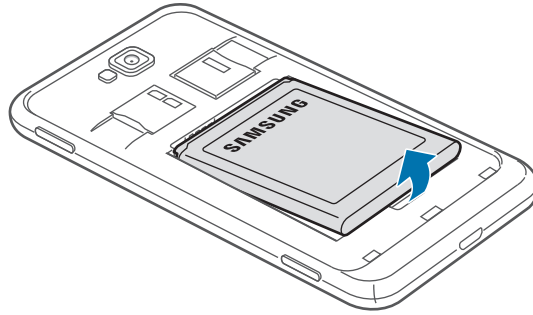

- 3 Push the SIM or USIM card until it disengages from the device, and then pull it out.

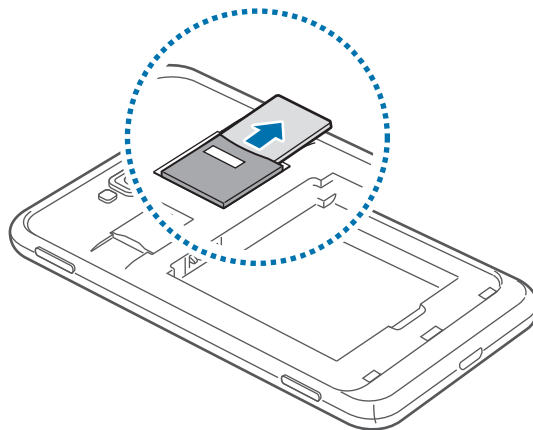

Charging the battery

Charge the battery before using it for the first time. Use the charger to charge the battery. A computer can be also used to charge the device by connecting them via the USB cable.



Use only Samsung-approved chargers, batteries, and cables. Unapproved chargers or cables can cause the battery to explode or damage the device.



- When the battery power is low, the device emits a warning tone and displays a low battery power message.
- If the battery is completely discharged, the device cannot be turned on immediately when the charger is connected. Allow a depleted battery to charge for a few minutes before turning on the device.

Charging with the charger

Plug the small end of the charger into the multipurpose jack of the device, and plug the large end of the charger into an electric socket.

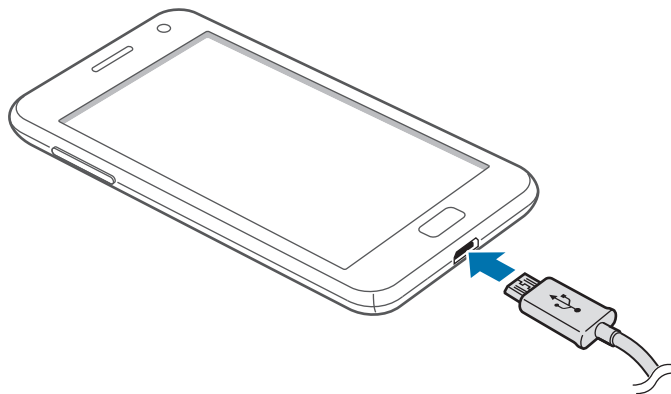



Connecting the charger improperly may cause serious damage to the device. Any damage caused by misuse is not covered by the warranty.



- The device can be used while it is charging, but it may take longer to fully charge the battery.
- If the device receives an unstable power supply while charging, the touch screen may not function. If this happens, unplug the charger from the device.
- While charging, the device may heat up. This is normal and should not affect the device's lifespan or performance. If the battery gets hotter than usual, the charger may stop charging.
- If the device is not charging properly, take the device and the charger to a Samsung Service Centre.

After fully charging, disconnect the device from the charger. First unplug the charger from the device, and then unplug it from the electric socket.



Do not remove the battery before removing the charger. This may damage the device.



To save energy, unplug the charger when not in use. The charger does not have a power switch, so you must unplug the charger from the electric socket when not in use to avoid wasting power. The device should remain close to the electric socket while charging.

Reducing the battery consumption

Your device provides options that help you save battery power. By customising these options and deactivating features in the background, you can use the device longer between charges:

- When you are not using the device, switch to sleep mode by pressing the Power button.
- Deactivate the Bluetooth feature.
- Deactivate the Wi-Fi feature.
- Deactivate auto-syncing of applications.
- Decrease the backlight time.
- Decrease the brightness of the display.

Inserting a memory card

Your device accepts memory cards with maximum capacities of 64 GB. Depending on the memory card manufacturer and type, some memory cards may not be compatible with your device.



- Some memory cards may not be fully compatible with the device. Using an incompatible card may damage the device or the memory card, or corrupt the data stored in it.
- Use caution to insert the memory card right-side up.



- The device supports the FAT and the exFAT file systems for memory cards. Format your memory card to one of these formats before using it in the device. When inserting a card formatted in a different file system, the device may not recognise the card.
- Frequent writing and erasing of data shortens the lifespan of memory cards.

- 1 Insert a memory card with the gold-coloured contacts facing downwards.
- 2 Push the memory card into the slot until it locks in place.

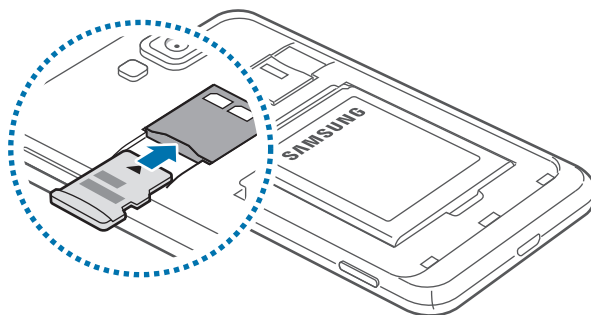

Removing the memory card

Before removing the memory card, first unmount it for safe removal. On the Start screen, scroll left, tap **Settings**, scroll to **system**, and then tap **phone storage** → **SD card** → **remove SD card** → **yes**.

Push the memory card until it disengages from the device, and then pull it out.



Do not remove the memory card while the device is transferring or accessing information. Doing so can cause data to be lost or corrupted or damage to the memory card or device. Samsung is not responsible for losses that result from the misuse of damaged memory cards, including the loss of data.

Formatting the memory card

A memory card formatted on a computer may not be compatible with the device. Format the memory card on the device.

On the Start screen, scroll left, tap **Settings**, scroll to **system**, and then tap **phone storage** → **SD card** → **format SD card** → **yes**.



Before formatting the memory card, remember to make backup copies of all important data stored on the device. The manufacturer's warranty does not cover loss of data resulting from user actions.

Turning the device on and off

When turning on the device for the first time, follow the on-screen instructions to set up your device.

Press and hold the Power button for a few seconds to turn on the device.

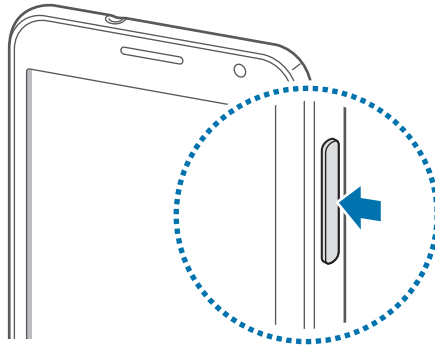

- Follow all posted warnings and directions from authorised personnel in areas where the use of wireless devices is restricted, such as aeroplanes and hospitals.
- On the Start screen, scroll left, tap **Settings**, scroll to **system**, and then tap **flight mode** to disable the wireless features.

To turn off the device, press and hold the Power button, and then drag the lock screen wallpaper down.

Holding the device

Do not cover the antenna area with your hands or other objects. This may cause connectivity problems or drain the battery.

Locking and unlocking the device

When not in use, lock the device to prevent unwanted operation. Pressing the Power button turns off the screen and puts the device into lock mode. The device automatically gets locked if it is not used for a specified period.

To unlock the device, press the Power button or the Start button when the touch screen is turned off, and then drag the lock screen wallpaper up.

Adjusting the volume

Press the Volume button up or down to adjust the ringtone volume, or to adjust the sound volume when playing music or video.

Switching to silent mode

Use one of the following methods:















- Press and hold the Volume button down until it switches to silent mode.
- Press the Volume button, and then tap .

Set the device to alert you to various events in silent mode. On the Start screen, scroll left, tap **Settings**, scroll to **system**, tap **ringtones+sounds**, and then drag the **Vibrate** switch to the right.

Basics

Indicator icons

The icons displayed at the top of the screen provide information about the status of the device. The icons listed in the table below are most common.

Icon	Meaning
	No signal
	Signal strength
	Roaming (outside of normal service area)
	GPRS network connected
	EDGE network connected
	UMTS network connected
	HSDPA network connected
	Wi-Fi connected
	Bluetooth feature activated
	No SIM or USIM card
	Silent mode activated
	Vibration mode activated
	Flight mode activated
	Battery power level

Using the touch screen

Use only fingers to use the touch screen.



- Do not allow the touch screen to come into contact with other electrical devices. Electrostatic discharges can cause the touch screen to malfunction.
- Do not allow the touch screen to contact water. The touch screen may malfunction in humid conditions or when exposed to water.
- To avoid damaging the touch screen, do not tap it with anything sharp or do not apply excessive pressure to it with your fingertips.
- Leaving the touch screen idle for extended periods may result in afterimages (screen burn-in) or ghosting. Turn off the touch screen when you do not use the device.

Finger gestures

Tapping

To open an application, to select a menu item, to press an on-screen button, or to enter a character using the on-screen keyboard, tap it with a finger.

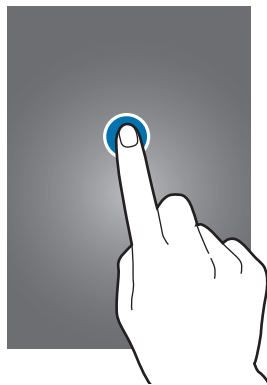

Dragging

To move an icon, thumbnail, or preview to a new location, tap and hold it and drag it to the target position.

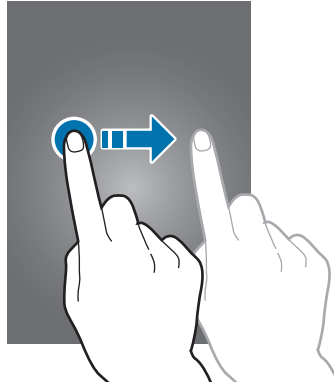

Double-tapping

Double-tap on a webpage, map, or image to zoom in a part. Double-tap again to return.

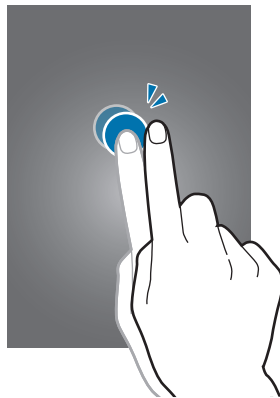

Flicking

Flick left or right to see another panel. Flick up or down to scroll through a webpage or a list, such as contacts.

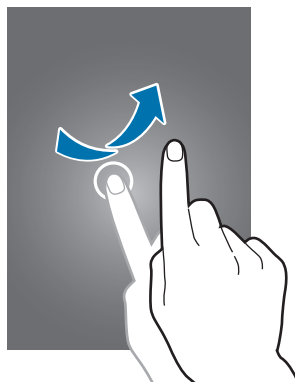

Pinching

Spread two fingers apart on a webpage, map, or image to zoom in a part. Pinch to zoom out.

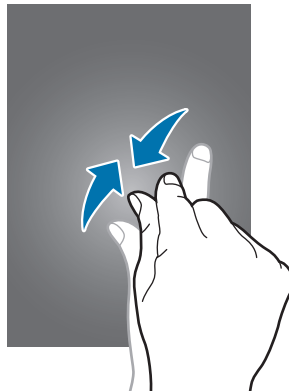

Rotating the screen

Many applications allow display in either portrait or landscape orientation. Rotating the device causes the display to automatically adjust to fit the new screen orientation.

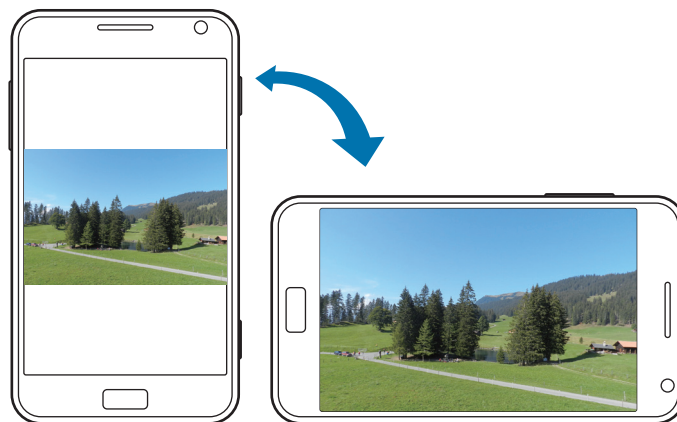

- Some applications do not allow screen rotation.
- Some applications display a different screen depending on the orientation.

Start screen

The Start screen is the starting point to access all of the device's features. It displays indicator icons, shortcuts to applications, and others.

Rearranging items



Adding an application tile

On the Start screen, scroll left, tap and hold an application icon, and then tap **pin to start**.

Moving an item

Tap and hold an item and drag it to a new location.

Resizing an item

Tap and hold an item, and then tap  to enlarge it or  to reduce it. To return it to the original size, tap .

Removing an item

Tap and hold an item, and then tap .

Using applications

This device can run many different types of applications, ranging from media to Internet applications.

Opening an application

On the Start screen or the Applications screen, tap an application icon to open it.

Tap  to search for an application.

Switching between applications

Tap and hold  to view all running applications, and then select one from the applications.

Closing an application

Close applications not in use to save battery power and maintain device performance.

Tap and hold , select an application, and then tap  to close it.

Applications screen

The Applications screen displays icons for all applications, including any new applications installed.

On the Start screen, scroll left to open the Applications screen.

Installing applications

Use application stores, such as **Store**, to download and install applications.

Uninstalling applications

Tap and hold an application, and then tap **uninstall**.



Default applications that come with the device cannot be uninstalled.

Help+Tips

Use this application to access help information and tips about how to use the device.

Tap **Help+Tips** on the Applications screen.

Use one of the following:

- **help:** Select a topic to access help information.
- **tips:** Select a topic to access useful tips.

Entering text

Use the Qwerty keyboard or the voice input feature to enter text.



Text entry is not supported in some languages. To enter text, you must change the input language to one of the supported languages.

Using the Qwerty keyboard

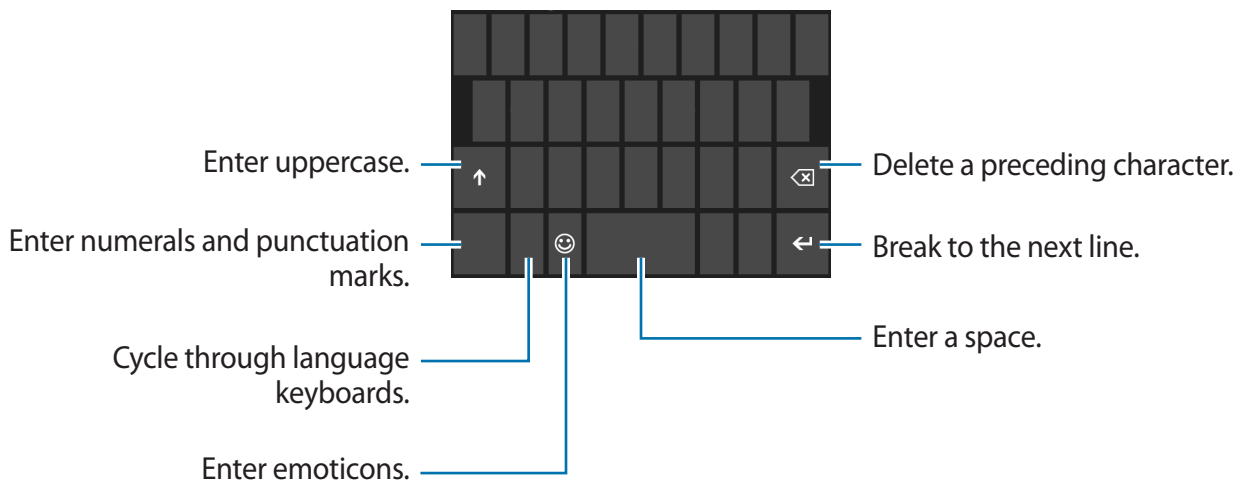

Entering uppercase

Tap  before entering a character. For all caps, tap it twice.

Changing language keyboards



You must add language keyboards to enter text in other languages. On the Applications screen, tap **Settings**, scroll to **system**, tap **keyboard** → **add keyboards**, and then select the language keyboards.

Tap the language key to change language keyboards.

Entering text by voice

Tap , speak into the microphone, and then tap **go**.

Copying and pasting

Tap over text, drag  to select more or less text, and then tap  to copy. The selected text is copied to the clipboard.

To paste it into a text entry field, place the cursor at the point where it should be inserted, and then tap .

Connecting to a Wi-Fi network

Connect the device to a Wi-Fi network to use the Internet. (p. 61)

Turning Wi-Fi on or off

On the Applications screen, tap **Settings**, scroll to **system**, tap **WiFi**, and then drag the **WiFi networking** switch to the right to turn it on. Drag the switch left to turn it off.



- This device uses a non-harmonised frequency and is intended for use in all European countries. The WLAN can be operated in the EU without restriction indoors, but cannot be operated outdoors in France.
- Turn off Wi-Fi to save the battery when not in use.

Joining Wi-Fi networks

On the Applications screen, tap **Settings**, scroll to **system**, tap **WiFi**, and then drag the **WiFi networking** switch to the right.

Select a network from the list of detected Wi-Fi networks, enter a password if necessary, and then tap **done**. Networks that require a password are indicated as secured networks. After the device connects to a Wi-Fi network, the device will automatically connect to it any time it is available.

Adding Wi-Fi networks

If the desired network does not appear in the networks list, tap **advanced** at the bottom of the networks list. Tap , enter the network name in **Network name**, select the security type and enter the password if it is not an open network, and then tap **add**.

Setting up accounts

Microsoft applications, such as **Store**, require a Microsoft account. Create Microsoft accounts to have the best experience with the device.

Adding accounts

Follow the instructions that appear when opening a Microsoft application without signing in to set up a Microsoft account.

To sign in with a Microsoft account, on the Applications screen, tap **Settings**, scroll to **system**, and then tap **email+accounts** → **add an account** → **Microsoft account**. After that, follow on-screen instructions to complete the account setup. More than one Microsoft account can be used on the device.

Removing accounts

On the Applications screen, tap **Settings**, scroll to **system**, tap **email+accounts**, tap and hold the account to remove, and then tap **delete**.

Transferring files

Move audio, video, image, or other types of files from the device to the computer, or vice versa.



The following file formats are supported by some applications. Some file formats are not supported depending on the version of the device's software.

- Music: m4a, m4b, wma, and mp3
- Image: bmp, gif, jpg, and png
- Video: m4v, mp4, avi, mov, dvr-ms, and wmv
- Document: doc, docx, xls, xlsx, ppt, pptx, pdf, and txt

Connecting as a media device

Connect the device to a computer via the USB cable. The device's internal memory and the memory card in the device both appear on the computer as removable storage devices.

- 1 Connect the device to the computer using the USB cable.
- 2 Transfer files between your device and the computer.

Securing the device

Prevent others from using or accessing personal data and information stored in the device by using the security features. The device requires a preset password whenever unlocking it.

Setting a password

On the Applications screen, tap **Settings**, scroll to **system**, tap **lock screen**, and then drag the **Password** switch to the right. Enter at least four numbers, and then enter the password again to verify it.

Unlocking the device

Turn on the screen by pressing the Power button or the Start button, and enter the password.



If the unlock code is forgotten, take the device to a Samsung Service Centre to reset it.

Updating the device

The device is set to download and install updates automatically. To check for available updates manually, on the Applications screen, tap **Settings**, scroll to **system**, and then tap **phone update**.

Communication

Phone



Use this application to make or answer a call.

Tap **Phone** on the Applications screen.

Making calls

Making a call

Use one of the following methods:

- **history**: Make a call from the history of incoming and outgoing calls.
- : Enter the number using the keypad, and then tap **call**.
- : Make a call from the contacts list.

Finding contacts

Tap , enter a name, phone number, or email address to find a contact in the contacts list. As characters are entered, predicted contacts appear. Select one to place a call to it.

Making an international call

Tap and hold **0** until the + sign appears. Enter the country code, area code, and phone number, and then tap **call**.

During a call

The following actions are available:

- **hold:** Hold a call. Tap **hold again** to retrieve the held call.
- **add call:** Dial a second call.
- **answer:** Answer a second call. The first call is automatically placed on hold. This feature is available only if the call waiting service is active.
- : Open the keypad.
- **speaker:** Activate the speakerphone. Keep the device away from your ears when using the speakerphone.
- **mute:** Turn off the microphone so that the other party cannot hear you.
- **merge:** Make a multiparty call when connected to two calls. Repeat this to add more parties. This feature is available only if the multiparty call service is active.
- **TAP TO SWAP:** Switch between two calls.

Adding contacts

To add a phone number to the contacts list from the keypad, enter the number and tap **save**.

Receiving calls

Answering a call

When a call comes in, tap **answer**, or press the headset button.

If the call waiting service is active, another call can be made. When the second call is answered, the first call is put on hold.

Rejecting a call

When a call comes in, tap **ignore**, or press and hold the headset button.

Automatically rejecting calls from unwanted numbers

On the Applications screen, tap **Settings**, scroll to **system**, tap **call blocking**, and then enter a number or select one from the contacts list.

Missed calls

If you have missed calls, the number of missed calls appears on the Start screen. Tap the **Phone** tile to view the list of missed calls.

Call waiting

Call waiting is a service provided by the service provider. A user can use this service to suspend a current call and switch to an incoming call.

To make use of this service, on the Applications screen, tap **Settings**, scroll to **system**, and then tap **additional call** → **call waiting**.

Call forwarding

The device can be set to send incoming calls to a specified number.

On the Applications screen, tap **Settings**, scroll to **system**, tap **additional call** → **call forwarding**, and then select a call type and condition. Enter a number and tap **Enable**.

Ending a call

Tap **end call** to end a call. Or press the headset button.

People

Use this application to manage contacts, including phone numbers, email addresses, and others.

Tap **People** on the Applications screen.

Managing contacts

Creating a contact

In **all**, tap , and then enter contact information.

Editing a contact

Tap .

Deleting a contact

Tap  → **Delete**.

Searching for contacts

Use one of the following search methods:

- Scroll up or down the contacts list.
- Tap  and enter search criteria.

Once a contact is selected, tap a phone number to make a call, or take one of the following actions.

- **text:** Compose a message.
- **send email:** Compose an email.

Importing and exporting contacts

Syncing with Microsoft accounts or social network sites

If a contact is added or deleted on the device, it is also added to or deleted from the Microsoft or SNS accounts, and vice versa.

Importing contacts

Tap  → **settings** → **import SIM contacts**. Select contacts to import, and then tap **import**.

Viewing posts from social network sites

In **what's new**, tap  → **refresh**, and then select a post.

To add a comment, tap .



Contact groups

Adding contacts to a group

In **together**, select a group, and then tap .

Managing groups

Select a group, and then take one of the following actions:

- : Add the group to the Start screen.
-  → **rename**: Rename the group.
-  → **delete**: Delete the group.

Sending a message or email to a group's members

Select a group, and then tap **text** or **send email**.

Messaging

Use this application to send text messages (SMS) or multimedia messages (MMS).

Tap **Messaging** on the Applications screen.



You may incur additional charges for sending or receiving messages while you are outside your home service area. For details, contact your service provider.

Sending messages

In **threads**, tap , add recipients, and then enter a message.

Use the following methods to add recipients:

- Enter a phone number.
- Tap , and then select a contact.

Use the following method to make a multimedia message:

- Tap , and attach images, videos, contacts, and others.

Viewing incoming messages

Incoming messages are grouped into message threads by contact.

Select a contact to view the person's message.

Listening to a voice message

Tap **phone** → , and then follow the instructions from your service provider.

Email

Use this application to send or view email messages.



Setting up email accounts

Set up an email account when opening Email for the first time.

On the Start screen, tap , enter the email address and password, and then follow on-screen instructions to complete the setup. The new email account is added to the Start screen and the Applications screen.

To set up another email account, on the Applications screen, tap **Settings**, scroll to **system**, and then tap **email+accounts** → **add an account**.

Sending messages

On the Applications screen, tap the email account to use, and then tap . Enter recipients, subject, and message, and then tap .

Tap  to add a recipient from the contacts list.

Tap  → **show cc & bcc** to add more recipients.

Tap  to attach images.

Reading messages

On the Applications screen, select an email account to use, and new messages are retrieved. To manually retrieve new messages, tap .

Tap a message to read.

Tap the attachment to open it, and then tap  → **save to phone** to save it.

ChatON

Use this application to chat with any device that has a mobile phone number.

Tap **ChatON** on the Applications screen.

Create the buddies list by entering phone numbers or email addresses of Samsung accounts, or selecting buddies from the list of suggest.

Select a buddy to start chatting.

Web & network

Internet Explorer

Use this application to browse the Internet.

Tap **Internet Explorer** on the Applications screen.

Viewing webpages

Tap the address field, enter the web address, and then tap →.

Opening a new page

Tap ... → **tabs** → .



To go to another webpage, tap ... → **tabs**, and tap the page to select it.

Bookmarks

To bookmark the current webpage, tap ... → **add to favorites**.

To open a bookmarked webpage, tap ... → **favourites**.

History

Tap  → **recent** to open a webpage from the list of recently-visited webpages. To clear the history, tap .

Links

Tap and hold a link on the webpage to open it in a new page, share, or copy.

Sharing webpages

To share a webpage address with others, tap  → **share page**.

Bluetooth

Bluetooth creates a direct wireless connection between two devices over short distances. Use Bluetooth to exchange data or media files with other devices.



- Samsung is not responsible for the loss, interception, or misuse of data sent or received via the Bluetooth feature.
- Always ensure that you share and receive data with devices that are trusted and properly secured. If there are obstacles between the devices, the operating distance may be reduced.
- Some devices, especially those that are not tested or approved by the Bluetooth SIG, may be incompatible with your device.
- Do not use the Bluetooth feature for illegal purposes (for example, pirating copies of files or illegally tapping communications for commercial purposes). Samsung is not responsible for the repercussion of illegal use of the Bluetooth feature.

To activate Bluetooth, on the Applications screen, tap **Settings**, scroll to **system**, tap **Bluetooth**, and then drag the **Status** switch to the right.

Pairing with other Bluetooth devices

On the Applications screen, tap **Settings**, scroll to **system**, tap **Bluetooth**, drag the **Status** switch to the right, and detected devices are listed. Select the device you want to pair with, and then accept the auto-generated passkey on both devices to confirm.

Sending and receiving data

Many applications support data transfer via Bluetooth. An example is **Photos**. Open **Photos**, select an image, tap  → **share...** → **Bluetooth**, and then select one of the paired Bluetooth devices. After that, accept the Bluetooth authorisation request on the other device to receive the image.

When your device receives data from other devices, the device saves the files to an appropriate application or folder according to their types.

Media

Music+Videos

Use this application to listen to music and play videos or podcasts.

Tap **Music+Videos** on the Applications screen.



- Some file formats are not supported depending on the device's software version.
- Some files may not play properly depending on the encoding used.

Playing music

Select a music category, and then select a song to play.

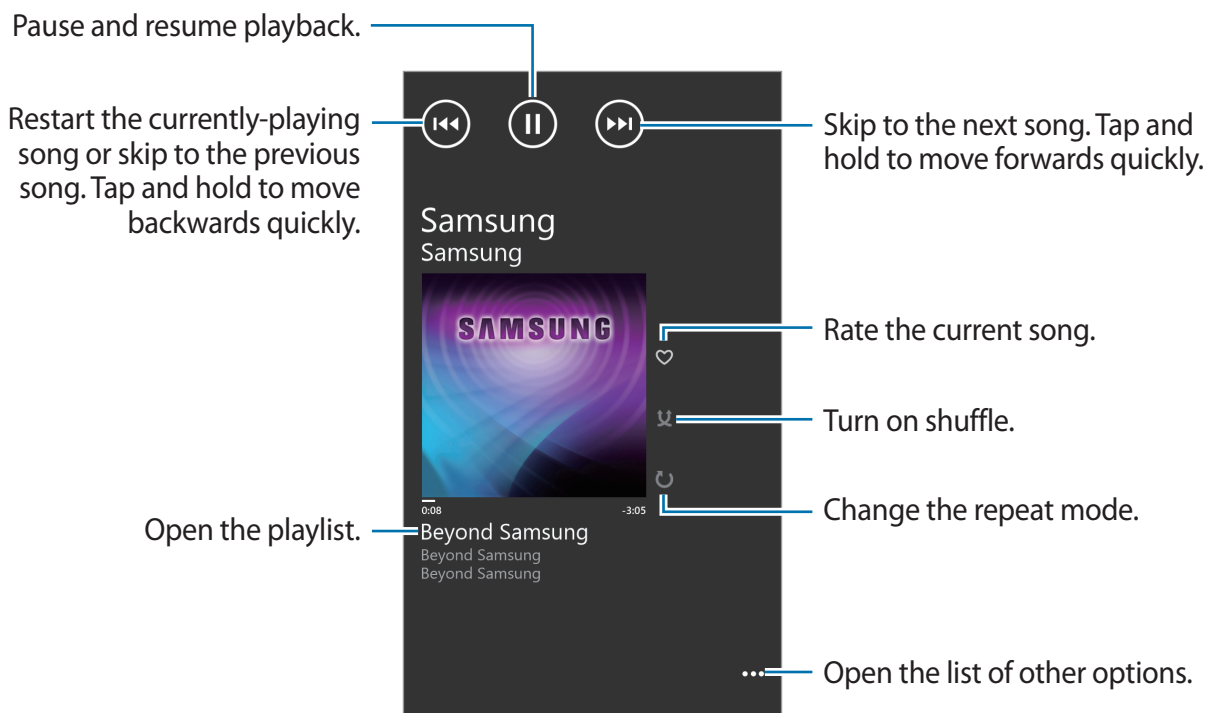

Creating playlists

Make an own selection of songs.

While playing a music, tap **⋮** → **save as playlist**, enter a title, and then tap **→**.

Playing videos

Select a video category, and then select a video to play.

Restart the current video or skip to the previous video. Tap and hold to move backwards quickly.

Move forwards or backwards by dragging the bar.

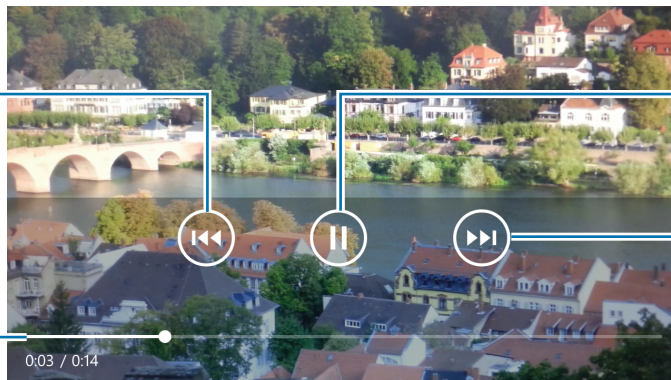

Pause and resume playback.

Skip to the next video. Tap and hold to move forwards quickly.

Playing podcasts

Select a podcast category, and then select a podcast → an episode.

Camera

Use this application to take photos or videos.

Use **Photos** to view photos and videos taken with the device's camera. (p. 45)

Tap **Camera** on the Applications screen.



The camera automatically shuts off when unused.

Camera etiquette

- Do not take photos or videos of other people without their permission.
- Do not take photos or videos where legally prohibited.
- Do not take photos or videos in places where you may violate other people's privacy.

Taking photos

Taking a photo

Press the Camera button to take the photo.



Taking videos

Taking a video

Tap , and then press the Camera button to take a video. To stop recording, press the Camera button again.