

## 9. User Manual

- \* Depending on the software installed or your service provider or country, some of the descriptions in this guide may not match your phone exactly.
- \* Depending on your country, your phone and accessories may appear different from the illustrations in this guide.

**SAMSUNG ELECTRONICS**



World Wide Web  
<http://www.samsungmobile.com>

Printed in Korea  
Code No.:GH68-09035A  
English. 01/2006. Rev. 1.0



# **SGH-X300**

## **User's Guide**



# Important safety precautions



Failure to comply with the following precautions may be dangerous or illegal.

## Drive safely at all times

Do not use a hand-held phone while driving. Park the vehicle first.

## Switch off the phone when refuelling

Do not use the phone at a refuelling point (service station) or near fuels or chemicals.

## Switch off in an aircraft

Wireless phones can cause interference. Using them in an aircraft is both illegal and dangerous.

## Switch off the phone near all medical equipment

Hospitals or health care facilities may be using equipment that could be sensitive to external radio frequency energy. Follow any regulations or rules in force.



## Interference

All wireless phones may be subject to interference, which could affect their performance.

## Be aware of special regulations

Meet any special regulations in force in any area and always switch off your phone whenever it is forbidden to use it, or when it may cause interference or danger.

## Water resistance

Your phone is not water-resistant. Keep it dry.

## Sensible use

Use only in the normal position (held to the ear). Avoid unnecessary contact with the antenna when the phone is switched on.

## Emergency calls

Key in the emergency number for your present location, then press .

## Keep your phone away from small children

Keep the phone and all its parts, including accessories, out of the reach of small children.

## Accessories and batteries

Use only Samsung-approved accessories and batteries. Use of any unauthorised accessories could damage your phone and may be dangerous.



- The phone could explode if the battery is replaced with an incorrect type.
- Dispose of used batteries according to the manufacturer's instructions.

## Qualified service

Only qualified service personnel may repair your phone.

For more detailed safety information, see "Health and safety information" on page 64.

# About this Guide

This User's Guide provides you with condensed information about how to use your phone. To quickly learn the basics for your phone, please refer to "Get started" and "Step outside the phone."

In this guide, the following instruction icons appear:



Indicates that you need to pay careful attention to the subsequent information regarding safety or phone features.



Indicates that you can get more information on the referenced page.



Indicates that you need to press the Navigation keys to scroll to the specified option and then select it.



Indicates a key on the phone.  
For example, [ **z** ]



Indicates a soft key, whose function is displayed on the phone screen.  
For example, <**Menu**>

- **Tri-band operation**

Use your phone in worldwide GSM networks, in any of 900, 1800, and 1900 bands.

## *Special features of your phone*



- **FM radio**

Listen to your favourite radio stations anytime, anywhere.



- **IrDA**

Send and receive Phonebook entries via an infrared port.



- **Web browser**

Access the wireless web to get up-to-the-minute information and a wide variety of media content.



- **Java**

Enjoy Java™-based embedded games and download new games.



- **Phonebook**

Store home, office, or cellular phone numbers for your entries.

- **Multimedia Message Service (MMS)**

Send and receive MMS messages with a combination of text, images, and sounds.



- **Calendar and to do list**

Keep track of your daily and monthly schedules and tasks.



- **Alarm**

Use your phone as an alarm clock to wake you up in the morning or notify you to an event.



- **Calculator**

Perform basic calculations and do currency conversions.



- **Voice recorder**

Record memos or sounds.

## Contents

### Unpack 6

*Make sure you have each item*

### Your phone 6

*Buttons, features, and locations*

### Get started 7

*First steps to operating your phone*

Install and charge the phone .....	7
Power on or off .....	8
Keys and display .....	9
Access menu functions .....	11
Customise your phone .....	12
Make/Answer calls .....	14

### Step outside the phone 14

*Begin with games, the web, the FM radio, and other special features*

Play games .....	14
Browse the web .....	15

Listen to the FM radio .....	15
Use Phonebook .....	16
Send messages .....	17
View messages .....	18

### Enter text 19

*ABC, T9, Number, and Symbol mode*

### Call functions 22

*Advanced calling features*

### Menu functions 26

*All menu options listed*

### Solve problems 62

*Help and personal needs*

### Health and safety information 64

### Index 71



## Overview of menu functions

To access Menu mode, press <Menu> in Idle mode.

### 1 SIM AT ▶ p. 29

### 2 Call records ▶ p. 29

- 1 Missed calls ▶ p. 29
- 2 Received calls ▶ p. 30
- 3 Dialed calls ▶ p. 30
- 4 Delete all ▶ p. 30
- 5 Call time ▶ p. 30
- 6 Call cost\* ▶ p. 31

### 3 Network services ▶ p. 31

- 1 Call diverting ▶ p. 31
- 2 Call barring ▶ p. 32
- 3 Call waiting ▶ p. 32
- 4 Network selection ▶ p. 33
- 5 Caller ID ▶ p. 33
- 6 Closed user group ▶ p. 33
- 7 Band selection ▶ p. 34

### 4 Sound settings ▶ p. 34

- 1 Ring tone ▶ p. 34
- 2 Ring volume ▶ p. 34
- 3 Alert type ▶ p. 34
- 4 Keypad tone ▶ p. 35
- 5 Message tone ▶ p. 35
- 6 Folder tone ▶ p. 35
- 7 Alert on call ▶ p. 35
- 8 Power on/off ▶ p. 35
- 9 Extra tones ▶ p. 35

### 5 Messages ▶ p. 36

- 1 Text messages ▶ p. 36
- 2 Multimedia messages ▶ p. 41
- 3 Push messages ▶ p. 45

### 6 Funbox ▶ p. 45

- 1 WAP browser ▶ p. 45
- 2 Games ▶ p. 48
- 3 Sounds ▶ p. 49
- 4 Images ▶ p. 49
- 5 Delete all ▶ p. 49
- 6 Memory status ▶ p. 49

### 7 Organiser ▶ p. 50

- 1 Alarm ▶ p. 50
- 2 Calendar ▶ p. 51
- 3 Time & Date ▶ p. 52
- 4 Calculator ▶ p. 52
- 5 To do list ▶ p. 53
- 6 Voice memo ▶ p. 53
- 7 Currency exchange ▶ p. 54

### 8 FM Radio ▶ p. 55

### 9 Phone settings ▶ p. 56

- 1 Infrared activate ▶ p. 56
- 2 Display settings ▶ p. 58
- 3 Greeting message ▶ p. 59
- 4 Own number ▶ p. 59
- 5 Language ▶ p. 59
- 6 Security ▶ p. 59
- 7 Extra settings ▶ p. 61
- 8 Volume key ▶ p. 61
- 9 Short cut ▶ p. 61
- 0 Reset settings ▶ p. 61

Press <Phonebook> in Idle mode.

### Phonebook ▶ p. 26

- 1 Search ▶ p. 26
- 2 New entry ▶ p. 26
- 3 Group search ▶ p. 27
- 4 Edit group ▶ p. 27
- 5 Speed dial ▶ p. 28
- 6 Delete all ▶ p. 28
- 7 Memory status ▶ p. 28
- 8 SDN\* ▶ p. 29

\* Shows only if supported by your SIM card.

## Unpack

Make sure you have each item



Phone



Travel Adapter



Battery



User's Guide

You can obtain various accessories from your local Samsung dealer.

- ☒ The items supplied with your phone and the accessories available at your Samsung dealer may vary, depending on your country or service provider.

## Your phone

Buttons, features, and locations

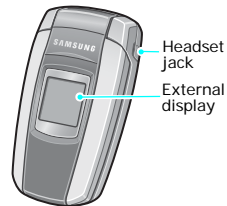

## Get started

*First steps to operating your phone*

### SIM card information

When you subscribe to a cellular network, you receive a plug-in SIM (Subscriber Identity Module) card loaded with your subscription details, such as your PIN, and available optional services.

### Install and charge the phone

- 1** Remove the battery cover.

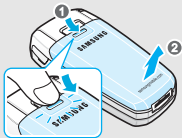

- ✓ If the phone is already on, first turn it off by holding [⏻].

- 2** Insert the SIM card.

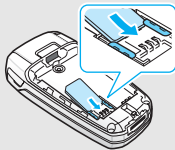

- ✓ Make sure that the gold-coloured contacts on the card face down into the phone.

- 3** Install the battery.

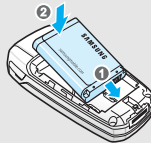

- 4** Replace the cover.

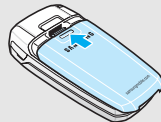

- 5** Plug the travel adapter into the phone.

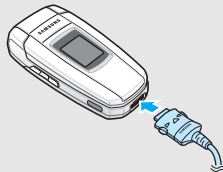

- 6** Plug the adapter into a standard AC wall outlet.

- 7 When the phone is completely charged (the battery icon becomes still), unplug the adapter from the power outlet.

- 8 Remove the adapter from the phone.

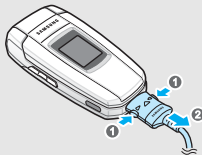

### Low battery indicator

When the battery is low:

- a warning tone sounds,
- the battery low message displays, and
- the empty battery icon  blinks.

If the battery level becomes too low, the phone automatically turns off. Recharge your battery.

## Power on or off

### Power on

Do not turn on the phone when mobile phone use is prohibited.

1. Open the phone.
2. Press and hold [] to turn on the phone.
3. If necessary, enter the PIN and press <OK>.

### Power off

1. Open the phone.
2. Press and hold [].

## Keys and display

### Keys



Perform the function indicated on the bottom line of the display.



In Idle mode, access your favourite menus directly. ► p. 61  
In Menu mode, scroll through menu options.



In Idle mode, launch the web browser.  
In Menu mode, select the highlighted menu option or confirm input.



Make or answer a call.  
In Idle mode, retrieve numbers recently dialled, missed, or received.



Delete characters from the display.  
In Menu mode, return to the previous menu level.



End a call.  
Press and hold to switch the phone on or off.  
In Menu mode, cancel input and return the phone to Idle mode.



Enter numbers, letters, and some special characters.  
In Idle mode, press and hold [1] to access your voicemail server. Press and hold [0] to enter an international call prefix.



Enter special characters.  
In Idle mode, press and hold [#] to activate or deactivate Silent mode. Press and hold [\*] to enter a pause between numbers.







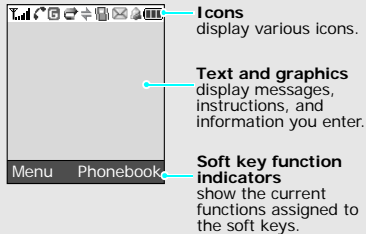

Adjust the phone volume.  
In Idle mode, with the phone open, adjust the keypad tone volume. With the phone closed, press and hold to turn on the backlight of the external display.









## Display

### Layout



### Icons\*

-  Received signal strength
-  Call in progress
-  Out of your service area; you cannot make or receive calls
-  GPRS network
-  Roaming
-  Call diverting feature active  
▶ p. 31

-  IrDA feature active ▶ p. 56
-  Silent mode or call ringer set to vibrate ▶ p. 13, p. 34
-  Mute mode ▶ p. 25
-  New text message
-  New voicemail message
-  New multimedia message
-  Alarm set ▶ p. 50
-  Battery power level

\* Depending on your country or service provider, the icons shown on the display may vary.

## Access menu functions

### Use the soft keys

The roles of the soft keys vary depending on the function you are using. The bottom line of the display indicates their current role.



Press the left soft key to select the highlighted option.

Press the right soft key to return to the previous menu level

### Select an option

1. Press the appropriate soft key.
2. Press the Navigation keys to move to the next or previous option.
3. Press **<Select>** or [ **i** ] to confirm the function displayed or option highlighted.
4. To exit, choose either of the following methods:
  - Press **<↺>** or [ **C** ] to move up one level.
  - Press [ **↻** ] to return to Idle mode.

### Use shortcuts

Press the number key corresponding to the option you want.

## Customise your phone

### Display language

1. In Idle mode, press <Menu> and select **Phone settings** → **Language**.
2. Select a language.

### Call ringer melody and volume

1. In Idle mode, press <Menu> and select **Sound settings** → **Ring tone**.
2. Select a ringtone.
3. Select **Ring volume**.
4. Adjust the volume level.
5. Press <OK>.

### Idle mode wallpaper

You can set wallpaper for the idle screen.

1. In Idle mode, press <Menu> and select **Phone settings** → **Display settings** → **Wallpaper** → **Wallpaper list**.
2. Select the image name you want.
3. Scroll through images until you find the one you want.
4. Press <Select>.



### Menu shortcuts

You can set [Up], [Left], and [Right] to function as shortcuts to access your favourite menus.

1. In Idle mode, press <Menu> and select **Phone settings** → **Short cut**.
2. Select a key.
3. Select a menu to be assigned to the key.

### Silent mode

You can switch the phone to Silent mode to avoid disturbing other people.

Press and hold [#] in Idle mode.

### Phone lock

You can protect the phone against unauthorised use with a phone password. The phone will require the password on power-up.

1. In Idle mode, press <Menu> and select **Phone settings** → **Security** → **Change password**.
2. Enter the default password, **00000000**, and press <OK>.
3. Enter a new 4- to 8-digit password and press <OK>.
4. Enter the new password again and press <OK>.
5. Select **Phone lock**.
6. Select **Enable**.
7. Enter the password and press <OK>.

## Make/Answer calls

### Make a call

1. Enter an area code and phone number.
2. Press [↵].
3. To end the call, press [📞].

### Answer a call

1. When the phone is ringing, press [↵].
2. To end the call, press [📞].

### Adjust the volume during a call

Press [▲/▼].

## Step outside the phone

*Begin with games, the web, the FM radio, and other special features*

## Play games

### Launch a game

1. In Idle mode, press <Menu> and select **Funbox** → **Games** → a game.
2. Scroll to **START GAME** and press [↵].
3. Select a game mode or press any key to start the game.
4. To end the game, press [📞] and then <Yes>.

## Browse the web

Using a built-in web browser, you can easily access the wireless web to get a variety of up-to-date services and information and to download web content.

### Launch the web browser

In Idle mode, press [ **z** ].

### Navigate the web

- To scroll through browser items, press [Up] or [Down].
- To select an item, press [ **z** ].
- To return to the previous page, press [C].
- To access browser options, press and hold [ \* ] or [ # ].

## Listen to the FM radio

### Listening to the radio

1. Plug the connector of the supplied headset into the jack on the right side of the phone.
2. In Idle mode, press [Down].
3. Press <**Options**> and select **Power on/off** → **On**.
4. Press [Left] or [Right] to find available radio stations.
5. To turn off the radio, disconnect the headset from the phone.

### Storing a radio station

1. From the station list on the FM Radio screen, select an empty location.
2. Select **Add**.
3. Enter the station title and press **<OK>**.
4. Enter the frequency of the station and press **<OK>**.
5. Select a location in which you want to store the station.

## Use Phonebook

### Add an entry

1. In Idle mode, enter a phone number and press **<Save>**.
2. Select a number type.
3. Select **Phone** or **SIM**.
4. Enter a name and press **<OK>**.
5. Press **<OK>** to save the entry.

### Find an entry

1. In Idle mode, press **<Phonebook>** and select **Search**.
2. Enter the first few letters of the name you want.
3. Select an entry.
4. Scroll to a number and press **[↵]** to dial, or press **<Options>** to access options.

## Send messages

### Send a text message (SMS)

1. In Idle mode, press **<Menu>** and select **Messages** → **Text messages** → **Write new**.
2. Enter the message text.
3. Press **<Options>** and select **Save and send** or **Send only**.
4. If you selected **Save and send**, select a memory location.
5. Enter a destination number and press **<OK>**.

### Send a multimedia message (MMS)

1. In Idle mode, press **<Menu>** and select **Messages** → **Multimedia messages** → **Write new**.
2. Enter the message subject press **<OK>**.
3. Select **Add here**.

4. Select an adding option and add message contents.
5. When you have finished, press **<Options>** and select **Send**.
6. Select a destination type.
7. Select one of **Phone number**, **E-mail address**, or **Phonebook**.
8. Enter a destination number or address and press **<OK>**, or select a number from Phonebook.
9. To add other destinations, select **Add destination** and repeat from step 7.
10. When you have finished, select **Send message**.

## View messages

---

### View a text message

When a notification appears:

1. Press <**View**>.
2. Select the message from the Inbox.

From the Inbox:

1. In Idle mode, press <**Menu**> and select **Messages** → **Text messages** → **Inbox**.
  2. Select a message.
- 

### View a multimedia message

When a notification appears:

1. Press <**View**>.
2. Press <**Options**> and select **Retrieve**.
3. Select the message from the Inbox.

---

From the Inbox:

1. In Idle mode, press <**Menu**> and select **Messages** → **Multimedia messages** → **Inbox**.
2. Select a message.

## Enter text

ABC, T9, Number, and Symbol mode

You can enter text in some features, such as Messages, Phonebook, or Organiser, using ABC mode, T9 mode, Number mode, and Symbol mode.

### Changing the text input mode

The text input mode indicator displays when the cursor is in a text field

**Example:** Writing an SMS message



Press the right soft key to change the input mode:

- **Ab**: ABC mode
- **T9**: T9 mode

- **1**: Number mode
- None: Symbol mode

### Using ABC mode

Press the appropriate key until the character you want appears on the display.

Key	Characters in order displayed	
	Upper case	Lower case
1	. , - ? ! @ : ( ) / 1 _	
2	A B C 2 Ä Å Æ Ç Γ	a b c 2 à ä å æ Γ
3	D E F 3 É Δ Φ	d e f 3 è é Φ
4	G H I 4 Θ Ψ	g h i 4 ì Ψ
5	J K L 5 Λ	j k l 5 Λ
6	M N O 6 Ñ Ø Ö ö	m n o 6 ñ ø ò ö
7	P Q R S 7 Π Σ Ξ	p q r s 7 β Σ Ξ
8	T U V 8 Ü ü	t u v 8 ù ü
9	W X Y Z 9 Ω	w x y z 9 Ω
0	space + = < > € £ \$ % & ¥ ¤ 0	

(Creating an SMS message with GSM-alphabet encoding)

## Other ABC mode operations

- To enter the same letter twice or to enter a different letter on the same key, wait for the cursor to move to the right automatically or press [Right]. Then, enter the next letter.
- Press [#] to insert a space.
- Press [\*] to change case. Initial capital (Ab), Capital lock (AB), and Lower case (ab) are available.
- Press the Navigation keys to move the cursor.
- Press [C] to delete characters one by one. Press and hold [C] to clear the display.
- Depending on your country, you may be able to access an input mode for your specific language by press and holding [\*].

## Using T9 mode

T9 is a predictive text input mode that allows you to key in any character using single keystrokes.

### Entering a word in T9 mode

1. Press [2] to [9] to start entering a word. Press each key once for each letter.  
For example, press [4], [3], [5], [5], and [6] to enter *Hello* in T9 mode.  
T9 predicts the word that you are typing, and it may change with each key that you press.
2. Enter the whole word before editing or deleting characters.
3. When the word displays correctly, go to step 4. Otherwise, press [0] to display alternative word choices for the keys that you have pressed.  
For example, *Of* and *Me* use [6] and [3].
4. Press [#] to insert a space and enter the next word.



## Other T9 mode operations

- Press [**1**] to enter periods or apostrophes automatically.
- Press [**\***] to change case. Initial capital (**Ab**), Capital lock (**AB**), and Lower case (**ab**) are available.
- Press [Left] or [Right] to move the cursor.
- Press [**C**] to delete characters one by one. Press and hold [**C**] to clear the display.

## Adding a new word to the T9 dictionary

This feature may not be available for some languages.

1. Enter the word that you want to add.
2. Press [**0**] to display alternative words for your key presses. When there are no more alternative words, **Add** displays on the bottom line.
3. Press **<Add>**.
4. Enter the word you want using ABC mode and press **<OK>**.

## Using Number mode

Number mode enables you to enter numbers.

Press the keys corresponding to the digits you want.

## Using Symbol mode

Symbol mode enables you to insert symbols.

To	Press
display more symbols	[Up] or [Down].
select a symbol	the corresponding number key.
clear the symbol(s)	[ <b>C</b> ].
insert the symbol(s)	<b>&lt;OK&gt;</b> .

## *Call functions*

### *Advanced calling features*

#### **Making a call**

1. In Idle mode, enter the area code and phone number.
2. Press [**↵**].

- ☒ • Press [**C**] to clear the last digit or press and hold [**C**] to clear the whole display. You can move the cursor to edit an incorrect digit.
- Press and hold [**\***] to enter a pause between numbers.

#### **Making an international call**

1. In Idle mode, press and hold [**0**]. The **+** character appears.
2. Enter the country code, area code, and phone number, then press [**↵**].

#### **Redialling recent numbers**

1. In Idle mode, press [**↵**] to display the list of recent numbers.
2. Scroll to the number you want and press [**↵**].

#### **Making a call from Phonebook**

Once you have stored a number in Phonebook, you can dial the number by selecting it from Phonebook. ► p. 26

You can also use the Speed dial feature to assign your most frequently called numbers to specific number keys. ► p. 28

You can quickly dial a number from Phonebook using its location number assigned when stored.

To dial a number from the phone's memory:

1. In Idle mode, press and hold [**0**]. The **+** character appears.
2. Enter the location number for the phone number you want and press [**#**].
3. Press [Up] or [Down] to scroll through other numbers, if necessary.

4. Press <**Dial**> or [↵] to dial the number you want.

To dial a number from the SIM card:

1. In Idle mode, enter the location number for the phone number you want and press [#].
2. Press [Up] or [Down] to scroll through other numbers, if necessary.
3. Press <**Dial**> or [↵] to dial the number you want.

## Ending a call

Close the phone or press [📞].

## Answering a call

When you receive an incoming call, the phone rings and displays the incoming call image.

Press <**Accept**> or [↵] to answer the call.

### Tips for answering a call

- When **Anykey answer** is active, you can press any key to answer a call, except for <**Reject**> and [📞]. ▶ p. 61

- When **Active folder** is active, you can simply open the phone. ▶ p. 61
- Press <**Reject**> or [📞] to reject a call.
- Press and hold [▲/▼] to reject a call or mute the ringer, depending on the **Volume key** setting. ▶ p. 61

## Viewing missed calls

If you have missed calls, the screen displays how many calls you have missed.

1. Press <**View**>.
2. If necessary, scroll through the missed calls.
3. Press [↵] to dial the number you want.

## Using the headset

Use the headset to make or answer calls without holding the phone.

Connect the headset to the jack on the right side of the phone. The button on the headset works as follows:

To	Press
redial the last call	the button twice.
answer a call	<a href="#">the button.</a>
end a call	the button.

## Options during a call

You can access a number of functions during a call.

### Adjusting the volume during a call

Use to adjust the earpiece volume during a call.

Press [**▲**] to increase the volume level and [**▼**] to decrease the volume level.

## Placing a call on hold/Retrieving

Press <**Hold**> or <**Unhold**> to place the call on hold or retrieve the call.



## Making a second call

You can make another call if your network supports this function.

1. Press <**Hold**> to put the call on hold.
2. Make the second call in the normal way.
3. Press <**Swap**> to switch between the calls.
4. To end the current call, press [].

## Answering a second call

You can answer an incoming call, if your network supports this function and you have activated the Call waiting feature. ► p. 32

1. Press [] to answer the call. The first call is automatically put on hold.
2. Press <**Swap**> to switch between the calls.
3. To end the current call, press [].

## Using the speakerphone feature

Use the speakerphone feature to talk and listen with the phone a short distance away.

Press [ **i** ] and then <**Yes**> to activate the speakerphone feature. Press the key again to switch back to the earpiece.

## Using In-call options

Press <**Options**> to access the following options during a call:

- **Menu:** access the phone's menu functions.
- **Mute/Unmute:** switch off the phone's microphone so that the other person on the phone cannot hear you, or switch it back on.
- **Mute keys/Send keys:** switch the key tones on or off.



To communicate with answering machines or computerised telephone systems, **Send keys** must be selected.

- **Send DTMF:** send the DTMF (Dual tone multi-frequency) tones as a group. The DTMF tones are the tones used in phones for tone dialling, sounding when you press the number keys. This option is helpful for entering a password or an account number when you call an automated system, like a banking service.
- **Phonebook:** access the contact list.
- **Join:** set up a multi-party call by adding a caller on hold to a currently active call. You can include up to 5 people on a multi-party call.
- **Select one:** select one of multi-party call participants. You can then use the following options:
  - Private:** have a private conversation with one multi-party call participant. The other participants can converse with each other. After the private conversation, select **Join** to return to the multi-party call.
  - Remove:** disconnect one multi-party call participant.

## Menu functions

*All menu options listed*

### Phonebook

You can store phone numbers on your SIM card and in your phone's memory. The SIM card and phone's memory are physically separate, but they are used as a single entity called Phonebook.

To access this menu, press <**Phonebook**> in Idle mode.

#### Search

---

Use this menu to search for numbers in Phonebook.

#### Finding an entry

1. Enter the first few letters of the name that you want to find.
2. Select a name from the list.
3. Scroll to a number and press [↵] to dial, or press <**Options**> to access Phonebook options.

### Using Phonebook options

While viewing an entry, press <**Options**> to access the following options:

- **Paste**: paste the selected number into the dialling screen.
- **Edit**: edit entry information.
- **Delete**: delete the selected entry from the name.
- **Copy**: copy the number to the phone's memory or to the SIM card.
- **Caller group**: assign the selected number to a caller group.
- **Add entry**: add a new entry to the selected name.
- **Send via IrDA**: send the selected number or all numbers in entry via the infrared port. ▶ p. 56



#### New entry

---

Use this menu to add a new entry to Phonebook.

#### Storing an entry in the phone's memory

1. Select an entry type.
  -  : Mobile phone number

- : Office phone number
  - : Home phone number
  - : E-mail address; an e-mail address can be stored only in the phone's memory.
2. Select **Phone**.
  3. Enter a name and press <**OK**>.
  4. Enter a number or an e-mail address and press <**Save**>.
  5. Change the location number, if you want, and press <**OK**>.

### Storing an entry on the SIM card

1. Select an entry type.
2. Select **SIM**.
3. Enter a name and press <**OK**>.
4. Enter a number and press <**Save**>.
5. Change the location number, if you want, and press <**OK**>.

### Group search

---

Use this menu to search for your numbers in Phonebook in caller groups.

1. Enter the first few letters of the group name.
2. Select a group.
3. Select the name you want.
4. Press [>] to dial the number or <**Options**> to access Phonebook options.

### Edit group

---

Use this menu to edit your caller groups' properties.

Select a group and change the group settings by using the following options:

- **Call ring tone**: set a ringtone for incoming calls from the group members.
- **SMS tone**: set a ringtone for incoming messages from the group members.
- **Graphic**: set a graphic icon for incoming calls from the group members.
- **Group name**: assign a name to the group.

## Speed dial

---

Use this menu to assign speed dial numbers (2 to 9) to eight of your most frequently called numbers.

### Assigning speed dial entries

1. Select a key location from **2** to **9**. Key **1** is reserved for your voicemail server.
2. Select a name from the Phonebook list.
3. Select the number you want.

### Managing speed dial entries

From the Speed dial list, press **<Options>** to access the following options:

- **Change**: assign a different number to a key.
- **Delete**: clear the speed dial setting for a key.
- **Delete all**: clear the speed dial settings for all keys.
- **Number**: check the number assigned to a key.

### Dialling speed dial entries

In Idle mode, press and hold the appropriate key.

## Delete all

---

Use this menu to delete all of the entries from your phone's memory, your SIM card, or both.

1. Press [ **⌵** ] to select the memory locations to be cleared.
2. Press **<Delete>**.
3. Enter the phone password and press **<OK>**.

☒ The password is preset to **00000000**. You can change this password. ► p. 60

4. Press **<Yes>** twice to confirm the deletion.

## Memory status

---

Use this menu to check the number of entries you have stored in the phone's memory and on the SIM card.



## SDN

---

Use this menu to view the list of Service Dialling Numbers (SDN) assigned by your service provider, including emergency numbers and numbers for directory enquiries. This menu is available if your SIM card supports SDN.

Scroll to the number you want and press <**Dial**> or [**\**].

## SIM AT *(Menu 1)*

This menu is available if you use a SIM AT card that supports SIM Application Toolkit menus and provides additional services, such as news, weather, sports, entertainment, and location services. Available services may vary, depending on your service provider's plans. For details, see your SIM card instructions or contact your service provider.

To access this menu, press <**Menu**> in Idle mode and select **SIM AT**.

## Call records *(Menu 2)*

Use this menu to view the calls you have dialled, received, or missed, and the length of calls. You can also check the cost of your calls, if your SIM card supports this function.

To access this menu, press <**Menu**> in Idle mode and select **Call records**.

### Missed calls *(Menu 2.1)*

---

This menu displays the most recent calls you did not answer.

### Accessing a call record

1. Select a call record.
2. Press [Up] or [Down] to move to another call record.
3. Press [**\**] to dial, or <**Options**> to access call record options.

### Using call record options

While viewing call details, press <**Options**> to access the following options:

- **Edit:** change the number of the selected call record.
- **Delete:** delete the selected call record.

### Received calls (Menu 2.2)

---

This menu displays the most recent calls you have received.

### Dialled calls (Menu 2.3)

---

This menu displays the most recent calls you have dialled.

### Delete all (Menu 2.4)

---

Use this menu to delete all of the records in each call type.

1. Press [ **2** ] to select the call types to be cleared.
2. Press <**Delete**>.
3. Press <**Yes**> twice to confirm the deletion.

### Call time (Menu 2.5)

---

This menu displays the time log for calls made and received. The actual time invoiced by your service provider will vary.

- **Last call time:** check the length of your last call.
- **Total sent:** check the total length of all the calls you have dialled.
- **Total received:** check the total length of all the calls you have received.
- **Reset timers:** reset the call timers. You need to enter the phone password.



The password is preset to **00000000**. You can change this password. ► p. 60

## Call cost (Menu 2.6)

---

This network feature displays the cost of calls. This menu is available only if your SIM card supports this feature. Note that this is not intended to be used for billing purposes.

- **Last call cost:** check the cost of your last call.
- **Total cost:** check the total cost of all of your calls. If the total cost exceeds the maximum cost set in **Set max cost**, you must reset the counter before you can make another call.
- **Max cost:** check the maximum cost limit set in **Set max cost**.
- **Reset counters:** reset the cost counters.
- **Set max cost:** set the maximum cost authorised for your calls.
- **Price/Unit:** set the price per unit that is applied when the cost of your calls is calculated.

## Network services (Menu 3)

Use this menu to access network services. Please contact your service provider to check their availability and subscribe to them, if you wish.

To access this menu, press <**Menu**> in Idle mode and select **Network services**.

### Call diverting (Menu 3.1)

---

This network service reroutes incoming calls to a phone number that you specify.

1. Select a call diverting option:
  - **Divert always:** divert all calls.
  - **Busy:** divert calls when you are on another call.
  - **No reply:** divert calls when you do not answer the phone.
  - **Unreachable:** divert calls when you are not in an area covered by your service provider or when your phone is switched off.
  - **Cancel all:** cancel all call diverting options.

2. Select the type of calls to be diverted.
3. Press <**Activate**>. To deactivate call diverting, press <**Options**> and select **Remove**.
4. Enter the number to which calls are to be diverted and press <**OK**>.
5. If you selected **No reply**, select the length of time the network delays before diverting a call.

### Call barring (Menu 3.2)

---

This network service allows you to restrict your calls.

1. Select a call barring option:
  - **All outgoing**: prohibit all outgoing calls.
  - **International**: prohibit international calls.
  - **International except home**: only allow calls to numbers within the current country when you are abroad, and to your home country.
  - **All incoming**: prohibit incoming calls.
  - **Incoming while abroad**: prohibit incoming calls when you use your phone outside of your service area.

- **Cancel all**: cancel all call barring settings, allowing calls to be sent and received normally.
- **Change barring password**: change the call barring password obtained from your service provider.

2. Select the type of calls to be barred.
3. Press <**Activate**>. To deactivate call barring, press <**Deactivate**>.
4. Enter the call barring password supplied by your service provider and press <**OK**>.

### Call waiting (Menu 3.3)

---

This network service informs you when someone is trying to reach you while you are on another call.

1. Select the type of calls to which the call waiting option will apply.
2. Press <**Activate**>. To deactivate call waiting, press <**Deactivate**>.

## Network selection *(Menu 3.4)*

---

This network service allows you to select the network used when roaming outside of your home area, or let the network to be chosen automatically.

You can select a network other than your home network only if there is a valid roaming agreement between the two.

## Caller ID *(Menu 3.5)*

---

This network service allows you to prevent your phone number from being displayed on the phone of the person being called. If you select **Default**, the phone will use the default setting provided by the network.

- ☒ Some networks do not allow the user to change this setting.

## Closed user group *(Menu 3.6)*

---

Use this menu to set incoming and outgoing calls to be restricted to a selected user group. For details about how to create a closed user group, contact your service provider.

- **Index list:** list, add, or delete CUG index numbers. Press <**Options**> to access the options for setting up an index list.
- **Outside access:** enable calls to numbers other than those in the Closed user group. This feature depends on the nature of your CUG subscription.
- **Default group:** enable the default CUG, if you have set one with your service provider. When making a call, you are given the option of using your default CUG, instead of selecting one from the list.

## **Band selection** (Menu 3.7)

---

For the phone to make and receive phone calls, it must register with an available network. Your phone can handle any of the following types of networks: GSM 1900 and Combined GSM 900/1800.

The country where you purchased your phone determines the default band that it uses. When you travel abroad, you must remember to change to an appropriate band.

## **Sound settings** (Menu 4)

Use this menu to customise various sound settings.

To access this menu, press <**Menu**> in Idle mode and select **Sound settings**.

### **Ring tone** (Menu 4.1)

---

Use this menu to select a ringtone for the call ringer. You can select one of the embedded ringtones or downloaded sounds.

### **Ring volume** (Menu 4.2)

---

Use this menu to adjust the ringtone volume.

### **Alert type** (Menu 4.3)

---

Use this menu to specify how you are to be informed of incoming calls.

- **Melody**: the phone rings using the selected ringtone.
- **Vibration**: the phone vibrates but not rings.
- **Vibra+melody**: the phone vibrates three times and then starts ringing.

## Keypad tone *(Menu 4.4)*

Use this menu to select the tone that the phone sounds when you press a key.

- ☒ You can adjust the keypad tone volume using [▲/▼] in Idle mode.

## Message tone *(Menu 4.5)*

Use this menu to change the sound settings for incoming SMS messages, MMS messages, and cell broadcast (CB) messages individually.

- **SMS tone:** specify how you are informed of new SMS messages.
- **SMS-CB tone:** specify how you are informed of new CB messages.
- **MMS tone:** specify how you are informed of new MMS messages.
- **Repetition:** set whether or not the phone repeats alerting you to new messages. If you selected **Periodic**, the phone alerts you every 2 minutes until you view the message.

## Folder tone *(Menu 4.6)*

Use this menu to select the tone that the phone sounds when you open or close the phone.

## Alert on call *(Menu 4.7)*

Use this menu to select whether or not the phone informs you when you receive a new message or when the time for an alarm comes during a call.

## Power on/off *(Menu 4.8)*

Use this menu to select the melody that the phone plays when it is switched on or off.

## Extra tones *(Menu 4.9)*

Use this menu to customise additional tones for the phone.

- **Error tone:** set the phone to beep when you make a mistake.
- **Minute minder:** set the phone to beep every minute during an outgoing call to keep you informed of the length of your call.

- **Connect tone:** set the phone to beep when an outgoing call is connected to the system.

## Messages (Menu 5)

Use the **Messages** menu to send and receive short messages, and multimedia messages. You can also access push messages from web servers.

To access this menu, press <**Menu**> in Idle mode and select **Messages**.

### Text messages (Menu 5.1)

---

Short Message Service (SMS) allows you to send or receive text messages including simple pictures, melodies, and animated images.

#### Inbox (Menu 5.1.1)

Use this menu to access SMS messages you have received.

While viewing a message, press <**Options**> to access the following options:

- **Delete:** delete the message.

- **Send:** forward the message to other people.
- **Text reply:** reply to the sender.
- **Call back:** make a call to the sender.
- **Cut address:** extract URLs, e-mail addresses, or phone numbers from the message.
- **Move to phone/Move to SIM:** move the message between the SIM card and the phone's memory.
- **Select objects:** save images or sounds from the message into your phone's memory.

#### Outbox (Menu 5.1.2)

Use this menu to access SMS messages that you have sent or have saved to send at a later time.

While viewing a message, press <**Options**> to access the following options:

- **Delete:** delete the message.
- **Send:** forward the message to other people.
- **Cut address:** extract URLs, e-mail addresses, or phone numbers from the message.



- **Move to phone/Move to SIM:** move the message between the SIM card and the phone's memory.
- **Select objects:** save images or sounds from the message into your phone's memory.

### Write new (Menu 5.1.3)

Use this menu to create and send an SMS message.

1. Enter your message.

☒ The maximum number of characters allowed in a short message varies by service provider. If your message exceeds the maximum number of characters, the phone will split the message.

2. Press **<Options>** to access the following options:
  - **Send only:** just send the message.
  - **Save and send:** save the message in **Outbox** and then send it.
  - **Save only:** save the message in **Outbox** to send it later.
  - **Text formatting:** change the text attributes.

- **Add objects:** add a sound, melody, picture, or animated image to the message.
- **Add templates:** add one of text templates.
- **Add emoticon:** add one of preset emoticons.
- **Add phonebook:** add a phone number or e-mail address from Phonebook.
- **Add bookmark:** add a web page's address from the Favorite list.
- **Language:** change the language to be used in T9 mode.

3. When you have finished, press **<Options>** and select **Send only** or **Save and send**.
4. If you selected **Save and send**, select a memory location.
5. Enter a destination number.
6. Press **<OK>** to send the message.

### **Templates** (Menu 5.1.4)

Use this menu to create templates with the sentences you use frequently so that you can retrieve and insert them when composing an SMS message.

#### **Creating a template**

1. Select an empty location.
2. Select **Edit**.
3. Enter a message and press <**OK**>.

#### **Using template options**

From the template list, press <**Options**> to access the following options:

- **Edit**: create a new template or edit the selected template.
- **Send message**: create and send a new message using the template.
- **Delete**: delete the selected template.

### **Emoticon templates** (Menu 5.1.5)

Your phone provides preset emoticons so that you can retrieve and insert them when composing an SMS message. Use this menu to create or edit emoticons.

#### **Creating an emoticon**

1. Select a category.
2. Press <**Options**> and select **Add**.
3. Enter an emoticon and press <**Save**>.

#### **Using emoticon options**

From the emoticon list, press <**Options**> to access the following options:

- **Add**: add a new emoticon.
- **Edit**: edit the selected emoticon.
- **Send**: create and send a new message using the emoticon.
- **Delete**: delete the selected emoticon.

## Settings (Menu 5.1.6)

Use this menu to customise the SMS settings.

- ☒ The setting options available in this menu may vary depending on your service provider.

- **Setting x** (where **x** is the setting group number): set the properties of each setting group. The group accessed last is activated for sending or receiving subsequent messages.

**Service centre:** store or changes the number of your message centre.

**Default destination:** store a default destination number. It will be displayed in the Destination field.

**Default type:** set the default message type. The network can convert the messages into the selected format.

**Default validity:** set the length of time your messages are stored in the SMS server.

**Setting name:** change the name of the setting group.

- **Common settings:** the following options are available:

**Reply path:** allow recipients to reply to you through your SMS server.

**Delivery reports:** set the network to inform you when your messages have been delivered.

**Bearer selection:** select either **GSM** or **GPRS preferred**, depending on your network.

**Character support:** select a character encoding type. If you select **Automatic**, the phone switches the encoding type from GSM-alphabet to Uni-code if you enter a uni-code character.

Use of uni-code encoding will reduce the maximum number of characters in a message to about half. If this menu is not shown, your phone provides the automatic character encoding by default.

## Delete all (Menu 5.1.7)

Use this menu to delete SMS messages in each message folder all at once.

1. Press [ **z** ] to select the message folders to be cleared.

2. Press <**Delete**>.
3. Press <**Yes**> twice to confirm the deletion.

### **Memory status** (Menu 5.1.8)

Use this menu to check the number of SMS messages you have stored in each folder.

### **Voice mail** (Menu 5.1.9)

Use this menu to store the number of the voicemail server and access your voicemails.

☒ You must enter the voicemail server number before accessing the server. Your service provider can give you the number.

- **Connect to voice server:** connect to the voicemail server to allow you to listen to your messages. You can also connect to the voicemail server by pressing and holding [**1**] in Idle mode.
- **Voice server number:** change the voicemail server number.

### **Broadcast** (Menu 5.1.0)

Your phone receives Cell Broadcast (CB) messages, which are messages related to various topics, such as weather forecast, traffic, and news report, from network. Use this menu to access broadcast messages or change the settings for the service.

- **Read:** open received CB messages.

The **Volatile** box saves messages until the phone is switched off.

The **Archive** box saves messages indefinitely. Press <**Options**> and select **Save** when a text notification appears or while viewing a CB message in the Volatile box. The message is saved in the **Archive** box.

- **Receive:** select to receive CB messages, or not.
- **Channel list:** specify the channels from which you receive CB messages.
- **Language:** select the preferred languages in which CB messages display.







Please contact your service provider for details.

## Multimedia messages (Menu 5.2)

Multimedia Message Service (MMS) delivers messages containing a combination of text, an image, and an audio, from phone to phone or from phone to e-mail.

### Inbox (Menu 5.2.1)

Use this menu to access MMS messages that you have received. The following icons tell you the message status:

-  Read notification
-  Unread notification
-  Retrieving from the server
-  Processing your request
-  Failed to retrieve
-  Read message
-  Unread message

While viewing a message, press <**Options**> to access the following message options:

### Notifications

- **Retrieve:** retrieve the message from the MMS server.



- **Delete:** delete the notification.
- **More properties:** access the message properties.



### Messages

- **Delete:** delete the message.
- **Reply:** reply to the sender.
- **Call back:** make a call to the sender.
- **Cut address:** extract URLs, e-mail addresses, or phone numbers from the message.
- **Forward:** forward the message to other people.
- **Save picture:** save an image from the message into the **Images** folder.
- **Save sound:** save a sound from the message into the **Sounds** folder.
- **Properties:** access the message properties.

### Outbox (Menu 5.2.2)

Use this menu to access MMS messages that you have sent. The following icons tell you the message status:

-  Being sent
-  Sent

-  Failed to send
-  To be sent

While viewing a message, press **<Options>** to access the following options:

- **Delete:** delete the message.
- **Cut address:** extract URLs, e-mail addresses, or phone numbers from the message.
- **Send:** send or resend the message.
- **Edit message:** edit the message.
- **Properties:** access the message properties.

### **Draft** (Menu 5.2.3)

Use this menu to access MMS messages you have saved to send at a later time.

You can view a message and use the options the same as in **Outbox**.

### **Write new** (Menu 5.2.4)

Use this menu to create and send an MMS message.

1. Enter the message subject and press **<OK>**.

2. Press **<Options>** to access the following options:

- **Add text:** add message text.
- **Add picture:** add a picture to the message.
- **Add sound:** add a sound clip to the message.
- **Send:** send the message.
- **Save:** save the message in **Draft** or **Templates**.
- **Settings:** change the message settings.
  - ▶ p. 44
- **Add destination:** enter destination numbers or addresses.
- **Preview:** view the message as it will be shown on the recipient's phone.



The maximum size allowed for a message can differ, depending on your service provider.

3. After adding items, highlight one and press **<Options>** to access the following options for editing the message:

- **Edit text/Edit picture/Edit sound:** edit the text, picture, or sound.

- **Add page:** add pages. Move to each page by pressing [Left] or [Right].
  - **Delete:** remove the added item.
  - **Duration:** set how long one page displays. After the specified time, the display automatically scrolls to the next page.
4. When you have finished, press <**Options**> and select **Send**.
  5. Select a destination type (To, Cc, Bcc).
  6. Select one of **Phone number**, **E-mail address**, or **Phonebook**.
  7. Enter a phone number or an e-mail address and press <**OK**>, or select one from Phonebook.
  8. To add more destinations, select **Add destination** and repeat from step 6.
  9. To enter additional numbers or addresses to other destination types, press <**↻**> and repeat from step 5.
  10. When you have finished, select **Send message**.

### **Templates** (Menu 5.2.5)

Use this menu to access MMS templates you have saved as templates so that you can use them for composing an MMS message.

From the template list, press <**OK**> to access the following options:

- **Edit message:** create and send a new message using the template.
- **Delete:** delete the selected template.

### **Delete all** (Menu 5.2.6)

Use this menu to delete MMS messages in each message folder all at once.

1. Press [ **⌘** ] to select the message boxes to be cleared.
2. Press <**Delete**>.
3. Press <**Yes**> twice to confirm the deletion.

### **Memory status** (Menu 5.2.7)

Use this menu to check the amount of memory currently in use in each message box.

### Setup (Menu 5.2.8)

Use this menu to customise the MMS settings.

- **Delivery report:** set the network to inform you when your messages have been delivered.
- **Read reply:** send a read-reply request along with your messages.
- **Auto download:** set whether or not your phone retrieves new incoming messages from the MMS server without notifications.
- **Message acceptance:** select the categories of messages you want to receive.
- **Hide ID:** set whether to hide your phone number from the recipient's phone.
- **Expiry date:** set the length of time your messages are stored in the message server.
- **Delivery time:** set the time delay before messages are sent.
- **Priority:** set the priority level of your messages.
- **Report allowed:** set the network to inform the sender when a message has been delivered to you.

- **Page duration:** set how long one page in your outgoing messages displays. After a specified time, the display automatically scrolls to the next page.

### MMS profile (Menu 5.2.9)

You can configure required network connection settings for MMS. The profile accessed last is automatically activated for sending or receiving subsequent messages.



Check with your service provider before you change any MMS settings on your phone.

For each profile, set the following parameters:

- **Profile name:** assign a name to the MMS profile.
- **Connection URL:** enter the URL address of your MMS server.
- **Security:** select a security mode for data transmission.
- **IP address:** enter the IP address of the MMS server.
- **User name:** enter the login ID.



- **Password:** enter the login password.
- **APN:** enter the access point name of the MMS server.

### **Push messages** (Menu 5.3)

---

Use this menu to access push messages from the wireless web server or change the settings for receiving push messages.

- **Inbox:** view push messages you have received.
- **Receive:** determine whether or not your phone receives push messages.  
**Never:** the phone rejects push messages.  
**Always:** the phone receives all push messages.
- **Delete all:** delete all push messages.

### **Funbox** (Menu 6)

The **Funbox** menu allows you to use the web browser, play Java games, and access images and sounds stored in the phone's memory.

To access this menu, press <**Menu**> in Idle mode and select **Funbox**.

### **WAP browser** (Menu 6.1)

---

The Wireless Application Protocol (WAP) browser on your phone allows you to access the wireless web. From the wireless web, you can access up-to-date information and a wide variety of media content, such as games, wallpapers, and ringtones.

#### **Home** (Menu 6.1.1)

Use this menu to connect your phone to the network and load the homepage of the wireless web service provider. You can also press [ **⌂** ] in Idle mode.

## Navigating the web browser

To	Press
scroll through browser items	[Up] or [Down].
select a browser item	[ <i>i</i> ].
return to the previous page	[C].

## Using page options

From any web page, press and hold [ \* ] or [ # ] to access the following options; when you access page options by [ \* ], some options are not available:

- **Bookmarks:** bookmark the current page or access the Favorite list.
- **Reload:** reload the current page with updated information.
- **Home:** return to the homepage.
- **Go to URL:** enter a URL address manually.
- **Show URL:** view the URL address of the current web page.

- **Edit home:** change the page to be used for your homepage.
- **Security info:** access security information.
- **Clear cache:** delete information stored in the cache. The cache is a temporary memory site that stores recently accessed web pages.
- **Inbox:** read messages received from a web server.
- **Show image:** view the images on the current web page in order.

## Exiting the web browser

Press [  ] to end the network connection and exit the browser.

## Favorite (Menu 6.1.2)

Use this menu to save URL addresses as bookmarks in order to quickly access web pages.

## Adding a bookmark

1. Select an empty location.
2. Enter a URL address and press <Enter>.
3. Enter a title for the bookmark and press <Enter>.

## Using bookmark options

After saving an item, press <**Options**> to access the following options:

- **Go to URL:** access the bookmarked web page.
- **Edit:** edit the URL address and title of the bookmark.
- **Delete:** delete the bookmark.

### http:// (Menu 6.1.3)

Use this menu to manually enter a URL address and access the associated web page.

### Settings (Menu 6.1.4)

Use this menu to set up connection profiles to be used for the web browser. The profile accessed last is automatically activated for accessing the wireless web.

- ☒ Check with your service provider before you change any browser settings on your phone.

For each server, set the following parameters:

- **Profile name:** enter a profile name.
- **Homepage URL:** enter the URL address of the page to be used as your homepage.
- **Security:** select a security mode for data transmission.
- **Bearer:** select the network bearer type; **GPRS** or **Data**. Remaining options depend on the bearer setting.

*When the bearer is set to **GPRS**:*

- **IP address:** enter the IP address of the proxy server.
- **User name:** enter the login ID.
- **Password:** enter the login password.
- **APN:** enter the access point name of the GPRS network gateway.

*When the bearer is set to **Data**:*

- **IP address:** enter the IP address of the proxy server.
- **Login name:** enter the login ID.

- **Password:** enter the login password.
- **Dial-up number:** enter the PPP phone number.
- **Data call type:** select a call type for data transmission.

### Clear cache (Menu 6.1.5)

Use this menu to clear information stored in the cache.

### Games (Menu 6.2)

---

You can download Java applications from various sources using the web browser, and store them in your phone. Use this menu to access and play Java games.

- ☒ Java services may not be available, depending on your service provider.

### Accessing an embedded game

1. Select the game you want on the Games list.  
On the startup screen of the game, you can access the following options:
  - **START GAME:** start a new game.

- **CONTINUE:** continue the last game you played.
- **HIGH SCORE:** view the high score table. This option may not be available for some games.
- **HOW TO PLAY:** view how to play the game and the key functions for the game.
- **OPTION:** switch on or off the game sound.

2. Select **START GAME** or **CONTINUE** to start a game.
3. Follow the onscreen instructions.

### Viewing game information

Scroll to the game you want and press <**Info**>.

### Changing the DNS settings

You may need to change the DNS (Domain Name Server) setting of the Java server at your service provider's instructions.

1. Select **Setting** on the Games list.
2. Enter the primary address and press <**OK**>.
3. Enter the secondary address and press <**OK**>.

## Sounds *(Menu 6.3)*

---

Use this menu to access sounds downloaded from the wireless web or received in messages.

While reviewing a file, press <**Options**> to access the following options:

- **Rename**: change the file name.
- **Delete**: delete the file.
- **Set as ring tone**: set the sound as your call ringtone.

## Images *(Menu 6.4)*

---

Use this menu to access images downloaded from the wireless web or received in messages.

While reviewing a file, press <**Options**> to access the following options:

- **Rename**: change the file name.
- **Delete**: delete the file.
- **Set as wallpaper**: set the image as wallpaper for the idle screen.

## Delete all *(Menu 6.5)*

---

Use this menu to delete all of the downloaded items in the **Games**, **Sounds**, and **Images** folders.

1. Press [ **↓** ] to select the folders to be cleared.
2. Press <**Delete**>.
3. Press <**Yes**> twice to confirm the deletion.

## Memory status *(Menu 6.6)*

---

Use this menu to check the total amount of memory for media items and the amount of memory currently in use in each media box.

## **Organiser** (Menu 7)

The **Organiser** menu enables you to keep track of your schedule and tasks, and to record voice memos. You can also set the time and date and use convenient features, such as an alarm clock, a calculator, and a currency converter.

To access this menu, press <**Menu**> in Idle mode and select **Organiser**.

### **Alarm** (Menu 7.1)

---

Use this menu to set alarms to sound at a specific time.

#### **Setting an alarm**

1. Select the type of alarm.
2. Enter the time for the alarm to sound.  
Press <**Options**> and select **Alarm tone** to change the alarm tone.
3. Press [ **z** ].
4. Select **AM** or **PM** in 12-hour time format.

5. If you selected **Morning call** in step 1, select a schedule for the alarm to work.

#### **Stopping an alarm**

When the alarm sounds, press any key.

#### **Deactivating alarms**

When you do not need an alarm to sound any longer, you can deactivate it.

- To remove an alarm set, select it from the Alarm screen, press <**Options**>, and select **Remove alarm**.
- To remove all alarm sets, select **Remove alarm** from the Alarm screen.

#### **Setting the alarm to sound even if the phone is off**

From the Alarm screen, select **Autopower** → **Enable**.

If the phone is off when it is time for the alarm to sound, the phone switches on and sounds the alarm.

## Calendar (Menu 7.2)

Use this menu to write memos on your schedule or set alarms to act as a reminder.

When you access the **Calendar** menu, the calendar in Month view appears with today's date highlighted.

### Selecting a day

- Press [Left] or [Right] to move by day.
- Press [Up] or [Down] to move by week.
- Press [▲/▼] to move by month.

### Using calendar options

From the calendar, press <**Options**> to access the following options:

- **Search all:** view all of the memos you have created.
- **Delete all:** delete all memos.
- **Go to date:** enter the specific date you want to access.
- **Exit:** exit the **Calendar** menu.

### Entering a new memo

1. Select a date on the calendar.
2. Enter your memo and press <**OK**>.
3. Press [ **⌚** ] to set an alarm to sound on the chosen day. Otherwise, press <**Skip**>.
4. Enter the time for the alarm to sound.  
Press <**Melody**> to change the alarm tone.
5. Press [ **⌚** ].
6. Select **AM** or **PM** in 12-hour format.  
The colour of the date on the calendar changes to green to indicate that a memo exists for that date.

### Viewing a memo

1. Select a date which has memos on the calendar.  
If more than one memo exists, they will display in order of their alarm times.
2. Press [Left] or [Right] to access the other memos scheduled for the selected day.

### Using calendar memo options

While viewing a memo, press **<Options>** to access the following options:

- **New:** add a new memo.
- **Edit:** edit the selected memo.
- **Alarm:** set an alarm for the memo.
- **Delete:** delete the memo.
- **Copy to:** copy the memo to another date.
- **Move to:** change the date of the memo.

### Time & Date (Menu 7.3)

---

Use this menu to change the time and date displayed on your phone. Before setting the time and date, specify your time zone in **World time**.

- **Set time:** enter the current time.
- **Set date:** enter the current date.
- **World time:** set your local time zone and find out what time it is in another part of the world.



To apply daylight savings time to time zones, press **<Options>** and select **Set daylight saving time**.

- **Time format:** select 12-hour or 24-hour time format.

### Calculator (Menu 7.4)

---

Use this menu to perform basic arithmetic functions such as addition, subtraction, multiplication, and division.

1. Enter the first number.
  - Press **<.( )>** to insert a decimal point or a bracket.
  - Press **[ \* ]** or **[ # ]** to move the cursor.
2. Press the Navigation keys to access the math function you want.
3. Enter the second number.
4. Press **[ = ]** to view the result.
5. If necessary, repeat from step 2 to continue the calculation.



## To do list (Menu 7.5)



---



Use this menu to create tasks and manage them.

### Creating a task

1. Press <**New**>.
2. Enter a task and press <**OK**>.
3. Select a priority level.
4. Enter your deadline and press [  ].

### Viewing the task

When you access the **To do list** menu, the tasks display with a check mark, if the task has been done, and a priority level indicator;  for High,  for Normal, and  for Low.

 You can change the status of a specific task by pressing [  ].

While viewing a task, press <**Options**> to access the following options:

- **New:** add a new task.
- **Mark:** change the status of the selected task.

- **Edit:** edit the task.
- **Sort:** sort the tasks by priority or status.
- **Copy:** copy the selected task.
- **Copy to calendar:** copy the task to the calendar as a memo.
- **Delete:** delete the task.
- **Delete all:** delete all tasks.
- **Exit:** exit the **To do list** menu.

## Voice memo (Menu 7.6)

---

Use this menu to record and play voice memos.

### Voice record (Menu 7.6.1)

You can record a voice memo of up to 30 seconds.

1. Press <**Record**> to start recording.
2. Speak into the microphone.
3. When you have finished, press <**Stop**>. The following options display:
  - **Replay:** play back your memo.
  - **Re-record:** discard the memo and record another one.

- **Save:** save the memo.
- **Quit:** cancel your recording and exit the **Voice record** menu.

4. Select **Save** to save the voice memo.
5. Enter a name of the voice memo and press **<OK>**.

### **Memo list** (Menu 7.6.2)

You can access the list of voice memos you have recorded.

Press **<Options>** to access the following options:

- **Play:** play the selected voice memo.
- **Send:** send the voice memo as part of an MMS message.
- **Rename:** change the file name.
- **Information:** access the file properties.
- **Delete:** delete the voice memo.

### **Delete all** (Menu 7.6.3)

You can delete all of the voice memos you have recorded at one time.

### **Memory status** (Menu 7.6.4)

You can check the total amount of memory currently in use for storing voice memos and the number of voice memos.

### **Currency exchange** (Menu 7.7)

---

Use this menu to do currency conversions.

1. Enter the rate of foreign currency and press **<OK>**.
2. Enter the amount of the source currency you want to convert and press **<OK>**.

The amount you entered and its equivalent value in the foreign currency display.

## FM Radio (Menu 8)

Use this menu to listen to music or news via the FM radio on your phone.

To access this menu, press **<Menu>** in Idle mode and select **FM radio**, or press [Down].

### Turning on and listening to the radio

First, you must connect your phone with the headset, which serves as a radio antenna.

1. Plug the connector of the supplied headset into the jack on the right side of the phone.
2. From the FM Radio screen, press **<Options>** and select **Power on/off** → **On**.
3. Press [Left] or [Right] to find the radio station you want.

You can also press and hold [Left] or [Right] to scan through available radio stations.

4. To exit the **FM Radio** menu without turning off the radio, press []. This enables you to access other functions while listening to the radio.

### Setting up a radio station list

You can store your favourite radio stations to quickly access them without searching through noisy frequencies.

1. Connect the headset to the phone and turn on the radio.
2. Select an empty location and select **Add**.
3. Enter a title for the station you want and press **<OK>**.
4. Enter the frequency of the station and press **<OK>**.
5. Select a location in which you want to store the station.
6. Repeat from step 2 to store other stations.

To listen to the stored stations, press [Up] or [Down] from the FM Radio screen.

### Turning off the radio

To turn off the radio, press **<Options>** from the radio screen and select **Power on/off** → **Off**, or disconnect the headset.

## Using radio options

---

On the FM radio screen, press <**Options**> to access the following options:.

- **Power on/off:** turn the radio on or off.
- **Add:** store a radio station.
- **Edit:** edit the title or frequency for a saved radio station.
- **Self tuning:** let the phone automatically scan through and save available radio stations.
- **Remove:** remove the selected station or all stations.
- **Pop-up alert:** set the phone to alert you to listen to the radio at a specified time. When the pop-up notification appears on the screen, press <**Listen**> to turn on the specified radio station.
- **Settings:** change the radio settings.  
**Volume:** select the radio volume.  
**Mode:** change the audio mode to the phone's speaker or headset.

## Phone settings *(Menu 9)*

The **Phone settings** menu provides you with various setting options to customise the phone to your preferences and needs. You can also reset the settings to their default status.

To access this menu, press <**Menu**> in Idle mode and select **Phone settings**.

## Infrared activate *(Menu 9.1)*

---

Use this menu to send or receive data to or from IrDA-compatible computers or phones through the infrared port.

## Connecting with a computer

Select **With PC** to use the IrDA feature with a computer.

To use an infrared connection, you must:

- configure and activate an IrDA-compliant infrared port on your PC.

- activate the infrared feature on the phone; the IrDA icon (  ) appears on the top line of the display.
- align the IrDA port on the phone with the IrDA port on your phone computer or another phone.

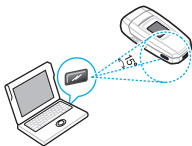

The connection is ready for data transmission.

If there is no communication between your phone and the IrDA-compliant device within 30 seconds activating the feature, it is automatically deactivated.

### Receiving Phonebook data from another phone

1. Align the IrDA ports on both phones with each other.

2. Select **With other phone** from the **Infrared activate** menu.
3. When the list of the received data displays, select one of the two options:

To save an individual item:

- a. Select the item you want from the list.
- b. Press **<Options>** and select **Save** to save the data.

Otherwise, select **Discard** to delete the data.

To save all data:

- a. From the item list, press **<Options>** to select one of the following options:
  - **Save all vCard**: save all Phonebook entries.
  - **Discard all vCard**: delete all Phonebook entries.
- b. Press **<Save>** to save the entries.

### Sending your Phonebook to another phone

1. Align the IrDA ports on both phones with each other.
2. Access **Phonebook** → **Search**.

3. Select a name.
4. Scroll to a number or e-mail address.
5. Press <**Options**> and select **Send via IrDA**.
6. Select a sending option.
  - **Selected data:** send the selected number.
  - **All data:** send all of the numbers and e-mail addresses in the name.

The number is sent to the other phone.

### Deactivating the infrared port

To end the IrDA connection and deactivate the infrared port, select **Deactivate infrared** from the **Infrared activate** menu.

## Display settings (Menu 9.2)

---

Use this menu to change settings for the display and light.

### Wallpaper (Menu 9.2.1)

You can change the background image and the settings for the text of Idle mode.

- **Wallpaper list:** select a background image.
- **Text display:** determine the phone displays the time and date.
- **Text colour:** select a text colour.

### Brightness (Menu 9.2.2)

You can adjust the brightness of the display for varying lighting conditions.

### Contrast (Menu 9.2.3)

You can adjust the contrast of the brightness for the main display and external display. Adjust this setting with the display brightness to see the display clearly in different lighting conditions.

### **Backlight** (Menu 9.2.4)

You can select the length of time the backlight or display stays on.

- **Backlight on:** select the length of time the backlight stays on.
- **Backlight dim:** select the length of time the display is in Dim mode after the backlight turns off. After a specified time, the display turns off.

### **Graphic logo** (Menu 9.2.5)

Use this menu to set the phone to display a graphic icon instead of your service provider's logo on the idle screen. This is only available if a graphic icon has been received in a message.

### **Dialling font colour** (Menu 9.2.6)

Use this menu to select a font colour for the numbers entered while dialling.

### **Greeting message** (Menu 9.3)

---

Use this menu to enter the greeting that is displayed briefly when the phone is switched on.

### **Own number** (Menu 9.4)

---

Use this feature to check your phone numbers, or to assign a name to each of the numbers. Changes made here do not affect the actual subscriber numbers on your SIM card.

### **Language** (Menu 9.5)

---

Use this menu to select one of several languages for the display text. If you select **Automatic**, the phone uses the same language as the SIM card.

### **Security** (Menu 9.6)

---

Use this menu to protect the phone against unauthorised use by managing the several access codes of your phone and SIM card.

- ☒ If you enter an incorrect PIN/PIN2 three times in succession, the SIM card is blocked. To unblock it, you need to enter your PUK/PUK2 (Personal Unblocking Key). The codes are supplied by your network operator.

### **PIN check** (Menu 9.6.1)

The 4- to 8-digit PIN (Personal Identification Number) protects your SIM card against unauthorised use. When this feature is enabled, the phone requires your PIN each time it is switched on.

### **Change PIN** (Menu 9.6.2)

Use this menu to change your PIN. The PIN check feature must be enabled to change the PIN.

### **Phone lock** (Menu 9.6.3)

Use this menu to lock the phone from unauthorised use. When this feature is enabled, you must enter a 4- to 8-digit phone password each time the phone is switched on.

The password is preset to **00000000**. To change the password, use the **Change password** menu.

### **Change password** (Menu 9.6.4)

Use this menu to change your phone password.

### **Privacy** (Menu 9.6.5)

Use this menu to lock your media content, including MMS messages, voice memos, images, and sounds.

1. Press [ **z** ] to select the items to be locked.
2. Press **<OK>** to lock the marked items.
3. Enter the phone password and press **<OK>**.

To access a locked item, you need to enter the phone password.

### **SIM lock** (Menu 9.6.6)

This menu allows your phone to work only with the current SIM by assigning a SIM lock code. You must enter the SIM lock code to use a different SIM card.

### **FDN mode** (Menu 9.6.7)

If supported by your SIM card, Fixed Dialling Number (FDN) mode restricts your outgoing calls to a limited set of phone numbers. When this feature is enabled, you can make calls only to phone numbers stored on the SIM card.



## Change PIN2 (Menu 9.6.8)

If supported by your SIM card, the Change PIN2 feature changes your current PIN2.

## Extra settings (Menu 9.7)

You can turn the automatic redialling or answering feature on or off.

- **Auto redial:** set the phone to make up to ten attempts to redial a phone number after an unsuccessful call.
- **Active folder:** answer an incoming call by opening the phone.
- **Anykey answer:** answer an incoming call by pressing any key, except <Reject> or [↵].

## Volume key (Menu 9.8)

Use this menu to set whether the phone mutes the call ringer or rejects a call if you press and hold [▲/▼] when a call comes in.

## Short cut (Menu 9.9)

You can use the Navigation keys as shortcut keys to access specific menus directly from Idle mode. Use this menu to change the shortcut assignments for [Up], [Left], and [Right]. [Down] is fixed as a shortcut to **FM Radio**.

1. Select a key to be used as a shortcut key.
2. Select a menu to be assigned to the key.

## Reset settings (Menu 9.0)

Use this menu to reset the phone to its default settings.

Enter the 4- to 8-digit phone password and press <OK>.



The password is preset to **00000000**. You can change this password. ► p. 60

## *Solve problems*

### *Help and personal needs*

To save the time and expense of an unnecessary service call, perform the simple checks in this section before contacting a service professional.

### **When you switch on your phone, the following messages may appear:**

#### **"Insert SIM card"**

- Be sure that the SIM card is correctly installed.

#### **"Phone locked"**

- The automatic locking function has been enabled. You must enter the phone's password before you can use the phone.

#### **"Enter PIN"**

- You are using your phone for the first time. You must enter the PIN supplied with the SIM card.
- The PIN check feature is enabled. Every time the phone is switched on, the PIN has to be entered. To disable this feature, use the **PIN check** menu.

#### **"Enter PUK"**

- The PIN code has been entered incorrectly three times in succession, and the SIM card is now blocked. Enter the PUK supplied by your service provider.

### **"No service," "Network failure," or "Not done" displays**

- The network connection has been lost. You may be in a weak signal area. Move and try again.
- You are trying to access an option for which you have no subscription with your service provider. Contact the service provider for further details.

### **You have entered a number but it was not dialled**

- Be sure that you have pressed [↵].
- Be sure that you have accessed the right cellular network.
- Be sure that you have not set an outgoing call barring option.

**Your correspondent cannot reach you**

- Be sure that your phone is switched on. ([] pressed for more than one second.)
- Be sure that you are accessing the correct cellular network.
- Be sure that you have not set an incoming call barring option.



**Your correspondent cannot hear you speaking**

- Be sure that you have switched **on** the microphone.
- Be sure that you are holding the phone close enough to your mouth. The microphone is located at the bottom of the phone.

**The phone starts beeping and "Warning Low battery" flashes on the display**

- Your battery is insufficiently charged. Recharge the battery.

**The audio quality of the call is poor**

- Check the signal strength indicator on the display () . The number of bars indicates the signal strength from strong () to weak () .

- Try moving the phone slightly or moving closer to a window if you are in a building.

**No number is dialled when you re-call a Phonebook entry**

- Use the **Search** menu to ensure the number has been stored correctly.
- Re-store the number, if necessary.

**The battery doesn't charge properly or the phone sometimes turns itself off**

- Wipe the charging contacts both on the phone and on the battery with a clean soft cloth.

**If the above guidelines do not help you to solve the problem, take note of:**

- The model and serial numbers of your phone
- Your warranty details
- A clear description of the problem

Then contact your local dealer or Samsung after-sales service.

## *Health and safety information*

### **Exposure to Radio Frequency (RF) Signals**

---

#### **Certification Information (SAR)**

Your wireless phone is a radio transmitter and receiver. It is designed and manufactured not to exceed the exposure limits for radio frequency (RF) energy set by the Federal Communications Commission (FCC) of the U.S. government. These FCC exposure limits are derived from the recommendations of two expert organizations, the National Council on Radiation Protection and Measurement (NCRP) and the Institute of Electrical and Electronics Engineers (IEEE). In both cases, the recommendations were developed by scientific and engineering experts drawn from industry, government, and academia after extensive reviews of the scientific literature related to the biological effects of RF energy.

The exposure limit set by the FCC for wireless mobile phones employs a unit of measurement known as the Specific Absorption Rate (SAR). The SAR is a measure of the rate of absorption of RF energy by the human body expressed in units of watts per kilogram (W/kg). The FCC requires wireless phones to comply with a safety limit of 1.6 watts per kilogram (1.6 W/kg). The FCC exposure limit incorporates a substantial margin of safety to give additional protection to the public and to account for any variations in measurements.

SAR tests are conducted using standard operating positions accepted by the FCC with the phone transmitting at its highest certified power level in all tested frequency bands. Although the SAR is determined at the highest certified power level, the actual SAR level of the phone while operating can be well below the maximum value. This is because the phone is designed to operate at multiple power levels so as to use only the power required to reach the network. In general, the closer you are to a wireless base station antenna, the lower the power output.

When approval test is done, no Samsung supplied accessories are available but maybe available later after approval.

“Before a new model phone is available for sale to the public, it must be tested and certified to the FCC that it does not exceed the exposure limit established by the FCC. Tests for each model phone are performed in positions and locations (e.g. at the ear and worn on the body) as required by the FCC. The highest SAR values for this model phone as reported to the FCC are Head: 0.823 W/Kg, Body-worn 0.246 W/Kg. For body worn operation, this model phone has been tested and meets the FCC RF exposure guidelines when used with a Samsung accessory designated for this product or when used with an accessory that contains no metal and that positions the handset a minimum of 1.5 cm from the body.”

Non-compliance with the above restrictions may result in violation of FCC RF exposure guidelines.

SAR information on this and other model phones can be viewed on-line at [www.fcc.gov/oet/fccid](http://www.fcc.gov/oet/fccid). This site

uses the phone FCC ID number, A3LSGHX300. Sometimes it may be necessary to remove the battery pack to find the number. Once you have the FCC ID number for a particular phone, follow the instructions on the website and it should provide values for typical or maximum SAR for a particular phone. Additional product specific SAR information can also be obtained at [www.fcc.gov/cgb/sar](http://www.fcc.gov/cgb/sar).

## **Consumer Information on Wireless Phones**

The U.S. Food and Drug Administration (FDA) has published a series of Questions and Answers for consumers relating to radio frequency (RF) exposure from wireless phones. The FDA publication includes the following information:

### **What kinds of phones are the subject of this update?**

The term wireless phone refers here to hand-held wireless phones with built-in antennas, often called "cell," "mobile," or "PCS" phones. These types of wireless phones can expose the user to measurable radio frequency energy (RF) because of the short distance between the phone and the user's head. These RF exposures are limited by Federal Communications Commission safety guidelines that were developed with the advice of FDA and other federal health and safety agencies. When the phone is located at greater distances from the user, the exposure to RF is drastically lower because a person's RF exposure decreases rapidly with increasing distance from the source. The so-called "cordless

phones," which have a base unit connected to the telephone wiring in a house, typically operate at far lower power levels, and thus produce RF exposures well within the FCC's compliance limits.

### **Do wireless phones pose a health hazard?**

The available scientific evidence does not show that any health problems are associated with using wireless phones. There is no proof, however, that wireless phones are absolutely safe. Wireless phones emit low levels of radio frequency energy (RF) in the microwave range while being used. They also emit very low levels of RF when in the stand-by mode. Whereas high levels of RF can produce health effects (by heating tissue), exposure to low level RF that does not produce heating effects causes no known adverse health effects. Many studies of low level RF exposures have not found any biological effects. Some studies have suggested that some biological effects may occur, but such findings have not been confirmed by additional research. In some cases, other researchers have had difficulty in reproducing those studies, or in determining the reasons for inconsistent results.

## What is FDA's role concerning the safety of wireless phones?

Under the law, FDA does not review the safety of radiation-emitting consumer products such as wireless phones before they can be sold, as it does with new drugs or medical devices. However, the agency has authority to take action if wireless phones are shown to emit radio frequency energy (RF) at a level that is hazardous to the user. In such a case, FDA could require the manufacturers of wireless phones to notify users of the health hazard and to repair, replace or recall the phones so that the hazard no longer exists.

Although the existing scientific data do not justify FDA regulatory actions, FDA has urged the wireless phone industry to take a number of steps, including the following:

- "Support needed research into possible biological effects of RF of the type emitted by wireless phones;
- "Design wireless phones in a way that minimizes any RF exposure to the user that is not necessary for device function; and

- "Cooperate in providing users of wireless phones with the best possible information on possible effects of wireless phone use on human health.

FDA belongs to an interagency working group of the federal agencies that have responsibility for different aspects of RF safety to ensure coordinated efforts at the federal level. The following agencies belong to this working group:

- "National Institute for Occupational Safety and Health
- "Environmental Protection Agency
- "Federal Communications Commission
- "Occupational Safety and Health Administration
- "National Telecommunications and Information Administration

The National Institutes of Health participates in some interagency working group activities, as well.

FDA shares regulatory responsibilities for wireless phones with the Federal Communications Commission (FCC). All phones that are sold in the United States must comply with FCC safety guidelines that limit RF

exposure. FCC relies on FDA and other health agencies for safety questions about wireless phones.

FCC also regulates the base stations that the wireless phone networks rely upon. While these base stations operate at higher power than do the wireless phones themselves, the RF exposures that people get from these base stations are typically thousands of times lower than those they can get from wireless phones. Base stations are thus not the primary subject of the safety questions discussed in this document.

### **What are the results of the research done already?**

The research done thus far has produced conflicting results, and many studies have suffered from flaws in their research methods. Animal experiments investigating the effects of radio frequency energy (RF) exposures characteristic of wireless phones have yielded conflicting results that often cannot be repeated in other laboratories. A few animal studies, however, have suggested that low levels of RF could accelerate the development of cancer in laboratory animals. However, many of the studies that showed

increased tumor development used animals that had been genetically engineered or treated with cancer-causing chemicals so as to be pre-disposed to develop cancer in absence of RF exposure. Other studies exposed the animals to RF for up to 22 hours per day. These conditions are not similar to the conditions under which people use wireless phones, so we don't know with certainty what the results of such studies mean for human health.

Three large epidemiology studies have been published since December 2000. Between them, the studies investigated any possible association between the use of wireless phones and primary brain cancer, glioma, meningioma, or acoustic neuroma, tumors of the brain or salivary gland, leukemia, or other cancers. None of the studies demonstrated the existence of any harmful health effects from wireless phones RF exposures. However, none of the studies can answer questions about long-term exposures, since the average period of phone use in these studies was around three years.



## **What research is needed to decide whether RF exposure from wireless phones poses a health risk?**

A combination of laboratory studies and epidemiological studies of people actually using wireless phones would provide some of the data that are needed. Lifetime animal exposure studies could be completed in a few years. However, very large numbers of animals would be needed to provide reliable proof of a cancer promoting effect if one exists. Epidemiological studies can provide data that is directly applicable to human populations, but ten or more years' follow-up may be needed to provide answers about some health effects, such as cancer. This is because the interval between the time of exposure to a cancer-causing agent and the time tumors develop - if they do - may be many, many years. The interpretation of epidemiological studies is hampered by difficulties in measuring actual RF exposure during day-to-day use of wireless phones. Many factors affect this measurement, such as the angle at which the phone is held, or which model of phone is used.

## **What is FDA doing to find out more about the possible health effects of wireless phone RF?**

FDA is working with the U.S. National Toxicology Program and with groups of investigators around the world to ensure that high priority animal studies are conducted to address important questions about the effects of exposure to radio frequency energy (RF).

FDA has been a leading participant in the World Health Organization international Electromagnetic Fields (EMF) Project since its inception in 1996. An influential result of this work has been the development of a detailed agenda of research needs that has driven the establishment of new research programs around the world. The Project has also helped develop a series of public information documents on EMF issues.

FDA and Cellular Telecommunications & Internet Association (CTIA) have a formal Cooperative Research and Development Agreement (CRADA) to do research on wireless phone safety. FDA provides the scientific oversight, obtaining input from experts in government, industry, and academic organizations. CTIA-funded research is conducted through contracts

to independent investigators. The initial research will include both laboratory studies and studies of wireless phone users. The CRADA will also include a broad assessment of additional research needs in the context of the latest research developments around the world.

### **What steps can I take to reduce my exposure to radio frequency energy from my wireless phone?**

If there is a risk from these products - and at this point we do not know that there is - it is probably very small. But if you are concerned about avoiding even potential risks, you can take a few simple steps to minimize your exposure to radio frequency energy (RF). Since time is a key factor in how much exposure a person receives, reducing the amount of time spent using a wireless phone will reduce RF exposure.

- "If you must conduct extended conversations by wireless phone every day, you could place more distance between your body and the source of the RF, since the exposure level drops off dramatically with distance. For example, you could use a

headset and carry the wireless phone away from your body or use a wireless phone connected to a remote antenna.

Again, the scientific data do not demonstrate that wireless phones are harmful. But if you are concerned about the RF exposure from these products, you can use measures like those described above to reduce your RF exposure from wireless phone use.

### **What about children using wireless phones?**

The scientific evidence does not show a danger to users of wireless phones, including children and teenagers. If you want to take steps to lower exposure to radio frequency energy (RF), the measures described above would apply to children and teenagers using wireless phones. Reducing the time of wireless phone use and increasing the distance between the user and the RF source will reduce RF exposure.

Some groups sponsored by other national governments have advised that children be discouraged from using wireless phones at all. For

example, the government in the United Kingdom distributed leaflets containing such a recommendation in December 2000. They noted that no evidence exists that using a wireless phone causes brain tumors or other ill effects. Their recommendation to limit wireless phone use by children was strictly precautionary; it was not based on scientific evidence that any health hazard exists.

### **Do hands-free kits for wireless phones reduce risks from exposure to RF emissions?**

Since there are no known risks from exposure to RF emissions from wireless phones, there is no reason to believe that hands-free kits reduce risks. Hands-free kits can be used with wireless phones for convenience and comfort. These systems reduce the absorption of RF energy in the head because the phone, which is the source of the RF emissions, will not be placed against the head. On the other hand, if the phone is mounted against the waist or other part of the body during use, then that part of the body will absorb more RF energy. Wireless phones marketed in the U.S. are required to meet safety requirements regardless of whether they

are used against the head or against the body. Either configuration should result in compliance with the safety limit.

### **Do wireless phone accessories that claim to shield the head from RF radiation work?**

Since there are no known risks from exposure to RF emissions from wireless phones, there is no reason to believe that accessories that claim to shield the head from those emissions reduce risks. Some products that claim to shield the user from RF absorption use special phone cases, while others involve nothing more than a metallic accessory attached to the phone. Studies have shown that these products generally do not work as advertised. Unlike "hand-free" kits, these so-called "shields" may interfere with proper operation of the phone. The phone may be forced to boost its power to compensate, leading to an increase in RF absorption. In February 2002, the Federal Trade Commission (FTC) charged two companies that sold devices that claimed to protect wireless phone users from radiation with making false and unsubstantiated

claims. According to FTC, these defendants lacked a reasonable basis to substantiate their claim.

### **What about wireless phone interference with medical equipment?**

Radio frequency energy (RF) from wireless phones can interact with some electronic devices. For this reason, FDA helped develop a detailed test method to measure electromagnetic interference (EMI) of implanted cardiac pacemakers and defibrillators from wireless telephones. This test method is now part of a standard sponsored by the Association for the Advancement of Medical instrumentation (AAMI). The final draft, a joint effort by FDA, medical device manufacturers, and many other groups, was completed in late 2000. This standard will allow manufacturers to ensure that cardiac pacemakers and defibrillators are safe from wireless phone EMI. FDA has tested wireless phones and helped develop a voluntary standard sponsored by the Institute of Electrical and Electronic Engineers (IEEE). This standard specifies test methods and performance requirements for hearing aids and wireless phones so that no interference occurs when a

person uses a compatible phone and a compatible hearing aid at the same time. This standard was approved by the IEEE in 2000.

FDA continues to monitor the use of wireless phones for possible interactions with other medical devices. Should harmful interference be found to occur, FDA will conduct testing to assess the interference and work to resolve the problem.

Additional information on the safety of RF exposures from various sources can be obtained from the following organizations:

- FCC RF Safety Program:  
<http://www.fcc.gov/oet/rfsafety/>
- Environmental Protection Agency (EPA):  
<http://www.epa.gov/radiation/>
- Occupational Safety and Health Administration's (OSHA):  
<http://www.osha.gov/SLTC/radiofrequencyradiation/index.html>

- National institute for Occupational Safety and Health (NIOSH):  
<http://www.cdc.gov/niosh/emfpg.html>
- World health Organization (WHO):  
<http://www.who.int/peh-emf/>
- International Commission on Non-Ionizing Radiation Protection:  
<http://www.icnirp.de>
- National Radiation Protection Board (UK):  
<http://www.nrpb.org.uk>
- Updated 4/3/2002: US food and Drug Administration  
<http://www.fda.gov/cellphones>

## Road Safety

---

Your wireless phone gives you the powerful ability to communicate by voice, almost anywhere, anytime. But an important responsibility accompanies the benefits of wireless phones, one that every user must uphold.

When driving a car, driving is your first responsibility. When using your wireless phone behind the wheel of a car, practice good common sense and remember the following tips:

1. Get to know your wireless phone and its features, such as speed dial and redial. If available, these features help you to place your call without taking your attention off the road.
2. When available, use a hands-free device. If possible, add an additional layer of convenience and safety to your wireless phone with one of the many hands free accessories available today.

3. Position your wireless phone within easy reach. Be able to access your wireless phone without removing your eyes from the road. If you get an incoming call at an inconvenient time, let your voice mail answer it for you.
4. Let the person you are speaking with know you are driving; if necessary, suspend the call in heavy traffic or hazardous weather conditions. Rain, sleet, snow, ice and even heavy traffic can be hazardous.
5. Do not take notes or look up phone numbers while driving. Jotting down a "to do" list or flipping through your address book takes attention away from your primary responsibility, driving safely.
6. Dial sensibly and assess the traffic; if possible, place calls when you are not moving or before pulling into traffic. Try to plan calls when your car will be stationary. If you need to make a call while moving, dial only a few numbers, check the road and your mirrors, then continue.
7. Do not engage in stressful or emotional conversations that may be distracting. Make people you are talking with aware you are driving and suspend conversations that have the potential to divert your attention from the road.
8. Use your wireless phone to call for help. Dial 9-1-1 or other local emergency number in the case of fire, traffic accident or medical emergencies. Remember, it is a free call on your wireless phone!
9. Use your wireless phone to help others in emergencies. If you see an auto accident, crime in progress or other serious emergency where lives are in danger, call 9-1-1 or other local emergency number, as you would want others to do for you.
10. Call roadside assistance or a special non-emergency wireless assistance number when necessary. If you see a broken-down vehicle posing no serious hazard, a broken traffic signal, a minor traffic accident where no one appears injured, or a vehicle you know to be stolen, call roadside assistance or other special non-emergency number.

**“The wireless industry reminds you to use your phone safely when driving.”**

For more information, please call 1-888-901-SAFE, or visit our web-site [www.wow-com.com](http://www.wow-com.com)

Provided by the Cellular Telecommunications & Internet Association

**Operating Environment**

---

Remember to follow any special regulations in force in any area and always switch your phone off whenever it is forbidden to use it, or when it may cause interference or danger. When connecting the phone or any accessory to another device, read its user's guide for detailed safety instructions. Do not connect incompatible products.

As with other mobile radio transmitting equipment, users are advised that for the satisfactory operation of the equipment and for the safety of personnel, it is recommended that the equipment should only be used in the normal operating position (held to your ear with the antenna pointing over your shoulder).

**Using Your Phone Near Other Electronic Devices**

---

Most modern electronic equipment is shielded from radio frequency (RF) signals. However, certain electronic equipment may not be shielded against the RF signals from your wireless phone. Consult the manufacturer to discuss alternatives.

**Pacemakers**

Pacemaker manufacturers recommend that a minimum distance of 15 cm (6 inches) be maintained between a wireless phone and a pacemaker to avoid potential interference with the pacemaker.

These recommendations are consistent with the independent research and recommendations of Wireless Technology Research.

**Persons with pacemakers:**

- should always keep the phone more than 15 cm (6 inches) from their pacemaker when the phone is switched on.
- should not carry the phone in a breast pocket.

- should use the ear opposite the pacemaker to minimize potential interference.

If you have any reason to suspect that interference is taking place, switch your phone off immediately.

### **Hearing Aids**

Some digital wireless phones may interfere with some hearing aids. In the event of such interference, you may wish to consult your hearing aid manufacturer to discuss alternatives.

### **Other Medical Devices**

If you use any other personal medical devices, consult the manufacturer of your device to determine if it is adequately shielded from external RF energy. Your physician may be able to assist you in obtaining this information. Switch your phone off in health care facilities when any regulations posted in these areas instruct you to do so. Hospitals or health care facilities may be using equipment that could be sensitive to external RF energy.

### **Vehicles**

RF signals may affect improperly installed or inadequately shielded electronic systems in motor vehicles. Check with the manufacturer or its representative regarding your vehicle. You should also consult the manufacturer of any equipment that has been added to your vehicle.

### **Posted Facilities**

Switch your phone off in any facility where posted notices require you to do so.

### **Potentially Explosive Environments**

---

Switch your phone off when in any area with a potentially explosive atmosphere and obey all signs and instructions. Sparks in such areas could cause an explosion or fire resulting in bodily injury or even death.

Users are advised to switch the phone off while at a refueling point (service station). Users are reminded of the need to observe restrictions on the use of radio equipment in fuel depots (fuel storage and distribution



areas), chemical plants or where blasting operations are in progress.

Areas with a potentially explosive atmosphere are often but not always clearly marked. They include below deck on boats, chemical transfer or storage facilities, vehicles using liquefied petroleum gas (such as propane or butane), areas where the air contains chemicals or particles, such as grain, dust or metal powders, and any other area where you would normally be advised to turn off your vehicle engine.

## **Emergency Calls**

---

This phone, like any wireless phone, operates using radio signals, wireless and landline networks as well as user programmed functions, which cannot guarantee connection in all conditions. Therefore, you should never rely solely on any wireless phone for essential communications (medical emergencies, for example).

Remember, to make or receive any calls the phone must be switched on and in a service area with adequate signal strength. Emergency calls may not be

possible on all wireless phone networks or when certain network services and/or phone features are in use. Check with local service providers.

To make an emergency call:

1. If the phone is not on, switch it on.
2. Key in the emergency number for your present location (for example, 911 or other official emergency number). Emergency numbers vary by location.
3. Press .

If certain features are in use (call barring, for example), you may first need to deactivate those features before you can make an emergency call. Consult this document and your local cellular service provider.

When making an emergency call, remember to give all the necessary information as accurately as possible. Remember that your phone may be the only means of communication at the scene of an accident; do not cut off the call until given permission to do so.

## **Restricting Children's access to your Phone**

Your phone is not a toy. Children should not be allowed to play with it because they could hurt themselves and others, damage the phone or make calls that increase your phone bill.

## **FCC Notice and Cautions**

---

### **FCC Notice**

- ☑ This device complies with Part 15 of the FCC Rules. Operation is subject to the following two conditions: (1) this device may not cause harmful interference, and (2) this device must accept any interference received, including interference that may cause undesired operation.

The phone may cause TV or radio interference if used in close proximity to receiving equipment. The FCC can require you to stop using the phone if such interference cannot be eliminated.

Vehicles using liquefied petroleum gas (such as propane or butane) must comply with the National Fire Protection Standard (NFPA-58). For a copy of this standard, contact the National Fire Protection Association, One Battery march Park, Quincy, MA 02269, Attn: Publication Sales Division.

### **Cautions**

Changes or modifications made in the radio phone, not expressly approved by Samsung, will void the user's authority to operate the equipment.

Only use approved batteries, antennas and chargers. The use of any unauthorized accessories may be dangerous and void the phone warranty if said accessories cause damage or a defect to the phone.

Although your phone is quite sturdy, it is a complex piece of equipment and can be broken. Avoid dropping, hitting, bending or sitting on it.

## **Other Important Safety Information**

---

- Only qualified personnel should service the phone or install the phone in a vehicle. Faulty installation or service may be dangerous and may invalidate any warranty applicable to the device.
  - Check regularly that all wireless phone equipment in your vehicle is mounted and operating properly.
  - Do not store or carry flammable liquids, gases or explosive materials in the same compartment as the phone, its parts or accessories.
  - For vehicles equipped with an air bag, remember that an air bag inflates with great force. Do not place objects, including both installed or portable wireless equipment in the area over the air bag or in the air bag deployment area. If wireless equipment is improperly installed and the air bag inflates, serious injury could result.
  - Switch your phone off before boarding an aircraft. The use of wireless phone in aircraft is illegal and may be dangerous to the aircraft's operation.
- Failure to observe these instructions may lead to the suspension or denial of telephone services to the offender, or legal action, or both.

## **Product Performance**

---

### **Getting the Most Out of Your Signal Reception**

The quality of each call you make or receive depends on the signal strength in your area. Your phone informs you of the current signal strength by displaying a number of bars next to the signal strength icon. The more bars displayed, the stronger the signal.

If you're inside a building, being near a window may give you better reception.

### **Understanding the Power Save Feature**

If your phone is unable to find a signal after 15 minutes of searching, a Power Save feature is automatically activated. If your phone is active, it periodically rechecks service availability or you can check it yourself by pressing any key.

Anytime the Power Save feature is activated, a message displays on the screen. When a signal is found, your phone returns to standby mode.

### **Understanding How Your Phone Operates**

Your phone is basically a radio transmitter and receiver. When it's turned on, it receives and transmits radio frequency (RF) signals. When you use your phone, the system handling your call controls the power level. This power can range from 0.006 watts to 0.2 watts in digital mode.

### **Maintaining Your Phone's Peak Performance**

For the best care of your phone, only authorized personnel should service your phone and accessories. Faulty service may void the warranty.

There are several simple guidelines to operating your phone properly and maintaining safe, satisfactory service.

- Hold the phone with the antenna raised, fully-extended and over your shoulder.
- Try not to hold, bend or twist the phone's antenna.
- Don't use the phone if the antenna is damaged.
- Speak directly into the phone's receiver.

- Avoid exposing your phone and accessories to rain or liquid spills. If your phone does get wet, immediately turn the power off and remove the battery. If it is inoperable, call Customer Care for service.

### **Availability of Various Features/Ring Tones**

---

Many services and features are network dependent and may require additional subscription and/or usage charges. Not all features are available for purchase or use in all areas. Downloadable Ring Tones may be available at an additional cost. Other conditions and restrictions may apply. See your service provider for additional information.

### **Battery Standby and Talk Time**

---

Standby and talk times will vary depending on phone usage patterns and conditions. Battery power consumption depends on factors such as network configuration, signal strength, operating temperature,

features selected, frequency of calls, and voice, data, and other application usage patterns.

### **Battery Precautions**

---

- Never use any charger or battery that is damaged in any way.
- Use the battery only for its intended purpose.
- If you use the phone near the network's base station, it uses less power; talk and standby time are greatly affected by the signal strength on the cellular network and the parameters set by the network operator.
- Battery charging time depends on the remaining battery charge and the type of battery and charger used. The battery can be charged and discharged hundreds of times, but it will gradually wear out. When the operation time (talk time and standby time) is noticeably shorter than normal, it is time to buy a new battery.
- If left unused, a fully charged battery will discharge itself over time.

- Use only Samsung-approved batteries and recharge your battery only with Samsung-approved chargers. When a charger is not in use, disconnect it from the power source. Do not leave the battery connected to a charger for more than a week, since overcharging may shorten its life.
- Extreme temperatures will affect the charging capacity of your battery: it may require cooling or warming first.
- Do not leave the battery in hot or cold places, such as in a car in summer or winter conditions, as you will reduce the capacity and lifetime of the battery. Always try to keep the battery at room temperature. A phone with a hot or cold battery may temporarily not work, even when the battery is fully charged. Li-ion batteries are particularly affected by temperatures below 0 °C (32 °F).
- Do not short-circuit the battery. Accidental short-circuiting can occur when a metallic object (coin, clip or pen) causes a direct connection between the + and - terminals of the battery (metal strips on the battery), for example when you carry a spare

battery in a pocket or bag. Short-circuiting the terminals may damage the battery or the object causing the short-circuiting.

- Dispose of used batteries in accordance with local regulations. In some areas, the disposal of batteries in household or business trash may be prohibited. For safe disposal options for Li-Ion batteries, contact your nearest Samsung authorized service center. Always recycle. Do not dispose of batteries in a fire.

## **Care and Maintenance**

---

Your phone is a product of superior design and craftsmanship and should be treated with care. The suggestions below will help you fulfill any warranty obligations and allow you to enjoy this product for many years.

- Keep the phone and all its parts and accessories out of the reach of small children.
- Keep the phone dry. Precipitation, humidity and liquids contain minerals that will corrode electronic circuits.

- Do not use the phone with a wet hand. Doing so may cause an electric shock to you or damage to the phone.
- Do not use or store the phone in dusty, dirty areas, as its moving parts may be damaged.
- Do not store the phone in hot areas. High temperatures can shorten the life of electronic devices, damage batteries, and warp or melt certain plastics.
- Do not store the phone in cold areas. When the phone warms up to its normal operating temperature, moisture can form inside the phone, which may damage the phone's electronic circuit boards.
- Do not drop, knock or shake the phone. Rough handling can break internal circuit boards.
- Do not use harsh chemicals, cleaning solvents or strong detergents to clean the phone. Wipe it with a soft cloth slightly dampened in a mild soap-and-water solution.
- Do not paint the phone. Paint can clog the device's moving parts and prevent proper operation.
- Do not put the phone in or on heating devices, such as a microwave oven, a stove or a radiator. The phone may explode when overheated.
- When the phone or battery gets wet, the label indicating water damage inside the phone changes color. In this case, phone repairs are no longer guaranteed by the manufacturer's warranty, even if the warranty for your phone has not expired.
- If your phone has a flash or light, do not use it too close to the eyes of people or animals. This may cause damage to their eyes.
- Use only the supplied or an approved replacement antenna. Unauthorized antennas or modified accessories may damage the phone and violate regulations governing radio devices.
- If the phone, battery, charger or any accessory is not working properly, take it to your nearest qualified service facility. The personnel there will assist you, and if necessary, arrange for service.

# *Index*

## **A**

ABC mode, text input • 19  
Active folder • 61  
Alarm • 50  
Answering  
    call • 23  
    second call • 24  
Anykey answer • 61  
Auto redial • 61

## **B**

Background image • 58  
Backlight, set • 59  
Band selection • 34  
Barring, calls • 32  
Battery  
    charging • 7  
    low indicator • 8  
    precautions • 65  
Brightness, display • 58  
Broadcast messages • 40  
Browser, web • 45

## **C**

Calculator • 52

Calendar • 51  
Call cost • 31  
Call records  
    dialled • 30  
    missed • 29  
    received • 30

Call time • 30

Caller group  
    editing • 27  
    searching • 27

Caller ID • 33

Calls

    answering • 23  
    barring • 32  
    diverting • 31  
    holding • 24  
    making • 22  
    redialling • 22  
    rejecting • 23  
    waiting • 32

CB (Cell Broadcast) messages • 40

Characters, enter • 19  
Connection tone • 36  
Contrast, display • 58

Creating messages

    MMS • 42  
    SMS • 37

CUG (Closed User Group) • 33

Currency converter • 54

## **D**

Date, set • 52

Deleting

    calendar memos • 52  
    call records • 30  
    downloaded items • 49  
    MMS • 41, 42, 43  
    phonebook • 26, 28  
    SMS • 36, 43  
    tasks • 53  
    voice memos • 54

Delivery reports, message • 44

Dialled calls • 30

Dialling font, set • 59

Display

    backlight, set • 59  
    brightness • 58  
    contrast • 58  
    icons • 10

    language • 59

    layout • 10

    settings • 58

Diverting calls • 31

DTMF tones, send • 25

## **E**

Emergency calls • 68

Emoticons • 38

## **F**

FDN (Fixed Dialling Number)

    mode • 60

FM radio • 55

Folder tone • 35

Funbox • 45

## **G**

Games • 48

Greeting message • 59

## **H**

Health and safety • 64

Holding, call • 24

## **I**

Icons, description • 10



Images, downloaded • 49  
 Inbox, messages  
     MMS • 41  
     SMS • 36  
 Infrared port • 56  
 International calls • 22  
 Internet • 45  
**J**  
 Java applications • 48  
**K**  
 Keypad tones  
     selecting • 35  
     sending/muting • 25  
     volume • 35  
**L**  
 Language, select • 59  
 Last number, redial • 22  
 Locking  
     media content • 60  
     phone • 60  
     SIM card • 60  
 Low battery indicator • 8  
**M**  
 Memory status  
     downloaded items • 49

    messages • 43  
     phonebook • 28  
 Message tone • 35  
 Messages  
     cell broadcast • 40  
     greeting • 59  
     MMS • 41  
     push • 45  
     SMS • 36  
     voice • 40  
 Minute minder • 35  
 Missed calls • 29  
 MMS messages  
     creating/sending • 42  
     deleting • 41, 42  
     setting • 44  
     viewing • 41  
 Multiparty-call • 25  
**N**  
 Names  
     entering • 19  
     searching • 26  
 Network band, selection • 33  
 Network services • 31  
 Numbers  
     searching • 26  
     storing • 26

**O**  
 Organiser • 50  
 Outbox, messages  
     MMS • 41  
     SMS • 36  
**P**  
 Password  
     call barring • 32  
     phone • 60  
 Phone  
     care and maintenance • 69  
     display • 10  
     icons • 10  
     locking • 13, 60  
     password • 60  
     resetting • 61  
     switching on/off • 8  
     unpacking • 6  
 Phonebook  
     adding • 26  
     deleting • 26, 28  
     finding • 26  
     options • 26  
     speed dialling • 28  
 PIN, change • 60  
 PIN2, change • 61

Power on/off tone • 35  
 Privacy • 60  
 Problems, solve • 62  
 Push messages • 45  
**R**  
 Radio • 55  
 Received calls • 30  
 Redialling  
     automatically • 61  
     manually • 22  
 Resetting phone • 61  
 Ringer  
     incoming calls • 34  
     messages • 35  
 Road safety • 66  
 Roaming • 33  
**S**  
 Safety  
     information • 64  
     precautions • 1  
 SDN (Service Dialling Numbers) • 29  
 Security, calls • 59  
 Sent messages  
     MMS • 41  
     SMS • 36

- Shortcut • 13, 61
- Silent mode • 13
- SIM card
  - inserting • 7
  - locking • 60
- SMS messages
  - creating/sending • 37
  - deleting • 36, 39
  - setting • 39
  - viewing • 36
- Sound settings • 34
- Sounds, downloaded • 49
- Speakerphone • 25
- Speed dial • 28
- Switching on/off
  - microphone • 25
  - phone • 8

### **T**

- T9 mode, text input • 20
- Templates
  - emoticon • 38
  - MMS • 43
  - SMS • 38
- Text, enter • 19
- Time, set • 52

### **V**

- Voice memos • 53
- Voicemail server • 40
- Volume key, set • 61

### **W**

- Waiting call • 32
- Wallpaper • 58
- Web browser
  - access • 45
  - bookmarks • 46
- World time • 52