

- \* Depending on the software installed or your service provider or country, some of the descriptions in this guide may not match your phone exactly.
- \* Depending on your country, your phone and accessories may appear different from the illustrations in this guide.

**SAMSUNG ELECTRONICS**





Only for Marketing

# **SGH-Z240**

## **User's Guide**



# Important safety precautions

- ☒ Failure to comply with the following precautions may be dangerous or illegal.

## Copyright information

- Bluetooth® is a registered trademark of the Bluetooth SIG, Inc. worldwide.
- Java™ is a trademark or registered trademark of Sun Microsystems, Inc.
- Picsel and Picsel Viewer™ are trademarks of Picsel Technologies, Inc.

## Drive safely at all times

Do not use a hand-held phone while driving. Park your vehicle first.

## Switch off the phone when refuelling

Do not use the phone at a refuelling point (service station) or near fuels or chemicals.

## Switch off in an aircraft

Wireless phones can cause interference. Using them in an aircraft is both illegal and dangerous.

## Switch off the phone near all medical equipment

Hospitals or health care facilities may be using equipment that could be sensitive to external radio frequency energy. Follow any regulations or rules in force.

## Interference

All wireless phones may be subject to interference, which could affect their performance.

## Be aware of special regulations

Meet any special regulations in force in any area and always switch off your phone whenever it is forbidden to use it, or when it may cause interference or danger.

## Water resistance

Your phone is not water-resistant. Keep it dry.

## Sensible use

Use only in the normal position (held to your ear). Avoid unnecessary contact with the antenna when the phone is switched on.

## Emergency calls

Key in the emergency number for your present location, then press .

## Keep your phone away from small children

Keep the phone and all its parts, including accessories, out of the reach of small children.

## Accessories and batteries

Use only Samsung-approved batteries and accessories, such as headsets and PC data cables. Use of any unauthorised accessories could damage you or your phone and may be dangerous.

- The phone could explode if the battery is replaced with an incorrect type.
- Dispose of used batteries according to the manufacturer's instructions.



At very high volumes, prolonged listening to a headset can damage your hearing.

## Qualified service

Only qualified service personnel may repair your phone.

For more detailed safety information, see "Health and safety information" on page 32.

# About this Guide

This User's Guide provides you with condensed information about how to use your phone.

In this guide, the following instruction icons appear:



Indicates that you need to pay careful attention to the subsequent information regarding safety or phone features.



Indicates that you need to press the Navigation keys to scroll to the specified option and then select it.



Indicates a key on the phone. For example, [↶]



Indicates a soft key, whose function is displayed on the phone screen. For example, <**Select**>



- **3G**

Your phone is capable of operating in a 3G environment, allowing much greater data transfer speed, video streaming, and video conferencing.

## *Special features of your phone*



- **Camera and camcorder**

Use the camera module on your phone to take a photo or record a video.



- **Media player**

Play media files on your phone. You can enjoy high quality videos and music.



- **Java**

Enjoy Java™-based embedded games and download new games.



- **Image editor**

Crop, resize, rotate, and decorate your photos.



- **Photo printing**

Print your photos to preserve your best moments forever.



- **Bluetooth**

Transfer media files and personal data, and connect to other devices using wireless Bluetooth technology.



- **File viewer**

Open documents in various formats on the phone without corruption.



- **Web browser**

Access the wireless web to get up-to-the-minute information and a wide variety of media content.

## Contents

### **Unpack 6**

*Make sure you have each item*

### **Get started 6**

*First steps to operating your phone*

Assemble and charge the phone .....	6
Power on or off.....	7
Phone layout.....	7
Keys and icons .....	8
Access menu functions .....	11
Enter text .....	11
Customise your phone.....	12

### **Step outside the phone 14**

*Begin with call functions, camera, media player, web browser, and other special features*

Make or answer calls.....	14
Use the camera .....	15
Play music .....	16
Browse the web.....	18

Use Phonebook .....	18
Send messages.....	19
View messages .....	21
Use Bluetooth .....	21
Switch applications.....	23
Replace the front cover .....	23

### **Menu functions 24**

*All menu options listed*

### **Health and safety information 32**

## Overview of menu functions

To access Menu mode, press [OK/↵] in Idle mode.

### 1 Call log

### 2 Contacts

### 3 Media player

### 4 Internet

- 1 Go to homepage
- 2 Enter URL
- 3 Bookmarks
- 4 Saved pages
- 5 History
- 6 Advanced
- 7 Browser settings

### 5 Messages

- 1 Create message
- 2 Inbox
- 3 Email inbox
- 4 Drafts
- 5 Outbox
- 6 Sentbox
- 7 My folders
- 8 Templates
- 9 Media album
- 10 Delete all
- 11 Messages settings
- 12 Memory status

### 6 My files

- 1 Images
- 2 Videos
- 3 Sounds
- 4 Games and more
- 5 Other files
- 6 To album
- 7 Memory status

### 7 Calendar

### 8 Camera

### 9 Bluetooth

### \* Applications

- 1 Memo
- 2 Tasks
- 3 Voice recorder
- 4 World clock
- 5 Calculator
- 6 Converter
- 7 Timer
- 8 Stopwatch
- 9 SIM application toolkit<sup>1</sup>

### 0 Alarms

### # Settings

- 1 Phone profiles
- 2 Time & date
- 3 Display & light settings
- 4 Phone settings
- 5 Call settings
- 6 Security
- 7 Application settings
- 8 Network settings
- 9 Memory settings
- 10 Master reset

1. Available only if supported by your USIM/SIM card.



## Unpack

Make sure you have each item

- Phone
- Travel Adapter
- Battery
- Additional front and battery covers
- User's Guide

You can obtain various accessories from your local Samsung dealer.

- ☒ The items supplied with your phone and the accessories available at your Samsung dealer may vary, depending on your country or service provider.

## Get started

First steps to operating your phone

### Assemble and charge the phone

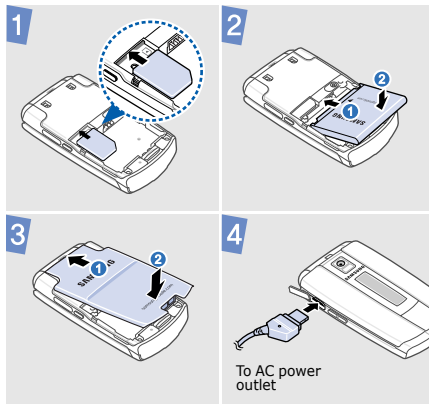

## Removing the battery cover



## Power on or off

### Switch on

1. Open the phone.
2. Press and hold [Power].
3. If necessary, enter the PIN and press **<Confirm>**.

### Switch off

1. Open the phone.
2. Press and hold [Power].

## Phone layout With the phone open

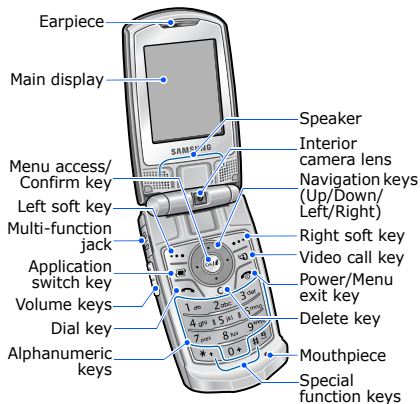

## With the phone closed

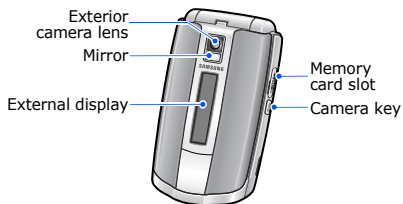

## Keys and icons

### Keys



Perform the function indicated on the bottom line of the display.



In Idle mode, access your favourite menus directly.

In Menu mode, scroll through menu options.



In Idle mode, access Menu mode.

In Menu mode, select the highlighted menu option or confirm input.



Open the application switch window to access other applications without exiting the current application.



Make or answer a call.

In Idle mode, retrieve the numbers recently dialed, missed, or received.



Delete characters from the display or items in an application.



Make a video call.



Press and hold to switch the phone on or off.  
End a call.  
In Menu mode, cancel input and return the phone to Idle mode.



Enter numbers, letters, and some special characters.



Enter special characters or perform special functions.



Adjust the phone volume.



In Idle mode, press and hold to turn on the camera.  
In Camera mode, take a photo or record a video.

## Icons

The following icons may appear on the top line of the screen to indicate your phone's status. Depending on your country or service provider, the icons shown on the display may vary.



Signal strength



GPRS (2.5G) network



Connecting to GPRS (2.5G) network or transferring data in GPRS (2.5G) network



EDGE network



Connecting to EDGE network or transferring data in EDGE network



UMTS (3G) network



Connecting to UMTS (3G) network or transferring data in UMTS (3G) network



HSDPA (3G+) network



Connecting to HSDPA (3G+) network or transferring data in HSDPA (3G+) network



Voice call in progress



Out of your service area



Video call in progress



Out of your service area



Roaming network



Bluetooth active



Connected with PC via a USB port



Browsing Internet



Connected to secured web page



Memory card inserted



New message:

- : Text message
- : Multimedia message
- : Email
- : Voicemail
- : Push
- : Configuration message



Inbox full:

- : Text message
- : Multimedia message
- : Email
- : Voicemail
- : Push
- : Configuration message



Profile setting

- : Normal
- : Silent
- : Driving
- : Meeting
- : Outdoor
- : Offline



Battery power level

## Access menu functions

Select an option	<ol style="list-style-type: none"><li>1. Press a desired soft key.</li><li>2. Press the Navigation keys to move to the next or previous option.</li><li>3. Press &lt;<b>Select</b>&gt; or [OK/↵] to confirm the function displayed or option highlighted.</li><li>4. Press &lt;<b>Back</b>&gt; to move up one level. Press [⏮] to return to Idle mode.</li></ol>
Use menu numbers	Press the number key corresponding to the option you want.

## Enter text

Change the text input mode	<ul style="list-style-type: none"><li>• Press and hold [*] to switch between T9 mode (T9SAb) and ABC mode (Abc).</li><li>• Press [*] to change case or switch to Number mode (123).</li><li>• Press and hold [#] to switch to Symbol mode.</li></ul>
ABC mode	<p>To enter a word:</p> <p>Press the appropriate key until the character you want appears on the display.</p>
T9 mode	<p>To enter a word:</p> <ol style="list-style-type: none"><li>1. Press [2] to [9] to start entering a word.</li><li>2. Enter the whole word before editing or deleting characters.</li></ol>

	3. When the word displays correctly, press [#] to insert a space. Otherwise, press [0] to display alternative word choices.
Number mode	Press the keys corresponding to the digits you want.
Symbol mode	Press the corresponding number key to select a symbol.
Other operations	<ul style="list-style-type: none"><li>• Press [1] to enter punctuation marks or special characters.</li><li>• Press [#] to insert a space.</li><li>• Press the Navigation keys to move the cursor.</li><li>• Press [C] to delete characters one by one.</li><li>• Press and hold [C] to clear the entire display.</li></ul>

## Customise your phone

### Display language

1. In Idle mode, press [OK/↵] and select **Settings** → **Phone settings** → **Language** → **Screen text**.
2. Select a language.
3. Press <Save>.

### Call ringer melody

#### To change the profile properties:

1. In Idle mode, press [OK/↵] and select **Settings** → **Phone profiles**.
2. Scroll to the sound profile you are using.
3. Press <Options> and select **Edit**.
4. Select **Voice call ringtone** → a ringtone.

- 
5. Select **Video call ringtone** → a ringtone.
  6. Press <**Options**> and select **Save**.

To change the sound profile:

1. In Idle mode, press [OK/↵] and select **Settings** → **Phone profiles**.
2. Select the profile you want.

---

#### Key tone volume

In Idle mode, press [▲/▼] to adjust the key tone volume.

---

#### Idle mode wallpaper

1. In Idle mode, press [OK/↵] and select **Settings** → **Display & light settings** → **Display settings** → **Wallpaper** → **Pictures** → **Images**.

- 
2. Select an image category.
  3. Select an image.
  4. Press <**Set**>.

---

#### Menu shortcuts

1. In Idle mode, press [OK/↵] and select **Settings** → **Phone settings** → **Shortcuts**.
2. Select a key.
3. Select a menu to be assigned to the key.

---

#### Silent profile

You can activate the Silent profile to avoid disturbing other people. In Idle mode, press and hold [#].



## Phone lock

1. In Idle mode, press [OK/↵] and select **Settings** → **Security** → **Change phone password**.
2. Enter a new 4- to 8-digit password and press <**Confirm**>.
3. Enter the new password again and press <**Confirm**>.
4. Select **Phone lock**.
5. Select **On**.
6. Enter the password and press <**Confirm**>.

## Step outside the phone

*Begin with call functions, camera, media player, web browser, and other special features*

## Make or answer calls

### Make a call

#### To make a voice call:



1. In Idle mode, enter an area code and phone number.
2. Press [↵].  
Press [▲/▼] to adjust the volume.
3. Press [⏏] to end the call.

#### To make a video call:

1. In Idle mode, enter an area code and phone number.
2. Press [📞].
3. Press [⏏] to end the call.



---

### Answer a call

1. When the phone rings, press [.
2. Press [] to end the call.

---

### Use the speakerphone feature

During a voice call, press [] and then <**Yes**> to activate the speaker.  
Press [] again to switch back to the earpiece.

---

### Make a multi-party call

1. During a call, call the second participant.  
The first call is put on hold.
2. Press <**Options**> and select **Join**.
3. Repeat step 1 and 2 to add more participants.

---

### 4. During a multi-party call:

- Press <**Options**> and select **Split** to have a private conversation with one participant.
- Press <**Options**> and select **End** → **Select participant** → a participant you want to drop → **Drop** to drop one participant.

5. Press [] to end the multi-party call.

---

## Use the camera

### Take a photo

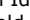
1. In Idle mode, press and hold [/00] to turn on the camera.
2. Aim the lens at the subject and make any desired adjustments.

### Take a photo (continued)

3. Press [OK/✓] or [⏏/⏏] to take a photo. The photo is saved automatically.
4. Press <📷> to take another photo.

### View a photo

1. In Idle mode, press [OK/✓] and select **My files** → **Images** → **My photos**.
2. Select the photo you want.

### Record a video

1. In Idle mode, press and hold [⏏/⏏] to turn on the camera.
2. Press [1] to switch to Record mode.
3. Press [OK/✓] or [⏏/⏏] to start recording.

4. Press [OK/✓] or [⏏/⏏] to stop recording. The video is saved automatically.
5. Press <Back> to record another video.

### View a video

1. In Idle mode, press [OK/✓] and select **My files** → **Videos** → **My video clips**.
2. Select the video you want.

## Play music

### Copy music files to the phone

Use these methods:

- Download from the wireless web
- Download from a computer using the optional Samsung PC Studio. See Samsung PC Studio User's Guide.

- 
- Receive via Bluetooth
  - Copy to a memory card and insert the card into the phone.
- 

### Create a playlist

1. In Idle mode, press [OK/↵] and select **Media player**.
2. Scroll to the **Music** tab.
3. Press <**Options**> and select **Create playlist**.
4. Enter the name for the playlist and press <**Save**>.
5. Select the playlist you just created.
6. Press <**Options**> and select **Add** → **Playlist** or **Files**.

7. Scroll to the playlist you want, or press [OK/↵] to select the files you want.
  8. Press <**Select**> or <**Add**>.
- 

### Play music files

1. Select the file you want to play.
2. During playback, use the following keys:
  - OK/↵: pause or resume playback.
  - Left: return to the previous file.
  - Right: skip to the next file.
  - ▲/▼: adjust the volume.
3. Press [Down] to stop playback.

## Browse the web

### Launch the web browser

In Idle mode, press [OK/↵] and select **Internet** → **Go to homepage**. The homepage of your service provider opens.

### Navigate the web

- To scroll through browser items, press [Up] or [Down].
- To select an item, press [OK/↵].
- To return to the previous page, press <**Back**>.
- To access browser options, press <**Options**>.

## Use Phonebook

### Add a contact

1. In Idle mode, enter a phone number and press <**Options**>.
2. Select **Add to Contacts** → a memory location → **New**.

3. For **Phone**, select a number type.
4. Specify contact information.
5. Press <**Save**> or [OK/↵] to save the contact.

### Find a contact

1. In Idle mode, press [OK/↵] and select **Contacts**.
2. Enter the first few letters of the name you want.
3. Select a contact.
4. Scroll to a number and press [↶] to dial, or press [OK/↵] and select **Edit** to edit contact information.

## Send messages

### Send a text message

1. In Idle mode, press [OK/↵] and select **Messages** → **Create message** → **Message**.
2. Enter the message text.
3. Move to the recipient field.
4. Enter destination numbers.
5. Press <**Options**> and select **Send** to send the message.

### Send a multimedia message

1. In Idle mode, press [OK/↵] and select **Messages** → **Create message** → **Message**.
2. Enter your message.
3. Press <**Options**> and select **Add subject**.
4. Press <**OK**>.

5. Enter the message subject and press [Down] to move to the text field.
6. Press <**Options**> and select **Add item, Create item, or Add attachment**.
7. Add a media file, Contacts entry, calendar item, or bookmark item.
8. Press [Up] until the recipient field highlights.
9. Enter destination numbers or email addresses.
10. Press <**Options**> and select **Send** to send the message.

### Send a postcard

1. In Idle mode, press [OK/↵] and select **Messages** → **Create message** → **MovilFoto**.
2. Select a postcard type.
3. If you selected **Postcard**, move to **Greeting message** and enter your message.
4. Select **Picture** and add an image.
5. Select **[Recipient]**.
6. Select **Phonebook** or **New address**.
7. For **Phonebook**, select a postal address from the **Contacts** list. For **New address**, specify destination information.
8. Press <**Options**> and select **Send** to send the postcard.

### Send an email

1. In Idle mode, press [OK/↵] and select **Messages** → **Create message** → **Email**.
2. Enter the email text.
3. Press <**Options**> and select **Add subject**.
4. Enter the email subject.
5. Press <**Options**> and select **Add attachment** or **Create item**.
6. Add a media file, Contacts entry, calendar item, or bookmark item.
7. Press [Up] until the recipient field highlights.
8. Enter email addresses.
9. Press <**Options**> and select **Send** to send the email.

## View messages

### View a text message

1. In Idle mode, press [OK/↵] and select **Messages** → **Inbox**.
2. Select a text message.

### View a multimedia message

1. In Idle mode, press [OK/↵] and select **Messages** → **Inbox**.
2. Select a multimedia message.

### View an email

1. In Idle mode, press [OK/↵] and select **Messages** → **Email inbox**.
2. Press <**Options**> and select **Download**.
3. Select an email or a header.

4. If you selected a header, press <**Options**> and select **Retrieve** to view the body of the email.

## Use Bluetooth

Your phone is equipped with Bluetooth technology, enabling you to connect the phone wirelessly to other Bluetooth devices and exchange data with them, talk hands-free, or control the phone remotely.

### Turn on Bluetooth

1. In Idle mode, press [OK/↵] and select **Bluetooth** → **Activation** → **On**.
2. Select **My phone's visibility** → **On** to allow other devices to locate your phone.



**Search for  
and pair  
with a  
Bluetooth  
device**

1. In Idle mode, press [OK/↵] and select **Bluetooth** → **My devices** → **Search new device**.
2. Select a device.
3. Enter a Bluetooth PIN or the other device's Bluetooth PIN, if it has one, and press <OK>. When the owner of the other device enters the same code, pairing is complete.

**Send data**

1. Access an application, **Contacts**, **My files**, **Calendar**, **Memo**, or **Tasks**.
2. Select an item.
3. Press <Options> and select **Send contact detail via/Send via/Send** → **Bluetooth/Via Bluetooth**.
4. Search for and select a device.
5. If necessary, enter the Bluetooth PIN and press <OK>.

**Receive  
data**

1. When a device attempts to access your phone, press <Yes> to permit the connection.
2. If necessary, press <Yes> to confirm that you are willing to receive.

## Switch applications

You can switch to other applications from a menu, without closing the menu screen you are using.

### Switch to an application

1. While using a menu, press [].
2. Select an application.

### Available applications

- **Call:** open the dialling screen.
- **Messaging:** access the **Messages** menu.
- **Internet:** launch the web browser.

### Close all running applications

1. Press [].
2. Scroll to **End all?**.
3. Press <**Yes**>.

## Replace the front cover

Your phone comes with extra front and battery covers in different colours. You can choose the pair of covers that suits your personal taste.

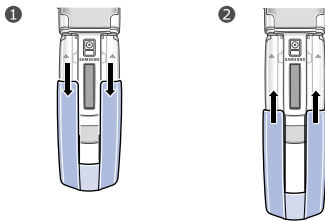

## Menu functions

### *All menu options listed*

This section provides brief explanations of menu functions on your phone.

## **Call log**

Check the most recent calls dialed, received, or missed.

## **Contacts**

Search for contact information stored in Contacts.

## **Media player**

Listen to music or play video.

## **Internet**

Menu	Description
Go to homepage	Connect your phone to the network and load the homepage of the wireless web service provider.
Enter URL	Enter a URL address and access the associated web page.
Bookmarks	Save URL addresses in order to quickly access web pages.
Saved pages	Access the list of pages you have saved while online.
History	Access the list of pages you have accessed recently.

Menu	Description
Advanced	Clear the cache. Delete cookies or set whether or not they are stored. Change the settings for the web browser and access version and copyright information about it.
Browser settings	Select a connection profile to be used for accessing the wireless web.

## Messages

Menu	Description
Create message	Create and send text, multimedia, email messages, and postcards.
Inbox	Access messages that you have received.

Menu	Description
Email inbox	Access emails that you have received.
Drafts	Access messages that you have saved to send at a later time.
Outbox	Access messages that the phone is attempting to send or has failed to send.
Sentbox	Access messages that you have sent.
My folders	Access messages that you have moved to this folder.
Templates	Make and use templates of frequently used messages or passages.
Media album	Access the Media Album service, with which you can organise your own online media album.

Menu	Description
Delete all	Delete messages in each message folder all at once.
Messages settings	Set up various options for using the messaging services.
Memory status	Check the amount of memory currently in use in each message folder.

## My files

Menu	Description
Images, Videos, Sounds, Other files	Access media files and other files stored in the phone's memory.
Games and more	Access the embedded Java games and download Java applications.

Menu	Description
To album	Access the Media Album service, with which you can organise your own online media album.
Memory status	Check memory information for media items.

## Calendar

Keep track of your schedule.

## Camera

Use the camera embedded in your phone to take photos and record videos.

## Bluetooth

Menu	Description
Activation	Activate or deactivate the Bluetooth feature.
My devices	Search for connectable Bluetooth devices.
My phone's visibility	Allow other Bluetooth devices to locate your phone or not.
My phone's name	Assign a Bluetooth device name to your phone, which is then displayed on other devices.
Secure mode	Determine if the phone asks for your confirmation when other devices access your data.
Bluetooth service	Display available Bluetooth services.

## Applications

Menu	Description
Memo	Make memos for things that are important and manage them.
Tasks	Make a list of tasks you need to complete.
Voice recorder	Record voice memos and any other sounds.
World clock	Set your local time zone and find out the current time in another part of the world.
Calculator	Perform arithmetic functions.
Converter	Do conversions, such as length and temperature.
Timer	Set a period of time for the phone to count down.
Stopwatch	Measure elapsed time.

Menu	Description
SIM application toolkit	Use a variety of additional services offered by your service provider.

## Alarms

Set alarms. The alert type for a normal alarm corresponds to the call alert type setting.

## Settings

Menu	Description
Phone profiles	Change the sound settings of the phone for different events or situations.
Time & date	Change the time and date displayed on your phone.

Menu	Description
Display & light settings → Display settings → Wallpaper	Change the background image that is displayed in Idle mode.
Display & light settings → Display settings → Greeting message	Enter the greeting that is displayed briefly when the phone is switched on.
Display & light settings → Display settings → Main menu style	Select a display style for the main menu screen.
Display & light settings → Display settings → Pop up list menu	Display the pop-up list that shows the menu options.

Menu	Description
Display & light settings → Display settings → LCD brightness	Adjust the brightness of the display for varying lighting conditions.
Display & light settings → Display settings → Dialling display	Customise the settings for the display while dialling.
Display & light settings → Display settings → Clock display	Set the dual clock, one for your local time zone and the other for a time zone of your choice, to be displayed in Idle mode.
Display & light settings → Light settings → Backlight time	Select the length of time the backlight or display stays on when the phone is not used.

Menu	Description
Display & light settings → Light settings → Keypad light	Set how the phone controls the use of the keypad light.
Phone settings → Language	Select a language for the display text.
Phone settings → Shortcuts	Use the Navigation keys as shortcuts to access specific menus directly from Idle mode.
Phone settings → Own number	Check your phone numbers or assign a name to each of the numbers.
Phone settings → Volume key function	Set how the phone reacts if you press and hold [▲/▼] when a call comes in.
Call settings	Set options for call functions.



Menu	Description
Security → Phone lock	Activate your phone password to protect your phone against unauthorised use.
Security → SIM lock	Set the phone to work only with the current USIM/SIM card by assigning a SIM lock password.
Security → PIN lock	Activate your PIN to protect your USIM/SIM card against unauthorised use.
Security → Privacy lock	Lock access to messages, files, call logs, contacts, calendar, memo, tasks, or all menu functions on the phone, except for call functions.

Menu	Description
Security → Fixed dialling mode	Set the phone to restrict calls to a limited set of phone numbers, if supported by your USIM/SIM card.
Security → Change phone password	Change the phone password.
Security → Change PIN code	Change the PIN.
Security → Change PIN2 code	Change the PIN2.
Security → Mobile tracker	Set the phone to send the preset tracking message to your family or friends when someone tries to use your phone with another USIM/SIM card.

Menu	Description
Application settings	Customise the settings for using applications available on the phone.
Network settings → Network selection	Select the network to be used while roaming outside of your home area, or let the network be chosen automatically.
Network settings → Network mode	Select the network you use.
Network services → Preferred networks	Add a new network to your preferred network list, if your USIM/SIM card supports it.
Network services → Connections	Create and customise the profiles containing the settings for connecting your phone to the network.

Menu	Description
Memory settings	Manage memory of your phone and memory card.
Master reset	Reset the phone's settings you have changed.

### **Exposure to Radio Frequency (RF) Signals**

---

#### **Certification Information (SAR)**

Your wireless phone is a radio transmitter and receiver. It is designed and manufactured not to exceed the exposure limits for radio frequency (RF) energy set by the Federal Communications Commission (FCC) of the U.S. government. These FCC exposure limits are derived from the recommendations of two expert organizations, the National Council on Radiation Protection and Measurement (NCRP) and the Institute of Electrical and Electronics Engineers (IEEE). In both cases, the recommendations were developed by scientific and engineering experts drawn from industry, government, and academia after extensive reviews of the scientific literature related to the biological effects of RF energy.

The exposure limit set by the FCC for wireless mobile phones employs a unit of measurement known as the Specific Absorption Rate (SAR). The SAR is a measure of the rate of absorption of RF energy by the human body expressed in units of watts per kilogram (W/kg). The FCC requires wireless phones to comply with a

safety limit of 1.6 watts per kilogram (1.6 W/kg). The FCC exposure limit incorporates a substantial margin of safety to give additional protection to the public and to account for any variations in measurements.

SAR tests are conducted using standard operating positions accepted by the FCC with the phone transmitting at its highest certified power level in all tested frequency bands. Although the SAR is determined at the highest certified power level, the actual SAR level of the phone while operating can be well below the maximum value. This is because the phone is designed to operate at multiple power levels so as to use only the power required to reach the network. In general, the closer you are to a wireless base station antenna, the lower the power output.

Before a new model phone is available for sale to the public, it must be tested and certified to the FCC that it does not exceed the exposure limit established by the FCC. Tests for each model phone are performed in positions and locations (e.g. at the ear and worn on the body) as required by the FCC.

The highest SAR values for this model phone as reported to the FCC are:

GSM1900 Head: 0.614 W/Kg, Body-worn:  
0.583 W/Kg.

For body worn operation, this model phone has been tested and meets the FCC RF exposure guidelines when used with a Samsung accessory designated for this product or when used with an accessory that contains no metal and that positions the handset a minimum of 1.5 cm from the body.

Non-compliance with the above restrictions may result in violation of FCC RF exposure guidelines.

SAR information on this and other model phones can be viewed on-line at [www.fcc.gov/oet/fccid](http://www.fcc.gov/oet/fccid). This site uses the phone FCC ID number, A3LSGHZ240. Sometimes it may be necessary to remove the battery pack to find the number. Once you have the FCC ID number for a particular phone, follow the instructions on the website and it should provide values for typical or maximum SAR for a particular phone. Additional product specific SAR information can also be obtained at [www.fcc.gov/cgb/sar](http://www.fcc.gov/cgb/sar).

## **Consumer Information on Wireless Phones**

---

The U.S. Food and Drug Administration (FDA) has published a series of Questions and Answers for consumers relating to radio frequency (RF) exposure from wireless phones.

The FDA publication includes the following information:

### **What kinds of phones are the subject of this update?**

The term wireless phone refers here to hand-held wireless phones with built-in antennas, often called "cell," "mobile," or "PCS" phones. These types of wireless phones can expose the user to measurable radio frequency energy (RF) because of the short distance between the phone and the user's head. These RF exposures are limited by Federal Communications Commission safety guidelines that were developed with the advice of FDA and other federal health and safety agencies. When the phone is located at greater distances from the user, the exposure to RF is drastically lower because a person's RF exposure decreases rapidly with increasing distance from the source. The so-called "cordless phones," which have a base unit connected to the telephone wiring in a house, typically operate at far lower power levels, and thus produce RF exposures well within the FCC's compliance limits.

## **Do wireless phones pose a health hazard?**

The available scientific evidence does not show that any health problems are associated with using wireless phones. There is no proof, however, that wireless phones are absolutely safe. Wireless phones emit low levels of radio frequency energy (RF) in the microwave range while being used. They also emit very low levels of RF when in the stand-by mode. Whereas high levels of RF can produce health effects (by heating tissue), exposure to low level RF that does not produce heating effects causes no known adverse health effects. Many studies of low level RF exposures have not found any biological effects. Some studies have suggested that some biological effects may occur, but such findings have not been confirmed by additional research. In some cases, other researchers have had difficulty in reproducing those studies, or in determining the reasons for inconsistent results.

## **What is FDA's role concerning the safety of wireless phones?**

Under the law, FDA does not review the safety of radiation-emitting consumer products such as wireless phones before they can be sold, as it does with new drugs or medical devices.

However, the agency has authority to take action if wireless phones are shown to emit radio frequency energy (RF) at a level that is hazardous to the user. In such a case, FDA could require the manufacturers of wireless phones to notify users of the health hazard and to repair, replace or recall the phones so that the hazard no longer exists.

Although the existing scientific data do not justify FDA regulatory actions, FDA has urged the wireless phone industry to take a number of steps, including the following:

- "Support needed research into possible biological effects of RF of the type emitted by wireless phones;
- "Design wireless phones in a way that minimizes any RF exposure to the user that is not necessary for device function; and
- "Cooperate in providing users of wireless phones with the best possible information on possible effects of wireless phone use on human health.

FDA belongs to an interagency working group of the federal agencies that have responsibility for different aspects of RF safety to ensure coordinated efforts at the federal level. The following agencies belong to this working group:

- "National Institute for Occupational Safety and Health
- "Environmental Protection Agency
- "Federal Communications Commission
- "Occupational Safety and Health Administration
- "National Telecommunications and Information Administration

The National Institutes of Health participates in some interagency working group activities, as well.

FDA shares regulatory responsibilities for wireless phones with the Federal Communications Commission (FCC). All phones that are sold in the United States must comply with FCC safety guidelines that limit RF exposure. FCC relies on FDA and other health agencies for safety questions about wireless phones.

FCC also regulates the base stations that the wireless phone networks rely upon. While these base stations operate at higher power than do the wireless phones themselves, the RF exposures that people get from these base stations are typically thousands of times lower than those they can get from wireless phones. Base stations are thus not the primary subject of the safety questions discussed in this document.

## **What are the results of the research done already?**

The research done thus far has produced conflicting results, and many studies have suffered from flaws in their research methods. Animal experiments investigating the effects of radio frequency energy (RF) exposures characteristic of wireless phones have yielded conflicting results that often cannot be repeated in other laboratories. A few animal studies, however, have suggested that low levels of RF could accelerate the development of cancer in laboratory animals. However, many of the studies that showed increased tumor development used animals that had been genetically engineered or treated with cancer-causing chemicals so as to be pre-disposed to develop cancer in absence of RF exposure. Other studies exposed the animals to RF for up to 22 hours per day. These conditions are not similar to the conditions under which people use wireless phones, so we don't know with certainty what the results of such studies mean for human health.

Three large epidemiology studies have been published since December 2000. Between them, the studies investigated any possible

association between the use of wireless phones and primary brain cancer, glioma, meningioma, or acoustic neuroma, tumors of the brain or salivary gland, leukemia, or other cancers. None of the studies demonstrated the existence of any harmful health effects from wireless phones RF exposures. However, none of the studies can answer questions about long-term exposures, since the average period of phone use in these studies was around three years.

**What research is needed to decide whether RF exposure from wireless phones poses a health risk?**

A combination of laboratory studies and epidemiological studies of people actually using wireless phones would provide some of the data that are needed. Lifetime animal exposure studies could be completed in a few years. However, very large numbers of animals would be needed to provide reliable proof of a cancer promoting effect if one exists. Epidemiological studies can provide data that is directly applicable to human populations, but ten or more years' follow-up may be needed to provide answers about some health effects, such as cancer. This is because the interval between the time of exposure to a cancer-causing agent and the time tumors develop - if

they do - may be many, many years. The interpretation of epidemiological studies is hampered by difficulties in measuring actual RF exposure during day-to-day use of wireless phones. Many factors affect this measurement, such as the angle at which the phone is held, or which model of phone is used.

**What is FDA doing to find out more about the possible health effects of wireless phone RF?**

FDA is working with the U.S. National Toxicology Program and with groups of investigators around the world to ensure that high priority animal studies are conducted to address important questions about the effects of exposure to radio frequency energy (RF).

FDA has been a leading participant in the World Health Organization international Electromagnetic Fields (EMF) Project since its inception in 1996. An influential result of this work has been the development of a detailed agenda of research needs that has driven the establishment of new research programs around the world. The Project has also helped develop a series of public information documents on EMF issues.

FDA and Cellular Telecommunications & Internet Association (CTIA) have a formal

Cooperative Research and Development Agreement (CRADA) to do research on wireless phone safety. FDA provides the scientific oversight, obtaining input from experts in government, industry, and academic organizations. CTIA-funded research is conducted through contracts to independent investigators. The initial research will include both laboratory studies and studies of wireless phone users. The CRADA will also include a broad assessment of additional research needs in the context of the latest research developments around the world.

### **What steps can I take to reduce my exposure to radio frequency energy from my wireless phone?**

If there is a risk from these products - and at this point we do not know that there is - it is probably very small. But if you are concerned about avoiding even potential risks, you can take a few simple steps to minimize your exposure to radio frequency energy (RF). Since time is a key factor in how much exposure a person receives, reducing the amount of time spent using a wireless phone will reduce RF exposure.

- "If you must conduct extended conversations by wireless phone every day,

you could place more distance between your body and the source of the RF, since the exposure level drops off dramatically with distance. For example, you could use a headset and carry the wireless phone away from your body or use a wireless phone connected to a remote antenna.

Again, the scientific data do not demonstrate that wireless phones are harmful. But if you are concerned about the RF exposure from these products, you can use measures like those described above to reduce your RF exposure from wireless phone use.

### **What about children using wireless phones?**

The scientific evidence does not show a danger to users of wireless phones, including children and teenagers. If you want to take steps to lower exposure to radio frequency energy (RF), the measures described above would apply to children and teenagers using wireless phones. Reducing the time of wireless phone use and increasing the distance between the user and the RF source will reduce RF exposure.

Some groups sponsored by other national governments have advised that children be discouraged from using wireless phones at all.



For example, the government in the United Kingdom distributed leaflets containing such a recommendation in December 2000. They noted that no evidence exists that using a wireless phone causes brain tumors or other ill effects. Their recommendation to limit wireless phone use by children was strictly precautionary; it was not based on scientific evidence that any health hazard exists.

### **Do hands-free kits for wireless phones reduce risks from exposure to RF emissions?**

Since there are no known risks from exposure to RF emissions from wireless phones, there is no reason to believe that hands-free kits reduce risks. Hands-free kits can be used with wireless phones for convenience and comfort. These systems reduce the absorption of RF energy in the head because the phone, which is the source of the RF emissions, will not be placed against the head. On the other hand, if the phone is mounted against the waist or other part of the body during use, then that part of the body will absorb more RF energy. Wireless phones marketed in the U.S. are required to meet safety requirements regardless of whether they are used against the head or

against the body. Either configuration should result in compliance with the safety limit.

### **Do wireless phone accessories that claim to shield the head from RF radiation work?**

Since there are no known risks from exposure to RF emissions from wireless phones, there is no reason to believe that accessories that claim to shield the head from those emissions reduce risks. Some products that claim to shield the user from RF absorption use special phone cases, while others involve nothing more than a metallic accessory attached to the phone. Studies have shown that these products generally do not work as advertised. Unlike "hand-free" kits, these so-called "shields" may interfere with proper operation of the phone. The phone may be forced to boost its power to compensate, leading to an increase in RF absorption. In February 2002, the Federal Trade Commission (FTC) charged two companies that sold devices that claimed to protect wireless phone users from radiation with making false and unsubstantiated claims. According to FTC, these defendants lacked a reasonable basis to substantiate their claim.

## **What about wireless phone interference with medical equipment?**

Radio frequency energy (RF) from wireless phones can interact with some electronic devices. For this reason, FDA helped develop a detailed test method to measure electromagnetic interference (EMI) of implanted cardiac pacemakers and defibrillators from wireless telephones. This test method is now part of a standard sponsored by the Association for the Advancement of Medical Instrumentation (AAMI). The final draft, a joint effort by FDA, medical device manufacturers, and many other groups, was completed in late 2000. This standard will allow manufacturers to ensure that cardiac pacemakers and defibrillators are safe from wireless phone EMI. FDA has tested wireless phones and helped develop a voluntary standard sponsored by the Institute of Electrical and Electronic Engineers (IEEE). This standard specifies test methods and performance requirements for hearing aids and wireless phones so that no interference occurs when a person uses a compatible phone and a compatible hearing aid at the same time. This standard was approved by the IEEE in 2000. FDA continues to monitor the use of wireless phones for possible interactions with other medical devices. Should harmful interference

be found to occur, FDA will conduct testing to assess the interference and work to resolve the problem.

Additional information on the safety of RF exposures from various sources can be obtained from the following organizations:

- FCC RF Safety Program:  
<http://www.fcc.gov/oet/rfsafety/>
- Environmental Protection Agency (EPA):  
<http://www.epa.gov/radiation/>
- Occupational Safety and Health Administration's (OSHA):  
<http://www.osha.gov/SLTC/radiofrequencyradiation/index.html>
- National Institute for Occupational Safety and Health (NIOSH):  
<http://www.cdc.gov/niosh/emfpg.html>
- World Health Organization (WHO):  
<http://www.who.int/peh-emf/>
- International Commission on Non-Ionizing Radiation Protection:  
<http://www.icnirp.de>
- National Radiation Protection Board (UK):  
<http://www.nrpb.org.uk>
- Updated 4/3/2002: US Food and Drug Administration  
<http://www.fda.gov/cellphones>

## **Road Safety**

---

Your wireless phone gives you the powerful ability to communicate by voice, almost anywhere, anytime. But an important responsibility accompanies the benefits of wireless phones, one that every user must uphold.

When driving a car, driving is your first responsibility. When using your wireless phone behind the wheel of a car, practice good common sense and remember the following tips:

1. Get to know your wireless phone and its features, such as speed dial and redial. If available, these features help you to place your call without taking your attention off the road.
2. When available, use a hands-free device. If possible, add an additional layer of convenience and safety to your wireless phone with one of the many hands free accessories available today.
3. Position your wireless phone within easy reach. Be able to access your wireless phone without removing your eyes from the road. If you get an incoming call at an inconvenient time, let your voice mail answer it for you.
4. Let the person you are speaking with know you are driving; if necessary, suspend the call in heavy traffic or hazardous weather conditions. Rain, sleet, snow, ice and even heavy traffic can be hazardous.
5. Do not take notes or look up phone numbers while driving. Jotting down a "to do" list or flipping through your address book takes attention away from your primary responsibility, driving safely.
6. Dial sensibly and assess the traffic; if possible, place calls when you are not moving or before pulling into traffic. Try to plan calls when your car will be stationary. If you need to make a call while moving, dial only a few numbers, check the road and your mirrors, then continue.
7. Do not engage in stressful or emotional conversations that may be distracting. Make people you are talking with aware you are driving and suspend conversations that have the potential to divert your attention from the road.
8. Use your wireless phone to call for help. Dial 9-1-1 or other local emergency number in the case of fire, traffic accident or medical emergencies. Remember, it is a free call on your wireless phone!

9. Use your wireless phone to help others in emergencies. If you see an auto accident, crime in progress or other serious emergency where lives are in danger, call 9-1-1 or other local emergency number, as you would want others to do for you.
10. Call roadside assistance or a special non-emergency wireless assistance number when necessary. If you see a broken-down vehicle posing no serious hazard, a broken traffic signal, a minor traffic accident where no one appears injured, or a vehicle you know to be stolen, call roadside assistance or other special non-emergency number.

**"The wireless industry reminds you to use your phone safely when driving."**

For more information, please call 1-888-901-SAFE, or visit our web-site [www.wow-com.com](http://www.wow-com.com)  
Provided by the Cellular Telecommunications & Internet Association

## **Operating Environment**

---

Remember to follow any special regulations in force in any area and always switch your phone off whenever it is forbidden to use it, or when it may cause interference or danger. When connecting the phone or any accessory to

another device, read its user's guide for detailed safety instructions. Do not connect incompatible products.

As with other mobile radio transmitting equipment, users are advised that for the satisfactory operation of the equipment and for the safety of personnel, it is recommended that the equipment should only be used in the normal operating position (held to your ear with the antenna pointing over your shoulder).

## **Using Your Phone Near Other Electronic Devices**

---

Most modern electronic equipment is shielded from radio frequency (RF) signals. However, certain electronic equipment may not be shielded against the RF signals from your wireless phone. Consult the manufacturer to discuss alternatives.

### **Pacemakers**

Pacemaker manufacturers recommend that a minimum distance of 15 cm (6 inches) be maintained between a wireless phone and a pacemaker to avoid potential interference with the pacemaker.

These recommendations are consistent with the independent research and recommendations of Wireless Technology Research.

### **Persons with pacemakers:**

- should always keep the phone more than 15 cm (6 inches) from their pacemaker when the phone is switched on.
- should not carry the phone in a breast pocket.
- should use the ear opposite the pacemaker to minimize potential interference.

If you have any reason to suspect that interference is taking place, switch your phone off immediately.

### **Hearing Aids**

Some digital wireless phones may interfere with some hearing aids. In the event of such interference, you may wish to consult your hearing aid manufacturer to discuss alternatives.

### **Other Medical Devices**

If you use any other personal medical devices, consult the manufacturer of your device to determine if it is adequately shielded from external RF energy. Your physician may be able

to assist you in obtaining this information. Switch your phone off in health care facilities when any regulations posted in these areas instruct you to do so. Hospitals or health care facilities may be using equipment that could be sensitive to external RF energy.

### **Vehicles**

RF signals may affect improperly installed or inadequately shielded electronic systems in motor vehicles. Check with the manufacturer or its representative regarding your vehicle. You should also consult the manufacturer of any equipment that has been added to your vehicle.

### **Posted Facilities**

Switch your phone off in any facility where posted notices require you to do so.

### **Potentially Explosive Environments**

---

Switch your phone off when in any area with a potentially explosive atmosphere and obey all signs and instructions. Sparks in such areas could cause an explosion or fire resulting in bodily injury or even death.

Users are advised to switch the phone off while at a refueling point (service station). Users are reminded of the need to observe restrictions on

the use of radio equipment in fuel depots (fuel storage and distribution areas), chemical plants or where blasting operations are in progress.

Areas with a potentially explosive atmosphere are often but not always clearly marked. They include below deck on boats, chemical transfer or storage facilities, vehicles using liquefied petroleum gas (such as propane or butane), areas where the air contains chemicals or particles, such as grain, dust or metal powders, and any other area where you would normally be advised to turn off your vehicle engine.

## **Emergency Calls**

---

This phone, like any wireless phone, operates using radio signals, wireless and landline networks as well as user programmed functions, which cannot guarantee connection in all conditions. Therefore, you should never rely solely on any wireless phone for essential communications (medical emergencies, for example).

Remember, to make or receive any calls the phone must be switched on and in a service area with adequate signal strength. Emergency calls may not be possible on all wireless phone networks or when certain network services and/or phone features are in use. Check with local service providers.

To make an emergency call:

1. If the phone is not on, switch it on.
2. Key in the emergency number for your present location (for example, 911 or other official emergency number). Emergency numbers vary by location.
3. Press .

If certain features are in use (call barring, for example), you may first need to deactivate those features before you can make an emergency call. Consult this document and your local cellular service provider.

When making an emergency call, remember to give all the necessary information as accurately as possible. Remember that your phone may be the only means of communication at the scene of an accident; do not cut off the call until given permission to do so.

## **Restricting Children's access to your Phone**

Your phone is not a toy. Children should not be allowed to play with it because they could hurt themselves and others, damage the phone or make calls that increase your phone bill.

## **FCC Notice and Cautions**

---

### **FCC Notice**

- ☑ • This device complies with Part 15 of the FCC Rules. Operation is subject to the following two conditions: (1) this device may not cause harmful interference, and (2) this device must accept any interference received, including interference that may cause undesired operation.
- This equipment has been tested and found to comply with the limits for a Class B digital device, pursuant to part 15 of the FCC Rules.
- These limits are designed to provide reasonable protection against harmful interference in a residential installation. This equipment generates, uses and can radiate radio frequency energy and, if not installed and used in accordance with the instructions, may cause harmful interference to radio communications. However, there is no guarantee that interference will not occur in a particular installation.

- ☑ If this equipment does cause harmful interference to radio or television reception, which can be determined by turning the equipment off and on, the user is encouraged to try to correct the interference by one or more of the following measures:
  - Reorient or relocate the receiving antenna.
  - Increase the separation between the equipment and receiver.
  - Connect the equipment into an outlet on a circuit different from that to which the receiver is connected.
  - Consult the dealer or an experienced radio/TV technician for help.

The phone may cause TV or radio interference if used in close proximity to receiving equipment. The FCC can require you to stop using the phone if such interference cannot be eliminated.

Vehicles using liquefied petroleum gas (such as propane or butane) must comply with the National Fire Protection Standard (NFPA-58). For a copy of this standard, contact the National Fire Protection Association, One Batterymarch Park, Quincy, MA 02269, Attn: Publication Sales Division.

## Cautions

Changes or modifications made in the radio phone, not expressly approved by Samsung, will void the user's authority to operate the equipment.

Only use approved batteries, antennas and chargers. The use of any unauthorized accessories may be dangerous and void the phone warranty if said accessories cause damage or a defect to the phone.

Although your phone is quite sturdy, it is a complex piece of equipment and can be broken. Avoid dropping, hitting, bending or sitting on it.

## Other Important Safety Information

---

- Only qualified personnel should service the phone or install the phone in a vehicle. Faulty installation or service may be dangerous and may invalidate any warranty applicable to the device.
- Check regularly that all wireless phone equipment in your vehicle is mounted and operating properly.
- Do not store or carry flammable liquids, gases or explosive materials in the same compartment as the phone, its parts or accessories.
- For vehicles equipped with an air bag, remember that an air bag inflates with great force. Do not place objects, including both installed or portable wireless equipment in the area over the air bag or in the air bag deployment area. If wireless equipment is improperly installed and the air bag inflates, serious injury could result.
- Switch your phone off before boarding an aircraft. The use of wireless phone in aircraft is illegal and may be dangerous to the aircraft's operation.
- Failure to observe these instructions may lead to the suspension or denial of telephone services to the offender, or legal action, or both.

## Product Performance

---

### Getting the Most Out of Your Signal Reception

The quality of each call you make or receive depends on the signal strength in your area. Your phone informs you of the current signal strength by displaying a number of bars next to the signal strength icon. The more bars displayed, the stronger the signal.

If you're inside a building, being near a window may give you better reception.



## **Understanding the Power Save Feature**

If your phone is unable to find a signal after 15 minutes of searching, a Power Save feature is automatically activated. If your phone is active, it periodically rechecks service availability or you can check it yourself by pressing any key.

Anytime the Power Save feature is activated, a message displays on the screen. When a signal is found, your phone returns to standby mode.

## **Understanding How Your Phone Operates**

Your phone is basically a radio transmitter and receiver. When it's turned on, it receives and transmits radio frequency (RF) signals. When you use your phone, the system handling your call controls the power level. This power can range from 0.006 watts to 0.2 watts in digital mode.

## **Maintaining Your Phone's Peak Performance**

For the best care of your phone, only authorized personnel should service your phone and accessories. Faulty service may void the warranty.

There are several simple guidelines to operating your phone properly and maintaining safe, satisfactory service.

- Hold the phone with the antenna raised, fully-extended and over your shoulder.
- Try not to hold, bend or twist the phone's antenna.
- Don't use the phone if the antenna is damaged.
- Speak directly into the phone's receiver.
- Avoid exposing your phone and accessories to rain or liquid spills. If your phone does get wet, immediately turn the power off and remove the battery. If it is inoperable, call Customer Care for service.

## **Availability of Various Features/Ring Tones**

---

Many services and features are network dependent and may require additional subscription and/or usage charges. Not all features are available for purchase or use in all areas. Downloadable Ring Tones may be available at an additional cost. Other conditions and restrictions may apply. See your service provider for additional information.

## Battery Standby and Talk Time

---

Standby and talk times will vary depending on phone usage patterns and conditions. Battery power consumption depends on factors such as network configuration, signal strength, operating temperature, features selected, frequency of calls, and voice, data, and other application usage patterns.

## Battery Precautions

---

- Never use any charger or battery that is damaged in any way.
- Use the battery only for its intended purpose.
- If you use the phone near the network's base station, it uses less power; talk and standby time are greatly affected by the signal strength on the cellular network and the parameters set by the network operator.
- Battery charging time depends on the remaining battery charge and the type of battery and charger used. The battery can be charged and discharged hundreds of times, but it will gradually wear out. When the operation time (talk time and standby time) is noticeably shorter than normal, it is time to buy a new battery.
- If left unused, a fully charged battery will discharge itself over time.
- Use only Samsung-approved batteries and recharge your battery only with Samsung-approved chargers. When a charger is not in use, disconnect it from the power source. Do not leave the battery connected to a charger for more than a week, since overcharging may shorten its life.
- Extreme temperatures will affect the charging capacity of your battery: it may require cooling or warming first.
- Do not leave the battery in hot or cold places, such as in a car in summer or winter conditions, as you will reduce the capacity and lifetime of the battery. Always try to keep the battery at room temperature. A phone with a hot or cold battery may temporarily not work, even when the battery is fully charged. Li-ion batteries are particularly affected by temperatures below 0 °C (32 °F).
- Do not short-circuit the battery. Accidental short-circuiting can occur when a metallic object (coin, clip or pen) causes a direct connection between the + and - terminals of the battery (metal strips on the battery), for example when you carry a spare battery in a pocket or bag. Short-circuiting the

terminals may damage the battery or the object causing the short-circuiting.

- Dispose of used batteries in accordance with local regulations. In some areas, the disposal of batteries in household or business trash may be prohibited. For safe disposal options for Li-Ion batteries, contact your nearest Samsung authorized service center. Always recycle. Do not dispose of batteries in a fire.

### **Care and Maintenance**

---

Your phone is a product of superior design and craftsmanship and should be treated with care. The suggestions below will help you fulfill any warranty obligations and allow you to enjoy this product for many years.

- Keep the phone and all its parts and accessories out of the reach of small children.
- Keep the phone dry. Precipitation, humidity and liquids contain minerals that will corrode electronic circuits.
- Do not use the phone with a wet hand. Doing so may cause an electric shock to you or damage to the phone.
- Do not use or store the phone in dusty, dirty areas, as its moving parts may be damaged.
- Do not store the phone in hot areas. High temperatures can shorten the life of electronic devices, damage batteries, and warp or melt certain plastics.
- Do not store the phone in cold areas. When the phone warms up to its normal operating temperature, moisture can form inside the phone, which may damage the phone's electronic circuit boards.
- Do not drop, knock or shake the phone. Rough handling can break internal circuit boards.
- Do not use harsh chemicals, cleaning solvents or strong detergents to clean the phone. Wipe it with a soft cloth slightly dampened in a mild soap-and-water solution.
- Do not paint the phone. Paint can clog the device's moving parts and prevent proper operation.
- Do not put the phone in or on heating devices, such as a microwave oven, a stove or a radiator. The phone may explode when overheated.
- When the phone or battery gets wet, the label indicating water damage inside the

phone changes color. In this case, phone repairs are no longer guaranteed by the manufacturer's warranty, even if the warranty for your phone has not expired.

- If your phone has a flash or light, do not use it too close to the eyes of people or animals. This may cause damage to their eyes.
- Use only the supplied or an approved replacement antenna. Unauthorized antennas or modified accessories may damage the phone and violate regulations governing radio devices.
- If the phone, battery, charger or any accessory is not working properly, take it to your nearest qualified service facility. The personnel there will assist you, and if necessary, arrange for service.