

About Gear Circle

With this Bluetooth headset (also referred to as Circle), you can connect with Bluetooth-enabled devices, such as smartphones and tablets. You can answer calls and play music from the connected devices.

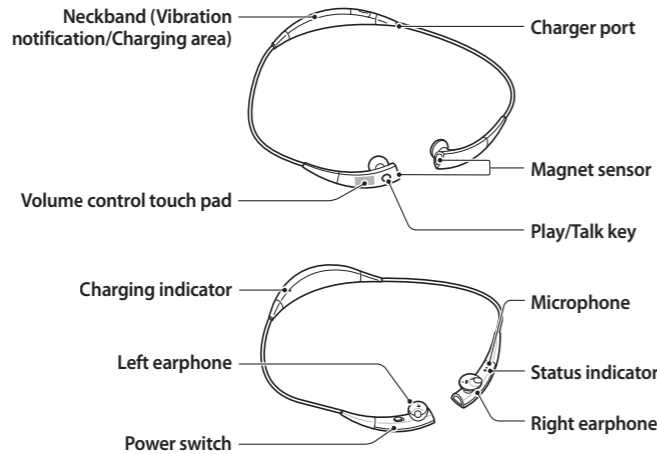

- This quick start guide is designed to provide basic information about using the Bluetooth headset and describes some specific features. You can find more information in the user manual at www.samsung.com. You can also view the user manual in the connected device. Open the Apps screen of the connected device and tap **Samsung Gear** → **User manual**.
- To learn how to remove the battery from the Circle, refer to the user manual.

Connecting to other devices

To use the Circle, you must pair it with another device. After pairing with a device, the Circle will automatically connect to the device in the future. You can connect the Circle to other devices using the Samsung Gear app or via Bluetooth.

Connecting devices using the Samsung Gear app

Install the Samsung Gear app on the other device and connect the Circle to the device.

- 1 Other device** Download the Samsung Gear app from **GALAXY Apps**. You can also visit apps.samsung.com/gear to download the Samsung Gear app.
- 2 Other device** Turn on the Bluetooth feature.

- 3 Circle** Turn on the Circle. When you turn on the Circle for the first time, the Circle automatically enters Bluetooth pairing mode. The status indicator flashes green, blue, and then red for 3 minutes.
- 4 Other device** On the Apps screen, tap **Samsung Gear**.
- 5 Other device** From the search results, tap **Gear Circle**.

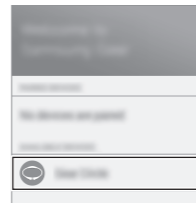

Controls functions

- Power switch: Slide up or down to turn the Circle on or off.
- Play/Talk key: Press to answer or end a call. Press to play music or pause playback. Press and hold for 3 seconds to enter Bluetooth pairing mode.
- Volume control touch pad:
 - Swipe upwards or downwards to adjust the volume during media playback or a call.
 - Swipe upwards or downwards to stop the Circle vibration when a call comes in.

Status indicator

- Bluetooth pairing mode: Blinking green, blue, and red
- Power on: Blinking blue 3 times
- Power off: Blinking red 3 times
- Incoming call: Blinking blue

- 6 Other device** Read and agree to the terms and conditions, and then tap **Finish**. When the devices are connected properly, the Circle will beep and vibrate.

Connecting devices via Bluetooth

- 1 Circle** Turn on the Circle. When you turn on the Circle for the first time, the Circle automatically enters Bluetooth pairing mode. The status indicator flashes green, blue, and then red for 3 minutes.
- 2 Other device** Turn on the Bluetooth feature.
- 3 Other device** Access the Bluetooth menu and search for Bluetooth devices.
- 4 Other device** From the search results, tap **Gear Circle**. When the devices are connected properly, the Circle will beep and vibrate.

Charging indicator

- Charging: Red
- Fully charged: Green
- ☞ Check the product box for the device, earbud tips (3 pairs, S/M/L), neck guides (for outdoor activities, S/M/L), a charger, and the quick start guide. The items supplied with the device and available accessories may vary depending on the region.

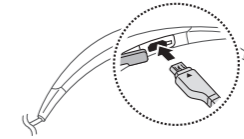

- ☞ To save energy, unplug the charger when not in use. The charger does not have a power switch, so you must unplug the charger from the electric socket when not in use to avoid wasting power. The charger should remain close to the electric socket and easily accessible while charging.
- The socket-outlet shall be installed near the equipment and shall be easily accessible.

Charging the battery

Charge the battery before using the Circle for the first time.

Open the charger port cover and plug the small end of the charger into the charger port of the Circle.

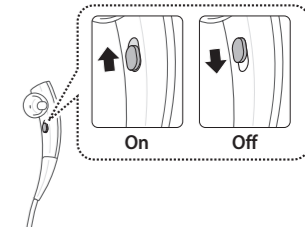

Reconnecting the devices

The connection between the Circle and the connected device may disconnect when using the devices over long distances. When the connection is ended, the Circle will beep and vibrate.

Place the Circle near the connected device to reconnect. When the devices are reconnected, the Circle will beep and vibrate.

If the connection is lost due to a problem with the device, press the Play/Talk key on the Circle or access the Bluetooth menu on the device. If the earphones are connected, separate them and reconnect the devices.

Disconnecting the devices

Turn off the Circle or deactivate the Bluetooth feature on the connected device.

- ☞ The Samsung Gear app is available for Samsung smartphones that have more than 1 GB of memory and run Android 4.2.2 or higher.
- Place the Circle near to the device to connect.
- If the Circle does not enter Bluetooth pairing mode, separate the earphones and press and hold the Play/Talk key for 3 seconds.
- The method for connecting via Bluetooth may vary depending on the connected devices. For more information, refer to the user manual of the connected device.

Connecting to two devices

The Circle can connect to two Bluetooth-enabled devices at the same time.

After pairing the Circle with another device, enter Bluetooth pairing mode again to connect to a second device. Then, reconnect to the first device. The Circle is now connected to two devices.

Turning the Circle on or off

Slide the Power switch up or down to turn the Circle on or off.

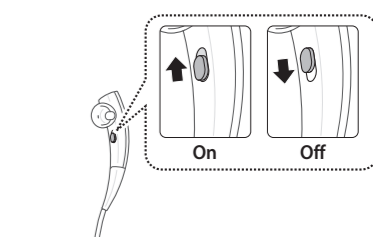

Notices for using Bluetooth

- To avoid problems when connecting your device to another mobile device, place the devices close to each other.
- Ensure that your device and the other Bluetooth device are within the Bluetooth connection range (10 m). The distance may vary depending on the environment the devices are used in.
- Ensure that there are no obstacles between your headset and a connected device, including human bodies, walls, corners, or fences.
- Do not touch the Bluetooth antenna of a connected device.
- Bluetooth uses the same frequency as some industrial, scientific, medical, and low power products and interference may occur when making connections near these types of products.
- Some devices, especially those that are not tested or approved by the Bluetooth SIG, may be incompatible with the headset.



Using the earbud tips

Cover the earphones with the provided earbud tips that best fit your ears.

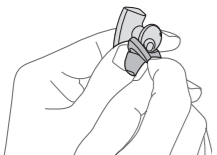

- ⚠ Do not put the earphones in your ears without earbud tips.
- Do not pull the earbud tip excessively. The earbud tip may tear.

14

Using the Samsung Gear app

If the Circle and the other device are connected using the Samsung Gear app, you can access additional features, such as adjusting the sound effect or setting the notification feature.

On the connected device, open the Apps screen and tap **Samsung Gear** to launch it.

Gear SoundAlive

Select a sound effect or adjust the sound effect manually.

On the Samsung Gear main screen, tap **Gear SoundAlive**.

Notifications

Set the device to notify you of missed calls and new messages via a voice notification to the Circle.

On the Samsung Gear main screen, tap **Notifications**, tap the **Notifications** switch to activate it, and then select apps.

21

Wearing the Circle

Cover the earphones with the provided earbud tips and correctly wear the earphones. The earphones contain magnets so that they can be attached. Wearing the Circle using the neck guide (for outdoor activities) will prevent the neckband from falling off of your neck.

Wearing the Circle



15

Safety information

To prevent injury, fire, or explosion, read and adhere to all safety information before using the device.

⚠ Warning

- The Gear Circle contains magnets in its earbuds. The American Heart Association (US) and the Medicines and Healthcare Products Regulatory Agency (UK) both warn that magnets can affect the operation of implanted pacemakers, cardioverters, defibrillators, insulin pumps or other electro medical devices (collectively, "Medical Device") within the range of 15 cm (6 inches). If you are a user of any of these Medical Devices, **DO NOT USE THE GEAR CIRCLE UNLESS YOU HAVE CONSULTED WITH YOUR PHYSICIAN.**
- Do not touch the power cord with wet hands or disconnect the charger by pulling the cord.
- Do not use your device outdoor during a thunderstorm.
- Use manufacturer-approved accessories and supplies.

22

Connecting the earphones



Using the neck guide

1



16

- Do not expose the device to physical impact or damage.
- Do not store your device near or in heaters, microwaves, cooking equipment, or high pressure containers.
- Do not use or store your device in areas with high concentrations of dust or airborne materials.
- Do not allow children or animals to chew or suck the device.
- Do not poke eyes, ears, or other body parts with the device or insert the device into the mouth.

⚠ Caution

- Follow all posted warnings and directions from authorised personnel in areas where the use of wireless devices is restricted, such as aeroplanes and hospitals.
- Do not store your device near magnetic fields. Magnetic stripe cards, including credit cards, phone cards, passbooks, and boarding passes, may be damaged by magnetic fields.
- Do not use the device for anything other than its intended purposes.

23

2



Adjusting the volume

Swipe upwards or downwards on the Volume control touch pad to adjust the volume.

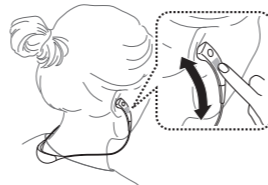

17

- Do not pull on any part of the device excessively.
- Use caution when taking off the device. The headset cable may tangle around your neck.
- Use caution when using the device while you are walking or moving. The device may fall off of your neck.
- Use caution when you wear the device with other accessories, such as a necklace.
- Turn off the device in potentially explosive environments.
- Comply with all safety warnings and regulations regarding mobile device usage while operating a vehicle.
- Leave the device in a dry place. If the device is exposed to freshwater, dry it thoroughly with a clean, soft cloth and take it to a Samsung Service centre.
- Do not store your device in very hot or very cold areas. It is recommended to use your device at temperatures from 5°C to 35°C.
- Do not use the device while driving. Using the device may take attention away from your primary responsibility of driving safely.

24

Using the Circle

Answering a call

While wearing the Circle

When a call comes, the Circle will beep and vibrate. Press the Play/Talk key.

While the earphones are connected

When a call comes, the Circle will vibrate. Separate the earphones and put them in your ears. When you separate the earphones, the call will be received.

Rejecting a call

When a call comes in, press and hold the Play/Talk key for 1 second or connect the earphones.

18

- Any changes or modifications to your device can void your manufacturer's warranty. If your device needs servicing, take your device to a Samsung Service Centre.



To prevent possible hearing damage when using a headset, do not listen to sound at high volume for long periods.

Correct disposal



This marking on the product, accessories or literature indicates that the product and its electronic accessories (e.g. charger, headset, USB cable) should not be disposed of with other household waste. This product is RoHS compliant.



This marking on the battery, manual or packaging indicates that the batteries in this product should not be disposed of with other household waste.

19

Switching sound output

Use the related menu on the connected device to switch sound output between the Circle and the connected device.

When the earphones are connected, you can automatically switch the sound output to the Circle by separating the earphones.

Ending a call

Press the Play/Talk key or reconnect the earphones.

Playing music

Press the Play/Talk key.

The most recently-played music file will play automatically in the default music app installed on the connected device.



Federal Communications Commission

This device complies with part 15 of the FCC Rules. Operation is subject to the following two conditions: (1) This device may not cause harmful interference, and (2) this device must accept any interference received, including interference that may cause undesired operation.

The device and its antenna must not be co-located or operating in conjunction with any other antenna or transmitter. Users are not permitted to make changes or modify the device in any way. Changes or modifications not expressly approved by Samsung will void the user's authority to operate the equipment.

RF Exposure Statement (2.1091)
FCC RF Radiation Exposure Statement: FCC RF Radiation Exposure Statement: This equipment complies with FCC RF Radiation exposure limits set forth for an uncontrolled environment. This device and its antenna must not be co-located or operating in conjunction with any other antenna or transmitter.

25

Pausing and resuming playback

Press the Play/Talk key or connect the earphones to pause playback.

To resume playback, separate the earphones and press the Play/Talk key.

Skipping to the next song

Press the Play/Talk key twice to skip to the next song while playing music.

Launching S Voice

While you are wearing the Circle, press and hold the Play/Talk key for 1 second.

If the connected device support **S Voice**, you can use the app via the Circle.

Industry Canada

Operation is subject to the following two conditions: (1) This device may not cause interference and (2) this device must accept any interference, including interference that may cause undesired operation of the device. The term "IC:" before the certification/registration number only signifies that registration was performed based on a Declaration of Conformity indicating that Industry Canada technical specifications were met. It does not imply that Industry Canada approved the equipment.

Le présent appareil est conforme aux CNR d'Industrie Canada applicables aux appareils radio exempts de licence. L'exploitation est autorisée aux deux conditions suivantes : (1) l'appareil ne doit pas produire de brouillage, et (2) l'utilisateur de l'appareil doit accepter tout brouillage radioélectrique subi, même si le brouillage est susceptible d'en compromettre le fonctionnement.

Industry Canada RF Radiation Exposure Statement
This equipment complies with Industry Canada RF Radiation exposure limits set forth for an uncontrolled environment. This device and its antenna must not be co-located or operating in conjunction with any other antenna or transmitter.

RF de l'Industrie Canada d'exposition aux radiations: Cet équipement est conforme à l'exposition de l'Industrie Canada rayonnements RF limites établies pour un environnement non contrôlé. L'antenne pour ce transmetteur ne doit pas être même endroit avec d'autres émetteurs sauf conformément à l'Industrie Canada procédures de produits Multi-émetteur.

20