

SAMSUNG

SM-R150

SAMSUNG CONFIDENTIAL

SAMSUNG

05070779

English (USA). 04/2016.

Rev.1.0

www.samsung.com

Table of

Basics

27 Customising settings

- 3 Read me first
- 4 About the Gear IconX
- 5 Package contents
- 6 Device layout
- 7 Charging the battery
- 9 Indicator light identification
- 11 Wearing the Gear IconX earbuds
- 14 Connecting the Gear IconX earbuds to a mobile device
- 16 Coupling the two earbuds
- 16 Setting the main earbud

Using the Gear IconX

- 17 Using the touchpad
- 20 Transferring music files to the Gear IconX earbuds
- 22 Listening to music
- 23 Recording exercise information
- 25 Using call features
- 26 Using ambient sound mode

Table of

Appendix

- 29 Troubleshooting
- 32 Resetting the Gear IconX earbuds
- 33 Removing the battery

SAMSUNG CONFIDENTIAL

SAMSUNG

05070779

Basics

Read me first

Please read this manual before using this device to ensure safe and proper use.

- Images may differ in appearance from the actual product. Content is subject to change without prior notice. You can access the full user manual for more information. Visit www.samsung.com to view device information, the user manual, and more.
- Before using other devices, make sure they are compatible with the Gear IconX. Visit www.samsung.com to see a list of compatible mobile devices.
- This product includes certain free/ open source software. To see the instructions for viewing the open source license, go to the Samsung website (opensource.samsung.com).

Instructional icons



Warning: situations that could cause injury to yourself or others



Caution: situations that could cause damage to your device or other equipment



Notice: notes, usage tips, or additional information

About the Gear IconX

Gear IconX wireless sports earbuds allow you to track your activity levels as well as play music. You can listen to music played from the connected mobile device or the music saved in the Gear IconX earbuds. Even when using the Gear IconX earbuds alone, they still record and save exercise information, such as activity duration and burnt calories.

Use the Gear IconX earbuds alone. You can listen to music saved in your Gear IconX earbuds. The Gear IconX earbuds also record exercise information.



Use the Gear IconX earbuds with your mobile device. You can listen to music saved in the connected mobile device and answer incoming calls. You can also view your recorded exercise information via the S Health app on your mobile device.

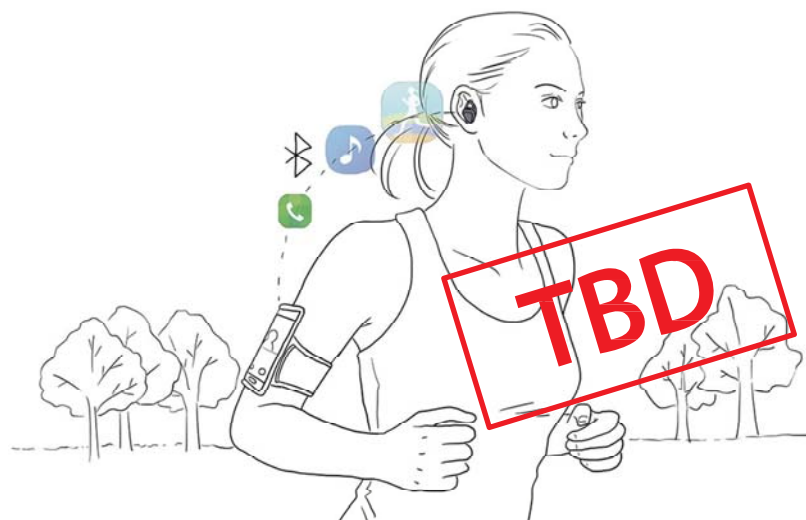

Package contents

Check the product box for the following items:

- Earbud (left/right)
- Charging case
- Wingtip (3 sets, S/M/L)
- Earbud tip (3 sets, S/M/L)
- USB cable
- USB connector
- Quick start guide



- The items supplied with the Gear IconX earbuds and any available accessories may vary depending on the region or service provider.
- The supplied items are designed only for this Gear IconX earbuds and may not be compatible with other devices.
- Appearances and specifications are subject to change without prior notice.
- You can purchase additional accessories from your local Samsung retailer. Make sure they are compatible with the Gear IconX earbuds before purchase.
- Use only Samsung-approved accessories. Using unapproved accessories may cause the performance problems and malfunctions that are not covered by the warranty.
- Availability of all accessories is subject to change depending entirely on manufacturing companies. For more information about available accessories, refer to the Samsung website.

Device layout

Earbud

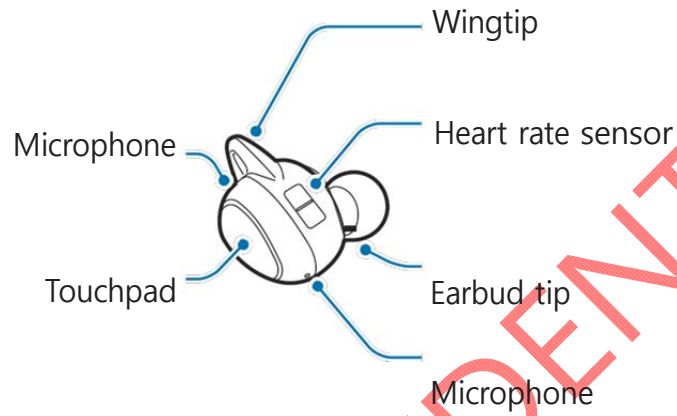

Charging case

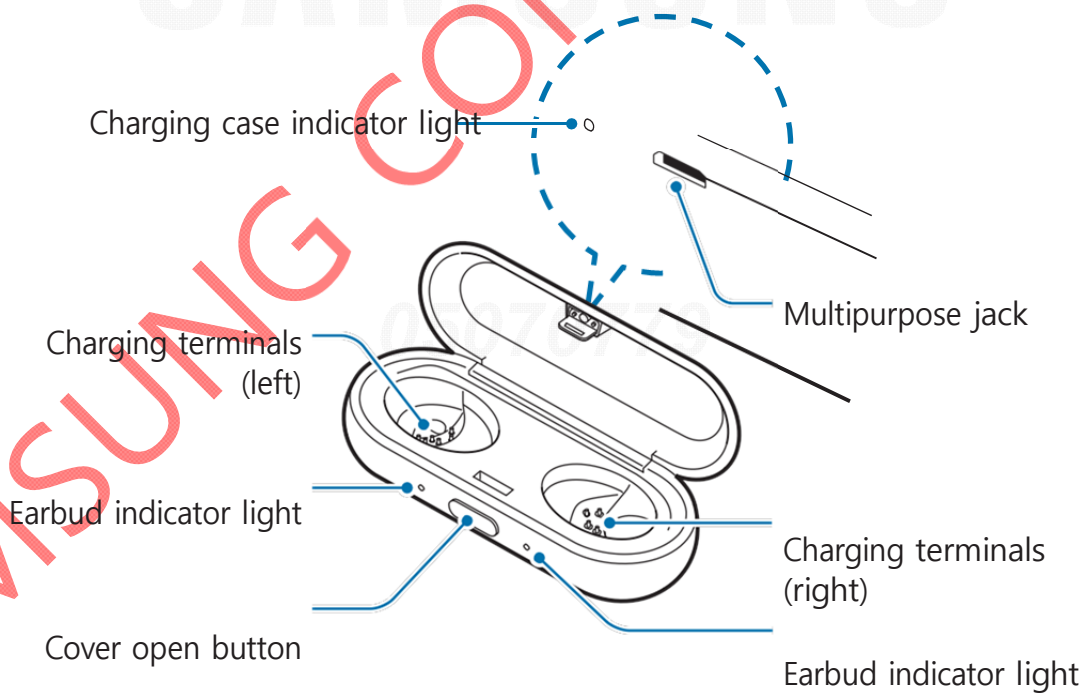

Charging the battery

Fully charge the battery before using the Gear IconX earbuds for the first time or when it has been unused for extended periods.

You can charge the Gear IconX earbuds with the charging case and a charger (sold separately). The charging case, which has a built-in battery, is charged along with the earbuds. You can charge the earbuds by placing them into the charging case without connecting to an electric socket.

- ⚠ Use only Samsung-approved chargers, batteries, and cables. Unapproved chargers or cables can cause the battery to explode or damage the Gear IconX earbuds.

- 1 Push the cover open button to open the charging case.
- 2 Check the direction of each earbud and insert them into the left and right slots of the charging case.

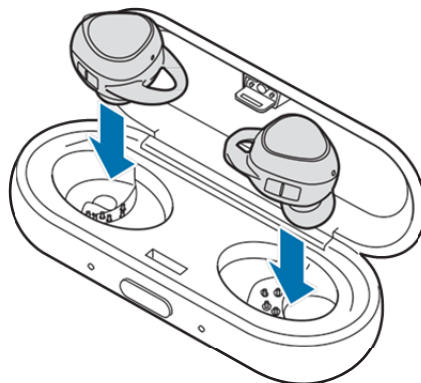

- 3 Close the charging case.

- 4 Connect the USB cable to the USB power adaptor, and then plug the end of the USB cable into the multipurpose jack of the charging case.

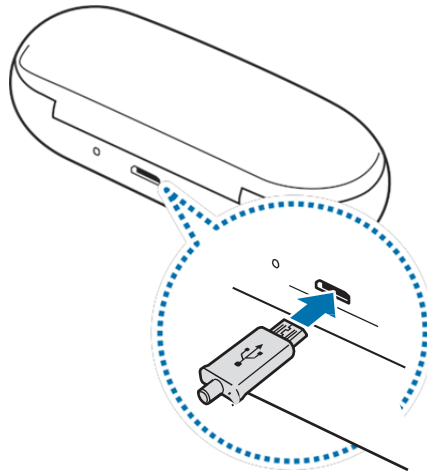

You can also connect the charging case to a computer via the included USB connector and cable to charge the Gear IconX earbuds.



Connecting the charger improperly may cause serious damage to the charging case. Any damage caused by misuse is not covered by the warranty.

- 5 Plug the USB power adaptor into an electric socket.

The batteries of the earbuds and the charging case are charged simultaneously.



- Using a power source other than the charger, such as a computer, may result in a slower charging speed due to a lower electric current.
- While charging, the charging case may heat up. This is normal and should not affect the Gear IconX earbuds' lifespan or performance. If the battery gets hotter than usual, the charger may stop charging.

6 After fully charging, disconnect the charging case from the charger. First unplug the charger from the charging case, and then unplug it from the electric socket.



- To save energy, unplug the charger when not in use. The charger does not have a power switch, so you must unplug the charger from the electric socket when not in use to avoid wasting power. The charger should remain close to the electric socket and be easily accessible while charging.
- If the Gear IconX earbuds and the charging case are fully discharged, it may take a while for the Gear IconX to start charging.
- If the earbuds and charging case are not charging properly, take them with the charger to a Samsung Service Center.

Indicator light identification

The indicator lights inform you of your Gear IconX's charging status. The earbuds' indicator lights are located on the front of the charging case and show the charging status of each earbud, respectively. The indicator light on the rear of the charging case indicates the charging status of the case itself.

Earbud indicator lights

Color	Status
Continuously on red	• Charging
Continuously on green	• Fully charged
Flashes red (fast)	• Charging stopped due to overheating
Flashes red (normal)	• No contact with the charging terminals

Charging case indicator light

Color	Status
Continuously on red	• Charging
Continuously on green	• Fully charged
Flashes red (fast)	• Charging stopped due to overheating
Flashes red (normal)	• Power lost while charging



- If power is lost, the indicator lights will flash red about for 30 seconds and turn off.
- When you disconnect the power source from the charging case after the earbuds are fully charged, the green indicator lights will turn off after three minutes.
- If the indicator light does not work as described, disconnect the charger from the Gear IconX and reconnect it.
- When the battery level drops to 10% or below, a voice guide will inform you of the battery level. Before the battery is fully discharged, connect the Gear IconX earbuds to your mobile device to save your exercise information.

Wearing the Gear IconX earbuds

Putting an earbud tip on the earbud

- 1 Select the earbud tip (S/M/L) that fits your ear.
- 2 Cover the latch at the bottom of the earbud with the earbud tip.

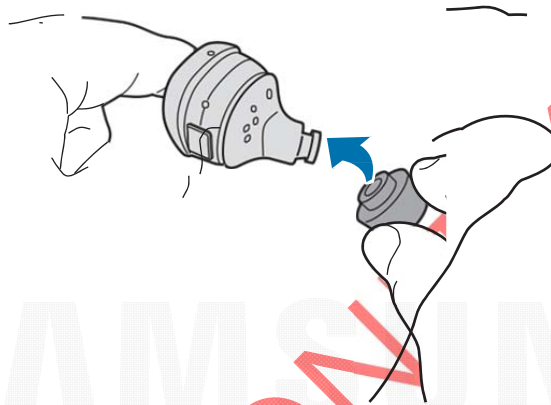

- Do not put the earbuds in your ears without earbud tips. Doing so may hurt your ears.
- Do not pull the earbud tip excessively. The earbud tip may tear.

- 3 Follow the same procedure for the other earbud.

Putting a wing tip on the earbud

- 1 Select the wing tip (S/M/L) that fits your ear.
- 2 Select the wing tip for the left or right ear.
- 3 Cover the earbud with the wingtip.

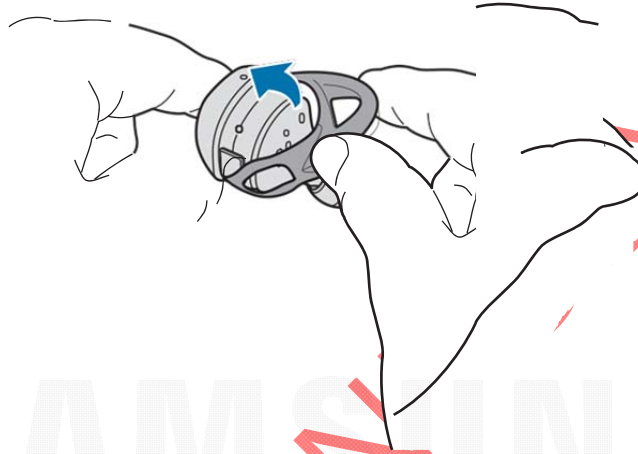

- 4 Adjust the wingtip so that the heart rate sensor is not blocked.



- Do not put the earbuds in your ears without wing tips. Doing so may hurt your ears.
- Do not pull the wingtip excessively. The wingtip may tear.

- 5 Follow the same procedure for the other earbud.

Wearing the earbuds

- 1 Check the direction of each earbud and insert them into your ears with the wingtip facing upwards.

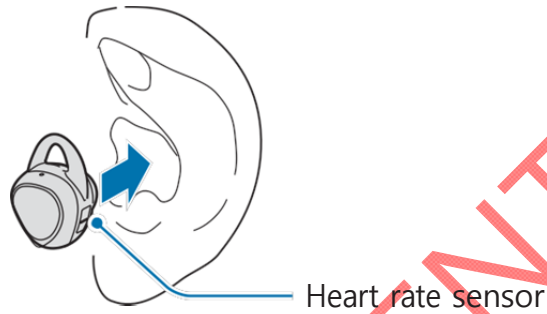

- 2 Adjust the earbuds by rotating them to the left or right to fit your ears.

The heart rate sensor will detect when you are wearing the earbuds and emit a beep. The

Gear IconX earbuds will enter Bluetooth pairing mode.



- If the heart rate sensor does not make contact with your ear, the earbud may not work.
- Follow all posted warnings and directions from authorized personnel in areas, such as aeroplanes and hospitals.

Connecting the Gear IconX earbuds to a mobile device

Connecting via Bluetooth

Bluetooth is a wireless technology standard that uses a 2.4 GHz frequency to connect to various devices over short distances. It can connect and exchange data with other Bluetooth enabled devices, such as mobile devices, without connecting via cables.

Notices for using Bluetooth

- To avoid problems when connecting your Gear IconX earbuds to another device, place the devices close to each other.
- Ensure that your Gear IconX earbuds and the other Bluetooth device are within the Bluetooth connection range (5 m). The distance may vary depending on the environment the devices are used in.
- Ensure that there are no obstacles between the Gear IconX earbuds and a connected device, including human bodies, walls, corners, or fences.
- Do not touch the Bluetooth antenna of a connected device.
- Bluetooth uses the same frequency as some industrial, scientific, medical, and low power products and interference may occur when making connections near these types of products.
- Some devices, especially those that are not tested or approved by the Bluetooth SIG, may be incompatible with the Gear IconX earbuds.
- Do not use the Bluetooth feature for illegal purposes (for example, pirating copies of files or illegally tapping communications for commercial purposes).

Connecting to a mobile device

Connect the Gear IconX earbuds to your mobile device to save music files in the earbuds, answer calls, and record your exercise information. To connect your Gear IconX earbuds to a mobile device, install the Samsung Gear app on the mobile device.

Depending on your device, you can download the Samsung Gear app from the following places:

- Samsung Android devices: Galaxy Apps, apps.samsung.com/gear
- Other Android devices: Play Store, apps.samsung.com/gear

- 1 Insert both earbuds into your ears.
They automatically enter Bluetooth pairing mode.

- 2 On the Apps screen, tap Samsung Gear.
- 3 Tap CONNECT TO GEAR.
- 4 Tap OK when the Bluetooth activation request window appears.
- 5 Follow the on-screen instructions to complete the connection.

When your Gear IconX earbuds and mobile device are connected, a voice guide will inform you that a connection has been made.



- Once devices are paired, recently connected devices automatically connect to your headset whenever you turn it on.
- If the Bluetooth connection fails or the other device cannot locate the Gear IconX earbuds, remove the device's information from the other

device's list. Then, try to connect again.

- The Bluetooth connection range and sound quality may vary depending on the connected devices.

Disconnecting devices

Remove the earbuds from your ears to end the current connection. Alternatively, on the Apps screen of the mobile device, tap Samsung Gear → MORE → Disconnect.

Reconnecting devices

Insert both earbuds into your ears to connect to your mobile device again. Alternatively, on the Apps screen of the mobile device, tap Samsung Gear → MORE → Connect.

Connecting with new Gear IconX earbuds

You can disconnect the Gear IconX earbuds from your mobile device and connect new ones. Tap MORE → Connect to new Gear.

Coupling the two earbuds

Insert both earbuds into your ears. When you wear the earbuds for the first time, they will automatically couple and emit a beep. Once coupled, they will be automatically connected in the future.



- If an earbud comes out of your ear, the coupling between the two earbuds is disconnected.
- When the coupling is disconnected, wear both earbuds again. The coupling is automatically recovered. If the coupling is not recovered, keep the earbuds in the charging case for a while and then wear them again.
- If you lose an earbud, you may have a problem using some Gear IconX earbuds'

features. You can purchase additional earbuds. Visit a Samsung Service Center.

Setting the main earbud

Set the main earbud to use the call feature and to record exercise information.

On the Apps screen of the mobile device, tap Samsung Gear → SETTINGS → Settings →

Select main earbud, and then tap Right or Left.

Using the Gear IconX

Using the touchpad



- To avoid hurting your ears, do not apply excessive pressure to the touchpad with your fingertips.
- To avoid damaging the touchpad, do not tap it with anything sharp.



- It may take a while for the touchpad to function correctly after the Gear IconX

earbuds turn
on.

- The direction in which you wear the Gear IconX earbuds will affect the direction of your drag on the touchpad. Wear the earbuds correctly. For more information, refer to [Wearing the earbuds](#).

Tapping

To play or pause music or to answer or end a call, tap the touchpad with your finger. When you answer a second call during a call, tap the touchpad to switch between the calls.

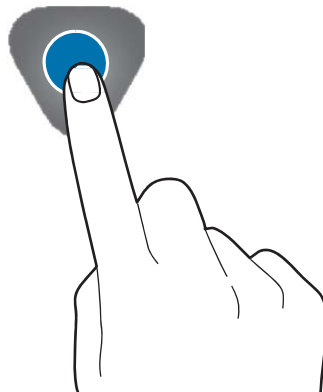

Double-tapping

Double-tap the touchpad to skip to the next song during music playback.

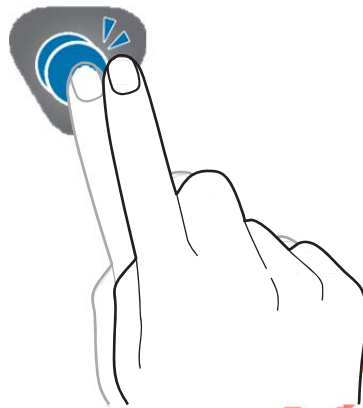

Tapping three times

Tap the touchpad three times to skip to the previous song during music playback.

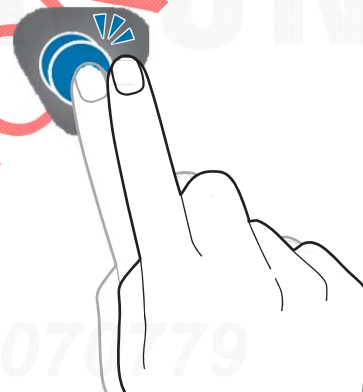

Tapping and holding

Tap and hold the touchpad for more than two seconds to hear the readout menus, to reject a call, or turn off the microphone during a call.

When you have a call placed on hold, tap and hold the touchpad for more than two seconds to end the current call and resume the call on hold.

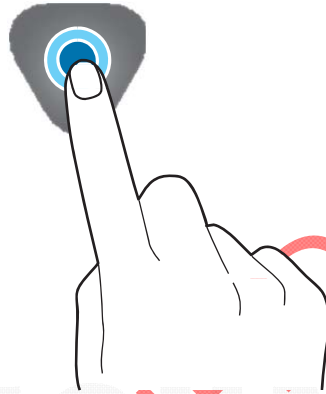

Dragging

Drag your finger upwards or downwards on the touchpad to adjust the volume.

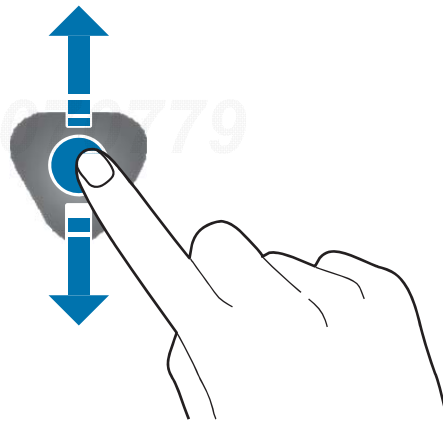

Transferring music files to the Gear IconX earbuds

Transferring music files from your mobile device

Transfer music files from your mobile device to your Gear IconX earbuds via the Samsung

Gear app on your mobile device.



- The music files which are not transferred via the Samsung Gear app may not be played.
- The Gear IconX earbuds support the MP3, WAV, WMA, and AAC file formats.
- You can save up to 1,000 music files in the Gear IconX earbuds.

- 1 Place the earbuds in the charging case.
- 2 Plug the USB connector into the multipurpose jack of your mobile device. Connect the charging case and the mobile device using the USB cable.

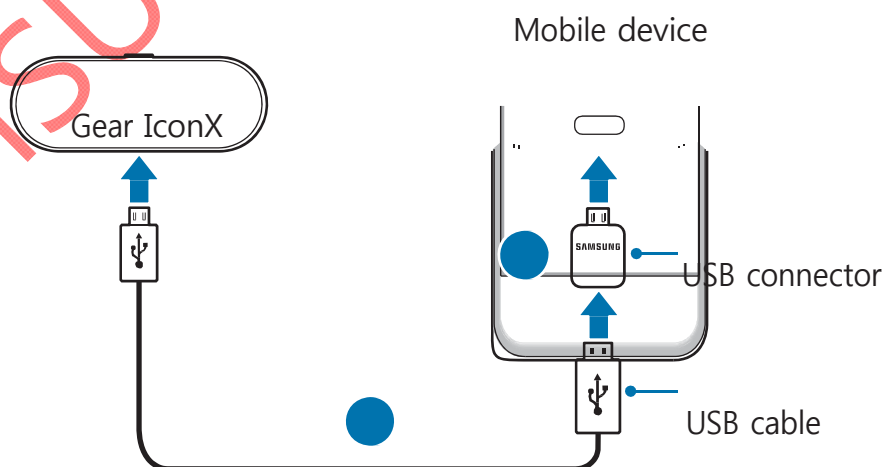



- You must plug the USB connector into your mobile device. If you plug the USB connector into the Gear IconX, your mobile device will not recognize the Gear IconX.
- Transferring data with the USB connector increases the battery power consumption. Ensure that the battery is fully charged before transferring data. If the battery power is low, data transfer may be interrupted.

3 On the Apps screen of the mobile device, tap Samsung Gear → SETTINGS → Music → Manage tracks → ADD. Alternatively, tap Samsung Gear → Memory → ADD.

4 Tick music files to transfer and tap DONE.



Do not disconnect the USB cable or USB connector from the Gear IconX earbuds or mobile device when you are transferring files. Doing so may cause data loss or device damage.

Transferring music files from your computer

Transfer music files from your computer to the Gear IconX earbuds using the Gear IconX earbuds as a removable disk for data transfer. To connect your Gear IconX to a computer, install the Samsung Gear program on the computer.

Depending on the computer's OS type, you can download the Samsung Gear program from the following places:

- Windows:

1 Place the earbuds in the charging case.

Using the Gear

2 Connect the charging case and the computer using the USB cable.

3 In the computer, run Samsung Gear and click Add.

4 Select music files to transfer and click Open.



Music files are saved in the MUSIC folder of the Gear IconX earbuds. Do not change the folder name or create a new folder. If you make any changes to the file directory of the Gear IconX earbuds, the music files may not play.

Listening to music

Playing music files saved in the Gear IconX

Listen to music saved in the Gear IconX earbuds without connecting them to your mobile device.

Tap the touchpad to play music.



The same music files must be saved in the left and right earbuds. If the music files in each earbud are different, the Gear IconX earbuds will play only the music files in the main earbud.

Pausing or resuming playback

Tap the touchpad to pause or resume playback.

Skipping to the next song

Double-tap the touchpad to skip to the next song during playback.

Skipping to the previous song

Tap the touchpad three times to skip to the previous song during playback.

Adjusting the volume

Drag your finger upwards or downwards on the touchpad to adjust the volume during playback.



Listening to music at a high volume may cause hearing damage.

Playing music files saved in your mobile device

Listen to music saved in your mobile device by connecting the Gear IconX earbuds to the mobile device. You can stream music played from the connected mobile device without saving music files in the Gear IconX earbuds.

On the mobile device, launch a music player app and play music. You can control the playback in the same way as when playing music saved in the Gear IconX earbuds.



- Adjust the volume via your connected device if a sound is low on your Gear IconX earbuds while at full volume.
- If you connect the Gear IconX earbuds to your mobile device while listening to music, the volume may change.

Recording exercise information

Starting a workout

Record and save exercise information, such as activity duration and burnt calories, without connecting the Gear IconX earbuds to your mobile device.

- 1 Tap and hold the touchpad and release it when you hear "Start workout".
- 2 When you hear "Workout starts" followed by four beeps, start your workout.
 - To check the status of your workout, tap and hold the touchpad and release it when you hear "Workout status". Then, you will hear the recorded exercise information. You can select the types of information to be played in the Exercise audio guide option.
 - To hear your surroundings during your workout, tap and hold the touchpad

Using the Gear

and release it when you hear "Ambient sound". Then, you will hear "Ambient sound mode turns on".

- If the heart rate sensor does not make contact with your ear, the Gear IconX earbuds may stop working. Remove the earbuds from your ears and insert them into your ears again. When you hear "Workout starts again", you can continue your workout.

- 3 When you have finished your workout, tap and hold the touchpad and release it when you hear "Finish workout".

You will hear the details of your workout.



- The Gear IconX earbuds can recognize and save information only for walking and running.
- The voice guide will give you the following types of information during or after your workout:
 - Type of workout
 - Total duration
 - Total distance
 - Average speed
 - Average heart rate
 - Total amount of burnt calories

Viewing exercise information

You can view the recorded exercise information on the S Health app of the connected mobile device. After finishing your workout, connect the Gear IconX earbuds to your mobile device while you are wearing them.

Starting a workout with the Gear IconX connected to your mobile device

When you work out with the Gear IconX earbuds connected to your mobile device, the exercise information will be recorded directly to the S Health app of the connected mobile device.

- 1 Connect the Gear IconX earbuds to your mobile device. For more information, refer to

SAMSUNG CONFIDENTIAL

SAMSUNG

05070779

2 On the Apps screen of the mobile device, tap S Health → MORE → Accessory → Gear IconX.

3 Tap and hold the touchpad and release it when you hear "Start workout". Ensure that the heart rate sensor makes contact with your ear. When you hear "Workout starts" followed by four beeps, start your workout.

You can check the status of your workout in real time on the S Health app of the connected mobile device.

4 When you have finished your workout, tap and hold the touchpad and release it when you hear "Finish workout".



You can also use the Gear IconX earbuds with other heart rate monitor (HRM) apps.

Using call features

Answer and control calls with the Gear IconX earbuds.

Answering or rejecting a call

When a call comes in while you are wearing the Gear IconX earbuds, they will emit a beep and vibrate. Drag your finger upwards or downwards on the touchpad to stop the vibration.

To answer the call, tap the touchpad.

To reject the call, tap and hold the touchpad.



When a call comes in, a voice guide will inform you of the caller information. You can answer or reject the call by saying a voice command. To help the Gear IconX earbuds recognize your command, say a command when the

Using the Gear

Gear IconX earbuds do not vibrate.

SAMSUNG CONFIDENTIAL

SAMSUNG

05070779

Adjusting the volume

Drag your finger upwards or downwards on the touchpad to adjust the volume during a call.

Placing a call on hold

Tap and hold the touchpad to place the current call on hold.

Answering a second call

When a second call comes in during a call, the Gear IconX earbuds will emit a beep. To end the current call and answer the second call, tap and hold the touchpad.

To place the current call on hold and answer the second call, tap the touchpad. To switch between the two calls, tap the touchpad.

Turning off the microphone

Tap and hold the touchpad to turn off the microphone so that the other party cannot hear you.

Ending a call

Tap the touchpad to end the current call.

Using ambient sound mode

Hear your surroundings while you are listening to music outdoors, so you can quickly detect any potentially dangerous situations.

Tap and hold the touchpad and release it when you hear "Ambient sound". Then, you will hear

Using the Gear

"Ambient sound mode turns on" and the feature will be activated.



- You can activate or deactivate this feature via the connected mobile device. For more information, refer to [Customising settings](#).
- During a call, ambient sound mode turns off automatically. After the call, the mode returns to the previous state.

Customising settings

INFO

View the status of the Gear IconX earbuds connected to your mobile device. On the Apps screen of the mobile device, tap Samsung Gear → INFO.

- Device info: View the connection status and the remaining battery level of the Gear IconX earbuds.
- Memory: View the Gear IconX earbuds' storage capacity and the list of music files saved in the Gear IconX earbuds.
- Music: View the file name of the currently playing music.
- Volume: Adjust the sound volume of the Gear IconX earbuds.
- Exercise: View your exercise information detected by the Gear IconX earbuds.

SETTINGS

Customize the settings of the Gear IconX earbuds connected to your mobile device. On the Apps screen of the mobile device, tap Samsung Gear → SETTINGS.

Music

- Manage tracks: Transfer music files from your mobile device to the Gear IconX earbuds.
- Shuffle: Turn shuffle on or off.
- Music control feedback: Select a feedback sound type when you touch the

Using the Gear
touchpad to control music playback.

Notifications

You will receive notifications from apps of the mobile device via the Gear IconX earbuds. Even if you deactivate notifications, you will still receive notifications for incoming calls and alarms.

- Notifications: Change the notification settings for each app.

Settings

- Exercise audio guide: Activate the audio guide to hear exercise information during your workout, and select an interval for the audio guide messages.



If the heart rate sensor does not make contact with your ear, this feature may not work properly.

- Ambient sound: Activate ambient sound mode to hear your surroundings. In ambient sound mode, you can quickly detect any potentially dangerous situations even while listening to music.
- Readout menu: Set the Gear IconX earbuds to read out the menus used for recording exercise information. You can hear and select the menus by tapping and holding the touchpad.
- Voice command: Set to use voice commands for answering or rejecting calls.
- Select main earbud: Set an earbud as the main earbud to be used for answering calls and recording exercise information. The right earbud is preset as the main earbud.
- About Gear IconX: View the device information of the Gear IconX earbuds, change the device name, and update the software. You can also reset the Gear IconX earbuds.

Appendix

Troubleshooting

Before contacting a Samsung Service Center, please attempt the following solutions. Some situations may not apply to your Gear IconX earbuds.

Your Gear IconX earbuds do not work

- When the battery is completely discharged, you cannot use your Gear IconX earbuds.

Charge the battery completely before using the Gear IconX earbuds.

- If an earbud's heart rate sensor does not make contact with your ear, the earbud may not work. If you do not hear a beep informing you that the Gear IconX earbuds are active, remove the earbuds from your ears and put them in again.

Another Bluetooth device cannot locate your Gear IconX earbuds

- When you wear the earbuds, listen for the beep to ensure that your Gear IconX earbuds have entered Bluetooth pairing mode.
- Reset the Gear IconX earbuds and try searching for them again.
- Ensure that your Gear IconX earbuds and the other Bluetooth device are within the Bluetooth connection range (5 m).

If the tips above do not solve the problem, contact a Samsung Service Center.

A Bluetooth connection is not established or your Gear IconX earbuds and the mobile device are disconnected

- Ensure there are no obstacles, such as walls or electrical equipment, between the devices.
- Ensure that the latest version of the Samsung Gear app is installed on the mobile device.
- Ensure that your Gear IconX earbuds and the other Bluetooth device are within the Bluetooth connection range (5 m). The distance may vary depending on the environment the devices are used in.
- Restart the mobile device and relaunch the Samsung Gear app.

The battery does not charge properly (For Samsung-approved chargers)

- Ensure that the charging terminals of the Gear IconX earbuds and the charging case are in contact with each other.
- Ensure that the charger is connected properly.
- If the battery terminals are dirty, the battery may not charge properly. Wipe both gold- colored contacts and try charging the battery again.
- Visit a Samsung Service Center and have the battery replaced.

You cannot hear others speaking

- Adjust the earbud volume.
- Adjust the volume on the connected device when you cannot hear sounds on your Gear

IconX earbuds at full
volume.

Sound echoes during a call

Adjust the volume by dragging your finger upwards or downwards on the touchpad, or move to another area.

SAMSUNG CONFIDENTIAL

SAMSUNG

05070779

Audio quality is poor

- Wireless network services may be disabled due to issues with the service provider's network. Ensure to keep the Gear IconX earbuds away from electromagnetic waves.
- Ensure that your Gear IconX earbuds and the other Bluetooth device are within the maximum Bluetooth range (5 m).

The battery depletes faster than when first purchased

- When you expose the Gear IconX or the battery to very cold or very hot temperatures, the useful charge may be reduced.
- The battery is consumable and the useful charge will get shorter over time.

The time on the Gear IconX earbuds have been reset

The time will be reset when the Gear IconX earbuds are fully discharged. You can set the time by connecting it to the mobile device via Bluetooth.

Your Gear IconX earbuds are hot to the touch

When you use the Gear IconX earbuds for an extended period of time, it may feel hot to the touch. This is normal and should not affect your Gear IconX earbuds' lifespan or performance.

If the Gear IconX earbuds overheat or feel hot for a prolonged period, do not use them for a while. If the Gear IconX earbuds continues to overheat, contact a Samsung Service Center.

A small gap appears around the outside of the Gear IconX case

- This gap is a necessary manufacturing feature and some minor rocking or

vibration of parts may occur.

- Over time, friction between parts may cause this gap to expand slightly.

Resetting the Gear IconX earbuds

You can reset the settings and delete the music files from your Gear IconX earbuds. Before performing a reset, remember to make backup copies of any music files you do not want to delete.

Resetting the Gear IconX earbuds via the Samsung Gear app

- 1 On the Apps screen of the mobile device, tap Samsung Gear.
- 2 Tap SETTINGS → Settings → About Gear IconX → Reset Gear IconX.
- 3 Tap Reset Gear.

Resetting the Gear IconX earbuds via the Reset button

- 1 Remove the wingtip from an earbud. Then, use a paper clip to press and hold the Reset button for more than seven seconds.

The earbud will turn off.

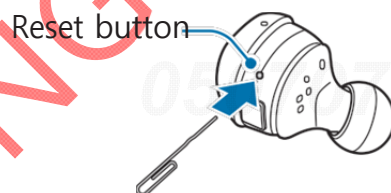

- 2 Press and hold the Reset button for more than three seconds to reset the earbud.

All files saved in the earbud will be deleted.

Removing the battery

- To remove the battery, you **must** visit an authorized service center with the provided instructions.
- For your safety, you **must not attempt to remove** the battery. If the battery is not properly removed, it may lead to damage to the battery and device, cause personal injury, and/or result in the device being unsafe.
- Samsung does not accept liability for any damage or loss (whether in contract or tort, including negligence) which may arise from failure to precisely follow these warnings and instructions, other than death or personal injury caused by Samsung's negligence.

- 1 Remove the wingtip and earbud tip from the earbud.
- 2 Remove the touchpad using a flat-edged tool.
- 3 Desolder the circuit board using a soldering iron, then remove it out of the battery bracket.
- 4 Remove the battery.

FCC Notice and Cautions

FCC Part 15.19

This device complies with part 15 of the FCC Rules. Operation is subject to the following two conditions: (1) This device may not cause harmful interference, and (2) this device must accept any interference received, including interference that may cause undesired operation.

FCC Part 15.21

Any changes or modifications (including the antennas) to this device that are not expressly approved by the manufacturer may void the user's authority to operate the equipment.

Note : This equipment has been tested and found to comply with the limits for a Class B digital device, pursuant to part 15 of the FCC Rules. These limits are designed to provide reasonable protection against harmful interference in a residential installation. This equipment generates, uses and can radiate radio frequency energy and, if not installed and used in accordance with the instructions, may cause harmful interference to radio communications. However, there is no guarantee that interference will not occur in a particular installation. If this equipment does cause harmful interference to radio or television reception, which can be determined by turning the equipment off and on, the user is encouraged to try to correct the interference by one or more of the following measures:

- Reorient or relocate the receiving antenna.
- Increase the separation between the equipment and receiver.
- Connect the equipment into an outlet on a circuit different from that to which the receiver is connected.
- Consult the dealer or an experienced radio/TV technician for help.

Modifications not expressly approved by the manufacturer could void your authority to operate the equipment under FCC rules.

FCC RF Radiation Exposure Statement: This equipment complies with FCC RF Radiation exposure limits set forth for an uncontrolled environment.

This device and its antenna must not be co-located or operating in conjunction with any other antenna or transmitter.

Copyright

Copyright © 2016 Samsung Electronics

This manual is protected under international copyright laws.

No part of this manual may be reproduced, distributed, translated, or transmitted in any form or by any means, electronic or mechanical, including photocopying, recording, or storing in any information storage and retrieval system, without the prior written permission of Samsung Electronics.

Trademarks

- SAMSUNG and the SAMSUNG logo are registered trademarks of Samsung Electronics.
- Bluetooth® is a registered trademark of Bluetooth SIG, Inc. worldwide.
- All other trademarks and copyrights are the property of their respective owners.



LEFT EARBUD FCC ID : A3LSMR150L
RIGHT EARBUD FCC ID : A3LSMR150R
LEFT EARBUD IC : 649E-SMR150L
RIGHT EARBUD IC : 649E-SMR150R
5V ; 50mA
S/N : 00000
Made in Vietnam
DESIGNED BY SAMSUNG



Fabriqué en Vietnam
Conçu par Samsung