

Top of Dial Remote

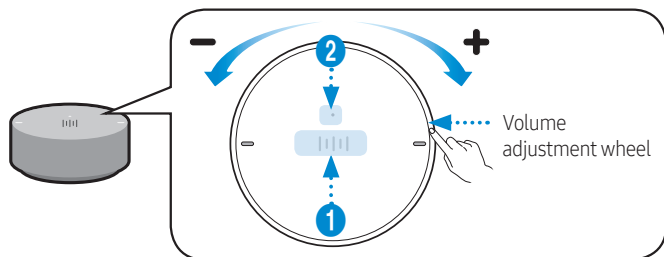

1

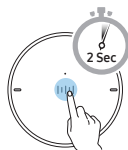
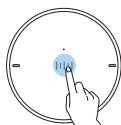

Mobile device voice recognition
* Bluetooth dedicated function

2

LED Display For more information, see page 5.

Bottom of Dial Remote

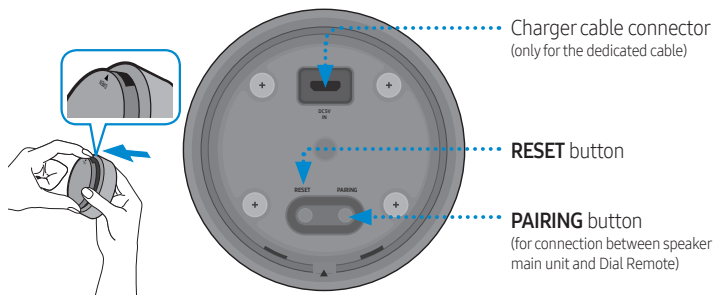

Using Dial Remote

Connecting between the Dial Remote and Speaker

* Before use of the Dial Remote

Charge the dial until the LED lights.
(When fully charged, the LED changes to green.)

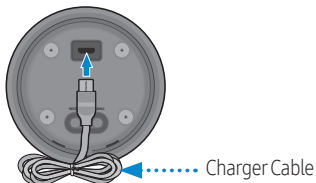

1

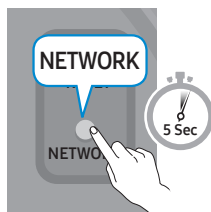
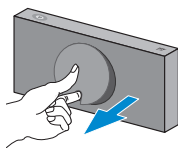

2

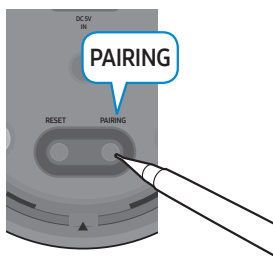
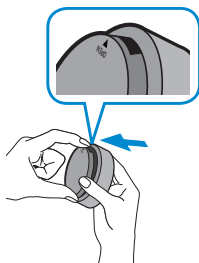

Additional functions - Mobile device voice recognition

Dedicated functions in Bluetooth mode

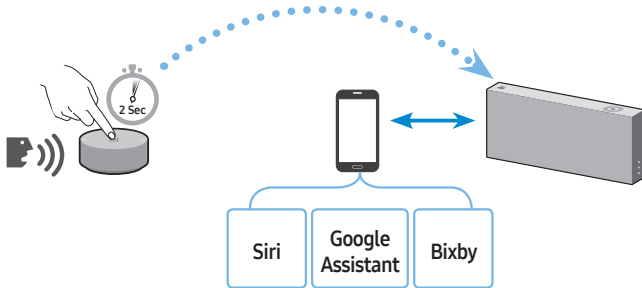

Function example	Speaking example
Listening to music	Play xxx from Spotify
Text message	Send xxx to Mom

- ✓ Available functions may differ depending on the specification for mobile device voice recognition from OS.

Additional functions - Mobile device voice recognition

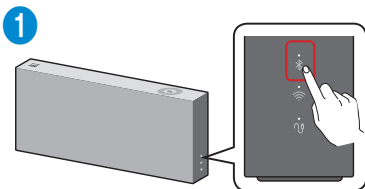

Press the **Bluetooth** button on the right side of the main unit to switch to **BT** mode.

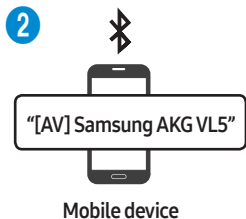

Select "[AV] Samsung AKG VL5" from the Bluetooth speaker list on your mobile device.

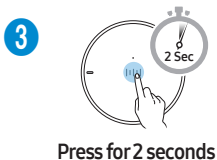

Press the **Multi-function** button on Dial Remote for more than 2 seconds.

- The mobile device voice recognition function is activated.

CAUTION

- ✓ Keeping a device more than 0.6 inches from a face, when using the voice-control to work through mic.

* Troubleshooting

- If it is unavailable even when you press the **Multi-function** button for more than 2 seconds, check the connection between the mobile device and Bluetooth.
- For more information about connection to a mobile device, refer to Full Manual at the Samsung website.

Reference

LED specifications on Dial Remote

LED	Status	Description	
		Operation	Battery
Off	All Off	Standby	Battery discharged
White	Off	Normal operation	Fully charged
Blue	On	Mobile voice recognition active (Dedicated for Bluetooth)	-
Green	Blinking	Waiting for connection to the speaker	-
Red	On	Connection to the speaker failure	While using the charger cable: Until it is fully charged
		In error	

FCC Information

This device complies with part 15 of the FCC Rules. Operation is subject to the following two conditions :

- (1) This Device may not cause harmful interference, and
- (2) This device must accept any interference received, including interference that may cause undesired operation.

Note: This equipment has been tested and found to comply with the limits for CLASS B digital device, pursuant to Part 15 of FCC Rules. These limits are designed to provide reasonable protection against harmful interference when the equipment is operated in a commercial environment. This equipment generates, uses and can radiate radio frequency energy and, if not installed and used in accordance with the instructions, may cause harmful interference to radio communications. However, there is no guarantee that interference will not occur in a particular installation. If this equipment does cause harmful interference to radio or television reception, which can be determined by turning the equipment off and on, the user is encouraged to try correct the interference by one or more of the following measures:

- 1.1. Reorient or relocate the receiving antenna.
- 1.2. Increase the separation between the equipment and receiver.
- 1.3. Connect the equipment into an outlet on a circuit different from that to which receiver is connected.
- 1.4. Consult the dealer or experienced radio/TV technician for help.

WARNING

Changes or modifications not expressly approved by the manufacturer could void the user's authority to operate the equipment.

"CAUTION : Exposure to Radio Frequency Radiation.

Antenna shall be mounted in such a manner to minimize the potential for human contact during normal operation. The antenna should not be contacted during operation to avoid the possibility of exceeding the FCC radio frequency exposure limit.

"ATTENTION: L'exposition aux rayonnements à fréquence radioélectrique.

Antenne doit être montée de telle manière à minimiser le risque de contact humain pendant l'utilisation normale. L'antenne ne doit pas être contacté pendant le fonctionnement pour éviter la possibilité de dépasser la limite de l'exposition aux fréquences radio de la FCC.

IC Information

This device complies with Industry Canada license-exempt RSS standard(s). Operation is subject to The following two conditions: (1) this device may not cause interference, and (2) this device must accept any interference, including interference that may cause undesired operation of the device.

Le présent appareil est conforme aux CNR d'Industrie Canada applicables aux appareils radio exempts de licence. L'exploitation est autorisée aux deux conditions suivantes:

- 1) l'appareil ne doit pas produire de brouillage;
- 2) l'appareil doit accepter tout brouillage radioélectrique subi, même si le brouillage est susceptible d'en compromettre le fonctionnement.