

Introduction

What is the WEA512i?

The Samsung WEA512i is an Access Point (AP) which has been designed for the wireless communications optimized for indoor hotspot environment. It offers unparalleled performance and connectives for all wireless devices such as smartphones, laptops, tablets etc. The WEA512i supports the following features:

- IEEE 802.11a/b/g/n/ac standard
- PoE (Power over Ethernet) IEEE 802.3af
- 2 × 2 MU-MIMO (Multi User-Multiple Input Multiple Output)
- Wireless LAN through both 2.4 GHz and 5 GHz bandwidth simultaneously

Components

After unpacking the WEA512i, check whether all of the following components are included.



WEA512i

Package Contents

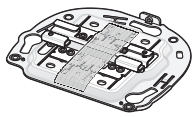

Mounting Bracket



5 M3 × L6 screws
(Including 1 spare)



Installation Manual



Security Torx (T10) Screw



Plastic 4 anchors



4 M4 × L28 screws



NOTE

- It is recommended to keep all packaging materials and the box.
- The power adapter is sold separately. When necessary, please contact the place of purchase.

Functions

Front View

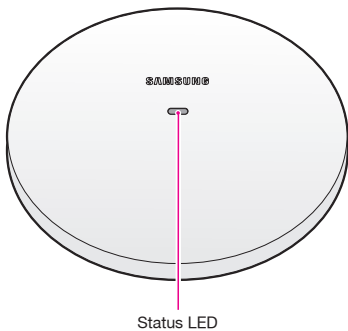

Status LED

Rear View

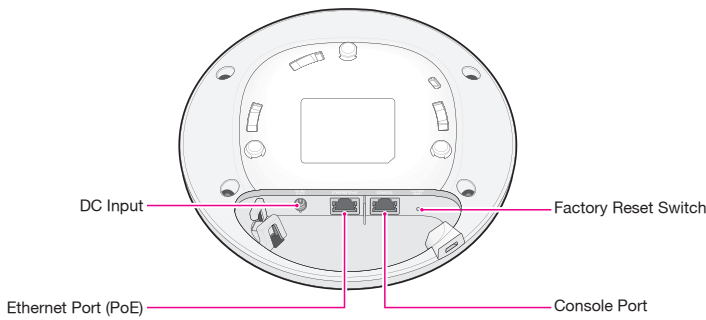

NOTE

- A dust cover is installed on DC Input port (DC 48 V). Remove the cover before use.

Interface

Port Name	Description
Status LED	Displays the status information of the WEA512i via LED.
DC Input	This is for connecting the power adapter when the PoE is not available.
Ethernet Port (PoE)	Supports 1000 BASE-T Gigabit Ethernet and PoE IEEE 802.3af.
Console Port	This is used for checking the operational status of the WEA512i and for CLI input.
Factory Reset Switch	This is used to reset the WEA512i to the initial factory settings.

Status LED

LED	Status	Description
System start status	White On	Initial LED status
	Blue On	Device reset and test in progress
	Red On	Booting failure (Device reset failure)
Normal operation status	Green On	When there is no connected wireless UE
	Blue On	When there is a connected wireless UE
Upgrade	Green blinking	Software upgrade in progress
Error status	Red blinking	Physical connection error of network
	Yellow blinking	IP address conflict
	Purple blinking	Dynamic IP address allocation failure
	Bluish-green blinking	Logical connection error of network
	Red, green and off repeated	Wireless interface error

Installation

The WEA512i can be installed on ceilings or walls. Please check whether all the components are included before installation.

Before Installation

Safety Requirements

Risks may be caused when the following safety warnings are not properly observed. For safe use, make sure to be well-informed.



WARNING

- There is an electrical risk with the product. Make sure that the power is off during installation and do not proceed with the installation when there is current leakage. Use of products with current leakage may cause serious electrical shock to the user.
- Wear anti-static gloves or take appropriate actions to prevent ESD when handling the product.
- The wired LAN hub providing power over the Ethernet (PoE) in accordance with IEEE 802-3af/at shall be a UL Listed device with the output evaluated as a Limited Power Source as defined in IEC/EN/UL60950-1.



CAUTION

- This product must be installed or removed only by appropriately-trained service personnel.
- All interconnecting equipment including this product must be installed within the same building. For details, refer to Environment A of IEEE 802.3af/at standard.
- This product must be installed with at least 3 m or more distance from the WiMAX/3G/4G repeater or antenna.

Installation Instructions

The instructions below must be followed when installing.

- It must be installed in a place that can be easily accessed for product installation, cable connection and maintenance.
- The PoE LAN cable must be always installed away from any electrical interference source such as power lines, fluorescent lights or transmitters.
- The PoE LAN cable must be CAT 5E or higher.
- When PoE is unavailable, a power adapter (sold separately) can be used. The 3-pin (including ground) power socket that supplies 100~240 V AC, 50~60 Hz must be located within 2 m from each equipment and the power must be supplied through an independent circuit breaker. It is recommended to use the equipment that uses a filter or a surge protector.

Installation on Ceilings (When the ceiling type is T-bar)



CAUTION

- When incorrectly installed on the ceiling, the WEA512i may drop onto a person or equipment. Therefore, make sure to fix it firmly.
- If the ceiling type is not T-Bar, please refer to the 'Installation Manual' provided separately. For this installation manual, please contact the dealer.

1. Remove the holding tape that was attached to fix the ceiling clip.

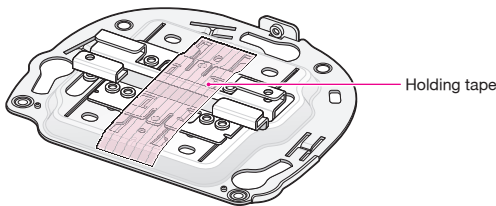

2. Open the ceiling clip so that it is wider than the width of the T-bar.

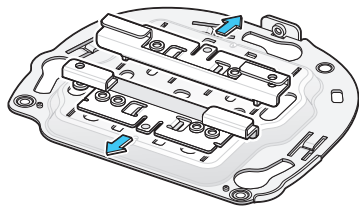

3. Move the ceiling clip so that it is appropriate for the T-bar width.



4. Fix the ceiling clip in place by tightening the 4 designated screws.

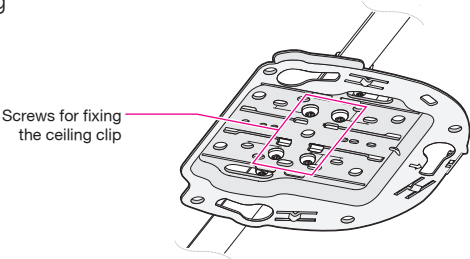

5. Fix the T-bar in place by fastening the screws (total of 2) that are on the ceiling clip.

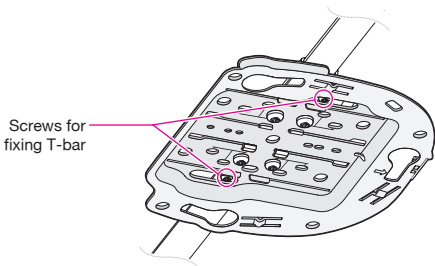

NOTE If the T-bar size of the ceiling is 15 mm, 24 mm or 38 mm, the position to fix the ceiling clip can be checked from the bottom surface of the mounting bracket. If the T-bar size is unknown, push the ceiling clip to check the fixing positions.

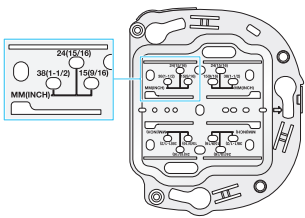

6. Pull out a LAN cable through a hole on the ceiling and connect it to an Ethernet port (PoE) on the back side of the WEA512i.

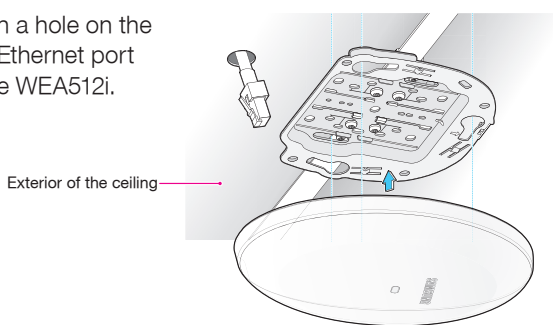

NOTE If PoE is not supported, connect the power adapter to the DC input on the back side of the WEA512i.

7. Align the WEA512i with the 3 holes on the mounting bracket and then turn clockwise to fix it in place. Clean up the ceiling and other cables.

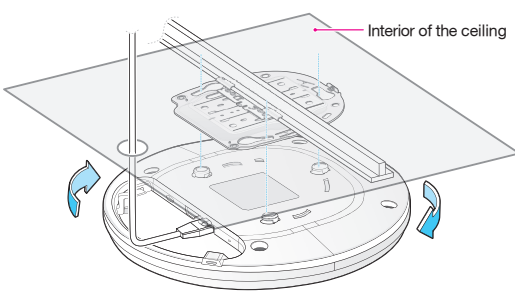

Installation on Walls

1. Remove the holding tape that was attached to fix the ceiling clip.

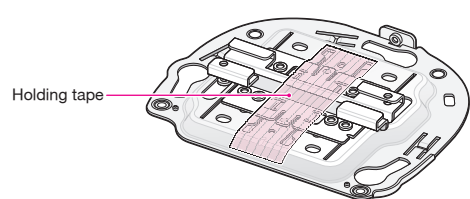

2. Remove the ceiling clip from the mounting bracket.

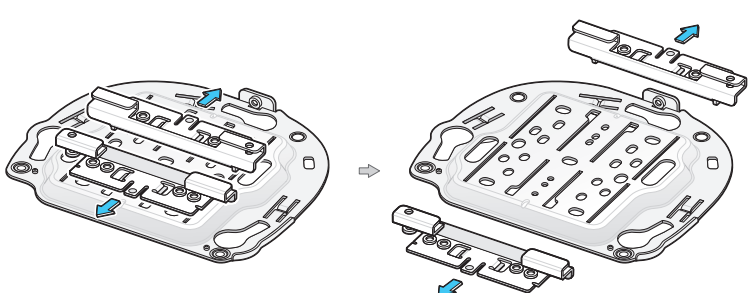

3. Place the mounting bracket on the wall. Mark and drill 4 screws in appropriate spots.

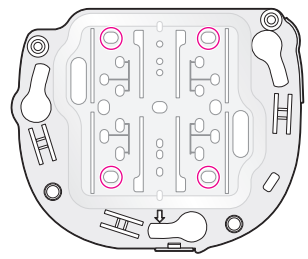

4. Use a hammer to insert 4 plastic anchors into the drilled holes on the wall. Align the inserted plastic anchors and the screw holes of the bracket. Fix the bracket to the wall by fastening four M4 x L28 screws.

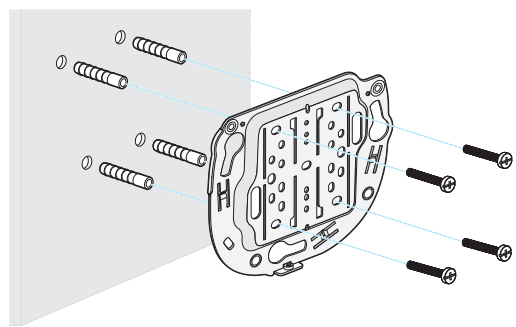

5. Insert a LAN cable into the Ethernet port (PoE) on the back side of the WEA512i.



If PoE is not supported, connect the power adapter to the DC input on the back of the WEA512i.

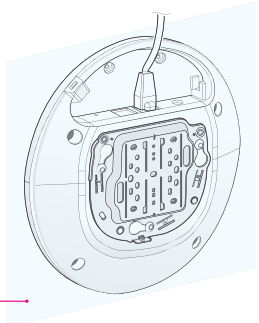

Installing Anti-Theft Lock Cable

When installing the WEA512i in a public place, it is recommended to use anti-theft lock cables to prevent any loss. (An anti-theft lock cable can be purchased separately and a variety of products can be found in the market.)

1. Connect the anti-theft lock cable to the WEA512i.

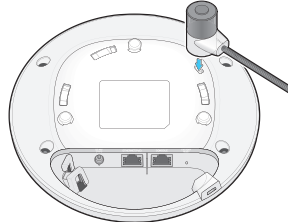

or

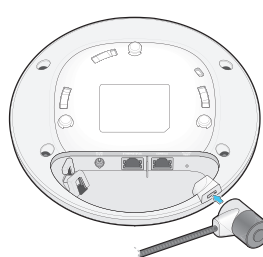

2. Turn the lock cable key to lock the cable.
3. Remove the key from the lock cable and keep it in a separate location.



Using the anti-theft Torx screws

The WEA512i can be prevented from being stolen when tightening the Torx screws as shown below. (Torx screws can be easily tightening when they are fixed to the mounting bracket before assembling the AP product.)

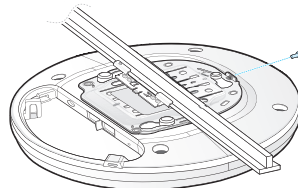

This equipment generates, uses and can radiate radio frequency energy and, if not installed and used in accordance with the instructions, may cause harmful interference to radio communications. However, there is no guarantee that interference will not occur in a particular installation. If this equipment does cause harmful interference to radio or television reception, which can be determined by turning the equipment off and on, the user is encouraged to try to correct the interference by one or more of the following measures:

- Reorient or relocate the receiving antenna.
- Increase the separation between the equipment and receiver.
- Connect the equipment into an outlet on a circuit different from that to which the receiver is connected.
- Consult the dealer or an experienced radio/TV technician for help.



Changes or modifications not expressly approved by the party responsible for compliance could void the user's authority to operate the equipment.

The 5150-5250 MHz band is restricted to indoor use only.

RF Radiation Exposure Statement:

This equipment complies with RF radiation exposure limits set forth for an uncontrolled environment. This equipment should be installed and operated with a minimum distance of 20 cm between the radiator and your body. This transmitter must not be co-located or operating in conjunction with any other antenna or transmitter.



Should the AP be installed in a ceiling with ventilation, the AP Ethernet port must be horizontally placed.

This product is RoHS compliant.

Frequency Range	Output Power (Max.)
2400-2483.5 MHz (WLAN 2.4G)	19.49 dBm
5150-5725 MHz (WLAN 5G)	28.70 dBm
5725-5875 MHz (non-Specific SRD)	13.46 dBm



AT	BE	CY	DK	EE	FI
DE	EL	IE	LU	MT	NL
SI	ES	SE	UK	NO	CH

<http://www.samsungenterprise.com>
Part No.: EC68-00205A (Ver.1.0)