

The Samsung logo, consisting of the word "SAMSUNG" in white capital letters inside a black oval.

SAMSUNG

YP-N1

Personal Navigation Device

user manual

features of your new personal navigation devices

You have chosen a cutting-edge navigation system. Congratulations! Please enjoy using it. This navigation system leads you straight to your destination, whether you are traveling by car or on foot. You may navigate and plan your route with an easy to use and intuitive interface, just by using your finger. You may also use this application to plan your trip to suit your personal preferences and interests and to save interesting destinations before you set off on your trip. This manual leads you through the main features of the system.

WHAT IS GPS (GLOBAL POSITIONING SYSTEM)

It means a system that provides the location, height and velocity of the receiver based on the signals from 4 or more GPS satellites.

EASY-TO-USE NAVIGATION

The easy-to-use intuitive menu enables users to use the various functions easily while driving a car.

FAST AND PRECISE PATH SEARCH

You can find the optimal path to stopover and destination so that you can reach the destination faster and more conveniently. If you drive away from the recommended path, new path is automatically found in a short time.

EASY DESTINATION SEARCH

You can easily search for a destination by selecting a location from the map, or specifying address, POI, or Favorites.

REAL-TIME VOICE ANNOUNCEMENT











Rest areas and gas stations as well as the path are also announced in real-time.

BLUETOOTH COMPLIANCE (YP-N1BZ ONLY)

You can register a Bluetooth hands-free (mobile phone) to the product and connect it via Bluetooth wireless connection.

safety information

What the icons and signs in this user manual mean :

 WARNING	Means that death or serious personal injury is a risk.
 CAUTION	Means that there is a potential risk for personal injury or material damage.
 CAUTION	To reduce the risk of fire, explosion, electric shock, or personal injury when using your product, follow these basic safety precautions:
 NOTE	Means hints or referential pages that may be helpful to operate the player.
	Do NOT attempt.
	Do NOT disassemble.
	Do NOT touch.
	Follow directions explicitly.
	Unplug the power plug from the wall socket.
	Call the service center for help.



These warning signs are here to prevent injury to you and others.
Please follow them explicitly. After reading this section, keep it in a safe place for future reference.

safety information

This manual describes how to properly use your product. Read it carefully to avoid damaging the product and injuring yourself.

Pay particular attention to the following serious warnings:

PROTECT YOURSELF

-  ▪ Only use an authorized charger to charge the product. Do not use unauthorized power adapter to charge the product.
- Do not connect multiple power cords to one wall outlet using a multi-tap.
- Do not operate the product or stare at the screen while driving.
- Avoid bending the power cord or placing a heavy object over the power cord.
- Do not get the product wet or drop it in water. If the product gets wet, do not switch it on because you could get an electric shock. Instead, contact a Samsung Service Center near you.
- Do not place the product in damp, dusty, or sooty areas because these environments could lead to fire or electric shock.
- Do not pull the power cord out by holding the plug. If the cable is damaged, it may cause a fire or electric shock.
-  ▪ Since the map of this product may differ from the actual road information, follow traffic regulations in a real road situation for your safety.
-  ▪ Unplug the power cord when you do not use this product or it is lightning or thunder storming.

PROTECT YOURSELF



- Do not tap on the power cord with wet hands.



- Do not disassemble, repair, or modify this product on your own.



CAUTION

- If the system emits smoke, or unusual noise, or smells of burning, turn the system off immediately, disconnect the power sources, and contact Samsung customer service.

PROTECT YOUR PRODUCT



- Do not leave the product in temperatures above 95°F (35°C), such as a sauna or a parked car.
- Do not drop the product or place heavy objects on top of it.
- Prevent any foreign particles or dust from entering into the product.
- Do not place the product near magnetic objects.
- Do not remove the SD memory card during operation of the navigation system.



- Be sure to backup important data. Samsung is not responsible for data loss.

- Use only accessories provided by or approved by Samsung.
- Start the engine after disconnecting the vehicle charger. Otherwise, the product may be damaged.



CAUTION

- Do not spray water on the product. Never clean the product with chemical substances such as benzene or thinner, as it may cause fire, electric shock or deteriorate the surface.

PRECAUTIONS FOR ROUTE GUIDANCE



- Some part of the map of this product may differ from the actual road conditions and the information provided by the route guidance may be incorrect. In this case, please drive according to the actual road situation and traffic regulations.



CAUTION

- If the condition of the road guided by the route guidance is not good due to bad weather, use alternative road depending on situation.



NOTE

- The position indicated by the GPS may be incorrect depending on the surrounding terrain condition and weather. In this case, since the current location is incorrect, the route guide may provide incorrect information.
- For newly built or expanded roads, the route guidance may provide incorrect information. In this case, correct information will be given by the route guidance as soon as the road of the map becomes consistent with the real road.
- The road condition is subject to change at any time. It is recommended to keep your map up to date for safe driving. The route guidance is for your reference while driving.

contents

THE BASICS

11

- 11 What's included
- 12 Your personal navigation device
- 14 Cradle
- 15 Using the touch screen
- 16 screen displays
- 17 Installing the device onto your vehicle
- 18 Separating the device from your vehicle
- 19 Charging the battery
- 20 Charging the battery using the car charger
- 21 Hardware power on/off switch
- 22 Using SD memory card
- 24 Installing external-type GPS antenna (Not Supplied)
- 25 Installing TMC antenna
- 26 Changing the settings and preferences
 - 26 Map Settings
 - 28 Display Settings
 - 30 Route Settings
 - 31 Sound Settings
 - 32 General Settings
 - 34 Language & Unit Settings
 - 35 System Settings
 - 36 About
- 37 Using navigation system
- 37 Zooming in/out the map
- 38 Controlling the volume
- 39 GPS data/traffic information
- 40 Resetting the system

contents

USING THE NAVIGATION

41

- 41 Planning a route
- 42 Specifying a start point
- 43 Adding a stopover
- 43 Removing a stopover
- 43 Changing the final destination
- 44 Saving locations in favorite
- 45 Saving the location of safety camera
- 46 Saving the locations of home and work place
- 47 Finding an address
- 48 Finding home or workplace
- 49 Finding out favorites
- 50 Finding a recently visited place
- 51 Finding POI (point of interest)
- 53 Coordinates
- 54 Route settings
 - 54 Recalculate
 - 55 Itinerary
 - 56 Edit route
 - 58 Clear route
 - 58 Route Info
 - 59 Simulation
 - 59 Turn view
 - 60 Manage track logs

contents

MORE THAN NAVIGATION

62

62	Using Bluetooth
62	What is Bluetooth?
63	Bluetooth specification
64	Using mobile phone
64	To pair a mobile phone
65	To search for a new mobile phone
65	To remove a mobile phone from the list
65	To rename a device
66	To pair a mobile phone
67	To search for a new mobile phone
67	To remove a mobile phone from the list
67	To rename a device
68	To redial using the recent call number
68	To answer an incoming call
68	To switch a call
69	To switch to the mobile phone while talking on the hands-free device (YP-N1)
69	To switch to the hands-free device (YP-N1) while talking on the mobile phone
69	To disconnect the mobile phone
70	To use the tone keyboard
70	To view my device information

contents

CONNECTING TO YOUR PC

71

- 71 PC requirements
- 72 Connecting to your PC
- 73 Disconnecting from your PC
- 74 Using the map manager

TROUBLESHOOTING

76

APPENDIX

79

- 79 Menu tree
- 80 Product specifications
- 82 Contact samsung world wide

the basics

WHAT'S INCLUDED

Your new Personal Navigation Device comes with these accessories.
If you're missing any of these items, contact a Samsung Service center near you.



**Personal
Navigation Device**



Car Charger



Power Adapter



SD Memory Card



TMC antenna

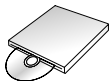

Installation CD



Car Cradle



Cradle



USB Cable

**Carrying Case
(YP-N1BZ only)**

The accessories in your box may look slightly different than these.

YOUR PERSONAL NAVIGATION DEVICE

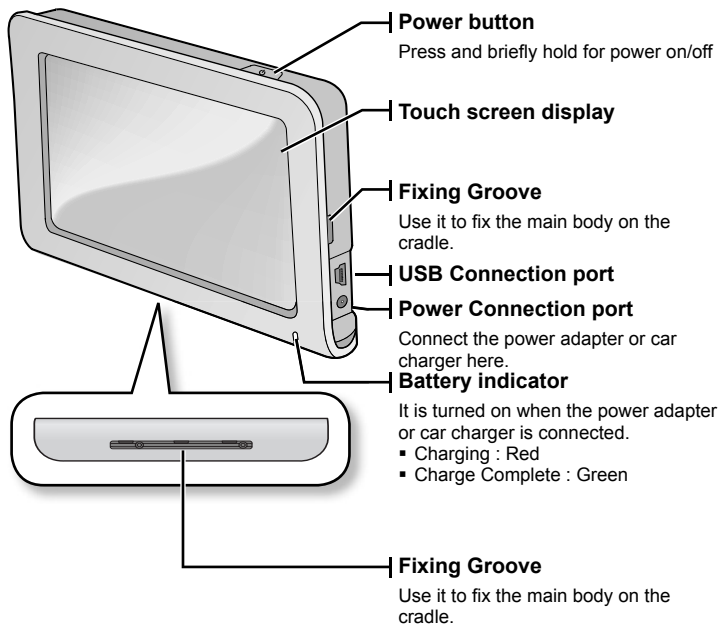

YOUR PERSONAL NAVIGATION DEVICE (Continued)

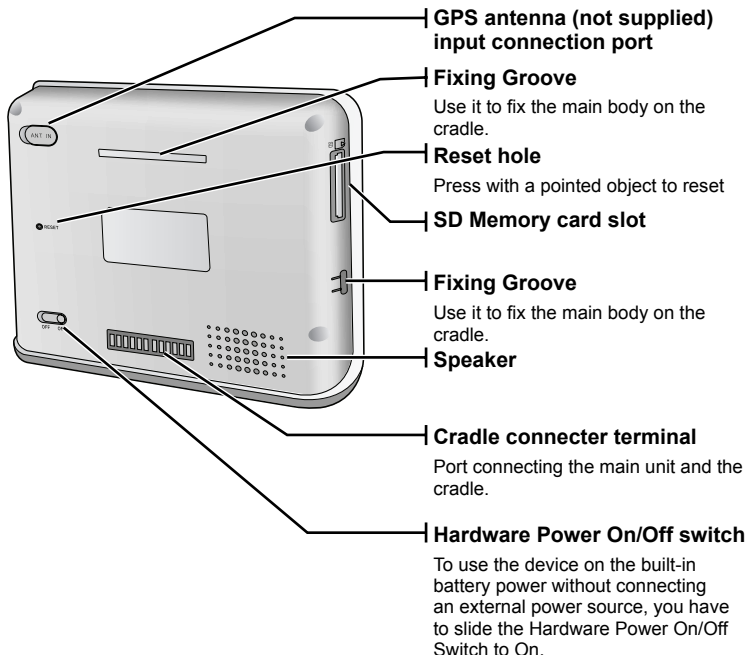

CRADLE

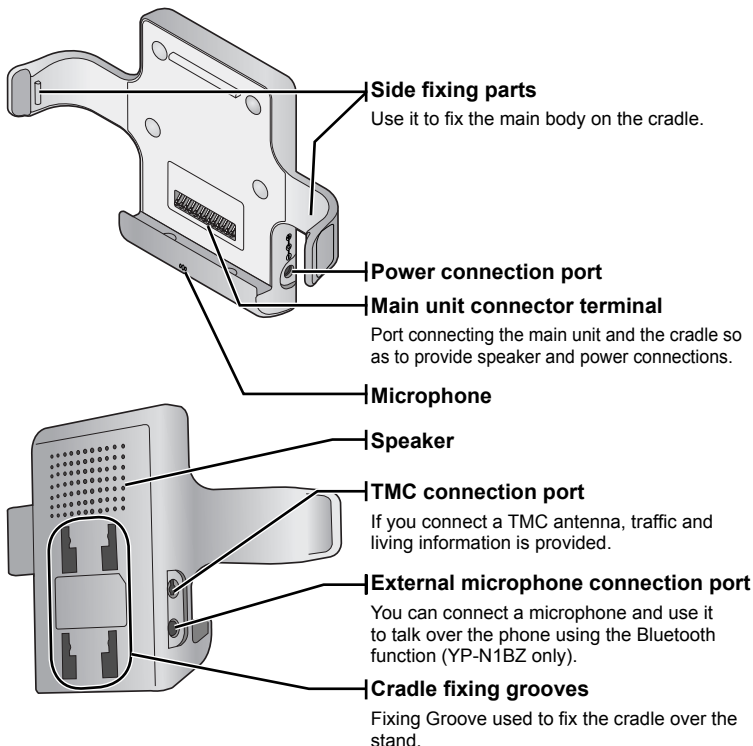

USING THE TOUCH SCREEN

Tap on over the screen with your finger tips.

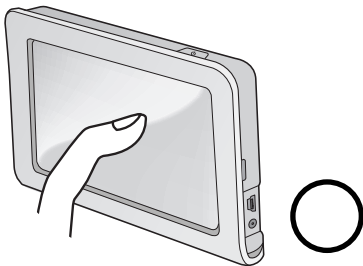

CAUTION

- Using a sharp object to tap on on the screen may cause damage to it.
- Avoid tap on the touch screen with dirty fingers.

SCREEN DISPLAYS

Main (Driving Mode)

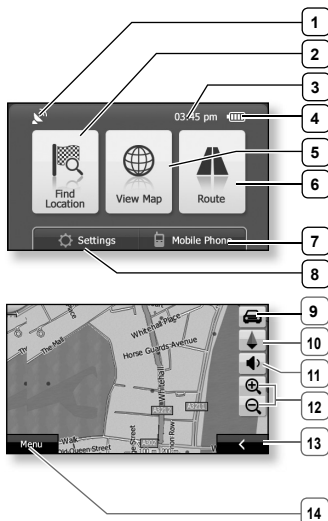

- | | |
|----|-------------------------------|
| 1 | GPS Signal Reception Status |
| 2 | Find Location button |
| 3 | Current Time |
| 4 | Remaining Battery Capacity |
| 5 | View Map button |
| 6 | Route button |
| 7 | Mobile phone button |
| 8 | Settings button |
| 9 | GPS button |
| 10 | Zoom-In/Zoom-Out Button |
| 11 | Volume Control button |
| 12 | Show/Hide Setup Route Buttons |
| 13 | Compass |
| 14 | MENU button |



■ The Blue tooth function supports only these models. (YP-N1BZ)

NOTE

INSTALLING THE DEVICE ONTO YOUR VEHICLE



- **Before you start** - Select a position to install the cradle that will not block driver's field of vision and clean the place before installation.

1. Attach the suction cup to the place you selected completely and push the locking tab in the direction of the arrow shown by the figure.

- The suction cup is secured.

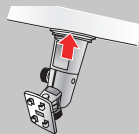

2. Insert the catches of the stand to the Cradle Fixing Grooves and slide the cradle so that the catches are in the CLOSE position.



3. Insert the main unit into the cradle.

- Put the main body into the cradle until it clicks at the both side of the fixing parts in order to secure the installation.



4. Adjust the angle of the support to facilitate your visibility.

- Release the adjustment screw 1 counterclockwise slightly and adjust the angle between the 180 degrees in vertical and 360 degrees in horizontal. If you find a comfortable angle, fasten the adjustment screw 1 by turning it clockwise.
- Release the adjustment screw 2 counterclockwise slightly and adjust the angle between the 180 degrees in horizontal. If you find a comfortable angle, fasten the adjustment screw 2 by turning it clockwise.

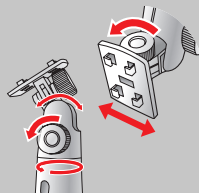

SEPARATING THE DEVICE FROM YOUR VEHICLE

1. Pull the both sides of fixing parts of the cradle outward and separate the main unit from the cradle.



2. Pull the locking tab in the direction of the arrow shown by the figure.
 - The suction cup is released.



3. Remove the suction cup by holding the projected part.
 - The cradle is separated.

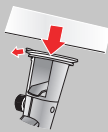

CAUTION

- Install the cradle to a position that does not block driver's field of vision and will not cause an injury of the driver or follow passenger even if it falls.



NOTE

- Note that the adsorption of the suction cup may decrease when the temperature difference between outside and inside is high.
- Separate the cradle from the vehicle for long time of no use.
- The adsorption of the suction cup is the best when the temperature of the inside car is between 10~50°C.

CHARGING THE BATTERY

Charge it before using the player for the first time and when you haven't used it for a long time.

The battery for your mp3 player will fully charge in about three and a half hours, although total charging time varies depending on your PC environment.



- **Before you start** - Slide the Hardware Power On/Off Switch to OFF.

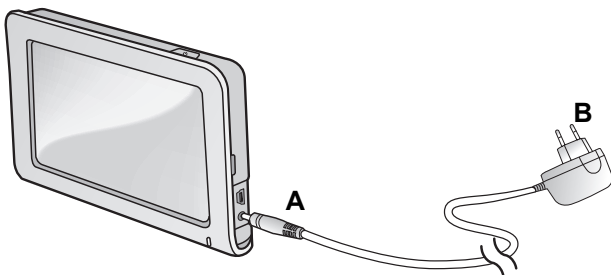

1. Connect the power adapter jack (A) to the Power connection port.
2. Plug the power adapter plug (B) to the wall outlet.
 - The LED turns on in red while charging the battery and it turns to green when it is fully charged.



NOTE

- It is recommended using the device by connecting it to a power source when you use it in a house or vehicle where power source is available and moving the device is not frequently required.
- The battery may be discharged when you first use this product. Fully recharge the battery before use.

CHARGING THE BATTERY USING THE CAR CHARGER

The battery for your mp3 player will fully charge in about three and a half hours.

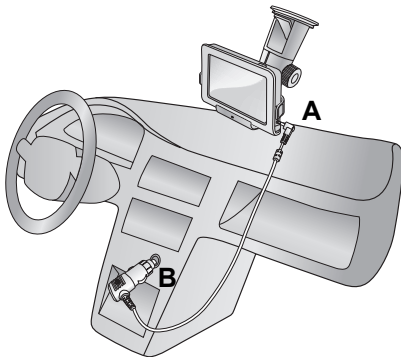

1. Install the main unit into the cradle.
2. Connect the car charger jack (A) to the Power connection port of the cradle.
3. Plug the car charger plug (B) into the cigar jack of the vehicle.

CARING FOR THE BATTERY

Your battery will last longer if you follow these simple guidelines for caring for and storing it.

- Recharge and store the battery within the temperature range of 40°F~95°F (5°C~35°C).
- Do not charge the battery longer than 12 hours.

HARDWARE POWER ON/OFF SWITCH

To use the built-in battery power without connecting the power adapter or car charger, you have to slide the Hardware Power On/Off switch to On.

To turn the Hardware Power On/Off Switch on

Slide the Hardware Power On/Off switch to ON.

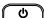
- Alternatively you can turn the power on by pressing the  button.

To turn the Hardware Power On/Off Switch off

Slide the Hardware Power On/Off switch to OFF.

- Even if you press the , the power will not be turned on.

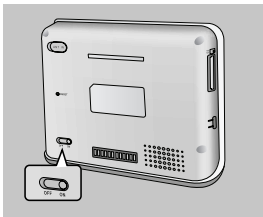

NOTE

- When the product is left unused for an extended time, slide the Power On/Off switch to OFF to avoid discharged battery.

TURNING THE POWER ON & OFF

To turn the power on

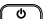
Press and hold the  button.

- The power is turned on.

To turn the power off

Press and hold the  button.

- The power is turned off.

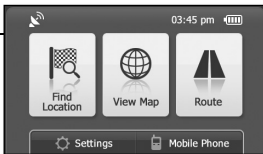

USING SD MEMORY CARD



- **Before you start** - Insert or remove the SD memory card only when the power is turned off.

Removing the SD memory card

Press the SD memory card tip slightly.

- The SD memory card pops up.

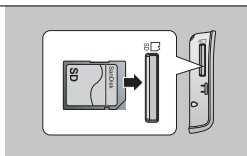

Inserting the SD memory card

Insert the SD memory card as shown by the figure.

- Insert SD memory card so that the label faces forward.

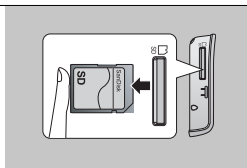

write protection switch

A SD card supports a mechanical write protection switch. Setting the switch prevents accidental erasure of files recorded on the SD card.

To enable writing, move the switch up to the direction of terminals. To set write protection, move the switch down.

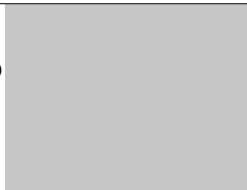

USING SD MEMORY CARD (Continued)



NOTE

- The SD memory card may have insufficient free space as it has stored the map data. In this case, purchase another one in the Internet shopping mall or digital camera shop.



CAUTION

- If an adapter is required for the memory card you have purchased, make sure to use the memory card by using an appropriate adapter. If you use a non-compatible card, it may be damaged or you will not be able to remove it.
- Do not remove the memory card while the navigation system is running.
- Do not insert a memory card upside down or in a wrong direction.
- Unsupported memory cards
Some SD memory cards, if thick out of the specification or with a label attached onto it, may not be removed.
- This product supports up to 4GB of memory capacity.
- Memory cards other than SD such as T-Flash are not supported.
- When you keep or carry a memory card, package it with the memory card case because the data may be damaged by antistatic electricity.
- Please note that manufacturer shall not be liable to the data loss due to the damage of the memory card.
- If you turn the main unit on under no memory card inserted, the  icon appears on the screen.

INSTALLING EXTERNAL-TYPE GPS ANTENNA (NOT SUPPLIED)

Installing an external-type GPS antenna when the received GPS signal strength is weak, will provide better GPS signal sensitivity.

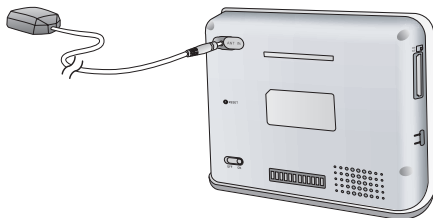

1. Connect the GPS antenna jack (A) to the GPS antenna input connection port of the main unit.
2. Install the GPS antenna (B) on the roof of the vehicle or a metal part of the hood.
3. Arrange the GPS antenna cable so that it will not disturb driving.



- The external-type GPS antenna is unbundled. You can purchase one in a navigation device shop.

Recommended GPS antenna models

INSTALLING TMC ANTENNA

If you install TMC antenna, you can use useful information such as traffic and living information.

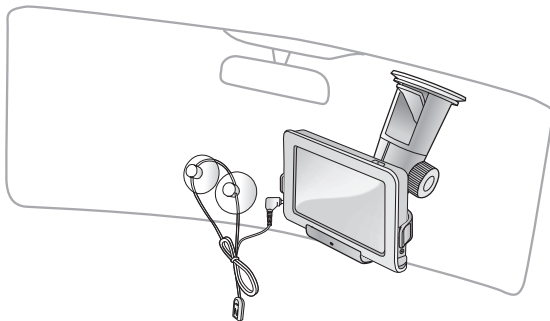

1. Clean up the windshield.
2. Attach the TMC antenna (A) to the windshield.
3. Connect the TMC antenna jack (B) to the TMC connection port (C) of the cradle.



NOTE

- Arrange the TMC antenna cable so that it will not disturb your driving.
- In some areas, the TMC reception sensitivity may not be good enough.

CHANGING THE SETTINGS AND PREFERENCES

Your Personal Navigation Device comes with settings and preferences that were set up at the factory, but you can change these pre-set values to truly customize your product.

Map Settings

You can configure map settings such as View Mode, Day/Night Mode, Map Color, etc.

1. Tap “Settings” button in the main menu.

- The “Settings” window appears.

2. Tap “Map” button.

- The “Map” settings window appears.

3. Configure the settings you want by tapping on a desired button.

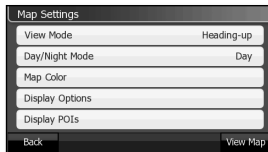

NOTE

- Tap **Back** button to move to the previous screen.

- If you tap “View Map” button in the Map Settings window, you can move to the map screen.

CHANGING THE SETTINGS AND PREFERENCES (continued)

Map setting options

View Mode : Select one from “Heading-up, North-up, and 3D” and tap OK button. “Heading-up” rotates the map so that the vehicle always moves upward. (The most popular mode). “North-up” fixes the map regardless of the heading of the vehicle so that north of the map is located on top. “3D” mode enables the user to view the map in 3D. You can switch the mode by tapping on the compass icon on the map screen.

Day/Night Mode : Select one from “Day, Night, and Auto” and tap OK button. “Auto” mode automatically switches to Day or Night mode according to the actual time. (Time is automatically set through GPS.)

Map Color : Select a map color by tapping on the   button and select the OK button.

Display Options : Select one from “Alternative Road Names, Show Street Labels, and Textured Polygons” and tap OK button. “Alternative Road Names” determines which road name will be displayed when there are more than a name for a road. “Show Street Labels” shows street names. “Textured Polygons” shows roads in a graphical form.

Display POIs : You can select interest information items (Services, Transportation, etc.) to be displayed. Select an item you want and tap on either the Show or Hide button.

The items marked with  are displayed on the map.

CHANGING THE SETTINGS AND PREFERANCES (continued)

Display Settings

You can configure screen settings such as Brightness, Auto Brightness, etc.

1. Tap “Settings” button in the main menu.

- The “Settings” window appears.

2. Tap “Display” button.

- The “Display” settings window appears.

3. Configure the settings you want by tapping on a desired button.



NOTE

- Tap **Back** button to move to the previous screen.

- If you tap “View Map” button in the Display Settings window, you can move to the map screen.

CHANGING THE SETTINGS AND PREFERANCES (continued)

Display setting options

Brightness : You can adjust the screen brightness depending on the surrounding brightness that changes according to the time.

Tap  button to adjust the brightness to the level you want, and tap OK button.

Auto Brightness : This function automatically detects surrounding brightness and adjust the screen brightness accordingly. Select either “On” or “Off”.

Brightness Timeout : If no button is pressed within the time set shown below, the display screen will automatically turn off. Select one from “Always On, 15 Sec, 30 Sec, and 1 min” and tap OK button.

LCD Calibration : If the tapping point is incorrectly set, you can reset it into focus.

Pop-up Info : You can determine whether to display information such as address, firm name, etc. Select either “On” or “Off”.

LCD Calibration Settings

1. Tap LCD Calibration button.
 - The LCD calibration confirmation screen appears.
2. Point on the center of focus using a ball-point pen.
 - The location of the focus changes as shown in the figure. If you tap on the focus 5 times, the setting confirmation message appears.
3. To save the new focus setting, tap on any point on the screen.
 - The setup is completed and the product returns to the previous menu.



CAUTION

- Using a sharp object to touch on the screen may cause damage to it.

CHANGING THE SETTINGS AND PREFERENCES (continued)

Route Settings

You can configure route related options such as Route Preference, Vehicle, etc.

1. Tap “Settings” button in the main menu.

- The “Settings” window appears.

2. Tap “Route” button.

- The “Route” settings window appears.

3. Configure the settings you want by tapping on a desired button.



- Tap “Back” button to move to the previous screen.

NOTE ▪ If you tap “View Map” button in the Route Settings window, you can move to the map screen.

Route setting options

Route Preference : Select one from “Fast, Short, or Economical” and tap OK button. “Fast” option provides the fastest route, “Short” provides the shortest route, and “Economical” provides the cheapest route that requires the minimum gas consumption.

Vehicle : Select one from “Car, Taxi, Bus, Lorry, Emergency, Pedestrian, and Bicycle” and tap OK button.

Avoidances : Select one from “Unpaved Roads, Motorways, Ferries, U-turns, Permit needed, Toll roads” not to listen to information about the selection in the route guidance and tap OK button.

Off Route Recalculation : Select one from “Automatic, Ask First, and Off” and tap OK button. The “Automatic” option automatically finds a new route when you drive out of the recommended route. The “Ask First” mode will ask you first to determine whether to find a new route again. The “Off” mode will not find a new route even if you drive away from the recommended route.

TMC : You can configure traffic information provision function. “Exclude selected station” provides traffic information including the selected area. “Show excluded stations” allows you to confirm the area included in the traffic information provision area. The “Automatic” option of “Recalculation to avoid traffic” enables finding a route avoiding traffic-jammed area, while the “Disabled” option finds a route regardless of traffic information.

CHANGING THE SETTINGS AND PREFERENCES (continued)

Sound Settings

You can configure volume and sound settings.

1. Tap “Settings” button in the main menu.

- The “Settings” window appears.

2. Tap “Sound” button.

- The “Sound” settings window appears.

3. Configure the settings you want by tapping on a desired button.

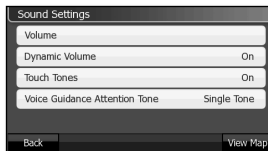

- Tap **Back** button to move to the previous screen.

NOTE ▪ If you tap “View Map” button in the Sound Settings window, you can move to the map screen.

Sound setting options

Volume : You can control the volume level. Tapping on the **+** button turns the volume up, while tapping on the **-** button turns the volume down. To select the Mute function, press the **M** button so that the **M** icon appears. To cancel the Mute function, tap **M** button so that the icon changes to **M**.

Dynamic Volume : You can setup the volume so that the volume rises as the velocity increases. Select “On” to automatically adjust the volume according to the velocity. Select “Off” to keep the volume level steady.

Touch Tones : You can determine whether to enable or disable the touch tone. Select either “On, or Off”.

Voice Guidance Attention Tone : Select one from “Single Tone, Dual Tone, and Off” and tap OK button. “Single Tone” sounds an alarm once before voice guidance. “Dual Tone” sounds an alarm twice before voice guidance. “Off” does not sound an alarm before voice guidance.

CHANGING THE SETTINGS AND PREFERENCES (continued)

General Settings

You can configure Safety Mode and Warn When Speeding settings.

1. Tap “Settings” button in the main menu.

- The “Settings” window appears.

2. Tap “General” button.

- The “General” settings window appears.

3. Configure the settings you want by tapping on a desired button.



NOTE

- Tap **Back** button to move to the previous screen.

- If you tap “View Map” button in the General Settings window, you can move to the map screen.

CHANGING THE SETTINGS AND PREFERANCES (continued)

General setting options

Safety Mode : You can configure the touch screen so that it does not work while driving for safety purposes. To use the Safety Mode, select “Yes”. Otherwise, select “No”.

Warn When Speeding : You can set the alarm so that it sounds when you are driving faster than the speed limit. Select either “On, or Off”.

▪ To Setup Options

Tap “Options” button and set a speed limit by using the **+** and **-** buttons. Using the “Speeding tolerance” option, you can set an allowed margin for the speed limit in percentage. (Example: If you set the “Speeding tolerance” option to “10%”, an alarm sounds when you drive faster than 88km on a road where the speed limit is 80km.) Using the “Alternative speed limit” option, you can setup a speed limit in Km/h.

Enable Safety Cameras : You can determine whether to display the Safety Cameras (speedcam). Select either “On, or Off”.

If you set the Enable Safety Cameras option to “On”, a confirmation message will appear saying that it can be illegal in some areas. To display Safety Cameras, select “Yes”. Otherwise, select “No”.

Smart Zoom : This function automatically zooms in the map when turning your vehicle such as turning left, turning right and making a U-turn. After that, the map is automatically zoomed out so that you can view more far distance on the map. Select either “On” or “Off”.

CHANGING THE SETTINGS AND PREFERENCES (continued)

Language & Unit Settings

You can set the language, time, and unit of distance.

1. Tap “Settings” button in the main menu.

- The “Settings” window appears.

2. Tap “Language & Unit” button.

- The “Language & Unit” settings window appears.

3. Configure the settings you want by tapping on a desired button.

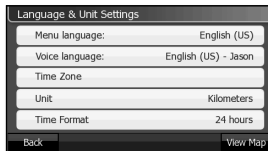

- Tap **Back** button to move to the previous screen.

NOTE ▪ If you tap “View Map” button in the Language & Unit Settings window, you can move to the map screen.

Language setting options

Menu language : You can select a language for the screen display.

“English(AU), English(UK), English(US), Español, Français, Hebrew, Hrvatski, Italiano, Magyar, Nederlands, Norsk, Polski, Português, Română, Slovenský, Suomi, Svenska, Türkçe, Vlaams, Ελληνικά, Русский”

Voice language : You can select a language and voice type (male / female) for the voice guidance.

Time Zone : You can select your time zone depending on your location.

Unit : You can setup so that the distance is displayed in “Miles” or “Kilometres”.

Time Format : “12 hours” option shows time in 12 hours and “24 hours” shows time in 24 hours.

CHANGING THE SETTINGS AND PREFERANCES (continued)

System Settings

You can configure various system settings.

1. Tap "Settings" button in the main menu.
 - The "Settings" window appears.
2. Tap "System" button.
 - The "System" settings window appears.
3. Configure the settings you want by tapping on a desired button.

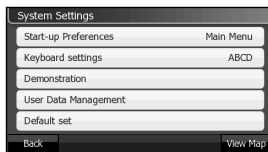

NOTE

- Tap **Back** button to move to the previous screen.

- If you tap "View Map" button in the System Settings window, you can move to the map screen.

System setting options

Start-up Preferences : You can select the start menu that appears when you turn the power on. Select one from "Main Menu, Map, and Find Location" and tap OK button.

Keyboard settings : You can setup the keyboard to be displayed on the text input screen.

Demonstration : You can view a driving simulation.

User Data Management : You can save data such as route and user settings into an SD memory card and read and delete the data saved in the memory card. Select one from "Backup Data, Restore Data, and Clear Data" and tap OK button. Select "Backup Data" to backup data into a memory card. Select "Restore Data" to restore data using the backup file. Select "Clear Data" to delete data. The saved data appears as "iGO-backup.db" file in the <Removable Disk> on a PC. You can copy the "iGO-backup.db" file into the PC for later use.

Default set : You can restore all settings to default values. Select either "Yes" or "No".

CHANGING THE SETTINGS AND PREFERENCES (continued)

About

You can view system related information such as model name, firmware version, serial number, etc.

1. Tap “Settings” button in the main menu.

- The “Settings” window appears.

2. Tap “About” button.

- The “About” window appears.
- You can view model name, firmware version, and serial number.

For the procedures to upgrade the firmware, refer to the firmware upgrade instructions. ► Page 69

3. Tap on the “Licenses” tab.

- You can view available maps.

4. Tap on the “Maps” tab.

- You can view area supported by the navigation function.



NOTE

- Tap **Back** button to move to the previous screen.



USING NAVIGATION SYSTEM

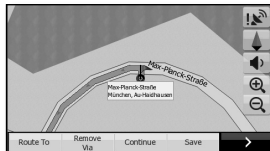

- ★ ▪ **Before you start** - Before using the navigation system, set the Language and Time Zone. (See Page 35)
1. Tap “View Map” button in the main menu.
 - You will see a map on the screen.
 2. Select a desired destination by tapping on or dragging it.
 3. Tap “Route To” button.
 - The route from the current location to destination is automatically searched for.
 4. Start driving.
 - The navigation system starts automatically.



ZOOMING IN/OUT THE MAP

You can zoom in or out the map.

To zoom in or out, tap  or  button on the right side of the map.

- Tapping on the  button zooms in the map, while tapping on the  button zooms out the map.







NOTE

- If you select <Settings>-><General> and set <Smart Zoom> to <On>, The map is automatically zoomed in when you turn your vehicle such as turn left, turn right and make a U-turn. After that, the map is automatically zoomed out so that you can view more far distance on the map.

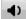

CONTROLLING THE VOLUME

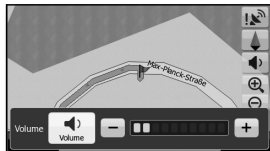

You can control the volume of the touch tone and voice guidance.

1. Tap  button on the right side of the map.
 - The volume control window appears.
2. Adjust the volume by tapping on the  and  buttons.
 - Tapping on the  button turns the volume up, while tapping on the  button turns the volume down.



To use the Mute function

Tap  button in the volume control menu. If the icon changes to , the sound will be muted.

To cancel the Mute function, tap  button so that the icon changes to .

GPS DATA/TRAFFIC INFORMATION

You can view GSP information such as accuracy, position, etc.

1. Tap  button on the right side of the map.
 - The GPS information screen appears.
2. To view traffic information, tap “Traffic Info” button.
 - Traffic Events are listed.
 - Distance: You can view traffic information near you first.
 - Type: You can view traffic information by type.

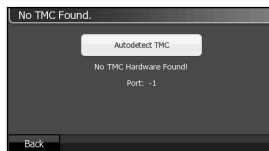
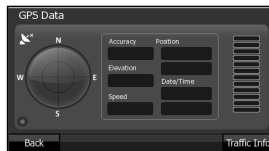

RESETTING THE SYSTEM

When the product does not work properly or cannot be turned off, you can reset the product.

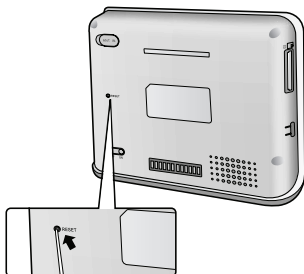

Press the Reset hole with a sharp object.

- The system will be initialized.
- Your settings and data will not be affected.

using the navigation



- **Before you start** - Check if the SD memory card is inserted in the device. Connect the power or turn the device on and then check the charge status.

PLANNING A ROUTE

You can select a desired destination on the map, based on the current location.

1. Tap “View Map” button in the main menu.
 - You will see a map on the screen.
 2. Select a desired destination by tapping on or dragging it.
 3. Tap “Route To” button.
 - The route from the current location to destination is automatically searched for.
 - The current location is marked with a blue flag and the destination is marked with a red flag.
 4. Start driving.
 - The navigation system starts automatically.
-  **NOTE**
- If the “Calculating route...” message appears, please wait for a moment. It takes some time to search for a route.
 - The route search time differs, depending on the distance and the route settings.



SPECIFYING A START POINT

You can select a desired destination on the map, based on the current location.

1. Tap “View Map” button in the main menu.
 - You will see a map on the screen.
2. Select a start point by tapping on or dragging it.
3. Tap “Start” button.
 - The start point will be marked with a blue flag.
4. Select a desired destination by tapping on or dragging it.
5. Tap “Route To” button.
 - The route from the start point to the destination is automatically searched for.
 - The destination is marked with a red flag.

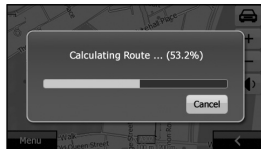

ADDING A STOPOVER

You can add a stopover between the start point and the destination.

1. When the navigation route is set, select a stopover by tapping on or dragging it.
 - You will see a map on the screen.
2. Tap “Add Via” button.
 - The stopover is marked with a white flag and the navigation route is recalculated.
 - You can add stopovers on and on.

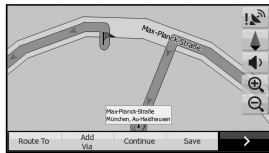

REMOVING A STOPOVER

You can delete a start point, destination or stopover.

1. Select a stopover to delete on the map.
2. Tap “Remove Via” button.
 - The selected stopover is removed.

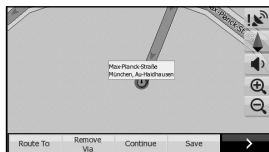

CHANGING THE FINAL DESTINATION

You can change a final destination.

1. When the navigation route is set, select a final destination by tapping on or dragging it.
2. Tap “Continued” button.
 - The initial destination is changed to a stopover and marked with a white flag.
 - The final destination is marked with a red flag.

SAVING LOCATIONS IN FAVORITE

You can save your favorite destinations to quickly access them when planning your route.

1. Select a desired location by tapping on or dragging it.
 - You can also search for a location you want by using the “Find Location” function. (See page 51~57)
2. Tap “Save” button.
 - The Save window appears.
3. Tap “Favorite” button.
 - The text input mode appears.
4. Enter a name for the Favorite location using the keyboard and tap “Done” button.
 - The Favorite location name and address confirmation window appears.



Favorite options

Rename : You can rename a Favorite location name..





Delete : You can delete a saved location from Favorite. When the deletion confirmation message appears, select “Yes” or “No”.

View Map : You can view the Favorite location on the map. The Favorite location is marked with the  icon.

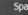

NOTE ▪ To search for a saved Favorite location, search for the location using the Find Location Favorites in the main menu. (See page 53)

Button Description of Text/Number Input Mode

 Space	 Delete
 Switches to text keyboard	 Switches to numeric keypad
 Completes your input	

The search can be performed even if you just enter a part of a keyword.



SAVING THE LOCATION OF SAFETY CAMERA

You can save and refer to information of the safety camera including position, type, direction and speed limit for your safe driving.

1. Select a desired location by tapping on or dragging it.
 - You can also search for a location you want by using the "Find Location" function.
(See page 51~57)
2. Tap "Save" button.
 - The Save window appears.
3. Tap "Safety Cameras" button.
 - The "Safety Cameras" setup window appears.
4. Set the camera type, direction and speed and tap [OK] button.
 - When done, the product will return to the previous menu.



Safety Camera options

Camera Type : allows you to set the type of the safety camera.

- Fixed
- Removable
- Red-light
- Section : a section-detection camera that measures the average speed between the two end points of the section
- Normal Traffic Light

Camera Direction : allows you to set the direction of the safety camera.

Camera Speed : allows you to set the speed limit.

SAVING THE LOCATIONS OF HOME AND WORK PLACE

You can save the locations of your home and work place for later use.

You can follow the same instruction to save the locations of both home and workplace. Let us take a home for example.

1. Select a desired location by tapping on or dragging it.
 - You can also search for a location you want by using the “Find Location” function. (See page 51~57)
2. Tap “Save” button.
 - The Save window appears.
3. Tap “HOME” button.
 - The selected location is saved.



NOTE

- To find out the location of home or workplace, navigate in “Find Location -> HOME or WORK” in the main menu. (See page 52)

FINDING AN ADDRESS

You can find out the address of a destination.

1. Tap "Find Location" button in the main menu.
 - The "Find Location" window appears.
2. Tap "Address" button.
 - You will see a list of recently visited cities.
3. Tap on the city to find.
 - The character input mode appears.
4. Enter desired characters (street number) using the screen keyboard.

Ex) Entering "A" on the keyboard will display a list of all street names including "A".
5. Select a desired street name in the list.
 - The number input mode appears.
6. Enter the street number and tap "Done" button.
 - The selected address will be displayed in a map.



Address options

Other City : allows you to search for other city.

Clear : allows you to remove the list of recently visited cities.

Find intersection : allows you to search for an intersection.

Change Country : allows you to search for other country.

City center : you can use the map to mark the center of a specific city.

Button Description of Text/Number Input Mode

Space	Delete
Switches to text keyboard	Switches to numeric keypad
Completes your input	

The search can be performed even if you just enter a part of a keyword.



NOTE

- Characters available to input are displayed in white and, those unavailable, in grey. Grey characters could not be entered by tapping on them.

FINDING HOME OR WORKPLACE

You can easily find out the location of home or workplace once it is memorized.

- ★ **Before you start** - You should have saved the location of home or workplace. (See page 50).

You can follow the same instruction to find out the locations of both home and workplace. Let us take a home for example.

1. Tap “Find Location” button in the main menu.
 - The “Find Location” window appears.
2. Tap “Home” button.
 - Mark the location of your home on the map.



If the location of home or workplace is not memorized

1. Tap “Find Location” button in the main menu.
 - The “Find Location” window appears.
2. Tap “Home” button.
 - The setting confirmation message appears.
3. Tap “Yes” button.
 - The current location is saved as home.

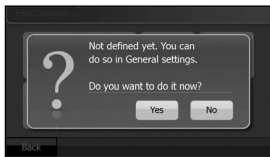

FINDING OUT FAVORITES

You can easily find out the locations listed in Favorites.

★ ▪ **Before you start** - Add frequently visited places to the Favorites list. (See page 49)

1. Tap "Find Location" button in the main menu.
 - The "Find Location" window appears.
2. Tap "Favorites" button.
 - The "Favorites" list appears.
3. Select a desired address in the "Favorites" list.
 - Using the ▲, ▼ buttons to move up or down.
 - The "View Favorite" window appears.
4. Tap "OK" button.
 - The selected location is marked on the map.
 - Locations in the Favorites list are marked with the 📍 icon.

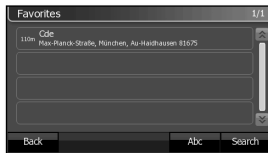

Favorites options

ABC/Distance : tapping on the "ABC" button will sort the list in alphabetical order. Tapping on the "Distance" button will sort the list from the nearest to the farthest.

Search : the character input mode appears. You can enter an address in the Favorite list to find it out.

View Favorite options



Rename : the character input mode appears. You can edit addresses in the Favorite list.

Delete : Delete : you can remove an address(es) in the Favorite list. When the confirmation window appears, select "Yes" or "No".

OK: completes your changes and returns to the map.

FINDING A RECENTLY VISITED PLACE

You can find a recently visited place.

1. Tap “Find Location” button in the main menu.
 - The “Find Location” window appears.
2. Tap “Recent Location” button.
 - The “Recent Location” list appears.
3. Select a desired address in the “Recent Location” list.
 - Using the ,  buttons to move up or down.
 - The selected location is marked on the map.

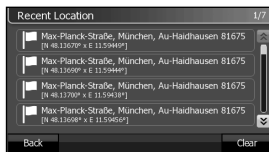



Recent Location option

Clear : allows you to remove the list of recently visited places.

FINDING POI (POINT OF INTEREST)

You can search for desired service or transportation information by POI.

1. Tap “Find Location” button in the main menu.
 - The “Find Location” window appears.
2. Tap “POI” button.
 - The “POI” list appears.
3. Select a desired item in the “POI” list.
 - Using the   buttons to move up or down.
 - A detailed list appears.



POI

Service : Service: you can find gas stations, car repair shops, tourist attractions and etc by the service type.

Transportation : you can find major transportation facilities such as airports and railway stations and etc.

Shopping : you can find shopping malls, outlets, etc.

Entertainment : you can find leisure places such as parks, zoos and cinemas.

Culture : you can find places for cultural life such as museums, concert halls, libraries, etc.

Sports & Recreation : you can find recreation places such as golf clubs, swimming pools, gymnasiums, etc.

Emergency Government : you can find emergency services such as hospitals, police stations, public offices, etc.



Food & Drink : you can find food restaurants serving food and beverages.

Lodging : you can find sleeping accommodation such as hotels and camp sites.

Natural landmark : you can find places of note such as famous mountains and landscapes.



FINDING POI (POINT OF INTEREST) (Continued)

4. Tap on a desired item.

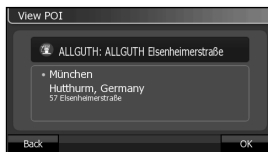
- Using the ,  buttons to move up or down.
- A list of names and addresses appears.
- **Change Ref.** : you can select one from “Current GPS, Cursor, Destination and Address”. “Current GPS” informs you of the current location detected by the GPS satellite. “Cursor” indicates the location you selected on the map. “Destination: indicates the predefined location. “Address” enables you to find a place by the address.



5. Tap on a desired address.

- Using the ,  buttons to move up or down.
- The “View POI” window appears.
- <Dial> : you can use Bluetooth to place a phone call by selecting a number in a phone book (if any). (YP-N1BZ only)

6. Tap on OK to check your current position on the map.

- The selected location is marked on the map.

Find POI options

All : displays all POIs without grouping by the category in alphabetical order.

Search : the character input mode appears. You can enter a POI name to find it.

COORDINATES

You can find a location by entering latitude and longitude.

1. Tap “Find Location” button in the main menu.
 - The “Find Location” window appears.
2. Tap “Coordinate” button.
 - The “Coordinate” number input mode appears.
3. Tap on either the left or right input box.
 - When “.” blinks at the ending digit, it is selected.
4. Tap on either “N/S” or “E/W” to select latitude or longitude.
5. Tap  button to delete a number.
 - Numbers are cleared one by one from the end. The letters of “N, S, E, W” are not cleared.
6. Enter numbers and symbols using the keyboard and tap “Done” button.
 - The input coordinates of latitude and longitude are marked on the map.

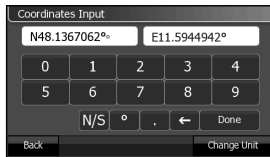

Coordinate option

Change Unit : you can select a display form of latitude and longitude. Select a desired item and tap on OK.

“DD.DDDD” indicates an angle, “DD MM.MMM” is an angle and minute, “DD MM SS.S” displays an angle, minute and second.



NOTE

- Enter a valid coordinate. Otherwise, it will not be marked on the map.

ROUTE SETTINGS

You can configure the settings of navigation routes.



- **Before you start** - you should have set at least one route. (See page 46)
You can just use Edit Route and Mange Track Logs menus if no route has been set.

Recalculate

1. Tap “Route” button in the main menu.
 - The “Route” window appears.
2. Tap “Recalculate” button.
 - You will see the Route Recalculation window.
3. Select a desired item.



Recalculate options

Recalculate : reconfigures a set route.

Bypass : You can choose to block the calculated route for a given distance and force an alternative route. Select either 1 km, 2 km, 5 km, 10 km or 30 km.

Clear Route : clears a set route.

Drop next via : Drop next via : the Drop Next Via button pops up for a route with a stopover. Use this if you want to skip over the stopover.

ROUTE SETTINGS (Continued)

Itinerary

You can check the itinerary for the selected route and view a summary of distances and addresses for each midway stop.

1. Tap "Route" button in the main menu.

- The "Route" window appears.

2. Tap "Itinerary" button.

- The "Itinerary" list appears.

3. Tap Mode button to select a desired mode.

- Detailed Instructions : you can view a detailed list of itinerary.
- Instructions : you can view a list of itinerary.
- Route Summary : you can view a summary of distances and addresses for each stopover.

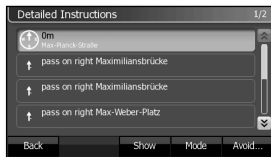

Itinerary options

Show : tapping on the Show button under Itinerary will mark the selected location on the map.

Mode : select one from Detailed Instructions, Instructions and Route Summary.

Avoid... : you can configure the navigation settings so that you can bypass a traffic congestion.

Select one from Manoeuvre, Road, 1 km, 2 km, 5 km, 10 km and 30 km.

Select Manoeuvre if you want to select a route to avoid in the Itinerary list.

Select Road if you want to select a road to avoid in the Itinerary list.

The "Avoid..." function will not work in front of a traffic-congested area.

ROUTE SETTINGS (Continued)

Edit Route

This provides management of change route, change order and deletion of stopovers.

To add a route

1. Tap “Route” button in the main menu.
 - The “Route” window appears.
2. Tap “Edit Route” button.
 - The “Edit Route” list appears.
3. Tap “Add” button.
 - The “Find Location” window appears.
4. Refer to pages 51 to 57 to add a route.



To delete a route

1. Tap “Route” button in the main menu.
 - The “Route” window appears.
2. Tap “Edit Route” button.
 - The “Edit Route” list appears.
3. Select a route to delete in the “Edit Route” list.
4. Tap “Delete” button.
 - The selected route will be removed.



ROUTE SETTINGS (Continued)

Edit Route(Continued)

To set an optimized route

1. Tap "Route" button in the main menu.
 - The "Route" window appears.
2. Tap "Edit Route" button.
 - The "Edit Route" list appears.
3. Tap "Optimise" button.
 - This will set the most effective route regarding distance, time and fuel to take.



To change the order of route

1. Tap "Route" button in the main menu.
 - The "Route" window appears.
2. Tap "Edit Route" button.
 - The "Edit Route" list appears.
3. Select a route to change the order of in the "Edit Route" list.
4. Tap "Up" or "Down" button.
 - Tapping on "Up" will move one level up in the list and "Down" will move one level down.



ROUTE SETTINGS (Continued)

Clear Route

You can remove a set route.

1. Tap “Route” button in the main menu.
 - The “Route” window appears.
2. Tap “Clear Route” button.
 - The confirmation message pops up.
3. Tap “Yes” button.
 - clears a set route.

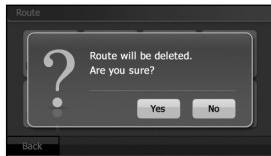

Route Info

You can check the distance, time to take and estimated arrival time of a set route.

1. Tap “Route” button in the main menu.
 - The “Route” window appears.
2. Tap “Route Info” button.
 - The Route Information window appears.
 - You can check the distance, time to take and estimated arrival time of a set route.

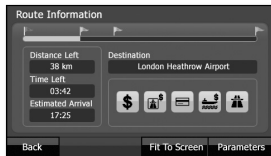

Route Info options

Fit To Screen : displays a set route on the map so that it fits the screen.

Parameters : you can set route options including Route Preference and Vehicle.
(See page 32)

ROUTE SETTINGS (Continued)

Simulation

You can preview the course of a set route as if you are in the actual driving.

1. Tap "Route" button in the main menu.
 - The "Route" window appears.
2. Tap "Simulation" button.
 - The "Simulation" window appears.



Turn View

You can view the navigation screen in a symbol system rather than the typical map.

1. Tap "Route" button in the main menu.
 - The "Route" window appears.
2. Tap "Turn View" button.
 - The navigation symbol system appears.



NOTE

- Tap on any area if you want to switch to the map display.



ROUTE SETTINGS (Continued)

Manage Track Logs

You can keep track of and check route logs for later use.

To record navigation tracks

1. Tap “Route” button in the main menu.
 - The “Route” window appears.
2. Tap “Manage Track Logs” button.
 - Track Logs are listed.
3. Tap “Record” button.

A map screen appears where you can record the navigation tracks.



To stop recording

Tap “Stop Recording” button.



ROUTE SETTINGS (Continued)

Manage Track Logs

To play a track log

1. Select a desired item in “Track Logs” list.
2. Tap “Replay” button.
 - The selected log will be played.

To remove a log

1. Select an item to delete in “Track Logs” list.
2. Tap “Delete” button.
 - The selected log will be removed.

To check a log

1. Select a desired item in “Track Logs list.
2. Tap “Info” button.
 - The Information window appears. You can check the route information including the recording start and end times, time to take, average speed and total distance.
3. Tap “Colour on the map” button if you want to specify a route display color on the map.
 - The selected route will be displayed in the selected colour.

Track Information options

Rename : the character input mode appears. You can change the log name. (See page 51)

Fit To Screen : displays an entire track log on the map so that it fits the screen.

Export : You can store the track log on a memory card. When the Track Log confirmation message appears, tap OK button. The confirmation message also appears for an existing log file.

more than navigation

USING BLUETOOTH

Add a Bluetooth-compliant a hands-free (mobile phone) to your product before you can configure the wireless connection. When the connection is successfully made, you are now ready for wireless communications.

What is Bluetooth?

Bluetooth is a computing and telecommunications industry specification that describes how mobile phones, computers and PDAs can easily interconnect with each other and with home and business phones and computers using a short wireless connection.

- The Bluetooth device can cause a noise or malfunction, depending on the use conditions.
 - When the user hold the product in one hand and take a mobile phone in the other hand, this will interfere with the wireless connection or if part of the user's body tap ones on the transmission system of the product or mobile phone
 - Electrical variation from electrical jamming by the wall, corner or office partitioning Electrical interference from the same frequency-band devices including medical equipment, microwave oven and wireless LAN.
- The farther the distance between product and mobile phone is, the lower the quality is and if the distance exceeds a certain limit, the connection will be lost.
- When pairing the Bluetooth device with the product, make it within a short distance as possible.
- In week electric-field areas such as inside the lift or in the subway, the Bluetooth connection may not work properly.



NOTE

- The Bluetooth function of the player are optimized with Samsung products. If used with third party products, the Bluetooth function may not work properly.

USING BLUETOOTH (Continued)

Bluetooth Specification

The performance of a Bluetooth device can vary, depending on the specification. This product is compliant with the standard Bluetooth specifications.

- Specifications for certain purposes : In general, the transmission output is great, causing less reduction of the signal strength but requiring more power from the battery.
- Standard Specifications: The transmission output is comparatively low, which causes more reduction of the signal strength but minimizes the power consumption to increase the useful time.



NOTE

- Set off the Bluetooth mode when it is left unused. Tap on the Enable Bluetooth button on your mobile phone. When the V mark disappears, the Bluetooth mode will be set off. Set off the Bluetooth mode. Using Bluetooth reduces the battery usable time.

USING MOBILE PHONE



- **Before you start** - Check if your mobile phone is available for pairing with a Bluetooth device. (refer to the user guide for the mobile phone)

To pair a mobile phone

(You only have to pair it once)

1. Tap “Mobile Phone” button in the main menu.
 - The “Mobile Phone” window appears.
 2. Tap “Enable Bluetooth” button to check it ☒.
 - The check mark ☒ indicates the Bluetooth mode is available and unchecking it will set off the Bluetooth mode.
 3. Tap Connect to Phone button.
 4. Press the Search button.
 - Make sure that the mobile phone to connect should support the Bluetooth function.
 - You will see a list of mobile phones that support Bluetooth.
 5. Tap on a mobile phone to pair.
 - The password input window appears on the mobile phone.
 6. Enter 0000 for the password.
 - The mobile phone is paired and ready for connection with the product.
-  **NOTE**
- For instructions on pairing the product, refer to the user guide of your mobile phone.
 - In some mobile phones, the functions of search device and mobile conversation (placing/receiving calls) can not work properly due to difference of the hands-free system.

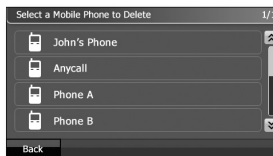

USING MOBILE PHONE (Continued)

To search for a new mobile phone

1. Tap on the Connect to Phone button in the Mobile Phone window.
 - You will see a list of registered mobile phones.
2. Tap Search button.



To remove a mobile phone from the list

1. Tap on the Connect to Phone button in the Mobile Phone window.
 - You will see a list of registered mobile phones.
2. Tap Delete button.
 - The Select a Mobile Phone to Delete window appears.
3. Tap on a mobile phone to delete.
 - The selected mobile phone will be removed.



To rename a device

1. Tap on the Connect to Phone button in the Mobile Phone window.
 - You will see a list of registered mobile phones.
2. Tap on the "Rename" button.
 - The character input mode appears.
3. Tap on a mobile phone to rename.
4. Rename the device.
 - Refer to page 00 for the character input.



USING MOBILE PHONE (Continued)



- **Before you start** - Check if your mobile phone is available for pairing with a Bluetooth device. (refer to the user guide for the mobile phone)

To pair a mobile phone

(You only have to pair it once)

1. Tap “Mobile Phone” button in the main menu.
 - The “Mobile Phone” window appears.
 2. Tap “Enable Bluetooth” button to check it ☒.
 - The check mark ☒ indicates the Bluetooth mode is available and unchecking it will set off the Bluetooth mode.
 3. Tap Connect to Phone button.
 4. Press the Search button.
 - Make sure that the mobile phone to connect should support the Bluetooth function.
 - You will see a list of mobile phones that support Bluetooth.
 5. Tap on a mobile phone to pair.
 - The password input window appears on the mobile phone.
 6. Enter 0000 for the password.
 - The mobile phone is paired and ready for connection with the product.
-  **NOTE**
- For instructions on pairing the product, refer to the user guide of your mobile phone.
 - In some mobile phones, the functions of search device and mobile conversation (placing/receiving calls) can not work properly due to difference of the hands-free system.



USING MOBILE PHONE (Continued)

To search for a new mobile phone

1. Tap on the Connect to Phone button in the Mobile Phone window.
 - You will see a list of registered mobile phones.
2. Tap Search button.



To remove a mobile phone from the list

1. Tap on the Connect to Phone button in the Mobile Phone window.
 - You will see a list of registered mobile phones.
2. Tap Delete button.
 - The Select a Mobile Phone to Delete window appears.
3. Tap on a mobile phone to delete.
 - The selected mobile phone will be removed.



To rename a device

1. Tap on the Connect to Phone button in the Mobile Phone window.
 - You will see a list of registered mobile phones.
2. Tap on the "Rename" button.
 - The character input mode appears.
3. Tap on a mobile phone to rename.
4. Rename the device.
 - Refer to page 00 for the character input.



USING MOBILE PHONE (Continued)

To redial using the recent call number

Tap on the Redial button in the Mobile Phone window.

- The product places a call using the recent call number.



To answer an incoming call

1. You will see the confirmation message when you get an incoming call.
2. Tap on the Yes button.
 - You can now make conversations with the other person.

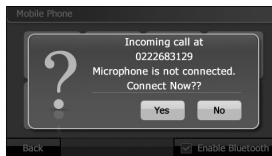

To switch a call

Ex) If you get a call at xxx-xxxx-5678 while making phone conversations at xxx-xxxx-1234

1. You will see the incoming call message for 5678 while making conversations at 1234.
2. Tap Yes button.
 - The call at 1234 will automatically switch to call-waiting mode and you can make conversations at 5678.
3. If you make the call at 5678 wait and return to 1234, tap on the Mobile Phone button in the main menu.
 - The Option menu appears.
4. "Tap on the Switch Call button."
 - The call at 5678 switches to call-waiting mode and you can make conversations at 1234.

USING MOBILE PHONE(Continued)

To switch to the mobile phone while talking on the hands-free device (YP-N1)

1. Tap Mobile Phone button while making conversations.
 - The Option menu appears.
2. Tap Voice to Phone button.
 - You can make conversations on the mobile phone.

To switch to the hands-free device (YP-N1) while talking on the mobile phone

1. Tap Mobile Phone button while making conversations.
 - The Option menu appears.
2. Tap Voice to Handsfree button.
 - You can make conversations on the hands-free device.

To disconnect the mobile phone

Tap on the Disconnect to Phone button in the Mobile Phone window.

- The mobile phone will be disconnected.



USING MOBILE PHONE (Continued)

To use the tone keyboard

You should use the tone keyboard for ARS service or for additional numbers such as extension.

1. Tap Mobile Phone button in the main menu while making conversations.
 - The Option menu appears.
2. Tap “Tone Keyboard” button.
 - The number input mode appears.
3. Enter a number or numbers.
 - Use the <= button if you entered a wrong number.

To view my device information

Tap on the About button in the Mobile Phone window.

- You can view your device information including device name, Bluetooth address and Bluetooth class.

connecting to your pc

PC REQUIREMENTS

Your PC system must meet the following minimum specifications in order to install :

- Pentium 300MHz or higher
- USB Port 2.0
- Windows XP or higher
- 100MB of free hard disc space
- CD Rom Drive (2X or higher)
- Resolution 1024 X 768 or higher

CONNECTING TO YOUR PC

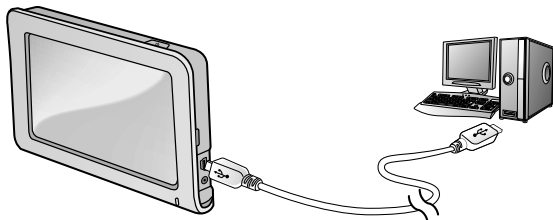

1. Connect the USB cable to the USB Connection Port of the device.
2. Connect the other end of the USB cable to the USB port (🔌) on your PC.



NOTE

- If you use an USB hub for the connection, USB communications may not work properly. Connect the USB cable directly to the USB port of your PC.
- If you connect the device through a USB hub, the connection may be unstable. Please connect the device to the computer directly.



CAUTION

- Do not disconnect the USB cable during file transfer. Disconnecting during transfer may damage the device or your PC.

DISCONNECTING FROM YOUR PC

Follow the steps below to prevent damage to the player and data when disconnecting from your PC.

1. Place the mouse cursor on top of the  icon on the taskbar at the bottom right corner of the desktop and click the left mouse button.
2. Click the <Safely Remove USB Mass Storage Device Drive> message.
3. Disconnect the player from your PC.

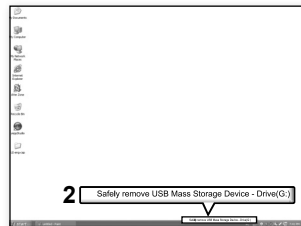
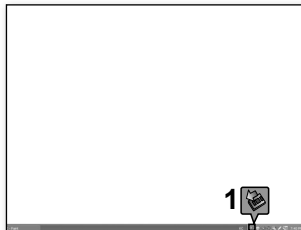

CAUTION

- Do not disconnect the player from the PC during file transfer. This may cause damage to data and the device.
- You cannot remove the hardware while the CD is installed on your PC. Please retry after the installation is finished.

USING THE MAP MANAGER

The Map Manager installs those data on the memory card, together with the program files of your navigation software and the voice files for guidance.



- **Before you start** – Insert the installation DVD provided with the device into the DVD-ROM drive. DVD를 CD-ROM에 넣으면 인식하지 못하므로 반드시 DVD-ROM에 넣어 주세요.

1. Click “Map Manager”.

- Device에 IGO 프로그램이 설치되어 있지 않은 경우 여러 메시지가 나타납니다.
- PC에 데이터가 백업되어 있지 않은 경우 백업 확인 창이 나타납니다. “OK” 버튼을 터치하면 데이터 백업이 시작됩니다.
- 설치 DVD 내의 프로그램이 최신 버전일 경우 프로그램 업데이트 확인 창이 나타납니다. “OK” 버튼을 터치하면 프로그램 업데이트가 시작됩니다.

2. Select the language of the installation program.

3. 왼쪽의 “Locally available maps” 창에서 원하는 지도를 선택한 후 “Install” 버튼을 클릭하세요.

- 오른쪽의 “Installed maps on device” 창에 설치됩니다.



USING THE MAP MANAGER (Continued)

4. 사용하지 않는 지도를 삭제하려면 오른쪽의 “Installed maps on device” 창에서 삭제할 지도를 선택한 후 “Remove” 버튼을 클릭하세요.
 - 선택한 지도가 삭제됩니다. 단, “Locally available maps”에 없는 지도를 삭제한 경우 “Locally available maps”에 자동으로 백업됩니다.
5. Device의 지도 데이터를 PC에 백업하려면 “Backup”을 클릭하세요. 백업된 지도 데이터를 Device로 복구시키려면 “Restore”를 클릭하세요.



NOTE

- 최신 버전 지도는 ↑아이콘으로 표시되고, 구 버전 지도는 ↓아이콘으로 표시됩니다.
- “Locally available maps”과 “Installed maps on device”의 지도 버전이 동일한 경우 설치되지 않습니다.
- “Installed maps on device”의 지도가 “Locally available maps”의 지도보다 최신 버전일 경우 설치되지 않습니다.
- “Locally available maps”의 지도는 PC의 <Documents and Settings> → <BIGFOOT> → <My Documents> → <iGO 2006>에서 확인할 수 있습니다.
- 초기 화면의 “Install POI-Warner”를 클릭하면 항상 최신 버전의 단속 카메라 위치를 제공 받을 수 있는 프로그램이 설치됩니다.

troubleshooting

If you have a problem with your new Personal Navigation Device, check for a solution in this list. If the problem persists, contact a Samsung Service Center near you.

PROBLEM	SOLUTION
The product does not turn on.	<ul style="list-style-type: none">• If the product ran out of the battery, it doesn't turn on. Recharge the battery and try again.• Press the Reset hole to initiate the settings.• Check if the Hardware Power On/Off switch is positioned to On.
The product just turns off.	<ul style="list-style-type: none">• If the battery is used up, the product automatically turns off. Recharge it and try again.
The battery usable time is different from that specified in the user guide.	<ul style="list-style-type: none">• The battery usable time can differ, depending on the use conditions such as volume level, LCD brightness, Bluetooth mode, etc.• A recharged battery can have less usable time if it is exposed to low or high temperature for an extended time.
Nothing is displayed on the screen.	<ul style="list-style-type: none">• If the product is exposed to the direct light (sunlight, etc), the display may be unclear.
The navigation system does not work.	<ul style="list-style-type: none">• Check if your SD memory card has a map file stored.• Check if your SD memory card is damaged. If it is damaged, contact the store where you purchased it.• Check if the battery has an appropriate remaining capacity.

PROBLEM	SOLUTION
No sound is output.	<ul style="list-style-type: none">• Check if the volume is set to the minimum. Check if the Mute function is selected and if so, set it off.
The menu or voice guidance language is different.	<ul style="list-style-type: none">• In the main menu, select Settings → Language & Unit and change the settings of Menu Language or Voice Language.
Loading a map file does not work.	<ul style="list-style-type: none">• Check if you properly inserted the SD memory card into the memory card slot on the product.• Check the USB cable if it's correctly connected and try again.• Check if your SD memory card has an appropriate free space.
A file(s) or data is missing.	<ul style="list-style-type: none">• Make sure the USB cable should keep connected during the file or data transfer process. Otherwise, it can cause missing file or data, or even critical damage to the SD memory card. Samsung Electronics has no responsibility for missing data in any way. So please take caution.
The file transfer rate is too low.	<ul style="list-style-type: none">• If you are running multiple programs including Smart2go™ Setup Assistant on your PC, the file transfer rate will be low. So make sure to exit unnecessary programs before proceeding.
The program does not work at all.	<ul style="list-style-type: none">• Please refer to the recommended 'PC Requirements' section in this guide.

PROBLEM	SOLUTION
Connection between PC and product is not made.	<ul style="list-style-type: none"> • Press <Start> on the desktop to launch Windows Update. Check all of critical updates and service pack patches before updating the system. Restarts your system and try to connect again.
Heat emits from the product.	<ul style="list-style-type: none"> • Heat can be emitted during the recharging process. Heat has nothing to do with the performance and useful life of the product. You don't need to worry about.
Bluetooth connections could not be made.	<ul style="list-style-type: none"> • Check if your mobile phone supports the Bluetooth function. • Check if your mobile phone is already connected to other device. If so, disconnect it and try again. • Check if the Enable Bluetooth option is checked with V in the Mobile Phone window. If it is not checked with V, Bluetooth connection will not be made. • The Bluetooth connection can be set off if you turn off and restart the product or mobile phone. In this case, make the connection again.

appendix

MENU TREE

Here's a quick look at how the menus and functions are organized on your new Personal Navigation Device.

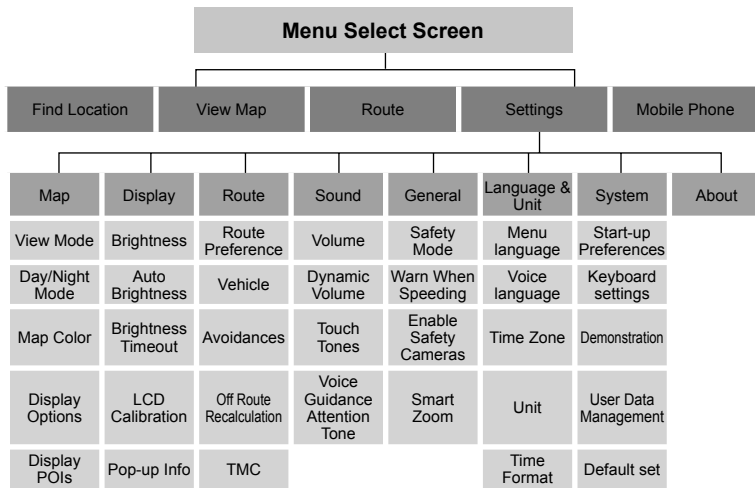

PRODUCT SPECIFICATIONS

Model Name	YP-N1
Power	AC Adapter: 8.4V/1A Car Power Adapter: 6V ~ 36V
Built-in Battery Power	1700 mAh 3.7V Built-in Lithium-Polymer battery
CPU	S3C2440-400MHz high performance CPU
LCD	4.3" WQVGA(480x272) TFT LCD (280 cd/m2) with Touch Screen panel Backlight control
Audio System	internal 0.9W amplify inside a Set. 1.2W Speaker inside Cradle. Echo cancellation with TMC1182.
GPS Module	GPS engine : SiRF III Frequency : 1575.42 MHz C/A code : 1.023 MHz Chip rate Channel : 20 Channels access Sensitivity : -159 dBm
GPS Performance	Acquisition times (Cold : 45 sec / Warm : 35 sec / Hot start : 8 sec) Accuracy (Position : 10 metres, : Velocity : 0.5 m/sec)

PRODUCT SPECIFICATIONS (CONTINUED)

I/O Interface		support SD memory card Support USB 2.0 Exteral TMC Ant		
Operation time		4 hours (condition: Backlight minimum)		
보관 온도		0~45		
Case		Plastics		
Weight		205 g		
Dimension (WxHxD)		122X84X19.5 mm		
Blue - tooth	Frequency Range	Transmit/Receive : 2402~2480 MHz	Spec Version Supported	Version 2.0 + EDR
	Module	Transmission Output	TMC Useable Sensitiivity	2.4 mW

The contents of this Manual are subject to change without prior notice for further improvement.

CONTACT SAMSUNG WORLD WIDE

If you have any questions or comments relating to Samsung products, please contact the SAMSUNG customer care center.

Country	Customer Care Center	Web Site
CANADA	1-800-SAMSUNG (7267864)	www.samsung.com/ca
MEXICO	01-800-SAMSUNG (7267864)	www.samsung.com/mx
U.S.A	1-800-SAMSUNG (7267864)	www.samsung.com
ARGENTINE	0800-333-3733	www.samsung.com/ar
BRAZIL	0800-124-421, 4004-0000	www.samsung.com/br
CHILE	800-726-7864 (SAMSUNG)	www.samsung.com/cl
COSTA RICA	0-800-507-7267	www.samsung.com/latin
ECUADOR	1-800-10-7267	www.samsung.com/latin
EL SALVADOR	800-6225	www.samsung.com/latin
GUATEMALA	1-800-299-0013	www.samsung.com/latin
JAMAICA	1-800-234-7267	www.samsung.com/latin
PANAMA	800-7267	www.samsung.com/latin
PUERTO RICO	1-800-682-3180	www.samsung.com/latin
REP. DOMINICA	1-800-751-2676	www.samsung.com/latin
TRINIDAD & TOBAGO	1-800-7267-864	www.samsung.com/latin
VENEZUELA	0-800-100-5303	www.samsung.com/latin
COLOMBIA	01-8000112112	www.samsung.com.co
BELGIUM	02 201 2418	www.samsung.com/be
CZECH REPUBLIC	844 000 844	www.samsung.com/cz
DENMARK	70 70 19 70	www.samsung.com/dk
FINLAND	030-6227 515	www.samsung.com/fi
FRANCE	3260 SAMSUNG or 08 25 08 65 65 (€0,15/Min)	www.samsung.com/fr
GERMANY	01805-121213 (€0,14/Min)	www.samsung.de
HUNGARY	06-80-SAMSUNG (7267864)	www.samsung.com/hu
ITALIA	800-SAMSUNG (7267864)	www.samsung.com/it

Country	Customer Care Center	Web Site
LUXEMBURG	0032 (0)2 201 24 18	www.samsung.lu
NETHERLANDS	0900 20 200 88 (€0,10/Min)	www.samsung.com/nl
NORWAY	815-56 480	www.samsung.com/no
POLAND	0 801 801 881	www.samsung.com/pl
PORTUGAL	80 8 200 128	www.samsung.com/pt
SLOVAKIA	0800-SAMSUNG (726786)	www.samsung.com/sk
SPAIN	902 10 11 30	www.samsung.com/es
SWEDEN	0771-400 200	www.samsung.com/se
U.K	0870 SAMSUNG (7267864)	www.samsung.com/uk
Republic of Ireland	0818 717 100	www.samsung.com/uk
Switzerland	0800-7267864	www.samsung.com/ch
RUSSIA	8-800-200-0400	www.samsung.ru
KAZAHSTAN	8-800-080-1188	www.samsung.kz
UZBEKISTAN	8-800-120-0400	www.samsung.uz
UKRAINE	8-800-502-0000	www.samsung.com/ur
LITHUANIA	8-800-77777	www.samsung.lt
LATVIA	800-7267	www.samsung.com/lv/index.htm
ESTONIA	800-7267	www.samsung.ee
AUSTRALIA	1300 362 603	www.samsung.com/au
CHINA	800-810-5858, 010-6475 1880	www.samsung.com.cn
HONG KONG	3698 -4698	www.samsung.com/hk
INDIA	3030 8282, 1800 110011	www.samsung.com/in
INDONESIA	0800-112-8888	www.samsung.com/id
JAPAN	0120-327-527	www.samsung.com/jp
MALAYSIA	1800-88-9999	www.samsung.com/my
PHILIPPINES	1800-10-SAMSUNG (7267864)	www.samsung.com/ph
SINGAPORE	1800-SAMSUNG (7267864)	www.samsung.com/sg
THAILAND	1800-29-3232, 02-689-3232	www.samsung.com/th
TAIWAN	0800-329-999	▪ www.samsung.com/tw
VIETNAM	1 800 588 889	▪ www.samsung.com/vn
SOUTH AFRICA	0860 7267864 (SAMSUNG)	▪ www.samsung.com/za
U.A.E	800SAMSUNG (7267864) 8000-4726	▪ www.samsung.com/mea

EUROPE ONLY

This marking shown on the product or its literature, indicates that it should not be disposed with other household wastes at the end of its working life.

To prevent possible harm to the environment or human health from uncontrolled waste disposal, please separate this from other types of wastes and recycle it responsibly to promote the sustainable reuse of material resources.

Household users should contact either the retailer where they purchased this product, or their local government office, for details of where and how they can take this item for environmentally safe recycling.

Business users should contact their supplier and check the terms and conditions of the purchase contract.

This product should not be mixed with other commercial wastes for disposal.



SAFETY INFORMATION

FCC

This device complies with part 15 of the FCC Rules.

Operation is subject to the following two conditions:

- (1) This device may not cause harmful interference, and
- (2) this device must accept any interference received, including interference that may cause undesired operation.

Caution: Any changes or modifications in construction of this device which are not expressly approved by the party responsible for compliance could void the user's authority to operate the equipment.

Note: This equipment has been tested and found to comply with the limits for a Class B digital device, pursuant to part 15 of the FCC Rules. These limits are designed to provide reasonable protection against harmful interference in a residential installation. This equipment generates, uses and can radiate radio frequency energy and, if not installed and used in accordance with the instructions, may cause harmful interference to radio communications. However, there is no guarantee that interference will not occur in a particular installation.

If this equipment does cause harmful interference to radio or television reception, which can be determined by turning the equipment off and on, the user is encouraged to try to correct the interference by one or more of the following measures:

- Reorient or relocate the receiving antenna.
- Increase the separation between the equipment and receiver.
- Connect the equipment to an outlet on a circuit different from that to which the receiver is connected.
- Consult the dealer or an experienced radio/TV technician for help.

SAFETY INFORMATION (CONTINUED)

FCC

Any changes or modifications not expressly approved by the grantee of this device could void the user's authority to operate the device.

Compliance

This product conforms to the following.

Council Directive: Directive 89/336/EEC, 92/31/EEC (EMC)

Declaration of Conformity

Name: Samsung Electronics Co., Ltd

Address: 416, Maetan-3Dong, Yeongtong-Gu, Suwon City, Kyungki-Do, Korea
442-742 declares under its sole responsibility that the product

Trade Name: Samsung Electronics Co., Ltd

Model Number: YP-U3 has been tested according to the FCC/CISPR22/95 requirements for Class B devices and found compliant with the following standards:

EMI/EMC: FCC Part 15 Subpart B

This device complies with part 15 of the FCC Rules.

Operation is subject to the following two conditions:

1. This device may not cause harmful interference, and
2. This device must accept any interference received, including interference that may cause undesirable operation.

Party Responsible for Product Compliance

Samsung Electronics America

QA Lab.

3351 Michelson Dr. Suite #290
Irvine, CA92612