



WORLDWIDE OLYMPIC PARTNER



삼성애니콜cdma2000

SPH-X1100 사용설명서



Anycall Land
www.anycall.com

사용설명서의 모든 내용은 애니콜 랜드의
'Manual Bank'에서도 보실 수 있습니다.

- 당사에서 제공하지 않는 별매품을 구입 사용시
배터리 수명단축 및 휴대폰의 불량이 발생합니다.
이에 대한 책임은 지지 않습니다.
- 제품보증서 재증
- 공공장소에서 휴대폰은 진동으로 사용하시고
타인에게 방해가 되지 않도록 합니다.
- 안전을 위해 운전 중에는 휴대폰 통화를 하지 않습니다.



기본기능

CDMA 2000 ?
/

) 가

)

)

)

)

4
5
7
8
9

)
/)
/)
가)

19
20
20
21
21
22
23

벨/전동/크기

12
13
14
15
16
17
18
18
19
19
19
19

)
, ()
/
)
)
)
)
가

25
27
29
29
29
29
30
30
31

문자입력방법

!

내휴대폰

)

)
)
)
)

가

)
)

33
33
34
34
35
37
38

39
40
40
41
41
42
43
44
45
45
45
46
46

E-mail
) E-mail
) E-mail
) E-mail
) E-mail
 /

휴대폰관리

가

가

95 / 117
 95 / 117
 95 / 118
 97 / 118
 97 / 118
 98 / 119
 99 / 120
 100 / 120
 100 / 120
 101 016-200-6004 120
 102 018-801-2000 120
 103 2004 (016 가) 121
 103 2004 121
 103 122
 103 122
 105 123
 106) 123
 107) 124
 108) 124
 109) 125
 110 () 126
 111 **게임기능** 126
 112 Push Push 127
 113 127
 114) 127
 115)
 116

PC 2000 129
 700 130
) 700 / 130
 ? 131
 !? 133
 134
 135
) 135
) 137
 139
 140
 141
 142
 144
 148

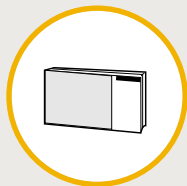
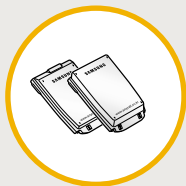
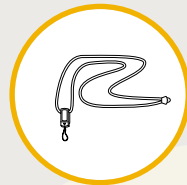

(/)

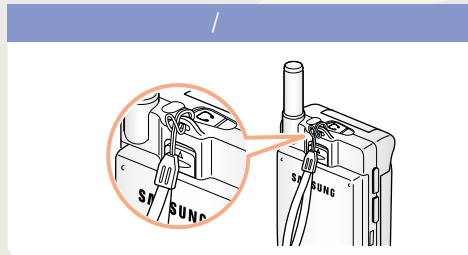



	/		
		(18)	
	/	(91)	
	/		
	/	magic	(85)
	/	(17)	
	/		
	/		
	/	(30)	
		(125)	

()



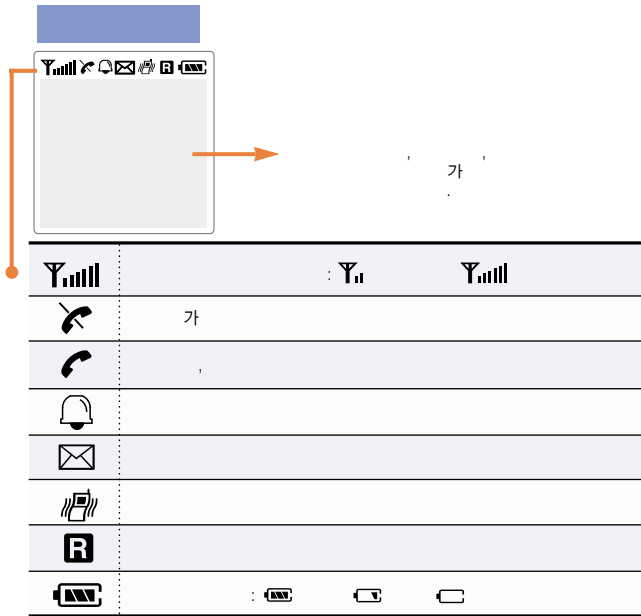



/

2가 가

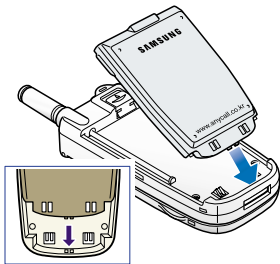

1

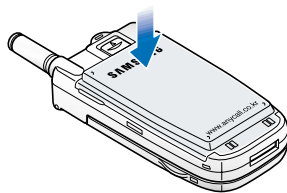

2

가

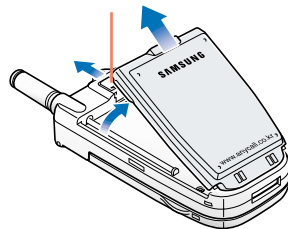

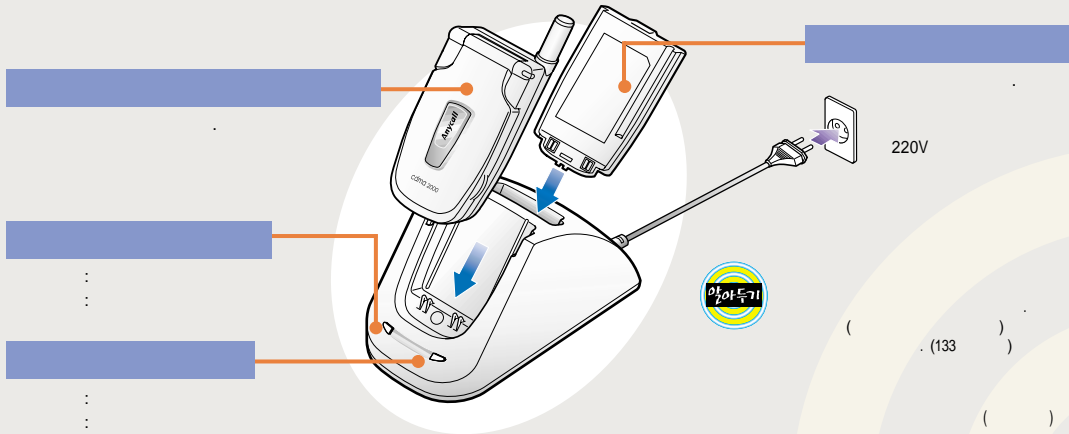

(133)

()

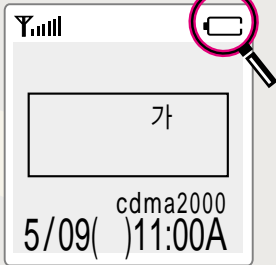

(570mAh)	(800mAh)
2 30	3

•
•



()

	IS-95A/B	90	130
		60 ~ 180	90 ~ 260
	CDMA2000	140 ~ 290	200 ~ 410

()

•

• IS-95A/B CDMA2000 CDMA2000

가

9

- , , , 가
- ()
- 가
- 가
- 가
- 가
- 가
- 가



?

가

- !
- , 가 !
- 가 !
- 가 !
- () , 가
- () 가 !
- , 0°C~+40°C !
- !
- 가 1~2
- 가 !

MEMO

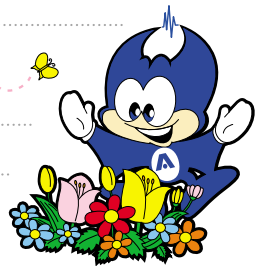

기본편

- 기본기능
- 벨/전동/크기

CDMA2000 ?

CDMA2000 3
IS-95A/B

IS-95C

IMT 2000

95A/B
(144 kbps)

(14.4 ~ 64 kbps)

CDMA2000

가

, Quick Paging

2 가
2

CDMA2000
IS-95A/B

CDMA2000





/

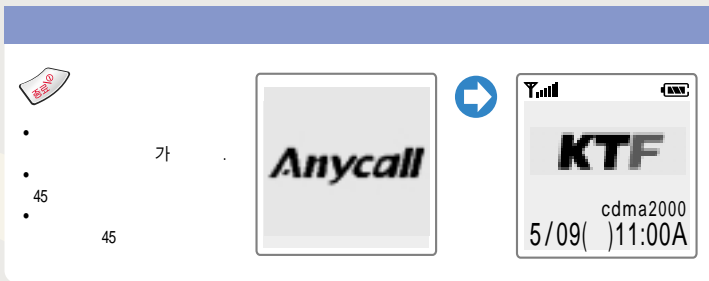



1

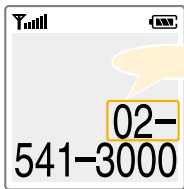

2



3

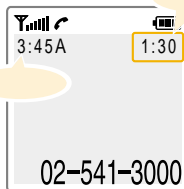

기본편

• 두 가지의

가



가



가

가

가
(17)

)

가

가

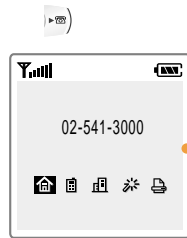
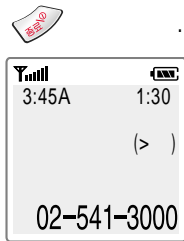

가

48



가
113 가

/ 가 .(117)
가



가

가 가
가 가



가

60

가



(30 , 30)

1

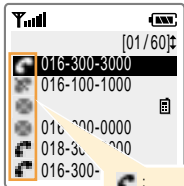

2

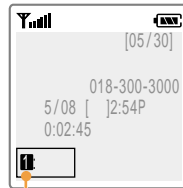
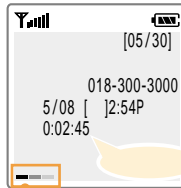
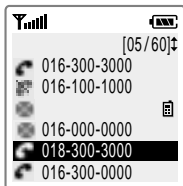

가
(21)



:
(48)



가

1



2



가

기본편

• 두 번째 기





	()
	<div>통화중예</div> <div>→ [인]</div> <div>17</div>
가	<div> <div>통화중예</div> <div>[대]</div> <div>→</div> <div>3 [대]</div> <div>[대]</div> <div>→</div> <div>3 [대]</div> <div>가</div> </div>
가	<div> <div>통화중예</div> <div>[대]</div> <div>→</div> <div>4 [대]</div> <div>→</div> <div>[대]</div> <div>→</div> <div>4 [대]</div> <div>가</div> </div>
	<div>→ [대]</div> <div>→</div> <div>5 [대]</div> <div>→</div> <div>[인]</div>



가 가

가

. (113)

. (40 ~ 42)

가

. (23)

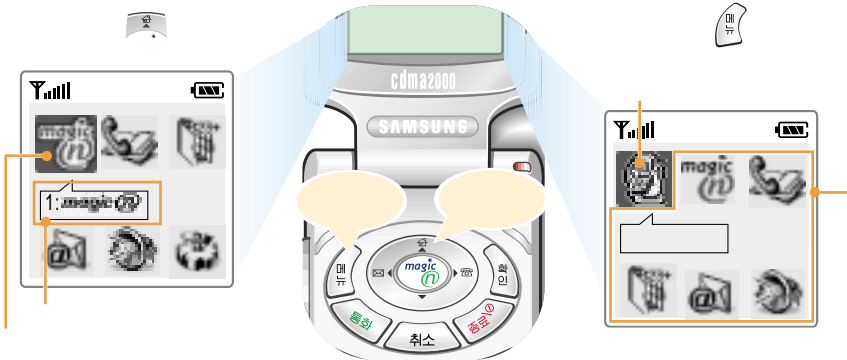

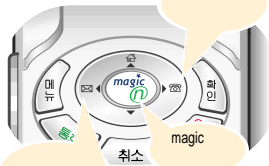

가



magic



가

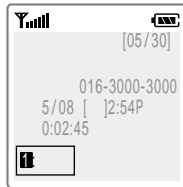
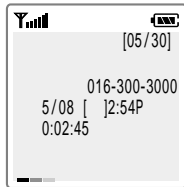

가

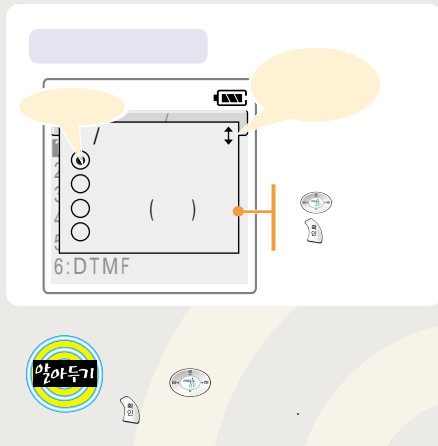
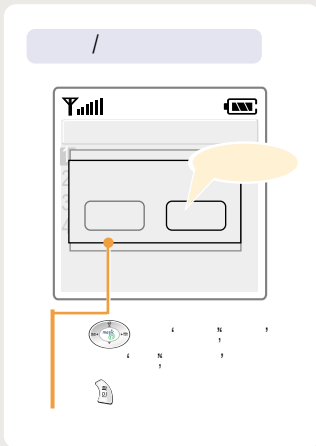
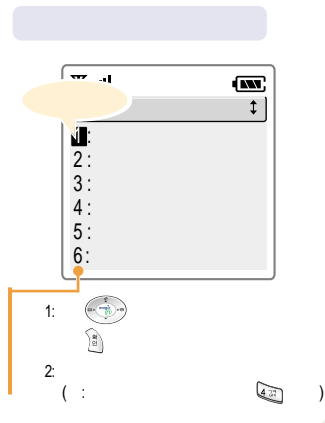



1 

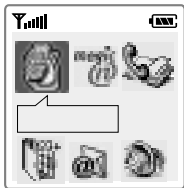

2 

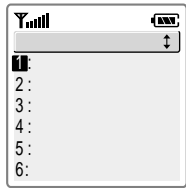

3 

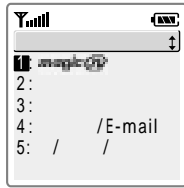

4 



24 6 가 .







(40 ~ 42) (46)

5

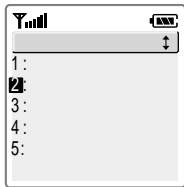

6



7

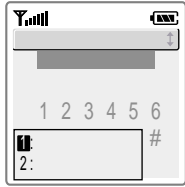

8



PC 2000

(129)

30

가





- 가
- (30)

()

()

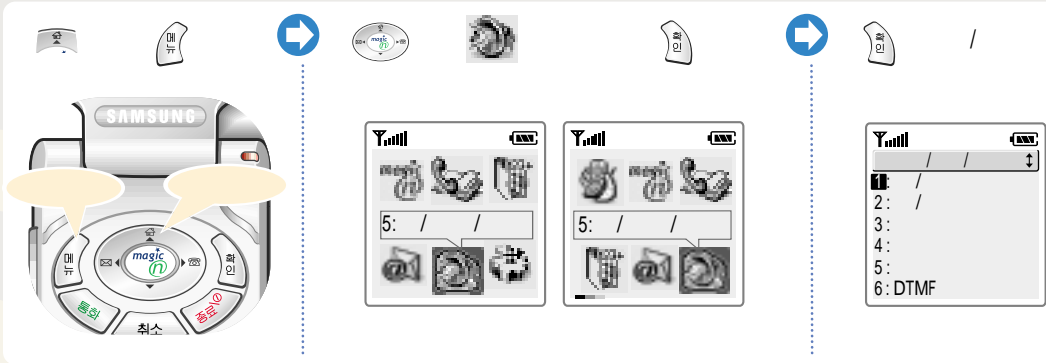

5: / /

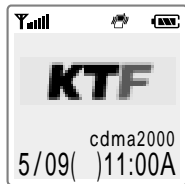
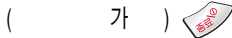
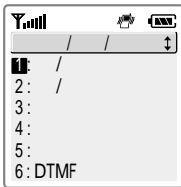
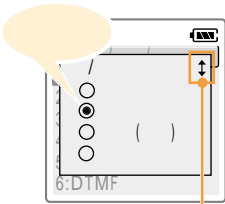



• 10

PC

(30

20

2000(129

)

)

magic (89

)

. 700

(130

)

3

가

3

가

,

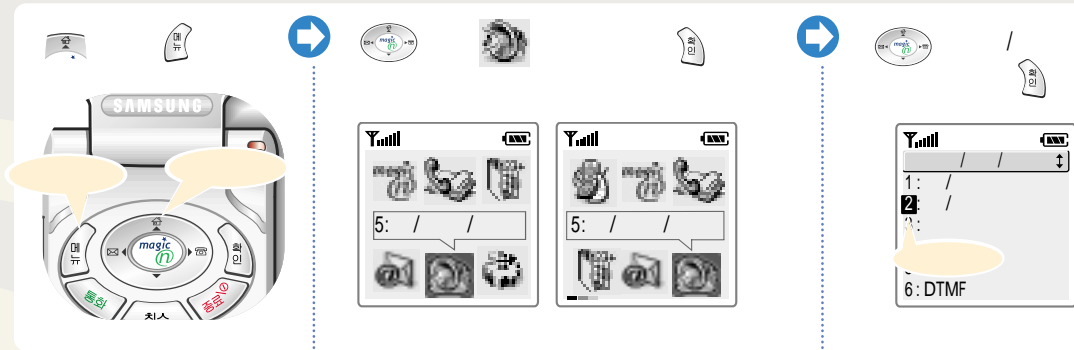

•

5: / /

5%

•

/

2%

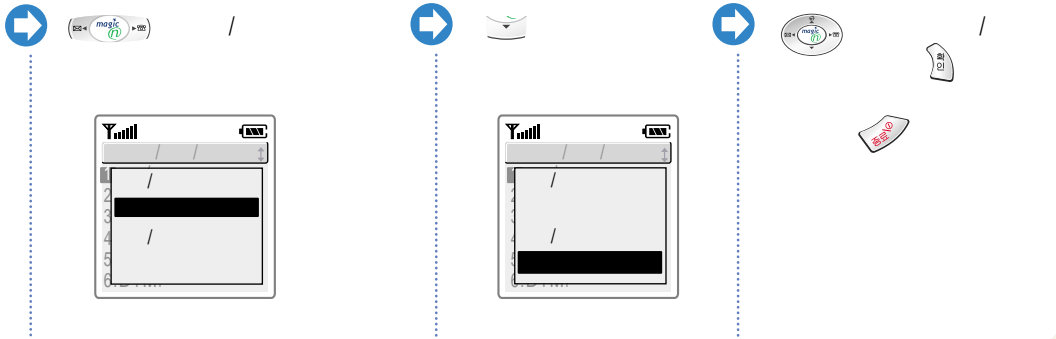

- : 10
- : 20
- 700 : 700
- :

PC

2000

3

magic

3

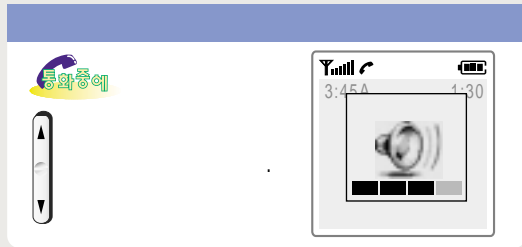
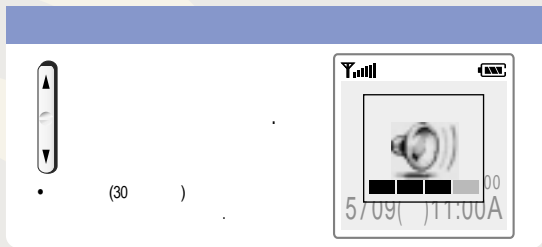
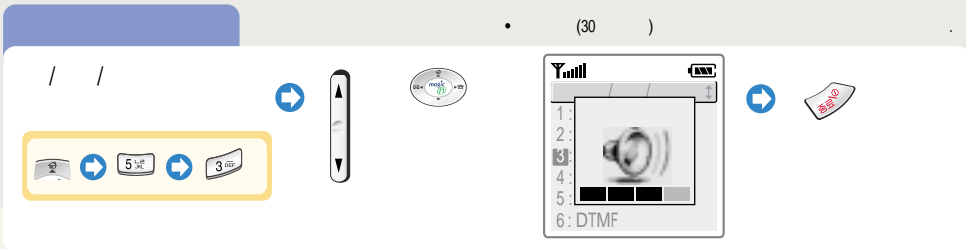



가 (,)

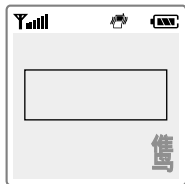

D-DAY	





가

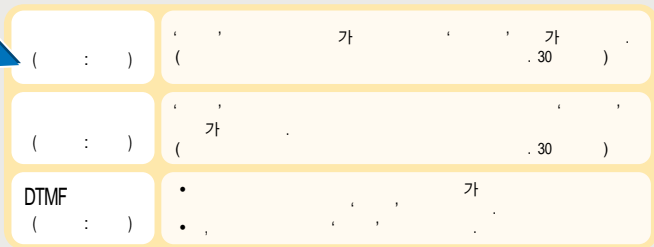
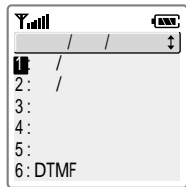
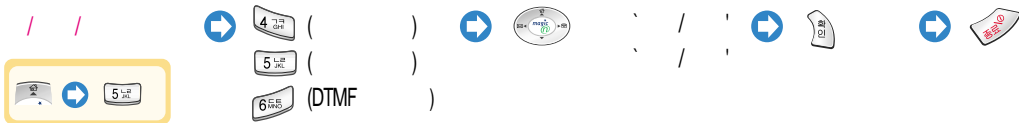

응용편

- 문자입력방법
- 내휴대폰
- 전화번호부
- 전자다이어리
- 인터넷 서비스 기능
- 메신저/E-mail
- 휴대폰관리
- 게임기능

하루
한번 쉬운!

문자 입력 방법

가



(34)



- (34)
- (35)
- (37)
- (38)

(43)
(44)
(48)
(59)

가 (71)
(73)
가 (75)
D-DAY (79)
(86)

D-DAY

(95)

(103)

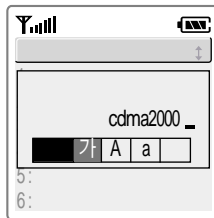

• (가)가

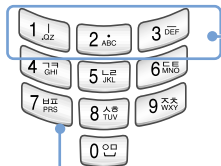

3

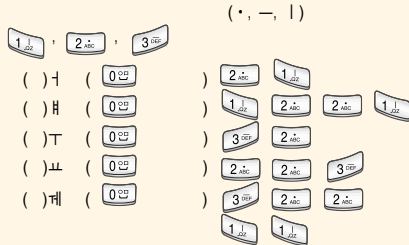

가



취소



(34 (가)
)
가
가

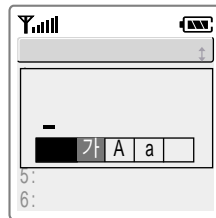



한번 따라해보세요!

Practice sequence for Hangeul input:

- 0 인 (0 in) → []
- 2 ABC (2 ABC) → []
- 1 JIZ (1 JIZ) → []
- 1 JIZ (1 JIZ) → []
- 7 비표 PPS (7 비표 PPS) → [비]
- 3 DE (3 DE) → []
- 5 LJK (5 LJK) → []
- 3 (3) → []
- 5 LJK (5 LJK) → [L]
- 1 JIZ (1 JIZ) → []
- 2 ABC (2 ABC) → []

한글 쉬운!
문자 입력 방법



가

K

5 누른

L

5 누른

• E-mail

	/	@
	이름	#



한번 따라해보세요!

‘ HIT ’

?

(A)
(a)
(34)

가

A

a

5:

6:

4 누른



4 누른

3

3



8 누른

H

HI

HIT



한번 따라해보세요!

?

가

(34)



가

가

가

(/ /)

0인

취스

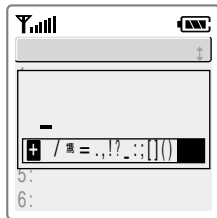

한번 쉬운!

문자 입력 방법

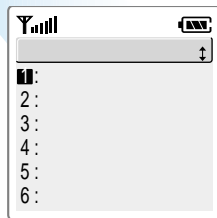
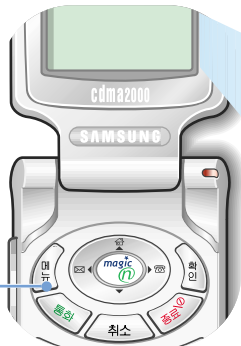
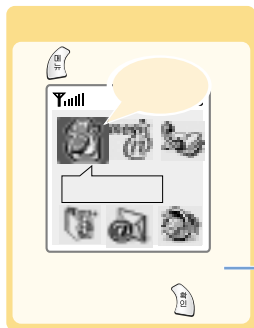

7:

- 23
- 40~42
- 43
- 44
- 45
- 46
- 46

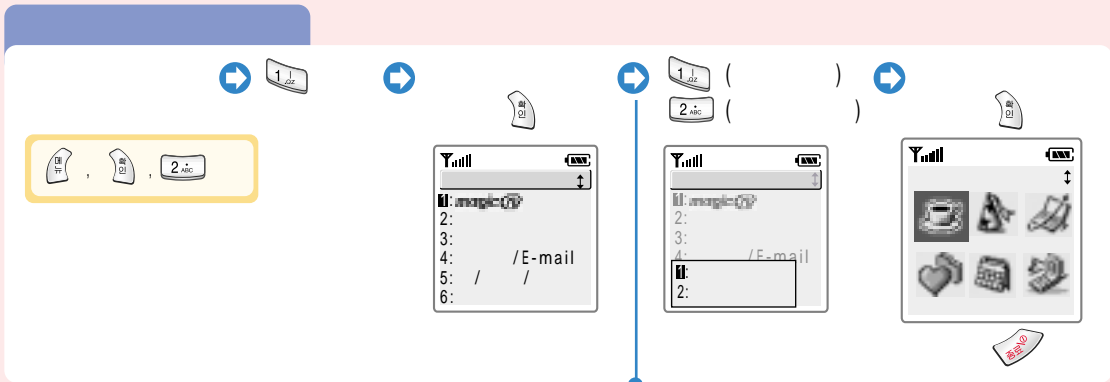

PC 2000 . (129)

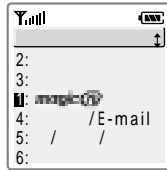

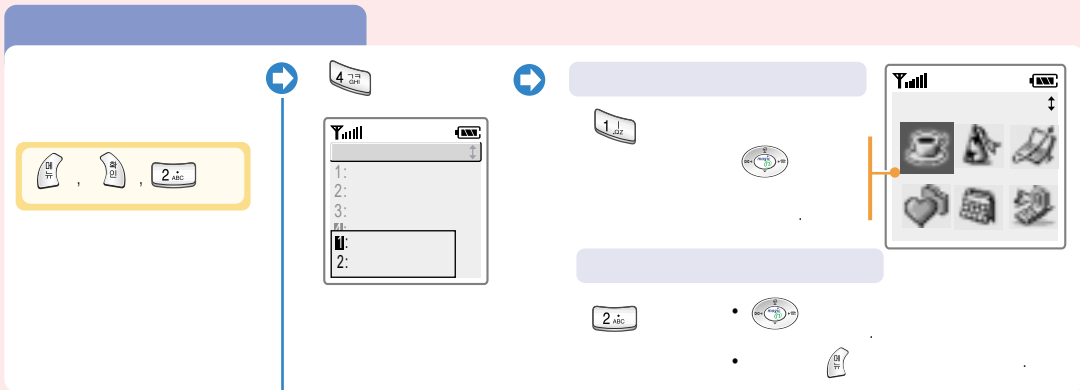

PC 2000

. (129)





8 ,

cdma2000
16

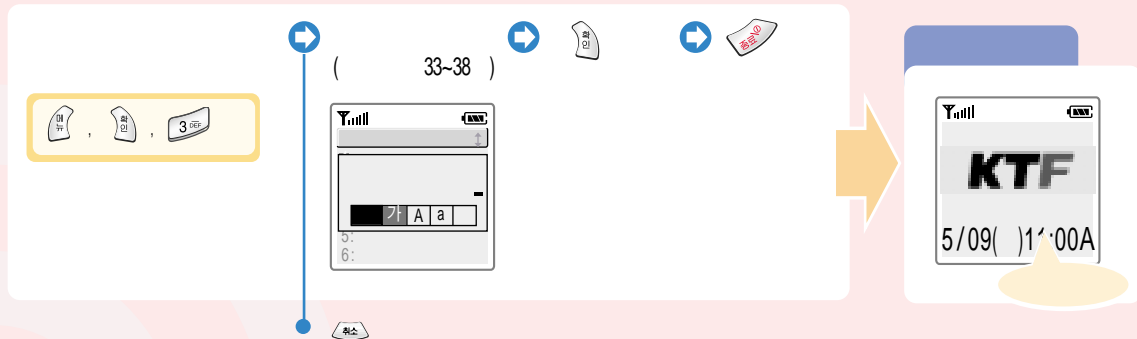



가

가

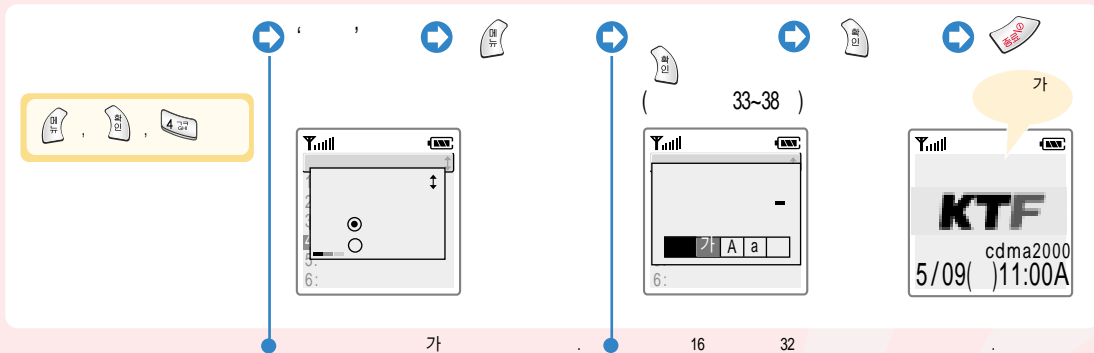

응용편

• 내부대폰



magic

PC

2000(129

)

magic (89

)

,

,



()



()



(magic)



()



()



가

가

가





()



‘ , ’





1



2

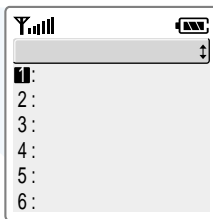

7 :
:

57

65~66

48

51

54

64

67



•
•
•

5, 1,000, 4, 2,400, E-mail, 12, (56)

3

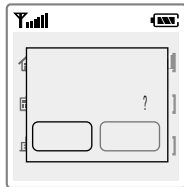
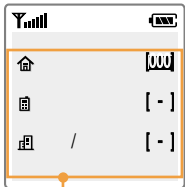
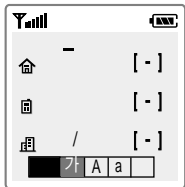

• 33~38
• 8, 가

16



• (49)

이용편

• 전자우편

주소

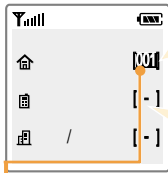

(000 ~ 999)

가

주소

[-]

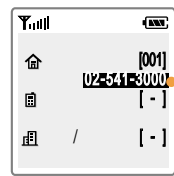

가

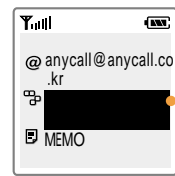

54

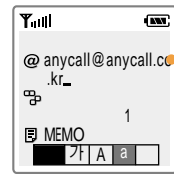

가

@

32

64

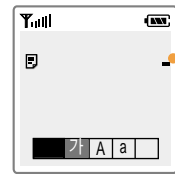

33 ~ 38

16

32

1.



2.

가
가

3.

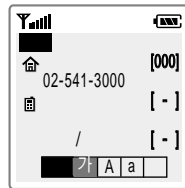
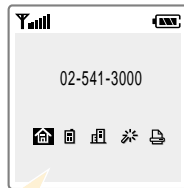

家 :
 田 :
 田 : /
 光 :
 印 : FAX



PC

2000

!

PC

2000

. (129)

49



가

가

.

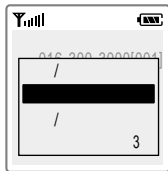
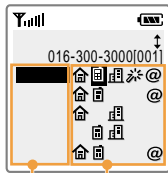
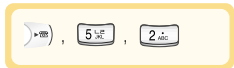

가

.

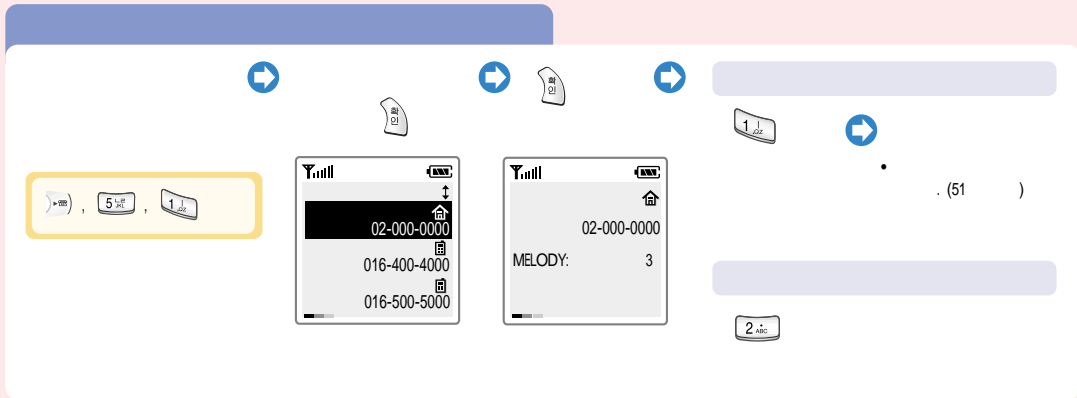

MEMO



- 가
- /
- 3
- 6
- 가

가

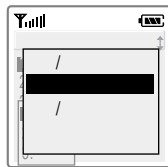
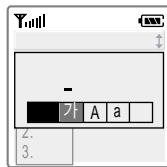
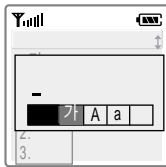

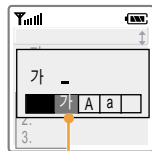
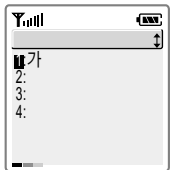

가
/

' (54)



' ,





(000 ~ 999)

0 0 0 ~ 0 0 9



001



009



0 1 0 ~ 9 9 9



023



255



이용편

• 전화 조작 마



⋮

1

1

1

1

1

1

1

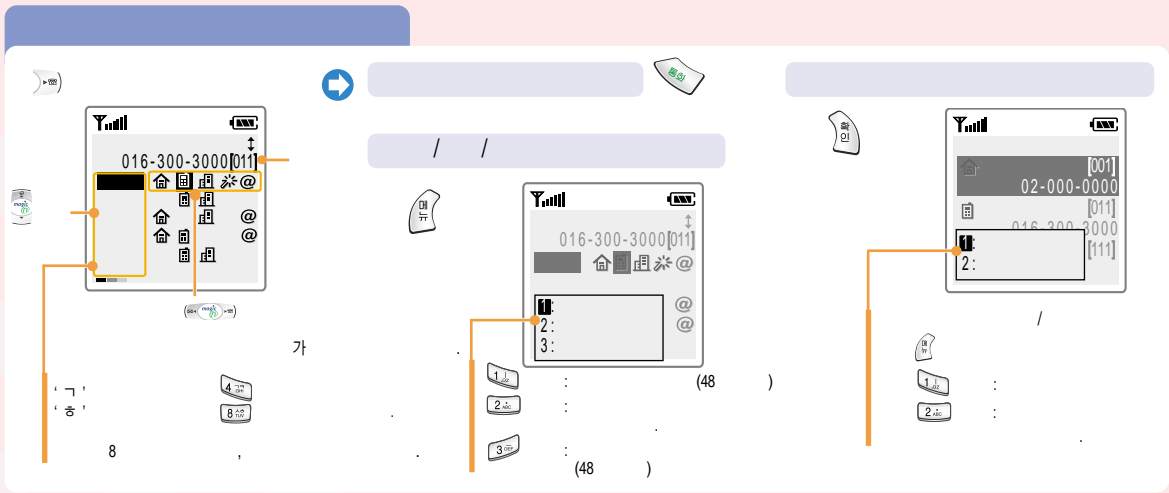

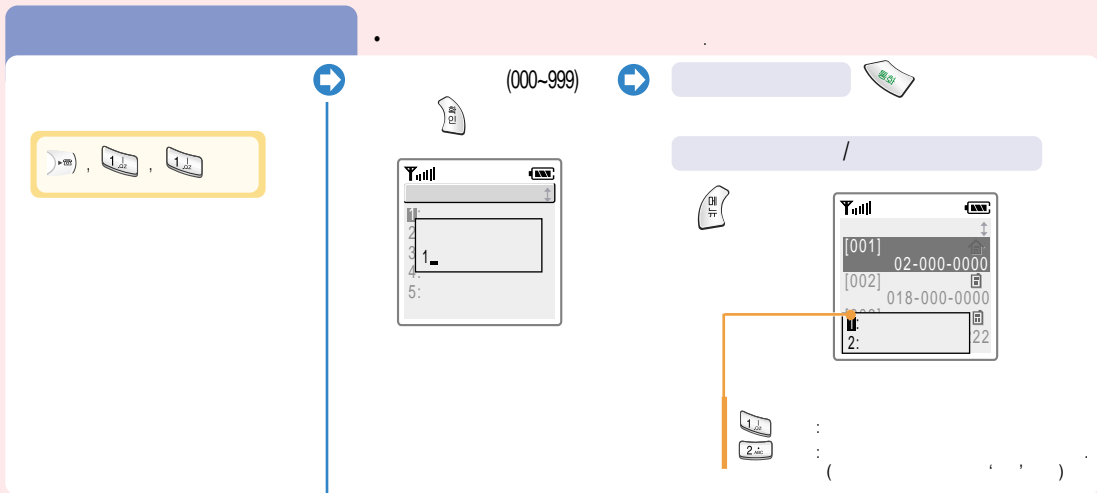

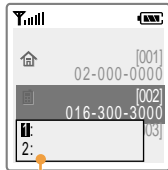
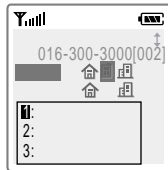
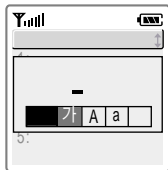

/



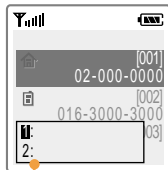
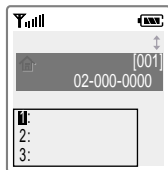
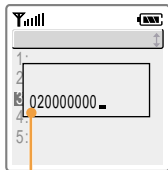
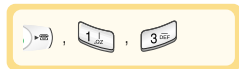

) 300 300 : 300
300 300 : 300
300 300 : 300

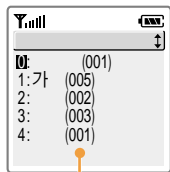

가

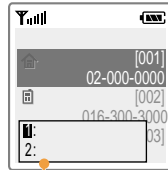
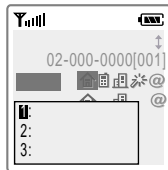

/



• (가)

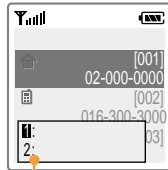
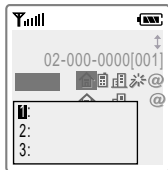

/





(ARS)

. (: ,) 가



가
(000~999)



(?)



‘ p 가



가

가



가



(ARS)

. (31)



(:0000)

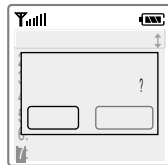



30

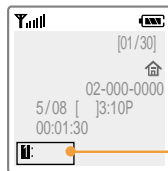
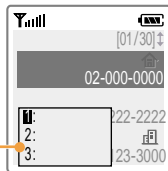
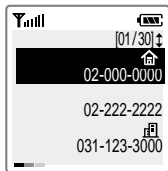
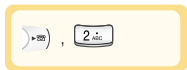

(50)





가

30

이동통신

• 전화 조작 마

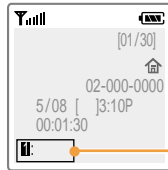
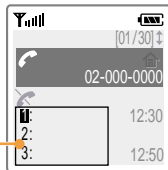
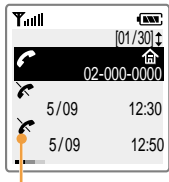

:

(50)





4

4

4

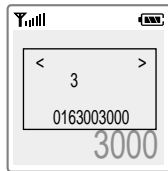

가



4 가

가



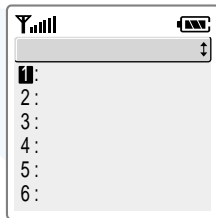
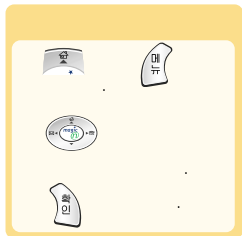

7: D-DAY

8:

9:

- 69
- 70
- 71
- 75
- 77
- 78
- D-DAY 79
- 81
- 82-83

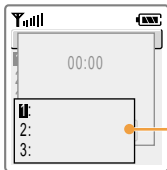

:



:

(



:



)

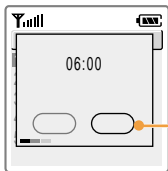

3



2

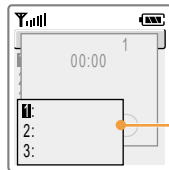

:



:

(



:



)



3

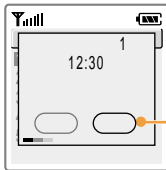



30



1:

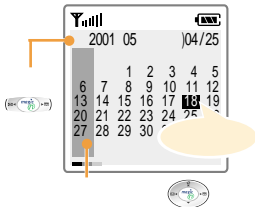

2:

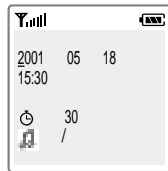



16 , 32

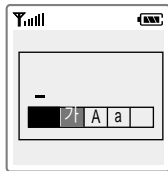

30 , 5 ,

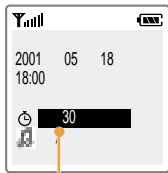

30 , 5 ,

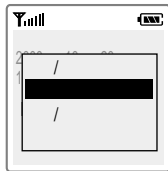

3

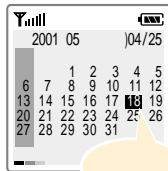

/ 가/



/ 가/

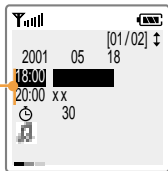
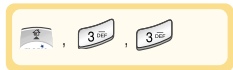



8

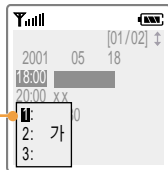

2





: (71)
: 가 (71)
:













2001 05)04/16

		1	2	3	4	5
6	7	8	9	10	11	12
13	14	15	16	17	18	19
20	21	22	23	24	25	26

2:

2001 05)04/16

		1	2	3	4	5
6	7	8	9	10	11	12
13	14	15	16	17	18	19
20	21	22	23	24	25	26
27	28	29	30	31		























5



(33~38)

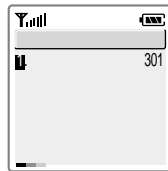
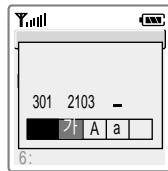

: 100 (200)

가



가

76



가

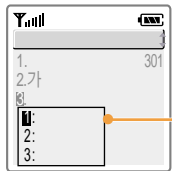
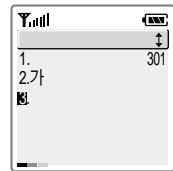

:

:

:

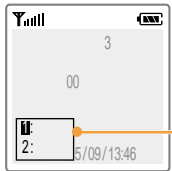

:

:

/



(:9)

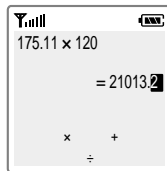
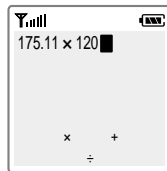
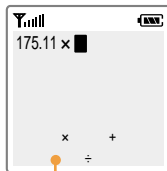
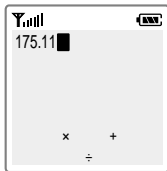

(-)



(2)



10





가

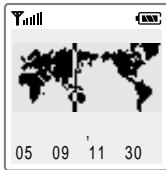
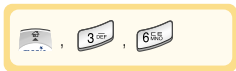

39

- | | | | |
|---|------|---|---|
| • | • | • | • |
| • | • LA | • | • |
| • | • | • | • |
| • | • | • | • |
| • | • | • | • |
| • | • | • | • |
| • | • | • | • |

이용편

• 고객센터



D-DAY

- D-DAY

(10)

D - DAY

D-DAY



D-DAY



(33 ~ 38)

8 , 16



가

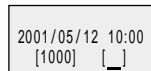

가

D-DAY

가/ /

D-DAY



D-DAY



가/ /



: 가

D-DAY

D-DAY

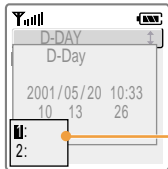

D-DAY

/

D-DAY



가 가

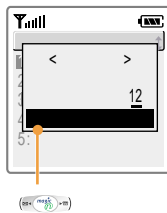
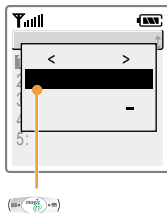
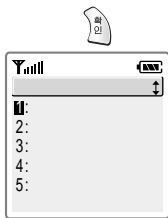



가

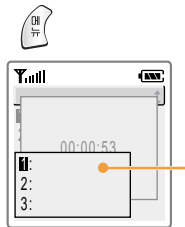
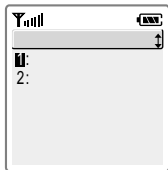

()



...

가

가

가

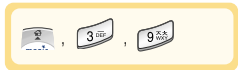

(24), , ,
) 3 50 15:50





(magic , /E-mail 가 , / .)

- magic , .
- /E-mail , , .
- / .



magic

magic

(113)

magic



magic



()



가

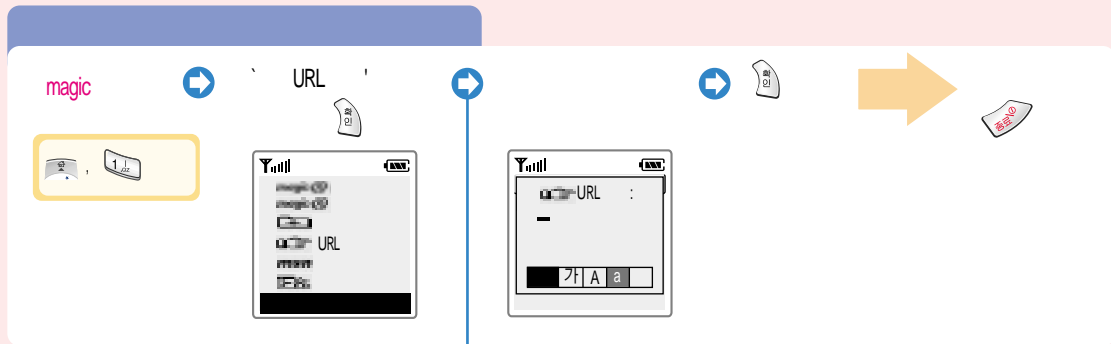

- URL(http://)
- (: www.magicn.com)
-
- (.)

magic



MSN



MSN

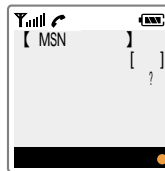

가

magic



* (Cookie) ?

가

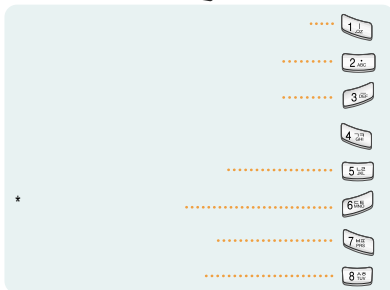

1(168.126.63.1)

(128.134.98.22), (7090),

Mail URL(www.magicn.com/smsmail/mail/write.asp?to=)

120(35 ~ 180)

/ /

/ / /

/

- 가
- 가
- () , 'EUC-KR, KS C5601, ASCII' 가
- 가
- () 가

magic



8



9





magic

/

(42), / (27)

magic



magic



magic

Best !



(45)





(

.)

?

가



1.

2.

3.

가

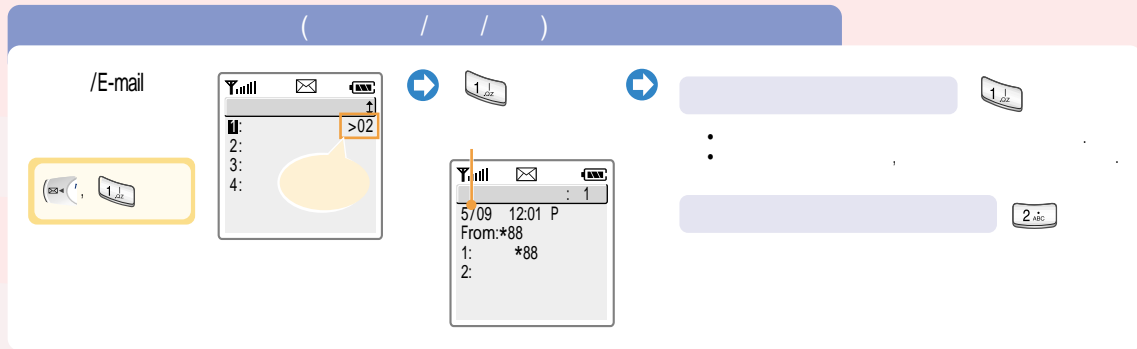

가

가

/E-mail



2 abc



/ /

1 abc

2 abc

3 abc

4 abc

:

:

:

:

:

(50

)

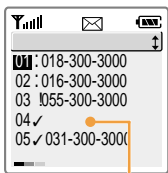

• :

• :

• ✓ :

• ! :

가

가

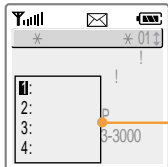

/E-mail

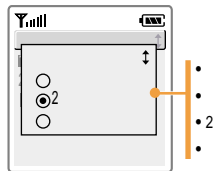
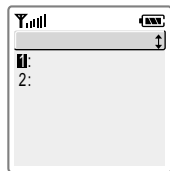

2

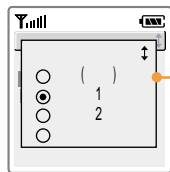

/E-mail

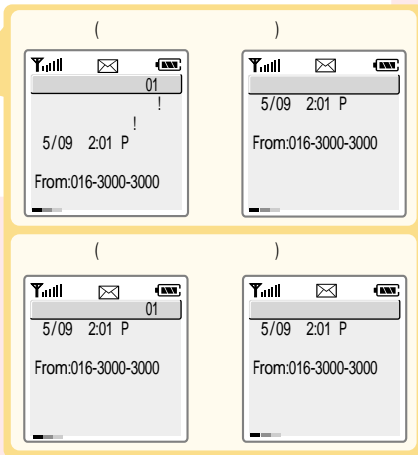
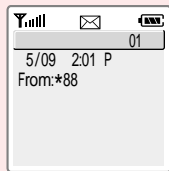
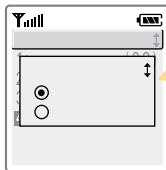
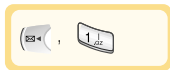



/ /

20



Y.ull

01:0183003000

02:0164004000_

03:

04:

05:

06:



Y.ull

01:_

02:_

03:

04:

2:



95

가

(97)

(33 ~38)



25

가

(1)가

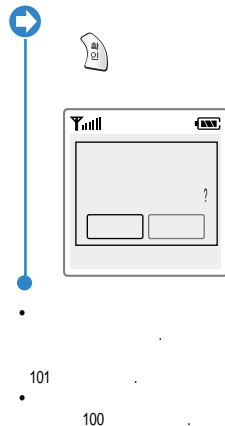
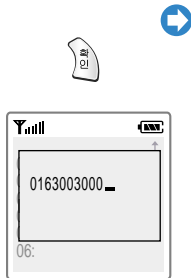
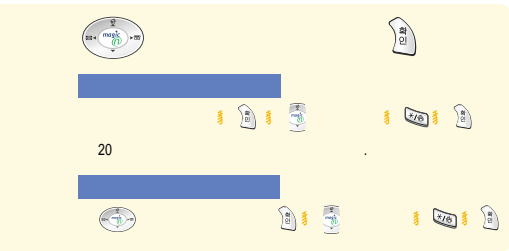
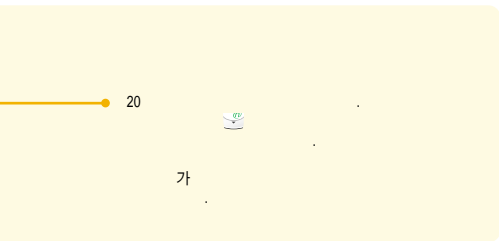

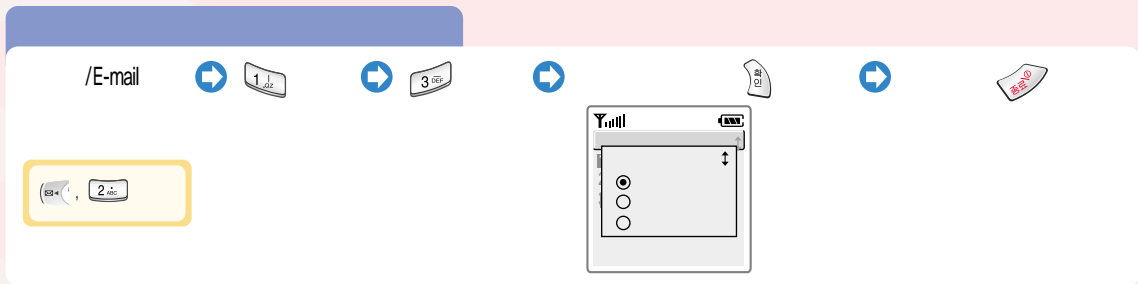
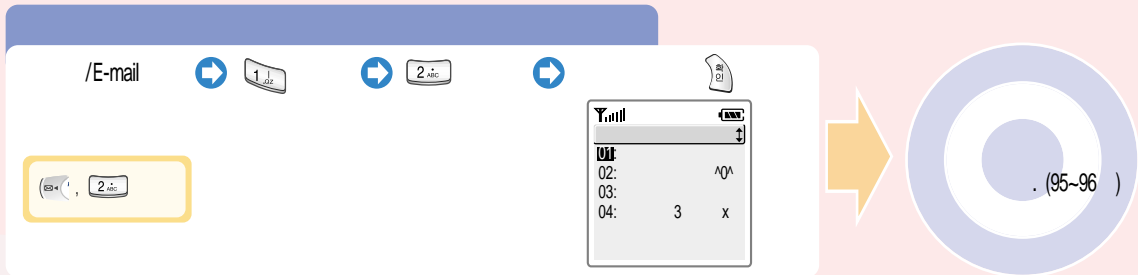

/E-mail



2 ABC



Y [signal] [battery]

1:

2:

3:

4:



Y [signal] [battery]

01:0183003000

02:0164004000 _

03:

04:

05:

06:



Y [signal] [battery]

01: _

02:

03:

04:

05:

06:

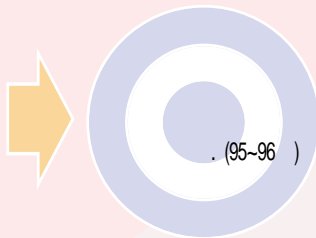

이동통신

• 문자/E-mail

/E-mail



(96)

가

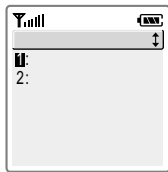

,

,

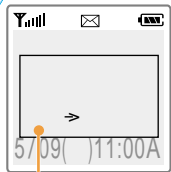

가

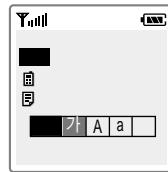



/E-mail



/

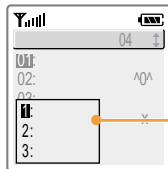
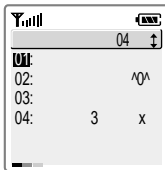

:

:



가

(

20

)

가

가

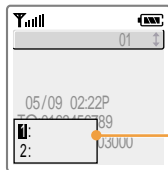

:

:

()

• 5

/E-mail



/

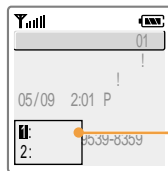
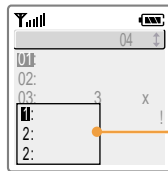
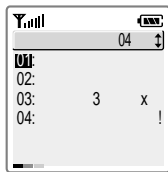



-
-
-

25

SMS

/E-mail

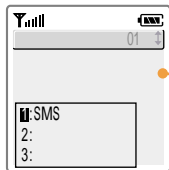
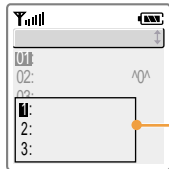
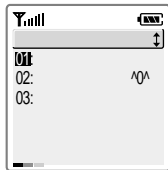

SMS

/



이동통신

• 문자 / E-mail



E-mail

E - mail

/E-mail

E-mail
E-mail

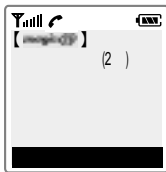

E - mail

/E-mail

E-mail

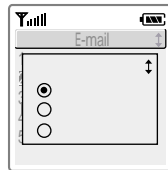

E-mail

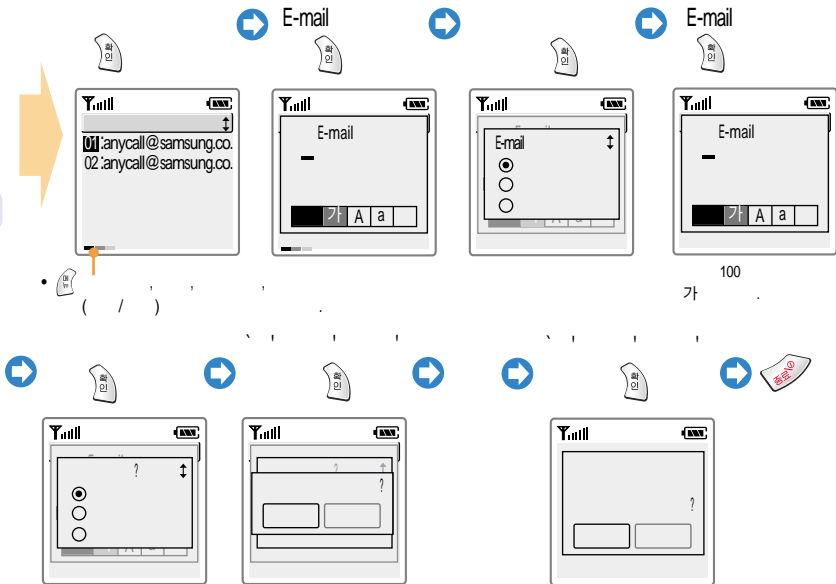

E - mail

5

E-mail

/E-mail
E-mail

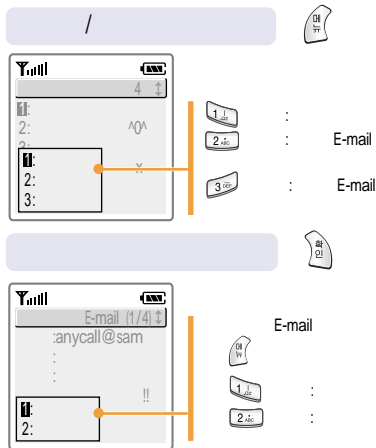
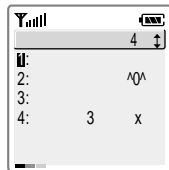

E - mail

5

/E-mail
E-mail

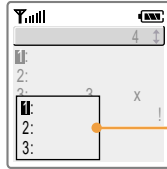
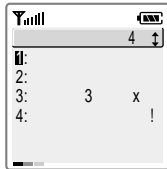

:

E-mail



:

E-mail



:

E-mail

E-mail

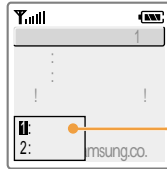

E-mail

/



:



:

E-mail

E - mail

가

/E-mail

E-mail

E-mail

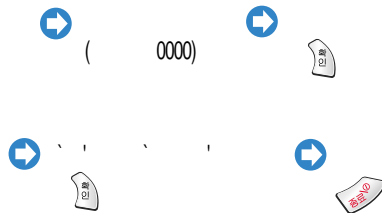
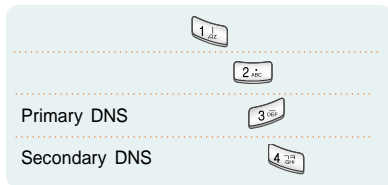



/

/E-mail

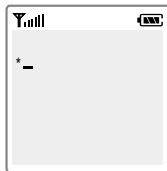
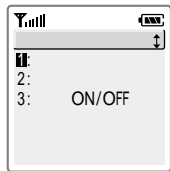

가



가



가



가 ,

가



가 .

, , , ,

가



가

가

(20)



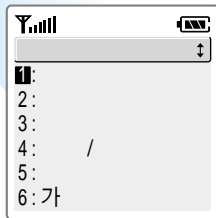
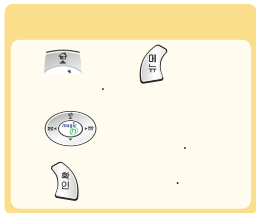

7 :
8 :
9 :
:

- 111
- 112
- 113
- / 114
- 115
- 가 116
- 122
- 122
- 123
- 125



•
• 0000



가 가



(

:0000)

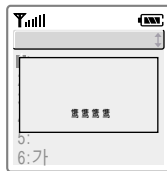

4



가





가

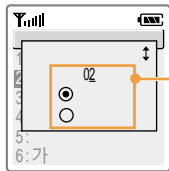



/



가
가



가

 ,
  6,
  3

1 ()
 2 ()
 3 ()
 4 ()

(:0000)
 ()
 ()

()
 ()

()	가	()	(:001, 002) 가
()	가	()	가



•

8

5

/

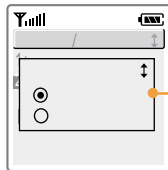
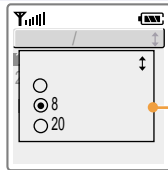
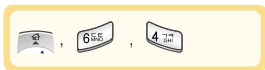

•



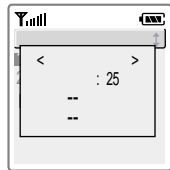



가

·
·

1

2

가



,

(

0000)



가



Y.	
가	↕
1:300-300-3000	<input checked="" type="checkbox"/>
2:400-400-4000	



1.
2.
3.

/

/

가

/

.

/

가



,



(0000)

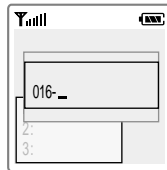
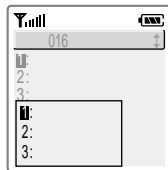
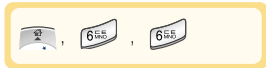

1~3



,



가



(0000)



가



(0000)



/

가

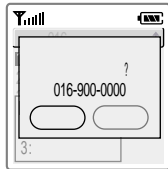

. (30)

가

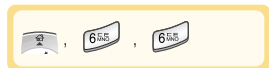

,

(0000)



/



/

가

.

/ 가



가 . (가)
/ 가 .
가 .
(.)
가 / .
가 .
1 2 . (018 가 .)

016-200-6004

016-200-6004

가

018-801-2000

018-801-2000

가

가



2004

(016 가)

- 016가 '2004' '2004' '2004'가 .
1. 2004 가 가 . 016-200-2004 016 .
 (016가 가 .)
 2. 2004
 3. 2004 '2004' .

2004

가



,

(

0000)

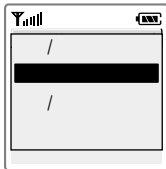
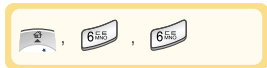



가

가



(:0000)



가



	(,) 가
가	가 /



1. 가 .
2. (139)
3. 가 .

. (30)

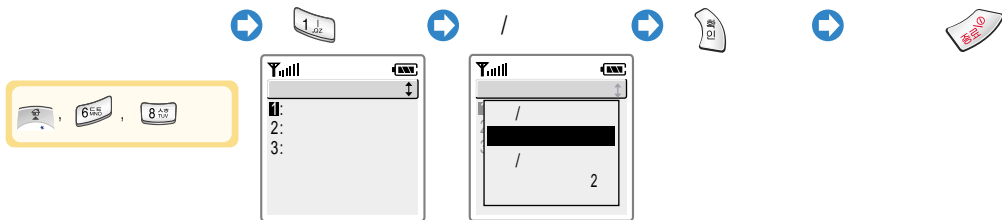

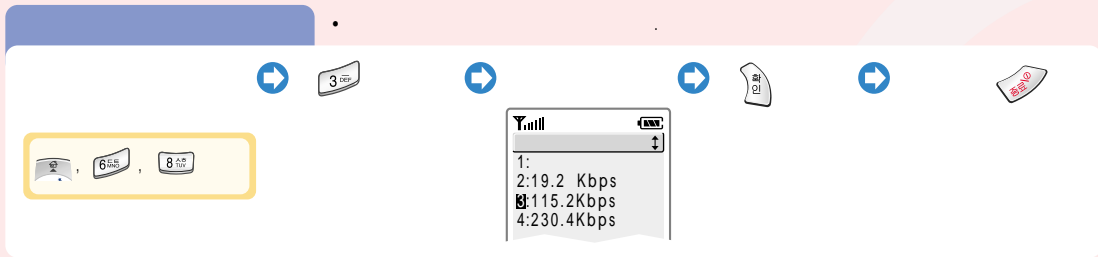
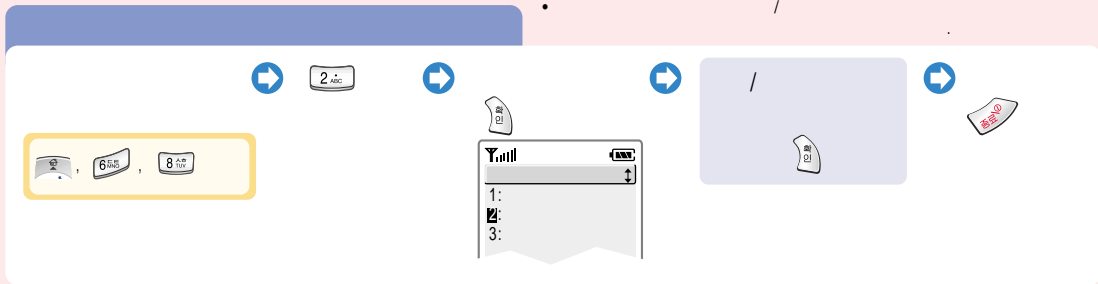



• ‘ ’
• (:119, 112) 가

()
• (‘ ’)

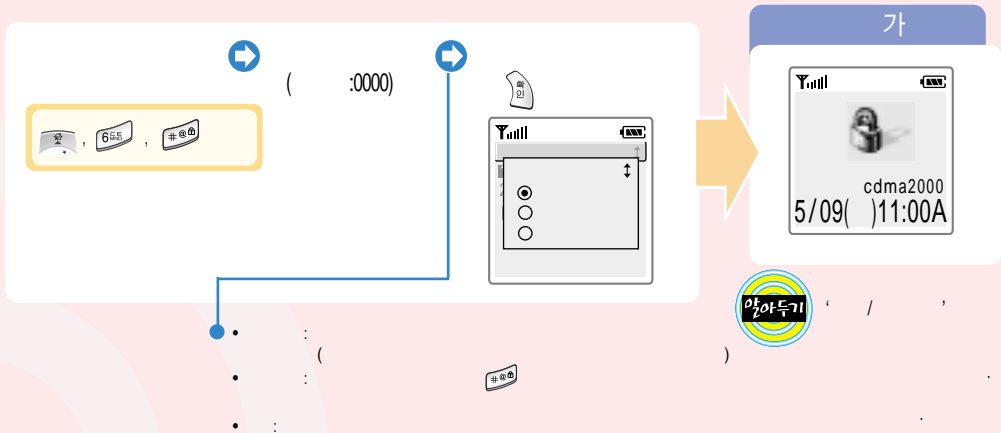



Push Push

GAME
Push-Push



Key Helper :



가

GAME



magic

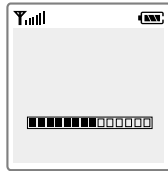
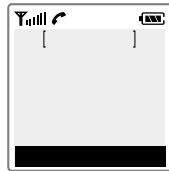

GAME

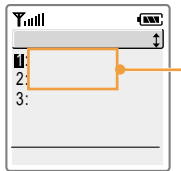
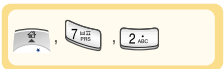

3



magic
magic



가 가 , ? , , .





PC

2000

PC

PC

2000

CD-ROM

PC

2000

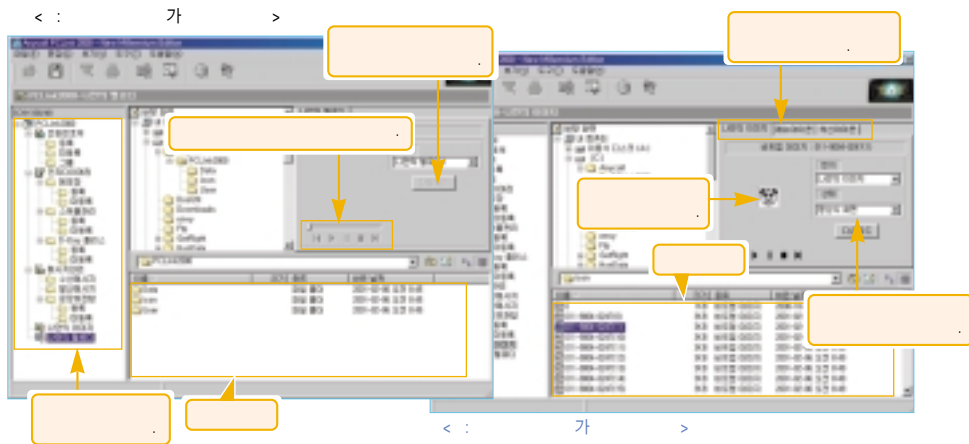



700

Anycall 부록

(SMS) 가

700

700

/

700-5782

700-5457

700-5857

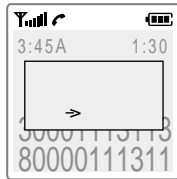

• 27

/

700

1, 2, 3

•

3

(,

/

.)



?



.	가 . (9)
,	.
' ' 가	가 2 .
.	.
가	.
()	.
.	.

() ?	
.	.(29) ,
가	/ / () . (25)
.	가
.	가 가
가	,



!?

가

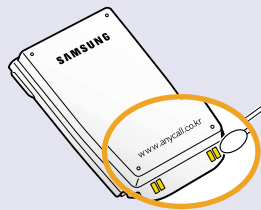
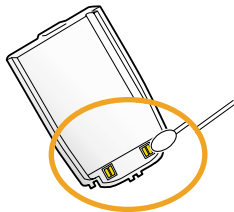
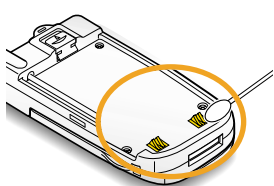

가

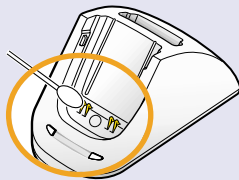

!



가

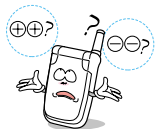
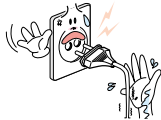

가



가

가

가



1. magic



1.magic

2.magic

3:

4.URL

5.MSN

6:

7:

2.



1:

1:

2:

3:

4:

5:

2:

3:

4:

5:

1:

2:

6:

7:

#:

3.

1:

2:

3:

4:

5:

6:

7:D-DAY

8:

9:

4.

/E-mail

1:

1:

2:

3:

2:E-mail

1:E-mail

2:E-mail

3:

4:

5:E-mail

3:

/

1:

2:

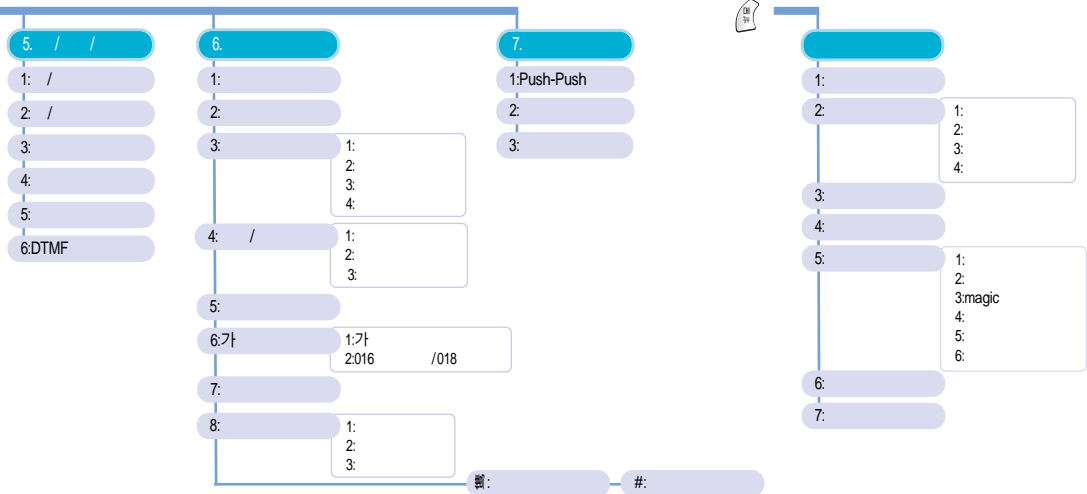

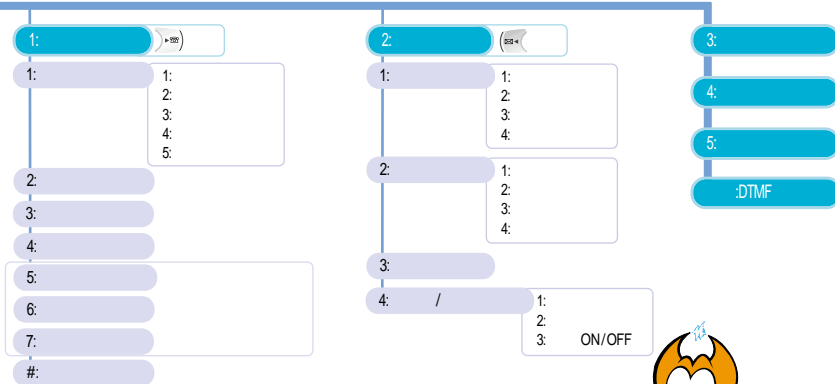

MEMO

.....

.....

.....

.....

.....

.....

.....

.....



별매품

●별매품의 그림은 실물과 다를 수 있습니다. 별매품 구입은 서비스센터 또는 구입하신 대리점에 문의하세요.

차량용 핸즈프리 유니트 (HCJ040FDK)

- 통화중에 휴대폰을 들지 않고 차의 핸들을 잡은 채로 자연스럽게 통화를 할 수 있습니다.
- 차량용 핸즈프리 거치대와 연결해서 사용할 수 있습니다.

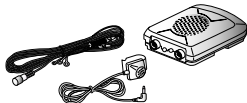

차량용 충전 키트 (CCH016SBK)

- 차량내 시거 잭으로 부터 전원을 공급 받아 휴대폰에 장착된 배터리를 빠른 시간내 충전시켜 주는 장치입니다.

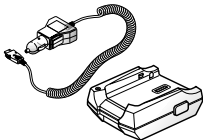

이어 마이크폰

- 전화를 받거나 끊을 때, 최근에 걸었던 번호로 전화 걸 때, 이어 마이크폰의 버튼을 눌러 주면 됩니다.
- 당사가 제공하지 않는 이어마이크폰 구입시용시 품질이 나빠질 수 있으며 이에 대한 책임은 지지 않습니다.
- 이어마이크폰은 목걸이형과 일반형이 있습니다.



PC링크 2000용 CD-ROM

- PC와 휴대폰을 케이블로 연결 하여, PC로 작성된 전화번호등의 데이터를 휴대폰으로 옮기거나 휴대폰의 데이터를 읽어 들여 편집 할 수 있으며 PC와 휴대폰이 연결된 상태에서 PC상에서 직접 전화나 SMS발신등을 할 수 있는 기능입니다.
- 데이터 통신 케이블 구입시 무료로 드리며, 애니콜 홈페이지에서 다운로드 받으실 수 있습니다.

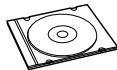

핸즈프리 거치대

- 차량내 휴대폰을 안전하게 걸 수 있도록 해주며 차량용 핸즈프리 유니트와 연결해서 사용할 수 있습니다.

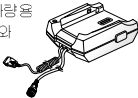

데이터 통신 케이블 (PCB016SBK)

- 휴대폰으로 PC통신, 인터넷 등을 이용할 수 있습니다.

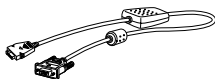

배터리

- 표준형, 대용량 배터리를 추가로 구입하여 사용할 수 있습니다.



여행용 충전기

(TCH016KBK)

- 간편하게 휴대할 수 있는 여행용 충전기입니다.
- 220V 전용입니다.

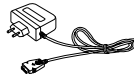



(mm)

(TX) : 1751.25 ~ 1778.75 MHz / (RX) : 1841.25 ~ 1868.75 MHz

: \pm 150 HZ

: 83.5(L) \times 44.5(W) \times 16.8(H)

: 83.5(L) \times 44.5(W) \times 18.8(H)

: 70g / : 79g

240mW

-20 ~ +50

0% ~ 95%



(.)

14

7



1 ()

10			
1			
가	3		
	4		
가	() 가		가
	() 가		가 10% 가



1 ,
6
5

	CDMA 2000		SPH-X1100
		SERIAL NO.	



. (가 가)

	1 2
--	--------

가

(, ,) (, , ,)

SAMSUNG

삼성전자

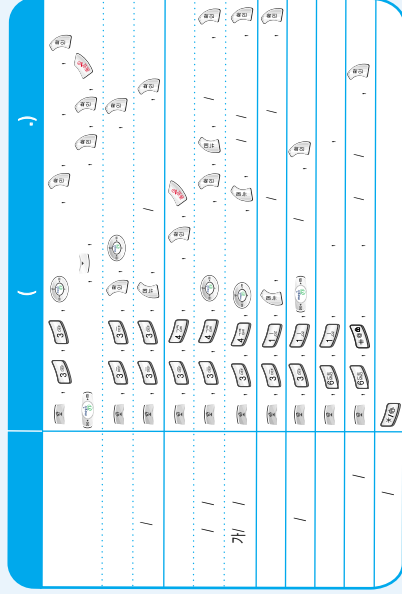
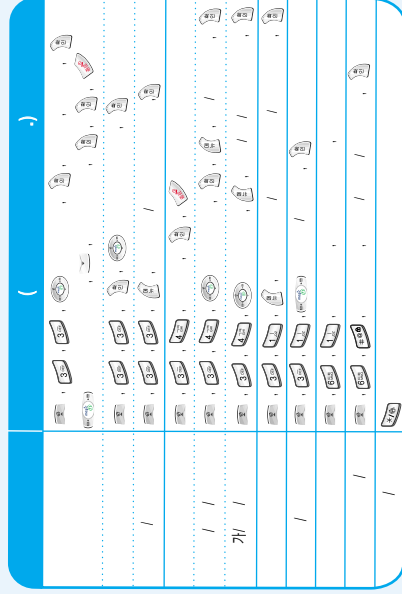

Menu Map

(For Foreigner)

The following illustration shows the start menu structure available and indicates the number assigned to each option.

To access menu mode, press the  or  key.

1. Magic

- 1-1. Magic
- 1-2. Magic Mail
- 1-3. Magic Bookmark
- 1-4. Magic URL
- 1-5. MSN Browser
- 1-6. Option
- 1-7. Display Line Mode (8 Lines/ 9Lines)

2. Phonebook

- 2-1. Search a number (1. by location/2. by name/
3. by number/4. by group/5. by time)
- 2-2. Last dialed numbers
- 2-3. Last received numbers
- 2-4. Add entry
- 2-5. Caller alert (1. Edit number/2. Set number/3. Icon list)
- 2-6. Edit group
- 2-7. Delete all
- 2-#. My own number

3. Organizer

- 3-1. Morning call
- 3-2. Alarm clock
- 3-3. Scheduler
- 3-4. Memo
- 3-5. Calculator
- 3-6. World clock
- 3-7. D-Day Plus
- 3-8. Unit measurement
- 3-9. Timer (1. Call Time/2. Set time & date)

4. Message/ E-mail

- 4-1. Messages (1. Incoming messages/ 2. Outgoing messages/
3. Write preset messages)
- 4-2. E-mail (1. Incoming E-mails/ 2. Write E-mails 3. Outbox/
4. Drafts/ 5.E-mail settings)
- 4-3. Handynet/ Mobile Friend

(For Foreigner)

Menu Map (Continued)

5. Sounds

- 5-1. Alert type
- 5-2. Ring type
- 5-3. Ring volume
- 5-4. Connect tone
- 5-5. Disconnect tone
- 5-6. DTMF tone

6. System

- 6-1. Change password
- 6-2. Automatic Area code
- 6-3. Call barring (1. Privacy/2. Incoming call/3. Overseas call/4. Caller ID)
- 6-4. Backlight (1. Lighting length/2. Lighting setup/3. Service backlight)
- 6-5. Contrast
- 6-6. NAM selection (1. Select phone number/
2. 016 free number/018 two number)
- 6-7. Check PIN
- 6-8. Data service (1. Alert type/2. Auto reception/3. Set transmission rate)
- 6-*.Reset phone
- 6-#. Lock phone

Customizing the Start Menu

You can customize the start menu items by the My phone menu. Press the  key. You will be accessed to the start menu with the My phone menu.

My phone (No number mapped)

- 1. Set start menu
- 2. Set menu screen (1. Menu icon/2. Menu order/
3. Pop-up menu box/4. Icon list)
- 3. Set my name
- 4. Scroll text
- 5. Animation (1. Standby mode/2. Incoming call/
3. Magic connection/4. Power-on/5. Power-off/
6. Delete Image)
- 6. Delete start menu
- 7. Reset start menu

In-Call Options

To access these functions during a call, press the  key.

1. Phonebook

- 1-1. Search a number (1. by location/2. by name/
3. by number/4. by group/
5. by time)
- 1-2. Last dialed numbers
- 1-3. Last received numbers
- 1-4. Add entry
- 1-5. Caller alert (Not supported during a call)
- 1-6. Edit group (Not supported during a call)
- 1-7. Delete all (Not supported during a call)
- 1-#. My own number

2. Messages

- 2-1. Incoming messages (1. Voice mail/2. Text messages/
3. Message alert/4. Message display)
- 2-2. Outgoing messages (1. Send message/2. Page/
3. Name card/4. Outbox)
- 2-3. Write preset messages
- 2-4. Handynet/ Mobile Friend

3. Switching microphone off(on)

4. Muting (Sending) key tone

5. Sending own number

: Sending DTMF dialing

Amplifying the transmitted signal

Press and hold  during a call.

To set this feature off, press and hold  once again.

Or, this feature will be automatically off when you end the call.

MEMO

SPH-X1100 Quick Reference Card

Function	Press in sequence
Alert Type	[5:2], [1:1], (Choose), [1:1]
Ring Type	[5:2], [2:2], (Choose), [1:1], (Choose), [1:1]
Ring Volume	[5:2], [3:2], [1:1] / [1:1] (Adjust), [1:1]
Earpiece Volume	During Conversation [1:1] / [1:1] (Adjust)
Key Tone Volume	[1:1] / [1:1] (Adjust)
Call Last Numbers Dialed	[2:2], [2:2], (Choose), [1:1]
Store in Memory	[4:2], Name, [1:1], Number / Location / E-mail / Group / Memo, [1:1]
Scan Memory	Hold [1:1], (Choose), [1:1]
Dial by Memory location	000009: Press and hold the last digit only 010-999: Press the first two digits briefly, and hold the last digit
Customizing the Start Menu	[1:1], (Choose), [1:1], (Choose a Menu), [1:1], (Choose a function), [1:1], (Choose a location), [1:1], (Choose a icon), [1:1]



SPH-X1100 Quick Reference Card

Function	Press in sequence
Alert Type	[5:2], [1:1], (Choose), [1:1]
Ring Type	[5:2], [2:2], (Choose), [1:1], (Choose), [1:1]
Ring Volume	[5:2], [3:2], [1:1] / [1:1] (Adjust), [1:1]
Earpiece Volume	During Conversation [1:1] / [1:1] (Adjust)
Key Tone Volume	[1:1] / [1:1] (Adjust)
Call Last Numbers Dialed	[2:2], [2:2], (Choose), [1:1]
Store in Memory	[4:2], Name, [1:1], Number / Location / E-mail / Group / Memo, [1:1]
Scan Memory	Hold [1:1], (Choose), [1:1]
Dial by Memory location	000009: Press and hold the last digit only 010-999: Press the first two digits briefly, and hold the last digit
Customizing the Start Menu	[1:1], (Choose), [1:1], (Choose a Menu), [1:1], (Choose a function), [1:1], (Choose a location), [1:1], (Choose a icon), [1:1]



Function	Press in sequence
Create Schedule	, , , (Choose Date), , Time, Event Choose Alarm, , Choose Ring Tone,
View Schedule	, , , (Choose Date),
Add/Delete Schedule	, , , , Choose New Schedule/ All Schedule Delete,
Create Memo	, , , Memo ,
View/Edit/Delete Memo	, , , (Choose a memo), , , Choose Edit/Delete,
Add/Delete/Delete All Memo	, , , (Choose a memo), , Choose New Memo/Delete/ All Delete,
Set Up Morning Call	, , , , , Choose Time/Melody/Morning Call On,
Morning Call On/Off	, , , Choose Set/Cancel
Change Password	, , , Password, New Password, New Password
Auto lock On/Off	, , , Password, Choose Auto lock/ Hand lock/ Off,
Manner Mode On/Off	Press and Hold

Function	Press in sequence
Create Schedule	, , , (Choose Date), , Time, Event Choose Alarm, , Choose Ring Tone,
View Schedule	, , , (Choose Date),
Add/Delete Schedule	, , , , Choose New Schedule/ All Schedule Delete,
Create Memo	, , , Memo, ,
View/Edit/Delete Memo	, , , (Choose a memo), , , Choose Edit/Delete,
Add/Delete/Delete All Memo	, , , (Choose a memo), , Choose New Memo/Delete/ All Delete,
Set Up Morning Call	, , , , , Choose Time/Melody/Morning Call On,
Morning Call On/Off	, , , Choose Set/Cancel
Change Password	, , , Password, New Password, New Password
Auto lock On/Off	, , , Password, Choose Auto lock/ Hand lock/ Off,
Manner Mode On/Off	Press and Hold

Serial Number)가 (ESN : Electronic

10 , 2,000 347

가 가

1.

2.

1.

2.

가

()

Licensed by QUALCOMM Incorporated under one or more
of the following Patents.

U.S. Patent No. 4,901,307 5,056,109 5,099,204
5,101,501 5,103,459 5,107,225
5,109,390

삼성전자주식회사

■ 경북 구미시 임수동 94-1번지



에니콜 A/S 문의

전국 어디서나 1588-7285
(처리바로)

제품 모델명, 고장상태, 연락처를 정확히 알려주시면 고객 여러분의
궁금증을 언제나 친절하게 상담, 빠른 서비스를 제공합니다.

서비스 사업자 관련 문의

(부가서비스 이용안내, 통화요금 등)

휴폰로 114 (무료)

● 사용설명서의 내용은 휴대폰의 소프트웨어 버전 또는 이동통신 사업자의
사정에 따라 다를 수 있으며, 사용자에게 통보없이 일부 변경될 수 있습니다.



고객상담실

서울 02-541-3000, 080-022-3000

부산 051-861-3000, 080-051-3000



PC통신

PC통신 (삼성전자 기업 포럼)

GO SEC(유니텔, 천리안, 하이텔, 나우누리, 넷츠고)



인터넷 홈페이지

<http://www.sec.co.kr>

<http://www.anycall.com>



AS마크란? 사후봉사가 우수한 기업에 대해 국가기관인
국립기술품질원이 품질을 보증하는 인증마크입니다.