

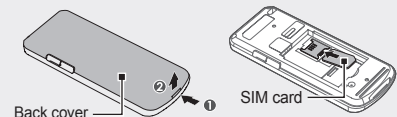

## Install the SIM card and battery

- Remove the back cover and insert the SIM card.



- Insert the battery and replace the back cover.

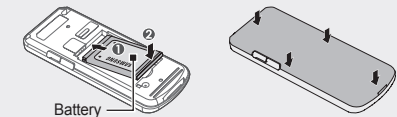

## Charge the battery

- Plug the supplied travel adapter.
- When charging is finished, unplug the travel adapter.



Do not remove the battery before removing the travel adapter. Doing this may cause damage to the device.

## Change your ringtone



- In Menu mode, select **Settings** → **Profiles**.
- Scroll to the profile you are using.

If you are using the silent, meeting, or offline profile, you are not allowed to change the ringtone.

- Press **<Options>** → **Edit**.
- Select **Call ringtone**.
- Select a ringtone.

To switch to another profile, select it from the list.

## Instructional icons

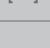
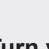
	<b>Note:</b> notes, usage tips, or additional information
	<b>Followed by:</b> the order of options or menus you must select to perform a step; for example: In Menu mode, select <b>Messages</b> → <b>Create message</b> (represents <b>Messages</b> , followed by <b>Create message</b> )
	<b>Square brackets:</b> phone keys; for example: [ <b>Power</b> ] (represents the Power/End key)
	<b>Angled brackets:</b> softkeys that control different functions at each screen; for example: <b>&lt;OK&gt;</b> (represents the OK softkey)

## Turn your phone on or off

To turn your phone on,

- Press and hold [**Power**].
- Enter your PIN and press **<OK>** (if necessary).

To turn your phone off, repeat step 1 above.

## Access menus

To access your phone's menus,

- In Idle mode, select **<Menu>** to access Menu mode.

You may need to press the Confirm key to access Menu mode depending on your region or service provider.

- Use the Navigation key to scroll to a menu or option.
- Press **<Select>**, **<OK>**, or the Confirm key to confirm the highlighted option.
- Press **<Back>** to move up one level; Press [**Power**] to return to Idle mode.

When you access a menu requiring the PIN2, you must enter the PIN2 supplied by the SIM card. For details, contact your service provider. Samsung is not responsible for any loss of passwords or private information or other damages caused by illegal software.

## Make a call

- In Idle mode, enter an area code and a phone number.
- Press [**Call**] to dial the number.
- To end the call, press [**End**].

The volume through mono earphones is very low or virtually inaudible. Use stereo earphones only.

## Call a recently dialled number

- In Idle mode, press [**Call**].
- Scroll left or right to a call type.
- Scroll up or down to a number or name.
- Press the Confirm key to view details of the call or [**Call**] to dial the number.

## Answer a call

- When a call comes in, press [**Call**].
- To end the call, press [**End**].

## Adjust the volume

### To adjust the volume of the ringtone

- In Menu mode, select **Settings** → **Profiles**.
- Scroll to the phone profile you are using.

If you are using the silent profile, you are not allowed to adjust the volume of the ringtone.

- Press **<Options>** → **Edit**.
- Select **Volume** and scroll to **Call alert**.
- Scroll left or right to adjust the volume level.
- Press **<Save>**.

### To adjust the volume of voice during a call

While a call is in progress, press the Navigation key up or down to adjust the volume.

In noisy environments, you may have difficulty hearing the calls while using the speakerphone feature. For better audio performance, use the normal phone mode.

## Change your ringtone

- In Menu mode, select **Settings** → **Profiles**.
- Scroll to the profile you are using.

If you are using the silent, meeting, or offline profile, you are not allowed to change the ringtone.

- Press **<Options>** → **Edit**.
- Select **Call ringtone**.
- Select a ringtone.

To switch to another profile, select it from the list.

## Use the shortcut toolbar

You can use the shortcut toolbar to access your favourite menus.

### To add menus on the shortcut toolbar

- In Menu mode, select **Settings** → **Display** → **Shortcuts toolbar**.
- Press **<Options>** → **Edit**.
- Select your favourite menus.
- Press **<Options>** → **Open** to select submenus (if necessary).
- Press **<Save>**, or press **<Options>** → **Save**.

### To access a menu from the shortcut toolbar

In Idle mode, scroll left or right to the menu you want and press the Confirm key.

When the shortcut toolbar is activated, the Navigation key does not work as shortcuts depending on your region.

## Enter text

### To change the text input mode

- Press and hold [**#**] to switch between T9 and ABC modes. Depending on your country, you may be able to access an input mode for your specific language.
- Press [**#**] to change case or switch to Number mode.
- Press [**\***] to switch to Symbol mode.
- Press and hold [**\***] to select an input mode or change the input language.

### T9 mode

- Press the appropriate alphanumeric keys to enter an entire word.
- When the word displays correctly, press [**0**] to insert a space. If the correct word does not display, press the Navigation key up or down to select an alternate word.

### ABC mode

Press an appropriate alphanumeric key until the character you want appears on the display.

### Number mode

Press an appropriate alphanumeric key to enter a number.

### Symbol mode

Press an appropriate alphanumeric key to enter a symbol.

To move the cursor, press the Navigation key. To delete characters one by one, press **<Clear>**. To delete all of the characters, press and hold **<Clear>**. To insert a space between characters, press [**0**]. To enter punctuation marks, press [**1**].

## Add a new contact

The memory location to save new contacts may be preset depending on your service provider. To change the memory location, in Menu mode, select **Settings** → **Application** → **Contacts** → **Save new contact to** → a memory location.

- In Idle mode, enter a phone number and press **<Options>**.
- Select **Create contact**.
- Select a number type (if necessary).
- Enter contact information.
- Press the Confirm key to add the contact to memory.

## Activate the mobile tracker

This feature helps track your phone when it is stolen or when someone tries to use your phone using other SIM card, the phone will automatically send the preset tracking message to family or friends. This feature may be unavailable due to certain features supported by your service provider.

- In Menu mode, select **Settings** → **Security** → **Mobile tracker**.
- Enter your password and select **OK**.

The first time you access Mobile tracker, you will be prompted to create and confirm a password.

- Scroll left or right to **On**.
- Scroll down and press the Confirm key to open the recipient list.
- Press the Confirm key to open your contact list.
- Select a contact.
- Select a number (if necessary).
- Press **<Options>** → **Save** to save the recipients.
- Scroll down and enter the sender's name.
- Press the Confirm key → **<Accept>**.

## Activate and send an SOS message

In an emergency, you can send SOS messages to your family or friends for help.

### To activate the SOS message

- In Menu mode, select **Messages** → **Settings** → **SOS messages** → **Sending options**.
- Scroll left or right to **On**.
- Scroll down and press the Confirm key to open the recipient list.
- Press the Confirm key to open your contact list.
- Select a contact.
- Select a number (if necessary).
- When you are finished selecting contacts, press **<Options>** → **Save** to save the recipients.
- Scroll down and set the number of times to repeat the SOS message.
- Press **<Save>** → **<Yes>**.

### To send an SOS message

- With the keys locked, press [**Power**] four times to send an SOS message to preset numbers. The phone switches to SOS mode and sends the preset SOS message.
- To exit SOS mode, press [**Power**].

## Set and use alarms

### To set a new alarm

- In Menu mode, select **Alarms**.
- Select an empty alarm location.
- Set alarm details.
- Press **<Save>**, or press **<Options>** → **Save**.

### To stop an alarm

When the alarm sounds,

- Press **<OK>** or the Confirm key to stop the alarm without snooze.
- Press **<OK>** or the Confirm key to stop the alarm with snooze, or press **<Snooze>** to silence the alarm for the snooze period.

### To deactivate an alarm

- In Menu mode, select **Alarms**.
- Select the alarm you want to deactivate.
- Scroll left or right to **Off**.
- Press **<Save>**.

If the battery has been removed, the scheduled alarm may not sound.

SAMSUNG ELECTRONICS	
<b>Declaration of Conformity (R&amp;TTE)</b>	
We, <b>Samsung Electronics</b>	
declare under our sole responsibility that the product	
<b>GSM Mobile Phone : GT-E1050</b>	
to which this declaration relates, is in conformity with the following standards and/or other normative documents.	
SAFETY	EN 60950-1 : 2006+A11:2009
EMC	EN 301 489-01 V1.8.1 (04-2008) EN 301 489-07 V1.3.1 (11-2005)
SAR	EN 50360 : 2001 EN 62209-1 : 2006
RADIO	EN 301 511 V9.0.2 (03-2003)
We hereby declare that [all essential radio test suites have been carried out and that] the above named product is in conformity to all the essential requirements of Directive 1999/5/EC.	
The conformity assessment procedure referred to in Article 10 and detailed in Annex[IV] of Directive 1999/5/EC has been followed with the involvement of the following Notified Body(ies):	
BABT, Forsyth House, Churchfield Road, Walton-on-Thames, Surrey, KT12 2TD, UK* Identification mark: 0168	
The technical documentation kept at : <b>Samsung Electronics QA Lab.</b>	
which will be made available upon request. <i>(Representative in the EU)</i> Samsung Electronics Euro QA Lab. Blackbushe Business Park, Saxony Way, Yateley, Hampshire, GU46 6GG, UK*	
2010.11.18	 Joong-Hoon Choi / Lab Manager (name and signature of authorised person)
* It is not the address of Samsung Service Centre. For the address or the phone number of Samsung Service Centre, see the warranty card or contact the retailer where you purchased your product.	