

DACOM



Model:S016
FCC ID:WTDS016

<http://www.china-dacom.com/>

EN

Preface

Dear Customer

Thank you for choosing Our Bluetooth Headset. Please read the user manual carefully for proper instruction to maximize the advantage of our product. Our Bluetooth headset is well designed fashionably, smart and portable, pure acoustic and multi functional. We have patents for the whole series of our Bluetooth headsets. Our Bluetooth headsets are applied with the top advanced electro acoustic technology, providing you the best enjoyment of music any time at home, outdoor or business situation, and provide the perfect acoustic with your notebook and any digital audiovisual devices. Leading you to wonderful music!

Precautions / Tips

Cautions

- Please keep or use this product at normal temperature;
- Do not expose this product in rain or moisture;
- Do not throw this product in case any damage thus made;
- Do not disassemble, repair or reform this product;
- Do not clean this product with any chemical solvents;
- Please use USB power of DC5V for output when needed;
- Do not throw away or put it in fire to avoid any danger.

Unified national service hotline:
400-881-0138

Product Description

Item: Bluetooth Headset
Bluetooth standard:V4.1
Charging means:power adapter output(DCSV 120mA)
Battery:High-capability rechargeable Lithium polymer battery
Bluetooth Operation:class 2
Bluetooth Mode:Headset/Handsfree/A2DP/AVRCP
Talk time: up to 4 hours
Playing time: up to 4 hours
Stand by time: 100 hours

- This product can accept audio file from any Bluetooth devices like Bluetooth mobile phones, Bluetooth notebooks...
- When being connected to Bluetooth DONGLE on PC, it can play any audio files on the computer. You can use it for voice chat to achieve wireless QQ,MSN,SKYPE.

Product schematic

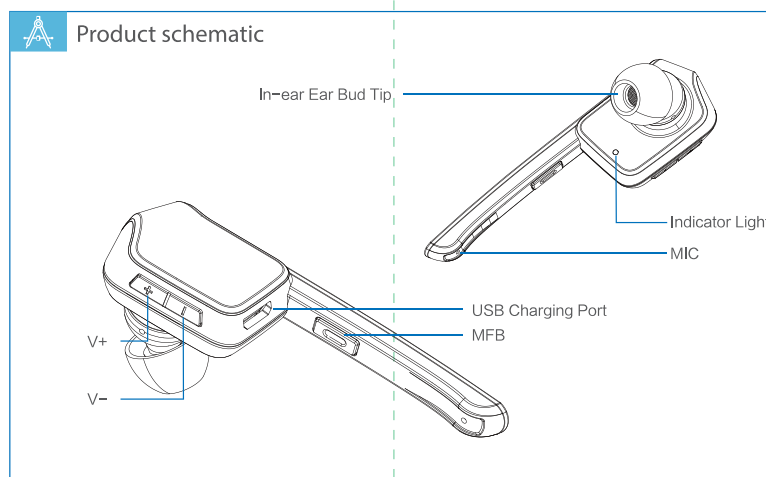

Features

- ⏻ Power on-Press and hold the "MFB" for about 2 seconds until the blue indicator light flashes.
Power off-With the headset power on, long press the "MFB" for about 3 seconds, the indicator light goes off.
- ☎ Answering a call-Press the answer key on your phone; Short press the "MFB" on your headset.
- 📞 Ending a call-Press the end key on your phone; Short press the "MFB" on your headset.
- 📞 Rejecting a call-Press the end key on your phone; Long press the "V-" for about 2 seconds on your headset.
- 📞 Redialing the last called number-Double press the "MFB" when headset is in standby mode.
- ⏸ Play / Pause-When you are listening to the music from the headset, you can short press the MFB button to play and pause.
- ⏮ Previous/Next Track Selection-When listening to the music, long press "V+" for about 2 seconds to previous track, long press "V-" for about 2 seconds to next track.
- 🔊 Volume control-Short press the "V+" to increase volume, short press the "V-" to decrease volume.

Features

- 📞 Voice dialing-On the status of standby, long press the "MFB" for about 2 seconds (Your phone must support this function)
- ☎ Call switching-Long press the "V+" for about 2 seconds during a call, re-press for recovery.
- 🔇 Muting-Long press the "V-" for about 2 seconds during a call, re-press for recovery.
- 🔋 Low power alarm-There will be low power alarm when the voltage is lower than 3.3V,The headset will be power off when the voltage is lower than 3V.
- 📶 Pairing steps
 - Keep the Bluetooth headset and your phone within 1 meter when pairing at the first time.
 - With the headset power off, long press the "MFB" for about 5 seconds until the headset is in pairing mode, red light and blue light flash alternately.
 - Set the phone to search for Bluetooth device.
 - When the list of detected devices appears, select "UCOMX" Enter pin code "0000" if needed.
 - Repeat above steps if the pairing failed.
 - Blue light flashes when pairing is done.

Features

- 📶 Twin-Link connection
 - Follow the instruction to pair with the first mobile phone, and disable phone Bluetooth function, then pair with the second mobile phone.
 - Active the Bluetooth function of the first mobile phone, manual connect with the first mobile phone.
 - During a call, short press the "MFB" to end current call and answer waiting call.
 - Double press the "MFB" to answer the second call and switching between two calls.
 - Short press the "MFB" to end the call one by one.
- ⚠ Tips: When two phones simultaneously connected to a Bluetooth headset, some functions will be restricted.
- 🔋 Charging
 - Your headset uses a rechargeable battery, you must charge the battery fully before using the headset for the first time.
 - Plug the charging cable in the charging port.
 - The red indicator light remains solid when charging.
 - The fully charging takes about 3 hours.
 - The red indicator light goes out and the blue indicator light remains solid when charging completed.
- 📞 Voice Prompts-There will be the voice prompt "Power on", "Power off", "your headset is connected", "Battery low" when using the headset

Handling of the Waste Electrical

The waste Electrical

This marking shown on the product or its literature indicates that it should not be disposed with other household wastes at the end of its working life.

To prevent possible harm to the environment or human health from uncontrolled waste disposal, please separate this from other types of wastes and recycle it responsibly to promote the sustainable reuse of material resources.

Household user should contact either the retailer where they purchased this product or their local government office, for details of where and how they can take this item for environmentally safe recycling.

Business users should contact their supplier and check the terms and conditions of the purchase contract. This product should not be mixed with other commercial wastes for disposal.



Services Hot Line: 400-881-0138

Services time: AM 9:00 - PM 6:00
Monday to Saturday (holiday is exclusive)

Service Regulations and Explanation

After service

(A) Service system

- 1.Consultancies: Please read this user manual carefully before using this product. For any problem during using it, you can either contact the local retailer or call our customer service Hot Line: **400-881-0138**
- 2.Exchange service: within exchange time limit, for any indeliberate error during proper use, making sure the product as well as its accessories and package are all not damaged (if the appearance is damaged, it can only be repaired) you can either have it exchanged for a new one or repaired after the error is tested and examined;
- 3.Warranty service: within the warranty time limit, for any indeliberate error that occurs during proper use, warranty service is free for no charge (the headphone has warranty service for free within one year; for any deliberate damage, the warranty service should be paid).
- 4.Charged warranty service: within three years counting from one year after the date the product was purchased, any error repair will be charged; and user should pay the repair components, freight and labor cost.

5.Any of the below situation is not in the warranty service, but we provide charged service:

- ① The warranty date is expired;
- ② The warranty card is altered, or the series number differs from that of the product;
- ③ Accidental or deliberate damage is done to the product (for example: improper use against the user manual, improper set up which causes error, plugging in unmatched power, exposed to water, fallen etc.)
- ④ cannot provide valid warranty card or invoice (other but can prove that it is within the service limit);
- ⑤ Any error damage caused by force majeure such as earthquake, fire, flood, lightning strike etc.
- ⑥ Deliberate assembling, repair or reform without permission from our company.

(B) Explanation of After Service:

- 1.The date of purchased should be in accordance with that of the invoice, any failure to provide the valid proof, is subjected to the production date.
- 2.Quality problem does not include user's personal preference to tone and timbre.
- 3.The shell and user manual package are exclusive to warranty service.
- 4.For the model that production has been stopped, we only provide functional repair.
- 5.We are not responsible for any promises by retailer other than our company.

NOTE: This equipment has been tested and found to comply with the limits for a Class B digital device, pursuant to part 15 of the FCC Rules. These limits are designed to provide reasonable protection against harmful interference in a residential installation. This equipment generates, uses and can radiate radio frequency energy and, if not installed and used in accordance with the instructions, may cause harmful interference to radio communications. However, there is no guarantee that interference will not occur in a particular installation. If this equipment does cause harmful interference to radio or television reception, which can be determined by turning the equipment off and on, the user is encouraged to try to correct the interference by one or more of the following measures:

- Reorient or relocate the receiving antenna.
- Increase the separation between the equipment and receiver.
- Connect the equipment into an outlet on a circuit different from that to which the receiver is connected.
- Consult the dealer or an experienced radio/TV technician for help.

This device complies with part 15 of the FCC rules. Operation is subject to the following two conditions:

- (1) this device may not cause harmful interference, and
- (2) this device must accept any interference received, including interference that may cause undesired operation.

Changes or modifications to this unit not expressly approved by the party responsible for compliance could void the user's authority to operate the equipment.