

The Savant Wireless RF Gateway (RFG-2000) Quick Reference Guide provides the information necessary to setup and operate the Savant Select Remote. After the Savant remotes are configured in RacePoint Blueprint, the remote will automatically find and communicate (Synch) with the nearest RFG-2000.

Box Contents

- (1) Savant Wireless RF Gateway (RFG-2000-xx)
- (1) Sheet metal Mounting Bracket (071-0664-xx)
- (1) 5V DC 2.5 AMP Universal Wall Unit with universal wall clips (025-0098-xx)
- (2) 2.2mm x 8mm screws (039-0205-xx)
- (1) Quick Reference Guide (this document)



Specifications

Environmental	
Operating Temperature	32° to 104° F (0° to 40° C)
Operating Humidity	5% to 95% Non-condensing
Physical	
Dimensions (L x W x D)	1.75 in x 2.12 in x 0.95 in (4.44 cm x 5.38 cm x 2.41 cm)
Weight	0.4 oz (0.0113 kg)
Enclosure	High-impact molded ABS plastic
Power	
Power	5V DC 7.5 AMP
Communication	
Wireless	RF Transceiver, Frequency (Spectrum) - ISM Band (2.4 GHz to 2.483 GHz)*
Regulatory	
Safety and Emissions	CE/FCC Part 15/C-Tick*
RoHS	Compliant

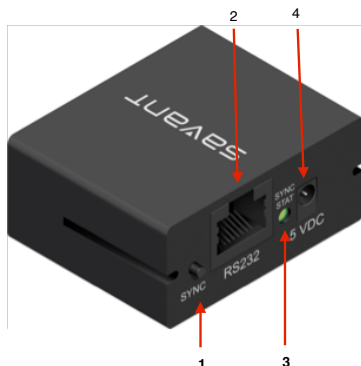

1	SYNC	Press to Reset RFG-2000
2	RS232	RJ-45 used to receive and transmit data transmission
3	SYNC STAT	Green indicates the system has adequate power and is operating normally. Off indicates that the system is getting no power.
4	5 VDC	5V DC power connector used to supply power to the RFG-2000

Installation

1. Screw mast antenna to RFG-2000 box.
2. Screw mounting bracket at desired location.
3. Snap RFG into mounting bracket (See below).
4. Plug in 5V DC power supply.

For surface mounting, the RFG-2000 can be inserted into the sheet metal mounting bracket that is shipped with the product. See below for installation instructions.

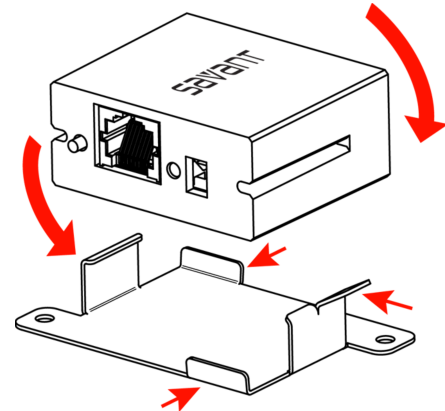

Additional Documentation

For more documentation, go to SavantSystems.com and navigate as follows:

- >Dealer Login > Knowledge Base > Products
 - Refer to **RacePoint Blueprint™ Programming Guide**

Compliance Information

This device is a composite device consisting of a Class B digital device and an intentional radiator that complies with Part 15 of the FCC Rules. Operation is subject to the following two conditions: (1) this device may not cause harmful interference, and (2) this device must accept any interference received, including interference that may cause undesired operation.

Any changes or modifications of this product, not approved by manufacturer will void the user's authority to operate the equipment.

This device complies with Industry Canada license-exempt RSS standard(s). Operation is subject to the following two conditions: (1) this device may not cause interference, and (2) this device must accept any interference, including interference that may cause undesired operation of the device.

Le présent appareil est conforme aux CNR d'Industrie Canada applicables aux appareils radio exempts de licence. L'exploitation est autorisée aux deux conditions suivantes : (1) l'appareil ne doit pas produire de brouillage, et (2) l'utilisateur de l'appareil doit accepter tout brouillage radioélectrique subi, même si le brouillage est susceptible d'en compromettre le fonctionnement.

Under Industry Canada regulations, this radio transmitter may only operate using an antenna of a type and maximum (or lesser) gain approved for the transmitter by Industry Canada. To reduce potential radio interference to other users, the antenna type and its gain should be so chosen that the equivalent isotropically radiated power (e.i.r.p.) is not more than that necessary for successful communication.

This radio transmitter (10052A-RFG2000) has been approved by Industry Canada to operate with the antenna types listed below with the maximum permissible gain and required antenna impedance for each antenna type indicated. Antenna types not included in this list, having a gain greater than the maximum gain indicated for that type, are strictly prohibited for use with this device.

Approved Antenna for the RFG-2000:
Antenna 2.4GHz Rubber Antenna (Part Number: 014-0098-00)