

Cancel

Translator Setup

Begin Translator setup

- 1 Check to make sure your Translator is plugged into the wall outlet and hold reset button for more than 3 seconds.
- 2 Go to your WiFi settings in system settings and select the device with name CbyGE-XXX.f Make sure your system is above iOS 9.0.
- 3 Connect your Translator to your wifi settings (only support 2.4Gz WiFi Channel)
- 4 Return to this screen.

I have connected

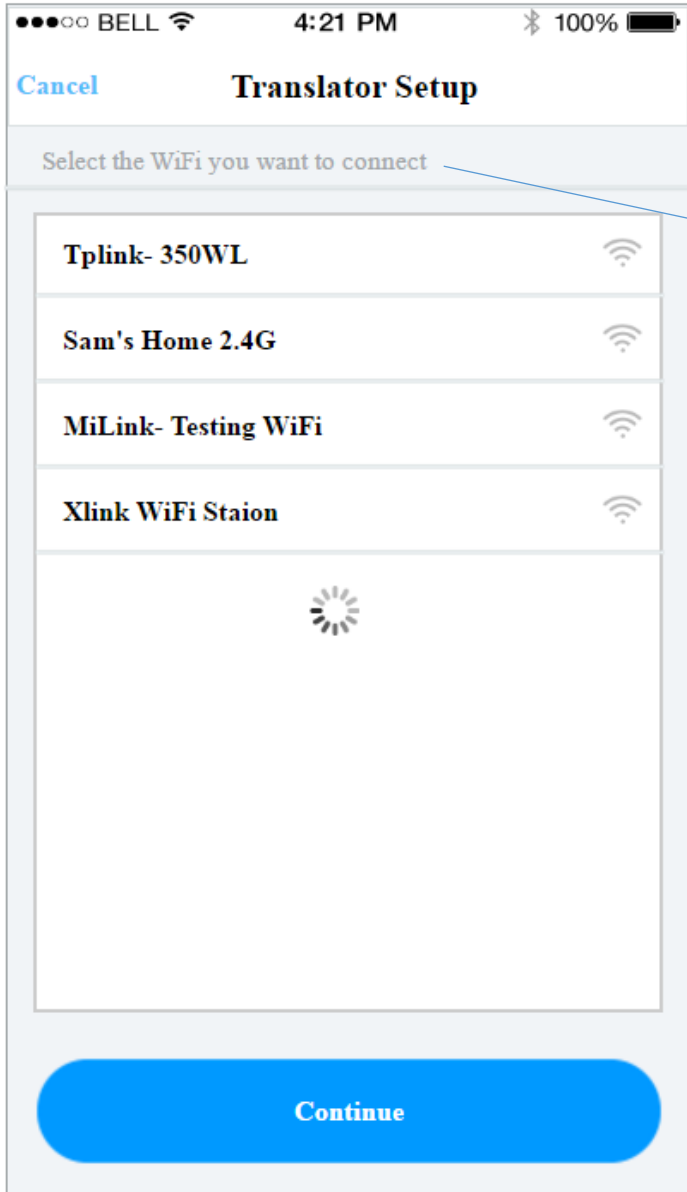

Update grammar to the following

Select the WiFi Network you want to connect to

iOS & Anroid

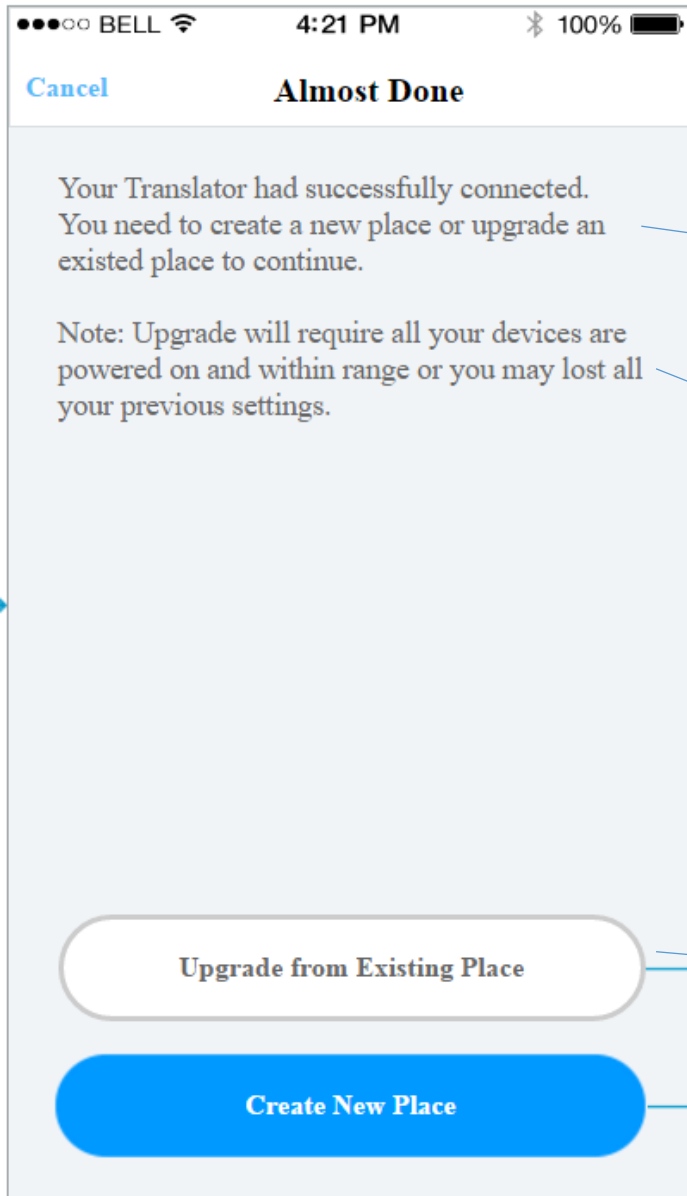

Update grammar to the following

Your reach device has successfully connected. You need to add the device to an existing place or create a new place to continue.

Note: When adding to an existing place, please ensure ALL other devices associated with this place are powered ON and within range. Failure to do so will result in loss of previously saved settings.
(i.e. lost schedule, bulb color, etc.)

Add to Existing Place

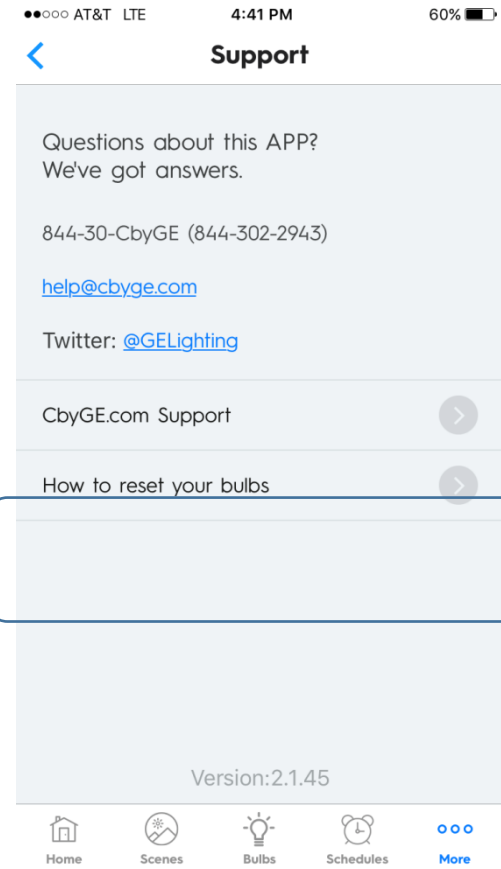
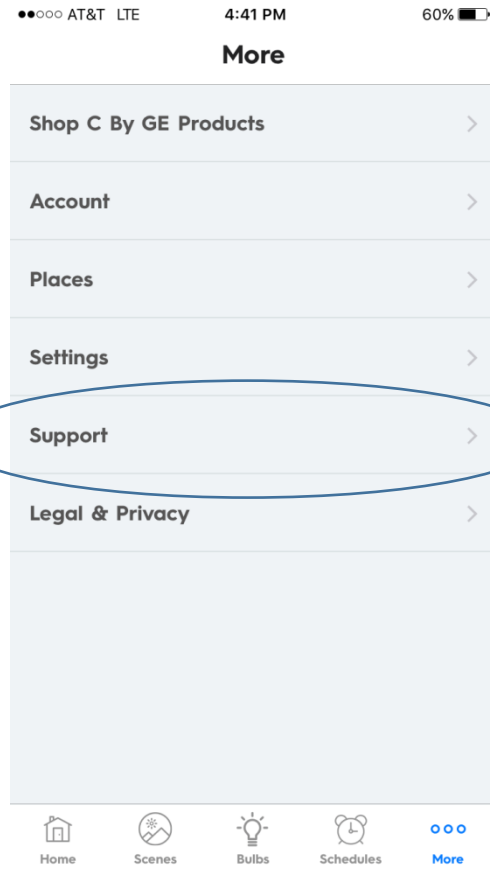
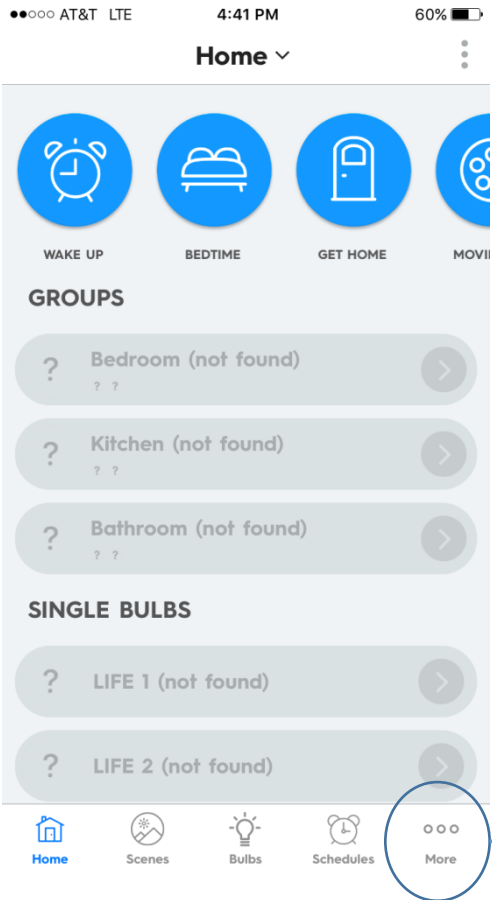

reach device support



reach Device Support

With the App:

1. Navigate to the Home tab | click on |
2. Click "Add New Bulb(s)"

OR

With the Translator:

Press the button on the Translator for less than 1 second

- 1) Navigate to the Home tab and click on 
- 2) Click "Add New Bulb(s)"

- 1) Make sure the reach device is paired to the correct network
- 2) Press and release the button on the side of the reach device
- 3) Once you see the LAN LED flashing, the hub has started adding devices
- 4) Please wait a few moments while devices are added

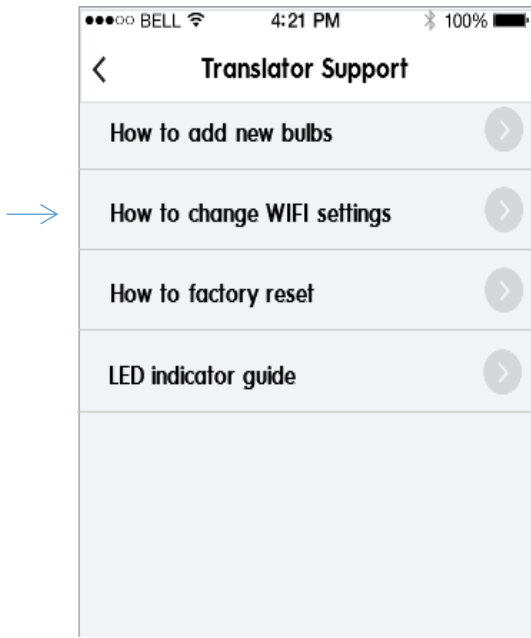

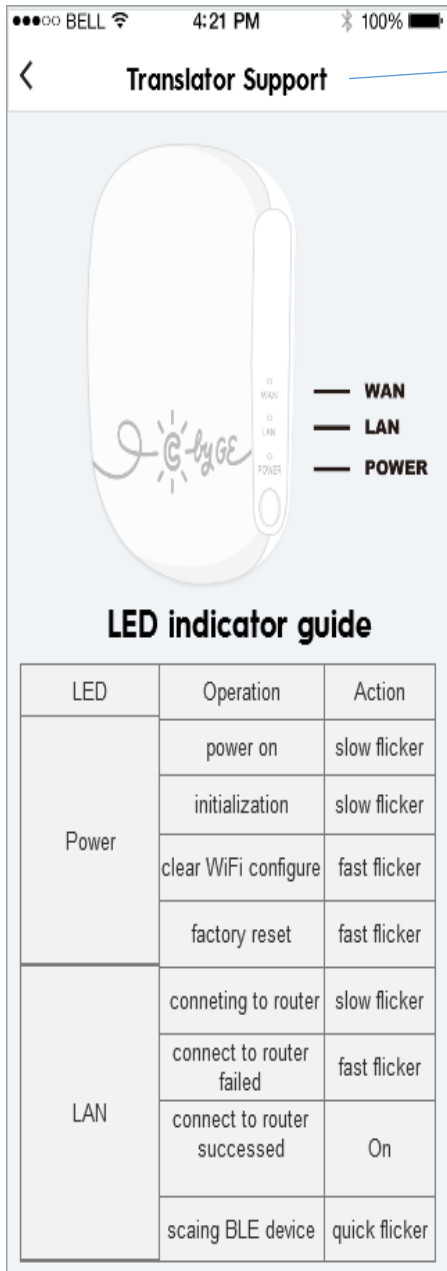

向下滑动

Scroll Down

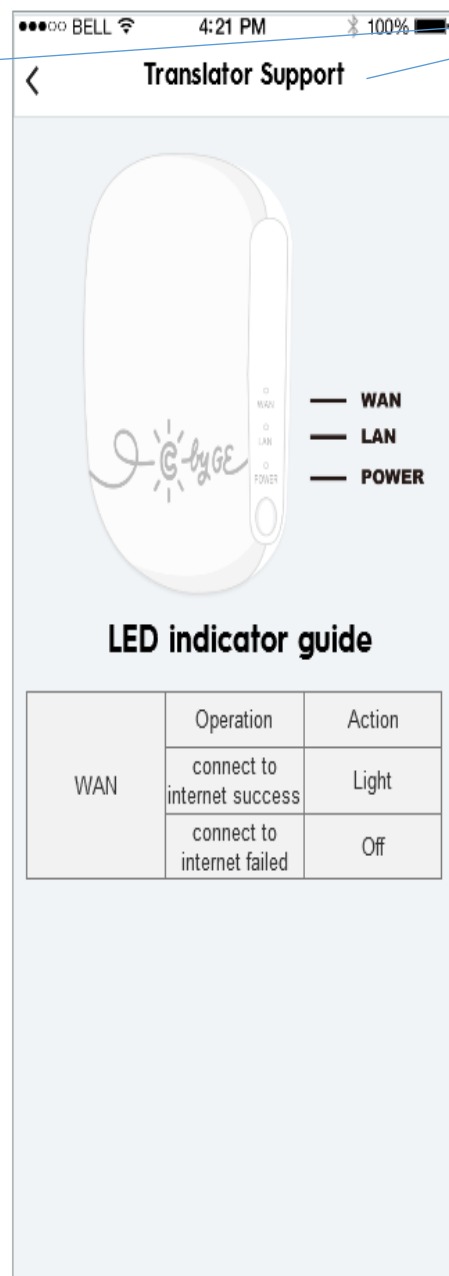

reach Device Support

LED	Operation	Action
Power	power on/initialization	slow flash
	config/reset	fast flash
LAN	connecting to router	slow flash
	connection fail	fast flash
	connection success	steady on
WAN	scanning devices	quick flash
	connection fail	steady off
	connection success	steady on

Action	Description
slow flash	0.5 Hz
quick flash	1.5 Hz
fast flash	5.0 Hz

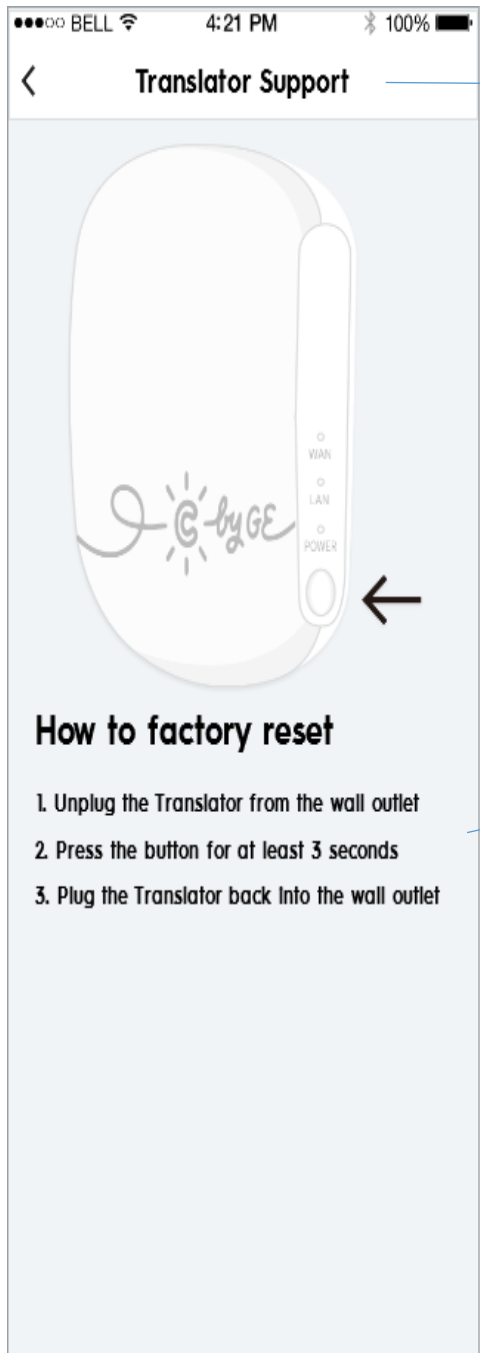

reach Device Support

1. Unplug the reach device from the wall outlet
2. While holding the button on the reach device, plug it back into the wall and continue holding the button for at least 3 seconds
3. Note: All 3 LEDs will start flashing once reach device has been reset