

SCHLAGE®

Installation Instructions

CM 5600 Series Heavy Duty Electronic Mortise Lock With Modular Access Control

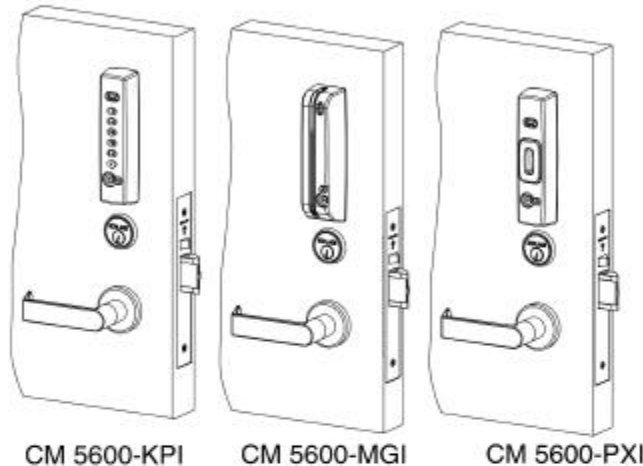

DESCRIPTION:

The Schlage CM 5600 Modular Lock is an electronic motor-driven (standard) or solenoid-operated (FSE-Fail Secure/FSA-Fail Safe) mortise lock set with access control.

The lock is mounted into the door and the access control credential reader is mounted on the face of the door. The electronic controller is mounted securely onto the inside of the door.

ITEM:	DESCRIPTION:
1	5696 LATCH MORTISE LOCK FSE/FSA 5695 ROLLER-BOLT MORTISE LOCK FSE/FSA 5694 AUTOBOLT MORTISE LOCK FSE/FSA
2	SPINDLE/SPRING(2)
3	ARMOR FRONT/SCREWS
4	SPRING CAGE (2)
5	MOUNTING PLATE
6	MOUNTING POSTS
7	OUTSIDE ROSE/HANDLE ASSY.
8	INSIDE ROSE
9	INSIDE HANDLE ASSY.
10	EVEREST CYLINDER/CAM
11	COMPRESSION RING
12	BLOCKING RING
13	COMBINATION SCREW PACK
14	MOUNTING SCREW PACK
15	INSIDE ESCUTCHEON/SCREWS
16	OUTSIDE ESCUTCHEON
17	LOCK HANDING SCREW
N/A	STRIKE/BOX/SCREWS
N/A	WIRING HARNESS KIT

LEVER DESIGNS:

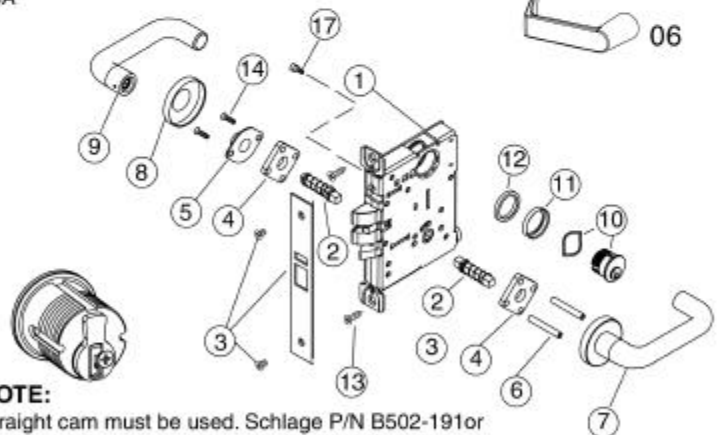
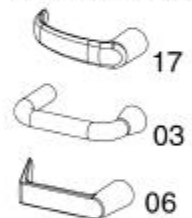

NOTE:

Straight cam must be used. Schlage P/N B502-191 or equivalent (for standard cylinder) or P/NB502-948 (for Everest cylinder - shown).

NOTE: Changes or modifications not expressly approved by the party responsible for compliance could void the user's authority to operate the equipment.

IR Security & Safety

Locknetics
On Board

DOOR PREPARATION

1

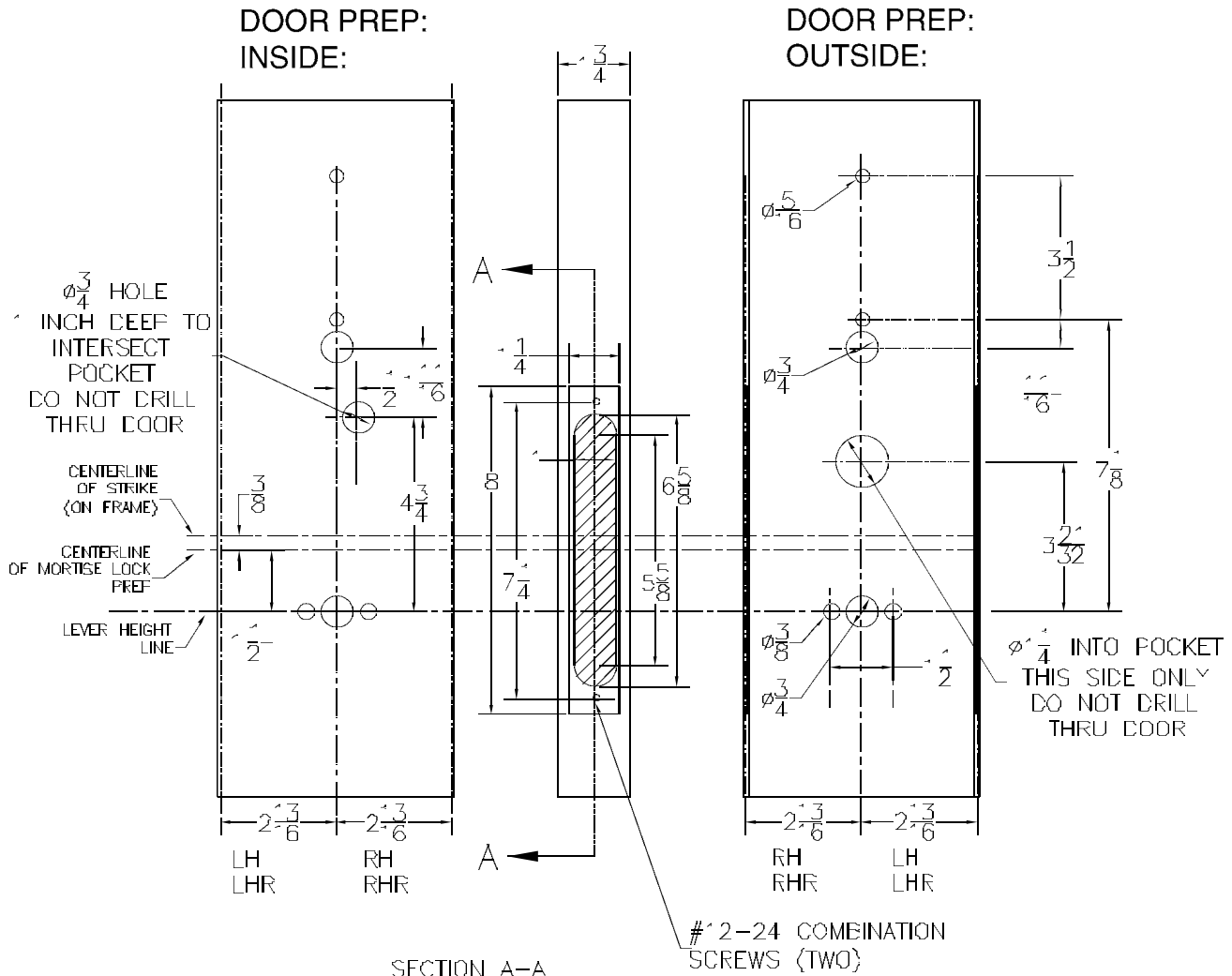

$\phi \frac{1}{4}$ INTO POCKET THIS SIDE ONLY DO NOT DRILL THRU DOOR

***BACKSET:**
 2 3/4" NOMINAL (2.813 ACTUAL)
 MEASURED FROM CENTER
 OF EDGE OF BEVELED DOOR.

Mortise pocket prep must be at least 5" deep.

2

Install STRIKE.

- a. Align centerline of strike template with the centerline marked on doorjamb. (Be sure to match centerline on both strike and lock trim templates.)
- b. Bore 1" diameter holes into doorjamb, 1 1/8" deep.
- c. Recess 5/32" for a flush fit of the strike and box.

NOTE: Additional recess is required when using strike reinforcement.

- d. Install Strike Box. Note the correct orientation of the box for models with the DSM option.
- e. Using a Philips screwdriver and two (2) strike mounting screws, install strike into doorjamb.

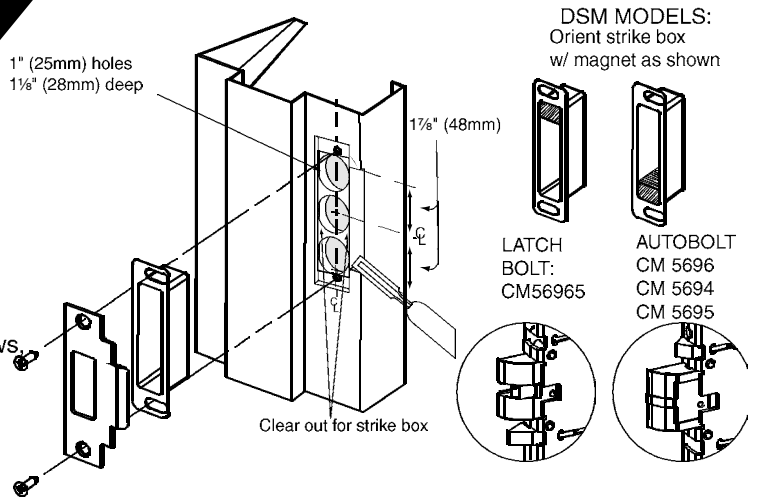

3

Install LOCK CASE (Verify correct hand of lock)

- a. Check position of lock handing screw, it should be installed in on the side opposite the cylinder. For changing bolt direction see section "H" at the end of this manual.
- b. Feed wiring harness from lock and wiring from frame (FSE/FSA models only) through door prep to inside of door as shown.
- c. Install lock case with lock case mounting screws.

NOTE: Leave the lock case mounting screws slightly loose to allow for adjustment.

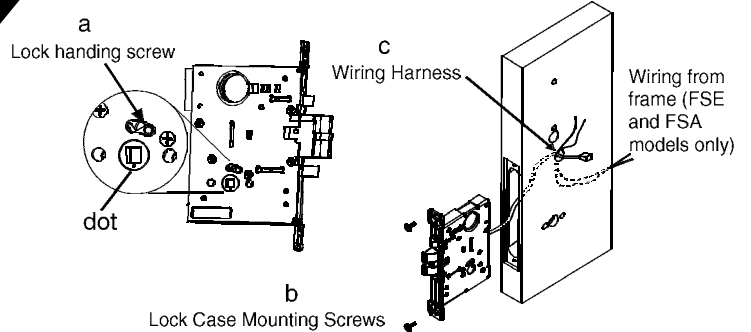

4

Install SPINDLES and SPRINGS.

- a. Slide a spring over each spindle.
- b. Make sure that cams on inside of lock case have the dot facing down. (See picture in step 3 above.)
- b. Insert spindles and springs so that the spindle stops are in contact with the lock case.

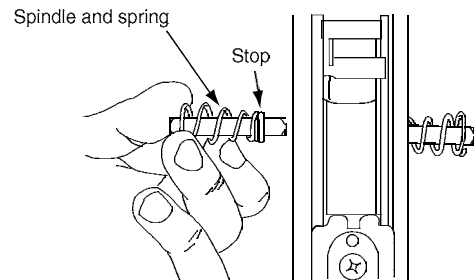

5

Thread MOUNTING POSTS onto outside rose or escutcheon.

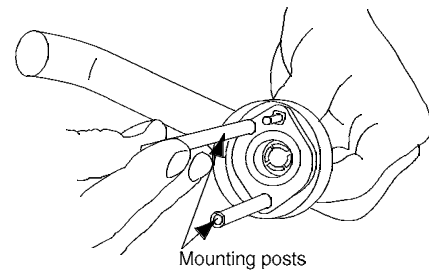

6

Install OUTSIDE SPRING CAGE.

Spring cage arrows should point in direction of lever rotation.

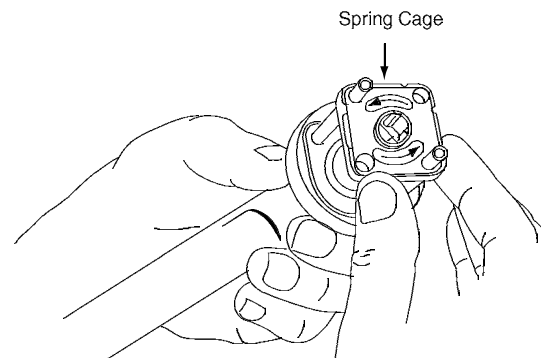

7

Install OUTSIDE ROSE or ESCUTCHEON.

Install with lever in working position.

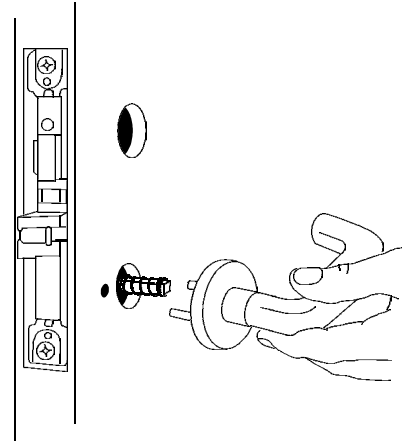

8

Install SPRING CAGE and MOUNTING PLATE.

a. Slide mounting plate and spring cage over the inside spindle and spring.

NOTE: Make sure the arrows on the spring cage point in the direction of lever rotation.

b. Insert and tighten two (2) mounting screws.

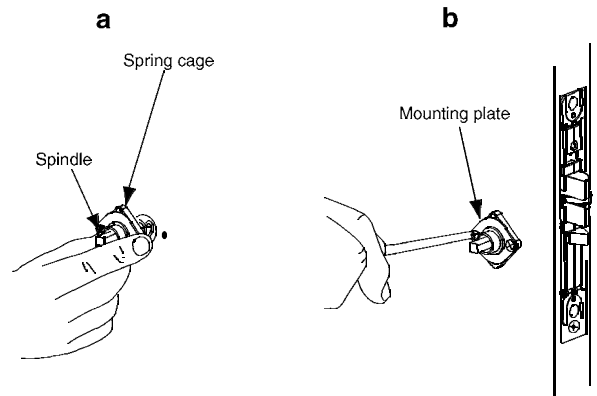

9

Install inside ROSE.

- a. Place rose or escutcheon over mounting plate.
- b. Install lever and tighten bushing with spanner wrench.

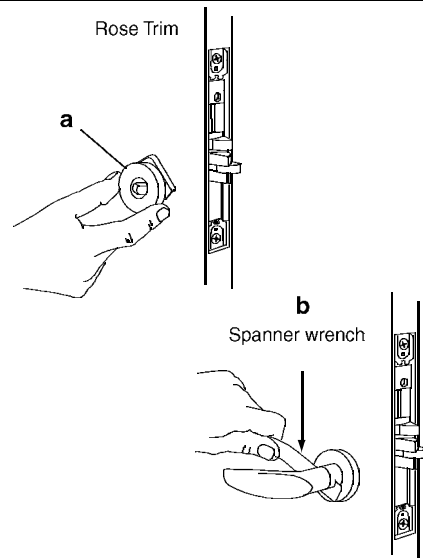

10

Install OUTSIDE FULL FACE CYLINDER.

- a. Assemble cylinder.
- b. Straight cam must be used. Schlage P/N B502-191 or equivalent (for standard cylinder) or P/NB502-948 (for Everest cylinder).
- c. Using a partially inserted key, screw the cylinder into the lock case.

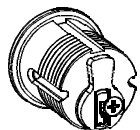

a
Cylinder Rose Trim With Long Cyinders

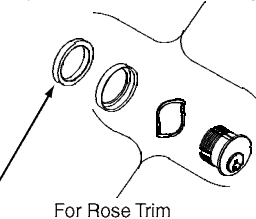

blocking rings available based on cylinder length and door thickness

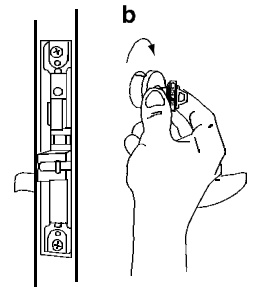

Install Keypad or Reader

11

Install KEYPAD or READER and CONTROLLER.

Pass wiring harness through door and inside escutcheon to inside as shown.

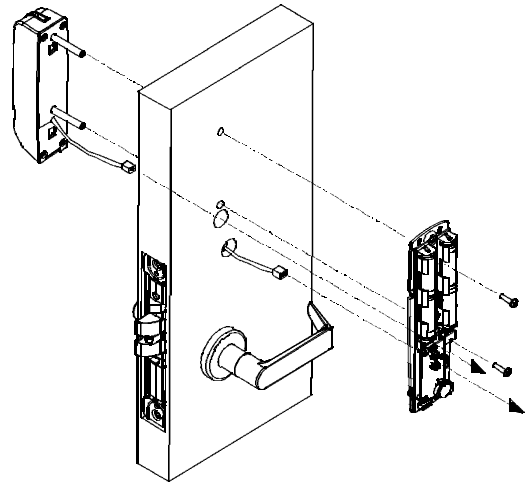

Make Electrical Connections

Plug harness connectors as shown.

Make wiring connections for FSE/FSA units.

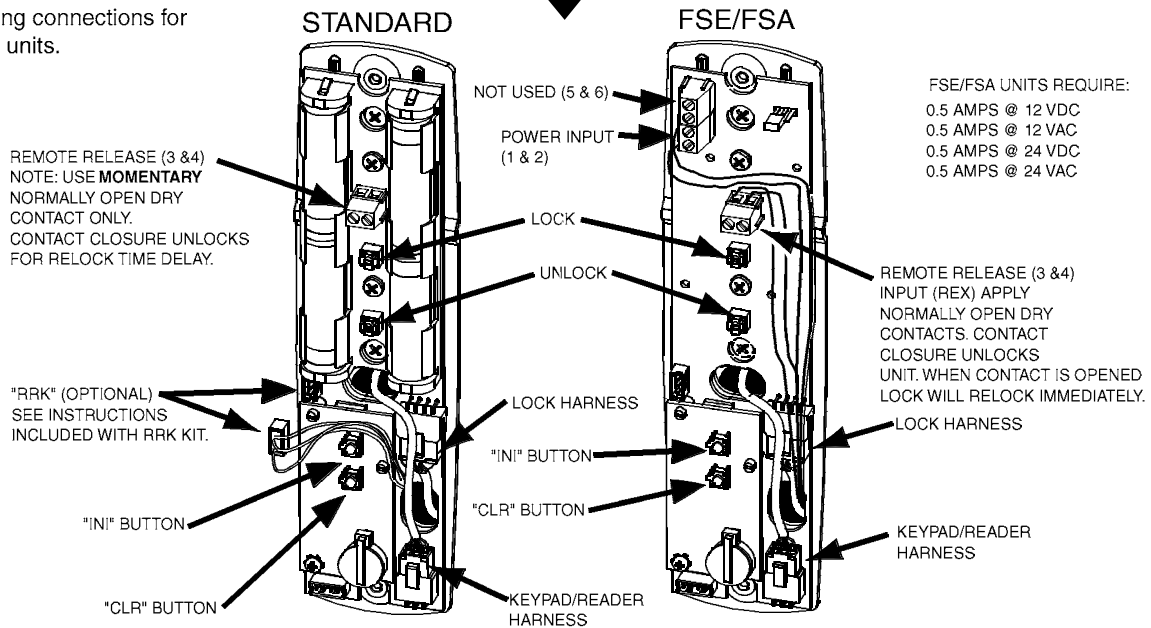

Program Lock and Install Controller Cover

Program Lock (refer to programming guide)
Install cover.

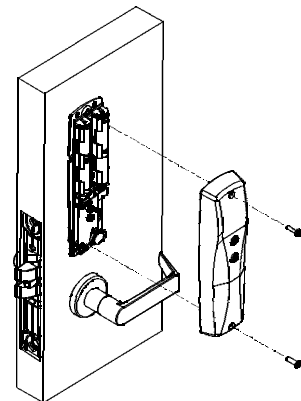

14

Install ARMOR FRONT

- a. Tighten the cylinder anchor screw until hand-tight.
- b. Tighten the two (2) lock case mounting screws.
- c. Place armor front in position and install two (2) armor front screws.

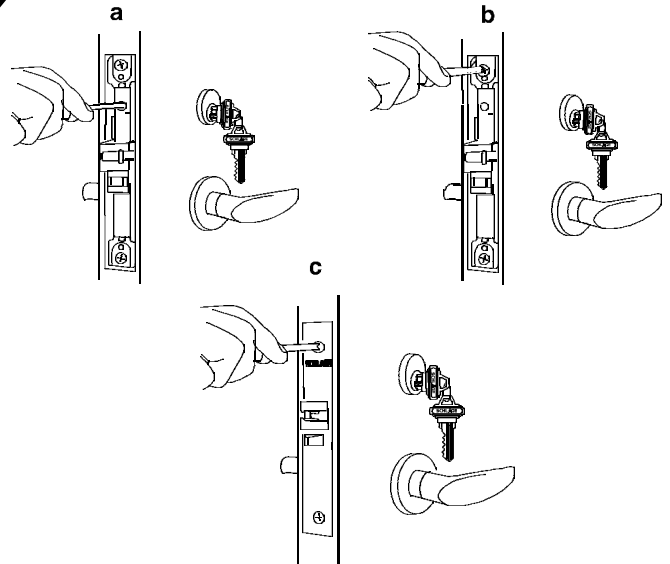

Hand Changing Instructions

H

To Change Hand

- a. Extend bolt fully by pressing on deadlatch. Insert change key into slot to fix latch shaft in position.
- b. Use hex wrench to loosen latch bolt set screw.
- c. Pull latch off shaft and reverse position. Keep spring in place.
- d. Apply thread lock compound to set screw. (Loctite 242 recommended.)
- e. Push bolt firmly back onto shaft. Tighten set latch set screw.
- f. Remove change key from slot.
- g. Make sure lock handing screw is installed on the inside of the lock (opposite the cylinder) Be sure the dot on the cam is facing down when installing the lock handing screw.

