

**UNIVERSAL WIRELESS
BLUETOOTH® HEADPHONE**



Congratulations on your purchase of the Scosche UBHP Bluetooth® Wireless Headphones. This system incorporates the latest Bluetooth® technology for your BlueLife® wireless lifestyle. Before using, please read this manual carefully.

FEATURES/SPECS:

BLUETOOTH® HEADPHONES:

- Cutting-edge ergonomic folding design
- 2.5mm male to 3.5mm male adapter cable included
- Female 3.5mm to Male RCA cable included
- Built in Lithium-ion 5 Hour Rechargeable Battery
- Supports Profiles: A2DP/HFP
- 2.5mm Switching Input/Output port allows UBHP to act as a wired headphone system or as a Bluetooth® stand-alone receiver
- USB Charging "Y" cable

OVERVIEW

ILLUSTRATION 1

1. Volume down
2. Power On/Off & Cellphone Answer/Hang Up
3. Volume Up

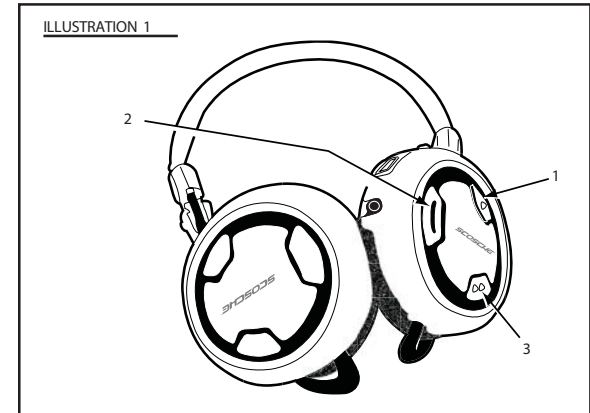

CHARGING

NOTE:

Before using the UBHP set for the first time, charge the headphones for a full two hours! A cable is provided in the kit for charging.

1. Plug the Mini cable end of the charger cord into the charging jack as shown in Illustration 2.
2. Connect the USB cable end to an available PC or LAPTOP USB port.
3. Charge Battery for 2.5 hours (LEDs will illuminate RED when charging creating a Violet hue)
4. The Red LED will turn off when charging is complete. Unplug each device and enjoy up to 5 hours of use.

This product may not be compatible with all Bluetooth® features on all Bluetooth® enabled products. Please consult your Bluetooth® A2DP enabled product operation manual for specific features and instructions.



CHARGING (Cont'd)

ILLUSTRATION 2

CHARGING CONNECTIONS

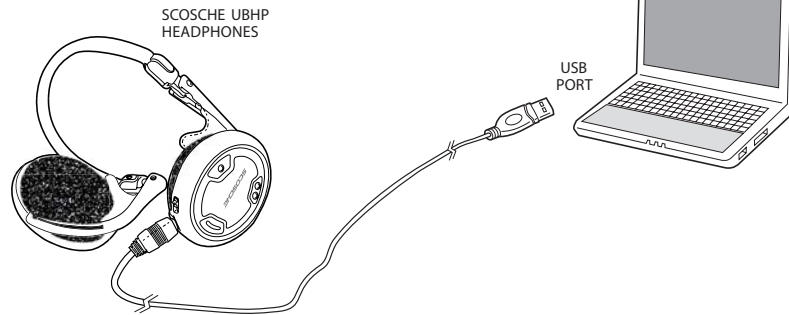

NOT TO SCALE

PAIRING

GENERAL PAIRING NOTES:

1. Keep the Bluetooth® products within a distance of 3 ft. (1 meter) when pairing.
2. These products are designed for AUTO-pairing function and no user input should be required. If for any reason you are asked for a passcode by any Bluetooth® device, always use "0000".
3. As a general rule, power the receiving device FIRST before the transmitting device. (Headphone is the receiver).
4. Compatible devices must be Bluetooth® V1.2 supporting A2DP profile.
5. Turn off any other nearby Bluetooth® devices, such as a cell phone or headset as this may hinder pairing process between your devices.
6. Pairing can take up to 1 minute and sometimes more. Once initial pairing is complete between your headphones, transmitter and Bluetooth® phone, reconnecting during normal use occurs in a fraction of the time.

PAIRING UBHP HEADPHONES TO THE IUBTT TRANSMITTER (sold separately)

1. Press the Power Button on the UBHP headphone for 3 seconds. Blue LED will flash indicating pairing mode.
2. Press the Power Button on the IUBTT transmitter for 3 seconds. Blue LED will flash indicating pairing mode.
3. Pairing should occur within 1 minute but can take up to 5 minutes. Blue LEDs will stop flashing indicating a successful wireless link between the two.
4. Plug the transmitter's 3.5 mm input jack to the headphone plug on any portable audio device such as iPod/MP3/DVD etc. You should hear the audio through your Bluetooth® Headphones.
5. If you are not successful pairing devices, repeat steps 1-4 above. Make sure receiving device is powered first as suggested in pairing notes and power off any other Bluetooth® mobile devices. If you still cannot successfully pair, go to the TROUBLESHOOTING steps in this manual or call Tech Support at (800) 621-3695 Ext 3.

LIMITED WARRANTY

Scosche Industries Inc. warrants this product to be free from defects in material and workmanship for a period of 90 days from purchase. This Scosche product is sold with the understanding that the purchaser has independently determined the suitability of this product. This warranty is offered to the original purchaser of the product only. This warranty does not cover the product if physically damaged, subjected to negligence or misuse, abuse, alteration, accident, or an act of God. This warranty does not apply to product which has been water or physically damaged, damaged by accident or which has been misused, disassembled or altered.

The original dated sales slip or proof of purchase will establish warranty eligibility. If the product should prove defective within the warranty period, return the product with proof of purchase to Scosche Industries Inc. Scosche, at its option, will replace or repair the product free of charge and return the product postage paid.

In no event shall Scosche Industries, Inc. be responsible for claims beyond the replacement value of the defective product, or in any way be liable or responsible for consequential or incidental damages.

No express warranties and no implied warranties, whether for fitness or any particular use, or otherwise, except as set forth above (which is made expressly in lieu of all other warranties) shall apply to products sold by Scosche. Scosche Industries cannot be held responsible for discrepancies/inconsistencies that may occur due to automotive manufacturing changes or options.

This device complies with FCC Rules Part 15. Operation is subject to the following two conditions: 1) This device may not cause interference, and (2) this device must accept any interference that may be received, including interference that may cause undesired operation. The manufacturer is not responsible for any radio or TV interference caused by unauthorized modification to this equipment. Such modification could void the user's authority to operate the equipment.

LED CHART	
(Transmitter and Headphone LED operate similar, unless noted)	
LED/COLOR	STATUS
Blue LED Blinking Blue LED Solid	Pairing Mode Connected with Bluetooth® Headphones or Bluetooth® Receiving Device
Red and Blue LED on Solid (Violet hue)	Charging and Connected with Bluetooth® Device
Red LED Solid	Battery is Currently Charging or LOW Battery (need recharge)
Red LED Off	Charging Complete

TROUBLE SHOOTING	
PROBLEM	TIP/SOLUTION
Difficulty pairing Headphones and Transmitter	1) Make sure both devices have been recently charged. These products will not pair on low battery voltage. 2) Make sure you power on the UBHP first, then the transmitter.
Difficulty pairing Headphones and Bluetooth cell phones	Make sure receiver is powered on first. 2) Make sure your cell phone's Bluetooth power is enabled and it is looking for devices. If needed, consult your cell phone's manual for information on pairing or discovering Bluetooth® devices for your particular phone.
Headphones drop wireless link less than 30 feet away	The Connection range varies on the surrounding environment. Range is not guaranteed to be 30 feet in all cases. Range can be reduced by other competing electronic devices include cordless telephones, microwaves and typical household electronic. Range can also be reduce
Headphones or Transmitter loses wireless for no reason	Check for other competing Bluetooth or 2.4Ghz electronic devices in close proximity to the transmitter or UBHP head phones. Power down these competing devices
No Audio heard from transmitter	1) Check to make sure the two products successfully paired and both devices are powered ON. 2) Make sure you are within range of the Transmitter. 3) Make sure source volume is not muted

PAIRING (Cont'd)

PAIRING THE UBHP HEADPHONES TO A BLUETOOTH CELL PHONE

- Place the headphones and Bluetooth® cell phone within 3 ft. (1m) of each other.
- Ensure headphone power is off.
- Press the power button on the right earpiece for 3 seconds. The Blue LED light flashes indicating pairing mode.
- While the headphone LED is flashing Blue, follow the instructions for your cell phone to seek (or discover) any Bluetooth® devices. You will be pairing the Scosche Bluetooth® headphones to your phone just like you would pair any Bluetooth® handset or hands-free kit. If needed, consult your cell phone's manual for information on pairing or discovering Bluetooth® devices for your particular phone.
- Your cell phone should display a list of local Bluetooth® devices. The Scosche headphones should be displayed as a device named "SCOSCHE Headphones".
- Select this device and your phone should connect to the headphones automatically. If your phone happens to ask for a password (or passcode) then enter "0000".
- Bluetooth® pairing should now be complete. (Blue LED on solid) If your phone fails to locate the Scosche headphones, then check to make sure your phone is seeking Bluetooth® devices. Check to make sure the Scosche headphone power is switched ON and the LED light is flashing BLUE indicating "pairing" mode. Repeat steps 1-6. If you cannot successfully pair the two devices, go to the TROUBLESHOOTING steps in this manual or call Tech Support at (800) 621-3695 Ext 3.
- Place the headphones over your ears and make a test call from your cell phone. Your cell-phone audio should be heard through the headphones.

HEADPHONE & TRANSMITTER OPERATION

POWER ON/OFF:

Under normal use, we suggest powering on the headphones (receiver) first, then power on your Bluetooth® transmitter. This method will produce the shortest connection time between the devices. If using a Bluetooth® cell phone, then connect to the headphone AFTER the transmitter is connected as the third device in your group. If you have previously paired with your Bluetooth® cell phone, then select the Scosche headphones from the Bluetooth® device list and choose to connect.

CONNECTING:

Simply connect the 3.5mm Bluetooth® transmitter's input cable to the headphone or line output plug of your iPod, MP3 or other portable media player. Play a track and enjoy the audio. The transmitter can send Bluetooth® audio signals to the headphones up to 30 feet away freeing you from the restrictions of wired headphones.

NOTE: Make sure the In/Out Switch on the headphones is set to "In" when listening to the headphones, otherwise no audio will be heard.

CELLULAR OPERATION

INCOMING CALL ANSWER:

With your UBHP headphones powered and a Bluetooth® wireless link established, a ring tone will be heard inside the headphones when you receive an incoming phone call. Simply press and release the Power Button to ANSWER an incoming call. If you were listening to music at the time, it will be interrupted during your call. You will hear the other party through the left headphone speaker and they will hear you through the built-in microphone on the right earpiece. The audio will return when the call ends.

ENDING A CALL:

When you are finished with the call, simply press and release the Power Button to END the call.

CELLULAR RE-CONNECTING:

Once you have initially paired your cell phone with the UBHP Bluetooth® headphones, operating steps may vary when needing to re-establish a Bluetooth® link between the headphones and cell phone. Some phones may attempt to reconnect automatically as soon as they "see" the UBHP and some phones may require you to select the "Scosche" headphones from a list of cataloged Bluetooth® devices in your particular phones memory. If needed, consult your cell phone's manual for information on connecting to Bluetooth® devices for your particular phone.

2.5 MM INPUT/OUTPUT WITH SWITCH

The UBHP Bluetooth® headphones include a unique 2.5MM stereo input/output port with switch:

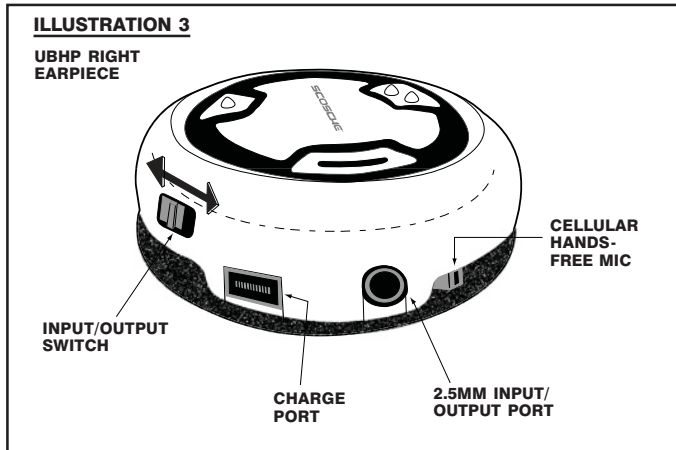

POSITION 1 (Input): Illustration 4

In this position the 2.5MM port acts as a direct audio wired input and the UBHP Headphones will operate as pair of high quality wired units. This is handy for air travel or anywhere wireless devices are not permitted.

- A) Make sure UBHP power is OFF.
- B) Connect to the 2.5mm to 3.5mm adapter cable between your portable media player and the UBHP headphones

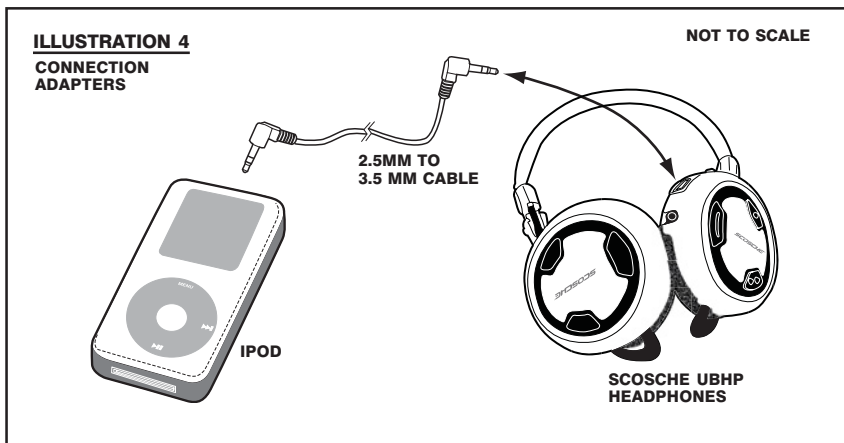

POSITION 2 (Output): Illustration 5

In this position the 2.5MM port acts as a bypass or audio output. The UBHP Headphones will operate as Bluetooth® RECEIVER and pass the audio signal through the 2.5mm port. This is handy if you need to send the audio signal from the IUBTT Bluetooth® Transmitter to an outboard or external device such as a set of amplified mini-speakers, home stereo or laptop computer.

- A) Make sure Both the headphones and transmitter are powered and a Bluetooth® wireless connection has been established.
- B) Connect to the 2.5mm to 3.5 mm adapter cable between the UBHP Headphones and your external secondary audio device.

2.5 MM INPUT/OUTPUT WITH SWITCH (Cont'd)

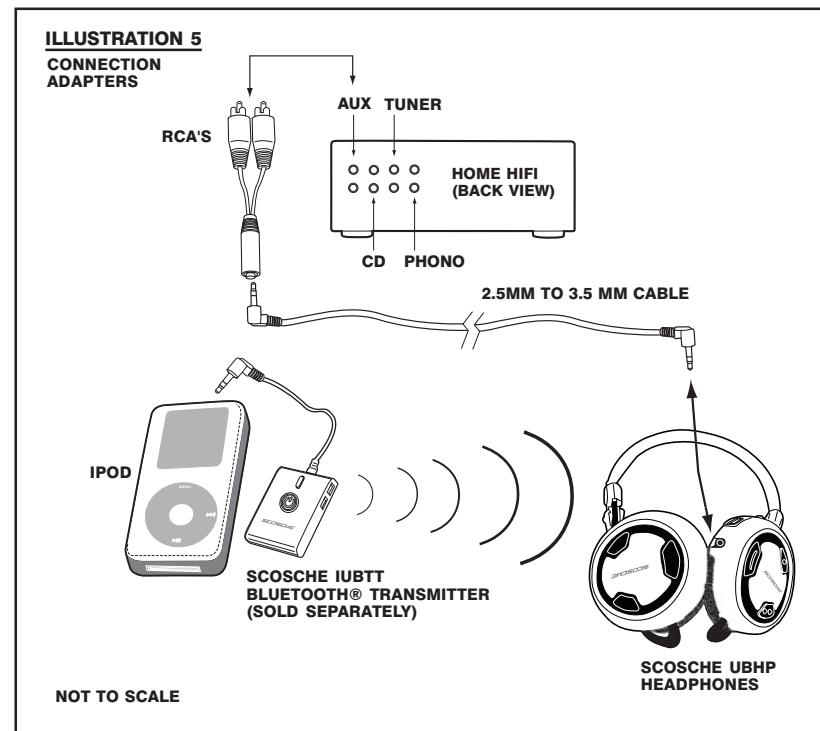

TRANSMITTER TRANSMITS TO HEADPHONES

CONNECTION ADAPTERS:

The UBHPK set includes adapters for many applications:

- 2.5mm Male to 3.5mm Male cable.
- This adapter allows the UBHP Headphones to be connected to various devices using a standard 3.5mm stereo output which is found on most MP3 players.
- 3.5mm Male to ¼ HiFi headphone Male.
- This adapter allows the IUBTT transmitter (or UBHP Headphones) to connect with home HiFi stereo receivers or devices that use 1/4" headphone jack.

CARE AND MAINTENANCE

1. Keep devices away from heavy moisture. Sources of humidity and all types of liquids will corrode electronic circuits.
2. Keep devices away from high heat. Extreme temperatures will shorten the life of electronic circuits and could possibly melt the plastic case. For example, do not store the unit in direct sunlight on a vehicle dashboard.
3. Don't attempt to open or repair these products. Non-expert handling will damage them and void any all possible warranty claims.
4. Don't use harsh chemicals, cleaning solvents or detergents to clean the products.