

BTR3

## Bluetooth receiver



Portable Devices

Technical specifications are subject to change without notice, we apologize for any inconvenience.

Operating Environment: -10 to +50°C  
 Weight of product: 10g  
 S/N Ratio: >90dB  
 Talk Time: Up to 7 hrs  
 Capacity of battery: 1000mAh  
 Operating Distance: 10m (free space)  
 RF frequency range: 2.4GHz-2.48GHz

### Bluetooth: 4.2

### Technical Specification

User's Guide: 1 pcs  
 Charging cable: 1 pcs  
 3.5mm audio cable: 1 pcs  
 L connector: 1 pcs

### BT008 Package contents

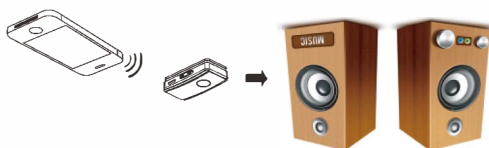

Remarks: please use power adapter according to the instruction when charging completed.

It will alarm automatically if the BTR3 is in low power, then you should charge it. Make sure the USB output into the USB charger or other charging device, the red led keeps lighting when charging, and light off when charging completed.

### Charging mode

Red led indicator: charging indicator, the red led lights when it's in charging, the red led will switch off when the charging completed and blue light on.  
 Blue led indicator: The blue led light blinks per 5 seconds when it's connected successfully. The blue led light blinks per 5 seconds when phone is in communication.  
 The red light and blue light flash alternately when you have an incoming call or you have outgoing calling.

## User manual

### Bluetooth music receiver

#### For phone and music

BTR3 is a multi-function Bluetooth receiver, it can connect iPhone, iPod, iTouch, Samsung and other smart phones with Bluetooth wireless technology; you can connect our BTR3 with your car audio system by 3.5mm audio adapter or 3.5mm audio cable, then connect your mobile BTR3 together with car audio system shall form a new Bluetooth audio system, and you can enjoy your music and answer phone calls by car audio system.

#### Power view of BTR3

**Power on:**  
 Keep pressing the MF Button for 3.0 seconds to power it on, the BTR3 enters into pairing mode, or automatically connects back to paired device for 3 minutes, if without any pairing, it is going to sleep mode after 3mins, and automatic power off after 12 minutes.

#### Power off:

Keep press the "MF Button" for around 3 seconds, then it will be powered off;

#### Steps to pair with BTR3

1. Power on the BTR3, ensure the BTR3 entered to pairing mode
2. Switch on Bluetooth search function in your mobile phone or other device needs to be connected, the mobile phone will display the "BTR3".
3. Select "BTR3" (some mobile phone need to enter the password "0000" to pair the headset) entering pairing, after successful connection, you can enjoy mobile's music and answer coming calls by our BTR3.

**Attention:** some smart phone (such as iPhone) paired with BT008 in the first time, the Cell phone music's default volume level and cell phone call's default volume level will be smaller, please adjust your phone volume level to fit the volume you want.

#### In music mode:

After connected successfully, shot press on MF button to play or to pause the music

#### Hands-free mode:

After connected successfully, shot press MF button to answer the coming call, or to drop the calling when you finish the talking;

#### Redial the last call

After connected successfully, double shot press MF button to redial the last call

#### Disconnect bluetooth

Keep pressing the "MF Button" for 3 seconds to power off, or shut off your mobile phone Bluetooth function to disconnect the Bluetooth.

**Note:** In order to let the product work well, before first time use it, please recharge power for two hours.

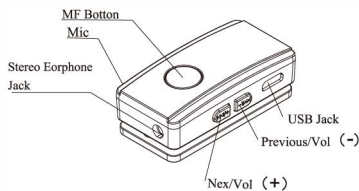

### Instruction of button operation

Single shot Press the MF button to play/pause the music; and answer/drop calls  
 Short push wheel switch, Vol(+) or Vol(-) Button to select previous song or next song.  
 Long push wheel switch, Vol(+) or Vol(-) Button to turn volume up or turn volume down.  
 Hold pressing MF button for 3 seconds to power it on/off, short press can play/pause music, answer and drop calls.

**FCC Caution:**

This device complies with part 15 of the FCC Rules. Operation is subject to the following two conditions: (1) This device may not cause harmful interference, and (2) this device must accept any interference received, including interference that may cause undesired operation.

Any Changes or modifications not expressly approved by the party responsible for compliance could void the user's authority to operate the equipment.

**Note:** This equipment has been tested and found to comply with the limits for a Class B digital device, pursuant to part 15 of the FCC Rules. These limits are designed to provide reasonable protection against harmful interference in a residential installation. This equipment generates uses and can radiate radio frequency energy and, if not installed and used in accordance with the instructions, may cause harmful interference to radio communications. However, there is no guarantee that interference will not occur in a particular installation. If this equipment does cause harmful interference to radio or television reception, which can be determined by turning the equipment off and on, the user is encouraged to try to correct the interference by one or more of the following measures:

- Reorient or relocate the receiving antenna.
- Increase the separation between the equipment and receiver.
- Connect the equipment into an outlet on a circuit different from that to which the receiver is connected.
- Consult the dealer or an experienced radio/TV technician for help.

## IC Caution:

This device complies with Industry Canada's licence-exempt RSSs. Operation is subject to the following two conditions:

- (1) This device may not cause interference; and
- (2) This device must accept any interference, including interference that may cause undesired operation of the device.

Le présent appareil est conforme aux CNR d'Industrie Canada applicables aux appareils radio exempts de licence. L'exploitation est autorisée aux deux conditions suivantes:

- (1) l'appareil ne doit pas produire de brouillage, et
- (2) l'utilisateur de l'appareil doit accepter tout brouillage radioélectrique subi, même si le brouillage est susceptible d'en compromettre le fonctionnement.