

Register your product online at

www.scosche.com/register

 **SCOSCHE**[®]

NEXC100

Full HD WiFi Dash Cam

Powered By

 **iNEXAR**

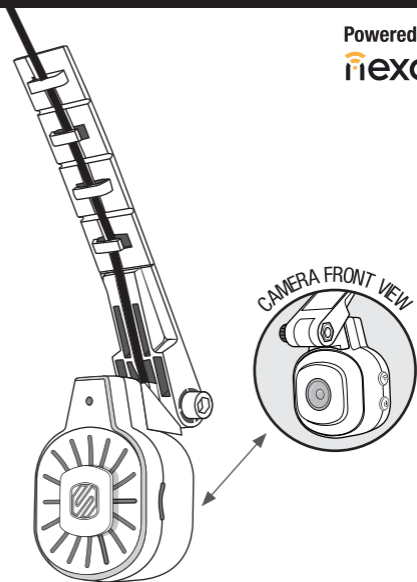

Compatible with Micro-SD Cards Up to 64GB. Micro-SD is card NOT included with NEXC100.

About

The NEXC100 is a full HD WiFi Dash Cam that works with your smartphone and the Nexar app to record your drive and store important vehicular events in the Nexar Cloud. It provides video evidence and an easy way to send it to your insurer if you choose to, and includes 24/7 support.

Table of Content

Cover	1
About Table of Contents	2
Safety.....	3
NEXC100 Included Parts	4
Camera Features	5
Video Storage Slot Camera Button Functions	6
Mounting NEXC100	7
Power Cable Routing Solution	8
Power Cable Routing Solution Illustrations.....	9
Nexar on iPhone® Devices	10
Connecting NEXC100 to iPhone® Devices	11
Nexar on Android™ Devices.....	12
Connecting NEXC100 to Android™ Devices.....	13
Troubleshooting TechSpecifications	14
FCC/IC Statement	15
Déclaration FCC / IC	16

Safety

Please read complete instructions to familiarize yourself with the NEXC100 before beginning installation.

Avoid Distracted Driving

Check all state, federal and local laws before installation. It is the responsibility of the user to determine, and obey, all applicable laws regarding use of electronic devices while operating a vehicle.

CAUTION!

Disconnect your vehicles negative battery terminal prior to the installation to help prevent electrical damage. We recommend the use of a Volt/ OHM meter over a test light to check wiring. A test or grounded wire probe can cause damage to the vehicle's computer and/or diagnostic system. Avoid all factory airbag wiring - airbags can accidentally deploy causing serious injury or death.

Device Safety

- Inspect power cable, do not use the power cable if it is damaged.
- Do not mount where it will impair the driver's view of the road or impair airbag deployment. Check local and state laws before mounting the NEXC100.
- Clean lens using a soft cloth and make sure there are no obstructions or debris on the lens.
- Avoid any major liquid spills/moisture on the device.
- Avoid open flames near the NEXC100 as it may cause damage.
- Keep out of reach of children.
- Scosche Industries Inc. is not responsible for any loss of data/content during operation.

For complete warranty details, camera hardware support or questions, visit us online at www.scosche.com or contact us at:

www.scosche.com/contact | customerservice@scosche.com |
1(800) 363-4490 ext.1, or scan the QR code on the right.



For technical support regarding the Nexar app or 1-Click reports, visit

Nexar online at: www.getnexar.com | www.getnexar.com/contact-us-support@getnexar.com | getnexar.com/faq or scan the QR code for FAQ.



NEXC100 Included Parts



NEXC100

Full HD 140° wide-angle lens WiFi Dash Cam works with your smartphone and the Nexar app to record your drive and save important vehicular events in the Nexar Cloud. It provides video evidence and an easy way to send data to your insurer in case of an accident.

Adjustable (cut-to-fit) Adhesive Docking Mount

Adjustable quick release docking mount can be positioned to best suit your camera's view of the road. Equipped with detachable cable routing adhesive hooks for a clean low profile and easy install to your vehicle's 12V power.

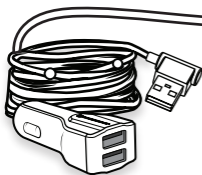
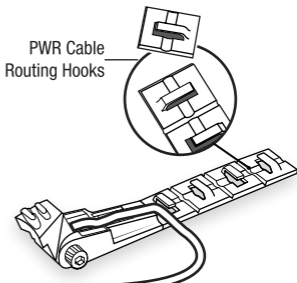

USB Power Cable & 24W dual-port (12W each) USB charger

90° USB 10-ft power cable with over-molded cable stoppers to discreetly run power from the 12V power source to your NEXC100 HD Dash camera through the headliner and trims/panels.

Cable Routing Kit

Use the kit to help route the power cable from the camera to the 12V socket



Cleaning Wipes
(1) Wet & (1) Dry



(4) Rubber
Strap



(5) Zip
Ties



(4) Adhesive Rubber
Cable Clips



(1) Panel/Trim
Removal Tool

Camera Features

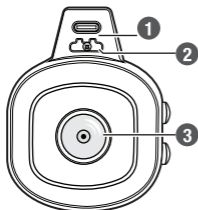

Front

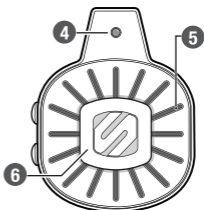

Back



Bottom View

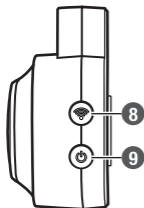

Button Side
View

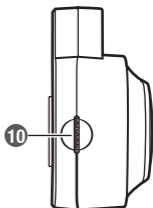

Storage Side
View

1. Type-C USB Power Input
2. Quick Release Docking Slot
3. 140° Wide-angle Lens (1080p Full HD Sony Low-light Image Sensor)
4. LED Indicator
5. Microphone

6. Capacitive Touch (Event Capture Button)
7. Speaker
8. WiFi Connection Button
9. Power Button
10. Memory Card Slot

Video Storage Slot

Inserting the Memory Card

1. Insert the memory card into the designated card slot with the golden contacts facing the back of the camera's body.
2. Push the memory card into the slot until it clicks into place.

Removing the Memory Card

Push the exposed edge of the memory card into the body of the camera until it clicks

Once pressed, the card will eject from location exposing enough of the card to remove from location.

CAUTION! Only remove memory card when the device is powered off. Attempting to remove the card while the device is operational may cause damage to saved files or the memory card itself.

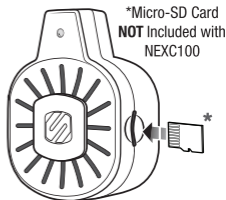

Camera Button Functions

A. WiFi Button

Press the WiFi button to toggle wireless connection to the device.

B. Power Button

- **Long Press:** Press hold (3+Sec.) power button to power ON or power OFF the device.
- **Short Press:** Press the power button to begin recording or to stop recording.

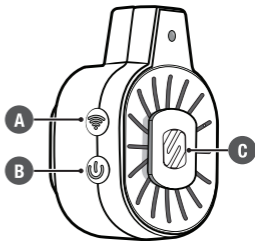

C. Capacitive Touch Button

The camera starts recording automatically once paired to mobile device. Use the Capacitive button to mark "events".

Mounting NEXC100

Window Mount Assembly

Align and set the top adhesive adjustment mount to the bottom adhesive cable mount support (1).

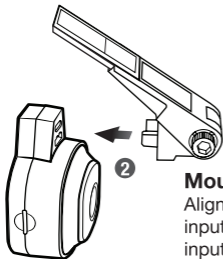
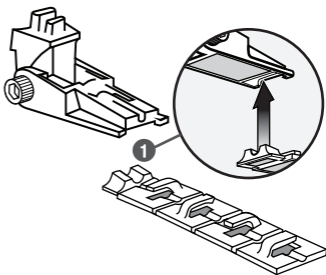

Mounting Camera to Mount Assembly

Align and attach the two extruded connection inputs on the mount assembly to the camera's input ports (2).

Applying & Adjusting Camera Assembly

- Thoroughly clean and dry the area of the windshield where the unit will be mounted, refer to page 3 **Safety** for suggestions.
- For sleek low profile look, fold and snap off the individual hooked squares (cut-to-fit) on the adhesive window mount (3).
- Carefully peel the adhesive strips from under the mount (4) and firmly press the mount onto location for 1 minute to secure mounting.

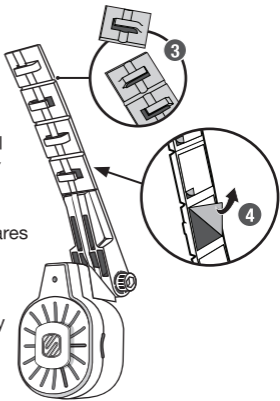

IMPORTANT! Please Read Before Routing Cable (This note refers to the sticker on the adhesive mount.)

To prevent any possible power cable damage, mount and position the NEXC100 to the vehicle's front windshield in the direction you wish to record before connecting and routing the power cable.

Use the illustrations on page 9 as a visual reference for possible power cable routing solutions instructed below.

Panel Removal Cable Routing Solution 1

For vehicles without airbags on the A-pillars.

1. Mount the camera assembly to front windshield.¹
2. Plan out your routing option see routing illustration on page 9.
3. Using the panel/trim removal tool and carefully remove the panels necessary for the route chosen. Use the cable's over-molded stoppers to help keep the cable in the headliner. **Note: Tools NOT provided may be required, we recommend researching your vehicle in advance before beginning installation.**
4. Connect the power cable to the camera then route the wire from the camera to the 12 volt power source. Use the mount hooks to secure cable routing near the camera device. **Note: Adhesive mounting hooks can be cut-to-fit location for a discrete look. Use ties and straps to secure.**
5. Reassemble panels in reverse order hiding away any excess wire.

Adhesive Hook Cable Routing Solution 2

For vehicles with airbags on the A-pillars.

1. Mount the camera assembly to the front windshield.²
2. Plan out your routing option see routing illustration on page 9.
3. Thoroughly clean and dry the area of the windshield where the adhesive camera docking mount, and the hooks will be mounted.
4. Connect and route the wire from the camera to the 12 volt power socket by extending the power cable along the edge of the windshield near the headliner and trim/panels.
5. Route the USB cable using the the provided rubber clips. If more clips are needed use any of the remaining cut-to-fit adhesive mounting hooks to help secure onto location.

1. Refer to safety on page 3 when mounting. 2.Ibid

Power Cable Routing Solution Illustrations

Detachable Mounting Hooks & Adhesive Rubber Cable Clips

Use the detachable mounting hooks and rubber mounting clips to route the cable from the camera to the 12 volt power source (recommended for solution 2) as illustrated below.

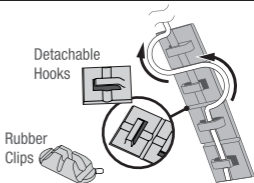

Cable Stoppers, Zip Ties & Cable Rubber Straps

USB over-molded cable stoppers prevent the cable from slipping under headliner. Use the zip ties and rubber straps provided to secure any excess cable or secure with vehicle's existing wiring.

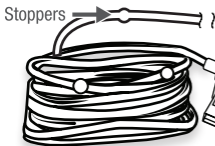

Power Cable Routing Solution

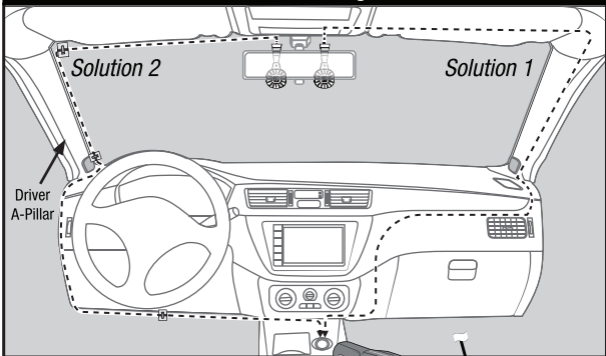

Connecting Charger & USB cable to 12V power.

Note: Routing solutions 1 & 2 can be applied to either driver's side or passenger side. Use the illustration above as a sample guide for you installation.



Nexar available on the App Store. The NEXC100 seamlessly works with the Nexar App. Download the app to record and capture events, access your free storage space, instantly report a crash and more.

1. Download³ the app by searching **Nexar** on the App Store or scan the QR code below for direct link to the app.
2. Once the app has been downloaded, open the app.
3. Register and enable all necessary settings when prompted.

For questions regarding the app contact Nexar at:

www.getnexar.com | www.getnexar.com/contact-us
support@getnexar.com | getnexar.com/faq or scan QR code for FAQ

Nexar available on the App Store.



3. It is recommended to download the app while connected to a WiFi network. Apple, the Apple logo, iPhone, and iPad are trademarks of Apple Inc., registered in the U.S. and other countries and regions. App Store is a service mark of Apple Inc.

Connecting NEXC100 to iPhone® Devices

Connecting to an iPhone® Device

1. Power on the NEXC100.⁴
2. Under setting on your iPhone tap and enable WiFi.
3. Connect to the WiFi network that begins with Nexar (NEXC1-5G)
4. Enter password: 1 2 3 4 5 6 7 8
5. Exit phone settings once WiFi connection has been established.
6. Open the Nexar app and tap the *Drive* button at the top of the screen to begin recording.
7. Confirm that the video feed on your phone is being received from the NEXC100 and not the phone's camera.

Note: Camera feed can be confirmed by two methods:

- Cover your phones camera lens and check the feed is from the cameras view on your smartphone device.
- Confirm that the camera icon in the app is active .

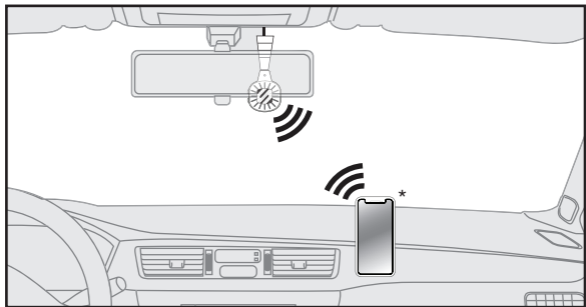

4. Camera will power on automatically when the vehicle is turned on, and power off when the vehicle is turned off. You may also power the device by pressing and holding the power button for 3+seconds.

*Smartphone device is NOT included with the NEXC100.



Nexar available on Google Play. The NEXC100 seamlessly works with the Nexar App. Download the app to record and capture events, access your free storage space, instantly report a crash and more.

1. Download⁵ the app by searching **Nexar** on Google Play or scan the QR code below for direct link to the app.
2. Once the app has been downloaded, open the app.
3. Register and enable all necessary settings when prompted.

For questions regarding the app contact Nexar at:

www.getnexar.com | www.getnexar.com/contact-us
support@getnexar.com | getnexar.com/faq or scan QR code for FAQ

Nexar available on Google Play



5. It is recommended to download the app while connected to a WiFi network. Google Play and the Google Play logo are trademarks of Google LLC

Connecting to Android™ Devices

1. Power on the NEXC100.⁶
2. Once the NEXC100 is on, open the Nexar app on your phone.
3. Tap on the **Menu** icon, then select **Settings**.
4. Under Settings, tap to select External Camera. Note: once the external camera has been selected, your phone will begin to pair to your NEXC100, this process may take a few moments.

Note: Camera feed can be confirmed by two methods:

- Cover your phones camera lens and confirm the video feed.
- Confirm that the external camera icon is active .

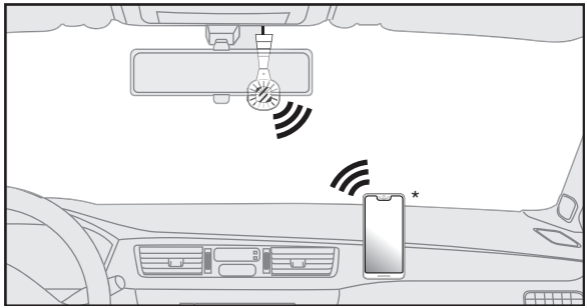

6. Camera will power on automatically when the vehicle is turned on, and power off when the vehicle is turned off. You may also power the device by pressing and holding the power button for 3+seconds. *Smartphone device is NOT included with the NEXC100.

Troubleshooting

Phone NOT connecting to camera?

- Turn WiFi connection On. Refer to your phone settings and toggle On/Off/On again and locate camera on your smartphone device.
- WiFi is On, but camera is not connecting? Confirm that the Nexar WiFi connection is selected and not a different connection.

For questions regarding the app contact Nexar at: www.getnexar.com | www.getnexar.com/contact-us | support@getnexar.com | getnexar.com/faq or scan the QR code on page 3 for FAQ.

Camera not turning ON when vehicle is turned on?

Check to see that all the power connections to the camera are properly made. If issue continues please contact us at: www.scosche.com/contact | customerservice@scosche.com | 1(800) 363-4490 ext.1

Tech Specifications

Camera

- 2.19 mega pixel 1/2.9" CMOS Sensor
- FOV 140° (diagonal angle)
- Built-in G-Sensor
- Full HD Recording

Connectivity

- SSID: NEXC1-5G
- WiFi 802.11b/g/n/ac (2.4 & 5GHz)
- Password Default: 1 2 3 4 5 6 7 8

Environment Requirements

- Operating temperature: -4° to 158°F (-20° to 70°C)

Language

English | Arabic | French | German | Hebrew
| Italian | Korean | Portuguese | Russian |
Simplified Chinese | Spanish

Location:

App may use your location even when it isn't open, which can decrease battery life.

Power

- Auto Quick Start
- Auto Power Off
- 12 Volt

System Requirements

- Android: Android 6.0 or Higher
- iPhone®, iPad®, iPod touch®: iOS 9 or higher
- Minimum 1.2GB free storage space

Storage

- Micro-SD Card (**Not Included**): Up to 64GB
- Cloud: Unlimited

Video

- Video Coding: H.264
- Video Format MP4
- Time/Date Watermark
- Automatic W/B, Variable Exposure

FCC Statement

This equipment has been tested and found to comply with the limits for a Class B digital device, pursuant to part 15 of the FCC Rules. These limits are designed to provide reasonable protection against harmful interference in a residential installation. This equipment generates, uses and can radiate radio frequency energy and, if not installed and used in accordance with the instructions, may cause harmful interference to radio communications. However, there is no guarantee that interference will not occur in a particular installation. If this equipment does cause harmful interference to radio or television reception, which can be determined by turning the equipment off and on, the user is encouraged to try to correct the interference by one or more of the following measures:

- Reorient or relocate the receiving antenna.
- Increase the separation between the equipment and receiver.
- Connect the equipment into an outlet on a circuit different from that to which the receiver is connected.
- Consult the dealer or an experienced radio/TV technician for help.

Caution: Any changes or modifications to this device not explicitly approved by manufacturer could void your authority to operate this equipment. This device complies with part 15 of the FCC Rules. Operation is subject to the following two conditions: (1) This device may not cause harmful interference, and (2) this device must accept any interference received, including interference that may cause undesired operation.

This equipment complies with FCC radiation exposure limits set forth for an uncontrolled environment. This equipment should be installed and operated with minimum distance 20cm between the radiator and your body.

Déclaration de la FCC

This device complies with Industry Canada's license-exempt RSSs.

Operation is subject to the following two conditions:

- (1) This device may not cause interference; and
- (2) This device must accept any interference, including interference that may cause undesired operation of the device.

Le présent appareil est conforme aux CNR d'Industrie Canada applicables aux appareils radio exempts de licence. L'exploitation est autorisée aux deux conditions suivantes:

- (1) l'appareil ne doit pas produire de brouillage;
- (2) l'utilisateur de l'appareil doit accepter tout brouillage radioélectrique subi, même si le brouillage est susceptible d'en compromettre le fonctionnement.

The device for operation in the band 5150–5250 MHz is only for indoor use to reduce the potential for harmful interference to co-channel mobile satellite systems;

les dispositifs fonctionnant dans la bande de 5150 à 5250MHz sont réservés uniquement pour une utilisation à l'intérieur afin de réduire les risques de brouillage préjudiciable aux systèmes de satellites mobiles utilisant les mêmes canaux;

This equipment complies with Canada radiation exposure limits set forth for an uncontrolled environment. This equipment should be installed and operated with minimum distance 20cm between the radiator & your body.

Cet équipement est conforme Canada limites d'exposition aux radiations dans un environnement non contrôlé. Cet équipement doit être installé et utilisé à distance minimum de 20cm entre le radiateur et votre corps.

The digital apparatus complies with Canadian CAN ICES-3 (B)/NMB-3(B).

Cet conforme à la norme NMB-003 du Canada.