

Secure Wireless

P319 : Secure Wireless Pet Immune PIR

USER MANUAL

INTRODUCTION

The P319 was designed to operate with any Saw or Crystal ITI, Caddx or Nupco panel (to operate with Napco ensure the outside of the box displays "Napco Gemini Compatible"). This unit has a unique Alarm Power Saver (APS) mechanism which enables it to trigger only after 2 minutes once the last movement has been detected.

FEATURES

- 60 Lbs Pet Immune
- High White Light Immunity
- 50 x 50 Coverage
- Quad Element PIR
- Wall or Ceiling Mount Included
- Long Range Curtain (Optional)
- Ultra High White Light Immunity Lens (Optional)
- Calibration Free Installation
- State-of-the-art wireless PIR
- Low current ASIC PIR Technology
- Powered by a 3Volt Lithium battery
- Battery life : up to 4 years
- Built in Automatic Power Saver (APS)
- Low Battery condition signal transmission
- Test mode for PIR coverage and RF signal



Version_1

OPERATION

The Wireless PIR transmits the following event data:

SUPERVISION - a periodical transmission. Every 60 minutes indicates detector's presence.

ALARM - alarm transmission triggered by PIR intrusion detection.

LOW BAT - Whenever the battery reaches a pre-set low level (2.4V) Battery Low signal will be sent with the next message (Supervision, Alarm, etc.)

TAMPER - Whenever the P319 cover is removed or the unit's cover is put back, a message will be transmitted with "Tamper" signal.

APS - The unique APS (Automatic Power Saver) function built in the detector enables a battery life span up to four years. The detector will transmit only when the last event has occurred more than 2 minutes prior to the current one.

SELECT MOUNTING LOCATION

Select the mounting location so that an intruder will cross the beams of the selected pattern. As the detector is a wireless transmitter, and in order to take full advantage from PIR sophisticated operation, do not install the detector in areas where large metal objects could interfere with the transmission of signals. It is also advisable to avoid the following locations:

- Facing direct sunlight.
- Facing areas that may change temperature rapidly.
- Areas where there are air ducts or substantial airflows.
- Installation on metal wall.

The P319 performs better when provided with a constant and stable environment.

HEIGHT: The PIR lens was designed for mounting height of 8 feet from the ground for optimal performance plus or minus 1 foot is acceptable.

MOUNTING THE DETECTOR

The Secure Wireless Pet Immune PIR can be mounted in a corner like standard PIR's or by installing the included hardware can be easily mounted to a wall or ceiling.

Standard Corner Mounting

- 1) Remove the Screw at the bottom of the case and open the PIR.
- 2) Mount the detector 8 feet from the ground (+/- 12 inches) for optimal detection.
- 3) Carefully mount using the screw guides for flat surface mounting or corner mounting. It is acceptable to bend the antenna slightly in order to mount the case to the wall or desired surface.

MOUNTING THE DETECTOR continued

Wall or Ceiling Mount

We have supplied hardware to attach the PIR as a wall or ceiling mount.

See below diagram if desired mounting is needed.

HEIGHT: The PIR lens was designed for mounting height of 8 feet from the ground for optimal performance plus or minus 1 foot is acceptable.

NOTE: We do not mount the back bracket in case a corner mount is desired. If we did mount the back bracket in production and a corner mount was desired the back bracket would need to be removed and 2 holes would then exist. There should never be a hole where insects can enter as they can cause false alarms.

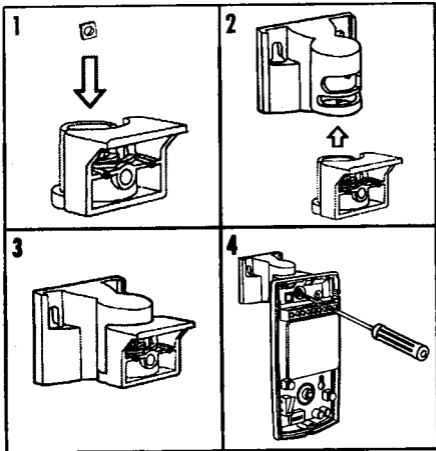

SETTING UP THE DETECTOR

The sensitivity adjustment switch sets up the detector for normal or harsh environment condition. Setting the sensitivity adjustment ((Pulse Count) switch (#7 of the diagram on page 6)).

- Position 1 = Normal. This means the detector will trigger the first time a person crosses its beam sending a wireless alarm condition.
- Position AUTO = Harsh. This means the beam must be crossed 3 times before it will send a wireless alarm condition.

Setting the Pet Immunity: (#5 of the diagram on page 6)

Slide the switch to 25Kgs for larger pets up to 60lbs (Decreased sensitivity) or 15Kgs for smaller pets under 30lbs (More sensitivity). The combination of AUTO and 25Kgs is the best combination for tough environments.

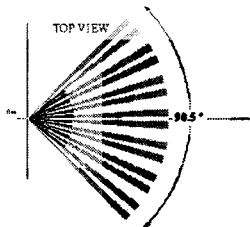

LENS PATTERN

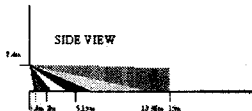

ENROLLING THE DETECTOR

The enrolling process of the P319 is the same as adding any other PIR to an ITI, Caddx or Napco system. Below is the method of enrolling an ITI or Caddx device. Since this is a crystal based transmitter it will operate on EITHER crystal or SAW receivers from ITI.

- 1) Install the battery into the PIR. Ensure the polarity (+/-) is correct as you insert the battery into the holder.
- 2) Enter Programming of a wireless Device on the ITI/Caddx panel
- 3) Press and release the Tamper switch on the PIR. (#8 on the diagram on page 6)
- 4) Go to the 'TESTING' section.

NOTE: For Napco users you press and HOLD the program button located on the PIR. Every six seconds for 1 full minute the PIR will send a fault/restore for the unit to automatically enroll the device.

TESTING

There are two tests that the P319 can perform which will help you complete and test installation and placement of the unit.

To Enter a WALK test:

Press and release the push button on the PIR (#4 of the diagram located on page 6) OR you may take a magnet and swipe it quickly next to the right side of the PIR housing (#3 of the diagram on page 6). Pressing the push button OR passing a magnet momentarily by the reed switch will cause the unit to enter a walk test for 1 minute.

Walk Test:

Each time the detector sees a NEW trigger, it will turn the blue LED 'ON' momentarily. This mode allows you to test the sensitivity and location of the PIR installation.

NOTE: This will not send an RF transmission, it will only give a visual LED blink when a trigger is detected.

To Enter an RF test:

Press and HOLD the push button OR place a magnet next to the reed switch for 2 seconds.

RF Test:

The RF test will send a Fault/Restore command every 6 seconds for 1 minute to allow a code learn or placement test. The unit will turn it's LED 'ON' each time that it transmits.

BATTERY

A 3 V lithium battery powers the unit. Thanks to the exclusive APS (Automatic Power Saver) characteristics, the battery provides about 4 years of continuous operation (depending on the amount of alarms). If the battery reaches a factory preset low level, the LOW BATTERY signal will be sent and the detector will remain operational for 30 days giving enough time to replace the 3V lithium battery.

BATTERY REPLACEMENT

- Remove screw at the bottom of the case to open.
- Take out the old battery.
- Using a flat head screwdriver short the two pins located behind the positive side of the battery holder for 10 seconds. This monetary short will discharge all remaining power from the circuits allowing a 'fresh' power up.
- Install a new battery according to polarity.

CAUTION !!! RISK OF EXPLOSION IF BATTERY IS REPLACED BY AN INCORRECT TYPE. DISPOSE OF USED BATTERIES ACCORDING TO THE INSTRUCTIONS.

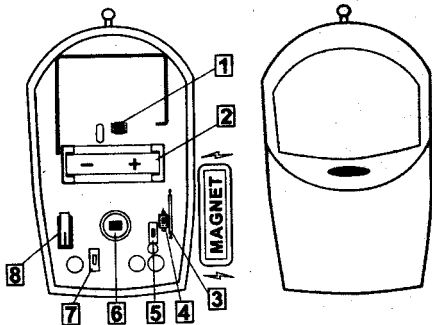

KEY

- 1) RF crystal section of the P319
- 2) Battery Holder and correct polarity
- 3) Reed Switch. Best used to enter Walk or RF test if the front cover is ON.
- 4) Push button: Best used to enter Walk or RF test if the front cover is OFF
- 5) Pet immunity setting for 15Kgs (30lbs) and 25Kgs (60lbs)
- 6) PIR quad element detector
- 7) Sensitivity (Pulse Count) switch.
- 8) Tamper Switch

TECHNICAL SPECIFICATIONS

Data Protocol	Selectable ITI/Coddex or Napco (Not all P319 models will operate with Napco. Check the original packaging to see if it shows "Gemini Compatible").
Modulation Type	ASK
Event Transmission	Alarm, Tamper, Test, Supervision, Low Bat
Supervision Timing	60 minutes
Detection Method	Quad Element
Detection Speed	0.3 ~ 1.5 m/sec
Lens Type	Spherical Hard Lens
Detection Coverage	90.5 (50 x 50)
Environment Conditions	Switch for Normal or Harsh selection
Battery	Lithium. 3V Type: CR123A
Current Consumption:	
Standby	~10 mA
Transmission	~16 mA
Power Saving	APS (Automatic Power Saver)
Install Test Modes	LED Indicator (RF & Optic) Walk Test and
Alarm Transmission Test	
Operating temperature	-10(C to +50(C Range
Dimensions	61mmX120mmX50mm (2.43" w X 4.25" h X 2"d)

Warning: Changes or modifications not expressly approved by the party responsible for compliance could void the user's authority to operate the equipment.

Federal Communications Commission (FCC) Statement

This device complies with part 15 of the FCC Rules. Operation is subject to the following two conditions: (1) This device may not cause harmful interference, and (2) this device must accept any interference received, including interference that may cause undesired operation.