

SEGA MASTER SYSTEM

SERVICE MANUAL

SEGA ENTERPRISES, LTD.

SEGA MASTER SYSTEM

SERVICE MANUAL

* CONTENTS *

| | |
|--|----------|
| Service Procedures | P. 3 |
| 1. Main Unit (Power Base) | |
| (A) Servicing the main unit (Power Base) | P. 4-5 |
| (B) Possible symptoms for each fault location | P. 6 |
| (C) Flow chart for troubleshooting fault locations | P. 7 |
| (D) Trouble shooting guide | P. 8-9 |
| 2. Software | P. 10 |
| 3. Auto Switchboxes and Cables | P. 11 |
| 4. Controller Related | P. 12 |
| * Schematic Diagram | P. 13-14 |
| * Parts Location | P. 15 |
| | |
| Parts List | P. 16 |
| 1. Master System (Power Base) | P. 17-18 |
| 2. PC Main M4 | P. 19-21 |
| 3. Control Pad | P. 22-23 |
| 4. Light Phaser | P. 24-26 |
| | |
| PARTS PRICE LIST | P. 27 |
| 1. SEGA Master System (RGB) | P. 28 |
| 2. SEGA Master System (PAL-I) | P. 29 |
| 3. SEGA Master System (PAL-B) | P. 30 |
| 4. SEGA Master System (PAL-G) | P. 31 |
| 5. SEGA Light Phaser | P. 32 |

Service Procedures

1. The system is divided into four blocks:
(1) Main unit (Power base); (2) Software; (3) Auto switchboxes and cables; (4) Controller related
2. Use a tester to check for continuity and confirm that there are no short circuits between the power and ground.
3. Check by individual block:
Set up a complete, well-operating system as a control; one by one, connect the blocks of the system to be tested to the control system and determine whether the system operates properly with the exchanged blocks.
4. Service by individual block:
When the source of the malfunction has been narrowed down to the relevant block, service that block or blocks in accordance with the appropriate service procedures.

1. Main Unit (Power Base)

(A) Servicing the main unit (Power Base)

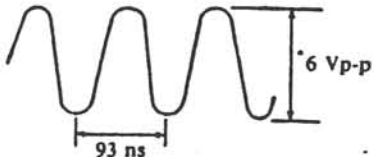
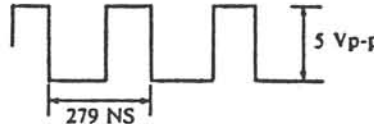
| Parts Test Procedure | Fault Location | Symptoms |
|--|---|---|
| <p>1. IC8(7805) power check. (1) IN DC 9 V. (2) OUT DC 5 V.</p> | <p>1. IC8 (7805) faulty. 2. Soldering faulty. 3. Short circuit. 4. Printed circuit board (PCB) pattern is cut. 5. POWER switch faulty. 6. Heat sink attachment faulty.</p> | <p>1. LED doesn't light. 2. No picture.</p> |
| <p>2. Power check of ICs. (1) Is Vcc 5 V power present?</p> | <p>1. PCB pattern is cut. 2. Soldering faulty.</p> | <p>1. No picture. 2. Screen is black.</p> |
| <p>3. Is reset circuit operating? (1) Use tester to measure voltage of JR. Should be 0—3.6 V (slowly rises).</p> | <p>1. Capacitor (C131) faulty. 2. Soldering faulty. 3. Resistor (R130) faulty.</p> | <p>1. No picture. 2. Screen is black.</p> |
| <p>4. Is oscillator circuit operating? (1) Pin 30 of IC5: AC 6 Vp-p; 10.738635 MHz \pm 100 Hz.</p>  <p>(2) Pin 34 of IC5 clock: 3.579545 MHz \pm 30 Hz</p>  | <p>1. XTAL(10M) faulty. 2. C107, C108 faulty. 3. Soldering faulty. 4. PCB pattern is cut. 5. IC5 faulty. 6. Frequency exceeds allowable deviation.</p> | <p>1. No picture. 2. Color may be monochromatic.</p> |
| <p>5. Check connectors. (1) Make visual check of connector pins. (2) Check for faulty soldering connections.</p> | <p>1. Broken from excessive weight. 2. Soldering faulty. 3. PCB pattern is cut. 4. Terminal plugs are dirty.</p> | <p>1. No picture. 2. Picture is monochromatic. 3. Characters are unnatural. 4. Controls do not respond properly.</p> |

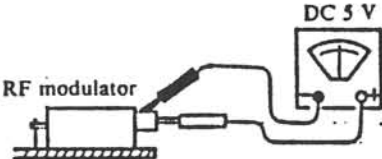
| Parts Test Procedure | Fault Location | Symptoms |
|---|---|---|
| <p>6. Check button switches. (1) Check power button switch.</p> <p>(2) Check reset button switch. (3) Check pause button switch.</p> | <p>1. Switch is loose. 2. Soldering faulty 3. PCB pattern is cut. 4. Switch is short-circuited.</p> <p>1. Soldering faulty. 2. PCB pattern is cut. 3. Blade is not parallel with circuit board. 4. Switch is short-circuited.</p> | <p>1. No power voltage present. 2. LED doesn't light. 3. No picture. 4. Reset occurs spontaneously. 5. Characters suddenly appear abnormal.</p> <p>1. Reset doesn't respond properly. 2. Pause doesn't operate properly.</p> |
| <p>7. Check RF modulator. (1) Is OUT +5 V present?</p>  <p>(2) Check channel selector: Are CH3 and CH4 okay?</p> | <p>1. PCB pattern is cut. 2. Soldering faulty. 3. RF modulator is faulty.</p> <p>1. RF modulator is faulty.</p> | <p>1. No picture. 2. Picture appears dirty. 3. No sound. 4. Much audio noise.</p> <p>1. CH3 appears but not CH4. 2. CH4 appears but not CH3.</p> |
| <p>8. Check CON 1. (1) R23 DC 1.3 V (VIDEO) without load. (2) 6.5.8 DC 1.9 V (RGB) without load.</p> | <p>1. Various problems are conceivable. In event system is not operating at all. 2. In event IC9 is faulty.</p> | <p>1. No picture.</p> |

(B) Possible symptoms for each fault location

| Fault Location (Contents of malfunction) | Symptom |
|---|---|
| 1. When IC1 (CPU) is faulty. | 1. System doesn't operate at all. No picture at all. |
| 2. When IC2 (OS ROM) is faulty. | 1. Since this is the program which operates the system, no picture will appear. 2. Depending on the case, a mosaic pattern may appear. |
| 3. When IC3 RAM is faulty. | 1. Since this is the unit that temporarily records data, no picture will appear. 2. Depending on the case, a picture may appear, but it is easily distorted. |
| 4. When IC4 is faulty. | 1. Since this IC emits several control signals, no picture will appear. 2. Controller may not respond properly. 3. Pause, reset may not respond properly. |
| 5. When IC5 is faulty. | 1. If no oscillation is present, clock 3.58 MHz is not produced, with result that system does not operate at all; no picture will appear. 2. In addition, several control signals are involved; if fault is present, system will not operate and no picture will appear. 3. Even if a picture appears, characters may be distorted. 4. Colors may be improper. 5. Sound may appear alone without picture. 6. Picture may appear alone without sound. |
| 6. When IC6, IC7 are faulty. | 1. Since these parts are responsible for temporarily storing color data, picture may not appear. 2. Even if picture appears, colors may be improper. 3. Characters may be distorted. 4. Picture may be move sluggishly or jerkily. |
| 7. When IC8 is faulty. | 1. Since this is +5 V stabilized current, if malfunction is present, uniform +5 V is not present; system will not operate and no picture will appear. 2. LED doesn't light. |
| 8. When IC9 is faulty. | 1. Since this part converts the RGB signal to composite mode, a malfunction will result in no picture. 2. Even if a picture appears, color may be abnormal. |

(C) Flow chart for troubleshooting fault locations

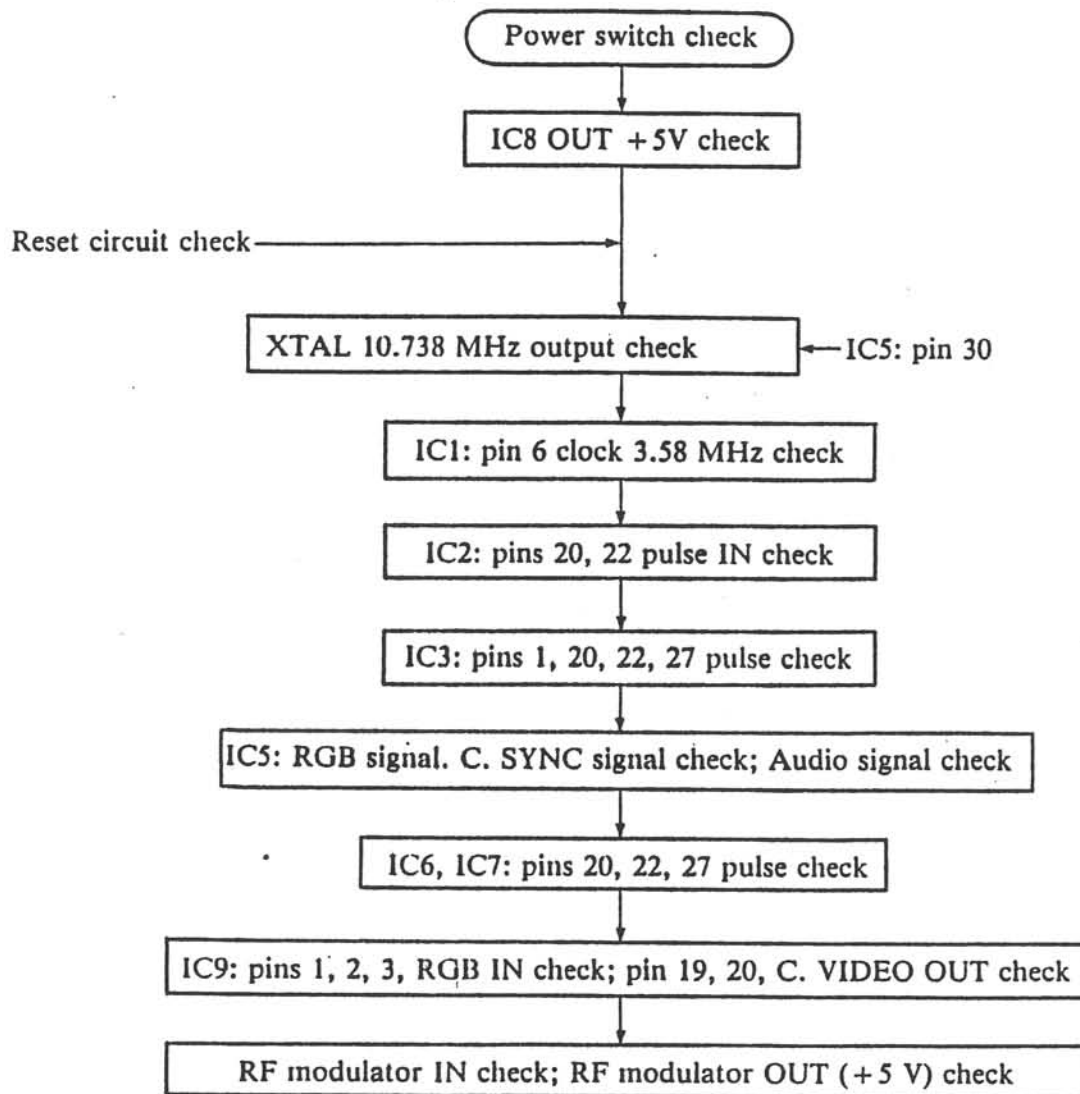

(D) Troubleshooting guide

a) In event controls do not respond normally

| Symptom(s) | Fault Location(s) |
|---|--|
| <ol style="list-style-type: none">1. Game doesn't start.2. Button may not respond when pressed.3. Absolutely no response at all. | <ol style="list-style-type: none">1. CON5 or CON6 faulty (disconnection).2. Soldering faulty.3. PCB pattern is cut.4. IC is faulty.5. EMI filter is faulty.6. Resistor 330 ohm is faulty.7. Check for continuity between CON5 and CON6 terminals and terminals of IC4. |
| <ol style="list-style-type: none">4. Demonstration screen doesn't appear.5. Switch stays depressed in middle of game.6. Switch remains fixed in one direction.7. Starts by itself. | <ol style="list-style-type: none">1. CON5 or CON6 is faulty (short-circuited)2. Soldering is short-circuited.3. PCB pattern is short-circuited.4. IC4 is faulty. |

b) In event picture appears alone without sound

| Service Procedures | Fault Location |
|---|---|
| <ol style="list-style-type: none">1. Check whether audio signal is present between pins 1 and 2 of CN1. When a mini-speaker or earphone is connected, sound can be heard.2. Is audio signal output from pin 10 of IC5?<ol style="list-style-type: none">1) MAX 300 mVp-p2) 20 Hz—20 kHz | <ol style="list-style-type: none">1. CN1 is faulty.2. Soldering faulty.3. PCB pattern is cut.4. Q48, C49, R47 are faulty.5. R46 is faulty.6. IC5 is faulty.7. RF modulator is faulty. |

c) In event picture is not present

| Service Procedures | Fault Location |
|--|---|
| <ol style="list-style-type: none">1. Is video signal present between pins 3 and 2 of CN1?2. Is video signal present at pin 3 of RF modulator?3. Is video signal output from pins 19 and 20 of IC9?4. Is RGB signal output from pins 23, 22, and 21 of IC9?5. Is RGB signal present at pins 1, 2, and 3 of IC9? | <ol style="list-style-type: none">1. C28, R27 is absent or faulty.2. CN1 is faulty.3. Soldering faulty.4. PCB pattern is cut.5. RF modulator is faulty (when picture is present on RF)6. IC9 is faulty.7. Peripheral parts around IC9 are faulty. |

2. Software

Software (Card or Cartridge) Malfunctions

| Symptoms | Fault Location |
|--|---|
| <p>1. No picture. Picture remains monochromatic. Picture is mosaic pattern.</p> | <p>1. Connector (50 pin) is dirty, disconnected, or other connection fault. 2. Soldering faulty. 3. Short-circuit. 4. Capacitor is missing or faulty. 5. IC is damaged from overheating or static electricity.</p> |
| <p>2. Characters are disrupted suddenly in middle of game. Reset occurs spontaneously in middle of game. Other abnormal symptoms appear in middle of game.</p> | <p>1. Connection fault at connector (50 pin). 2. Soldering faulty. 3. Capacitor is missing or faulty. 4. IC runaway overheating. 5. In the case of number 4 above, the problem may be rectified by adding a capacitor 100PF—180PF at A13 (address 13). 6. IC is faulty.</p> |

3. Auto Switchboxes and Cables

a) Auto switchbox

| Symptoms | Fault Location |
|---|--|
| 1. No picture. Game picture doesn't appear. TV picture doesn't appear. | 1. Cable is cut or shorted. 2. Plug is faulty. 3. Soldering is faulty on cable connection terminal. 4. PCB pattern is broken or interrupted. 5. Auto-switcher unit is faulty. |
| 2. Sound is bad. Much audio noise. | 1. Cable is cracked. 2. Soldering faulty. 3. Plug connection is faulty. 4. Auto switcher is faulty (adjustment faulty). |

b) Video Cable

| Symptoms | Fault Location |
|---|---|
| 1. No picture. No sound. | 1. Cable or plug is faulty; replace all. |

c) AC adaptor

| Symptoms | Fault Location |
|--|------------------------|
| 1. No picture. 2. LED doesn't light. 3. 13 V \pm 1 V not produced (without load) | 1. Replace all. |

4. Controller Related

Control pads

| Symptoms | Fault Location |
|---|--|
| 1. Controller does not operate. Doesn't move as it should. Game doesn't start. | 1. Cable is cut. 2. Faulty connection at connector. 3. PCB pattern is cut. 4. Conductive rubber is faulty. 5. Soldering faulty. |
| 2. Moves spontaneously by itself. Switch remains depressed in one direction. | 1. Cable is shorted. 2. Solder is greasy. 3. Conductive rubber is stuck. |

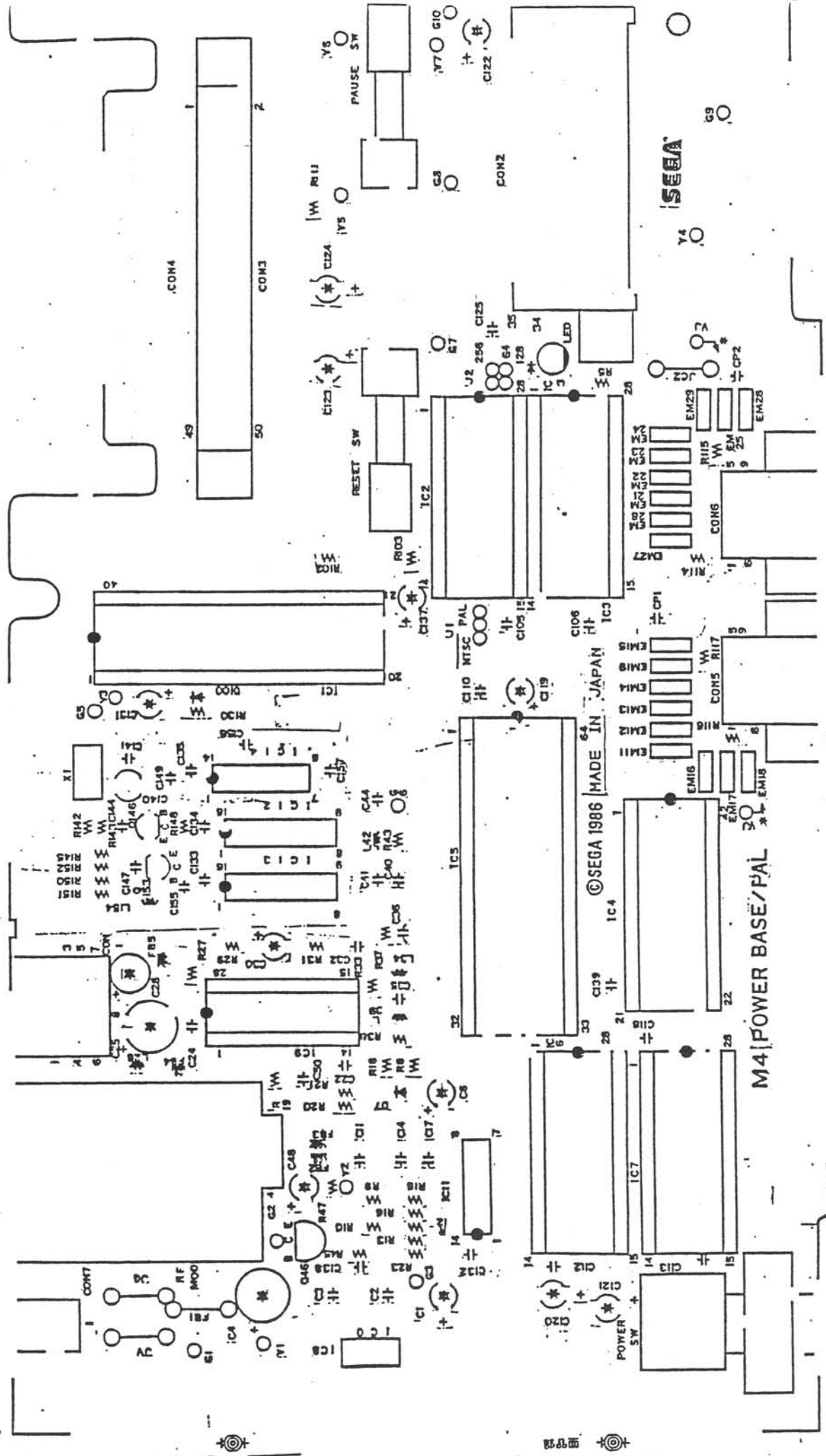

SEGA

© SEGA 1986 MADE IN JAPAN

M4 POWER BASE/PAL

PC MAIN M4

PARTS LIST

1. Master System (Power Base)

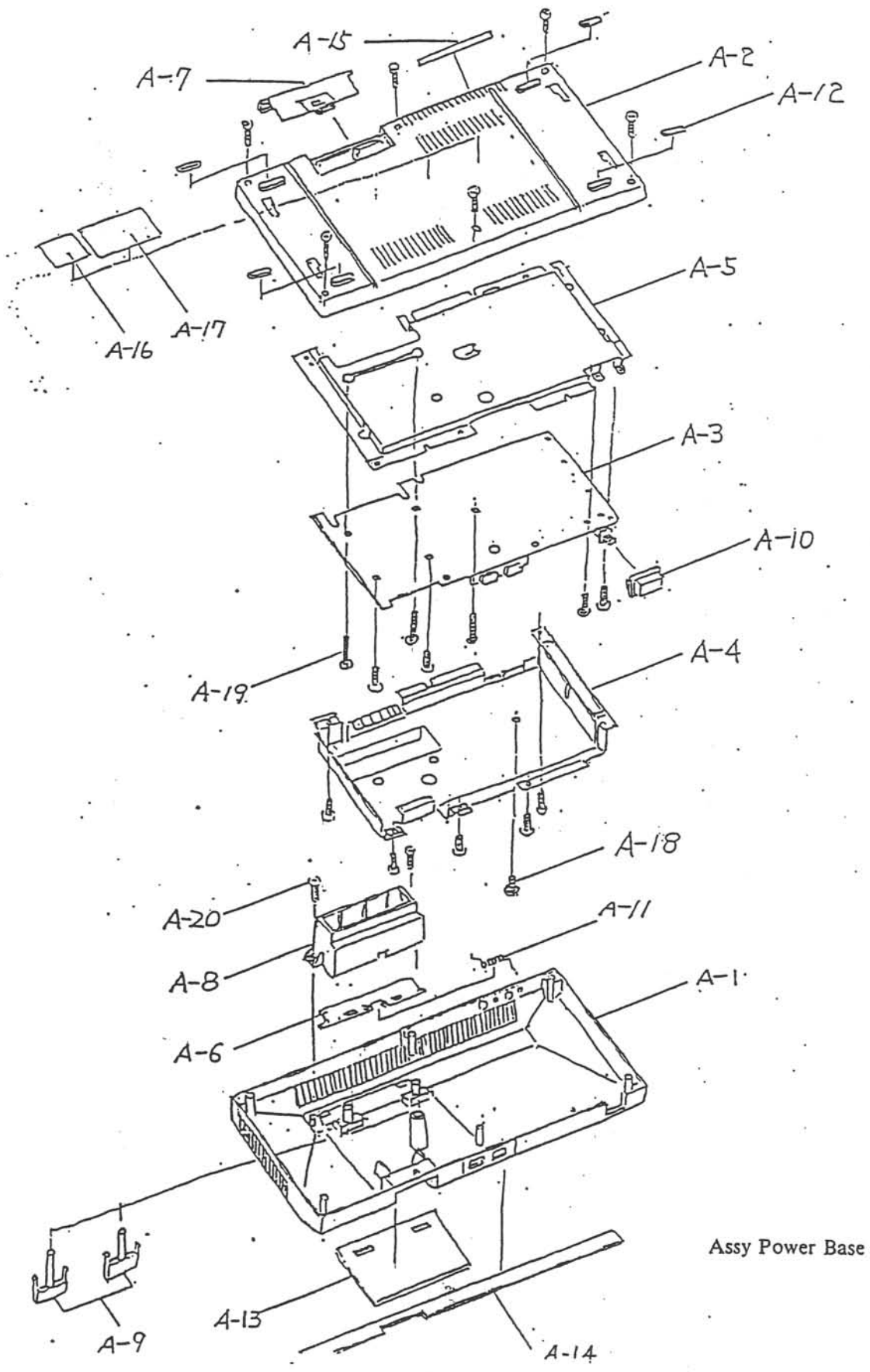

Assy Power Base

| Description No. | Part No. | Description | Note | Q'ty |
|-----------------|--------------|-------------------------|------------------------------|------|
| | 610-0034-03 | Assy Power Base AS | (Australia) | 1 |
| | 610-0034-05 | Assy Power Base UK | (United Kingdom) | 1 |
| | 610-0034-06 | Assy Power Base Spain | | 1 |
| | 610-0034-11 | Assy Power Base HK | (Hong Kong) | 1 |
| | 610-0034-13 | Assy Power Base ITA | (Italy) | 1 |
| | 610-0034-18 | Assy Power Base WG | (West Germany) | 1 |
| | 610-0034-20 | Assy Power Base Holland | | 1 |
| A-1 | 253-6007 | Top Case PB | | 1 |
| A-2 | 253-6014 | Bottom Case PB | | 1 |
| | 837-6097 | IC Board PB PAL-G | (Spain ITA WG Holland) | 1 |
| A-3 | 837-6118 | IC Board PB PAL-B | (AS) | 1 |
| | 837-6135 | IC Board PB PAL-I | (UK HK) | 1 |
| A-4 | 250-5023 | Shield Plate PB Top | | 1 |
| A-5 | 250-5022 | Shield Plate PB Bottom | (WG Only) | 1 |
| A-6 | 253-6009 | Lid A | | 1 |
| A-7 | 253-6015 | Lid B | | 1 |
| A-8 | 253-6010 | Cover PB | | 1 |
| A-9 | 253-6008 | Button PB | | 1 |
| A-10 | 253-6013 | Power Button PB | | 1 |
| A-11 | 125-5016 | Torsion Spring | | 1 |
| A-12 | 601-5514 | Rubber Foot | | 1 |
| A-13 | 253-6011 | Panel PB | | 1 |
| A-14 | 253-6012 | Inst Panel PB | | 1 |
| | 421-6419 | Seal RF | (AS) | 1 |
| A-15 | 421-6419-18 | Seal RF Ger | (UK Spain HK ITA WG Holland) | 1 |
| | 421-6394-03 | Seal Ser No AS | | 1 |
| | 421-6394-05 | Seal Ser No UK | | 1 |
| | 421-6394-06 | Seal Ser No Spain | | 1 |
| A-16 | 421-6394-11 | Seal Ser No HK | | 1 |
| | 421-6394-13 | Seal Ser No ITA | | 1 |
| | 421-6394-18 | Seal Ser No Ger | | 1 |
| | 421-6394-20. | Seal Ser No Holland | | 1 |
| A-17 | 421-6429 | Seal RFI Mark | | 1 |
| A-18 | 000-0306-S | M Scr PH 3 x 6 W/S | | 1 |
| A-19 | 029-0072 | Tap Scr PH 3 x 16 Blk | | 1 |
| A-20 | 012-0312 | Tap Scr PH 3 x 12 | | 1 |

2. PC Main M4

MARK 4 PART LIST PAL TYPE

| Description No. | Part No. | Description | Note | Q'ty |
|-----------------|------------|--------------------------------|-------------------------------|------|
| JV | 271-0005 | BEADS INDUCTOR FBA04VA600AB | | 1 |
| JG | 271-0005 | BEADS INDUCTOR FBA04VA600AB | | 1 |
| FB1 | 271-0005 | BEADS INDUCTOR FBA04VA600AB | | 1 |
| FB2 | 271-0005-1 | BEADS INDUCTOR FBA04VA600AB | | 1 |
| FB3 | 271-0005-1 | BEADS INDUCTOR FBA04VA600AB | | 1 |
| FB4 | 271-0005-1 | BEADS INDUCTOR FBA04VA600AB | | 1 |
| FB5 | 271-0005-1 | BEADS INDUCTOR FBA04VA600AB | | 1 |
| C1 | 150-0023 | CAP E | 10 μ F 16 V U-TYPE | 1 |
| C2 | 150-0060 | CAP CER | 0.1 μ F 16 V | 1 |
| C3 | 150-0060 | CAP CER | 0.1 μ F 16 V | 1 |
| C4 | 150-0047 | CAP E | 100 μ F 10 V U-TYPE | 1 |
| R5 | 497-0121 | RES | 120 Ω 1/6 W \pm 5% | 1 |
| C6 | 150-0007 | CAP E | 4.7 μ F 16 V U-TYPE | 1 |
| D7 | 481-5045 | DIODE | ISS133 (1S2473) | 1 |
| | (481-0149) | | | |
| R8 | 479-0103 | RES | 10 K Ω 1/6 W \pm 5% | 1 |
| R9 | 479-0332 | RES | 3.3 K Ω 1/6 W \pm 5% | 1 |
| R10 | 479-0332 | RES | 3.3 K Ω 1/6 W \pm 5% | 1 |
| C11 | 151-0060 | CAP CER | 0.1 μ F 16 V | 1 |
| R12 | 479-0332 | RES | 3.3 K Ω 1/6 W \pm 5% | 1 |
| R13 | 479-0332 | RES | 3.3 K Ω 1/6 W \pm 5% | 1 |
| C14 | 151-0060 | CAP CER | 0.1 μ F 16 V | 1 |
| R15 | 479-0332 | RES | 3.3 K Ω 1/6 W \pm 5% | 1 |
| R16 | 479-0332 | RES | 3.3 K Ω 1/6 W \pm 5% | 1 |
| C17 | 151-0060 | CAP CER | 0.1 μ F 16 V | 1 |
| R18 | 479-0103 | RES | 10 K Ω 1/6 W \pm 5% | 1 |
| R19 | 479-0103 | RES | 10 K Ω 1/6 W \pm 5% | 1 |
| R20 | 479-0332 | RES | 3.3 K Ω 1/6 W \pm 5% | 1 |
| R21 | 479-0102 | RES | 1 K Ω 1/6 W \pm 5% | 1 |
| C22 | 151-0201 | CAP CER | 82 pF 50 V CH TYPE | 1 |
| R23 | 479-0222 | RES | 2.2 K Ω 1/6 W \pm 5% | 1 |
| C24 | 151-0060 | CAP CER | 0.1 μ F 16 V | 1 |
| C25 | 150-0047 | CAP E | 100 μ F 10 V U-TYPE | 1 |
| L26 | 180-0049-1 | PEAKING COIL | 10 μ H 02TYPE | 1 |
| R27 | 479-0750 | RES | 75 Ω 1/6 W \pm 5% | 1 |
| C28 | 150-0047 | CAP E | 100 μ F 10 V U-TYPE | 1 |
| R29 | 479-0122 | RES | 1.2 K Ω 1/6 W \pm 5% | 1 |
| C30 | 150-0062 | CAP E | 47 μ F 10 V U-TYPE | 1 |
| R31 | 479-0222 | RES | 2.2 K Ω 1/6 W \pm 5% | 1 |
| C32 | 151-0060 | CAP CER | 0.1 μ F 16 V | 1 |
| R33 | 479-0102 | RES | 1 K Ω 1/6 W \pm 5% | 1 |
| L34 | 180-5032 | PEAKING COIL | 100 μ H 02TYPE | 1 |
| C35 | 151-0190 | CAP CER | 12 pF 50 V CH TYPE | 1 |
| C36 | 151-0172 | CAP CER | 180 pF 50 V CH TYPE | 1 |
| R37 | 479-0102 | RES | 1 K Ω 1/6 W \pm 5% | 1 |
| R38 | 479-0102 | RES | 1 K Ω 1/6 W \pm 5% | 1 |
| L39 | 180-5033 | PEAKING COIL | 12 μ H 02TYPE | 1 |

| Description No. | Part No. | Description | Note | Q'ty |
|-----------------|------------------------|--------------|-------------------------------|------|
| C40 | 151-0159 | CAP CER | 100 pF 50 V CH TYPE | 1 |
| C41 | 151-0190 | CAP CER | 12 pF 50 V CH TYPE | 1 |
| L42 | 180-5032 | PEAKING COIL | 100 μ H 02TYPE | 1 |
| R43 | 479-0102 | RES | 1 K Ω 1/6 W \pm 5% | 1 |
| C44 | 151-0058 | CAP CER | 0.01 μ F 16 V | 1 |
| R45 | 479-0222 | RES | 2.2 K Ω 1/6 W \pm 5% | 1 |
| Q46 | 482-0261 | XSTR | 2SC1740 (R or Q) | 1 |
| R47 | 479-0103 | RES | 10 K Ω 1/6 W \pm 5% | 1 |
| C48 | 150-0023 | CAP E | 10 μ F 16 V U-TYPE | 1 |
| C50 | 151-0058 | CAP CER | 0.01 μ F 16 V | 1 |
| D100 | 481-5045 (481-0149) | DIODE | ISSI33 (1S2473) | 1 |
| R102 | 479-0472 | RES | 4.7 K Ω 1/6 W \pm 5% | 1 |
| R103 | 479-0472 | RES | 4.7 K Ω 1/6 W \pm 5% | 1 |
| C105 | 151-0060 | CAP CER | 0.1 μ F 16 V | 1 |
| C106 | 151-0060 | CAP CER | 0.1 μ F 16 V | 1 |
| C110 | 151-0060 | CAP CER | 0.1 μ F 16 V | 1 |
| R111 | 479-0472 | RES | 4.7 K Ω 1/6 W \pm 5% | 1 |
| C112 | 151-0060 | CAP CER | 0.1 μ F 16 V | 1 |
| C113 | 151-0060 | CAP CER | 0.1 μ F 16 V | 1 |
| R114 | 479-0331 | RES | 330 Ω 1/6 W \pm 5% | 1 |
| R115 | 479-0331 | RES | 330 Ω 1/6 W \pm 5% | 1 |
| R116 | 479-0331 | RES | 330 Ω 1/6 W \pm 5% | 1 |
| R117 | 479-0331 | RES | 330 Ω 1/6 W \pm 5% | 1 |
| C118 | 151-0060 | CAP CER | 0.1 μ F 16 V | 1 |
| C119 | 150-0023 | CAP E | 10 μ F 16 V U-TYPE | 1 |
| C120 | 150-0023 | CAP E | 10 μ F 16 V U-TYPE | 1 |
| C121 | 150-0023 | CAP E | 10 μ F 16 V U-TYPE | 1 |
| C122 | 150-0062 | CAP E | 47 μ F 10 V U-TYPE | 1 |
| C123 | 150-0062 | CAP E | 47 μ F 10 V U-TYPE | 1 |
| C124 | 150-0062 | CAP E | 47 μ F 10 V U-TYPE | 1 |
| C125 | 151-0172 | CAP CER | 180 pF 50 V CH TYPE | 1 |
| R130 | 479-0104 | RES | 100 K Ω 1/6 W \pm 5% | 1 |
| C131 | 150-0023 | CAP E | 10 μ F 16 V U-TYPE | 1 |
| C132 | 151-0060 | CAP CER | 0.1 μ F 16 V | 1 |
| C133 | 151-0060 | CAP CER | 0.1 μ F 16 V | 1 |
| C134 | 151-0060 | CAP CER | 0.1 μ F 16 V | 1 |
| C135 | 151-0060 | CAP CER | 0.1 μ F 16 V | 1 |
| C137 | 150-0023 | CAP E | 10 μ F 16 V U-TYPE | 1 |
| C138 | 151-0172 | CAP CER | 180 pF 50 V CH TYPE | 1 |
| C139 | 151-0018 | CAP CER | 150 pF 50 V | 1 |
| CP1 | 151-0060 | CAP CER | 0.1 μ F 16 V | 1 |
| CP2 | 151-0060 | CAP CER | 0.1 μ F 16 V | 1 |
| C140 | 151-5004 | CAP TRIMMER | 30 pF | 1 |
| C141 | 151-0160 | CAP CER | 10 pF 50 V CH TYPE | 1 |
| R142 | 479-0103 | RES | 10 K Ω 1/6 W \pm 5% | 1 |
| R143 | 479-0512 | RES | 5.1 K Ω 1/6 W \pm 5% | 1 |
| C144 | 151-0161 | CAP CER | 22 pF 50 V CH TYPE | 1 |
| R145 | 479-0201 | RES | 200 Ω 1/6 W \pm 5% | 1 |
| Q146 | 482-0270 | XSTR | 2SC1907 | 1 |
| C147 | 151-0008 | CAP CER | 1000 pF 50 V | 1 |
| R148 | 479-0101 | RES | 100 Ω 1/6 W \pm 5% | 1 |

| Description No. | Part No. | Description | Note | Q'ty |
|-----------------|---|--|---|------|
| C149 | 151-0202 | CAP CER | 39 PF 50 V CH TYPE | 1 |
| R150 | 479-0183 | RES | 18 K Ω 1/6 W \pm 5% | 1 |
| R151 | 479-0332 | RES | 3.3 K Ω 1/6 W \pm 5% | 1 |
| R152 | 479-0271 | RES | 270 Ω 1/6 W \pm 5% | 1 |
| Q153 | 482-0270 | XSTR | 2SC1907 | 1 |
| L154 | 180-5032 | PEAKING COIL | 100 μ H 02 TYPE | 1 |
| C155 | 151-0060 | CAP CER | 0.1 μ F 16 V | 1 |
| C156 | 151-0002 | CAP CER | 100 pF 50 V | 1 |
| C157 | 151-0002 | CAP CER | 100 pF 50 V | 1 |
| EM11 | 271-0007 | EMI FILTER | 2200 pF | 1 |
| EM12 | 271-0007 | EMI FILTER | 2200 pF | 1 |
| EM13 | 271-0007 | EMI FILTER | 2200 pF | 1 |
| EM14 | 271-0007 | EMI FILTER | 2200 pF | 1 |
| EM15 | 271-0007 | EMI FILTER | 2200 pF | 1 |
| EM16 | 271-0007 | EMI FILTER | 2200 pF | 1 |
| EM17 | 271-0006 | EMI FILTER | 270 pF | 1 |
| EM18 | 271-0007 | EMI FILTER | 2200 pF | 1 |
| EM19 | 271-0007 | EMI FILTER | 2200 pF | 1 |
| EM21 | 271-0007 | EMI FILTER | 2200 pF | 1 |
| EM22 | 271-0007 | EMI FILTER | 2200 pF | 1 |
| EM23 | 271-0007 | EMI FILTER | 2200 pF | 1 |
| EM24 | 271-0007 | EMI FILTER | 2200 pF | 1 |
| EM25 | 271-0007 | EMI FILTER | 2200 pF | 1 |
| EM26 | 271-0007 | EMI FILTER | 2200 pF | 1 |
| EM27 | 271-0006 | EMI FILTER | 270 pF | 1 |
| EM28 | 271-0007 | EMI FILTER | 2200 pF | 1 |
| EM29 | 271-0007 | EMI FILTER | 2200 pF | 1 |
| XI | 230-5035 | CRYSTAL | 53.203424MHz \pm 5 ppm | 1 |
| LED | 390-5128 | LED | SLP-280U-F50 GREEN | 1 |
| IC1 | 315-0041 | IC | Z80ACPU | 1 |
| IC2 | MPR-10052 | IC | ROM CXK3864P-20 | 1 |
| IC3 | 315-0298 | IC | RAM μ PD4168-20 | 1 |
| IC4 | (315-0298-15) 315-5216 (315-5204) | IC | (or μ PD4168-15) CUSTOM CHIP G/A FUJITSU (or NEC) | 1 |
| IC5 | 315-5124 | IC | CUSTOM CHIP VDP | 1 |
| IC6 | 315-0298-15 | IC | RAM μ PD4168-15 | 1 |
| IC7 | 315-0298-15 | IC | RAM μ PD4168-15 | 1 |
| IC8 | 313-0092 | IC | REG 7805 | 1 |
| IC9 | 313-5054 | IC | RGB ENCODER V7040 | 1 |
| IC11 | 314-0062 | IC | 74LS74 | 1 |
| IC12 | 314-0355 | IC | 74ALS174 | 1 |
| IC13 | 314-0356 | IC | 74ALS175 | 1 |
| IC14 | 314-0358 | IC | 74ALS74 | 1 |
| CON1 | 212-5106 | DIN CONNECTOR 8P B-TYPE | | 1 |
| CON2 | 209-5020 | CARD CONNECTOR 35P | | 1 |
| CON3 | 209-5023-01 (209-5023) | EDGE CONNECTOR 50P MITSUMI (or BANDY) | | 1 |
| CON5 | 209-5017-01 | D-SUB CONNECTOR 9P | | 1 |
| CON6 | 209-5017-01 | D-SUB CONNECTOR 9P | | 1 |
| CON7 | 212-5004 | POWER JACK | | 1 |
| POWER SW | 509-5150 | PUSH SWITCH | | 1 |
| RESET SW | 509-5031 | BLADE SWITCH | | 1 |
| PAUSE SW | 509-5031 | BLADE SWITCH | | 1 |

3. Control Pad

ASSY CONTROL PAD 610-0180

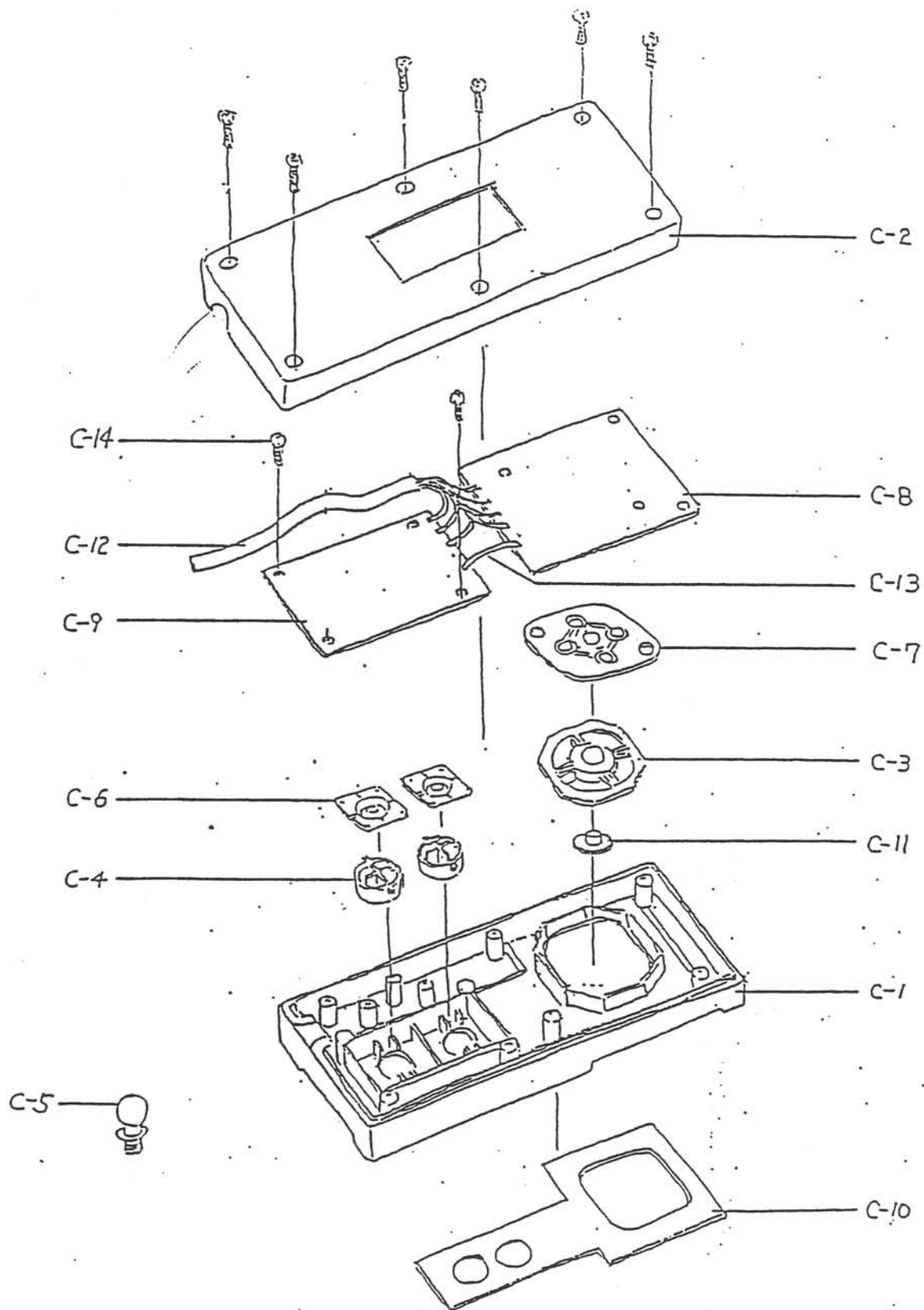

| Description No. | Part No. | Description | Note | Q'ty |
|-----------------|--------------|---------------------------|--------------------|------|
| C-1 | 253-6020 | Top Case 3020 | | 1 |
| C-2 | 253-6021 | Bottom Case 3020 | | 1 |
| C-3 | 253-6024 ✓ | Pad 3020 | | 1 |
| C-4 | 253-6023 | Button 3020 | | 2 |
| C-5 | 253-5071 | Stick SJ-150 | W/Poly Bag (2 set) | 1 |
| C-6 | 509-5089-1 ✓ | Rubber Contact 1P SJ-151 | | 2 |
| C-7 | 509-5090-1 ✓ | Rubber Contact 4P SJ-151 | | 1 |
| C-8 | 171-5193-3 | PC Board 45 x 38 3020 | | 1 |
| C-9 | 171-5194-2 | PC Board 51 x 31 3020 | | 1 |
| C-10 | 253-6022 | Instruction Plate 3020 | | 1 |
| C-11 | 253-6032 | Blind Cover 3020 | | 1 |
| C-12 | 600-5306 ✓ | Assy Cable 9P L = 2m 3020 | | 1 |
| C-13 | 600-5137-1 | Jumper Wire SJ-151 | | 1 |
| C-14 | 012-0208-1 | Tap Scr PH No.1 2 x 8 | | 6 |

4. Light Phaser

ASSY LIGHT PHASER

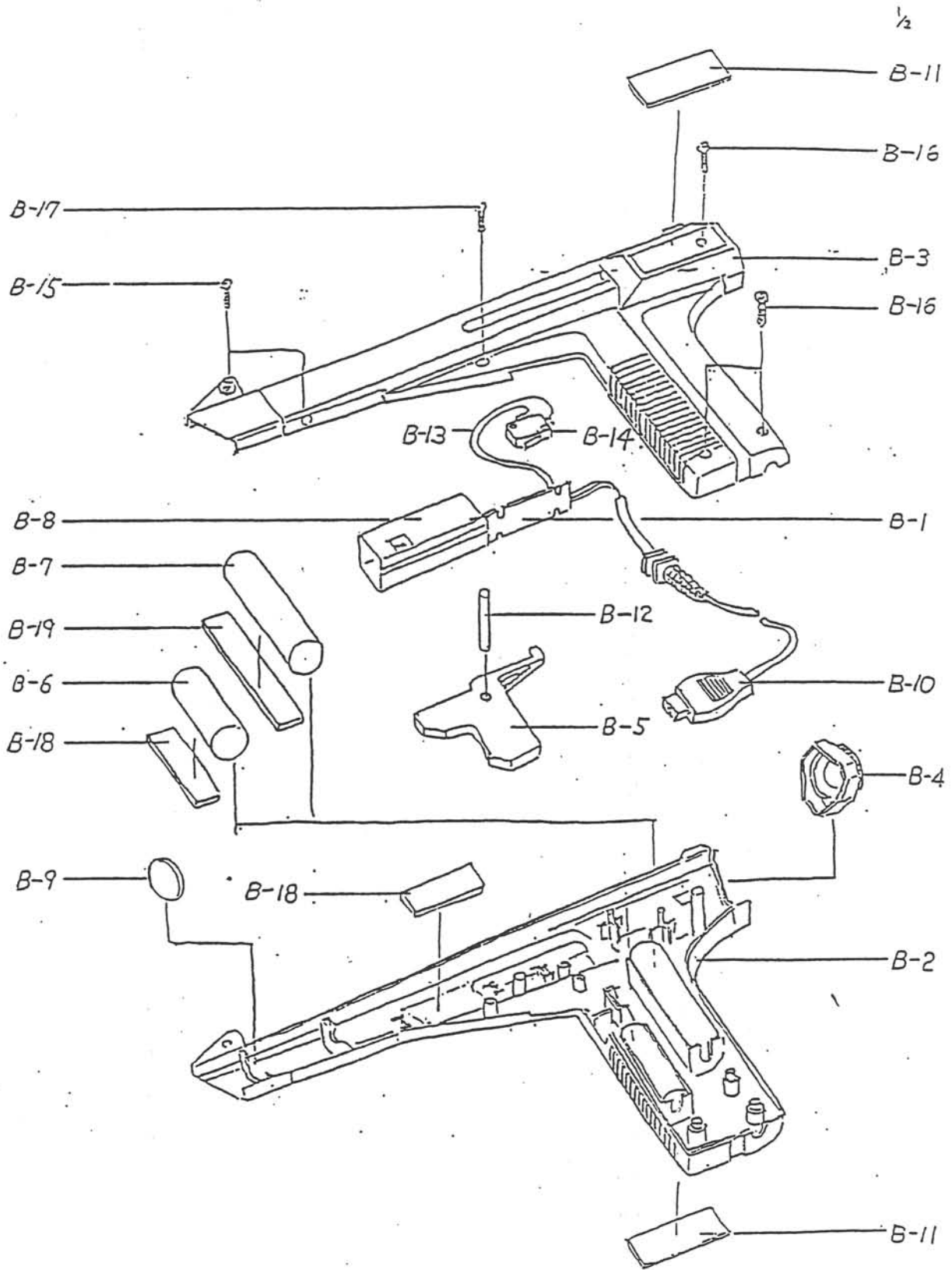

610-0035

| Description No. | Part No. | Description | Note | Q'ty |
|-----------------|-------------|---|---------------------|-------|
| B-1 | 837-6068 | PC Board Light Phaser | | 1 |
| B-2 | 253-6027 | Right Case LP | | 1 |
| B-3 | 253-6028 | Left Case LP | | 1 |
| B-4 | 253-6029 | Case Cover LP | | 1 |
| B-5 | 253-6030 | Trigger LP | | 1 |
| B-6 | 250-5020 | Weight A | | 1 |
| B-7 | 250-5021 | Weight B | | 1 |
| B-8 | 250-5024 | Shield Cover LP | | 1 |
| B-9 | 380-5003 | Lens LP | | 1 |
| B-10 | 600-5299 | Cord Assy LP | | 1 |
| B-11 | 421-6396 | Seal LP | | 2 |
| B-12 | 123-5011 | Shaft LP | | 1 |
| B-13 | 600-5010-10 | Cable Vinyl Single 1.5 mm/mm 0.8 x 16 Str. | Red | 0.2 m |
| B-14 | 509-5151 | Switch Micro Type V-151-3A5 or (AH71517) | Omron or Matsushita | 1 |
| B-15 | 029-0068 | Tap Scr PH 2 x 6 Blk | | 2 |
| B-16 | 029-0069 | Tap Scr PH 2.6 x 10 Blk | | 3 |
| B-17 | 029-0070 | Tap Scr PH 2.6 x 8 Blk | | 1 |
| B-18 | 601-5588 | RUBBER CUSHION A | | 2 |
| B-19 | 601-5589 | RUBBER CUSHION B | | 1 |

LIGHT PHASER

LIGHT PHASER

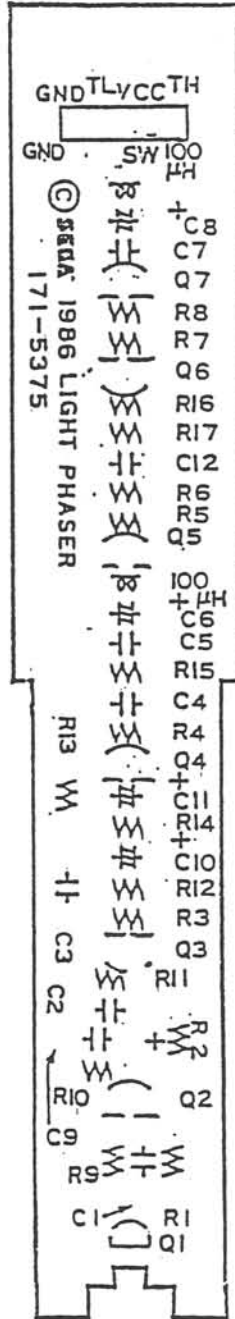

SEGA MASTER SYSTEM

PARTS PRICE LIST

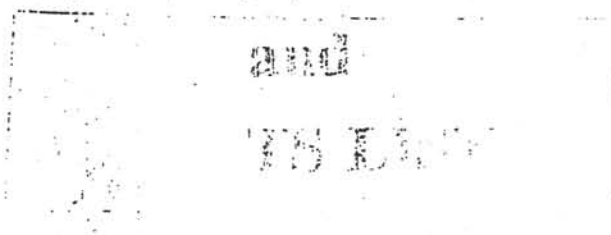

SEGA[®]

SEGA ENTERPRISES, LTD.

PARTS PRICE LIST FOR SEGA POWER SYSTM (RGB)

P-1/1

| PARTS NO. | PARTS NAME | FOB PRICE |
|-------------|------------------------------------|-----------|
| 400-5048Y | AC ADAPTER | ¥767 |
| 271-0005 | BEADS INDUCTOR FBA04VA600AB | ¥6 |
| 271-0005-1 | BEADS INDUCTOR FBA04VA600VB | ¥7 |
| 610-0030 | BOTTOM CASE ASSY PB | ¥319 |
| 253-6008 | BUTTON PB | ¥18 |
| 209-5020 | CARD CONNECTOR 35P PRE35R-1 | ¥148 |
| 610-0180 | CONTROL PAD ASSY | ¥429 |
| 209-5017-01 | D-SUB 9P ANGLE TYPE UC-0060#2 | ¥43 |
| 212-5106 | DIN CONN 8P B-TYPE UC-0059#2 | ¥51 |
| 481-0149 | DIODE 1S2473 | ¥4 |
| 481-5038 | DIODE 1SR-35-100A | ¥10 |
| 209-5023 | EDGE CONNECTOR 50P PSB4D25S-4RI | ¥127 |
| 271-0006 | EMI FILTER STB271KB | ¥12 |
| 271-0007 | EMI FILTER STX222MB | ¥12 |
| 315-5216 | IC CUSTOM CHIP G/A | ¥216 |
| 315-5124 | IC CUSTOM CHIP YH2602 | ¥1,182 |
| 313-5067 | IC CXA-1145P | ¥342 |
| MPR-10052 | IC CXK3864P-20 | ¥318 |
| 313-0092 | IC MA7805UC | ¥48 |
| 315-0298-15 | IC UPD4168C-15 | ¥422 |
| 315-0298 | IC UPD4168C-20 | ¥417 |
| MPR-11458 | IC uPD23C1011 FOR MS | ¥645 |
| MPR-11459 | IC uPD23C1011 FOR MS PLUS | ¥634 |
| MPR-11460 | IC uPD23C1011 FOR SS | ¥630 |
| 315-0041 | IC Z80A | ¥172 |
| 601-6057 | INDIVIDUAL BOX BS FIVE (3080) | ¥170 |
| 671-0116 | INDIVIDUAL BOX MS FIVE (3095) | ¥170 |
| 671-0114 | INDIVIDUAL BOX MS PLUS FIVE (3090) | ¥185 |
| 671-0115 | INDIVIDUAL BOX SS FIVE (3091) | ¥195 |
| 390-5128 | LED SLP-280F-51U | ¥14 |
| 253-5071 | MINI STICK SJ150 | ¥18 |
| 212-5004 | PIN PLUG FOR DC/NP UC-0056#2 | ¥26 |
| 253-6013 | POWER BUTTON PB | ¥15 |
| 509-5150 | PUSH SWITCH SPQ-01N | ¥87 |
| 610-0130 | RGB BOX FRANCE | ¥800 |
| 509-5207 | TACT SWITCH SKEVAA | ¥17 |
| 610-0158 | TOP CASE ASSY PBVA | ¥630 |
| 482-0270 | TR 2SC1907 | ¥25 |
| 230-0046-1 | XTAL 10.738635MHz+-30ppm | ¥79 |

PARTS PRICE LIST FOR SEGA POWER SYSTM (PAL-I)

P-1/1

| PARTS NO. | PARTS NAME | FOB PRICE |
|-------------|-----------------------------------|-----------|
| 400-5048Y | AC ADOPTER | ¥767 |
| 400-5056 | AC ADOPTER (UK) | ¥1,560 |
| 400-5057 | AC ADOPTER (HK) | ¥794 |
| 271-0005 | BEADS INDUCTOR FBA04VA600AB | ¥6 |
| 271-0005-1 | BEADS INDUCTOR FBA04VA600VB | ¥7 |
| 610-0030 | BOTTOM CASE ASSY PB | ¥319 |
| 253-6008 | BUTTON PB | ¥18 |
| 151-5004 | CAP CER TRIMMER 30pF | ¥18 |
| 209-5020 | CARD CONNECTOR 35P PRE35R-1 | ¥148 |
| 610-0180 | CONTROL PAD ASSY | ¥429 |
| 209-5017-01 | D-SUB 9P ANGLE TYPE UC-0060#2 | ¥43 |
| 212-5106 | DIN CONN 8P B-TYPE UC-0059#2 | ¥51 |
| 481-0149 | DIODE 1S2473 | ¥4 |
| 481-5038 | DIODE 1SR-35-100A | ¥10 |
| 481-5045 | DIODE 1SS133 | ¥3 |
| 209-5023 | EDGE CONNECTOR 50P PSB4D25S-4RI | ¥127 |
| 271-0006 | EMI FILTER STB271KB | ¥12 |
| 271-0007 | EMI FILTER STX222MB | ¥12 |
| 314-0355 | IC 74ALS174 | ¥95 |
| 314-0356 | IC 74ALS175 | ¥95 |
| 314-0358 | IC 74ALS74 | ¥58 |
| 314-0361 | IC 74HC132 | ¥77 |
| 315-5216 | IC CUSTOM CHIP G/A | ¥216 |
| 315-5124 | IC CUSTOM CHIP YM2602 | ¥1,182 |
| 313-5067 | IC CXA-1145P | ¥342 |
| MPR-10883 | IC CXK3864P-20 | ¥247 |
| 313-0092 | IC HA7805UC | ¥48 |
| 315-0298-15 | IC UPD4108C-15 | ¥422 |
| 315-0298 | IC UPD4108C-20 | ¥417 |
| MPR-11458 | IC uPD23C1011 FOR MS (3091) | ¥645 |
| MPR-11459 | IC uPD23C1011 FOR MS PLUS (3090) | ¥634 |
| MPR-11460 | IC uPD23C1011 FOR SS (3095) | ¥630 |
| 315-0041 | IC Z80A | ¥172 |
| 601-6057 | INDIVIDUAL BOX BS FIVE(3080) | ¥170 |
| 671-0116 | INDIVIDUAL BOX MS FIVE(3095) | ¥170 |
| 671-0114 | INDIVIDUAL BOX MS PLUS FIVE(3090) | ¥185 |
| 671-0115 | INDIVIDUAL BOX SS FIVE(3091) | ¥195 |
| 390-5128 | LED SLP-280F-51U | ¥14 |
| 253-5071 | MINI STICK SJ150 | ¥18 |
| 180-5032 | PEAKING COIL 100uF | ¥10 |
| 180-5033 | PEAKING COIL 12uH | ¥10 |
| 212-5004 | PIN PLUG FOR DC/NP UC-0056#2 | ¥26 |
| 253-6013 | POWER BUTTON PB | ¥15 |
| 509-5150 | PUSH SWITCH SPQ-01N | ¥87 |
| 200-5088 | RF MODULATOR VV3421 | ¥685 |
| 200-5020 | RF SWITCH BOX | ¥191 |
| 313-5054 | RGB ENCODER V-7040 | ¥401 |
| 509-5207 | TACT SWITCH SKEVAA | ¥17 |
| 610-0158 | TOP CASE ASSY PBVA | ¥630 |
| 482-0270 | TR 2SC1907 | ¥25 |
| 600-5040-02 | TV EXTENSION CABLE 2C2V | ¥135 |
| 230-5035 | XTAL 53.203424MHz | ¥176 |

PARTS PRICE LIST FOR SEGA POWER SYSTM (PAL-B)

P-1/1

| PARTS NO. | PARTS NAME | FOB PRICE |
|-------------|-----------------------------------|-----------|
| 400-5048Y | AC ADAPTER | ¥767 |
| 400-5050 | AC ADAPTER (AUSTRALIA) | ¥767 |
| 271-0005 | BEADS INDUCTOR FBA04VA600AB | ¥6 |
| 271-0005-1 | BEADS INDUCTOR FBA04VA600VB | ¥7 |
| 610-0030 | BOTTOM CASE ASSY PB | ¥319 |
| 253-6008 | BUTTON PB | ¥18 |
| 151-5004 | CAP CER TRIMMER 30pF | ¥18 |
| 209-5020 | CARD CONNECTOR 35P PRE35R-1 | ¥148 |
| 610-0180 | CONTROL PAD ASSY | ¥429 |
| 209-5017-01 | D-SUB 9P ANGLE TYPE UC-0060#2 | ¥43 |
| 212-5106 | DIN CONN 8P B-TYPE UC-0059#2 | ¥51 |
| 481-0149 | DIODE 1S2473 | ¥4 |
| 481-5038 | DIODE 1SR-35-100A | ¥10 |
| 481-5045 | DIODE 1SS133 | ¥3 |
| 209-5023 | EDGE CONNECTOR 50P PSB4D25S-4RI | ¥127 |
| 271-0006 | EHI FILTER STB271KB | ¥12 |
| 271-0007 | EHI FILTER STX222MB | ¥12 |
| 314-0355 | IC 74ALS174 | ¥95 |
| 314-0356 | IC 74ALS175 | ¥95 |
| 314-0358 | IC 74ALS74 | ¥58 |
| 314-0361 | IC 74HC132 | ¥77 |
| 315-5216 | IC CUSTOM CHIP G/A | ¥216 |
| 315-5124 | IC CUSTOM CHIP YM2602 | ¥1,182 |
| 313-5067 | IC CXA-1145P | ¥342 |
| MPR-10883 | IC CXK3804P-20 | ¥247 |
| 313-0092 | IC MA7805UC | ¥48 |
| 315-0298-15 | IC UPD4108C-15 | ¥422 |
| 315-0298 | IC UPD4108C-20 | ¥417 |
| MPR-11458 | IC uPD23C1011 FOR MS (3091) | ¥645 |
| MPR-11459 | IC uPD23C1011 FOR MS PLUS (3090) | ¥634 |
| MPR-11460 | IC uPD23C1011 FOR SS (3095) | ¥630 |
| 315-0041 | IC Z80A | ¥172 |
| 601-6057 | INDIVIDUAL BOX BS FIVE(3080) | ¥170 |
| 671-0116 | INDIVIDUAL BOX MS FIVE(3095) | ¥170 |
| 671-0114 | INDIVIDUAL BOX MS PLUS FIVE(3090) | ¥185 |
| 671-0115 | INDIVIDUAL BOX SS FIVE(3091) | ¥195 |
| 390-5128 | LED SLP-280F-51U | ¥14 |
| 253-5071 | MINI STICK SJ150 | ¥18 |
| 180-5032 | PEAKING COIL 100uF | ¥10 |
| 180-5033 | PEAKING COIL 12uH | ¥10 |
| 212-5004 | PIN PLUG FOR DC/NP UC-0056#2 | ¥26 |
| 253-6013 | POWER BUTTON PB | ¥15 |
| 509-5150 | PUSH SWITCH SPQ-01N | ¥87 |
| 200-5109 | RF MODULATOR VV3402 | ¥767 |
| 200-5088 | RF MODULATOR VV3421(AUSTRALIA) | ¥767 |
| 200-5020 | RF SWITCH BOX | ¥191 |
| 313-5054 | RGB ENCODER V-7040 | ¥401 |
| 509-5207 | TACT SWITCH SKEVAA | ¥17 |
| 610-0158 | TOP CASE ASSY PBVA | ¥630 |
| 482-0270 | TR 2SC1907 | ¥25 |
| 600-5040-02 | TV EXTENSION CABLE 2C2V | ¥135 |
| 230-5035 | XTAL 53.203424MHz | ¥176 |

PARTS PRICE LIST FOR SEGA POWER SYSTM (PAL-G)

P-1/1

| PARTS NO. | PARTS NAME | FOB PRICE |
|-------------|-----------------------------------|-----------|
| 400-5048Y | AC ADAPTER | ¥767 |
| 271-0005 | BEADS INDUCTOR FBA04VA600AB | ¥6 |
| 271-0005-1 | BEADS INDUCTOR FBA04VA600VB | ¥7 |
| 610-0030 | BOTTOM CASE ASSY PB | ¥319 |
| 253-6008 | BUTTON PB | ¥18 |
| 151-5004 | CAP CER TRIMMER 30pF | ¥18 |
| 209-5020 | CARD CONNECTOR 35P PRE35R-1 | ¥148 |
| 610-0180 | CONTROL PAD ASSY | ¥429 |
| 209-5017-01 | D-SUB 9P ANGLE TYPE UC-0060#2 | ¥43 |
| 212-5106 | DIN CONN 8P B-TYPE UC-0059#2 | ¥51 |
| 481-0149 | DIODE 1S2473 | ¥4 |
| 481-5038 | DIODE 1SR-35-100A | ¥10 |
| 481-5045 | DIODE 1SS133 | ¥3 |
| 209-5023 | EDGE CONNECTOR 50P PSB4D25S-4RI | ¥127 |
| 271-0006 | EMI FILTER STB271KB | ¥12 |
| 271-0007 | EMI FILTER STX222NB | ¥12 |
| 314-0355 | IC 74ALS174 | ¥95 |
| 314-0356 | IC 74ALS175 | ¥95 |
| 314-0358 | IC 74ALS74 | ¥58 |
| 314-0361 | IC 74HC132 | ¥77 |
| 315-5216 | IC CUSTON CHIP G/A | ¥216 |
| 315-5124 | IC CUSTON CHIP YM2602 | ¥1,182 |
| 313-5067 | IC CXA-1145P | ¥342 |
| MPR-10883 | IC CXK3804P-20 | ¥247 |
| 313-0092 | IC HA7805UC | ¥48 |
| 315-0298-15 | IC UPD4108C-15 | ¥422 |
| 315-0298 | IC UPD4108C-20 | ¥417 |
| MPR-11458 | IC uPD23C1011 FOR HS (3091) | ¥645 |
| MPR-11459 | IC uPD23C1011 FOR HS PLUS (3090) | ¥634 |
| MPR-11460 | IC uPD23C1011 FOR SS (3095) | ¥630 |
| 315-0041 | IC Z80A | ¥172 |
| 601-6057 | INDIVIDUAL BOX BS FIVE(3080) | ¥170 |
| 671-0116 | INDIVIDUAL BOX HS FIVE(3095) | ¥170 |
| 671-0114 | INDIVIDUAL BOX HS PLUS FIVE(3090) | ¥185 |
| 671-0115 | INDIVIDUAL BOX SS FIVE(3091) | ¥195 |
| 390-5128 | LED SLP-280F-51U | ¥14 |
| 253-5071 | MINI STICK SJ150 | ¥18 |
| 180-5032 | PEAKING COIL 100uF | ¥10 |
| 180-5033 | PEAKING COIL 12uH | ¥10 |
| 212-5004 | PIN PLUG FOR DC/NP UC-0056#2 | ¥26 |
| 253-6013 | POWER BUTTON PB | ¥15 |
| 509-5150 | PUSH SWITCH SPQ-01N | ¥87 |
| 200-5086 | RF MODULATER UE3622 | ¥792 |
| 200-5020 | RF SWITCH BOX | ¥191 |
| 313-5054 | RGB ENCORDER V-7040 | ¥401 |
| 509-5207 | TACT SWITCH SKEVAA | ¥17 |
| 610-0158 | TOP CASE ASSY PBVA | ¥630 |
| 482-0270 | TR 2SC1907 | ¥25 |
| 600-5040-02 | TV EXTENSION CABLE 2C2V | ¥135 |
| 230-5035 | XTAL 53.203424MHz | ¥176 |

PARTS PRICE LIST FOR SEGA LIGHT PHASER

P-1/1

| PARTS NO. | PARTS NAME | FOB PRICE |
|-------------|------------------------|-----------|
| 253-6029 | CASE COVER LP | ¥17 |
| 600-5299 | CORD ASSY LP | ¥191 |
| 253-6028 | LEFT CASE LP | ¥92 |
| 380-5003 | LENS LP | ¥29 |
| 837-6068 | PC BOARD LIGHT PHASER | ¥1,633 |
| 253-6027 | RIGHT CASE LP | ¥92 |
| 250-5024 | SHIELD COVER LP | ¥27 |
| 253-6030 | TRIGGER LP | ¥17 |
| 250-5020 | WEIGHT A | ¥38 |
| 250-5021 | WEIGHT B | ¥41 |
| 601-5610-50 | INDIVIDUAL BOX LP FIVE | ¥95 |

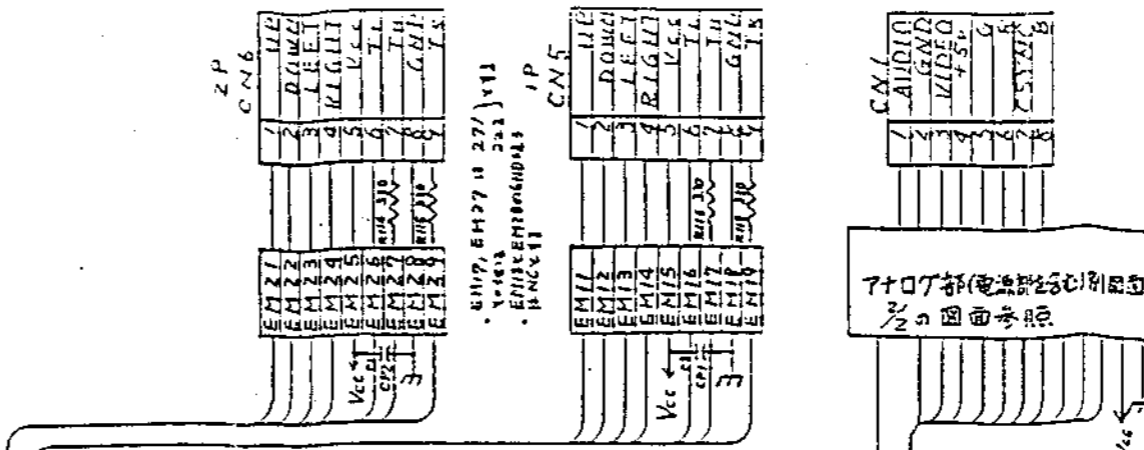
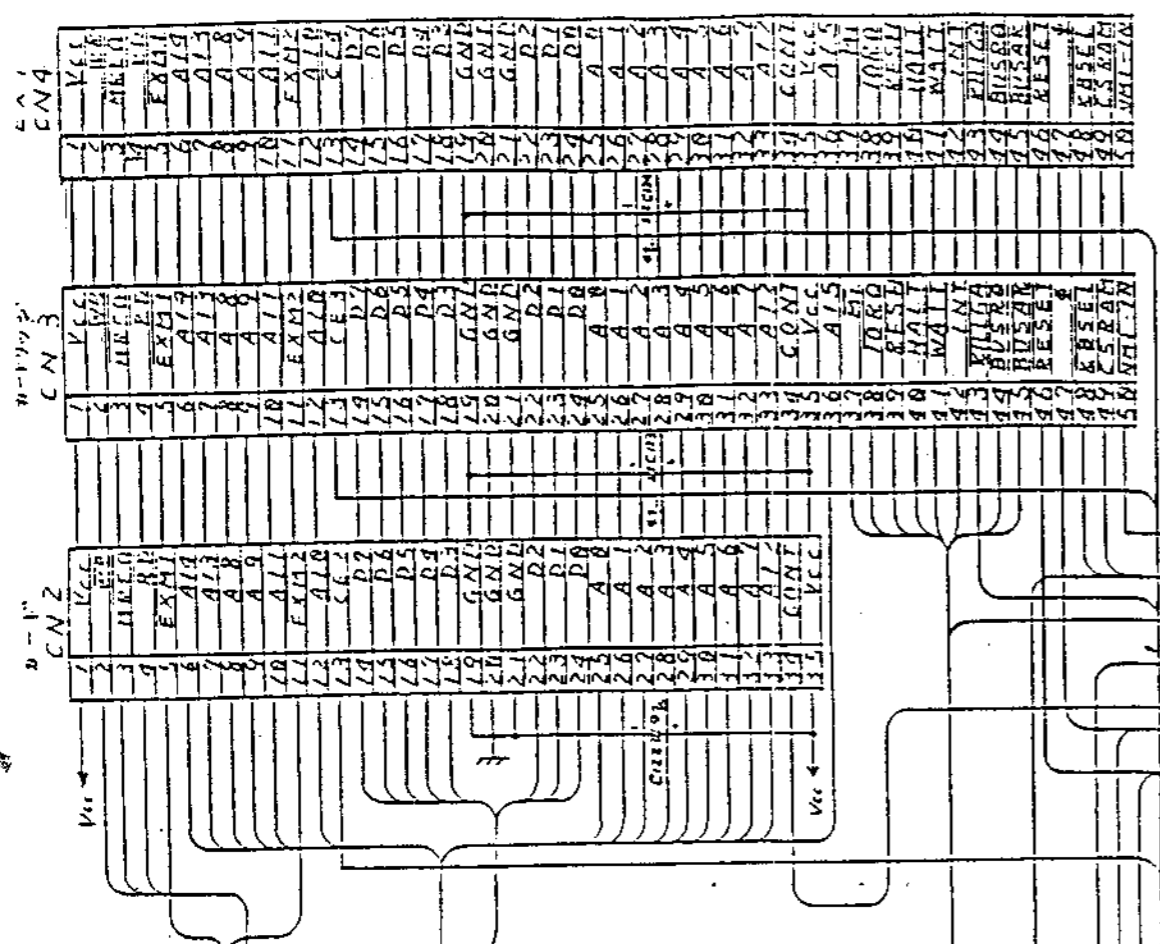

7+07部(電源供給)の接続
2の電源供給



IC2514H411.
PS2:バスコンパイル, 0.1μF 2.73.

| | | |
|---|--|--------------|
| SEGA SEGA ENTERPRISES, LTD. | | REV |
| THIS DRAWING WILL BE SOFT COPY BE CORRECT. THE ORIGINAL TO BE RETURNED ON DEMAND. | | 171-5554 |
| IC BOARD P3 PAL VAS | | 171-5554 |
| DESCRIPTION | | 171-5554 |
| | | SHEET 1 OF 2 |

