

Menu structure

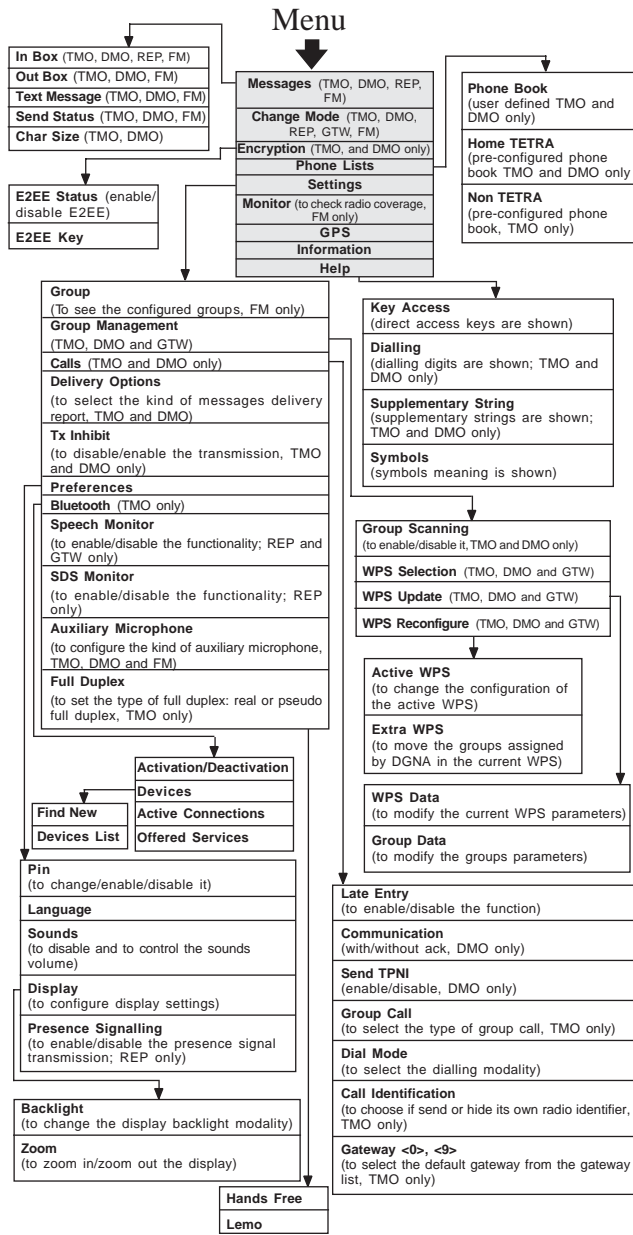

NOTES:
 - Some menus can be or not available according to the configuration of the radio terminal.
 - Choosing some options of WPS menus can cause the ending of active group calls.

Displayed symbols

	Signal level (TMO and GTW mode)
	Network, searching network (flashing)
	Direct Mode with Gateway equipment presence detected
	Fallback Mode
	Direct Mode
	Repeater Mode (Repeater only)
	Gateway Mode (Gateway only)
	Direct Mode with Repeater equipment presence detected
	Packet Data Context
	Packet Data Channel
	E2E Crypto Enable
	Custom E2EE Error
	Custom E2EE Enable
	No read Messages, Full queue with at least one message not read (flashing)
	Full Queue, each message is read
	Active Data Call
	Bluetooth Activated
	Earphone Speech Call
	Active Speech Call
	Keypad Volume Off
	Keypad Locked
	Group scanning Enabled
	Group Attach Failure
	SDS and voice communication monitoring (Repeater only)
	Voice communication monitoring (Repeater and Gateway only)
	SDS monitoring (Repeater only)
	Helmet detected
	Rotary Knob Enabled
	Tx Active
	UHF Network Channel
	UHF Simplex Channel
	Loudspeaker Audio Output
	Earphone Audio Output

Controls, indicators and connectors

Volume Controller/ Group - channel Selector	In the vehicular configuration: during normal operation the knob has the volume control function, turn it clockwise to turn up the volume (16 levels) of the audio output of the loudspeaker/earphone. Turn the knob counterclockwise to decrease the volume. If the knob is kept pressed until the alternate symbols and appear on the display it goes to group-channel selection function. Once in this modality turn the knob to choose among the available groups and select the group-channel by pressing the knob. Once pressed the knob you go back to volume control function. If, in group-channel selection modality, no operation on the knob is performed for a pre-defined time interval, the knob automatically changeovers to volume control function. Each changeover of knob function is signalled to the operator by means of a confirmation beep. In the Motorcycle configuration: the triple pushbutton allows the same operativity of the knob. ("+" to increase the volume/scroll up the groups; "-" to decrease the volume/scroll down the groups; "*" to switch from volume control to group selection/OK).
Green LED	Lit while the radio is receiving.
Red LED	Lit while the radio is transmitting; blinking while the transmission is inhibited (only TETRA).
Function Keys	When a symbol, or a writing, is present on the display near the key, by pressing the key you select the function associated to the relative symbol/writing.
Menu navigation keys	To scroll up/down the menu items, select the option and escape.
Off hook key	The off hook green key is used to accept/make (after having typed in the address) an individual full duplex call and if pressed in idle status accesses the calls list.
On hook key	The on hook red key is used to end the connection. It is also used to switch on/off the radio if kept pressed for a few seconds.
Alphanumeric keypad	Alphanumeric keypad for dialling numbers and/or strings. It is made up of 12 keys (10 digits plus and .
Clear key	Clear/escape key.
Yellow key	Only for TETRA: if a group is selected, by pressing the yellow key the writing "Dispatcher" on the display appears: now, by pressing PTT (if the network allows this function) the first available dispatcher of the selected group is called (not the group). By pressing again the yellow key the name of the selected group appears on the display and by pressing PTT the selected group is called. If no group is selected the yellow key allows to make an (half duplex) individual/group call by pressing PTT (after having typed in the address) even if the PTT default modality is set (by PRP) for group/(half duplex) individual call.
Switch audio key	The key allows to switch the audio from the external loudspeakers to handset accessory and viceversa. (Active only if the external loudspeaker and the handset are connected to the radio).
Emergency key	It lets the user send an emergency alarm.
12 pins connector	To be connected to audio accessories.
USB connector (only vehicular)	To be connected to USB-A mass storage device (for FPG3 software download).
PTT (Not located on the FPG3 front panel)	Push-To-Talk button, press it to talk during half duplex conversation. If pressed (in Idle status when a group-channel is selected, or after having typed in a group-channel address) it sends the call to the group-channel. See also the yellow key function description.



VS3000-FPG3 TETRA - Mobile Radio Terminal Quick Reference Guide

- Two versions are available:
- VS3000-FPG3 Vehicular configuration
 - VS3000-FPG3 Motorcycle configuration

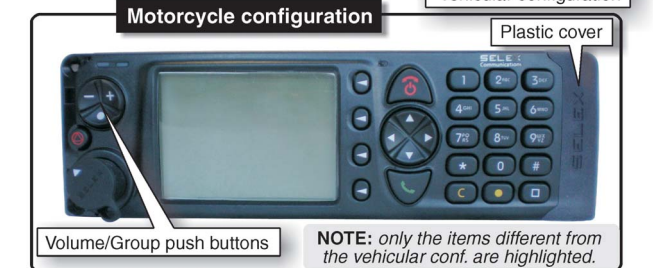
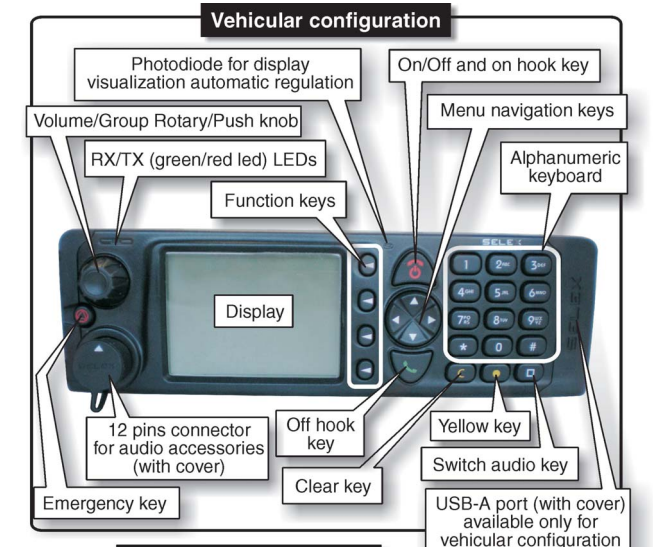

WARNING Before using the equipment, read all the instructions contained in the manual and, with special care, those relative to safety.

See the Safety Recommendation guide for FCC Approval.

© 2010 SELEX Communications S.p.A. - All rights reserved.
SELEX Communications S.p.A. reserves the right to change specifications, performance or features relevant to the product described without notice. This is an unpolished work the copyright in which vests in SELEX Communications S.p.A. The information contained herein is confidential and the property of SELEX Communications S.p.A. and is supplied without liability for errors or omissions. No part may be reproduced, disclosed or used except as authorised by contract or other written permission.

How to...		TMO	DMO	REP	GTW	FM
Change accessories configuration	See the relative accessories user's guide.	*	*	*	*	*
Switch on/switch off the radio	Keep pressed the key for a few seconds.	*	*	*	*	*
Manage the PIN (Personal Identification Number)	PIN insertion at power on, can be: • Enable/disabled from menu • Always enabled • Always disabled If PIN insertion is enabled, at power on the user must insert the current PIN. In case of insertion of 3 consecutive wrong pin, the current PUK must be inserted to unlock the radio. In case of 3 consecutive wrong PUK insertion the radio must be reprogrammed to be unlocked.	*	*	*	*	*
Adjust the Volume	To adjust the volume of the various sounds access from main menu to Settings → Preferences → Sounds . In the vehicular configuration: to adjust the speech volume, use the volume knob; turn it clockwise to increase the volume and counterclockwise to decrease it. In the Motorcycle configuration: the triple pushbutton allows the same operativity of the knob. ("+" and "-" to increase/decrease the volume; "*" to switch from volume control to group selection function).	*	*	*	*	*
Change group - channel	In the Vehicular configuration: keep pressed the knob until the alternate symbols and appear on the display. The radio is in group selection mode. Once in this modality turn the knob to choose among the available groups-channel and select the group by pressing the knob. In the Motorcycle configuration: the triple pushbutton allows the same operativity of the knob. ("+" and "-" to scroll the groups list; "*" to switch from volume control to group selection and to confirm the choose).	*	*	*	*	*
Lock/unlock keypad	Press and then (associated to menu) keys to lock the keypad; to unlock it press any key and follow the instructions shown on the display.	*	*	*	*	*
Change modality TMO/DMO/REP/ GTW/FM (*)	Keep pressed key for a few seconds. Otherwise select Change mode from main menu and select the modality.	*	*	*	*	*
Change Working Profile Subset (WPS)	Each WPS is composed of a set of different groups related to the group selector knob positions. Changing WPS you change the groups that can be selected by means of the knob. To change WPS, keep pressed key for a few seconds. Otherwise select Settings → Group Management → WPS Select .	*	*	*	*	*
Call a group / Channel	Select the group by means of the relevant knob (in the vehicular configuration) or the triple push button (in the motorcycle configuration), then press PTT to talk; otherwise type in the group address and press PTT (if the PTT default modality is set (by PRP) for individual call, press the key before pressing the PTT).	*	*	*	*	*
Call the dispatcher of the selected group (if the network allows this function)	Select the group by means of the relevant knob and press the key . Now by pressing PTT the first available dispatcher of the selected group is called (not the group). By pressing again the key and then the PTT the selected group is called.	*	*	*	*	*
Call the OPEN GROUP	Keep pressed key for a few seconds, then press PTT to talk.	*	*	*	*	*
Make an individual full duplex speech call	Type in the address or select a subscriber from phone book then press key .	*	*	*	*	*
Make an individual half duplex speech call	Type in the address or select a subscriber from phone book then press PTT (if the PTT default modality is set (by PRP) for group call, press the key before pressing the PTT).	*	*	*	*	*
Send an emergency alarm	Keep pressed the emergency key at least for 2 seconds. In TETRA mode the radio can be programmed to: send a call request, send an SDS, send a call request and an SDS, at the emergency key pressing. In FM mode, the radio sends an alarm until another radio gives the received alarm signal through the key .	*	*	*	*	*

How to...		TMO	DMO	REP	GTW	FM
Send a status message	Access the send status menu, pressing the key associated with when the radio is in idle status or selecting from main menu: Messages → Send Status . Select the status to be sent, then select an user by means of the key associated with or a group by means of the key associated with . To send the message use the key or select the Send option.	*	*	*	*	*
Send a text message	Access the text messages selecting from main menu Messages → Text Message . Create a new message or select a predefined message then select OPT → Send . Select an user () or a group () and send the message by means of key or selecting the option Send . During the editing of a message it is possible to change from uppercase to lowercase pressing the key .	*	*	*	*	*
Read a received message (Inbox)	Access the received messages list from main menu selecting Messages → Inbox . Use the keys , to scroll the list of messages. The received messages can be status or text messages. Select the message to be read (VIEW) and then OPT to choose among Delete-Reply-Reply+History .	*	*	*	*	*
Access last calls list	From idle status press key to display the list of the last 20 received/made individual calls. Scroll them by means of keys , . It is possible to recall the subscriber pressing the key followed by the PTT pressing (Half-Duplex call) or followed by the pressing of the key (Full-Duplex call, TMO only).	*	*	*	*	*
Go back in a group call	It is possible to go back in a group call which is still active and from which you have disconnected: in TMO by pressing the PTT and in DMO by keeping pressed the key .	*	*	*	*	*
Enable/Disable the speech monitoring function	From main menu select Settings → Speech monitor , to change the function status. If the speech monitor is active the user will be asked to deactivate it and vice versa. By pressing the key corresponding to YES the change is confirmed; by pressing the key corresponding to NO or the key the user can exit the menu without modification.	*	*	*	*	*
Enable/Disable the SDS monitoring function	From main menu select Settings → SDS monitor , to change the function status. If the SDS monitor is active the user will be asked to deactivate it and vice versa. By pressing the key corresponding to YES the change is confirmed; by pressing the key corresponding to NO or the key the user can exit the menu without modification.	*	*	*	*	*
Enable/Disable the presence signal	From main menu select Settings → Preferences → Presence Signalling To enable the transmission of presence signal select PsOn ; select PsOff to disable it.	*	*	*	*	*
Visualize GPS data	From main menu select GPS . The data relative to vehicle position will be shown on the display.	*	*	*	*	*
Activate Bluetooth (*)	Activate Bluetooth functionality selecting Settings → Bluetooth → Activation . Once Bluetooth is active the symbol appears on the radio display. Note: if the radio is turned off with the Bluetooth active, at the successive switch on the Bluetooth is deactivated.	*	*	*	*	*
Connect with Bluetooth device (*)	With Bluetooth functionality active select the menu item Find New from Settings → Bluetooth → Devices . Once the device has been found check if it is "Trusted" or "Untrusted" through the menu item Devices List from menu Settings → Bluetooth → Devices , showing the device information. If the device is "Untrusted" select OPT from the display showing the device information, and then select Service Search .	*	*	*	*	*

How to...		TMO	DMO	REP	GTW	FM
	Once the device is "Trusted" select OPT from the display showing the device information, and then select Service List . Choose the service scrolling the list through the keys and , select OPT and then Connect , to connect to the service.	*	*	*	*	*
Remove Bluetooth device (*)	To remove a Bluetooth device it is first necessary to disconnect it closing and removing the relative service: • select Settings → Bluetooth → Devices → Devices List ; • scroll the device list till the device to be removed and select OPT; • select the item Service List and scroll the Service List till the service to be close; • select OPT and then Disconnect . Then, from the same menu select Remove to remove the service. Now it is possible to remove the device: • select Settings → Bluetooth → Devices → Devices List ; • scroll the device list till the device to be removed and select OPT; • select the item Remove Device • press the key associated with "YES" to confirm the operation.	*	*	*	*	*
Deactivate Bluetooth (*)	To deactivate Bluetooth it is first necessary to remove all the Bluetooth accessories, then select Settings → Bluetooth → Deactivation .	*	*	*	*	*
Check the coverage of other users	Access the monitor menu keeping pressed the key for a few seconds from idle status, otherwise select item Monitor from main menu. Selecting Opt it is possible to choose among: • Add (to add an user to be monitored); • Delete (to remove an user to be monitored); • View (to visualize the details of the last three radio coverage checks of the specific user).	*	*	*	*	*
Make a call in FM mode (*)	To make a call in FM mode (whether to a user or to a group) dial the user or the group address to be called, or select the address from the Phone lists and press the key . Press PTT to talk.	*	*	*	*	*

(*) Function not available for U.S. market

TETRA Operating modes

The vehicular radio terminal can work in four different TETRA operating modes, depending on the protocol selected in menu Change Mode: Trunked Mode (TMO), Direct Mode (DMO), Repeater Mode (REP), Gateway Mode (GTW).

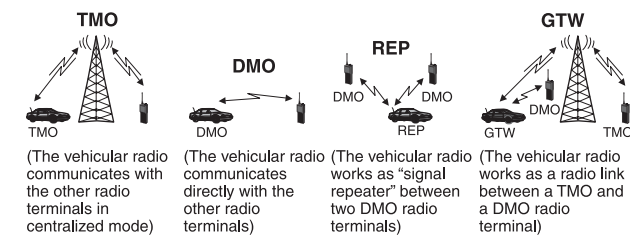

(The vehicular radio communicates with the other radio terminals in centralized mode)
(The vehicular radio communicates directly with the other radio terminals)
(The vehicular radio works as "signal repeater" between two DMO radio terminals)
(The vehicular radio works as a radio link between a TMO and a DMO radio terminal)

Menu main items

Messages
By means of this menu it is possible to send text and status messages, and to read received messages and sent messages that have been saved. It is also possible to define the text char size. In Repeater mode with SDS Monitor active it is possible to read the messages monitored by the radio.

Change Mode
By means of this menu item it is possible to select the transmission protocol TMO/DMO/REP/GTW/FM.

Encryption (TETRA only)
By means of this menu it is possible to enable/disable the encryption function.

Phone Lists
In TETRA mode, by means of this menu you can access the phone books (whether user defined or predefined). In FM mode you can directly access the FM users list.

Settings
Through the sub-menus of this item it is possible to configure several options of the radio terminal. For example (in TETRA mode) it is possible to inhibit the transmission (Tx Inhibit), to manage the working profiles WPS (Group Management), to access the Bluetooth functionalities.
Furthermore through the Preferences menu the user can personalize the terminal, setting: language, sounds volume, backlight, zoom in/zoom out. It is also possible in REP mode, to enable or disable the presence signal transmission.
In REP or GTW mode it is also possible to enable or disable the speech monitor function and only in REP mode the SDS monitor function.

Monitor (FM only) (*)
By means of menu Monitor it is possible to check the radio coverage of other FM radio users.

GPS
This menu allows to display the GPS data information.

Information
This menu allows to display the equipment information.

Help
Selecting Help from main menu it is possible to visualize the direct access keys function (direct access keys are available even during calls). Within the Help menu are also shown: the description of the strings to be dialled to define the call priority, the gateways and the address composition method (for TETRA). It is also possible to visualize a brief description of the symbols that can appear on the display.

NOTE:
For what concerns technical characteristics, reference standard, maintenance and troubleshooting, refer to the relevant technical handbook.