

Stay learning · Stay smart · Stay safe

Model:SL1701

<https://www.sensoro.ai>

In the box

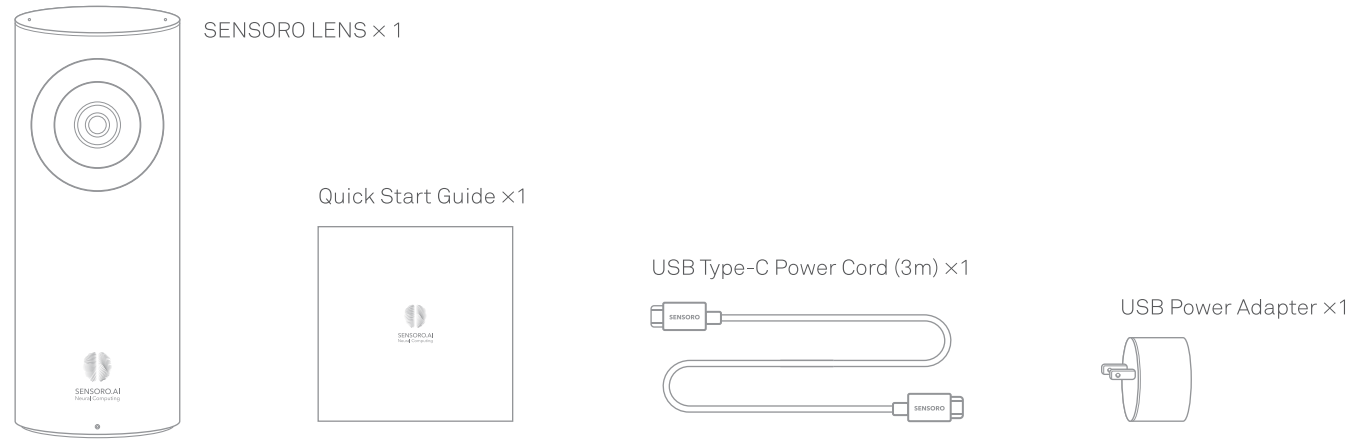

Appearance

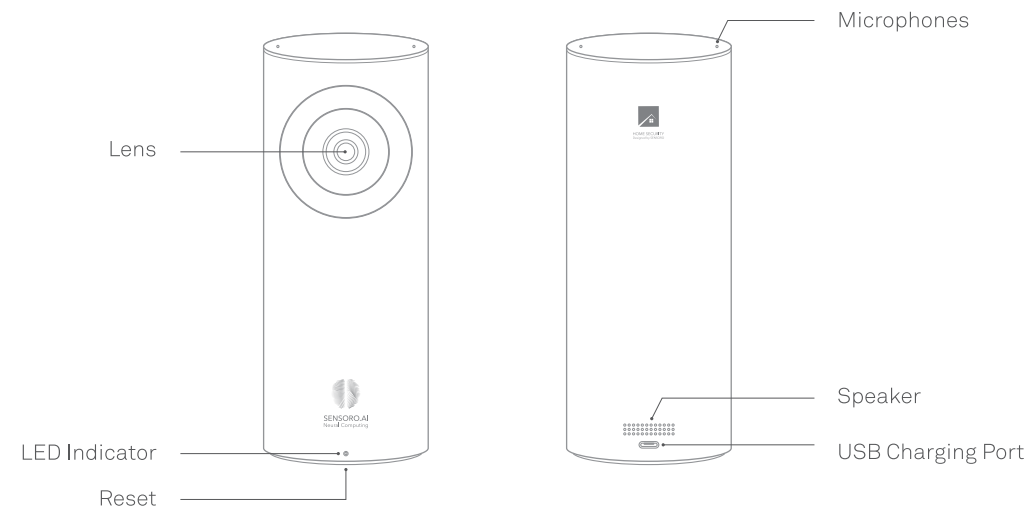

LED Indicator



Indicator Light Status	Device Status
Green light is solid and steady	The camera is connected to the Wi-Fi network and is functioning normally
Green light is blinking quickly	The Factory Reset is in progress
Green light is blinking slowly	The camera is booting up
Blue light is blinking quickly	The camera is upgrading itself
Yellow light is blinking slowly	SD card is not working properly
Red light is blinking slowly	The camera failed to connect to the Wi-Fi network



Quick start guide

1. Power on

Connect the power adapter to a power source and then connect the camera to the power adapter by the included power cable.

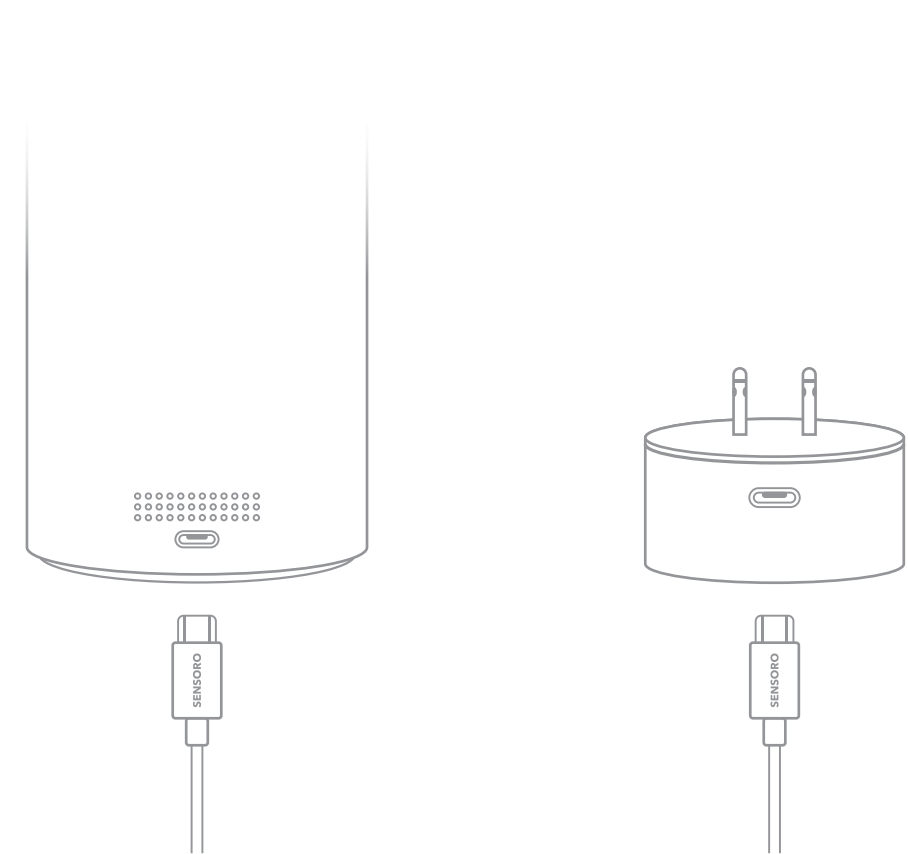

2. Download and install SENSORO LENS app

Search SENSORO LENS on App Store and Google Play, download and install it.



3. Sign in

Run SENSORO LENS app and register your account for the first time.

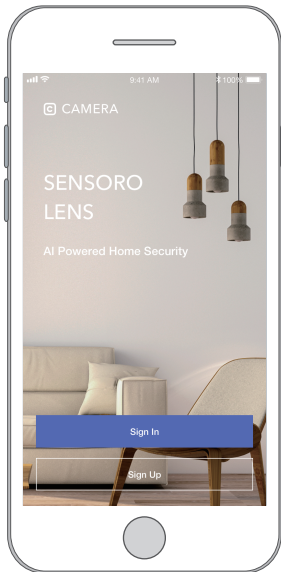

4. Add device

Follow the steps below to add your camera.

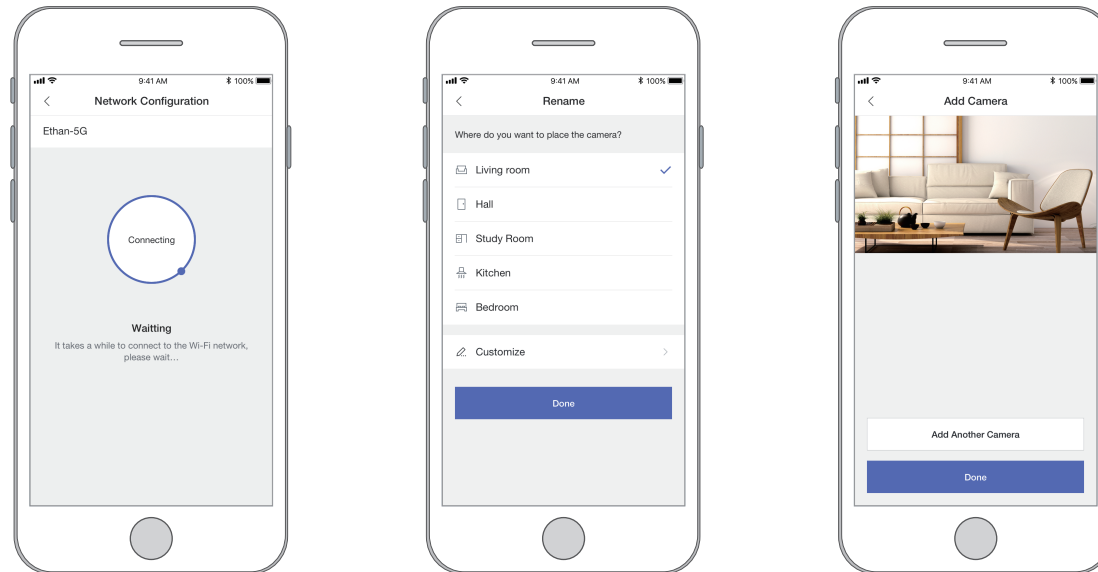
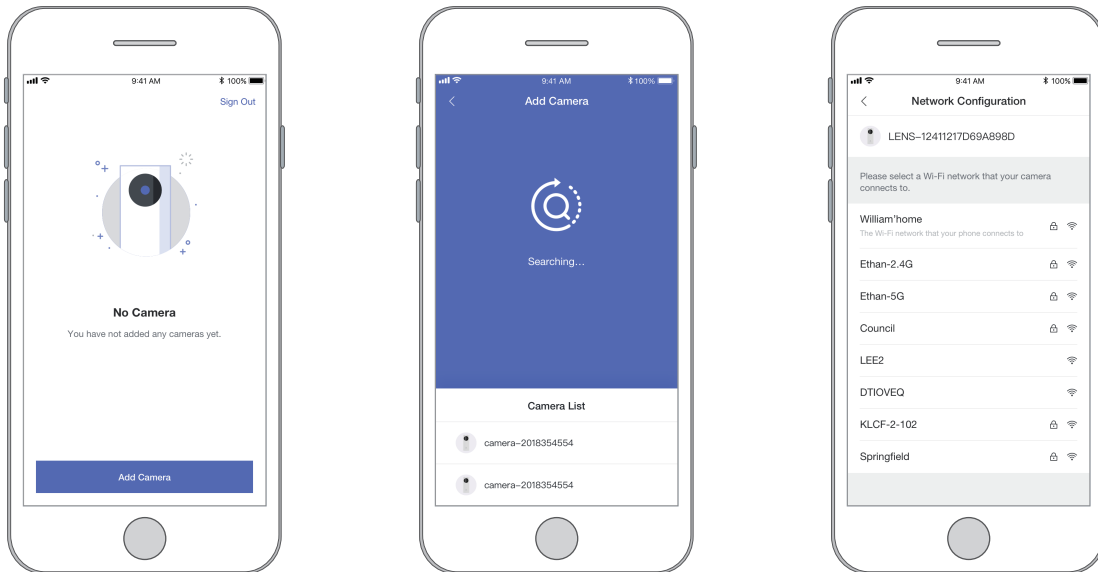

- The camera supports Bluetooth 4.2 protocol. Please turn on the phone Bluetooth switch before configuring the Wifi network.
- The camera supports 2.4G and 5G Wi-Fi network.



NOTICE:

- This product is designed for indoor usage only. Do not place the camera in wet, dusty, extremely hot or extremely cold environment.
- Do not let your children have easy access to your camera. Do not disassemble the camera at will.

FCC Warning:

This equipment has been tested and found to comply with the limits for a Class B digital device, pursuant to part 15 of the FCC Rules. These limits are designed to provide reasonable protection against harmful interference in a residential installation. This equipment generates, uses and can radiate radio frequency energy and, if not installed and used in accordance with the instructions, may cause harmful interference to radio communications.

However, there is no guarantee that interference will not occur in a particular installation. If this equipment does cause harmful interference to radio or television reception, which can be determined by turning the equipment off and on, the user is encouraged to try to correct the interference by one or more of the following measures:

- Reorient or relocate the receiving antenna.
- Increase the separation between the equipment and receiver.
- Connect the equipment into an outlet on a circuit different from that to which the receiver is connected.
- Consult the dealer or an experienced radio/TV technician for help.

Caution: Any changes or modifications to this device not explicitly approved by manufacturer could void your authority to operate this equipment.

This device complies with part 15 of the FCC Rules. Operation is subject to the following two conditions: (1) This device may not cause harmful interference, and (2) this device must accept any interference received, including interference that may cause undesired operation.

FCC Radiation Exposure Statement:

The equipment complies with FCC Radiation exposure limits set forth for uncontrolled environment. This equipment should be installed and operated with minimum distance 20cm between the radiator and your body.