



Cautions when using the Optical TOUCH CRUISER

- Do not operate the Optical TOUCH CRUISER using a pointed metallic object such as a pen tip. May cause scratches or a failure of the sensor.
- Note that putting a sticker, etc. to the operating range may cause a malfunction.
- Because the Optical TOUCH CRUISER detects motions of the fingerprint, it may not operate properly depending on the condition of the finger (when foreign objects, such as dust, sand, etc. are attached to the finger).

Setting whether to use Optical TOUCH CRUISER**<Usage settings>**

- 1 In the Custom menu, select [Settings] ▶ [General settings] ▶ [TOUCH CRUISER set] ▶ [Usage settings].
- 2 Select the setting ▶ .

Setting pointer speed/scroll speed**<Pointer speed/Scroll speed>**

- 1 In the Custom menu, select [Settings] ▶ [General settings] ▶ [TOUCH CRUISER set] ▶ [Pointer speed]/[Scroll speed].
- 2 Select the speed ▶ .

Setting and selecting menu**Set, change or save functions from the menu screens.**



- For details on operations in the viewer position  P. 37

The explanations in this manual are based on how to retrieve a function from the Custom menu.

Setting start menu <Menu priority>

Set the start menu that displayed when  is pressed in stand-by.

Start menu	Characteristics
Custom menu	<p>The preset Kisekai Tool ( P. 113) can be selected and set. Each Kisekai Tool consists of different functions and designs. Kisekai Tools can be downloaded from sites and used.</p> <p>Preset Kisekai Tools</p> <ul style="list-style-type: none"> ■ White ■ Black ■ Pink ■ 拡大メニュー (Large) ■ シンプル (Simple) ■ ダイレクトメニュー <p>※ Preset Kisekai Tools differ depending on the FOMA terminal handset color.</p>
Basic menu	Select the icon displayed on the menu to retrieve the function. Also, input the function number, which is assigned to each function, to quickly retrieve the function to be used.

- 1 In stand-by, press  ▶ [Settings] ▶ [Disp/LED/Power saver] ▶ [Menu priority].
 - In the Custom menu/Basic menu: Press  ▶ [Menu priority].
- 2 Select the start menu ▶  ▶ [Yes].

■ Switching set start menu temporarily

Switch the start menu temporarily. When the stand-by display reappears, the start menu returns to the one set in Menu priority. Use the Shortcut menu to retrieve saved functions quickly. Other functions can also be saved in the Shortcut menu (P. 393).



Stand-by

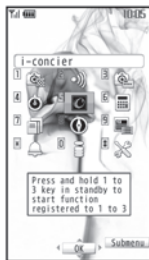

Shortcut menu



Custom menu



Basic menu

Retrieving a function from each menu

- For details on operating shortcut menu P. 393
- For details on the available functions P. 454
- Use and the Optical TOUCH CRUISER in either menu.
- Press the dial key corresponding to the menu item number (1, 2, 3, etc.) to select a function. However, in the Custom menu, a function may not be selected by using the menu item numbers.
- The method for selecting functions may differ depending on the Kisekai Tool set for the Custom menu.
- Press to re-select a function, and the previous screen reappears. Press to return to stand-by.

When a stock icon (P. 32) appears in stand-by, select **MENU** to show the each menu.

The way of activating 1Seg with Multi guide key or Optical TOUCH CRUISER is explained as an example below.

- For () use the Optical TOUCH CRUISER to select an item.
- The following shows the screen operated with the Optical TOUCH CRUISER.

■ Retrieving from the Custom menu



Custom menu

When [1Seg]
appearsWhen 1Seg is
activated

■ Retrieving from the Basic menu

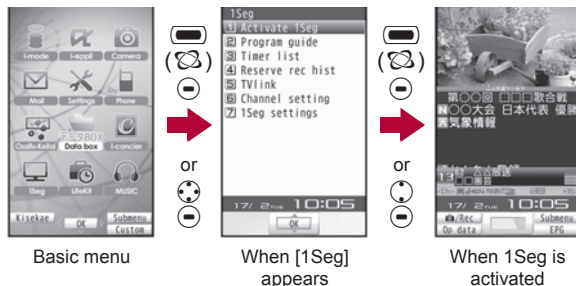

- In the Basic menu, input the function number, which is assigned to setting menu, to quickly retrieve the function to be used (P. 454).
- When the Custom menu image is changed by Kisekae Tool, the operation may differ from the description in this manual. In this case, switch the menu screen to the Basic menu (P. 35) or perform the Reset menu screen (P. 115).

■ Selecting a function from Submenu

When [Submenu] appears in the Operation guidance, press **Ⓢ** to display functions (Submenu) that can be used in the screen. Select the displayed Submenu with **⏮** or the Optical TOUCH CRUISER. If there are multiple pages in the Submenu, change pages with **⏮** or the Optical TOUCH CRUISER.

Alternatively, press the dial key corresponding to the menu item number (1, 2, 3, etc.) to select a function. However, some Submenus do not have item numbers.

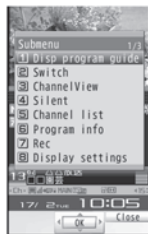

Submenu screen

Touch panel

Operations in viewer position

In the viewer position, operate by putting the finger on the touch panel (screen).

- In other than the viewer position, the touch panel is available during Videophone (P. 78).

Touch panel

- The operations differ depending on the function and screen in use. In addition, the message stating that the operation is not available appears when the touch panel cannot be used.
- Operate the touch panel inside the following operating range of touch panel. However, when a substitute image appears in the right side of the screen, operate in the left side of the screen where functions are shown.

Operating range of the touch panel



- The notation of operation described in this manual and its meaning are shown below.

Touch

Put the finger on the touch panel and put it off.

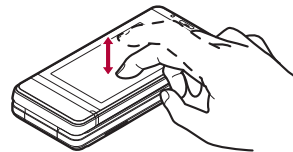

Double-touch

Quickly touch the same point twice.

Slide

Keep the finger on the touch panel and slide it.

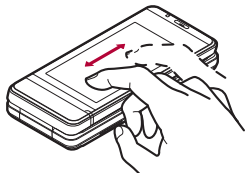
**Quick slide**

Quickly slide the finger and put it off.

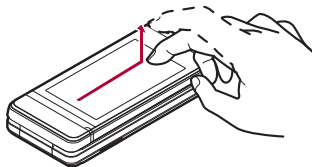
**Putting the distance between two fingers apart/closer**

Put two fingers on the touch panel and slide them with putting the distance between two fingers apart/closer.

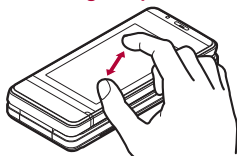

- When putting the finger on the touch panel, the tone sounds and the vibrator is activated (excluding while activating Touch menu and a camera).
 - The volume can be changed (☞ P. 104). The tone cannot be changed.
 - The vibrator can be set to ON/OFF (☞ P. 105).

When using the touch panel

- The touch panel does not work when operated with a gloved finger or with foreign objects placed on the operation pad.
- Note that operating with a wet finger or putting a sticker to the touch panel (display) may cause a malfunction.

Using menus or functions

Retrieve functions such as Full Browser or 1Seg from the Touch menu. Operating or changing settings with the Submenu or control key is available while using each function (touch operation is also available).

Touch menu

- If the screen is switched from the normal position to the viewer position in the stand-by display, Custom menu, Basic menu or others, Touch menu appears.
 - Functions to activate when setting the handset to the viewer position in the stand-by display can be changed (☞ P. 382).
- Touch the touch panel while displaying Stand-by (W) in the viewer position to display the Touch menu.
- The following functions can be retrieved from the Touch menu.



Map/GPS appli*1	Data box	My picture
Full Browser	Home	i-motion
	Bookmark	1Seg
1Seg	LifeKit	Manga&Book Reader
Camera	Shoot still pic	Document Viewer
	Shoot movie	
Mail	Inbox	MUSIC Player*2
	Outbox	
	Unsent messages	
	Compose message	



*1 "Mapping appli" (☞ P. 312) is started. i-appli to start can be changed from the Map setting (☞ P. 277, P. 311).

*2 The music is played from the spot where the playback stopped previously.

- To cancel/end a function, press  (CLR) while using the function.
- The images and items in the Touch menu cannot be changed.

Stand-by (W)

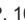
Stand-by (W) appears when the "CLR" key is touched or  (CLR) is pressed in the Touch menu.

- Stand-by (W) can be changed ( P. 108).
- Press  (CLR) while displaying Stand-by (W) to activate the camera.





Press  (CLR) for 1+ seconds to activate 1Seg.

- i-appli that does not support the touch panel is not available in the viewer position. Switch to the normal position and operate.
- When the following items are displayed in Stand-by (W), touch the displayed item and operate. Touch the area other than displayed items to operate Stand-by (W).
 - Stock icon
 - Notice that 1Seg reservation recording is completed

Submenu

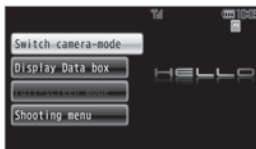
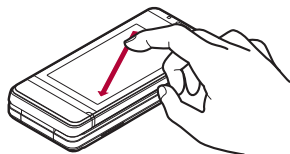
- While using the function, quickly slide the finger from the upper right to the lower left (or from the upper left to the lower right) to display the Submenu.



- Touch  of the control key or  on the upper part of the screen to display the Submenu.
- Touch the area other than the Submenu to hide the Submenu.

- The Submenu in the normal position and menu in the operation guidance are displayed in the Submenu with the handset set to the viewer position. Operate or change the settings by selecting the Submenu in the same way as in the normal position (some menu cannot be selected depending on the screen).

Control key



- While using a function, touch the touch panel to show the control keys.

Example: 1Seg



Example: MUSIC Player



- Touch the area other than the control keys to hide the control keys (excluding 1Seg). Also, if no operations are performed for approximately 7 seconds with the control keys shown, the control keys disappear.
- If there are extra keys other than those shown, touch  to show the next key.
- For details on control keys of each function  P. 41
- The control keys always appear in the shooting screen or while the music data is played.

Touch operation

- Easily operate with the finger without displaying the Submenu or control keys.
- For details on touch operation of each function  P. 41
- For the touch operation, be careful not to touch a key shown in the screen.
- Perform touch operation after hiding control keys while e-books, Word and Excel files, etc. are displayed.

■ Operations for menu and function

- Touch the touch menu or control keys to execute the functions.

Example: Touch menu



- In the Submenu, list and data list screens, select the menu, items, or data by touching, moving the cursor and re-touching them.

Example: [Camera] folder data list screen (Change theme: [Visual menu 1])

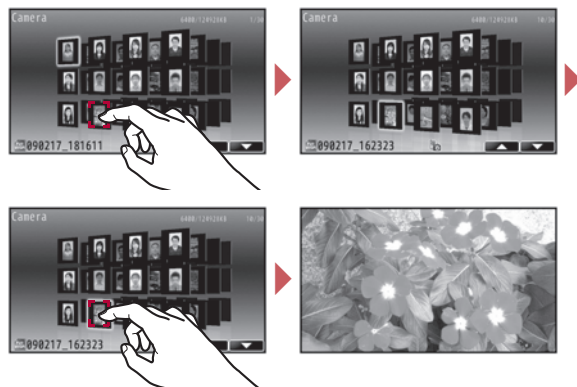

- Keep the image with cursor touched and the image appears in the center of the screen.



- If there are multiple pages in the Submenu, list or data list screen, use one of the following methods to switch the pages.
 - Quickly slide the finger left/right.
 - Touch or , etc. (when they appear).
 - Touch an image behind the image currently shown (when Change theme is set to [Visual menu 1]).
- When scrolling the Submenu, slide the area in which the Submenu is displayed up/down with the finger.
- In the screen activated from the Submenu, operation guidance menu in the normal position may appear as the control keys.
- When having touched the data or item by mistake, slide the finger away from it to cancel the selection.
- Touch the "CLR" key or press (P) to return to the previous screen.

Control key/Touch operation list

■ While Full Browser is displayed

Control key

- Control keys are not shown. Operate from the Submenu.

Touch operation

Keep key touched	To display a zoom bar*1
Slide the finger up/down/left/right	To scroll a screen
Quickly slide the finger left/right	To display next/previous page*2

*1 Zoom bar can also be displayed from the Submenu. Slide the slider of zoom bar left/right or touch $+$ / $-$ on the both ends of the zoom bar to zoom up/down the screen.

*2 Not available when there is no history.

- Touch the tab on the upper part of the screen to switch windows.
- Touch a link to highlight and touch it again to view the linked site.
- Quickly slide the finger left/right or touch ◀/▶ to move the cursor to next/previous history in the Visual history screen.
 - Quickly slide the finger up/down or touch ▲/▼ to switch windows.

■ While a PC movie is played back

Control key

	To fast forward*1, 2		To turn down the volume*3
	To pause/play*1		To stop
	To fast reverse*1, 2		To switch to the Full-screen mode
	To turn up the volume*3		

*1 May not appear for the PC movies which have restrictions on the operations such as the live distribution.

*2 Keep key touched to fast forward/fast reverse.

*3 Keep key touched to adjust the volume continuously.

- Settings can be changed from the Submenu.

Touch operation

Quickly slide the finger up/down	To adjust volume
----------------------------------	------------------

■ While 1Seg is being watched

Control key

	To select a station with UP*1		To record 1Seg programs as a still picture*2
	To select a station with DOWN*1		To turn up the volume*3
			To turn down the volume*3

*1 Keep key touched to select a station by searching a frequency. Touch to cancel the selection for station by searching a frequency.

*2 Keep key touched to record video. Touch to end recording.

*3 Keep key touched to adjust the volume continuously.

- Settings can be changed from the Submenu.

Touch operation

Quickly slide the finger up/down	To adjust volume
Quickly slide the finger left/right	To select a station with UP/DOWN

■ While camera is activated

Control key

	To shoot with the normal shutter*1
	To switch to the Egao focus shutter mode*1, 2
	To switch to the Furimuki shutter mode*1, 2
	To start shooting*3
	To end shooting*4

*1 Appears in the still picture shooting screen.

*2 Touch to return to the Normal shooting mode.

*3 Appears in the movie shooting screen.

*4 Appears while shooting a movie.

- Settings can be changed from the Submenu.
- In the preview screen after shooting still picture, the following keys appear.

	To save		To save all*
	To clear		To delete all*

* Appears after shooting still pictures continuously.

- Submenu appears after shooting movie.

Touch operation

Slide the finger up/down	To adjust the brightness
Slide the finger left/right	To adjust the zoom*

* The range of zoom is changed depending on how far the finger is slid left/right. When zooming up in a moment, double-touch the right edge of the screen.

- Focus and shoot as follows when the AF mode is set other than [Center AF], [Standard] or [Closeup].
 - Select [Def (people first)]: Touch the face detection frame to focus.
 - Select [Spot AF]: Touch a point to focus ► touch the focus area.
 - Select [Manual focus]: Slide the finger left/right to focus ► touch .

■ While a message details screen is displayed

Control key

	To next mail/message		To previous mail/message
--	----------------------	--	--------------------------

- Settings can be changed from the Submenu.

Touch operation

Slide the finger up/down	To scroll a screen up/down*
Slide the finger left/right	To next/previous mail or message

* Alternatively, touch / to scroll a screen up/down.

- When touching during Decome-Anime playback screen display, a message details screen is displayed.
- Touch the highlighted data (P. 187) or attached file to select it.

● Switch the display method for message details screen (P. 44).

■ While an image is displayed from My picture/1Seg of Data box

Control key

	To pause/play*		To next
	To previous		

* Appears for Flash movies.

- Settings can be changed from the Submenu.

Touch operation

Slide the finger left/right	To next/previous
Putting the distance between two fingers apart/closer	To zoom up/down

- If the zoomed up image is displayed, slide the finger up/down/left/right to change the display position.

■ While i-motion is displayed from i-motion of Data box

Control key

	To previous* ¹		To stop
	To pause/play		To switch to the Full-screen mode
	To next* ¹		To compose a message attached* ³
	To turn up the volume* ²		
	To turn down the volume* ²		

*¹ Keep key touched to perform Fast reverse/Fast forward.

*² Keep key touched to adjust the volume continuously.

*³ Appears when attaching is available.

● Settings can be changed from the Submenu.

Touch operation

Quickly slide the finger up/down	To adjust volume
Quickly slide the finger left/right	To next/previous

■ While a video is played back from 1Seg of Data box

Control key

	To fast reverse* ¹		To stop
	To pause		To return to a location of approx. 10 seconds before
	To fast forward* ¹		To skip to a location of approx. 30 seconds after
	To turn up the volume* ²		
	To turn down the volume* ²		

*¹ Keep key touched to increase the speed to $\ll \times 2 / \gg \times 2$. Touch to play back a video while performing Fast reverse/Fast forward.

*² Keep key touched to adjust the volume continuously.

● While stopped/paused, the following control keys appear.

	To play		To turn down the volume*
	To turn up the volume*		

* Keep key touched to adjust the volume continuously.

● Settings can be changed from the Submenu.

Touch operation

Quickly slide the finger up/down	To adjust volume
Quickly slide the finger left/right	Fast reverse/Fast forward*

* Operation is not available while stopped/paused. Operate during Fast reverse/Fast forward to increase the speed.

■ While e-book, etc. is displayed

Control key

	To top		Line-by-line/ Frame-by-frame reverse
	Line-by-line/ Frame-by-frame forward		

● Settings can be changed from the Submenu.

Touch operation

Quickly slide the finger up/down/ left/right	To move between lines/frames
---	------------------------------

● Touch a link to highlight and touch it again to view the linked site.

■ While Word or Excel files are displayed

Control key

	To next page		To previous page
--	--------------	--	------------------

● Settings can be changed from the Submenu.

Touch operation

Slide the finger up/down/left/right	To scroll a screen
Quickly slide the finger left/right	To next/previous page
Double-touch	To fit to screen
Putting the distance between two fingers apart/closer	To zoom up/down

■ While music data is played

Control key

	To previous song/To return to beginning of song*1		To view the list screen of music data for playback
	To pause/play		To display the folder list screen
	To next*1		To save images/lyrics*3
	To turn up the volume*2		To view next images/lyrics*3, 4
	To turn down the volume*2		
	To stop		

*1 Keep key touched to perform Fast reverse/Fast forward.

*2 Keep key touched to adjust the volume continuously.

*3 Appears while viewing images/lyrics.

*4 Appears when multiple images/lyrics are saved.

- Settings can be changed from the Submenu.

Touch operation

Quickly slide the finger up/down	To adjust volume
Quickly slide the finger left/right	To next/previous

Other operations

■ Entering terminal security code

If the security code entry screen appears, enter the terminal security code by touching the displayed numbers.

■ Switching display method for message details screen <Hori screen mode>

In the message details screen, touch [Hori screen mode] to display the message details screen in the left side of the screen. Re-touch to display in full-screen.

- Selecting is not possible in the normal position. The setting is valid only in the viewer position.

Support Book

Displaying Support Book

Use this function for unsure operations. After the Support Book appears, check the explanation and operation procedures of each function. In addition, directly start functions that were looked up in the Support Book.

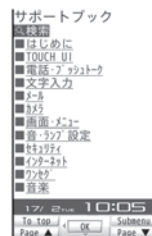

1 In stand-by, press > [Support Book].

2 Select a menu or item > .

- To start functions directly: Select the function to start > > [Yes].

FOMA card

Using FOMA card

A FOMA card is an IC card that records personal information, such as phone numbers. A FOMA card can store phonebook data and SMS. By switching FOMA cards, multiple FOMA terminals can be used for different purposes as needed.

- If a FOMA card is not inserted, transmission functions such as voice/Videophone/PushTalk calls, i-mode, mail transmission and packet transmission are not available on the FOMA terminal.

Inserting/Removing FOMA card

- Before inserting or removing the FOMA card, turn off the power, position the back facing upwards and remove the battery pack. Close and hold the FOMA terminal firmly with your both hands.

■ Inserting FOMA card

1 Hook a finger on the tab and pull the tray out (1).

- Pull out the tray straight until it stops.

2 Hold the FOMA card with the IC facing up and set on the tray (2).

3 Push the tray all the way in (3).

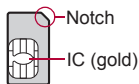

Fit the notch of the FOMA card to that of the tray.

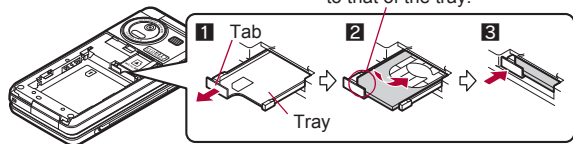

■ Removing FOMA card

1 Hook a finger on the tab, pull the tray out (1) and remove the FOMA card (2).

- Do not allow the FOMA card to fall when removing it.

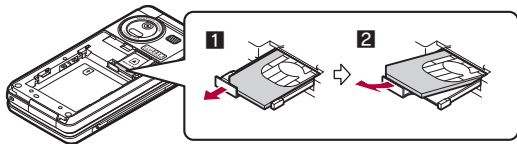

- Inserting or removing the FOMA card forcibly may damage the card or deform the tray. Use caution.
- Refer to the FOMA card user's guide for more information on the FOMA card.
- Do not misplace the FOMA card once it is taken out.
- When the tray falls off, slide the tray in straight along the guide rail.

Security codes

The FOMA card has a "PIN1 code" and a "PIN2 code".

Both are set to [0000] by default but can be changed to a four- to eight-digit number by the user (P. 125).

FOMA card security functions

<FOMA card security functions>

The FOMA terminal has built-in FOMA card security functions (FOMA card restriction functions) as functions for protecting personal data and files.

- When data or files are retrieved using any of the following methods or i-αpli is running with the FOMA card inserted into the FOMA terminal, FOMA card security functions are automatically set in the retrieved data or files.
 - When a file such as an image, melody or PDF is downloaded from a site or Internet web page
 - When a site or Internet web page is saved as a screen memo
 - When i-mode mail with a file attached is received
 - When i-αpli is running
- Data, files or software with FOMA card security functions run only when in use with the FOMA card inserted at time of acquisition. Display, play, attach to i-mode mail, run software, send data using Ir communication function and iC communication function, and copy to microSD Card can be executed. These operations cannot be performed if a different FOMA card is inserted.
- The following indicates the data for which FOMA card security is set.

■ Melody	■ Image (including animation and Flash movie)
■ Screen memo	■ Chaku-uta®/Chaku-uta full®
■ Chara-den	■ File attached to Message R/F
■ i-motion	■ ToruCa (details) image
■ PDF data	■ Image inserted to Deco-mail or signature
■ Kisekai Tool	■ Videophone picture memo

- Machi-chara ■ i-appli (including i-appli stand-by)
- Download dictionary
- Download font
- Contents transfer compatible data
- Image in Message R/F
- Music&Video Channel program
- Deco-mail template with data which FOMA card security functions are set
- Decome-Anime Template
- e-book/e-dictionary/e-comic saved in the [Comic] folder
- File attached to i-mode mail other than the following
 - ToruCa • Phonebook • Schedule
 - Bookmark • Documents
- ※ "Chaku-uta" is a registered trademark of the Sony Music Entertainment (Japan) Inc.
- The following indicates the settings saved in the FOMA card.
 - Own number ■ PIN setting
 - Select language ■ SSL certificates
 - SMS center ■ SMS expiry
 - SMS input character
- The following explanation refers to the FOMA card inserted at time of data/files retrieval as "one's own FOMA card" and other FOMA cards as "another's FOMA card".

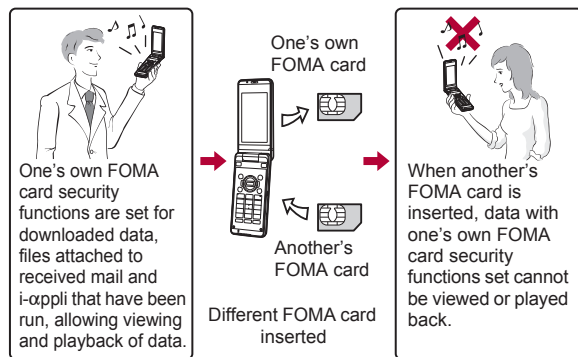

- When one's own FOMA card is replaced with another's FOMA card, the data or files for which FOMA card security functions are set cannot be set as stand-by displays or ring tones.
- When a FOMA card is replaced with another's FOMA card, FOMA card security functions are activated and if data or file retrieved from a site is set as the stand-by display or ring tone, the setting is reset to the default. When one's own FOMA card is re-inserted, the setting returns.

Example: When setting [Melody A], for which FOMA card security functions are set, as a ring tone

When one's own FOMA card is taken out or is replaced with another's FOMA card, ring tone returns to default setting. When one's own FOMA card is put back, the ring tone returns to [Melody A].

- FOMA card security functions cannot be set for data received using Ir communication or data transmission functions, and still pictures/movies, etc. shot with the FOMA terminal.

- It is possible to move or delete data or files for which FOMA card security functions are set even when another's FOMA card is inserted.
- Running i-appli by selecting highlighted text in i-mode mail details screen cannot be performed or retrieved when FOMA card security functions are set.
- If the FOMA card is replaced with another's FOMA card after i-appli stand-by is set, the set i-appli cannot be activated in stand-by, and the image set in Stand-by display appears.

FOMA card type

Note the following differences between "FOMA card (blue)" and "FOMA card (green/white)" used on the FOMA terminal.

Function	FOMA card (blue)	FOMA card (green/white)	Page
Number of phone number digits available in the FOMA card phonebook	Up to 20 digits	Up to 26 digits	P. 94
Client certificate operations for FirstPass	Not available	Available	P. 190
Use of WORLD WING	Not available	Available	P. 438
Service Numbers	Not available	Available	P. 429

About WORLD WING

WORLD WING is a DOCOMO's FOMA international roaming service that makes it possible to use the mobile phone number registered in Japan to make and receive calls even overseas by the FOMA card (green/white) and supported FOMA terminal.

- If subscribed to the FOMA service after September 1, 2005, subscription for "WORLD WING" is not required. However, if subscription for "WORLD WING" is canceled at or after subscription for the FOMA service, subscription for "WORLD WING" is required again.
- If subscribed to the FOMA service before August 31, 2005 but not subscribed to "WORLD WING", subscription for "WORLD WING" is required.
- Some payment plans are not available.
- When the FOMA card (green/white) is lost or stolen overseas, promptly contact DOCOMO and conduct a procedure for canceling the use of service. Refer to General Inquiries on the back of this manual for inquiries. Note that transmission/calling charges after the FOMA card is lost or stolen are incurred to the subscriber.

Attaching/Removing battery pack

Use the battery pack SH20 exclusive to the FOMA terminal.

- Turn off the power, close the FOMA terminal, and hold it in your both hands before attaching or removing the battery pack.

■ Attaching battery pack

- 1 Lightly push the back cover in the direction of the arrow (❶), slide approximately 3 mm (❷) and remove the back cover (❸).

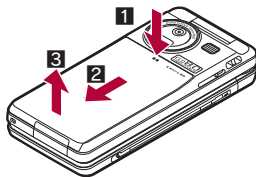

2 Attach the battery pack (4).

- The battery pack has tabs that make it easy to attach. Attach the battery pack with a recycle mark side faced up.

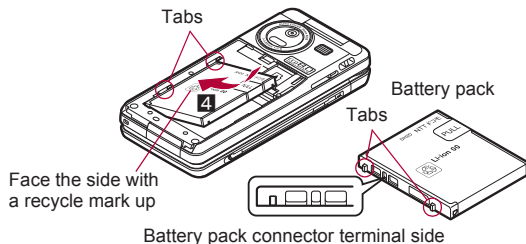

3 Attach the back cover (5).

- Attach the back cover as shown in the illustration and then push the back cover and slide into place.

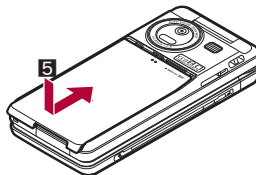

■ Removing battery pack

1 Follow step 1 of “Attaching battery pack” to remove the back cover.

2 Remove the battery pack.

- The battery pack has a “PULL” Tag that makes it easy to remove. Hold the “PULL” Tag between the fingers and lift up it in the direction of an arrow (45-degree from the FOMA terminal) to remove the battery pack.

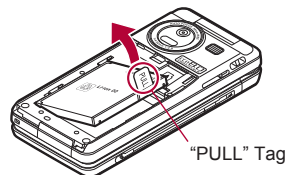

- Using unnecessary force when attaching or removing the battery pack may damage the connector terminal for the battery pack (charger terminal) on the FOMA terminal.
- Firmly close the back cover. If not closed firmly, the back cover may come off and the battery pack may fall out due to vibration.

Charging

The battery pack is not fully charged at the time of purchase. Be sure to charge the battery using the exclusive AC or DC adapter (sold separately) before use.

■ Cautions while charging

- Do not charge for long periods of time with the power left on. If the FOMA terminal is left on after charging is complete, the battery pack charge decreases.
- In such cases, the AC or DC adapter charges the battery again. However, depending on when the FOMA terminal is disconnected from the AC or DC adapter, the battery charge level may be low, the battery alert tone may sound, or the battery may only be usable for a short time.
- When the battery is empty and terminal is recharging, charging LED may not illuminate immediately.
- If the battery empty alert is displayed, the alert tone sounds and the power cannot be turned on, charge the battery for a while.
- If the battery empty alert is displayed and charging begins within 60 seconds of the alert tone, the status returns to normal.
- While charging, terminal may not turn on even when charging LED is illuminated in red. Charge longer and try turning power on again.
- Frequently recharging the battery when its power is still remaining enough may shorten the life of the battery pack. It is recommended to use the battery to a certain level before recharging.
- The battery pack cannot be charged by itself.

■ Estimated charge times and LED display

The following figures are estimated times for charging an empty battery pack with the FOMA terminal turned off.

FOMA AC Adapter 01/02	Approx. \$\$ min
FOMA DC Adapter 01/02	Approx. \$\$ min

- Charging LED illuminates in red while charging, and it turns off when charging is completed.
- Check that the battery pack has been properly attached when charging LED flashes red. The LED also flashes red when the battery pack has reached the end of its service life.

- The battery pack can also be charged with the FOMA terminal turned on (🔴 on the display flashes during charging). When charging is completed, charging LED turns off, and 🔴 on the display changes to 🔴.
- When the battery becomes warm, charging may automatically stop even if the battery has not been fully charged. Charging resumes after the temperature lowers to an appropriate temperature. While charging is stopped, charging LED turns off (🔴 on the display flashes while stopped).

■ Estimated times of use when fully charged

Continuous talk time	FOMA/3G		Voice call: Approx. \$\$ min
			Videophone call: Approx. \$\$ min
	GSM		Voice call: Approx. \$\$ min
Continuous stand-by time	FOMA/3G	3G/GSM setting: 3G	When mobile: Approx. \$\$ hr
		3G/GSM setting: AUTO	When mobile: Approx. \$\$ hr
	GSM		At rest: Approx. \$\$ hr
		3G/GSM setting: AUTO	At rest: Approx. \$\$ hr
1Seg watching time			Approx. \$\$ min

- Continuous talk time is estimated as the usage time at normal transmission signal strength, and continuous stand-by time is estimated as the usage time while moving with the FOMA terminal folded at normal signal strength. Using i-mode reduces talk (transmission)/stand-by time. When i-Channel is subscribed, information is automatically received and updated, so talk (transmission)/stand-by time will be reduced. In addition, when shooting or editing an image, watching 1Seg, composing i-mode mail, activating the downloaded i-appli or the i-appli stand-by, or using MUSIC Player, i-motion player, Bluetooth function or data communication, the talk (transmission)/stand-by time will be reduced even if calls or i-mode transmission are not made. Some i-appli software may continue transmission even after downloading. To avoid this, set not to connect in advance.

- The actual usage time is a combination of stand-by time and talk time, and the longer the talk time, the shorter the stand-by time becomes.
- 1Seg watching time is estimated as the watching time at normal transmission signal strength with a flat-plug stereo earphone set P01 (sold separately) used.
- Talk (transmission)/stand-by time may be reduced by about half or 1Seg watching time may be shortened depending on battery pack status, function used, temperature and other environmental conditions, or signal strength (no signal or weak signal).

Battery pack service life

- Battery pack is a consumable product. Service time per charge is gradually reduced every time the battery is charged.
- When service time per charge is reduced to about half of the default time, this means that the battery pack is approaching the end of its service life. In such a case, it is recommended to replace the battery pack as soon as possible. Depending on usage, the battery pack may swell as it approaches the end of its service life but this will not cause problems.
- If i-appli, Videophone, or 1Seg is used while charging for a long time, the service life of the battery pack may become shorter than estimated.
- To protect the environment, return used batteries to NTT DOCOMO, any DOCOMO retailer, or a recycling agency.



Li-ion 00

About charging batteries

- Refer to user's guide of FOMA AC Adapter 01/02 (sold separately), FOMA AC Adapter 01 for Global use (sold separately), or FOMA DC Adapter 01/02 (sold separately).
- FOMA AC Adapter 01 covers only 100V AC. FOMA AC Adapter 02/ FOMA AC Adapter 01 for Global use covers from 100 to 240V AC.

- The shape of the plug for the AC adapter is for 100V AC (for domestic use). To use the AC adapter of 100 to 240V AC overseas, a conversion plug adapter that is compatible with the voltage of your country of stay is required. Do not use a transformer for use overseas to charge the battery.

Charging by using AC adapter/DC adapter

[Read "FOMA AC adapter 01/02 (sold separately) and FOMA DC adapter 01/02 (sold separately) user's guide" carefully.]

- Battery pack can be charged even with the FOMA terminal opened or in the viewer position.

- 1 Open the external connector terminal cover (1) and insert the AC or DC adapter connector horizontally into the external connector terminal (2).

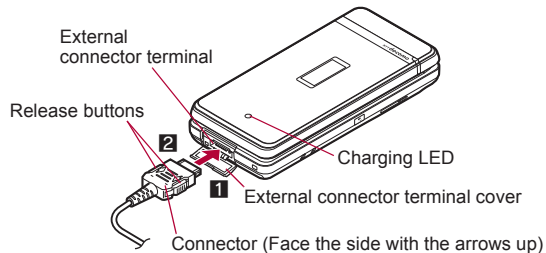

- Check the direction (See diagram) of the connector, keep it parallel with the FOMA terminal and firmly push all the way in until it clicks.

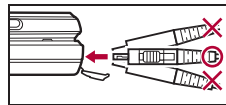

- 2** When inserting the AC adapter power plug into an outlet or inserting the DC adapter power plug into a car cigarette lighter socket, Charge start sound is heard, charging LED illuminates, and charging starts.

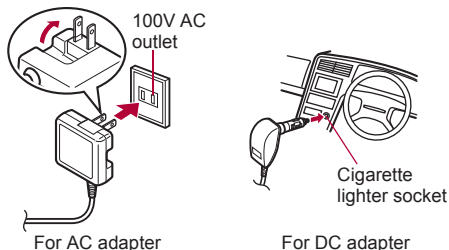

- 3** When Charge end sound is heard and charging LED turns off, charging is complete.

- When removing the connector, always hold the release buttons on both sides (1) and unplug it by pulling out horizontally (2).

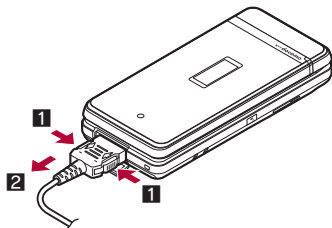

- Do not forcibly insert or remove. May cause damage to the external connector terminal and the connector.

- Pull the adapter out of the outlet or cigarette lighter socket if it will not be used for a long time.
- Do not forcefully pull the external connector terminal cover. May damage the cover.
- Do not place objects near the FOMA terminal when charging. May damage the FOMA terminal. In addition, a display may be damaged when charged in the viewer position.

When using a DC adapter

- The DC adapter should only be used in negative grounded vehicles (12 and 24V DC).
- Do not use with the car engine shut off. May drain the car battery.
- The DC adapter fuse (2A) is a consumable. For replacement, purchase a new fuse at a local automobile supply shop.
- Refer to the FOMA DC Adapter 01/02 user's guide for details.

Charging by using desktop holder

[Read "Desktop holder SH22 (sold separately) user's guide" carefully.]

- Battery pack can be charged with the FOMA terminal opened or in the viewer position.

- 1** Face the side with the arrows of the AC adapter connector up and insert it into the connector terminal of the desktop holder (1).
 - Keeping the connector parallel with the desktop holder, firmly push it all the way in until it clicks.
- 2** Insert the AC adapter power plug into an outlet (2).
- 3** When placing the FOMA terminal in the desktop holder, Charge start sound is heard, Charging LED illuminates, and charging starts.
 - Place the FOMA terminal as the figure shows (3), and push it in the direction of the arrow (4) until it clicks.

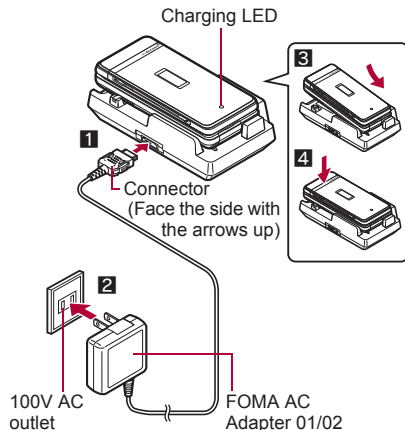

4 When Charge end sound is heard and charging LED turns off, charging is complete.

- Hold the desktop holder and lift the FOMA terminal out.
- Pull the AC adapter out of the outlet when left unused for a long period of time.
- When Charge start sound is not heard or when charging LED does not illuminate, check that the FOMA terminal is placed securely in the desktop holder (except when terminal is turned off, Manner mode is set or Charge start sound is Silent).
- When placing the FOMA terminal in the desktop holder, be careful that the strap is not caught in between the handset and the desktop holder.
- When the FOMA terminal placed in the desktop holder is set to the viewer position, operate while holding it so as not to come off from the desktop holder.

Battery level

Checking battery level



	Battery level is still sufficient.
	Battery level is low.
	Battery is almost empty. Charge the battery.
	Battery is empty (Power will turn off soon).
	Battery pack is being charged.

Checking battery level with sound and display

1 In the Custom menu, select [Settings] ▶ [General settings] ▶ [Check status] ▶ [Battery level].

Graphic			
Sound	Three beeps	Two beeps	One beep
Status	Battery is sufficiently full.	Battery is running low.	Battery is almost empty. Charge the battery.

- Wait approximately 2 seconds and the display disappears.
- The battery level sound is heard at the volume set in Key/Touch sound (P. 104).

If battery runs out

[Battery empty. Unsaved data will be lost. Ending current operation] appears if battery starts to run out (Press  to clear the message). After a while, an alert tone sounds. The warning screen stating that the battery runs out appears, handset operations are disabled and power turns off after approximately 60 seconds.



- During a voice/Videophone call, the alert tone sounds and [Battery empty. Unsaved data will be lost. Ending current operation] appears. The call is disconnected after approximately 20 seconds. At the same time, the screen above appears and after approximately 60 seconds, the power turns off.
- Alert tone does not sound when Manner mode or Public mode (Drive mode) is set (Alert tone sounds during a call).

Power ON/OFF

Turning power ON/OFF

Turning power ON

1 Press (for 2+ seconds).











- It may take some time for the wakeup screen to appear.
- The wakeup screen appears followed by the initial settings screen. Proceed to Initial setting ( P. 54).

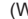

- If initial settings have been completed, the screen shown on the right appears when power is turned on. This screen is called the “stand-by display”.

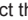

Stand-by display

Welcome mail

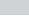
- “Welcome  デコメアニメ  ” (Welcome  Decome-Anime ) and “緊急速報「エリアメール」のご案内” (Information of Early Warning “Area Mail”) are saved by default.
- To check a welcome mail: In stand-by, press   select the stock icon  (mail message)  .
- For details on the following operations  P. 154

- If initial settings are not yet completed, the setting screen appears every time the power is turned on.
- If the FOMA card is not inserted, [Insert UIM] and a FOMA card error appear ( P. 31).
- When [Enter PIN1 code] appears, enter the PIN1 code ( P. 125).
- When a FOMA card is replaced with a new card, the terminal security code (four to eight digits) must be entered after turning on the terminal. If a correct terminal security code is entered, stand-by display appears. When a wrong terminal security code is entered five times, the power is turned off. However, turning on the power again is possible.
- When  appears, the handset is outside the service area or in a place with no signal. Move to a place where the icon disappears.

Turning power OFF

1 Press (for 2+ seconds).

- It may take some time for the power to be turned off (The end screen appears on the display until the power is turned off).

Select language

Changing screen display to English

1 In the Custom menu, select [設定] ▶ [一般設定] ▶ [Bilingual] ▶ [English].

- To switch the display language from English to Japanese: In the Custom menu, select [Settings] ▶ [General settings] ▶ [Select language] ▶ [日本語].
- If a FOMA card is inserted, settings are saved to the FOMA card as well. When the setting of the FOMA terminal handset and the setting of the inserted FOMA card are different, the setting in the FOMA card is prioritized.

Initial setting

Making initial setting

The initial settings screen appears automatically when the power is turned on for the first time. Each setting item can also be set from Menu (When the initial settings are complete, the stand-by display appears).

- Date and time settings
- Change terminal security code
- Key/Touch sound
- Location request menu
- Font size settings
- When items that have not been set remain, the setting screen appears every time the power is turned on.

1 Set the date and time (☎ P. 54).

2 Register a terminal security code (☎ P. 123).

3 Set the Key/Touch sound (☎ P. 104).

4 Set GPS Location provision ON/OFF (☎ P. 318).

5 Set the font size (☎ P. 119).

- When the initial settings are complete, the software update function confirmation screen appears. Read the description and select [Agree] (When the initial settings are made from the menu or the software update is set to other than [auto-update], the confirmation screen does not appear).

- Press  to cancel the initial settings.

Date settings





Setting date and time

Set the date and time on the FOMA terminal.

1 In the Custom menu, select [Settings] ▶ [General settings] ▶ [Date settings].

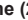

2 Select the [Auto time correction] field ▶ ▶ select the setting.



- ◆ Select [ON] ▶ .
- ◆ Select [OFF] ▶ select the [Date] field ▶  ▶ enter the date ▶  ▶ select the [Time] field ▶  ▶ enter the time (24-hour format) ▶  ▶ .
- When entering month, day and time, add 0 before numbers one through nine (example: 01, 02, 03, etc.).
- Set the date and time from 00:00 January 1, 2001 to 23:59 December 31, 2050.

- When Limit settings is set to [Enable], the terminal security code must be entered in the Date settings.

- The date and time that are set are saved even if the battery pack is removed, but if the battery pack remains removed for approximately 30 seconds or more, the settings are reset. Also, if the battery remains empty, the settings may be reset. When this happens, set again after charging the battery.
- If the date and time are not set correctly, the following functions cannot be used properly.





■ Redial, Received calls	■ Auto power ON/OFF
■ Alarm	■ Schedule
■ SSL (authentication)	■ i-appli Auto start
■ Starting i-appliDX	■ Reception, Recording
■ Machi-chara	■ Software update
■ Pattern definitions update	
■ Record message (voice), Record message (Videophone calls)	
■ Camera image titles/shooting date	
■ Playback of i-motion or music data with expiration date/period for replay.	
■ View of e-books/e-dictionaries/e-comics with expiration date/period for browse.	

When Auto time correction is set to [ON]

- When the power is turned on, the FOMA terminal adjusts the time by connecting to the network's time information.
- If the FOMA terminal does not adjust the time even when the power is turned on, turn off the power and restart.
- Time may not be adjusted depending on the signal status.
- Time may be off by a few seconds.
- When time difference is adjusted overseas, the local time and date and  appear in Redial, Received calls, Received/Sent messages history (SMS only), and Received/Sent messages list. The received/sent messages are not displayed in order of the displayed time and date but the mail reception/send.
-  does not appear in the Unsent messages for mail messages. If the date order display is set for the Unsent messages, unsent messages are displayed in the order of the displayed time and date.

- Time correction may not be performed depending on the overseas network.
- During overseas use, Japan time and local time (or time set in City) appear in the dual display except for the following cases.
 - When Auto time correction is set to [ON] and time correction information is not being received from an overseas network
 - When Auto time correction is set to [OFF] and City is set to the city in the same time zone as Japan

■ Changing time zone manually <City>

- 1 In the Date settings screen, select the [Auto time correction] field ▶  ▶ [OFF] ▶ .
- 2 Select a time zone ▶ .
- 3 Select a city ▶  ▶ .

Notify caller ID

Notifying the other party of your phone number

Display your number (caller ID) on the other party's phone (display) when making a voice/Videophone/PushTalk call.

- Handset number (caller ID) is important personal information. Be very careful about your caller ID setting.
- The Notify caller ID function is available only on compatible phone devices.

Setting Notify caller ID/No caller ID in advance

- 1** In the Custom menu, select [Settings] ▶ [NW Services] ▶ [Notify caller ID].
- 2** Select [Activate/Deactivate].
 - To check the setting: Select [Check setting].
- 3** Select the setting.
 - To notify caller ID: Select [Yes].
 - To not notify caller ID: Select [No].

- Notify caller ID setting cannot be set from outside the service area.

Own number

Checking your own phone number

- When checking your own phone number during a call ☎ P. 59
- 1** In the Custom menu, press **[0]**.
 - Alternatively, select [Phone] ▶ [Owner Information].
 - To switch between Number A and Number B (when 2in1 [Dual mode] is used): Press **[i]**.
- When changing the Number B of 2in1, use any of the following methods to obtain the correct Number B.
 - Set 2in1 function OFF and then perform 2in1 setting again to set 2in1 function ON
 - Check the 2in1 subscription
 - When a FOMA card exchange (2in1 subscriber → 2in1 nonsubscriber) is performed, set 2in1 function OFF.
 - When a FOMA card exchange (2in1 subscriber → 2in1 subscriber) is performed, check the 2in1 subscription.
 - For details on Owner information ☎ P. 395

Outline of international roaming (WORLD WING)

International roaming (WORLD WING) is a service that enables you, using overseas telecommunications carrier's networks, to make calls and use i-mode.

Use this FOMA terminal for voice/Videophone calls, i-mode and SMS with the phone number and mail address used in Japan. Network services such as Voice Mail and Call Forwarding Services can also be used.

- This service is available in the 3G network and GSM/GPRS network service areas. Refer to the DOCOMO "International Services website" for details on the area.
- By default, the FOMA terminal is set to automatically switch networks (P. 444).

Country codes of major countries

The following shows "Country code" used when making international calls (P. 65) or setting International dial assist (P. 66).

- For other country codes and details, refer to the DOCOMO "International Services website".

Country/Region	Code	Country/Region	Code
Australia	61	Maldives	960
Austria	43	Netherlands	31
Belgium	32	New Caledonia	687
Brazil	55	New Zealand	64
Canada	1	Norway	47
China	86	Peru	51
Czech	420	Philippines	63
Egypt	20	Russia	7
Fiji	679	Singapore	65
Finland	358	South Korea	82
France	33	Spain	34
Germany	49	Sweden	46
Greece	30	Switzerland	41
Hong Kong	852	Tahiti	689
Hungary	36	(French Polynesia)	
India	91	Taiwan	886
Indonesia	62	Thailand	66
Italy	39	Turkey	90
Japan	81	U.K.	44
Macau	853	U.S.A.	1
Malaysia	60	Vietnam	84

Available services overseas

The available communication services overseas are as follows.

Communication service	Explanation	3G	GSM	GPRS
Voice call	Make or receive calls in your country of stay or make international calls to Japan or to other countries with the same phone number as used in Japan while abroad.	○	○	○
Videophone	Make international Videophone calls to users of the specified 3G telecommunications carriers overseas and FOMA users in Japan.	○	×	×
i-mode mail	Send or receive i-mode mail overseas with the same address as used in Japan.	○	×	○
i-mode	Use i-mode overseas.	○	×	○
i-Channel	Use i-Channel overseas.	○	×	○
i-concier	Use i-concier overseas.	○	×	○
i-Widget	Use i-Widget overseas.	○	×	○
SMS	Send or receive SMS overseas with the same phone number as used in Japan.	○	○	○
Data communication (packet transmission)	Use packet transmission overseas.	○	×	○

- Some communication services are not available depending on the network/carrier. Refer to the DOCOMO "International Services website" for details.

- Packet transmission charges are separately incurred for the transmission included in monthly usage fees of i-Channel (P. 194) overseas.
- If i-Widget attempts transmission when the i-Widget screen appears, packet transmission charges are incurred for each transmission overseas.
- Unable to use 64K data communication by connecting a PC, etc. overseas.
- 日英版しゃべって翻訳 for SH (J-E Speech Translation for SH) is available overseas (P. 280).
- GPS function is not available overseas. An error screen appears and packet transmission charges are incurred when the site of GPS Service settings is accessed overseas.
- Overseas packet transmission charges differ from those in Japan.
- When the 2in1 is used, calling from Number B is not available overseas.
- When Multi Number is used, calling from Additional Number is not available overseas.

Before use overseas

The following items must be checked before departure, at your country of stay, and after homecoming.

Preparation before departure

Prepare below in Japan before using the FOMA terminal overseas.

About contract

- If subscribed to the FOMA service after September 1, 2005, a subscription for "WORLD WING" is not required. However, if a subscription for "WORLD WING" is canceled at or after a subscription for the FOMA service, a subscription for "WORLD WING" is required again.
- If subscribed to the FOMA service before August 31, 2005 but not subscribed to "WORLD WING", a subscription for "WORLD WING" is required. Some payment plans are not available.

- Insert the WORLD WING compatible FOMA card (other than blue) to the FOMA terminal (P. 44).

About charging batteries

- Precautions for handling the AC adapter P. 16
- Methods for charging the AC adapter P. 48

About browsing i-mode sites

To browse i-mode site overseas, the settings for overseas use must be made from iMenu in advance.

i-mode site: Select [iMenu] ▶ [English] ▶ [Options] ▶ [International Settings] ▶ [i-mode services Settings].

- Refer to “Mobile Phone User’s Guide [International Services]” and “Mobile Phone User’s Guide [i-mode] FOMA version” for details.

About setting network service

If subscribed to network services, Voice Mail Service, Call Forwarding Service or other services can be used overseas.

- Some network services may not be set or checked depending on overseas telecommunications carrier. In addition, some network services are available only in Japan. Refer to “Mobile Phone User’s Guide [International Services]” and “Mobile Phone User’s Guide [Network Services]” before departure.
- To use network services overseas, set Remote Control (P. 430, P. 446) to “Activate”.

About inquiries overseas

For lost, stolen, and cost settlement, or malfunction of the FOMA terminal overseas, refer to “Loss or theft of FOMA terminal or payment of cumulative cost overseas” or “Failures encountered overseas” on the back of this manual. Note that any call or transmission charges incurred after the FOMA terminal is lost or stolen are charged to the subscriber.

- Add the “International call access code (Table 1)” or “International prefix number for the universal number (Table 2)” that is assigned to your country of stay, to the head of your phone number for inquiries.

- For the latest information of the international call access code and the international prefix number for the universal number, refer to the DOCOMO “International Services website”.

International call access codes of major countries (Table 1)

The following shows the International call access codes of major countries.

- Communication charges to Japan will apply.

Country/Region	Code	Country/Region	Code
Australia	0011	Monaco	00
Belgium	00	Netherlands	00
Brazil	0021/ 0014	New Zealand	00
		Norway	00
Canada	011	Philippines	00
China	00	Poland	00
Czech	00	Portugal	00
Denmark	00	Russia	810
Finland	00	Singapore	001
France	00	South Korea	001
Germany	00	Spain	00
Greece	00	Sweden	00
Hong Kong	001	Switzerland	00
Hungary	00	Taiwan	002
India	00	Thailand	001
Indonesia	001	Turkey	00
Ireland	00	U.A.E.	00
Italy	00	U.K.	00
Luxemburg	00	U.S.A.	011
Macau	00	Vietnam	00
Malaysia	00		

International prefix number for the universal number (Table 2)

The following shows the International prefix number for the universal number of each country.

- Communication charges or other charges to your country of stay will apply.
- Communication charges to your country of stay will apply when calling from the mobile phone.

Country/Region	Code	Country/Region	Code
Argentina	00	Luxemburg	00
Australia	0011	Malaysia	00
Austria	00	Netherlands	00
Belgium	00	New Zealand	00
Brazil	0021	Norway	00
Bulgaria	00	Peru	00
Canada	011	Philippines	00
China	00	Portugal	00
Columbia	009	Singapore	001
Denmark	00	South Africa	09
Finland	990	South Korea	001
France	00	Spain	00
Germany	00	Sweden	00
Hong Kong	001	Switzerland	00
Hungary	00	Taiwan	00
Ireland	00	Thailand	001
Israel	014	U.K.	00
Italy	00	U.S.A.	011

- Some codes may not be used.
- Note that the universal number may not be used for calls from a mobile phone, payphone or hotel.
- The universal number can be used only for countries listed above.

- Calling from a hotel may cost you extra call charges requested by the hotel (You are responsible for the call charges). Confirm with the hotel before making calls.

Using at your country of stay

The service is available in the 3G network and GSM/GPRS network service areas.

The FOMA terminal is set to automatically search for the network when the power is turned on, and to be connected to the available telecommunications carrier in your country of stay.

- If the connected telecommunications carrier is changed when Auto time correction (P. 54) is set to [ON], a screen notifying that time difference is adjusted may appear.
- When Operator name display (P. 445) is set to [Display on], the telecommunications carrier connected appears in stand-by.
- When Clock display (P. 109) is set to [ON(Large)], the local time and Japan time appear (excluding regions keeping the same standard time as Japan time). The local time appears on the sub display.
- Talk time or stand-by time may be reduced to half the normal time depending on the network condition of your country of stay.

Setting after homecoming

By default, the FOMA terminal is set to automatically search for the network and to be connected to the FOMA network when the power is turned on after homecoming.

Reset the Network search mode to the FOMA network (DOCOMO).

- If the Network search mode is set to [Manual], switch to the FOMA network (DOCOMO) manually or change to [Auto].
- Set the 3G/GSM setting to [AUTO] or [3G].

Making a call at your country of stay

Make a call from overseas using the international roaming service.

Making a call outside your country of stay (including Japan)

Make a call from your country of stay to Japan or other countries.

1 In stand-by, enter [+] (press for 1+ seconds), country code, area code (city code) and other party's phone number.

- When the area code (city code) begins with 0, omit the 0 when dialing (However, include 0 when making a call to landline phones in some countries or regions such as Italy).

2 Press (Phone)/ (V.phone).

Making an international call outside your country of stay using Country code conversion

Set Country code conversion ( P. 66) to [ON] and set the country code frequently called to easily make an international call.

- 0 at the beginning of a phone number is automatically converted to the country code set in Country code conversion.

Example: Make a call from phonebook

1 In stand-by, press select the other party.

2 Press (Phone)/ (V.phone).

3 Select [Call].

- To dial a phone number as stored in the phonebook: Select [Original number].

Making a call to the phone in country saved in Set country code

Save a country code using Set country code ( P. 67) to select a country code before making an international call.

- The following operation is available overseas only.

1 In stand-by, enter a phone number [Add prefix setting] [International Call].

2 Select the country code .

3 Press (Phone)/ (V.phone).

Making a call in your country of stay

Make a domestic call at your country of stay in the same way as you do in Japan.

1 In stand-by, enter a phone number.

2 Press (Phone)/ (V.phone).

- Always dial the area code (city code), even when the number is in the same area.
- When making a domestic call at your country of stay using the phonebook, select [Original number] in step 3 of "Making an international call outside your country of stay using Country code conversion" on P. 442.

- Refer to the DOCOMO "International Services website" for details on available countries, country codes and telecommunications carriers.
- Even when Notify caller ID of the network service ( P. 55) is set to "Send ID", [Unavailable] or [User unset] appears depending on the telecommunications carrier, and the caller ID may not be displayed correctly.

Making a call to a WORLD WING subscriber overseas

When making a call to a "WORLD WING" subscriber overseas, make an international call to Japan regardless of your country of stay.

- 1** In stand-by, enter **[+]** (press **[0]** for 1+ seconds), country code **81** (Japan), the other party's mobile phone number excluding **0**.
- 2** Press **[📞]** (Phone)/**[📠]** (V.phone).

Receiving a call overseas

Receive a call overseas in the same way as you do in Japan.

- 1** Press **[📞]** to receive an incoming call.
 - Speak to the caller.
- Even when a caller tried to notify of caller ID, it might not be notified depending on the used telecommunications carrier.
 - When a call is received during international roaming, the call is forwarded from Japan. Call charges to Japan are incurred by the caller and receiving charges by the receiver.

Having calls to your FOMA terminal

■ Having calls made to your FOMA terminal from Japan

To receive an international call from Japan, have your phone number dialed just as a domestic call in Japan.

090 (or **080**)-XXXX-XXXX

- Calling from Received calls may not be available since the phone number may not be displayed correctly.

■ Having calls made to your FOMA terminal from countries other than Japan

Have the international call access code and **81** (Japan) added to the beginning of your phone number, and **0** excluded as an international call to Japan regardless of your country of stay.

International call access code of the country of the caller-81-90
(or **80**)-XXXX-XXXX

3G/GSM setting

Setting network communication system

Set the communication system supporting your area and telecommunications carrier.

- 1** In the Custom menu, select **[Settings]** ▶ **[Phone settings]** ▶ **[Other settings]** ▶ **[International Roam.]** ▶ **[3G/GSM setting]**.
- 2** Select the communication method ▶ **[⊖]**.



Network search mode

Setting a search method of telecommunications carrier

- Set to manually select a telecommunications carrier.
- Re-search a network to set another telecommunications carrier.
- Check that the Network search mode is set to [Auto] when  appears even after homecoming.

1 In the Custom menu, select [Settings] ▶ [Phone settings] ▶ [Other settings] ▶ [International Roam.] ▶ [Network search mode].

2 Select the setting.

- ◆ Select [Auto] ▶ [Yes].
 - When [Auto] is set: Select [Auto].
- ◆ Select [Manual] ▶ select a telecommunications carrier ▶ .
- ◆ Select [Network re-search].
 - The host network is changed automatically if the Network search mode is set to [Auto]. If set to [Manual], select a telecommunications carrier and press .

Checking communication services available

<In-area status>

Check the status whether making a call, data transmission or packet transmission is available.

1 In the Custom menu, select [Settings] ▶ [Phone settings] ▶ [Other settings] ▶ [In-area status] ▶ [Agree].

PLMN setting

Setting a telecommunications carrier to preferentially connect to











Specify the priority order of telecommunications carriers connected to when the Network search mode is set to [Auto]. Save up to 20.

1 In the Custom menu, select [Settings] ▶ [Phone settings] ▶ [Other settings] ▶ [International Roam.] ▶ [Network search mode] ▶ [PLMN setting].

- To check the saved telecommunications carrier's detailed information: Select the telecommunications carrier ▶ .

2 Select the number of the priority order ▶ .

3 Select the saving method.

- ◆ Select [PLMN manual select] ▶ enter a country code (MCC) ▶  ▶ enter a network code (MNC) ▶  ▶ select a communication method ▶ .
- ◆ Select [UPLMN by list] ▶ select a telecommunications carrier ▶  ▶ select a communication method ▶ .
 - To search a telecommunications carrier from country name: Select [UPLMN by list] ▶  ▶ select a country name ▶  ▶ select a telecommunications carrier ▶  ▶ select a communication method ▶ .
- ◆ Select [Set VPLMN to PLMN].
 - Save the telecommunications carrier currently connected to.
- ◆ Select [Change priority] ▶ select a destination ▶ .
- ◆ Select [Delete] ▶ [Delete one].
- ◆ Select [Delete] ▶ [Delete all] ▶ enter the terminal security code ▶ .

4 Select [Yes].

Operator name disp

Displaying a telecommunications carrier during roaming

Set whether to display a telecommunications carrier name currently connected to in stand-by during international roaming.

1 In the Custom menu, select [Settings] ▶ [Phone settings] ▶ [Other settings] ▶ [International Roam.] ▶ [Operator name disp].

2 Select the setting ▶  ▶ [Yes].

■ When displaying a telecommunications carrier

Telecommunications carrier name



Roaming guidance

Activating roaming guidance

When a call is received during international roaming, the caller hears the guidance stating that international roaming is activated.

- Make this setting while still in Japan.

1 In the Custom menu, select [Settings] ▶ [Other NW Services] ▶ [Roaming guidance].

2 Select an item ▶ .

3 Select [Yes].

Call barring



Setting incoming call to reject during roaming

Set the FOMA terminal to reject calls during roaming. Select whether to bar all incoming calls or only the Videophone and 64K data communication calls.

- Depending on the overseas telecommunications carrier, the setting cannot be made.
- Unable to use 64K data communication overseas.

1 In the Custom menu, select [Settings] ▶ [Phone settings] ▶ [Other settings] ▶ [International Roam.] ▶ [Call barring].

2 Select an item.

- ◆ Select [Activate] ▶ [Yes] ▶ select the barring method ▶  ▶ enter the network security code ▶ .
- ◆ Select [Deactivate] ▶ [Yes] ▶ enter the network security code ▶ .
- ◆ Select [Check setting].