

Selecting a function from Submenu

When [Submenu] appears in the operation guidance, press **[Q]** to display functions (Submenu) that can be used in the screen. Select the displayed Submenu with **[D]** or the Optical TOUCH CRUISER.

If there are multiple pages in the Submenu, change pages with **[D]** or the Optical TOUCH CRUISER. Alternatively, press the dial key corresponding to the menu item number (**[1]**, **[2]**, **[3]**, etc.) to select a function. However, some Submenus do not have item numbers.

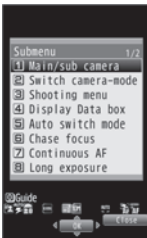

Submenu screen

Target data when operating functions from Submenu

- When operating functions from Submenu of data list screen, some functions target at selected data only while other functions target at all data in the list screen. When attempting to operate selected data only, select the data to operate in advance.
 - Function targeting at selected data only
Example: Edit title, Edit file name, Delete one, etc.
 - Function targeting at all data in the list screen
Example: Delete all, Copy all in folder, Move all in folder, etc.

Support Book

Displaying Support Book

Use this function for unsure operations. After the Support Book appears, check the explanation and operation procedures of each function. In addition, directly start functions that were looked up in the Support Book.



1 In stand-by, press **[Q]** [Support Book].

2 Select a menu or item **[D]**.

- To start functions directly: Select the function to start **[D]** **[D]** [Yes].

FOMA card

Using FOMA card

A FOMA card is an IC card that records personal information, such as phone numbers. A FOMA card can store phonebook data and SMS. By switching FOMA cards, multiple FOMA terminals can be used for different purposes as needed.

- If a FOMA card is not inserted, transmission functions such as voice/ Videophone calls, i-mode, mail transmission and packet transmission are not available on the FOMA terminal.

Inserting/Removing FOMA card

- Before inserting or removing the FOMA card, turn off the power, position the back facing upwards and remove the battery pack. Close and hold the FOMA terminal securely with your both hands.

■ Inserting FOMA card

1 Hook a finger on the tab and pull the tray out (1).

- Pull out the tray straight until it stops.

2 Hold the FOMA card with the IC facing up and set on the tray (2).

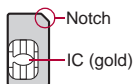

3 Push the tray all the way in (3).

Fit the notch of the FOMA card to that of the tray.

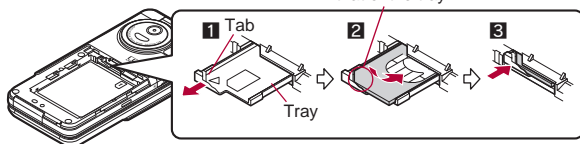

■ Removing FOMA card

1 Hook a finger on the tab, pull the tray out (1) and remove the FOMA card (2).

- Do not allow the FOMA card to fall when removing it.

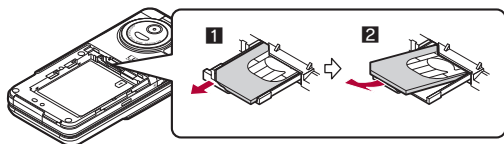

- Inserting or removing the FOMA card forcibly may damage the card or deform the tray. Use caution.
- Refer to the FOMA card user's guide for more information on the FOMA card.
- Do not misplace the FOMA card once it is taken out.
- When the tray falls off, slide the tray in straight along the guide rail.

Security codes

The FOMA card has a "PIN1 code" and a "PIN2 code".

Both are set to [0000] by default but can be changed to a four- to eight-digit number by the user (P. 110).

FOMA card security functions

<FOMA card security functions>

The FOMA terminal has built-in FOMA card security functions (FOMA card restriction functions) as functions for protecting personal data and files.

- When data or files are retrieved using any of the following methods or i-appli is running with the FOMA card inserted into the FOMA terminal, FOMA card security functions are automatically set in the retrieved data or files.
 - When a file such as an image, melody or PDF is downloaded from a site or Internet web page
 - When a site or Internet web page is added in screen memo
 - When i-mode mail with a file attached is received
 - When i-appli is running
- Data, files or software with FOMA card security functions run only when in use with the FOMA card inserted at time of acquisition. Display, play, attach to i-mode mail, run software, send data using Ir communication function and iC communication function, and copy to microSD Card can be executed. These operations cannot be performed if a different FOMA card is inserted.

- The following indicates the data for which FOMA card security is set.

■ Melody	■ Image (including animation and Flash movie)	
■ Screen memo	■ Chaku-uta®/Chaku-uta full®	
■ Chara-den	■ File attached to Message R/F	
■ i-motion	■ ToruCa (details) image	
■ PDF data	■ Image inserted to Deco-mail or signature	
■ Kisekai Tool	■ Videophone picture memo	
■ Machi-chara	■ i-appli (including i-appli stand-by)	
■ Download dictionary		
■ Download font	■ Contents transfer compatible data	
■ Image in Message R/F		
■ Music&Video Channel program		
■ Deco-mail template with data which FOMA card security functions are set		
■ Decome-Anime Template		
■ e-book/e-dictionary/e-comic saved in the [Comic] folder		
■ File attached to i-mode mail other than the following		
• ToruCa	• Phonebook	• Schedule
• Bookmark	• Documents	
- ※ "Chaku-uta" is a registered trademark of the Sony Music Entertainment (Japan) Inc.
- The following indicates the settings saved in the FOMA card.

■ Own number	■ PIN setting
■ Select language	■ SSL/TLS certificates
■ SMS center	■ SMS expiry
■ SMS input character	
- The following explanation refers to the FOMA card inserted at time of data/files retrieval as "one's own FOMA card" and other FOMA cards as "another's FOMA card".

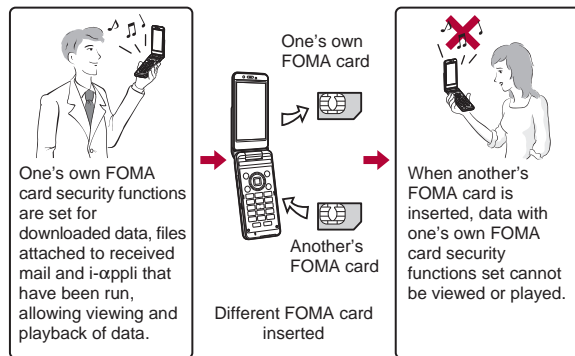

- When one's own FOMA card is replaced with another's FOMA card, the data or files for which FOMA card security functions are set cannot be set as stand-by displays or ring tones.
- When a FOMA card is replaced with another's FOMA card, FOMA card security functions are activated and if data or file retrieved from a site is set as the stand-by display or ring tone, the setting is reset to the default. When one's own FOMA card is re-inserted, the setting returns.

Example: When setting [Melody A], for which FOMA card security functions are set, as a ring tone

When one's own FOMA card is taken out or is replaced with another's FOMA card, ring tone returns to default setting. When one's own FOMA card is put back, the ring tone returns to [Melody A].

- FOMA card security functions cannot be set for data received using Ir communication or data transmission functions, and still/moving pictures, etc. shot with the FOMA terminal.
- It is possible to move or delete data or files for which FOMA card security functions are set even when another's FOMA card is inserted.
- Running i-appli by selecting highlighted text in i-mode mail details screen cannot be performed or retrieved when FOMA card security functions are set.

- If the FOMA card is replaced with another's FOMA card after i-appli stand-by is set, the set i-appli cannot be activated in stand-by, and the image set in Stand-by display appears.

FOMA card type

Note the following differences between "FOMA card (blue)" and "FOMA card (green/white)" used on the FOMA terminal.

Function	FOMA card (blue)	FOMA card (green/white)	Page
Number of phone number digits available in the FOMA card phonebook	Up to 20 digits	Up to 26 digits	P. 79
Client certificate operations for FirstPass	Not available	Available	P. 183
Use of WORLD WING	Not available	Available	P. 428
Service Numbers	Not available	Available	P. 418

About WORLD WING

WORLD WING is a DOCOMO's FOMA international roaming service that makes it possible to use the mobile phone number registered in Japan to make and receive calls even overseas by the FOMA card (green/white) and supported FOMA terminal.

- If subscribed to the FOMA service after September 1, 2005, subscription for "WORLD WING" is not required. However, if subscription for "WORLD WING" is canceled at or after subscription for the FOMA service, subscription for "WORLD WING" is required again.
- If subscribed to the FOMA service before August 31, 2005 but not subscribed to "WORLD WING", subscription for "WORLD WING" is required.
- Some payment plans are not available.
- When the FOMA card (green/white) is lost or stolen overseas, promptly contact DOCOMO and conduct a procedure for canceling the use of service. Refer to General Inquiries on the back of this manual for inquiries. Note that transmission/calling charges after the FOMA card is lost or stolen are incurred to the subscriber.

Attaching/Removing battery pack

Use the Battery Pack SH22 exclusive to the FOMA terminal.

- Turn off the power, close the FOMA terminal, and hold it in your both hands before attaching or removing the battery pack.

■ Attaching battery pack

- 1 Push the back cover in the direction of the arrow (1), slide approximately 2 mm (2) and remove the back cover (3).

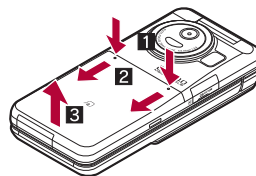

- 2 Attach the battery pack (4).

- The FOMA terminal has tabs that make it easy to attach. Attach the battery pack with a recycle mark side up.

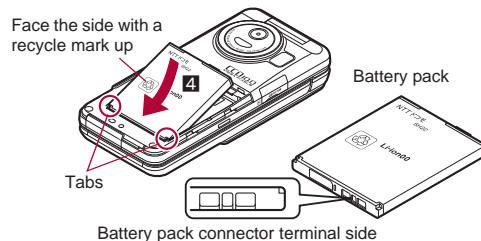

3 Attach the back cover (5).

- Place the back cover as shown in the illustration and then push the back cover and slide.

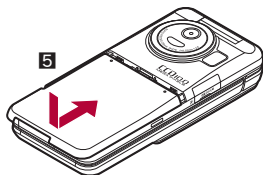

■ Removing battery pack

1 Follow step 1 of “Attaching battery pack” to remove the back cover.

2 Remove the battery pack.

- The battery pack has a tab that makes it easy to remove. Hook a finger on the tab to prevent excessive force on it and remove the battery pack upward.

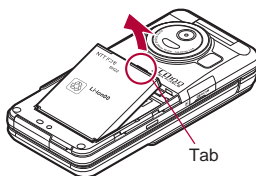

- Using unnecessary force when attaching or removing the battery pack may damage the connector terminal for the battery pack (charger terminal) on the FOMA terminal.
- Securely close the back cover. If not closed securely, the back cover may come off and the battery pack may fall out due to vibration.

Charging

The battery pack is not fully charged at the time of purchase. Be sure to charge the battery using the exclusive AC or DC adapter (sold separately) before use.

■ Cautions while charging

- Do not charge for long periods of time with the power left on. If the FOMA terminal is left on after charging is complete, the battery pack charge decreases.
In such cases, the AC or DC adapter charges the battery again. However, depending on when the FOMA terminal is disconnected from the AC or DC adapter, the battery charge level may be low, the battery alert tone may sound, or the battery may only be usable for a short time.
- When the battery is empty and terminal is recharging, charging LED may not illuminate immediately.
- If the battery empty alert is displayed, the alert tone sounds and the power cannot be turned on, charge the battery for a while.
- If the battery empty alert is displayed and charging begins within 60 seconds of the alert tone, the status returns to normal.
- While charging, terminal may not turn on even when charging LED is illuminated in red. Charge longer and try turning power on again.
- Frequently recharging the battery when its power is still remaining enough may shorten the life of the battery pack. It is recommended to use the battery to a certain level before recharging.

■ Estimated charge times and LED display

The following figures are estimated times for charging an empty battery pack with the FOMA terminal turned off.

FOMA AC Adapter 01/02	Approx. \$\$ min
FOMA DC Adapter 01/02	Approx. \$\$ min

- Charging LED illuminates in red while charging, and it turns off when charging is completed.

- Check that the battery pack has been properly attached when charging LED flashes red. The LED also flashes red when the battery pack has reached the end of its service life.
- The battery pack can also be charged with the FOMA terminal turned on (Battery icon flashes during charging).
- When the battery becomes warm, charging may automatically stop even if the battery has not been fully charged. Charging resumes after the temperature lowers to an appropriate temperature. While charging is stopped, charging LED turns off (Battery icon flashes while stopped).

■ Estimated times of use when fully charged

Continuous talk time	FOMA/3G		Voice call: Approx. \$\$ min Videophone call: Approx. \$\$ min (Substitute image: Approx. \$\$ min)
	GSM		Voice call: Approx. \$\$ min
Continuous stand-by time	FOMA/3G	3G/GSM setting: 3G	When mobile: Approx. \$\$ hr
		3G/GSM setting: AUTO	When mobile: Approx. \$\$ hr At rest: Approx. \$\$ hr
	GSM	3G/GSM setting: AUTO	At rest: Approx. \$\$ hr
1Seg watching time			Approx. \$\$ min

- Continuous talk time is estimated as the usage time at normal transmission signal strength, and continuous stand-by time is estimated as the usage time while moving with the FOMA terminal folded at normal signal strength. Using i-mode reduces talk (transmission)/stand-by time. When i-Channel is subscribed, information is automatically received and updated, so talk (transmission)/stand-by time will be reduced. In addition, when shooting or editing an image, watching 1Seg, composing i-mode mail, activating the downloaded i-appli or the i-appli stand-by, or using MUSIC Player, i-motion player, Bluetooth function or data communication, the talk (transmission)/stand-by time will be reduced even if calls or i-mode transmission are not made. Some i-appli software may continue transmission even after downloading. To avoid this, set not to connect in advance.
- The actual usage time is a combination of stand-by time and talk time, and the longer the talk time, the shorter the stand-by time becomes.
- 1Seg watching time is estimated as the watching time at normal transmission signal strength with the Stereo Earphone Set 01 (sold separately) used.
- Talk (transmission)/stand-by time may be reduced by about half or 1Seg watching time may be shortened depending on battery pack status, function used, temperature and other environmental conditions, or signal strength (no signal or weak signal).

■ Battery pack service life

- Battery pack is a consumable product. Service time per charge is gradually reduced every time the battery is charged.
- When service time per charge is reduced to about half of the default time, this means that the battery pack is approaching the end of its service life. In such a case, it is recommended to replace the battery pack as soon as possible. Depending on usage, the battery pack may swell as it approaches the end of its service life but this will not cause problems.
- If i-appli, Videophone, or 1Seg is used while charging for a long time, the service life of the battery pack may become shorter than estimated.
- To prevent damage to the environment, bring used battery packs to a docomo service counter, a docomo agent or a recycle center.



Li-ion00

About charging batteries

- Refer to user's guide of FOMA AC Adapter 01/02 (sold separately), FOMA AC Adapter 01 for Global use (sold separately), or FOMA DC Adapter 01/02 (sold separately).
- FOMA AC Adapter 01 covers only 100V AC. FOMA AC Adapter 02/ FOMA AC Adapter 01 for Global use covers from 100 to 240V AC.
- The shape of the plug for the AC adapter is for 100V AC (for domestic use). To use the AC adapter of 100 to 240V AC overseas, a conversion plug adapter that is compatible with the voltage of your country of stay is required. Do not use a transformer for use overseas to charge the battery.

Charging by using AC adapter/DC adapter

[Read "FOMA AC Adapter 01/02 (sold separately) and FOMA DC Adapter 01/02 (sold separately) user's guide" carefully.]

- Battery pack can be charged even with the FOMA terminal opened or in the Cycloid position.

- 1 **Open the external connector terminal cover and insert the AC or DC adapter connector horizontally into the external connector terminal (1).**

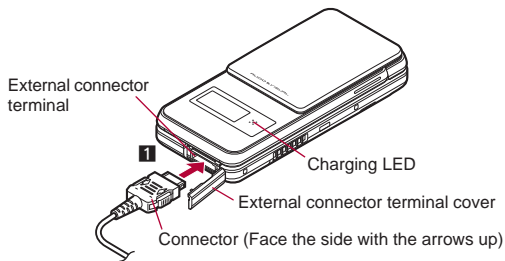

- Check the direction (See diagram) of the connector, keep it parallel with the FOMA terminal and securely push all the way in until it clicks.

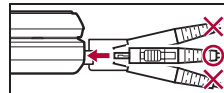

- 2 **When inserting the AC adapter power plug into an outlet or inserting the DC adapter power plug into a car cigarette lighter socket, Charge start sound is heard, charging LED illuminates, and charging starts.**

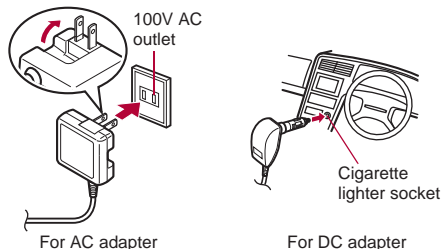

- 3 **When Charge end sound is heard and charging LED turns off, charging is complete.**

- When removing the connector, always hold the release buttons on both sides (1) and unplug it horizontally (2).

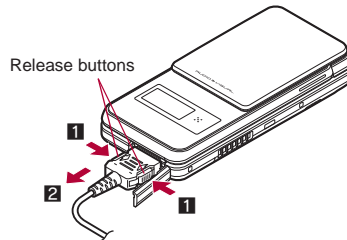

- Do not forcibly insert or remove. May cause damage to the external connector terminal and the connector.
- Pull the adapter out of the outlet or cigarette lighter socket if it will not be used for a long time.
- Do not forcefully pull the external connector terminal cover. May damage the cover.
- Do not place objects near the FOMA terminal when charging. May damage the FOMA terminal.

When using a DC adapter

- The DC adapter should only be used in negative grounded vehicles (12 and 24V DC).
- Do not use with the car engine shut off. May drain the car battery.
- The DC adapter fuse (2A) is a consumable. For replacement, purchase a new fuse at a local automobile supply shop.
- Refer to the FOMA DC Adapter 01/02 user's guide for details.

Charging by using desktop holder

- Battery pack can be charged even with the FOMA terminal opened or in the Cycloid position.

1 Face the side with the arrows of the AC adapter connector up and insert it into the connector terminal of the desktop holder (1).

- Keeping the connector parallel with the desktop holder, securely push it all the way in until it clicks.

2 Insert the AC adapter power plug into an outlet (2).

3 When placing the FOMA terminal in the desktop holder, Charge start sound is heard, charging LED illuminates, and charging starts.

- Place the FOMA terminal as the figure shows (3), and push it in the direction of the arrow (4) until it clicks.

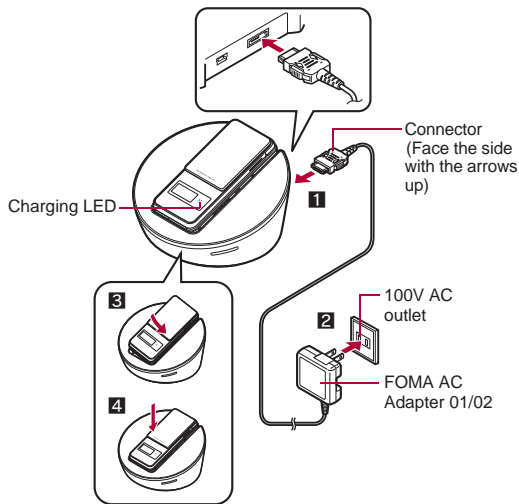

4 When Charge end sound is heard and charging LED turns off, charging is complete.

- Hold the desktop holder and lift the FOMA terminal out.

- Pull the AC adapter out of the outlet when left unused for a long period of time.
- When Charge start sound is not heard or when charging LED does not illuminate, check that the FOMA terminal is placed securely in the desktop holder (except when terminal is turned off, Manner mode is set or Charge start sound is Silent).
- When placing the FOMA terminal in the desktop holder, be careful that the strap is not caught in between the handset and the desktop holder.

- When the FOMA terminal placed in the desktop holder is set to the Cycloid position, operate while holding it so as not to come off from the desktop holder.

Battery level

Checking battery level

- If the battery icon is changed to [電池殘量\$\$], battery level is displayed in percentage. However, [Full] appears when battery level is 100% while [Low] appears when battery level is 4% or less.
- The battery icon and Percentage are rough indications.
- If the FOMA terminal is left for a long time or the power remains on, the battery level may reduce even after charging is complete.

	81 to 100%	Battery is sufficiently remaining.
	61 to 80%	Battery is remaining.
	41 to 60%	Battery level is low.
	21 to 40%	Battery level is very low.
	1 to 20%	Battery is almost empty. Charge the battery.
	0%	Battery is empty (Power will turn off soon).

Changing design of battery icon <Battery icon>

- In the Custom menu, select [Settings] ▶ [Battery] ▶ [Battery icon] ▶
- Select an image ▶

Checking battery level with sound and display

- In the Custom menu, select [Settings] ▶ [Battery] ▶ [Battery level].

- Battery level is displayed in percentage and graphic. In addition, it is notified by the number of the battery level sound according to its remaining amount.

Graphic	Number of beep sound
	Five times
	Four times
	Three times
	Twice
	Once

- Wait approximately 5 seconds and the display disappears.
- The battery level sound is heard at the volume set in Key sound (P. 90).
- If the Manner mode is set, the battery level sound follows the setting of the Manner mode.

If battery runs out

[Battery empty. Unsaved data will be lost. Ending current operation] appears if battery starts to run out (Press to clear the message). After a while, an alert tone sounds.

The warning screen stating that the battery runs out appears, handset operations are disabled and power turns off after approximately 60 seconds.

- During a voice/Videophone call, the alert tone sounds and [Battery empty. Unsaved data will be lost. Ending current operation] appears. The call is disconnected after approximately 20 seconds. At the same time, the screen above appears and after approximately 60 seconds, the power turns off.
- Alert tone does not sound when Manner mode or Public mode (Drive mode) is set (Alert tone sounds during a call).



Power ON/OFF









Turning power ON/OFF

Turning power ON

1 Press  (for 2+ seconds).

- It may take some time for the wakeup screen to appear.
- The wakeup screen appears followed by the initial settings screen. Proceed to Initial setting (☞ P. 48).
- If initial settings have been completed, the screen shown on the right appears when power is turned on. This screen is called the “stand-by display”.

Welcome mail

- “Welcome  ドコモ動画 ” (Welcome  docomo-doga ) and “緊急速報「エリアメール」のご案内” (Information of Early Warning “Area Mail”) are saved by default.
- To check a welcome mail: In stand-by, press   select the stock icon [] (mail message)  .
- For details on the following operations ☞ P. 138



Stand-by display

- If initial settings are not yet completed, the setting screen appears every time the power is turned on.
- If the FOMA card is not inserted, [Insert UIM] and a FOMA card error appear (☞ P. 31).
- When [Enter PIN1 code] appears, enter the PIN1 code (☞ P. 109).
- When a FOMA card is replaced with a new card, the terminal security code (four to eight digits) must be entered after turning on the terminal. If a correct terminal security code is entered, stand-by display appears. When a wrong terminal security code is entered five times, the power is turned off. However, turning on the power again is possible.
- When [] appears, the handset is outside the service area or in a place with no signal. Move to a place where the icon disappears.

Turning power OFF

1 Press  (for 2+ seconds).

- It may take some time for the power to be turned off (The end screen appears on the display until the power is turned off).

Select language

Changing screen display to English

1 In the Custom menu, select [設定] ▶ [一般設定] ▶ [Bilingual] ▶ [English].

- To switch the display language from English to Japanese: In the Custom menu, select [Settings] ▶ [General settings] ▶ [Select language] ▶ [日本語].
- If a FOMA card is inserted, settings are saved to the FOMA card as well. When the setting of the FOMA terminal handset and the setting of the inserted FOMA card are different, the setting in the FOMA card is prioritized.

Initial setting

Making initial setting

The initial settings screen appears automatically when the power is turned on for the first time. Each setting item can also be set from Menu (When the initial settings are complete, the stand-by display appears).

- Date and time settings
- Key sound
- Set all font size
- Change terminal security code
- Location request menu
- When items that have not been set remain, the setting screen appears every time the power is turned on.
- Alternatively, select [Settings] ▶ [Initial setting] in the Custom menu to display the setting screen.

1 Set the date and time (☞ P. 49).

2 Register a terminal security code (☞ P. 109).

3 Set the Key sound (P. 90).**4 Set GPS Location provision ON/OFF (P. 304).****5 Set the font size collectively (P. 105).**

- When the initial settings are complete, the software update function confirmation screen appears. Read the description and select [Agree] (When the initial settings are made from the menu or the software update is set to other than [auto-update], the confirmation screen does not appear).

- Press to cancel the initial settings.

Date settings**Setting date and time**

Set the date and time on the FOMA terminal.

1 In the Custom menu, select [Settings] ▶ [General settings] ▶ [Date settings].

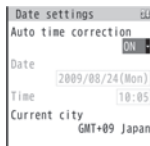

2 Select the [Auto time correction] field ▶ select the setting.

- Select [ON] ▶ .
- Select [OFF] ▶ select the [Date] field ▶ enter the date ▶ select the [Time] field ▶ enter the time (24-hour format) ▶ .
- When entering month, day and time, add 0 before numbers one through nine (example: 01, 02, 03, etc.).
- Set the date and time from 00:00 January 1, 2001 to 23:59 December 31, 2050.

- When Limit settings is set to [Enable], the terminal security code must be entered in the Date settings.

- The date and time that are set are saved even if the battery pack is removed, but if the battery pack remains removed for approximately 30 seconds or more, the settings are reset. Also, if the battery remains empty, the settings may be reset. When this happens, set again after charging the battery.
- If the date and time are not set correctly, the following functions cannot be used properly.
 - Redial, Received calls
 - Alarm
 - SSL/TLS (authentication)
 - Starting i-appliIDX
 - Machi-chara
 - Pattern definitions update
 - Record message (voice), Record message (Videophone calls)
 - Camera image titles/shooting date
 - Playback of i-motion or music data with expiration date/period for replay
 - View of e-books/e-dictionaries/e-comics with expiration date/period for browse
 - Auto power ON/OFF
 - Schedule
 - i-appli Auto start
 - Reception, Recording
 - Software update

When [Auto time correction] is set to [ON]

- When the power is turned on, the FOMA terminal adjusts the time by connecting to the network's time information.
- If the FOMA terminal does not adjust the time even when the power is turned on, turn off the power and restart.
- Time may not be adjusted depending on the signal status.
- Time may be off by a few seconds.
- When time difference is adjusted overseas, the local time and date and appear in Redial, Received calls, Received/Sent messages history (SMS only), received/sent mails list and location history list. The received/sent mails are not displayed in order of the displayed time and date but the mail reception/send.
- does not appear in the Unsent messages for mail messages. If the date order display is set for the Unsent messages, unsent mails are displayed in the order of the displayed time and date.
- Time correction may not be performed depending on the overseas telecommunications carriers. Change the time zone manually.

- During overseas use, Japan time and local time (or time set in City) appear in the dual display except for the following cases.
 - When Auto time correction is set to [ON] and time correction information is not being received from an overseas network
 - When Auto time correction is set to [OFF] and City is set to the city in the same time zone as Japan

■ Changing time zone manually <City>

- 1 In the Date settings screen, select the [Auto time correction] field ▶ ▶ [OFF] ▶ .
- 2 Select a time zone ▶ .
- 3 Select a city ▶ ▶ .

Notify caller ID

Notifying the other party of your phone number

Display your number (caller ID) on the other party's phone (display) when making a voice/Videophone call.

- Handset number (caller ID) is important personal information. Be very careful about your caller ID setting.
- The Notify caller ID function is available only on compatible phone devices.

Setting Notify caller ID/No caller ID in advance

- 1 In the Custom menu, select [Settings] ▶ [NW Services] ▶ [Notify caller ID].
- 2 Select [Activate/Deactivate].
 - To check the setting: Select [Check setting].
- 3 Select the setting.
 - To notify caller ID: Select [Yes].
 - To not notify caller ID: Select [No].

- Notify caller ID setting cannot be set from outside the service area.

Own number

Checking your own phone number

- When checking your own phone number during a call P. 54

1 In the Custom menu, press .

- Alternatively, select [Phone] ▶ [Own number] (or [Settings] ▶ [General settings] ▶ [Check status] ▶ [Own number]).
- To switch between Number A and Number B (when 2in1 [Dual mode] is used): Press .

- When changing the Number B of 2in1, use any of the following methods to obtain the correct Number B.
 - Set 2in1 function OFF and then perform 2in1 setting again to set 2in1 function ON
 - Check the 2in1 subscription
- When a FOMA card exchange (2in1 subscriber → 2in1 nonsubscriber) is performed, set 2in1 function OFF.
- When a FOMA card exchange (2in1 subscriber → 2in1 subscriber) is performed, check the 2in1 subscription.
- For details on Owner information P. 384

Map/GPS Function

Using Map/GPS function	300
Checking your location <Position location>	301
Setting position location <Set position loc.>	302
Viewing Map <Map>	302
Using GPS compatible i-appli.	302
Providing location information on request. <Loc. request menu>	304
Notifying present location information. <Location notification>	307
Displaying history of checked location information <Location history>	308
Using location information from each function	309

Using Map/GPS function

- Note that DOCOMO shall not be liable for the pure economic loss if you cannot confirm the positioning (communication) result with FOMA terminal failure, malfunction, error or external factors such as power failure (including battery exhaustion).
- FOMA terminals cannot be used as navigation system for professional use of aircrafts, vehicles, person, etc. Therefore, note that DOCOMO shall not be liable for the loss caused by the navigation system to use location information.
- FOMA terminals cannot be used as surveying GPS of high accuracy. Therefore, note that DOCOMO shall not be liable for the loss caused by the error of location information.
- GPS is the service in charge of Department of Defense of USA, therefore, GPS radio wave condition may be controlled (accuracy degradation, radio wave abort, etc.) for the US national security reason.
- For the use of Location provision or Location notification, check the information of an information provider and DOCOMO website. Charges may be incurred for these functions.
- Position location and Location notification are not available when Function lock is applied to GPS.
- Location provision, Position location and Location notification are not available in the following cases.
 - When a FOMA card is not inserted
 - During the Self mode
 - During software update
- Note that GPS is using the radio wave from satellites, and following conditions may cause the radio wave abort or difficulty to receive.
 - In or under buildings
 - In basement, tunnel, ground or water
 - In bags or boxes
 - In density area with buildings or residence
 - In or under densely trees
 - Near high-tension line
 - Inside cars or trains
 - In bad weather with heavy rain/snow
 - When people or objects are blocking mobile phones
 - When hands are covering screen/keypad/microphone/speaker of mobile phones

In these cases, the error of retrieved location information may be 300 m or more.

- GPS function of the FOMA terminal is not available outside the service area.

Using map and GPS function overseas

- Note the following when using a map and GPS function overseas.
 - Location notification and Location provision function are not available.
 - When attempting to connect to the GPS service setting site from [Service settings] in [Loc. request menu], an error message appears and the functions cannot be used. However, packet transmission charges are incurred in such cases.
 - The displayed map based on the acquired location information (latitude and longitude information) may not be accurate because of the legal system in each country and the area.
- Note the following when using each function.

■ Viewing map

- The selection screen for viewing a map either on the i-mode site or i-αplli appears when selecting Map in the Map/GPS menu or selecting [Read Map] after checking the present location, etc. Select the view mode.
- Even if a map is displayed on the i-mode site or i-αplli, the map may not be provided or the present location may not appear properly. In those cases, packet transmission charges apply.

■ Position location

- Set the correct date and time in advance.
- GPS positioning is available in the 3G network and GPRS network service areas.
- When GPS positioning is failed due to signal status, etc., the message asking whether to select a city name may appear. If [Select city name] is selected, the list of world cities appears. GPS positioning may succeed if the city around the present location is selected.
- Positioning is activated with [Quality mode] regardless of the Positioning mode settings.

■ Using GPS compatible i-appli

- Even if GPS compatible i-appli is set for Select Map, a map may not appear properly when location information that GPS compatible i-appli does not support is provided. In this case, packet transmission charges apply.

■ Location history

- [📍], the icon indicating that location is positioned overseas, appears for positioned location history in the location history list screen/location history screen. [🕒] appears in the location history list screen when the time difference is adjusted.
- If [Read Map] is selected from the location history positioned overseas, the selection screen for viewing a map either on the i-mode site or i-appli appears. Select the view mode.

Position location

Checking your location

Check the present location and check your place. Use this function for more convenient use such as showing a map from positioning location information, changing the location information to a URL, sending mail with the URL pasted, etc.

- Transmission charges are not incurred when the present location is positioned. However, packet transmission charges are applied when a map is displayed based on the location information.
- Change sound/volume/LED color for Position location (☎ P. 89, P. 103).

1 In the Custom menu, select [LifeKit] ▶ [Map/GPS] ▶ [Position location].

- In stand-by: Press **MAP** (for 1+ seconds).
 - It is activated following the GPS button setting after positioning.
- [📍] flashes while GPS positioning is being performed.

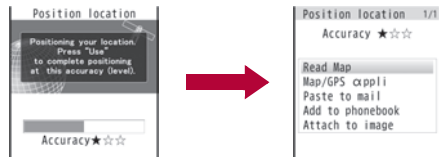

Accuracy level ★★★ : Almost accurate location information
Error is less than 50 m

Accuracy level ★★☆☆ : Relatively accurate location information
Error is less than 300 m

Accuracy level ★☆☆ : Rough location information
Error is 300 m or more

- Accuracy level is a rough indication. It may differ depending on the radio wave condition of the surroundings.
- To use the location information as a result of location positioning at the displayed accuracy level while the present location is being positioned: Press [📍].
- To cancel position location: Press [📍] ▶ [🔍].

2 Select a usage.

- ◆ Select [Read Map].
 - GPS compatible i-appli set in Map setting is activated.
- ◆ Select [Map/GPS appli] ▶ select i-appli ▶ [🔍].
- ◆ Select [Paste to mail] ▶ [OK] ▶ compose and send a mail.
 - The Location URL to be sent appears only on the i-mode supported terminal.
- ◆ Select [Add to phonebook] ▶ add to the phonebook.
- ◆ Select [Attach to image] ▶ select an image ▶ [📍] ▶ select the saving method ▶ [🔍].
- To check the location information: Press [📍].
- To retry position location: Press [📍].

Set position loc.

Setting position location

Setting GPS button <GPS button setting>

Set the operation that is automatically launched after positioning the present location by pressing  for 1+ seconds.

- 1 In the Custom menu, select [LifeKit] ▶ [Map/GPS] ▶ [Set position loc.] ▶ [GPS button setting].
- 2 Select the action ▶  ▶ [OK].

Setting Positioning mode for positioning location <Positioning mode>

- This setting is valid only when the positioning is performed in Japan.

- 1 In the Custom menu, select [LifeKit] ▶ [Map/GPS] ▶ [Set position loc.] ▶ [Positioning mode].
- 2 Select the Positioning mode ▶  ▶ [OK].
 - When [Quality mode] is selected, the positioning is performed with longer time. As a result, more accurate positioning is performed than in the Standard mode.

Map

Viewing Map

Activate GPS compatible i-αppli and view the present location or specified location.



- Make the Map setting in advance, and set GPS compatible i-αppli to activate.
 - By default, the FOMA terminal is set to activate "Map Application". For details on operating "Map Application"  P. 303
- 1 In the Custom menu, select [LifeKit] ▶ [Map/GPS] ▶ [Map].

- GPS compatible i-αppli is activated after positioning the present location.

Setting map <Map setting>



■ Setting i-αppli to activate as a map <Select Map>

Set GPS compatible i-αppli to activate when selecting Map in the Map/GPS menu or [Read Map] from the location information of each function.

- 1 In the Custom menu, select [LifeKit] ▶ [Map/GPS] ▶ [Map setting] ▶ [Select Map].
- 2 Select the GPS compatible i-αppli ▶  .



■ Setting whether to position present location when activating a map <Map activate setting>

Set whether to position the present location when Map in the Map/GPS menu is selected and GPS compatible i-αppli is activated.

- 1 In the Custom menu, select [LifeKit] ▶ [Map/GPS] ▶ [Map] ▶ [Map activate setting].
- 2 Select the setting ▶  .

Using GPS compatible i-αppli

Start i-αppli compatible with Map/GPS function.

- When GPS compatible i-αppli is used, location information is sent to the information provider of the software used.
 - When GPS function is used on GPS compatible i-αppli, set Location usage setting of the software used to [Send].
- 1 In the Custom menu, select [LifeKit] ▶ [Map/GPS] ▶ [Map/GPS αppli].
 - 2 Select software ▶  .

Starting GPS compatible i-appli by one-touch operation

1 In stand-by, press .

- GPS compatible i-appli is started according to Select Map. By default, the FOMA terminal is set to activate "Map Application".

Using “地図アプリ” (Map Application)

“Map Application” is a convenient i-appli for viewing the map of the present location or specified location, searching the peripheral area information or navigating to a destination. Search helpful facilities in case of disaster. With Chizu Talk function, exchange a message with the other party on the map.



©2009 ZENRIN DataCom CO., LTD.

Service charge

The appli services are divided into the following.

● Free functions

- View the map and search the peripheral area information. Also, search the food coupon.
- Display the location, which was positioned using GPS in the past, in the unit of municipality or prefecture with color on a map. This is the function that allows you to recognize the visited town at a glance.

- Change the mode to various maps such as a 3D map, a map with emphasized railways, a map in the day and night mode, including a normal map.

● Paid functions

Use all services excluding the traffic information for free until the 60th day from the first-time use of this software.

After the free period, the My menu registration (fees apply) for “ゼンリン 地図+ナビ” provided by ZENRIN DataCom CO., LTD. is required.



- Totally navigate to the destination including the means of driving, using train and walking. Search a route considering the traffic information.
- Display train transfer information and timetable.
- Exchange a message while displaying the other party's position on a map.
- Search helpful facilities in case of disaster. Use the i-appli without communication called Map Application for disaster. If a map for disaster of the area around the home is downloaded, it will be useful in case of an emergency.

- Packet transmission charges apply when using this service. It is recommended to use this software with Pake-hodai/Pake-hodai full/Pake-hodai double.
- When this software is deleted, download it from “iエリア-周辺情報-”.
- Note that there is no guarantee for the accuracy and immediacy of the information such as a map and route.
- Make sure that a person other than the driver operates this software while driving.
- This appli supports the Motion tracking.
- Screenshots are examples and may differ from actual screens.

Providing location information on request







Set whether to provide the present location on the request from the other party.

- Location provision may require the subscription to an information provider supporting the service and the service usage fee.
- To use a service supporting location provision, set Location provision ON/OFF to [Loc. provision:ON] or [Reject No. unset]. In addition, usage settings for each service (GPS Service settings) may be required. To use "imadoco-search", settings accessed by [iMenu] ▶ [お客様サポート] ▶ [各種設定(確認・変更・利用)] ▶ [その他サービス設定・確認] ▶ [位置情報利用設定] ▶ [イマドコサーチ設定] is required.
- Sent location information may not reach an information provider depending on the signal strength.
- Location information may be sent to an information provider without any operation when Location provision ON/OFF is set to [Loc. provision:ON] or [Reject No. unset]. Under [Loc. provision:OFF], even if the location information from the other party is received, it is automatically rejected, and the history of location provision does not remain.
- [ON] (blue) appears when Location provision ON/OFF is set to [Loc. provision:ON] or [Reject No. unset]. Until a location provision permission schedule ends if it is set, [ON] (blue) is displayed while permitted and [OFF] (gray) while rejected.
- If Location provision ON/OFF is set to [Reject No. unset], calls are automatically rejected when the location information from callers not saved in the phonebook are received. However, a request for Location provision may be received depending on the operating condition of other functions.
- Change sound/volume/LED color for Location provision (☞ P. 89, P. 103).
- Location information is provided free of charge.
- For the use of location information, check the information of an information provider and DOCOMO website. Charges may apply for these functions.

- 1 In the Custom menu, select [LifeKit] ▶ [Map/GPS] ▶ [Loc. request menu] ▶ [Loc. prov. ON/OFF].
- 2 Enter the terminal security code ▶ .
- 3 Select the setting ▶ .

● Location provision can also be set from initial settings (☞ P. 48).

Setting permission schedule onto Location provision

- 1 In the Location provision ON/OFF setting screen, select [Permission sched.].
- 2 Select [Start] ▶ enter the start time (24-hour format) ▶ .
- 3 Select [End] ▶ enter the end time (24-hour format) ▶ .
- 4 Select [Repeat] ▶ select the repeat method.
 - ◆ Select [Daily].
 - ◆ Select [Set day of week] ▶ select a day of the week ▶ .
 - ◆ Select [Not set] ▶ proceed to step 6.
- 5 Select [From] ▶ [Start date setting] ▶ enter the start date ▶  ▶ [End date setting] ▶ enter the end date ▶ .
 - To not set valid period: Select [End date] ▶ [Not set].
- 6 Press  ▶ select the setting of Reject No. unset ▶ .

● If an end time is set to the time before the scheduled time, location information is not provided for the day.

Setting Positioning mode of Location provision <Positioning mode>

- 1 In the Custom menu, select [LifeKit] ▶ [Map/GPS] ▶ [Loc. request menu] ▶ [Positioning mode].
- 2 Select the Positioning mode ▶  ▶ [OK].

Operation when permission schedule is set onto location provision

Example: When the current date is "August 24, 2009, 14:00"

Start: 15:00 End: 22:00

Setting details		Schedule when location provision is performed
Repeat	Valid period	
Not set	–	08/24/2009, 15:00 to 08/24/2009, 22:00
Everyday	From 08/29/2009 End date 09/29/2009	Everyday from 08/29/2009, 15:00 to 09/29/2009, 22:00 (between 15:00 and 22:00)
	From 08/19/2009 End date 09/29/2009	Everyday from 08/24/2009, 15:00 to 09/29/2009, 22:00 (between 15:00 and 22:00)
	Not set	Everyday after 08/24/2009, 15:00 (between 15:00 and 22:00)
Set day of week	From 08/29/2009 End date 09/29/2009	Set day of week from 08/29/2009, 15:00 to 09/29/2009, 22:00 (between 15:00 and 22:00)
	From 08/19/2009 End date 09/29/2009	Set day of week from 08/24/2009, 15:00 to 09/29/2009, 22:00 (between 15:00 and 22:00)
	Not set	Set day of week after 08/24/2009, 15:00 (between 15:00 and 22:00)

Start: 09:00 End: 22:00

Setting details		Schedule when location provision is performed
Repeat	Valid period	
Not set	–	08/24/2009, 14:00 to 08/24/2009, 22:00
Everyday	From 08/29/2009 End date 09/29/2009	Everyday from 08/29/2009, 09:00 to 09/29/2009, 22:00 (between 09:00 and 22:00)
	From 08/19/2009 End date 09/29/2009	Everyday from 08/24/2009, 14:00 to 09/29/2009, 22:00 (between 09:00 and 22:00)
	Not set	Everyday after 08/24/2009, 14:00 (between 09:00 and 22:00)

Setting details		Schedule when location provision is performed
Repeat	Valid period	
Set day of week	From 08/29/2009 End date 09/29/2009	Set day of week from 08/29/2009, 09:00 to 09/29/2009, 22:00 (between 09:00 and 22:00)
	From 08/19/2009 End date 09/29/2009	Set day of week from 08/24/2009, 14:00 to 09/29/2009, 22:00 (between 09:00 and 22:00)
	Not set	Set day of week after 08/24/2009, 14:00 (between 09:00 and 22:00)

Start: 15:00 End: 10:00





Setting details		Schedule when location provision is performed
Repeat	Valid period	
Not set	–	08/24/2009, 15:00 to 08/25/2009, 10:00
Everyday	From 08/29/2009 End date 09/29/2009	Everyday from 08/29/2009, 15:00 to 09/30/2009, 10:00 (between 15:00 and 10:00 on the next day)
	From 08/19/2009 End date 09/29/2009	Everyday from 08/24/2009, 15:00 to 09/30/2009, 10:00 (between 15:00 and 10:00 on the next day)
	Not set	Everyday after 08/24/2009, 15:00 (between 15:00 and 10:00 on the next day)
Set day of week	From 08/29/2009 End date 09/29/2009	Set day of week from 08/29/2009, 15:00 to 09/30/2009, 10:00 (between 15:00 and 10:00 on the next day)
	From 08/19/2009 End date 09/29/2009	Set day of week from 08/24/2009, 15:00 to 09/30/2009, 10:00 (between 15:00 and 10:00 on the next day)
	Not set	Set day of week after 08/24/2009, 15:00 (between 15:00 and 10:00 on the next day)

Setting details		Schedule when location provision is performed
Repeat	Valid period	
Not set	—	08/24/2009, 14:00 to 08/25/2009, 09:00
Everyday	From 08/29/2009 End date 09/29/2009	Everyday from 08/29/2009, 09:00 to 09/30/2009, 09:00 (between 09:00 and 09:00 on the next day)
	From 08/19/2009 End date 09/29/2009	Everyday from 08/24/2009, 14:00 to 09/30/2009, 09:00 (between 09:00 and 09:00 on the next day)
	Not set	Everyday after 08/24/2009, 14:00 (between 09:00 and 09:00 on the next day)
Set day of week	From 08/29/2009 End date 09/29/2009	Set day of week from 08/29/2009, 09:00 to 09/30/2009, 09:00 (between 09:00 and 09:00 on the next day)
	From 08/19/2009 End date 09/29/2009	Set day of week from 08/24/2009, 14:00 to 09/30/2009, 09:00 (between 09:00 and 09:00 on the next day)
	Not set	Set day of week after 08/24/2009, 14:00 (between 09:00 and 09:00 on the next day)

Setting host <Host setting>

Set the host for the GPS service setting site.

※ Setting does not normally need to be changed.

- 1 In the Custom menu, select [LifeKit] ▶ [Map/GPS] ▶ [Loc. request menu] ▶ [Host setting].**
- 2 Enter the terminal security code ▶ .**
- 3 Select [User specified host] ▶ .**
 - To return to the default host: Select [Default].
 - To change to the preset user-defined host: Select [User specified host].
 - To delete the set user-defined host: Select [User specified host] ▶  ▶  ▶ [Yes].

4 Select [Host name] ▶ enter the host name ▶ .

- Enter up to 99 single-byte alphanumeric characters and symbols.

5 Select [Host URL] ▶ enter the host URL ▶ .

- Enter up to 100 single-byte alphanumeric characters and symbols.

6 Press .

GPS service settings <Service settings>

Configure the setting required for Location provision.

1 In the Custom menu, select [LifeKit] ▶ [Map/GPS] ▶ [Loc. request menu] ▶ [Service settings].



- Connected to the GPS service setting site.

2 Configure the settings.

- Please contact GPS information providers for the setting details.

When location information is requested

Location provision starts when the request to provide the location information is received.

- When each service usage setting is set to [許可], the location information is automatically provided upon request.
- When each service usage setting is set to [毎回確認], a confirmation screen asking whether to provide appears at every request. Select [Yes] to start providing the location information.
- If no operation is performed when the location is requested, return to stand-by display after providing location information is end, and the stock icon [] (Send loc - Resp/Send loc - No resp/Send loc - Failed) appears. Select the stock icon and location histories appear.
- To cancel Location provision, press  and press . However, the location information may be sent depending on timing.
- Sent location information may not reach a requestor of the location information depending on the signal strength.
- Host ID for Location provision may not be displayed on the screen.

- When the 2in1 service is used, only Number A is available regardless of the mode. If the location information provision is requested with Number B, the location information is not provided, and the failure of search is notified to the other party.

When the location information is requested from the other party who used imadocokantan search

- A confirmation screen for location provision appears at every request. Select [Yes] to immediately notify to a rough positioning result to the other party.
After [Yes] is selected, the GPS positioning screen appears, and a high-accuracy positioning result is notified.
- If the location provision is canceled after [Yes] is selected on a confirmation screen for location provision, a rough positioning result is notified to the other party. In this case, the location history is recorded, but the location information does not appear.

When the location information is requested while in Public mode (Drive mode)

- If Location provision is set to [許可] for usage settings of each service, a confirmation screen for location provision is displayed, the GPS positioning screen appears, and the location is provided after GPS positioning. However, Location provision/accept, Location provision/notify, vibrator or called LED does not operate.
- When Location provision is set to [毎回確認] for usage settings of each service, location information is not provided.

Location notification

Notifying present location information

Notify the positioned Location information of the present location to specified service clients (information provider supporting Location notification).

- For Location notification function, subscription to an information provider supporting Location notification and a service usage fee may be required.
- Sent location information may not reach an information provider depending on the signal strength.
- Using Location notification is charged.

1 In the Custom menu, select [LifeKit] ▶ [Map/GPS] ▶ [Loc.notification/set] ▶ [Location notification].

2 Select the service client.

- ◆ Select [Select from list] ▶ select a service client ▶ ⊙.
- ◆ Select [Direct input] ▶ enter the service client ID ▶ ⊙.
 - To cancel positioning location: Press [F] ▶ ⊙.
 - Positioning may not be canceled or the location information may be sent depending on timing.

- Change sound/volume/LED color for Location notification (P. 89, P. 103).

- When the 2in1 service is used, the location information is notified with Number A regardless of the mode.

■ Setting Positioning mode of Location notification <Positioning mode>

1 In the Custom menu, select [LifeKit] ▶ [Map/GPS] ▶ [Loc.notification/set] ▶ [Positioning mode].

2 Select the Positioning mode ▶ ⊙ ▶ [OK].

■ Saving service clients <Notification clients>

Save up to five service clients to notify the present location.

1 In the Custom menu, select [LifeKit] ▶ [Map/GPS] ▶ [Loc.notification/set] ▶ [Notification clients].

2 Press [Save new].

- Alternatively, press [F].

3 Select [Name] ▶ enter a service client name ▶ ⊙.

- Enter up to 32 single-byte (16 double-byte) characters.

4 Select [ID] ▶ enter the service client ID ▶ ⊙.

- Enter ID specified by a GPS information provider.
- Enter up to 12 single-byte numeric characters. [×] and [#] are also available to enter.

- 5 Select [Phone number] ▶ enter a phone number.**
- ◆ Select [Search phonebook] ▶ select a recipient ▶ ◯.
 - ◆ Select [Direct input] ▶ enter a phone number ▶ ◯.
 - The phone number already saved as location service client cannot be added.
- 6 Select [Auto] ▶ select the setting ▶ ◯.**
- If automatic notice is set to [Yes], automatically notifies the present location to the recipient when a voice/Videophone call is made to a saved phone number.
- 7 Press [i].**

■ Submenu operations for notification clients screen

[Save new]	📧 P. 307
[Copy to microSD]	📧 P. 343
[Send data]	
▶ [Send Ir data]	📧 P. 357
▶ [iC transmission]	📧 P. 359
▶ [Send via Bluetooth]	📧 P. 399
[Add to phonebook] ▶ add to the phonebook	
[Delete]	
▶ [Delete one] ▶ [Yes]	
▶ [Delete selected] ▶ select a service client ▶ ◯ ▶ [i] ▶ [Yes]	
▶ [Delete all] ▶ enter the terminal security code ▶ ◯ ▶ [Yes]	

■ Editing saved contents of location service clients

- 1 In the notification clients screen, select a location service client ▶ ◯.**
- 2 Select an item ▶ ◯.**
- 3 Edit ▶ [i].**

Location history

Displaying history of checked location information

Up to 50 entries of location information positioned by GPS function are saved in Location history. Use location information on the history to display a map or for other operations.

- When 50 entries are exceeded, entries are overwritten starting with the oldest.
- Even if latitude and longitude are indicated on the Location history screen, sent location information may not reach the service clients or provider.

- 1 In the Custom menu, select [LifeKit] ▶ [Map/GPS] ▶ [Location history].**

- Location history types and dates are listed starting with the most recent.

Location history 1/3	
Position	07/21 14:09
Position	07/21 14:04
Position	07/21 10:12

Location history list

Location history type

Position	Position location	Notify	Location notification
Provide	Location provision		

- [▶] appears when the location history contains location information.
- To show a map: Select a location history ▶ [i].

- 2 Select the location history ▶ ◯.**

Loc. info details 1/3	
2009/07/21 14:09:30	1
Position location	2
N XX° XX' XX.XXX"	
E XXX° XX' XX.XXX"	
Coord:wgs84	
Accuracy★☆☆	3

Location history details screen

- 1 Positioning date**





2 History type

[Position location]/[Location notification]/[Location provision] appears. For [Location notification]/[Location provision], the icon and the information of the service client or service client for provision appear.

For Location notification

	Service client name		Service client ID
---	---------------------	---	-------------------

For Location provision

	Service client name for Location provision
	Service client ID for Location provision
	Requestor name for Location provision
	Requestor ID for Location provision

※ When the requestor ID for Location provision is a phone number or mail address, Phone To (AV Phone To) (☞ P. 173) and Mail To (☞ P. 173) can be used.

3 Location information

Latitude : Degrees, Minutes, Seconds
 Longitude : Degrees, Minutes, Seconds
 Datum* : wgs84 (World Datum), tokyo (Tokyo Datum)
 Accuracy : Error range of accuracy (☞ P. 301)

* Datum is a standard for expressing the position on the earth as latitude and longitude.

- Accuracy is a rough indication. It may differ depending on the radio wave condition of the surroundings.
- The entry that has failed or interrupted to position for Position location is not saved as Location history.
- If the location information is provided when the 2in1 service is used, the requestor name for Location provision appears in each 2in1 mode according to the Phonebook 2in1 setting.
- The location information and accuracy recorded in Location history may differ from those sent to a location provider and a location service client due to the signal strength, etc.



2 Submenu operations for location history list screen

[Read Map]

[Map/GPS appli] ▶ select i-appli ▶ 

[Paste to mail] ▶ [OK] ▶ compose and send a mail

[Add to phonebook] ▶ add to the phonebook

[Attach to image] ▶ select an image ▶  ▶  ▶ select the saving method ▶ 

[Send location info] ☞ P. 398

[Delete]

▶ [Delete one] ▶ [Yes]

▶ [Delete selected] ▶ select a location history ▶  ▶  ▶ [Yes]

▶ [Delete all] ▶ enter the terminal security code ▶  ▶ [Yes]

2 Submenu operations for location history details screen

- Refer to submenu operations for location history list screen (☞ P. 309) for the following functions.

■ Read Map

■ Map/GPS appli

■ Paste to mail

■ Add to phonebook

■ Attach to image

■ Send location info

[Delete one] ▶ [Yes]

Using location information from each function



Use location information with each function by adding location information to data such as phonebook and still pictures or displaying a map based on the added location information.

Adding location information

Example: Phonebook

1 In the phonebook entry screen, select [].

2 Select a location information to add.



- ◆ Select [From position loc.] ▶  ▶ [Yes].
 - The present location is positioned by GPS function.
- ◆ Select [From loc. history] ▶ select a location history ▶  ▶ [Yes].
- ◆ Select [From image] ▶ select an image ▶ .
- ◆ Select [Loc. info details].
- ◆ Select [Del. location info].
 - For images saved in My picture of Data box or i-mode mail, location information added to the phonebook can be selected. The location information added to an image cannot be selected.
 - For My picture of Data box, when the operation is made from the image list screen, multiple images to which location information is added can be selected.

Using added location information





■ Using location information in the FOMA terminal handset phonebook or in images saved in My picture of Data box

Example: Phonebook

1 In the phonebook entry details screen, select [].

- To show a map based on the address saved in the phonebook: In the phonebook entry details screen, select [] ▶  ▶ [OK].

2 Select a usage.



- ◆ Select [Read Map].
- ◆ Select [Map/GPS appli] ▶ select i-appli ▶ .
- ◆ Select [Paste to mail] ▶ [OK] ▶ compose and send a mail.
- ◆ Select [Attach to image] ▶ select an image ▶  ▶  ▶ select the saving method ▶ .
- ◆ Select [Loc. info details].

■ Using location information of sites, data broadcasting, ToruCa or Message R/F

Example: Sites

1 While viewing sites, select location information ▶ .

2 Select a usage.

- ◆ Select [Read Map].
- ◆ Select [Map/GPS appli] ▶ [Yes] ▶ select i-appli ▶ .
- ◆ Select [Paste to mail] ▶ [Yes] ▶ compose and send a mail.
 - To check the location information: Select a usage ▶  ▶ .

Using Ir communication with i-αpli

Use the Ir communication function from running i-αpli.
Activating i-αpli from Ir communication is also possible.

- For details on activating Ir communication from i-αpli  P. 284

Activating i-αpli from Ir communication

During Ir communication, if a signal to activate i-αpli is received from devices supporting Ir communication, software can be activated.

1 In the Custom menu, select [LifeKit] ▶ [Receive Ir data] ▶ [Receive] ▶ [Yes].

- The FOMA terminal waits to receive data. Software is activated when signal to activate i-αpli is received from the sender's FOMA terminal.

- When i-αpli To is set to [No], i-αpli is not activated from Ir communication.
- Cannot be activated as i-αpli stand-by.

Infrared remote control

Using infrared remote control function

Use the FOMA terminal's Infrared port from i-αpli software to operate equipment supporting the infrared remote control such as TVs and VCRs.

- To use the infrared remote control function, download compatible i-αpli software.

Remote control operation

Start i-αpli software that supports Ir remote control functions, point the FOMA terminal's Ir port to the front of the remote control sensor on the TV, VCR or other device to operate, and perform remote control operations.

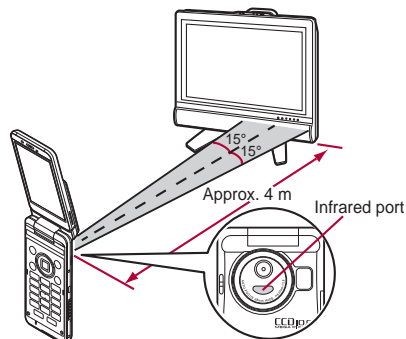

- Actual operational methods will differ with each i-αpli software application.
- Control devices from a distance of up to approximately 4 m (Distance will vary depending on the device, the ambient brightness and other factors).
- When in the Self mode, the Ir remote control function cannot be used.
- Depending on the device, operation may not run properly.
- Remote control operation may not run properly directly under fluorescent lights, near other equipment using infrared signals, or in areas of direct sunlight.

iC communication

Use iC communication to send and receive data to and from other FOMA terminals which also support iC communication function.

- During iC communication, the FOMA terminal status is the same as when outside the service area, such that making/receiving calls, i-mode, and data communications are not possible.
- iC communication is not available while a call is in progress or the IC card is locked.

- For an image, i-motion, Melody, PDF, or Decome-Anime Template in the Data box, Sending and receiving all data items is not available. For other than those above, data that can be sent and received or operations when various lock functions are set are same as for Ir communication (P. 354).
- For details on starting iC communication from i-appli (P. 284)

Precautions for using iC communication function

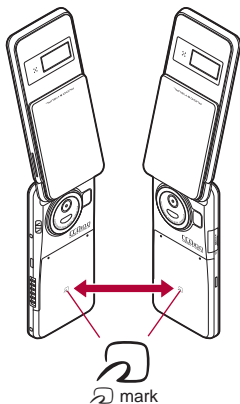

- Use while placing the iC mark of receiver's FOMA terminal on that of sender's FOMA terminal as shown.
- Do not move the FOMA terminal until all data are sent and received.
- Sending and receiving data may be difficult depending on the other party's FOMA terminal. In such case, make the clearance between the iC mark closer or farther, or move them up/down/left/right alternately.
- During iC communication, FOMA terminal called LED flashes (P. 103).

- Data communication via iC communication is not available while charging.

Sending and receiving data

- Terminal security code and authentication password entry are required for sending or receiving all data items. The authentication password is a password exclusively for iC communication. Before starting data transfer, the sender and receiver must enter the same user-specified four-digit password.

Sending data <Send/Send all>

Example: Phonebook

- 1 In stand-by, press .
- 2 Select a name **[Send data]** **[iC transmission]**.
- 3 Select the sending method.
 - ◆ Select **[Send]**.
 - ◆ Select **[Send all]** enter the terminal security code enter the authentication password .
- 4 Select **[Yes]**.
- 5 Place the mark on that of the other party's FOMA terminal.

Receiving data <Receive/Receive all>

- 1 In stand-by, place the mark on that of the other party's FOMA terminal.
- 2 Select **[Yes]**.
 - When receiving all data items: Select **[Yes]** enter the terminal security code enter the same authentication password entered on the sender's FOMA terminal **[Yes]**.
 - To cancel Receive: While receiving data, press .

■ Making a call after entering a phone number

1 In stand-by, enter a phone number ▶ press the switch for 2+ seconds.

- Call can also be made from phonebook and Redials/Received calls.

2 Press the switch for 2+ seconds to finish call.

- If multiple phone numbers are saved to memory numbers set in Headset switch to call, the first phone number saved is called.
- When a memory number set for Headset switch to call is set as Secret, set Secret mode to [ON] before using switch to call.
- Calls may be made accidentally if the FOMA terminal is carried in a bag with the Stereo Earphone Set connected. Disconnect when not in use.
- Calls may be made if an earphone/microphone without switch is rapidly inserted and removed.

Receiving calls with switch

Receive voice/Videophone calls.

1 Connect the Stereo Earphone Set.

2 When a call is received, press the switch for 2+ seconds.

- Set the location to which the ring tone is output (☞ P. 92).

3 Press the switch for 2+ seconds to finish call.

- Calls may be answered accidentally if the earphone/microphone with switch is connected while the ring tone sounds. Disconnect when not in use.

Auto answer setting

Receiving a call automatically when an earphone is connected

Automatically answer voice/Videophone calls received while the Stereo Earphone Set 01 (sold separately), etc. is connected.

- When the Stereo Earphone Set is not connected, Auto answer setting is not available even if set to [ON].

1 In the Custom menu, select [Settings] ▶ [Phone settings] ▶ [Incoming settings] ▶ [Auto answer setting].

2 Select [ON] ▶ enter a ring time ▶ .

- Calls are answered without ringing or vibrating when the ring time is set to "0 seconds".
- Calls from other parties set for Reject calls are not answered.
- Set different Auto answer setting and Record message ring times.
- If both Voice Mail Service and Auto answer setting are enabled, and the same number of seconds is set for both services, then Voice Mail Service may take priority. To prioritize Auto answer setting, set a shorter ring time than that set for the Voice Mail Service (This also applies to the Call Forwarding Service).

Bluetooth

Using Bluetooth function

Connect the FOMA terminal to Bluetooth devices wirelessly.

- Wireless communications with all the Bluetooth devices are not completely guaranteed.

Supported version and supported profiles

■ Supported version

Bluetooth specification Ver. 2.0+EDR*1

■ Supported profiles*2 (Supported services)

HSP (Headset Profile)

HFP (Hands Free Profile)

A2DP (Advanced Audio Distribution Profile)

AVRCP (Audio/Video Remote Control Profile)

HID (Human Interface Device Profile)

DUN (Dial-up Networking Profile)

OPP (Object Push Profile)

SPP (Serial Port Profile)

*1 The FOMA terminal and all Bluetooth function-installed devices have ensured that they conform to the Bluetooth specification according to the rules that the Bluetooth SIG defines, and are all authenticated. However, operating methods might differ, or data might not be exchanged even when they are connected wirelessly, depending on the features or specifications of connecting devices.

*2 Standardizes the communication procedures of Bluetooth device per feature of a device.

- If the FOMA terminal is already connected to Bluetooth devices, searching the Bluetooth device may not be available depending on the status of the FOMA terminal.

What can be performed using Bluetooth connection

■ Talking with Headset/Hands-free (HSP/HFP)

Connect commercially available Bluetooth compatible Headset to the FOMA terminal to talk wirelessly.

Connect a commercially available Bluetooth compatible hands-free device such as a car navigation system to the FOMA terminal to talk during hands-free operation using the car navigation system.

■ Playing on Audio device (A2DP/AVRCP)

Connect Wireless Earphone Set 02 (sold separately) or commercially available Bluetooth compatible audio device to the FOMA terminal to play music or sound of 1Seg wirelessly. Also, remote control operation may be available from Bluetooth devices. However, some devices do not support sounds of 1Seg, videos, or moving pictures in the [Link with recorder] folder in i-motion/Movie of Data box.

■ Using Bluetooth compatible keyboard or PC (HID)

Connect commercially available Bluetooth compatible keyboard to the FOMA terminal to enter text in the keyboard. Usual screen operations are available using Cursor key/Enter key/Esc key/Function key/Numeric key. In addition, operate commercially available Bluetooth compatible PC using presentation assist.

■ Making Dial-up connection wirelessly (DUN)

Connect a Bluetooth compatible PC to the FOMA terminal to make packet transmission or 64K data communication using the FOMA terminal as a modem.

- Refer to "Manual for PC Connection" in the accompanying CD-ROM for details.

■ Sending/Receiving data (File transfer) (OPP)

Send or receive phonebook entries, schedule, mails, text memos, bookmarks, location service clients, or ToruCa with the Bluetooth device.

■ Using Bluetooth communication from i-appli (SPP)

Connect with another mobile phone or Bluetooth device to play a match game and manage data.

■ Cooperating with Bluetooth compatible car navigation system (SPP)

Connect with a car navigation system complying with Photoremo@Navi standard to transmit location information to a car navigation system or send a mail transferred from a car navigation system with the FOMA terminal.

- The following sounds are output from the Bluetooth device or the FOMA terminal depending on the connected service.

	Connected services		
	HSP	HFP	A2DP
Voice call dial tone	○	○	×
Voice/Videophone call ring tone	○*1, 2	○*2	×
Calling tone at voice/Videophone call	○	○	×
The other party's voice at voice/Videophone call	○	○	×
Caller's voice from Record message at voice call	○	○	×
Sounds of 1Seg programs	×	×	○*3
i-motion playback tone	×	×	○*4, 5
Video playback tone	×	×	○*3
Movie playback tone	×	×	○*5
MUSIC Player playback tone	×	×	○*5
Music&Video Channel playback tone	×	×	○
Alarm tone	×	×	×
Mail ring tone	Notice first	×	×
	Operation first	×	×

○ : Output from the Bluetooth device.

× : Sounds from the FOMA terminal instead of outputting from the Bluetooth device.

- *1 The ring tone sounds from both the Bluetooth device and the FOMA terminal when Headset setting is set to [Headset + speaker].
- *2 The ring tone sounds from the FOMA terminal when Forward Ring Tone is set to [OFF].
- *3 Play only on an A2DP compatible Bluetooth device protected by copyright in the SCMS-T.
- *4 Play moving pictures in the [Link with recorder] folder in i-motion/Movie of Data box, only on an A2DP compatible Bluetooth device protected by copyright in the SCMS-T.
- *5 The tone does not sound for activating the player from sites or Ring tone.
- *6 The mail ring tone does not sound when a screen other than stand-by is shown.

- Some Bluetooth devices may not work as those specified above.
- The ring tone sounds from the Bluetooth device even while the Manner mode is set.
- Some commercially available Bluetooth compatible earphones or headphones may not conform to the Bluetooth specification. In this case, the audio noise may affect earphones or headphones.
- Refer to the manual for the Bluetooth device as well.

Precautions for handling the Bluetooth device

Note the following when using the Bluetooth device.

- Note the following to make good connection.
 - The distance between the FOMA terminal and another Bluetooth device keep within approximately 10 m with no obstructions in sight. The distance that can make connection may be shorter when there are obstructions between them or depending on the conditions of the surroundings (such as walls or furniture) and the structure of a building. Especially when there is a wall or floor of reinforced concrete between them, they may be unable to connect with each other. Note the above mentioned distance is not guaranteed.

- Move the FOMA terminal and another Bluetooth device as far away as possible from home electric appliances, AV devices, OA devices, etc. before connection. The Bluetooth device is liable to be adversely affected by a microwave oven so move as far away as possible from the microwave oven while using it. Otherwise, normal connection cannot be performed when electric devices are powered on or Bluetooth devices may cause noises or reception failure on a TV or radio set (TV images may degrade for specific channels of UHF or satellite broadcasting).
- Move the Bluetooth device to a place that connection is possible when there is a broadcast station or radio near a Bluetooth device, and the FOMA terminal cannot be connected to the device. Strong radio waves may prevent connection between Bluetooth devices.
- Wireless connection is available with Bluetooth device put in a bag or pocket. However, lowering of communication speed or noise may result when the Bluetooth device and the FOMA terminal are separated by your body.
- The Bluetooth device use the same frequency band (2.4 GHz) as wireless LANs (IEEE802.11 b/g). Therefore, using the Bluetooth device near a wireless LAN device may cause the radio interference, lowering of communication speed, noise, or connection fail. In this case, turn off the wireless LAN device or keep the FOMA terminal and the Bluetooth device at least approximately 10 m away from the wireless LAN.
- Electromagnetic signals from the Bluetooth device may affect the operation of electronic medical equipment. As some cases may result in accident, turn off the FOMA terminal and another Bluetooth device in the following place.
 - On trains ■ On airplanes ■ In hospitals
 - Nearby automatic doors or fire alarms
 - In places such as gas stations where flammable gas is generated

■ Using Bluetooth devices simultaneously

Connect Bluetooth simultaneously, for example, listening to the music on the Bluetooth device while composing mail with a Bluetooth compatible keyboard. For details on the combinations of functions that can be used simultaneously refer to P. 471

- For Hands-free and Headset services, the profile connected first takes priority. However, they can be simultaneously switched to connection stand-by.

Registering Bluetooth device

Search for the Bluetooth device to connect and register the device to the FOMA terminal. Register up to ten Bluetooth devices.

- To register a Bluetooth device, the Bluetooth passkey must be entered. Before starting the registration, enter the same user-specified 4- to 16-digit number on the FOMA terminal and the other party's Bluetooth device.
- Switch the other party's Bluetooth device to the registration stand-by status in advance.

1 In the Custom menu, select [LifeKit] ▶ [Bluetooth] ▶ [List/cnnect/discnct].

- When any Bluetooth devices have already been registered, the device list screen appears. Press  and proceed to step 3.



2 Select [Yes].

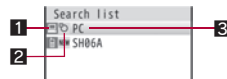



- Search the Bluetooth device around the FOMA terminal. Searched devices are displayed on the list.





Search list

1 Device category icon

	Computer		Peripheral
	Phone		Imaging device

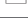
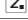

	LAN		Wearable terminal
	Audio device		Other

2 Classification icon

	Unregistered device that has been newly found
	Already registered device that has been found
	Already registered device that has been found and is set to default connection device
	Already registered and connected device that has been found
	Already registered and connected device that is set to default connection device

3 Device name

3 Select a Bluetooth device to register [Register Devices].

- Alternatively, select a Bluetooth device to register and press .
- To search again: Press .

4 Enter the Bluetooth passkey .

- If a device is the one supported by Audio service, the default connection device setting screen appears. When [Yes] is selected, the device is set to default connection device.

- Entering the Bluetooth passkey may not be required depending on the operations of the other party's Bluetooth device.
- When ten Bluetooth devices are already registered, the confirmation screen for overwriting appears. When [Yes] is selected, the Bluetooth devices are overwritten starting with the oldest communication date and time.
- When the already registered Bluetooth device is selected to register again, it cannot be registered again during the connection.
- For details on the operations of the other party's Bluetooth device, refer to the manuals of the Bluetooth device to be used.

- Searching is not available in the following cases.
 - While 1Seg or MUSIC Player is activated with connection made using Audio service
 - While receiving a call or during a voice/Videophone call with connection made using Headset service or Hands-free service

■ Submenu operations for search list screen

[Register Devices]

 P. 393

[Connection info]

- Enter up to 32 single-byte (16 double-byte) characters for a device name.

■ Searching only unregistered devices to register

1 In the Custom menu, select [LifeKit] [Bluetooth] [Register new device].

2 Register.

- For details on registering  step 3 of "Registering Bluetooth device" on P. 393

■ Connecting to Bluetooth devices

Connect to registered Bluetooth devices.

1 In the Custom menu, select [LifeKit] [Bluetooth] [List/cnnect/discnct].

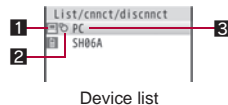

- To update the information: Press .



1 Device category icon (P. 393)







2 Classification icon

	Already registered and unconnected device that is set to default connection device
---	--

	Already registered device that is being connected
	Already registered and connected device that is set to default connection device

3 Device name

2 Select a Bluetooth device to connect to .

- Select a service and connect: Select a Bluetooth device to connect to  select a service   .
-  flashes at approximately 0.5-second intervals when the connection is completed.
- To disconnect the Bluetooth device: Select a Bluetooth device to disconnect   [Yes].
- If a Bluetooth device is turned off during the connection or disconnection processing or there is no response from the Bluetooth device, it takes up to approximately 20 seconds for the processing.
- If the FOMA terminal is disconnected from a Bluetooth device while being connected, the connected service is switched to connection stand-by. Also, if the FOMA terminal is turned off while being connected or in connection stand-by, the connection or connected service will be switched to connection stand-by when the power is turned on next time.
- When connection to the registered Bluetooth device is failed, delete the registration once and register the device again. It may be able to connect.
- Entering the Bluetooth passkey may be required depending on the other party's Bluetooth device when connecting, updating information, or sending via Bluetooth communication.

■ Submenu operations for device list screen

[Delete]  [Yes]

[Def cnnect dev]  [Yes]

- Set a device that is automatically connected when a Bluetooth compatible function is activated.







[Connection info]

- To edit the device name: Press  edit the device name .

Switching to registration stand-by/connection stand-by <Accept Registered>

Switch to receive a registration request/connection request from other Bluetooth devices in stand-by display.

1 In the Custom menu, select [LifeKit] [Bluetooth] [Accept Registered].

-  flashes at approximately 1-second intervals.
- Register devices within approximately 5 minutes after switching the FOMA terminal to connection stand-by. After approximately 5 minutes,  becomes illuminating.
- To select the service to switch to the connection stand-by: Select [Accept Registered]   select a service   .
- Turn off the Bluetooth power when disabling the stand-by status.

- Connection does not start when the other party's Bluetooth device is already in connection stand-by after the connection is ended. In this case, connect from the FOMA terminal.
- If connection stand-by is set when multiple Bluetooth devices are registered, the FOMA terminal may be connected to a Bluetooth device other than the one to be connected.
- While in connection stand-by, even if a connection request from a Bluetooth device is received, connection may not be made depending on the signal strength, etc.

■ When accepting a registration request from Bluetooth device or connection request from unregistered Bluetooth device

1 Registration request/Connection request from the other party in stand-by [Yes] register.

- For details on registering  step 4 of "Registering Bluetooth device" on P. 394

■ When accepting a connection request from registered Bluetooth device

- Automatically connect and [Ⓜ] becomes flashing at approximately 0.5-second intervals.
- When accepting a connection request from already connected service, or when there are two connecting Bluetooth devices, connection is not available.

Turning on/off Bluetooth power on the FOMA terminal <Bluetooth Power ON/Bluetooth Power OFF>

Turn on/off the Bluetooth power of the FOMA terminal.

- If the Bluetooth power is turned off, all services that are connecting or in connection stand-by are stopped. If the Bluetooth power is turned on, services that are previously connecting or in connection stand-by are switched to connection stand-by.

1 In the Custom menu, select [LifeKit] ▶ [Bluetooth] ▶ [Bluetooth Power ON]/[Bluetooth Power OFF] ▶ [Yes].

- With the following operations, Bluetooth is automatically turned on.
 - Connection/connection stand-by
 - Bluetooth reception/send
 - Bluetooth output from Bluetooth compatible functions (1Seg, i-motion, Video player, Music&Video Channel, MUSIC Player, Internet movie player)
 - Activating Bluetooth functions from i-appli
 - Device registration/Connection from presentation assist
- Also, Bluetooth remains on after the completion of the above processing. However, for Bluetooth communication from i-appli, if there is no Bluetooth function being used when i-appli ends, Bluetooth is turned off.
- While the FOMA terminal is turned off or in the Self mode, Bluetooth power is forcibly turned off. However, when the FOMA terminal is turned on or the Self mode is disabled, the original status (connection stand-by) is recovered.

Making a call using Bluetooth devices

1 Connect a Bluetooth device using Headset service or Hands-free service.

2 Make/Receive a call via the Bluetooth device.

- [Ⓜ] appears during a call via the Bluetooth device.
- To switch between call on the Bluetooth device and FOMA terminal: Press Ⓜ (for 1+ seconds) during a call.
 - When a connection is being made using the Headset service and the call is being made with the FOMA terminal, the connection can be switched only from the Bluetooth device.
 - Alternatively, press Ⓜ for 1+ seconds to switch while calling, receiving a call, holding a call, responding to a recorded message/recording message or on hold.

- During a call on the Bluetooth device, adjust the volume on the Bluetooth device.
- During a call on the Bluetooth device, the call continues when the FOMA terminal is closed regardless of Set when closed.
- If the FOMA terminal is disconnected from a Bluetooth device during a call, the call is finished.

Playing audio and music of 1Seg and MUSIC Player using Bluetooth devices

1 Connect a Bluetooth device using Audio service.

2 Activate and watch/play 1Seg, MUSIC Player, etc.

- During a Bluetooth outputting, adjust the volume on the Bluetooth device.
- Remote control operations are available even while playing MUSIC Player or Music&Video Channel player (program with voice only) in the background. However, remote control operations are not available when Submenu, etc. is displayed even in the player screen.
- Depending on the conditions of Bluetooth device or operations from the FOMA terminal, playing sound or music may be interrupted.

- If a voice or music is stopped from a Bluetooth device during the playback, the FOMA terminal may be outside the Bluetooth area or the Bluetooth device is turned off. Check the FOMA terminal and Bluetooth device. In this case, the Audio service may be disconnected depending on the Bluetooth device. To play the voice or music from the Bluetooth device again, reconnect the Audio service.
- When connecting the Wireless Earphone Set 02 (sold separately), connect it from the FOMA terminal.
- Some music data in AMR format may not be played depending on the car navigation.

Setting Auto start of MUSIC Player <Music auto start>



- 1 In the Custom menu, select [LifeKit] ▶ [Bluetooth] ▶ [Bluetooth setting] ▶ [Music auto start].
- 2 Select the setting ▶ .

- When Music auto start is [ON], if an Audio service is connected from a Bluetooth device with the Audio service in connection stand-by, MUSIC Player is automatically activated. However, it is not activated while a screen other than stand-by appears.

Outputting with voice from a Bluetooth device after each function is activated <Bluetooth output>

- Connect to the Bluetooth device that is set to the default connection device setting.
- 1 While 1Seg, video player, etc. is being activated, press  ▶ [Bluetooth output] ▶ [ON].

Connecting automatically to a Bluetooth device when each function is activated <Startup auto connct>

- 1 While 1Seg, video player, etc. is being activated, press  ▶ [Bluetooth output] ▶ [Startup auto connct].
- 2 Select the setting ▶ .

- When Startup auto connection is [ON] and there are some Bluetooth devices that are set to the default connection device setting, just activate 1Seg or MUSIC Player to automatically make it connect to the Bluetooth devices without connecting to the Audio service in advance.
- Connection is not available when 1Seg is activated by the time for starting or recording and Wakeup TV.
- When there is no Bluetooth device that is set to the default connection device setting, Startup auto connection cannot be set to [ON].
- The setting becomes valid from next start.

Using Bluetooth compatible keyboard











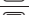

- 1 Connect a Bluetooth compatible keyboard using Presentation/Keyboard service.
- 2 In the text input screen, input text from keyboard.
 - Input method is automatically set to [Romaji method] and Quick conversion and Direct conversion are set to [OFF].

Bluetooth compatible keyboard

- Convenient operations in the text input screen are shown below.

To select text	Shift+Cursor key
To copy the selection	Ctrl+C
To cut the selection	Ctrl+X
To paste	Ctrl+V
To cancel operations (UNDO function)	Ctrl+Z
To change the range of characters to be converted	Shift+←, Shift+→

- Keys of the Bluetooth compatible keyboard correspond to the operation keys of the FOMA terminal as below. Corresponding keys can be operated same as the FOMA terminal.

FOMA terminal	Bluetooth compatible keyboard
	BS or DEL
	Esc
	Ctrl+Esc
	F1*1
	F2
	F3
	F4
	1 to 9, 0
	* "Shift+: (colon)"
	# "Shift+3"
	↑, ↓, ←, →
	Enter*2 (Text input screen: Ctrl+Enter)
	/

*1 Press in the compose message screen to send.

*2 Press in the text input screen to insert [↵] (line breaks).

- Some keys, such as numeric keypad, cannot be inputted.

- Text input is not available with the FOMA terminal during the operation with Bluetooth compatible keyboard. Switch the Input method to [5-touch]/[2-touch] for inputting the text with FOMA terminal (P. 409). In this case, the operation with Bluetooth compatible keyboard is not available.
- The terminal security code cannot be entered using a Bluetooth compatible keyboard.
- If the text box is selected during i-mode/Full Browser, the text input screen appears and text can be entered.

Connecting with a Bluetooth compatible car navigation system using Serial port service

In addition to Hands-free service, etc., Serial port service is available for connecting the FOMA terminal with a Bluetooth compatible car navigation system to use various functions.

- Refer to the following website for compatible models.

<http://k-tai.sharp.co.jp/peripherals/bluetooth/sh-07a.html>

- 1 Connect with a Bluetooth compatible car navigation system using Serial port service.
- 2 Send and receive data with car navigation system.

Sending location information to Bluetooth compatible car navigation system

Send location information to a cooperated Bluetooth compatible car navigation system from still pictures with location information or location history.

Example: Still picture

- 1 In the Custom menu, select [Data box] ▶ [My picture].
- 2 Select an image ▶  ▶ [Send data] ▶ [Send location info].
- 3 Select the sending method ▶ .

- When Bluetooth compatible car navigation system is not cooperated, location information is saved as send reservation data in the FOMA terminal. When the send reservation data is already saved, the confirmation screen asking whether to overwrite appears. The saved send reservation data is sent when Bluetooth compatible car navigation system is cooperated. Send reservation data is sent regardless of Function lock settings.

■ Deleting send reservation data <Del send res data>

- 1 In the Custom menu, select [LifeKit] ▶ [Bluetooth] ▶ [Del send res data] ▶ [Yes].

■ Checking missed calls or mail reception of the FOMA terminal with Bluetooth compatible car navigation system

Check missed calls or mail reception of the FOMA terminal with Bluetooth compatible car navigation system.

■ Sending a mail transferred from a Bluetooth compatible car navigation system with the FOMA terminal

If a phonebook in which other party's mail address is saved is transferred to a Bluetooth compatible car navigation system, a mail transferred from a Bluetooth compatible car navigation system can be sent with the FOMA terminal.

Sending and receiving data





Connect a Bluetooth device to the FOMA terminal with the File transfer service to send and receive data.

- While sending and receiving data through Bluetooth communication, the FOMA terminal status is the same as when outside the service area, such that making/receiving calls, i-mode, and data communications are not available.
- Sending and receiving data via Bluetooth communication is not available during a call.
- Images, i-motion, Melody and PDF of Data box or Decome-Anime Template cannot be sent or received. Other data that can be sent and received or operations for when various lock functions are set are same as for Ir communication (P. 354).



- If Session number setting is set to [ON], the terminal security code and authentication password entry are required to send all data. Authentication password is a password exclusively for Bluetooth. Before starting to send, the sender and receiver must enter the same user-specified four-digit password.

■ Sending data items <Send/Send all>

Example: Phonebook

- 1 In stand-by, press .
- 2 Select a name ▶  ▶ [Send data] ▶ [Send via Bluetooth].
- 3 Select the send method.
 - ◆ Select [Send].
 - ◆ Select [Send all] ▶ enter the terminal security code ▶ .
 - Set the receiving Bluetooth device to receive data.
- 4 Select [Yes].
- 5 Select a Bluetooth device to connect to ▶ .

■ Receiving data items <Receive Bluetooth>

- 1 In the Custom menu, select [LifeKit] ▶ [Bluetooth] ▶ [Receive Bluetooth] ▶ [Yes].
 - The FOMA terminal waits to receive data. Data is automatically received when data is sent from sender's Bluetooth device.
- 2 Select [Yes].
 - To receive all data items: Select [Yes] ▶ enter the terminal security code ▶  ▶ [Yes].
 - To cancel Receive: While receiving data, press .

Setting Bluetooth function <Bluetooth setting>

■ Checking Bluetooth information <Bluetooth info>

- 1 In the Custom menu, select [LifeKit] ▶ [Bluetooth] ▶ [Bluetooth setting] ▶ [Bluetooth info].
 - To edit the device name: Press  ▶ edit the device name ▶ .

- Enter up to 32 single-byte (16 double-byte) characters for a device name.

- Pictograms in the device name may not appear correctly for the other party's Bluetooth device.

■ Setting time to search Bluetooth device

<Time-out To Search>

1 In the Custom menu, select [LifeKit] ▶ [Bluetooth] ▶ [Bluetooth setting] ▶ [Time-out To Search].

2 Enter the search time ▶ .

■ Setting whether to perform Bluetooth authentication

<Set Authentications>

1 In the Custom menu, select [LifeKit] ▶ [Bluetooth] ▶ [Bluetooth setting] ▶ [Set Authentications].

2 Select the setting ▶ .

- The setting cannot be made when [0] appears.

■ Setting whether to perform Encryptions <Set Encryptions>

1 In the Custom menu, select [LifeKit] ▶ [Bluetooth] ▶ [Bluetooth setting] ▶ [Set Encryptions].

2 Select the setting ▶ .

- The setting cannot be made when Set Authentications is set to [No].
- The setting cannot be made when [0] appears.

■ Setting whether to forward ring tone to Bluetooth devices

<Forward Ring Tone>

1 In the Custom menu, select [LifeKit] ▶ [Bluetooth] ▶ [Bluetooth setting] ▶ [Forward Ring Tone].

2 Select the setting ▶ .

- The setting cannot be made while connecting Hands-free or Headset services.

■ Setting whether to enter authentication password

<Session no. setting>

When sending all data via Bluetooth communication, set whether to enter the authentication password.

1 In the Custom menu, select [LifeKit] ▶ [Bluetooth] ▶ [Bluetooth setting] ▶ [Session no. setting].

2 Select the setting ▶ .

Overseas Use

Outline of international roaming (WORLD WING)	428
Available services overseas	429
Before use overseas	430
Making a call at your country of stay.	432
Receiving a call overseas	433
Setting network communication system <3G/GSM setting>	434
Setting a search method of telecommunications carrier <Network search mode>	434
Setting a telecommunications carrier to preferentially connect to <PLMN setting>	434
Displaying a telecommunications carrier during roaming <Operator name disp>	435
Activating roaming guidance. <Roaming guidance>	435
Setting incoming call to reject during roaming <Call barring>	435
Using Missed Call Notice function during roaming <Missed Call Notice>	436
Using network services during roaming <Int'l services>	436

Outline of international roaming (WORLD WING)

International roaming (WORLD WING) is a service that enables you, using overseas telecommunications carrier's networks, to make calls and use i-mode.

Use this FOMA terminal for voice/Videophone calls, i-mode and SMS with the phone number and mail address used in Japan.

Network services such as Voice Mail and Call Forwarding Services can also be used.

- This service is available in the 3G network and GSM/GPRS network service areas. In addition, this service is available in countries and regions supporting 3G 850 MHz.
- By default, the FOMA terminal is set to automatically switch networks (☎ P. 434).
- Refer to the following before using the FOMA terminal overseas.
 - "Mobile Phone User's Guide [International Services]"
 - "Mobile Phone User's Guide [Network Services]"
 - PDF file "海外ご利用ガイド" pre-installed in [My Documents] of Data box
 - DOCOMO "International Services website"

Country codes of major countries

The following shows "Country code" used when making international calls (☎ P. 61) or setting International dial assist (☎ P. 62).

- For other country codes and details, some services are not available depending on the telecommunications carrier or network. Refer to the DOCOMO "International Services website" for information on available countries and regions, and telecommunications carriers.

Country/Region	Code	Country/Region	Code
Australia	61	Maldives	960
Austria	43	Netherlands	31
Belgium	32	New Caledonia	687
Brazil	55	New Zealand	64
Canada	1	Norway	47
China	86	Peru	51
Czech	420	Philippines	63
Egypt	20	Russia	7
Fiji	679	Singapore	65
Finland	358	South Korea	82
France	33	Spain	34
Germany	49	Sweden	46
Greece	30	Switzerland	41
Hong Kong	852	Tahiti (French Polynesia)	689
Hungary	36		
India	91	Taiwan	886
Indonesia	62	Thailand	66
Italy	39	Turkey	90
Japan	81	U.K.	44
Macau	853	U.S.A.	1
Malaysia	60	Vietnam	84

Available services overseas

The available communication services overseas are as follows.

Communication service	Explanation	3G	GSM	GPRS
Voice call*1, 2	Make or receive calls in your country of stay or make international calls to Japan or to other countries with the same phone number as used in Japan while abroad.	○	○	○
Videophone*1, 2	Make international Videophone calls to users of the specified 3G telecommunications carriers overseas and FOMA users in Japan.	○	×	×
i-mode mail	Send or receive i-mode mail overseas with the same address as used in Japan.	○	×	○
i-mode*3	Use i-mode overseas.	○	×	○
i-Channel*3, 4	Use i-Channel overseas.	○	×	○
i-concier*5	Use i-concier overseas.	○	×	○
i-Widget*6	Use i-Widget overseas.	○	×	○
SMS	Send or receive SMS overseas with the same phone number as used in Japan.	○	○	○
GPS position location	-	○	×	○
Packet transmission by connecting a PC, etc.*7	Use packet transmission overseas.	○	×	○

*1 When the 2in1 is used, calling from Number B is not available overseas.

- *2 When Multi Number is used, calling from Additional Number is not available overseas.
- *3 Overseas use settings for i-mode is required (☎ P. 430).
- *4 i-Channel setting is required. Packet transmission charges are incurred for each i-Channel reception (including Basic channel).
- *5 Overseas use settings for i-concier is required. Packet transmission charges are incurred for each information reception. Overseas use settings for i-concier can be changed in the following way.
In the Custom menu, select [i-concier] ▶ [設定] ▶ [その他共通設定] ▶ [海外利用設定].
- *6 Setting for i-Widget roaming is required (☎ P. 285). Multiple Widget appli may attempt transmission when i-Widget screen appears. In such case, packet transmission charges are incurred for each transmission.
- *7 Unable to use 64K data communication by connecting a PC, etc.

- Some services are not available depending on the telecommunications carrier or network. Refer to "Mobile Phone User's Guide [International Services]" or the DOCOMO "International Services website" for information on available countries and regions, and telecommunications carriers.
- Overseas packet transmission charges differ from those in Japan.
- 日英版しゃべって翻訳 for SH (J-E Speech Translation for SH) is available overseas (☎ P. 269).