

## LIMITED WARRANTY STATEMENT

The manufacturer warrants safe operation and reliability only under the following conditions:

- The product is installed and operated according to the assembly and operating instructions.
- Only original replacement parts are used.

### General Terms

This Limited Warranty applies to the enclosed product (the "Product") distributed by Great American Duck Races, Inc., an Arizona corporation (doing business as Great American Marketing and Events) ("GAME").

- GAME warrants that the Product will be free from defects in materials and workmanship under normal use for a period of ninety (90) days from the date of purchase. (Your dated sales or delivery receipt, showing the date of your Product purchase, is your proof of the purchase date.) During the warranty period, GAME will repair or replace any defective parts at no charge.
- All defective parts that are replaced by GAME will be replaced, at GAME's discretion, with either new parts or used parts that meet or exceed performance specifications for new parts. All parts removed from the Product under this warranty will become the property of GAME. Repair or replacement of any parts will not serve to extend the ninety (90) days warranty period.
- This Limited Warranty does not apply to expendable parts. This Limited Warranty does not extend to any product (a) from which the serial number has been removed or (b) that has been damaged or rendered defective (i) as a result of accident, misuse, abuse or other external causes; (ii) by operation outside the usage parameters stated in the manual that shipped with the Product; (iii) by the use of parts not manufactured or sold by GAME; or (iv) by modification or service by anyone other than GAME or an authorized GAME distributor.
- If a defect is identified within the warranty period, please contact GAME.

**EXCEPT FOR THE LIMITED WARRANTY SET FORTH ABOVE, GAME EXPRESSLY DISCLAIMS ALL OTHER WARRANTIES, WHETHER EXPRESS OR IMPLIED, ORAL OR STATUTORY (INCLUDING, WITHOUT LIMITATION, WARRANTIES OF MERCHANTABILITY AND FITNESS FOR A PARTICULAR PURPOSE). ANY IMPLIED WARRANTIES THAT MAY BE IMPOSED BY LAW ARE LIMITED TO THE TERMS OF THE ABOVE LIMITED WARRANTY.**

### Limitation of Liability

**EXCEPT FOR THE LIMITED WARRANTY DESCRIBED ABOVE, IN NO EVENT WILL GAME HAVE ANY LIABILITY OF ANY KIND WHATSOEVER (WHETHER UNDER CONTRACT, TORT, OR ANY OTHER THEORY OF LEGAL LIABILITY) TO ANY PERSON WITH RESPECT TO THE PRODUCT (INCLUDING, WITHOUT LIMITATION, (A) ANY USE OR MISUSE OF THE PRODUCT, (B) ANY FAILURE OR MALFUNCTION OF THE PRODUCT, (C) ANY BODILY INJURY, DEATH, LOSS OF OR DAMAGE TO ANY PROPERTY, OR ANY OTHER DAMAGES RELATED TO OR RESULTING FROM THE PRODUCT OR ITS USE (INCLUDING, WITHOUT LIMITATION, ANY SPECIAL, INCIDENTAL, CONSEQUENTIAL OR PUNITIVE DAMAGES, LOST PROFITS, LOSS OF USE), EVEN IF GAME OR GAME'S AUTHORIZED REPRESENTATIVES HAVE BEEN ADVISED OF THE POSSIBILITY OF ANY SUCH DAMAGES.**

### Severability

Any provision of this Limited Warranty which is prohibited or unenforceable in any jurisdiction will, as to such jurisdiction, be ineffective to the extent of such prohibition or unenforceability without invalidating the remaining portions hereof or affecting the validity or enforceability of such provision in any other jurisdiction.

### Venue and Choice of Law

This Limited Warranty is applicable in all countries. This Limited Warranty will be governed by the laws of the State of Arizona (regardless of any conflict of laws rules), and any disputes arising from this Limited Warranty will be resolved in Phoenix, Arizona.

### Entire Agreement

This Limited Warranty is understood to be the complete and exclusive agreement between GAME and the purchaser of the Product, superseding all prior agreements, oral or written, and all other communications between such parties relating to the Product. No employee or representative of GAME or any other party is authorized to make any warranty in addition to the limited warranty set forth above.

To obtain warranty service, please call, write, or email us directly at the address shown below.

This warranty gives you specific legal rights, and you may also have other rights which vary from state to state.

## FCC STATEMENT

1. This device complies with Part 15 of the FCC Rules.

Operation is subject to the following two conditions:

- (1) This device may not cause harmful interference, and
- (2) This device must accept any interference received, including interference that may cause undesired operation.

2. Changes or modifications not expressly approved by the party responsible for compliance could void the user's authority to operate the equipment.

---

Look for other GAME products at your favorite store or visit our website, [www.game-group.com](http://www.game-group.com).

---



Great American Merchandise & Events™  
16444 N. 91st Street  
Scottsdale, AZ 85260-1567 USA

tel: 888.382.5988, 602.957.3825  
fax: 602.957.7665  
email: [products@game-group.com](mailto:products@game-group.com)  
[www.game-group.com](http://www.game-group.com)

# DIGITAL WIRELESS THERMOMETER OWNER'S MANUAL

MODEL 4302



## RECEIVER

### Front View

1. Transmitter battery strength
2. Temperature
3. Temperature scale
4. Receiver battery strength
5. Signal indicator

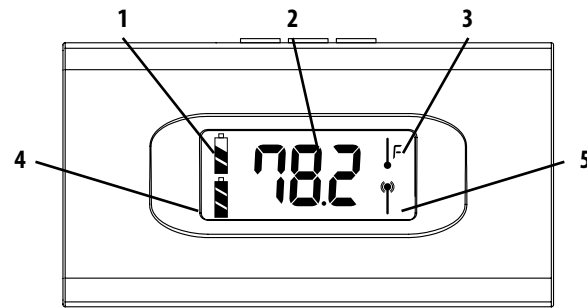

### Top Buttons Functions

1. Transmitter pairing button
2. Screen light
3. C°/F° button

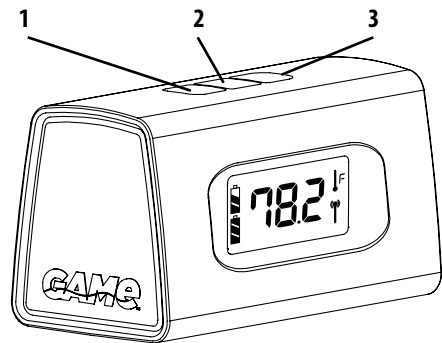

### Receiver Back View

1. Battery compartment
2. Wall mounts

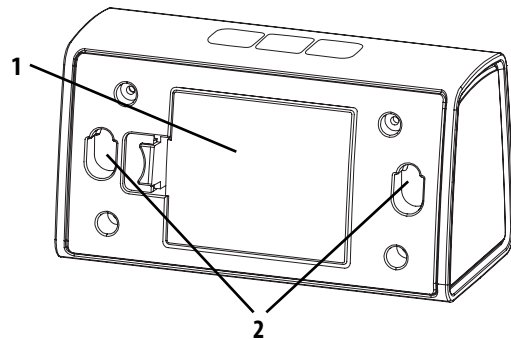

### Note

- Always read the owner's manual carefully before operating the unit.
- Avoid placing the receiver near interference sources/metal frames such as computer or TV sets.
- To help conserve batteries and ensure the longest and most accurate product function, the transmitter Unit transmits every 2.5 minutes if the temperature change is 0.5°C/1.1°F or more from the last reading. If the temperature change is less than 0.5°C/1.1°F, the transmitter unit will still transmit every 60 minutes in order to maintain connection. If the Receiver fails to receive a signal within 3 hours, the transmitter Icon will flash, indicating a problem with signal reception.
- Rechargeable batteries rated at less than 1.5 VDC (such as 1.2 VDC rechargeable cells) may adversely affect product range, accuracy, and performance.

## WIRELESS TRANSMITTER

### Transmitter Front View

1. C°/F° button
2. Battery strength indicator
3. Temperature
4. LCD temperature display
5. Transmitter icon
6. Transmitter pairing button
7. Battery cover
8. Data transmitter LED indicator

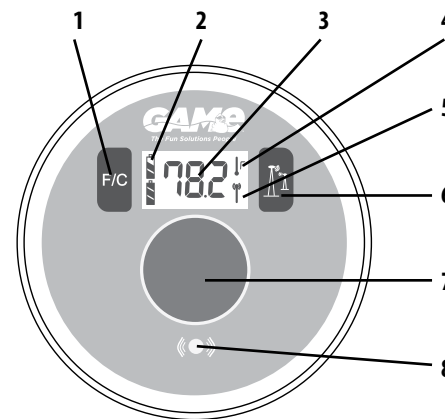

### Exploded View

1. Battery Cover
2. Transmitter Body
3. Transmitter Cover
4. Tether loops (2)

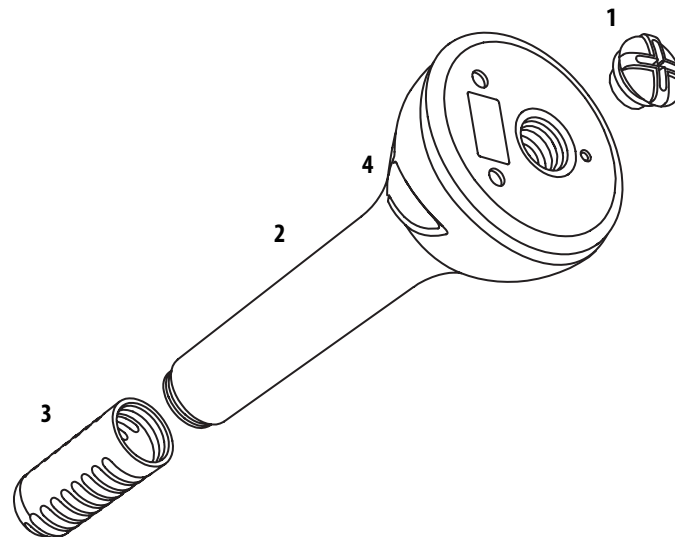

## SPECIFICATIONS

Range of temperature measurement:

Receiver	-0 °C to 50 °C (32°F to 122°F)
Remote transmitter	-50 °C to 70 °C (-58°F to 158°F)
Transmission	100M (300 ft.) open area, RF 433 MHz
Resolution	0.1 degree
Battery life	3 months (alkaline batteries recommended)

## RECEIVER BATTERY INSTALLATION

For first time installation, always insert batteries in the receiver display unit and then the remote transmitter. The receiver will seek a transmitter within range.

1. Open the battery cover of the back unit.
2. Install three (3) AAA batteries according to polarity indicated.
3. Replace the batteries compartment cover

## SETTING UP THE WIRELESS TRANSMITTER

1. Attach the transmitter cover to the transmitter body
2. Place the transmitter as close to the receiver as possible.
3. Remove the battery cap.
4. Install three (3) AAA batteries according to polarity indicated.
5. Screw and tighten the battery cap.
6. The red LED on the transmitter will flash when it transmits a signal. Temperature of the transmitter will be updated and displayed on the transmitter's LCD.
7. Press the "°C/°F" button on the back of the transmitter to change from Fahrenheit to Celsius.

NOTE: If the transmitter and receiver fail to automatically pair, bring the two units close together, and press the transmitter button on the receiver for 8 seconds, and then press the transmitter button on the transmitter for 1 second.

8. Place the transmitter into the water to be tested, and check for signal reception at the receiver. For most consistent results, tether the transmitter using the tether loops, and an appropriate length of water, UV, and chemical resistant string.

## LOW BATTERY INDICATOR/REPLACING BATTERIES

There are two low battery indication on the receiver and one on the transmitter. A low battery warning icon will appear on the transmitter screen and on the receiver screen.

When the low battery indicator appears, replace the batteries in both the transmitter and receiver. Follow the setup procedure above.

After replacing the batteries, re-pair the receiver with the transmitter by pressing the transmitter pairing button (#6) once.

### Note

- Do not mix old and new batteries.
- Do not dispose batteries into fire. Batteries may explode or leak.
- Do not mix alkaline standard (carbon-zinc), or rechargeable (nickel-cadium) batteries.
- Replace batteries ensuring the correct battery type, and as a simultaneous act.
- Remove batteries if product is to be left unused for a long time.
- Clean the battery contacts and also those of the devices prior to battery installation.
- The supply terminal is not to be short circuited (+) (-).
- Non-rechargeable batteries are not to be recharged.
- Batteries are to be inserted with the correct polarity.
- Remove exhausted batteries promptly and dispose of properly.