



5in1  
**ELECTRICAL  
MANDOLINE  
SLICER**

**MODEL # GMS100**



FOR CUSTOMER SERVICE  
QUESTIONS OR COMMENTS  
PLEASE CALL  
**888.552.0033**

**Gourmia**

GOURMIA.COM

**Gourmia**

# ELECTRICAL MANDOLINE SLICER

**MODEL # GMS100**

Safety Precautions .....	4
Product Specs .....	6
Using Your Device.....	7
Cleaning and Care.....	10
Useful Tips.....	10

**USER  
MANUAL**

## SAFETY PRECAUTIONS:

---

This appliance is not intended to be used by persons (including children) with reduced physical, sensory or mental capacities or lack of experience and knowledge, unless they are supervised or have been given instructions beforehand concerning use of the appliance by a person responsible for their safety.

Continuous running of meat grinder should be not more than 90 seconds with the motor cool down to room temperature before switching on again.

This appliance shall not be used by children. Keep the appliance and its cord out of reach of children.

Appliances can be used by persons with reduced physical, sensory or mental capabilities or lack of experience and knowledge if they have been given supervision or instruction concerning use of the appliance in a safe way and if they understand the hazards involved.

Children shall not play with the appliance.

If the supply cord is damaged, it must be replaced by the manufacturer, its service agent or a similarly qualified person in order to avoid a hazard. Always disconnect the appliance from the supply if it is left unattended and before assembling, disassembling or cleaning.

Switch off the appliance and disconnect from supply before changing accessories or approaching parts that move in use.

This appliance is intended for normal household use only. It is not intended for use in environments such as staff kitchen of shops, offices, farms or other work environments. Nor is it intended to be used by clients in hotels, motels, bed and breakfasts and other residential environments.

Unplug cord from outlet when not in use, before putting on or taking off parts, and before cleaning.

Do not use your appliance if it is not working correctly, if the boxes are damaged or broken, or if the power cord or plug has been damaged. To maintain safety, these parts must be replaced at an approved service center (see list in the service booklet) or by a person with similar qualifications.

- Children should be supervised to ensure they do not play with the appliance.

This appliance must not be operated by children. Keep the appliance and its cord out of the reach of children.

- Do not use your appliance if it is not working correctly, if the boxes are damaged or broken, or if the power cord or plug have been damaged. To maintain safety, these parts must be replaced at an approved service center (see list in the service booklet) or by a person with similar qualifications.
- Always read the instructions carefully before using your appliance for the first time: the manufacturer shall accept no liability in the event of any use that does not comply with the instructions.

- This appliance complies with applicable standards and regulations.
- It is designed to work with alternating current only. Before using it for the first time, we ask you to please check that the voltage of your mains network corresponds to the voltage given on the rating plate on the appliance.
- Do not place or use this appliance on a hotplate or near a naked flame (gas cooker).
- The appliance must only be used on a stable worktop, away from water splashes. Do not turn the appliance over.
- In order to avoid accidents and damage to the appliance, always keep your hands and kitchen utensils away from the blades and moving boxes.
- Do not operate the appliance constantly for over 3 minutes.
- Never remove the lid or boxes before the motor has stopped completely.
- Never push food with your hands, always use the pusher.
- Never use your fingers or other utensils to push food through the spout.
- Never put your fingers or other utensils inside the exit spout while the appliance is working or plugged in.
- Do not use the appliance with hard food products such as sugar, ice cubes or coffee grains.
- The appliance must be disconnected:
  - if you notice any anomalies during operation,
  - before maintenance or cleaning,
  - after each use.
- Never disconnect the appliance by pulling on the power cord.
- Only use an extension after having checked that it is in perfect working order.
- Always unplug the appliance if you are to leave it unattended and before fitting or removing the disks.
- Do not use accessories or spare parts other than those provided by the approved after-sales center.
- This product has been designed for domestic use only. In the event of any commercial use, inappropriate use or failure to comply with the instructions, the manufacturer accepts no responsibility and the guarantee will not apply.

## PRODUCT SPECS

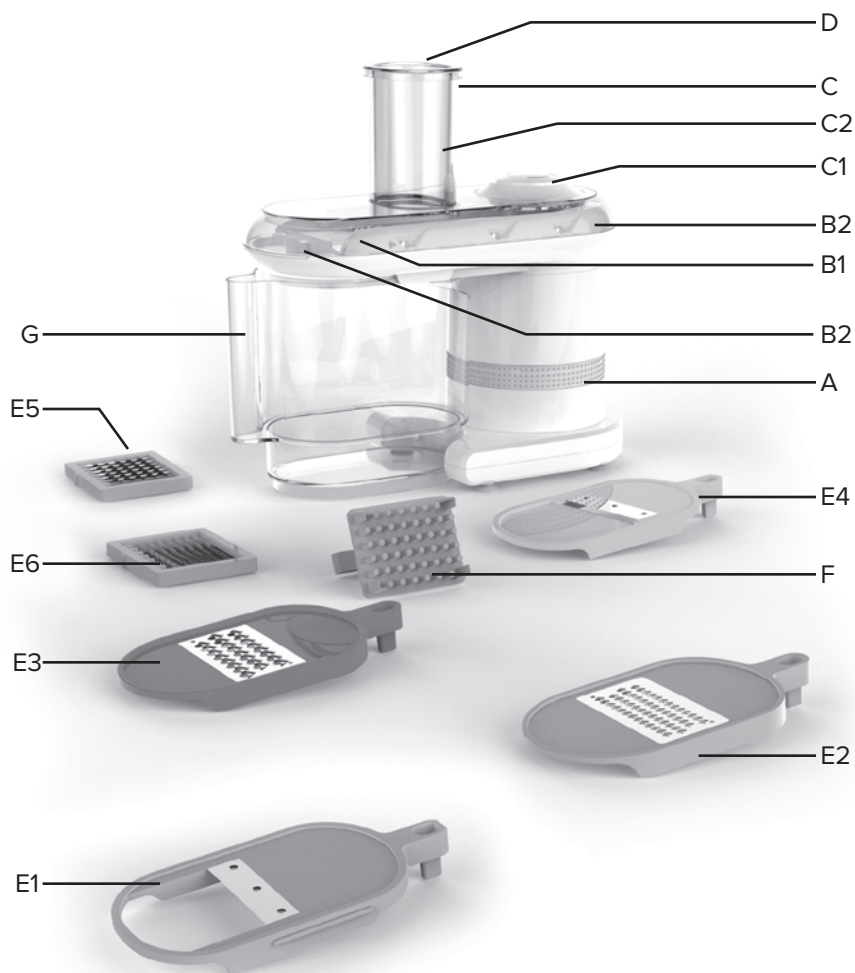

No.	Description	No.	Description
A.	Motor unit	E.	Boxes
B.	Removable protector tray	E1.	Slicer
B1.	Resisting panel	E2.	Fine Grater
B2.	Stalk collector	E3.	Coarse Grater
C.	Lid	E4.	Cubes/sticks disc
C1.	Start/Stop button	E5.	Sticks/fries knife accessory cleaner
C2.	Discharge spout	E6.	Cubes knife accessory
D.	Pusher	F.	Sticks/cubes knife accessory cleaner
		G.	Bowl (food collect or boxes storage)

## USING YOUR DEVICE

### BEFORE FIRST USE

- Clean the accessories (boxes, lid, pusher, and removable protector tray) with soapy water. Rinse and dry them carefully.

**Warning:** The box blades are extremely sharp, handle them with care and always hold by the plastic part.

### USE

Place the removable protector tray on top of the product (Fig. 1). The protector tray will keep the product from becoming dirty and will allow for easier cleaning.

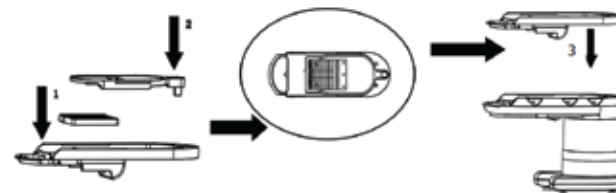

**Warning:** the product cannot be operated without this piece.

- Select the box that corresponds to the desired use.

-For a simple box (E1, E2, E3), place the box on the removable protection tray placing the box stem towards the back of the product (Fig. 2-1).

-For a two-pieces box (E4+E5, E4+E6), first place the knife accessory by positioning, then place the box on the removable protection tray, place the box stem towards the back of the product (Fig. 2-2).

**Attention:** When use cubes or stick accessories, blades E5 or E6 must be placed into correct position firstly before assemble E4.

- Place the lid on the whole appliance and lock it by pushing the lid forward (Fig. 3-1/3-2).

**Warning:** If the lid is not locked properly, the product will not function.

-place the bowl under unit, and ensure it into correct position to activate the micro-switch. (Fig.4)

**Attention:** For ensuring client's safety, your product is equipped with a Micro-switch, the bowl must be placed into correct position to activate the micro-switch before unit working.

- Plug in the product and place a recipient under it (Fig. 5).
- Press the Start/Stop button (Fig. 5).
- Put the food products down the lid opening and push them down with the pusher.

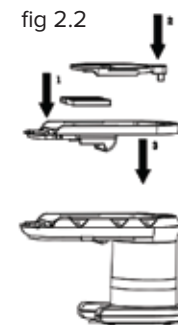
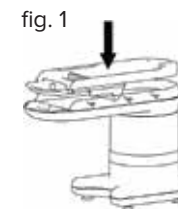

## USING YOUR DEVICE

- To change the box, unlock the lid by pushing it towards the back and remove the box (Fig. 6). It is best to clean the appliance in between each use
- Your product is equipped with a Start/Stop button (C1). For continuous functioning, keep the button pressed.
- Make sure to clean the cubes knife accessory (E5) and sticks knife accessory (E6) boxes with the cleaner (F), which will help you clean stuck food easily.

fig. 3

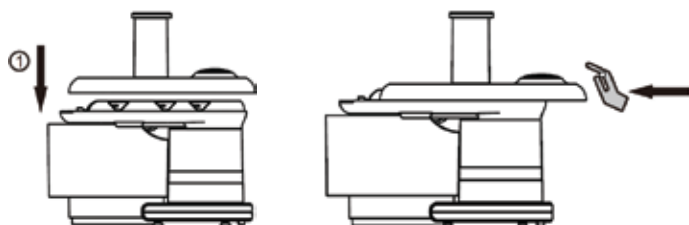

fig. 4

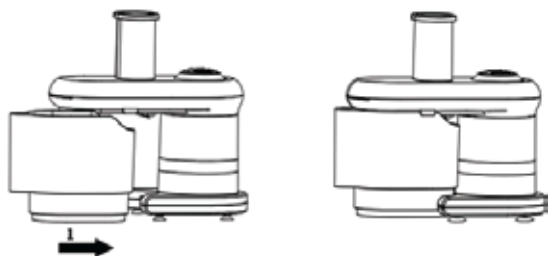

fig. 5

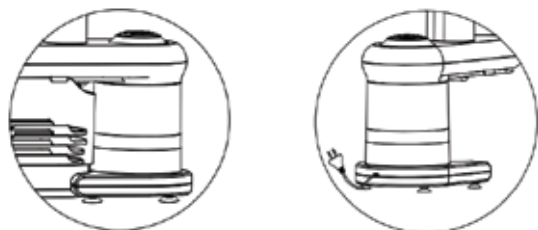
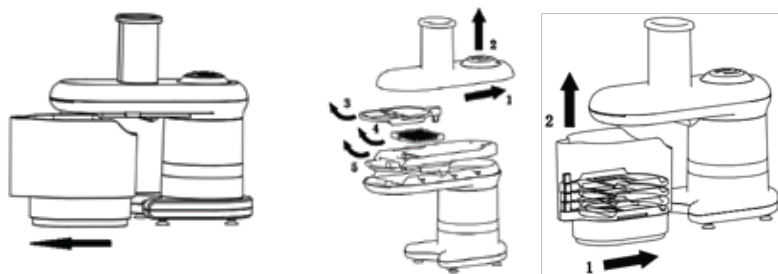

fig. 6



## TROUBLESHOOTING

Questions	Answers
I cannot close the lid ?	Make sure that the box is well placed inside the product.
The product is not working ?	<p>Make sure it is plugged in.</p> <p>Make sure that the removable protector tray is present in the product.</p> <p>Make sure that the box is well placed (stem towards back).</p> <p>Make sure the lid is well locked and that the Start/Stop button is pushed down.</p> <p>It is necessary to press the Start/Stop button for at least 1 second in order for the product to start.</p> <p>Make sure the bowl is into correct position, and micro-switch is activated.</p>
I cannot unlock the lid?	Turn the appliance on for one second in order to move the box, then unlock the lid.
The appliance stops while functioning due to blockage?	Unlock the lid and remove the box, clean the appliance and its accessories, then turn back on.
The food products have stopped coming out of the exit spout?	Unlock the lid and remove it. Remove the recipient and the removable protector tray, empty them completely and clean the appliance.

## CLEANING

- Always unplug the appliance before cleaning the motor unit.
- Do not immerse the motor unit, do not place under water. Clean the motor unit using a damp cloth. Dry it carefully.
- The removable tray, the pusher and the boxes (E1, E2, E3, E4, E5, E6) can be placed in the dishwasher in the top basket and using the “ECO” or “LESS DIRTY” functions.
- The lid can be rinsed under water but must not be placed in the dishwasher.
- Handle the boxes with care as the blades are extremely sharp.
- If the plastic parts become stained by foods such as carrots, rub the affected areas with a cloth soaked in vegetable oil and then clean as normal.
- If the cubes /sticks knife accessory stuffed food, you can use cleaner (F) push food to cleaning.

## STORAGE

- All six boxes (E1, E2, E3, E4, E5, E6) and the cleaning brush (F) can be stored on the appliance.
- Pile the six boxes and place them in the storage bowl.

## RECYCLING

**End-Of-Life Electric Or Electronic Products:** Your appliance is expected to last for many years. However, when the time comes to replace it, do not throw it in the bin or in a dump, but take it to the recycling center in your town (or to a waste reception center where applicable).

### Think of the environment!

Your appliance contains valuable materials which can be recovered or recycled.

Leave it at a local civic waste collection point



## USEFUL TIPS FOR BEST RESULTS

In order to obtain best results, we recommend that you leave the ingredients in the refrigerator before processing them (grating cheese, making cubes with cooked ingredients...).

If the food products are overcooked you will obtain poor results, as the products could cram the appliance. Cut the food so that it is easier to insert it in the feed tube on the lid.

	Slicer box E1	Thin grater Box E2	Coarse grater Box E3	Cubes Box E4E6	Sticks Box E4E5
Pineapple	●				●
Eggplant	●				●
Avocados	●			●	●
Beetroot	● (cooked only)	●	●	● (cooked only)	● (cooked only)
Carrots	● (raw only)	● (raw only)	● (raw only)	●	●
Celery	●	●	●		
Sausage	●			●	
Mushrooms	●				●
Cabbage	●				
Cucumbers	●	●	●	●	●
Pickles	●			●	
Zucchini	●	●	●	●	●
Mango	●			●	●
Melons	●				●
Onions	●			●	
Peaches (canned)	●			●	●
Pears	●			●	●
Pepper	●				●
Apples	●			●	●
Potatoes	● (raw only)	●	●	●	● (raw only)
Tomatoes	●				