

life made Limited Warranty Statement

life made warrants this product against defects in workmanship and material for a period of 12 months from the original date of purchase. If the product fails during normal and proper use within the warranty period, life made will repair or replace any products or parts determined to be defective in workmanship or material at its option. All components repaired or replaced by life made's service site will be under warranty for the remaining period of warranty.

This Limited Warranty covers only the accessory components packaged by this product. This Limited Warranty does not include failure caused by improper installation, operation, cleaning or maintenance, accident, damage caused by extreme temperature, humidity or extreme electrical stress, misuse, abuse unauthorized modifications to the product, software faults, normal wear and tear or any other event, act, default or omission outside of life made's control or if the serial number has been defaced, altered or removed, and the casing has been opened.

To obtain warranty service, please contact life made for specific instructions at the email below. Dated, documented proof of the original purchase is required.

life made Customer Service Representatives are available by emailing support @ lifemade.com

This device complies with Part 15 of the FCC Rules. Operation is subject to the following two conditions:

- (1) This device may not cause harmful interference
- (2) This device must accept any interference received, including interference that may cause undesired operation.



LPBNKFAM44-R

QUICK START GUIDE

life made...™
safe • convenient • mobile

Family Pack Mobile Power Charging Station

- Includes:
- Four 4,000 mAh portable chargers
 - Charging base
 - Four microUSB cables
 - AC plug for Charging Base

LPBNKFAM44-R

Uses & How To:

Charge your mobile device on the go:

1. To turn on the Battery Pack, press the on/off button.
2. Plug in the USB end of your charging cable into the Battery Pack, and the other end of the charging cable into your device to begin charging your device.
3. To turn off the Battery Pack, press the on/off button.

Battery Indicator and LED Flashlight:

1. Below the on/off button on the Battery Pack is an LED light to indicate your Battery Pack's battery level:

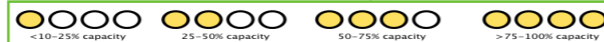

2. On the bottom of the Battery Pack you will find an LED flashlight. To turn it on, double press the on/off button. To turn it off, double press the on/off button.

Charging the Battery Pack:

1. Plug the Charging Base into the wall via the AC plug.
2. With the bottom of the Battery Pack facing down, place the Battery Pack in the Charging Dock of the Charging Base.

Make sure your Charging Base is plugged into a power source: To do so, take the AC Adaptor, and plug the wall connector part into an AC wall outlet, and plug the Charging Base connector part into the Charging Base.

Specifications:

Battery Capacity: 4000 mAh
Battery Type: Li-ion Battery
Input: 5V/1A
Output: 5V/1A

Safeguards:

- DO NOT use this product for anything other than its intended use.
- DO NOT expose the device to extremely high or low temperatures.
- DO NOT use if the device if it has been wet or moist due to electrical shock and/or injury to you and the device.
- DO NOT use if the device has been damaged in any way.
- Keep this product away from direct sunlight, humidity, liquids, and heat sources.
- This unit is NOT a toy.
- Keep this product away from children.
- Repairs should only be performed by a qualified electrician. Improper repairs may put the user at serious risk.

BATTERY DISPOSAL:
This product contains a lithium ion battery. Recycle and dispose according to your local and state laws.

LPBNKFAM44-R

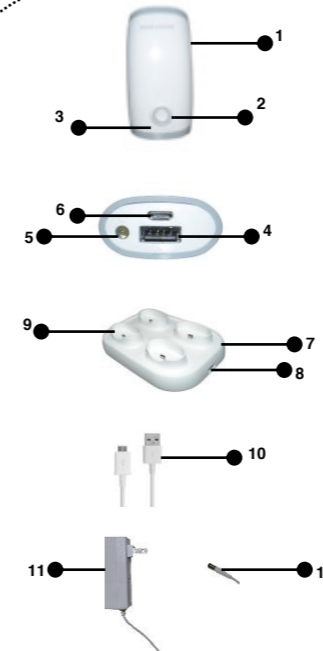

Part #	Description
1	Battery Pack
2	On/ Off Button
3	LED Battery Indicator
4	USB output
5	LED Flashlight
6	microUSB input
7	Charging Base
8	USB output
9	Battery Pack Charging Dock
10	microUSB Cable
11	AC Wall Plug Connector
12	AC Charging Base Connector