

# PT Battery-powered Security Camera

## Quick Setup Guide



To view this guide in other languages (e.g. Nederlands, German, Français, Español), and for detailed manuals, tools, etc., please visit [\*\*foscam.com/downloads\*\*](https://foscam.com/downloads).

# Content

Safety Instructions of Battery Usage .....	3
Add Device .....	4
Before You Get Started .....	4
WiFi connection .....	5
What's in the Box .....	11
Camera Introduction .....	12
Install the Camera .....	13
Mount the Camera .....	14
Solar panel installation .....	15
PC Access Your Camera .....	18
Important Notice .....	19
Product Performance .....	22
Troubleshooting .....	23

# Safety Instructions of Battery Usage

The camera is not designed for running 24/7 at full capacity or around-the-clock live streaming. It's designed to record motion events and to live view remotely only when you need it.

- The battery is built-in, so do not remove it from the camera.
- Charge the rechargeable battery with a standard and high-quality DC 5V battery charger or Foscam solar panel. Do not charge the battery with solar panels from any other brands.
- Charge the battery when temperatures are between 0°C and 45°C and always use the battery when temperatures are between -20°C and 60°C.
- Keep the USB charging port dry, clean and free of any debris and cover the USB charging port with the rubber plug when the battery is fully charged.
- Do not charge, use or store the battery near any ignition sources, such as fire or heaters.
- Do not use the battery if it gives off an odor, generates heat, becomes discolored or deformed, or appears abnormal in any ways. If the battery is being used or charged, remove the battery from the device or the charger immediately, and stop using it.
- Always follow the local waste and recycle laws when you get rid of the used battery.
- Please fully charge the battery before first use.
- Please use the included standard type-c charging cable to charge to avoid charging failure.

# Part A

## Add Device: Connection via the Foscam App (Recommended)

### Before You Get Started

Scan the QR code below to download and install the Foscam APP on APP Store (for iOS ) and Google Play (for Android ).



To ensure a smoother video experience on your smart phone, it is recommended that your smart phone meet the following specifications:

- iOS: version 11 or higher.
- Android: 4.1 or higher, using a device with a Graphics Processing Unit (GPU).

**Note:** For the best experience, please update the APP to the latest version!

## ■ WiFi connection

1. Open the foscama APP and please sign up for a Foscam account, or sign in if you have one already.

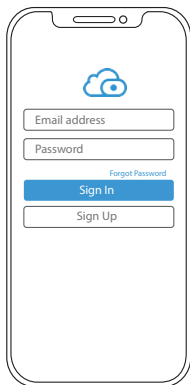
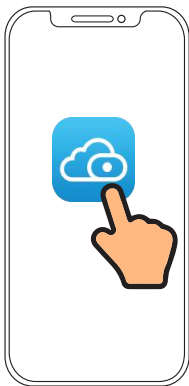

2. Turn on the power switch to power on the camera.



Warnings: Close cover tightly after use , to avoid water leakage causing the camera failure

### 3. Mobile phone connection to the network.

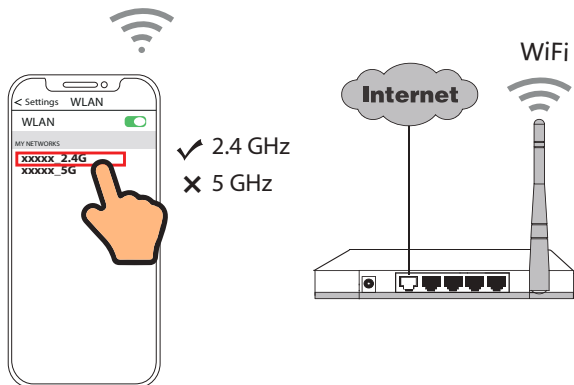

### 4. Follow the steps below:

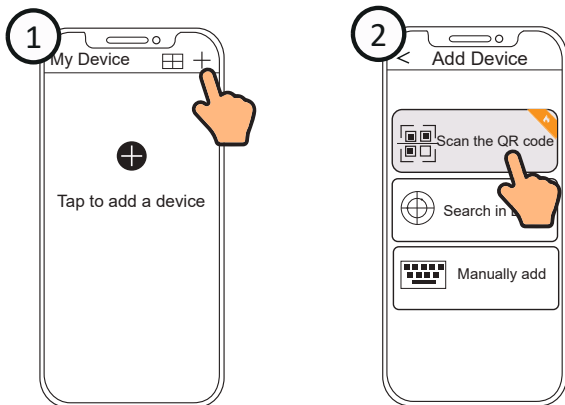

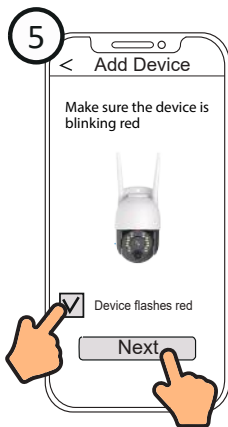

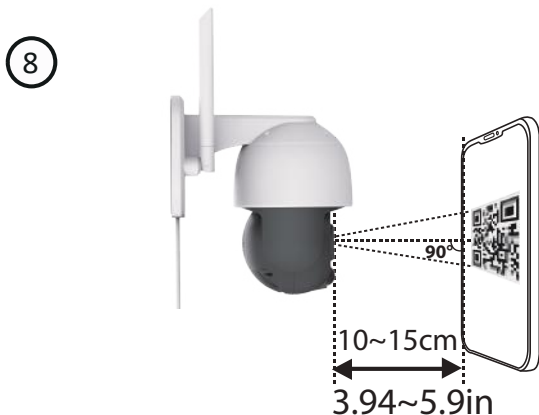
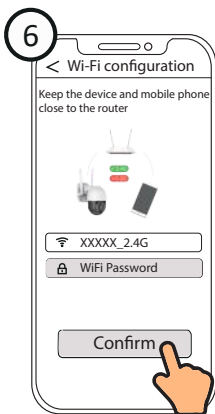

**Important:**

Please keep the camera lens and the QR code at the same level, and keep it for 5~10s without moving, until you will hear a voice prompt say **"WiFi connecting"**.



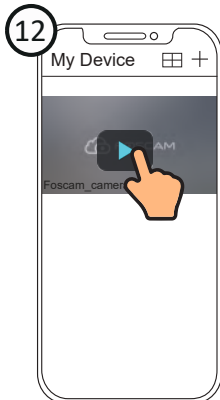
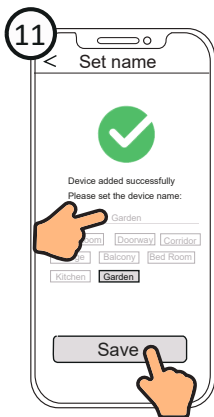
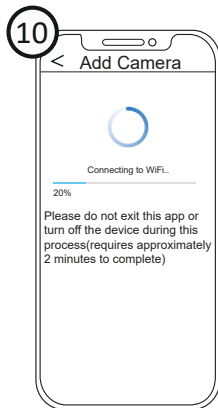

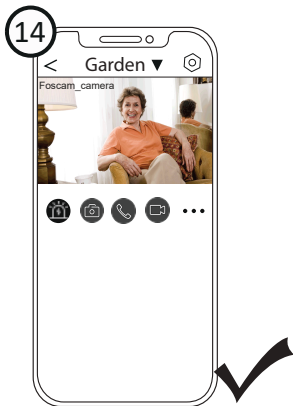
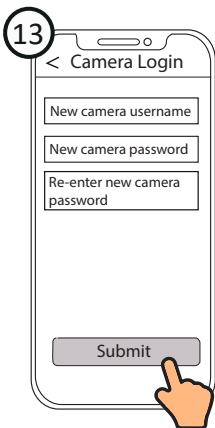

**Note:** If the process of adding a camera fails, please reset your camera and try adding again according to the above method.

# Part B

## What's in the Box



Camera x1



Solar Panel x1

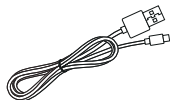

Type-C Cable x1

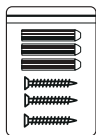

Screws x1  
(For camera)

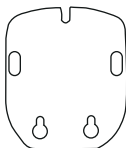

Mounting Bracket x1



User Manual x1

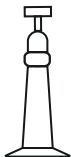

Solar Panel Bracket x1

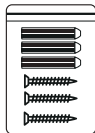

Screws x1  
(For Solar Panel)

# Camera Introduction

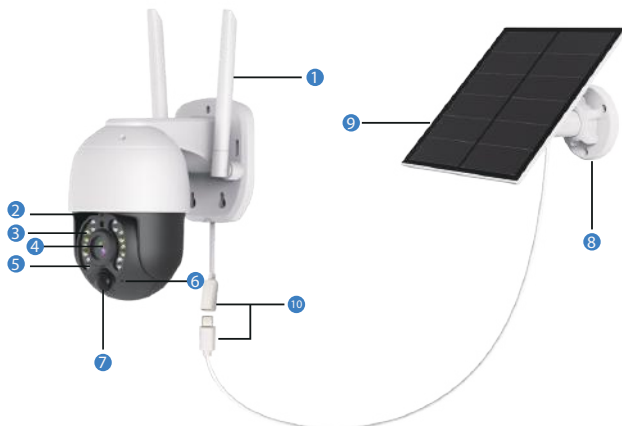

- 1 Antenna
- 2 LED indicator
- 3 Spotlight
- 4 Lens
- 5 Infrared LEDs
- 6 Microphone
- 7 Passive infrared
- 8 Solar Panel Bracket
- 9 Solar Panel
- 10 Solar Panel charging interface (For solar panel charging)



- 11 TF card slot
- 12 Solar Panel Bracket
- 13 Type-c Port  
(For charging with DC adapter)
- 14 Reset button
- 15 Speaker

## Different states of the status LED:

LED indicator	Description
The red light flashes slowly	Ready for Wi-Fi configuration
The blue light flashes quickly	Connecting to router
The blue light flashes slowly	Connecting to server
The blue light is always on	Connected to the server
The blue light flashes three times quickly and one slowly	Charging in sleeping status
Blue & red lights are always on	Full charge
Blue & red lights flash quickly	Firmware upgrading
All indicator off	Camera turned off or in standby status

## Install the Camera

- For outdoor use, the camera **MUST** be installed upside down for better waterproof performance and better PIR motion sensor's efficiency.
- Install the camera 2.2-2.5 meters (7-10 ft) above the ground. This height maximizes the detection range of the PIR motion sensor.
- For better motion detection performance, please install the camera angularly. we suggested installation camera downward tilt angle 10°.

### NOTE:

1. If a moving object approaches the PIR sensor vertically, the camera may fail to detect motion. The angle of the camera is related to the detection distance.
2. The Pan&Tilt angle will affect the PIR detection range;

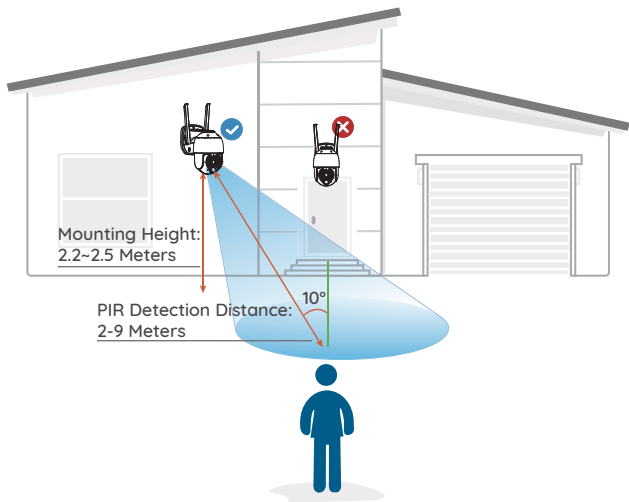

## Mount the Camera

1. Use the drill hole position template to mark the screw holes in the area, and then use the drilling tool to punch holes on the wall. Screw the expansion nut into the holes on the wall.

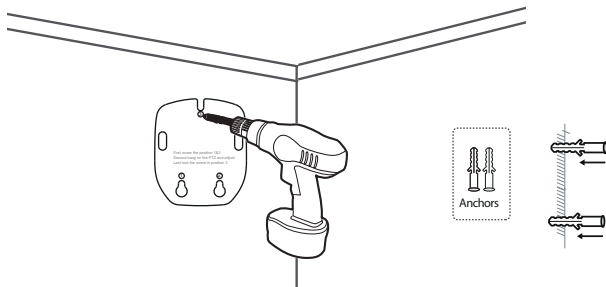

2. Mount the bracket with the screws provided in the package

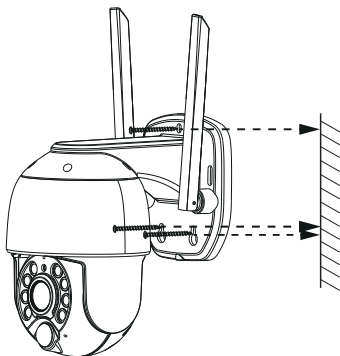

## Solar panel installation

1. Please select a position with the most sunlight throughout the year for your solar panel. The Foscam solar panel only needs a few hours of direct sunlight to sufficiently power your camera daily. The amount of energy that the solar panel can produce is affected by weather conditions, seasonal changes, geographic locations, etc.

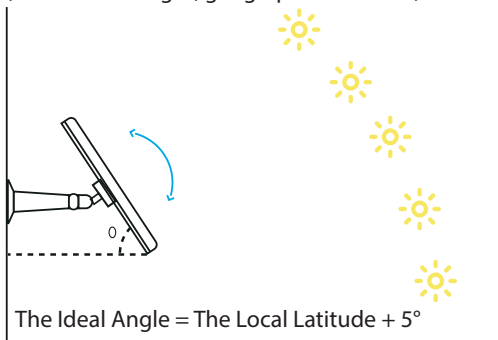

2. Mount the bracket with the mounting template and the screws provided in the package.

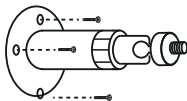

3. Slot the solar panel into the bracket and make sure it's secure.

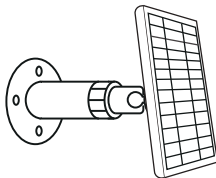

4. Loosen the adjusting control on the bracket and adjust the angle of the solar panel to make it receive direct sunlight, and then retighten the adjusting control to secure your setting.

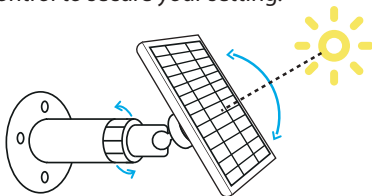

5. Connect the solar panel to the Foscam Battery camera with the Type-C cable.

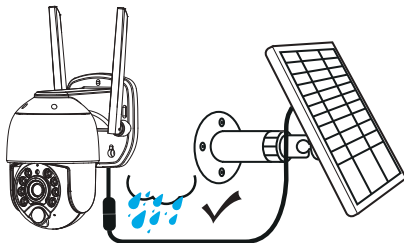





## Important Notes:

1. Make sure that there is NO blocking on the solar panel. The energy harvesting efficiency drops drastically even when a small portion of the solar panel is blocked.
2. Please don't install the solar panel completely horizontally. Otherwise your solar panel might accumulate dust and other debris easily. It's advised to install the solar panel angularly to make it receive direct sunlight.
3. Wipe the solar panel regularly to remove the dust or debris.
4. The following are used for charging indoor adapters, not waterproof.



Note:

1. Be sure to use the type-c cable included in the package to charge the device;
2. Close cover tightly after use, to avoid water leakage causing the camera failure;

5. Do not plug the adapter charging cable into the tail cable for charging



6. Connect the TYPE-C port on the solar panel to the tail cable on the camera. You have to hear a "click" to be waterproof.



## PC Access Your Camera

### ■ Foscam VMS



Foscam VMS is a new tool for PCs. It does not require plug-ins and is compatible with Windows & Mac, supporting all Foscam HD cameras and up to 36 cameras at the same time. If you would like to manage multiple cameras, we suggest you install Foscam VMS. You can download the "Foscam VMS" Windows version from [foscam.com/vms](https://foscam.com/vms), and can also download the "Foscam VMS" Mac version from the APP store:

<https://apps.apple.com/cn/app/foscamvms/id1521202507?mt=12>

**Note:** For the best experience, please update Foscam VMS to the latest version!

### Add the IP Camera

1. Run Foscam VMS, then create a local administrator account and login.
2. Tap the "+" icon on the Foscam VMS and follow the setup wizard to add your camera.

Please visit [foscam.com/downloads](https://foscam.com/downloads) to view the user manual and for additional detailed steps.

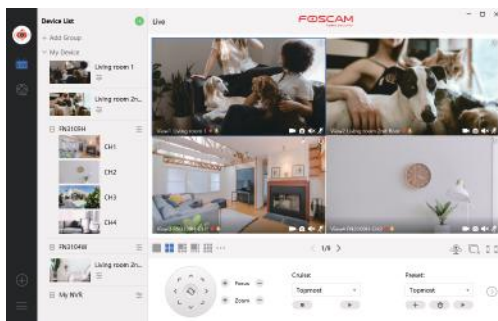

## Important Notice

### ■ Camera Username & Password

The camera username & password are used to access and manage your camera. Having a strong password can significantly improve the security of your camera.

If you have forgotten either of them, please press the "Reset" button.



Press the "Reset" button and hold it for more than 10 seconds

## ■ Storage Media

Your camera supports cloud and Micro SD card (only supports FAT32 format) storage formats.



cloud Storage



Micro SD card  
Support up to 256G  
(only supports FAT32 )

### How to format Micro SD card, please follow the steps below:

1



2

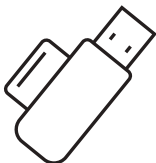

3



4

Scan the QR code below  
to download the  
"FoscamFormat " Tool



[foscam.com/downloads/app\\_software.html](https://foscam.com/downloads/app_software.html)

5

Open the  
"FoscamFormat " Tool



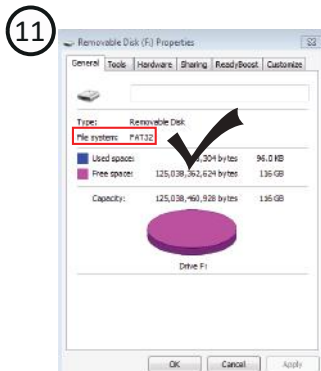
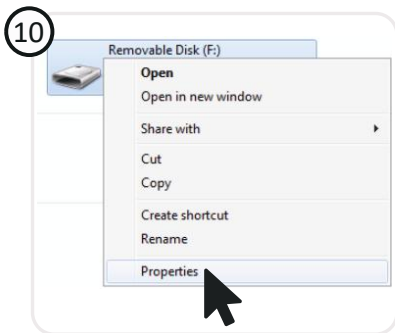
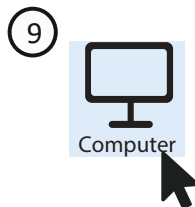
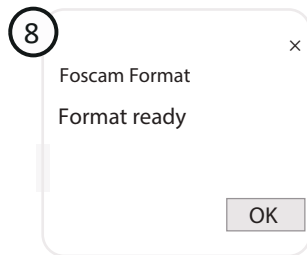
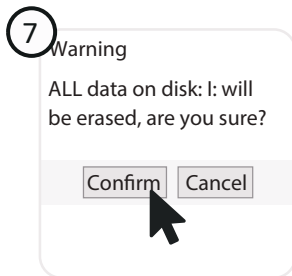
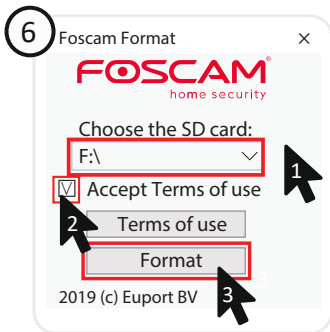

## ■ Safety Tips



Prohibit use at  
high temperature



Prohibit use at  
low temperature



Do not burn



Keep away  
from children



Do not puncture  
and crush



No unauthorized  
disassembly



Use the correct  
supplied type-c cable



Use the supplied  
screw pack

## Product Performance

WLAN frequency range	2412MHz - 2472MHz
Wireless Standard	IEEE802.11b/g/n (2.4GHz)
Power Supply	DC 5V 1.0A 5W

# Troubleshooting

## ● Camera is Not Powering On

If your camera is not turning on, please apply the following solutions :

1. Make sure the power switch is turned on.
2. Charge the battery with a DC 5V/1A power adapter. When the red and blue lights are on at the same time, the battery is fully charged.
3. If these won't work, please contact Foscam support :  
support@foscam.com.

## ● Failed to Scan QR Code on the Phone

If you cannot scan the QR code on your phone, please try the following solutions:

1. Wipe the camera lens with a dry paper/towel/tissue.
2. Vary the distance between your camera and the mobile phone so that the camera can focus better.
3. Try to scan the QR code under sufficient lighting.

## ● Failed to Connect to WiFi During Initial Setup Process

If the camera fails to connect to WiFi, please try the following solutions:

1. Ensure that you have entered the correct WiFi password.
2. Put the camera closer to your router to ensure a strong WiFi signal.
3. Change the encryption method of the WiFi network to WPA2-PSK/WPA-PSK (safer encryption) on your router interface.
4. Change your WiFi SSID or password and make sure that SSID is within 31 characters and password is within 64 characters.
5. Set your password using only the characters available on the keyboard.
6. If these won't work, please contact Foscam support :  
support@foscam.com.



**support@foscam.com**



CE Certificate statement Website:

<https://www.foscam.com/company/ce-certificate.html>

Exporter and Importer Information Opened to Public:

<https://www.foscam.com/company/open-information.html>

Manufacturer: Shenzhen Foscam Intelligent Technology Co., Ltd  
Addr: Room 901-902, Building 1B, Xingke 1st Street, Shenzhen  
International Innovation Valley, Nanshan Dist., Shenzhen,  
518055, China



**FAQS**



**Foscam APP**



**Facebook**

**[www.foscam.com](http://www.foscam.com)**

**Support email: [support@foscam.com](mailto:support@foscam.com)**

Due to product upgrades and other reasons, this guide may be slow to update, resulting in slight inconsistencies with the official website information. Please take the official website ([www.foscam.com](http://www.foscam.com)) information as the current standard.



### FCC Caution:

Any Changes or modifications not expressly approved by the party responsible for compliance could void the user's authority to operate the equipment.

This device complies with part 15 of the FCC Rules. Operation is subject to the following two conditions: (1) This device may not cause harmful interference, and (2) this device must accept any interference received, including interference that may cause undesired operation.

### IMPORTANT NOTE:

Note: This equipment has been tested and found to comply with the limits for a Class B digital device, pursuant to part 15 of the FCC Rules. These limits are designed to provide reasonable protection against harmful interference in a residential installation. This equipment generates, uses and can radiate radio frequency energy and, if not installed and used in accordance with the instructions, may cause harmful interference to radio communications. However, there is no guarantee that interference will not occur in a particular installation. If this equipment does cause harmful interference to radio or television reception, which can be determined by turning the equipment off and on, the user is encouraged to try to correct the interference by one or more of the following measures:

- Reorient or relocate the receiving antenna.
- Increase the separation between the equipment and receiver.
- Connect the equipment into an outlet on a circuit different from that to which the receiver is connected.
- Consult the dealer or an experienced radio/TV technician for help.

### FCC Radiation Exposure Statement:

This equipment complies with FCC radiation exposure limits set forth for an uncontrolled environment. This equipment should be installed and operated with minimum distance 20cm between the radiator & your body.