

# QUICK START GUIDE

## 1. SIZE

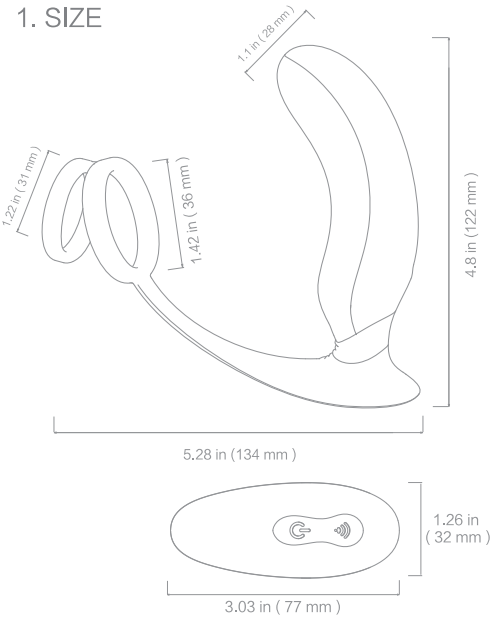

## 2. ON / OFF

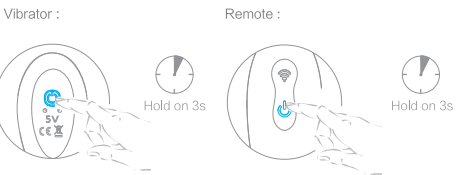

## 3. DISTANCE

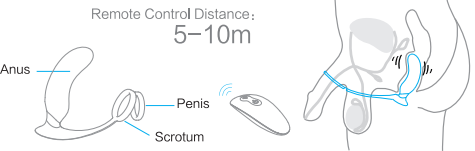

## 4.CHANGE PATTERNS



- 1.Hold "⏻" (on the vibrator) 3s to place it into Standby condition.
2. Hold "⏻" (on the remote) for 3s to turn on, then press "🔊" to switch patterns.
3. Hold "⏻" 3 seconds to pause while vibrating. You can restart the device with the remote directly within 20 minutes, otherwise it will be off. Repeat all above to turn it on.

\*The vibrator can work independently without the remote. Just press "⏻" again to change patterns after standby, and hold for 3s to turn off.

## 5.USB MAGNETIC CHARGING

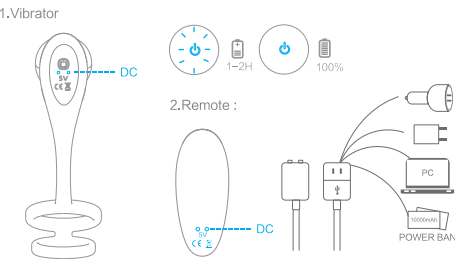

## 6. PRODUCT CLEANING

- Clean Please clean product with warm water or antibacterial soap.
- Wipe Dry the product with clean cloth or towel.
- Store Keep the product in a cool, dry, clean place.
- Attention Never clean this product with organic cleaner containing alcohol, gasoline or acetone. Avoid direct sunlight.

## 7. SAFETY

- Do not use it at temperature over 167 F/75 °C.
- Stop using it when any discomfort occurs.
- It is recommended to use it with water-based lubricant.
- Do not use it if you find the product unsmooth or damaged.
- Keep out of reach of children.



## FCC Warning Statement

Changes or modifications not expressly approved by the party responsible for compliance could void the user's authority to operate the equipment. This equipment has been tested and found to comply with the limits for a Class B digital device, pursuant to Part 15 of the FCC Rules. These limits are designed to provide reasonable protection against harmful interference in a residential installation. This equipment generates uses and can radiate radio frequency energy and, if not installed and used in accordance with the instructions, may cause harmful interference to radio communications. However, there is no guarantee that interference will not occur in a particular installation. If this equipment does cause harmful interference to radio or television reception, which can be determined by turning the equipment off and on, the user is encouraged to try to correct the interference by one or more of the following measures:

- Reorient or relocate the receiving antenna.
- Increase the separation between the equipment and receiver.
- Connect the equipment into an outlet on a circuit different from that to which the receiver is connected.
- Consult the dealer or an experienced radio/TV technician for help.

This device complies with part 15 of the FCC Rules. Operation is subject to the following two conditions: (1) This device may not cause harmful interference, and (2) this device must accept any interference received, including interference that may cause undesired operation.