

GENIE[®]

MINI TRANSMITTER with FLASHLIGHT

This Mini Transmitter is compatible with all INTELLICODE[®] radio equipped GENIE[®] products.



OPERATING INSTRUCTIONS (KEEP FOR FUTURE REFERENCE)

⚠ WARNING

A Moving Door can cause serious injury or death.

- 1 Keep people clear of opening while Door is moving.
- 2 **Do Not** allow children to play with Remote Controls.
- 3 During programming, Door Opener could begin to run, stay away from moving Door and its parts. To keep Door from moving, close Door and disconnect it from Opener by pulling Emergency Release Cord.

If Safety Reverse does not work properly:

- 1 Close Door and disconnect the Opener using Emergency Release Cord.
- 2 **Do not** use Door Opener, Remote Controls, or Wireless Keypad.
- 3 Refer to Door and Door Opener Owner's Manuals before attempting any repairs.

IF YOU ARE REPLACING A LOST OR STOLEN TRANSMITTER, START AT STEP 3.

STEP 1: PROGRAMMING THE RECEIVER

(A unique Transmitter code is set at the factory for each INTELLICODE[®] Transmitter)

- A Locate the Receiver Learn Code Button and Learn Indicator Light on the Power Head of your Door Opener (See Figure 1).
- B Press and release the Learn Code Button.
The Learn Indicator Light will blink about 2 times per second.
- C Press the Mini Transmitter Button once within 30 seconds.
The Learn Indicator Light will stay on — stops blinking.
- D Press the Mini Transmitter Button again.
The Learn Indicator Light will turn off.
The Transmitter Code is now stored in Receiver memory.

If the Mini Transmitter Button is not pressed a second time within 30 seconds (or if a different Code is sent) the Learn Indicator Light will begin blinking rapidly, then programming will stop. If programming stops, repeat Step 1 above.

- E Repeat Step 1 for each Transmitter to be used.

A total of 7 wireless devices may be programmed into Receiver memory at one time.

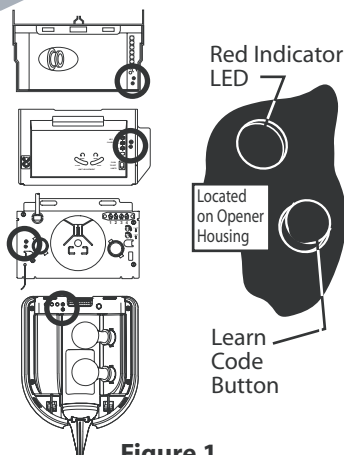

Figure 1

STEP 2: TRANSMITTER OPERATION

- A Point the Transmitter at the garage door and press gray button.
The door will move.
- B Press the button again.
The door stops.
- C Press the button again.
The door will move in the opposite direction.

The door automatically stops at fully open and fully closed positions.

- D To operate the Flashlight, press the logo button

STEP 3: ERASING ALL RECEIVER MEMORY

- A Locate the Learn Code Button and Indicator Light on the Power Head of your door operator. (Figure 1)
Press and hold the Learn Code Button for 10 seconds, or until the Indicator Light stops blinking and goes out.

All Transmitter Codes are erased from Receiver memory.

- B Reprogram the Receiver with the remaining Transmitter devices.
Follow Step 1.

STEP 4: BATTERY INSTALLATION (TRANSMITTER IS BATTERY POWERED)

- A Remove the Battery Compartment Cover. (Figure 2)
Remove the Battery Compartment Cover.
Slide the old battery out and discard.
- B Insert the new battery.
- C Clip Battery Compartment Cover in place.

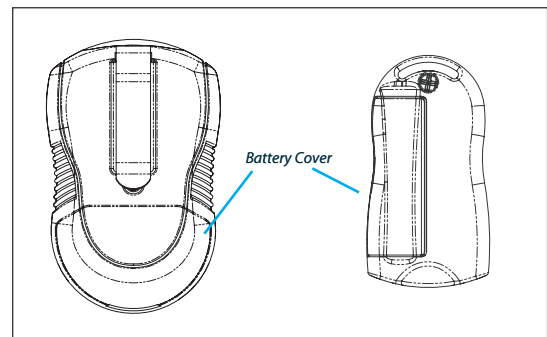

Figure 2

FCC and IC CERTIFIED

This device complies with FCC Part 15 and ASS 210 of industry Canada. Operation is subject to the following two conditions: (1) This device may not cause harmful interference, and (2) this device must accept any interference, including interference that may cause undesired operation of the device.

Changes or modifications not expressly approved by the manufacturer could void the user's authority to operate the equipment.

For additional information or help, see Owner's Manual or contact Customer Service: 1-800-35-GENIE. (To identify your local Distributor: 1-800-OK-GENIE)

Customer Service
22790 Lake Park Blvd.
Alliance, Ohio 44601
www.geniecompany.com