



# Setup and Features Information

## LATITUDE 10 - ST2

Language | Language | Language | Language

### About Warnings

**WARNING:** A WARNING indicates a potential for property damage, personal injury, or death.

### Views | Views | Views | Views | Views

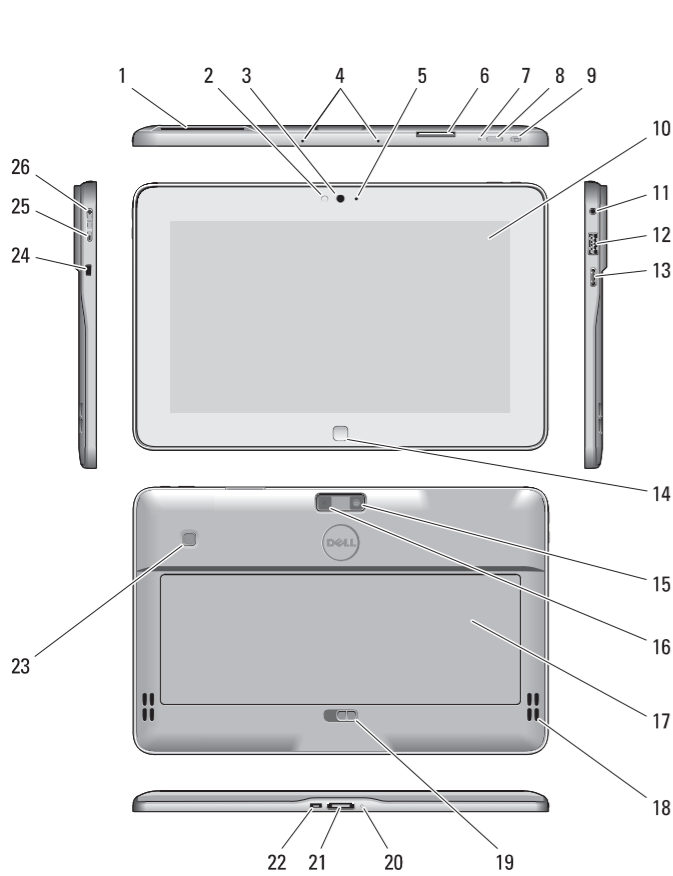

- 1 smart card reader (optional)
- 2 Ambient Light Sensor
- 3 front camera
- 4 microphones
- 5 camera LED
- 6 memory card reader
- 7 power LED
- 8 power button
- 9 screen rotation lock button
- 10 touch screen
- 11 audio connector
- 12 USB connector
- 13 mini HDMI connector
- 14 start button
- 15 back camera
- 16 camera Flash
- 17 battery
- 18 speakers
- 19 battery latch
- 20 battery status LED
- 21 dock/power connector
- 22 micro USB/power connector
- 23 finger print reader (optional)
- 24 security lock slot
- 25 volume decrease button
- 26 volume increase button

### Language

**LANGUAGE:** Language

### Language

**LANGUAGE:** Language

### Language

**LANGUAGE:** Language

### Language

**LANGUAGE:** Language

- 1 Language
- 2 Language
- 3 Language
- 4 Language
- 5 Language
- 6 Language
- 7 Language
- 8 Language
- 9 Language
- 10 Language
- 11 Language
- 12 Language
- 13 Language
- 14 Language
- 15 Language
- 16 Language
- 17 Language
- 18 Language
- 19 Language
- 20 Language
- 21 Language
- 22 Language
- 23 Language
- 24 Language
- 25 Language
- 26 Language

- 1 Language
- 2 Language
- 3 Language
- 4 Language
- 5 Language
- 6 Language
- 7 Language
- 8 Language
- 9 Language
- 10 Language
- 11 Language
- 12 Language
- 13 Language
- 14 Language
- 15 Language
- 16 Language
- 17 Language
- 18 Language
- 19 Language
- 20 Language
- 21 Language
- 22 Language
- 23 Language
- 24 Language
- 25 Language
- 26 Language

- 1 Language
- 2 Language
- 3 Language
- 4 Language
- 5 Language
- 6 Language
- 7 Language
- 8 Language
- 9 Language
- 10 Language
- 11 Language
- 12 Language
- 13 Language
- 14 Language
- 15 Language
- 16 Language
- 17 Language
- 18 Language
- 19 Language
- 20 Language
- 21 Language
- 22 Language
- 23 Language
- 24 Language
- 25 Language
- 26 Language

- 1 Language
- 2 Language
- 3 Language
- 4 Language
- 5 Language
- 6 Language
- 7 Language
- 8 Language
- 9 Language
- 10 Language
- 11 Language
- 12 Language
- 13 Language
- 14 Language
- 15 Language
- 16 Language
- 17 Language
- 18 Language
- 19 Language
- 20 Language
- 21 Language
- 22 Language
- 23 Language
- 24 Language
- 25 Language
- 26 Language

### Information para NOM (únicamente para México)

The following information provided on the device described in this document in compliance with the requirements of the official Mexican standards (NOM)

Voltaje de alimentación	100 V AC - 240 V AC
Frecuencia	50 - 60 Hz
Consumo eléctrico	1,00 A ~ 1,30 A
Voltaje de salida	19,0 V de CC / 19,5 V de CC
Intensidad de salida	1,58 A / 1,54 A

### Specifications

**NOTE:** Offerings may vary by region. The following specifications are only those required by law to ship with your computer. For more information regarding the configuration of your computer, click **Start** → **Help and Support** and select the option to view information about your computer.

Power	
Coin-cell battery	3 V CR2025 lithium ion
Input voltage	100-240 VAC
Output Power	30W
Physical	
Height	10.5mm
Width	274mm
Depth	176.6mm
(with security)	x
Weight (Minimum)	710 grams
Environmental	
Operating Temperature	0 °C to 35 °C (32 °F to 95 °F)

### Language

**LANGUAGE:** Offerings may vary by region. The following specifications are only those required by law to ship with your computer. For more information regarding the configuration of your computer, click **Start** → **Help and Support** and select the option to view information about your computer.

Power	
Coin-cell battery	x
Input voltage	x
Output Power	x
Physical	
Height (with a WLED panel)	x
Width	x
Depth	x
Weight (Minimum)	x
Environmental	
Operating Temperature	x

### Language

**LANGUAGE:** Offerings may vary by region. The following specifications are only those required by law to ship with your computer. For more information regarding the configuration of your computer, click **Start** → **Help and Support** and select the option to view information about your computer.

Power	
Coin-cell battery	x
Input voltage	x
Output Power	x
Physical	
Height (with a WLED panel)	x
Width	x
Depth	x
Weight (Minimum)	x
Environmental	
Operating Temperature	x

### Language

**LANGUAGE:** Offerings may vary by region. The following specifications are only those required by law to ship with your computer. For more information regarding the configuration of your computer, click **Start** → **Help and Support** and select the option to view information about your computer.

Power	
Coin-cell battery	x
Input voltage	x
Output Power	x
Physical	
Height (with a WLED panel)	x
Width	x
Depth	x
Weight (Minimum)	x
Environmental	
Operating Temperature	x

### Language

**LANGUAGE:** Offerings may vary by region. The following specifications are only those required by law to ship with your computer. For more information regarding the configuration of your computer, click **Start** → **Help and Support** and select the option to view information about your computer.

Power	
Coin-cell battery	x
Input voltage	x
Output Power	x
Physical	
Height (with a WLED panel)	x
Width	x
Depth	x
Weight (Minimum)	x
Environmental	
Operating Temperature	x

For Proof Only  
Dell Confidential  
OF79J2A00

1

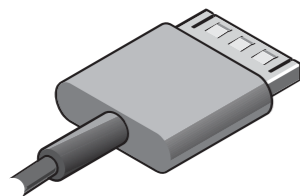

Connect the AC adapter to the AC adapter connector on the computer and to the electrical outlet.

Connect the AC adapter to the AC adapter connector on the computer and to the electrical outlet.

Connect the AC adapter to the AC adapter connector on the computer and to the electrical outlet.

Connect the AC adapter to the AC adapter connector on the computer and to the electrical outlet.

Connect the AC adapter to the AC adapter connector on the computer and to the electrical outlet.

2



Press the power button to turn on the computer.

Press the power button to turn on the computer.

Press the power button to turn on the computer.

Press the power button to turn on the computer.

Press the power button to turn on the computer.

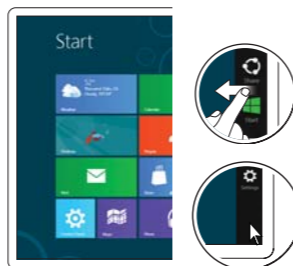

### Start screen

You can get to the Start screen by swiping in from the right edge of your screen and tapping the Start charm.

Or point mouse at lower or upper-right corner of the screen and then clicking the Start charm.

### Close App

If you're using a mouse, click the top of the app and drag it to the bottom of the screen. If you're using touch, drag the app to the bottom of the screen.

**NOTE:** When you're not using an app, Windows will leave it running in the background and then close it eventually.

### Shutdown

- Swipe in from the right edge of the screen, and then tap Settings. If you're using a mouse, point to the upper-right corner of the screen, move the mouse pointer down, and then click Settings.
- Tap or click Power, and then tap or click Shut down.

### Language

You can get to the Start screen by swiping in from the right edge of your screen and tapping the Start charm.

Or point mouse at lower or upper-right corner of the screen and then clicking the Start charm.

### Language

If you're using a mouse, click the top of the app and drag it to the bottom of the screen. If you're using touch, drag the app to the bottom of the screen.

**NOTE:** When you're not using an app, Windows will leave it running in the background and then close it eventually.

### Language

- Swipe in from the right edge of the screen, and then tap Settings. If you're using a mouse, point to the upper-right corner of the screen, move the mouse pointer down, and then click Settings.
- Tap or click Power, and then tap or click Shut down.

### Language

You can get to the Start screen by swiping in from the right edge of your screen and tapping the Start charm.

Or point mouse at lower or upper-right corner of the screen and then clicking the Start charm.

### Language

If you're using a mouse, click the top of the app and drag it to the bottom of the screen. If you're using touch, drag the app to the bottom of the screen.

**NOTE:** When you're not using an app, Windows will leave it running in the background and then close it eventually.

### Language

- Swipe in from the right edge of the screen, and then tap Settings. If you're using a mouse, point to the upper-right corner of the screen, move the mouse pointer down, and then click Settings.
- Tap or click Power, and then tap or click Shut down.

### Language

You can get to the Start screen by swiping in from the right edge of your screen and tapping the Start charm.

Or point mouse at lower or upper-right corner of the screen and then clicking the Start charm.

### Language

If you're using a mouse, click the top of the app and drag it to the bottom of the screen. If you're using touch, drag the app to the bottom of the screen.

**NOTE:** When you're not using an app, Windows will leave it running in the background and then close it eventually.

### Language

- Swipe in from the right edge of the screen, and then tap Settings. If you're using a mouse, point to the upper-right corner of the screen, move the mouse pointer down, and then click Settings.
- Tap or click Power, and then tap or click Shut down.

### Language

You can get to the Start screen by swiping in from the right edge of your screen and tapping the Start charm.

Or point mouse at lower or upper-right corner of the screen and then clicking the Start charm.

### Language

If you're using a mouse, click the top of the app and drag it to the bottom of the screen. If you're using touch, drag the app to the bottom of the screen.

**NOTE:** When you're not using an app, Windows will leave it running in the background and then close it eventually.

### Language

- Swipe in from the right edge of the screen, and then tap Settings. If you're using a mouse, point to the upper-right corner of the screen, move the mouse pointer down, and then click Settings.
- Tap or click Power, and then tap or click Shut down.

Information in this document is subject to change without notice.

© 2012 Dell Inc. All rights reserved.

Reproduction of these materials in any manner whatsoever without the written permission of Dell Inc. is strictly forbidden.

Information in this document is subject to change without notice.

© 2012 Dell Inc. All rights reserved.

Reproduction of these materials in any manner whatsoever without the written permission of Dell Inc. is strictly forbidden.

Information in this document is subject to change without notice.

© 2012 Dell Inc. All rights reserved.

Reproduction of these materials in any manner whatsoever without the written permission of Dell Inc. is strictly forbidden.

Information in this document is subject to change without notice.

© 2012 Dell Inc. All rights reserved.

Reproduction of these materials in any manner whatsoever without the written permission of Dell Inc. is strictly forbidden.

Information in this document is subject to change without notice.

© 2012 Dell Inc. All rights reserved.

Reproduction of these materials in any manner whatsoever without the written permission of Dell Inc. is strictly forbidden.

Regulatory Model Language Language Language Language	T05G
Regulatory Type Language Language Language Language	T05G001

## Finding More Information and Resources

See the safety and regulatory documents that shipped with your computer and the regulatory compliance website at [www.dell.com/regulatory\\_compliance](http://www.dell.com/regulatory_compliance) for more information on:

- Safety best practices
- Regulatory certification
- Ergonomics

See [www.dell.com](http://www.dell.com) for additional information on:

- Warranty
- Terms and Conditions (U.S. only)
- End User License Agreement

## Finding More Information and Resources

See the safety and regulatory documents that shipped with your computer and the regulatory compliance website at [www.dell.com/regulatory\\_compliance](http://www.dell.com/regulatory_compliance) for more information on:

- Safety best practices
- Regulatory certification
- Ergonomics

See [www.dell.com](http://www.dell.com) for additional information on:

- Warranty
- Terms and Conditions (U.S. only)
- End User License Agreement

## Finding More Information and Resources

See the safety and regulatory documents that shipped with your computer and the regulatory compliance website at [www.dell.com/regulatory\\_compliance](http://www.dell.com/regulatory_compliance) for more information on:

- Safety best practices
- Regulatory certification
- Ergonomics

See [www.dell.com](http://www.dell.com) for additional information on:

- Warranty
- Terms and Conditions (U.S. only)
- End User License Agreement

## Finding More Information and Resources

See the safety and regulatory documents that shipped with your computer and the regulatory compliance website at [www.dell.com/regulatory\\_compliance](http://www.dell.com/regulatory_compliance) for more information on:

- Safety best practices
- Regulatory certification
- Ergonomics

See [www.dell.com](http://www.dell.com) for additional information on:

- Warranty
- Terms and Conditions (U.S. only)
- End User License Agreement

## Finding More Information and Resources

See the safety and regulatory documents that shipped with your computer and the regulatory compliance website at [www.dell.com/regulatory\\_compliance](http://www.dell.com/regulatory_compliance) for more information on:

- Safety best practices
- Regulatory certification
- Ergonomics

See [www.dell.com](http://www.dell.com) for additional information on:

- Warranty
- Terms and Conditions (U.S. only)
- End User License Agreement

FCC warning statement :

This equipment has been tested and found to comply with the limits for a Class B digital device, pursuant to part 15 of the FCC rules. These limits are designed to provide reasonable protection against harmful interference in a residential installation. This equipment generates, uses and can radiate radio frequency energy and, if not installed and used in accordance with the instructions, may cause harmful interference to radio communications. However, there is no guarantee that interference will not occur in a particular installation. If this equipment does cause harmful interference to radio or television reception, which can be determined by turning the equipment off and on, the user is encouraged to try to correct the interference by one or more of the following measures:

- Reorient or relocate the receiving antenna.
- Increase the separation between the equipment and receiver.
- Connect the equipment into an outlet on a circuit different from that to which the receiver is connected.
- Consult the dealer or an experienced radio/TV technician for help.

FCC Caution :

This device complies with Part 15 of the FCC Rules. Operation is subject to the following two conditions:

- (1) this device may not cause harmful interference and
- (2) this device must accept any interference received, including interference that may cause undesired operation

The equipment complies with RF exposure limits set forth for an uncontrolled environment. The antenna(s) used for this transmitter must not be co-located or operating in conjunction with any other antenna or transmitter.

Vj g'f gxleg' hqt "qr gtcvkp"kp'vj g'dcpf "7372/7472"O J | "ku'qpn{ 'hqt 'kpf qqt'wug'vq'tgf weg'vj g'r qvgpvkrlhqt" j cto hwlkpvthgtgpeg'vq'eq/ej cppgr'o qdkrg'ucvgnkvg'u{ uvgo u0

You are cautioned that changes or modifications not expressly approved by the party responsible for compliance could void your authority to operate the equipment.

IC Caution: This device complies with Industry Canada licence exempt RSS standard(s). Operation is subject to the following two conditions: (1) this device may not cause interference, and (2) this device must accept any interference, including interference that may cause undesired operation of the device.

Cet appareil est conforme la norme d'Industrie Canada exempts de licence RSS (s). Son fonctionnement est soumis aux deux conditions suivantes: (1) cet appareil ne peut pas causer d'interférences, et (2) cet appareil doit accepter toute interférence, y compris les interférences qui peuvent causer un mauvais fonctionnement de l'appareil.

"

Vj g'gs wkr o gpv'eqo r nkgu'y kj "TH'gZR quwtg'iko ku'ugv'hqt vj 'hqt'cp'wpeqpv tqmgf "gpXkt qpo gpv0Vj g" cpvppc\*u+'wugf hqt 'vj ku'tcpuo kvgt'o wuv'pqv'dg'eq/mqecv'gf "qt"qr gtcvkpi 'kp'eqplwpevkqp'y kj 'cp{ 'qvj gt" cpvppc"qt'tcpuo kvgt0

"

N? s wkr go gpv'guv'eqplhqt o g'cwz 'iko kgu'f )gZr qukkqp'cwz 'tcf kqht<sup>2</sup> s wpegu<sup>2</sup> vcdnkgu'r qwt'wp'gpXkt qppgo gpv pqp'eqpv<sup>1/2</sup> z 0N)cpvppg '\*u+'wugf hqt 'eg'tcpuo gwgt'pg'f qk'r cu" vtg'eq/mqecrk<sup>2</sup> gu'qw'qr<sup>2</sup> tcpv'gp'eqplqpevkqp cxge'wpg'cwz g'cpvppg'qw'wp'cwz g<sup>2</sup> o gwgt0

Users should also be advised that

(i) the device for operation in the band 5150-5250 MHz is only for indoor use to reduce the potential for harmful interference to co-channel mobile satellite systems;

(ii) the maximum antenna gain permitted for devices in the bands 5250-5350 MHz and 5470-5725 MHz shall comply with the e.i.r.p. limit; and

(iii) the maximum antenna gain permitted for devices in the band 5725-5825 MHz shall comply with the e.i.r.p. limits specified for point-to-point and non point-to-point operation as appropriate.

High-power radars are allocated as primary users (i.e. priority users) of the bands 5250-5350 MHz and 5650-5850 MHz and that these radars could cause interference and/or damage to LE-LAN devices.

Les utilisateurs devraient aussi être avisés que

(i) les dispositifs fonctionnant dans la bande 5 150-5 250 MHz sont réservés uniquement pour une utilisation à l'intérieur afin de réduire les risques de brouillage préjudiciable aux systèmes de satellites mobiles utilisant les mêmes canaux;

(ii) le gain maximal d'antenne permis pour les dispositifs utilisant les bandes 5 250-5 350 MHz et 5 470-5 725 MHz doit se conformer à la limite de p.i.r.e.;

f]]L`Y`[ U]b`a UI`ja U`XDbhYbbY`dYfa`jg`fdci f`Yg`X]gdcg]hZg`i h`]gUbh`U`VUbXY` )`+&`!)` ,` &` `A`<nE`Xc]hgY` VtbZcfa`Yf`{` ``U`ja` ]hY`XY`d`]f`Y`"gd`fVZ]fY`dci f``BYI`d`c]h]cb`dc]bh`{` `dc]bhYh`bcb`dc]bh`{` `dc]bh`gY`cb`Y`Wlg` 8Y`d`i`gz`Yg`i`h`]gUHy` fg`XY`fUXUfg`XY`\\Ui`hY`di`jggUbW`gcbhXfg][`bfg`i`h`]gUHy` fg`df]bVdUi`I`fVW`{!`X`z`ei`D`g` cbh`U`df]cf]h`f`dci f`Yg`VUbXYg` )`&`\$!)` `` `)`\$`A`<n`Yh` `\*`\$!)` ,` `)`\$`A`<n`Yhei`Y`Wg`fUXUfg`dci`ffU]YbhWli`gYf` Xi` `Vfci` ]`U`[`Y`Yh`#ci` `XYg`Xca`a`U`[`Yg`Ui`I` `X]gdcg]hZg`@5B!`9@`

I`bXYf`-bXi`ghfm7UbUXU`fY`[`i` `Uh]cbgZ`h`]g`fUX]c`hfUbga` ]hYf`a`Umcb`mcdYfUHy`i`g]b[` `Ub`UbhYbbU`cZU`hmdY` UbX`a`UI`ja`i`a` `f`b`f`Y`ggY`f`L`[`U]b`Uddfcj`YX`Zc`f`h`Y`f`f`Ubga` ]hYf`Vm`-bXi`ghfm7UbUXU`"Hc`fYXi`W`dchYbh]U`fUX]c` ]bhYfZYfYbW`hc`ch`Yf`i`gYfgZ`h`Y`UbhYbbU`hmdY`UbX` ]hg`[`U]b`g`l`ci` `X`VY`gc`W`cgYb`h`Uh`h`Y`Yei`j`j`UYbh` ]gchfd]W`m`fUX]UHyX`dck`Yf`fY`"f`d`"L`]g`bcha`cY`h`Ub`h`Uh`b`YW`ggUfmZc`f`gi`WV`ggZ` `Vta`a`i`b]W]h]cb`" 9b`j`Yfhi` `XY`U`f`f`[` `Ya`Yb]Uh]cb`XY`"f`bXi`ghf]Y`Xi` `7UbUXUz`W`h`fa`YhYi`f`XY`fUX]c`bY`dYi`j`YbhZcbW]cbYf`Yb` i`h`]gUbhi`bY`UbhYbbY`Xfi`b`hmdY`Yha`UI`ja`i`a` `f`ci` `a`c]bgL` ;`U]b`Uddfcj`j`f`dci`f`f`fa`YhYi`f`dUf`-bXi`ghf]Y` 7UbUXU`"dci`f`f`f`Xi` ]fY`f]gei`Y`Xfi`bhYfZf`fYbW`Ui`I`Ui`hYg`i`h`]gUHy`fgZ`Y`hmdY`Xfi`UbhYbbY`Yhgcb`[`U]b`Xc]j`Ybh` ..fY`W`c]g]g`XY`gc`f`h`ei`Y`U`di`jggUbW`]gchfdY`fUmcbbfY`fei`j`U`YbhY`fD`-F`9L`bY`XfdUggY`dUg`W`ei` ]`Yghi` bfW`ggU]fY`dci`f`U`f`fi`gg]hY`XY`Vta`a`i`b]W]h]cb`"

## ▶ **RF Exposure Information (SAR)**

This device meets the government's requirements for exposure to radio waves.

This device is designed and manufactured not to exceed the emission limits for exposure to radio frequency (RF) energy set by the Federal Communications Commission of the U.S. Government.

The exposure standard for wireless devices employs a unit of measurement known as the Specific Absorption Rate, or SAR. The SAR limit set by the FCC is 1.6W/kg.

\*Tests for SAR are conducted using standard operating positions accepted by the FCC with the device transmitting at its highest certified power level in all tested frequency bands. Although the SAR is determined at the highest certified power level, the actual SAR level of the device while operating can be well below the maximum value. This is because the device is designed to operate at multiple power levels so as to use only the power required to reach the network. In general, the closer you are to a wireless base station antenna, the lower the power output.

For next-to-body operation, this device has been tested and meets the FCC exposure guidelines. SAR is measured with the device directly contacted to the body, while transmitting at the highest certified output power level in all frequency bands of the mobile device.

While there may be differences between the SAR levels of various devices and at various positions, they all meet the government requirement.

The FCC has granted an Equipment Authorization for this device with all reported SAR levels evaluated as in compliance with the FCC RF exposure guidelines.

### **IMPORTANT NOTE:**

#### **IC Radiation Exposure Statement**

This EUT is compliance with SAR for general population/uncontrolled exposure limits in IC RSS-102 and had been tested in accordance with the measurement methods and procedures specified in IEEE 1528.