

**Photos taking/ Video recording**

Press the photo taking button to take photo through the camera on the helicopter. The indicator on the transmitter will flash when a photo is taken.  
Press the video recording button to start recording video. Press the button again to stop recording. The indicator on the transmitter will turn on during recording. When the memory card is full, the status indicator flashes continuously. Move/remove the saved data from the Micro SD card before taking photos again. (Micro SD card is not included)

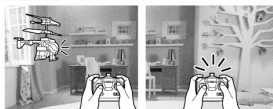

**\*Camera Mode:**

When the helicopter is stored inside the remote and both power switches turned on, red LED light from helicopter can be seen on the Transmitter (show hole on Transmitter). Light will be off after 3 minutes (sleep mode).  
Press photo or video button on remote to wake up the helicopter, a photo or video will then be taken. (LED from remote shows activity: 1sec > photo, long light > video, blinking > error)

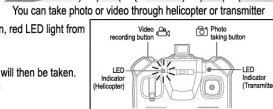

**Transferring files to computer**

**To store photos and videos**

1. Be sure your helicopter has been switched OFF. Connect the helicopter to the computer through the USB cable. Double click the "Removable Disk (F:)" in the computer

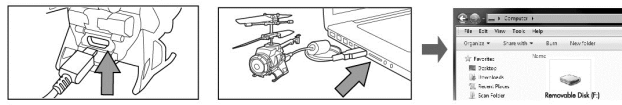

2. Enter the camera folder to review the files. Copy the images or videos to your computer.

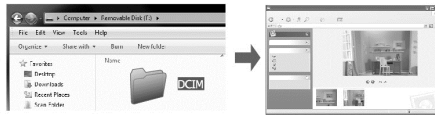

**NOTE: For Mac OS, user can transfer the photos or videos to computer through iPhoto.**

**Inserting and removing the MicroSD card**

1. Lift up the cover.
2. Insert the MicroSD card (not included) with the gold-colored contacts facing up.
3. For removing the MicroSD card, pull the MicroSD card out from the slot.

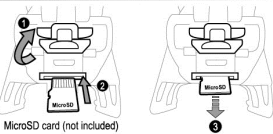

**Note: MicroSD card (not included), up to 32GB**

**Troubleshooting**

Symptom	Cause	Correction
The helicopter does not respond.	- The helicopter and/or the transmitter is switched off ("OFF"). - The battery of the helicopter is weak.	- Set the power switch to "ON". - Recharge the battery of the helicopter.
The video photo was not recorded.	- The battery of the helicopter is weak. - The memory card is full.	- Recharge the battery of the helicopter. - Move/remove some photos/videos.
The helicopter does not react, or react poorly to operation by transmitter.	- PAIRING / SYNC Procedure is not yet completed or done.	- Reset by switch off both helicopter and transmitter then switch both on again.
Loss of control.	- Out of the control range of distance.	- The transmission range is up to 20 meters in open space.

**Spy Cam Nano™**

Become our fan on facebook [facebook.com/SilverlitToys](https://www.facebook.com/SilverlitToys) Visit us at [www.Silverlit.com](http://www.Silverlit.com)

**SPYCAM NANO**

For Ages 15+  
Ab 15 Jahre  
Pour 15 ans et plus  
Moore leeftijd 15+  
Para 15 años  
Dai 15 anni in su

This product is in compliance with the essential requirements and other relevant provisions of Directive 1999/5/EC.



**Delivery contents**

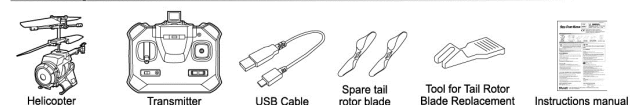

**Precautions, Warnings & Statements**

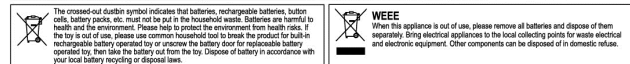

**Safety precautions:**  
Warning: Connection or modifications to this product not expressly approved by the party responsible for compliance could void the user's authority to operate the product.  
- The transmitter charger is also made for the LiPo rechargeable battery used in helicopter. Do not use it to charge any battery other than that of the helicopter.  
- Always remove batteries from the product when it is not being used for a long period of time. (Transmitter only)  
- Regularly examine for damage to the plug, enclosure and other parts. In the event of any damage, the product must not be used with the transmitter charger until the damage has been repaired.  
- Wipe the product gently with a clean cloth.  
- Do not expose the product away from direct heat.  
- Do not submerge the product into water that can damage the electronic assemblies.

**Care and Maintenance:**  
- Please read the operation instructions carefully prior to the first use.  
**Notes:**  
- New alkaline batteries are recommended to use in this product to obtain best and maximum performance.  
- This product must only be used with the recommended charger.  
**Battery warnings:**  
- Non-rechargeable batteries are not to be recharged.  
- Rechargeable batteries are not to be removed before being charged. (Transmitter only)  
- Different types of batteries or new and used batteries are not to be mixed. (Transmitter only)  
- Only batteries of the same or equivalent type are recommended to be used.  
- Batteries are to be inserted with correct polarity.  
- Exhausted batteries are to be removed from the product. (Transmitter only)  
- The supply terminals are to be short-circuited.  
- Do not mix old and new batteries. (Transmitter only)  
- Do not mix alkaline, standard (carbon-zinc) or rechargeable (nickel-cadmium) batteries. (Transmitter only)  
**This helicopter is equipped with a LiPo rechargeable battery, please pay attention to the following cautions for safety use:**  
- Do not dispose the battery in fire or heat.  
- Do not expose the battery to heat. A heat source may be a heat source such as fire or heater.  
- Do not stoke or throw the battery against hard surface.  
- Do not immerse the battery in water, and keep the battery in a cool dry environment.  
- When recharging, only use the battery charger specifically for that purpose.  
- Do not overcharge the battery.  
- Do not connect the battery to an electrical outlet.  
- Do not directly solder the battery and pierce the battery with a nail or other sharp object.  
- Do not disassemble or alter the battery.  
- Charge the battery every 6 months.  
- Do not directly solder the battery and pierce the battery with metal objects such as needles, hairpins etc.  
- As for a used battery, please recycle after covering the battery terminals with insulation tape or treating it as an individual waste.  
- Battery inside the product is not replaceable.

**Special notes:**  
- Please read the operation instructions carefully prior to the first use.

**FCC Statements**  
This device complies with part 15 of the FCC rules. Operation is subject to the following two conditions:  
1) This device may not cause harmful interference, and  
2) This device must accept any interference received, including interference that may cause undesired operation.  
**NOTE:** This equipment has been tested and found to comply with the limits for a Class B digital device, pursuant to Part 15 of the FCC Rules. These limits are designed to provide reasonable protection against harmful interference in a residential installation. However, there is no guarantee that interference will not occur in a particular installation. If this equipment does cause harmful interference to radio or television reception, which can be determined by turning the equipment off and on, the user is encouraged:  
- To reorient or relocate the receiving antenna.  
- To increase the separation between the equipment and receiver.  
- To connect the equipment into an outlet on a circuit different from that to which the receiver is connected.  
- Consult the dealer or an experienced radio/TV technician for help.

**Tip! Safety hints**

- Never take apart or attempt to modify the product. This could damage the product.
- Helicopter flying requires specific skills and should be learned under direct supervision of an experienced adult.
- Never operate this product if it has damaged parts.
- Attention! Do not fly the helicopter near persons and animals.
- Do not fly the helicopter in the vicinity of water and power lines.
- Always keep your eyes on the helicopter and prevent it from landing or crashing near your head, your body, or other people.
- Stand during operation in order to get out of the way of the helicopter quickly if necessary.
- Always switch the helicopter and the transmitter off when not operating.
- Warning! Do not touch the running rotors. Keep hands, hair and loose clothes away from moving parts to avoid injury.
- Never hold or throw any objects into the running rotors.
- Attention! Risk of eye injury! Keep a safety distance of at least 1 meter.
- Keep this instruction manual for future reference.

**The normal function of the product may be disturbed by Strong Electro Magnetic Interference. If so, simply reset the product to resume normal operation by following the instruction manual. In case the function could not resume, please use the product in other location.**

**For updated photo & video function of the plane may be disturbed by Strong Electro Magnetic Interference. If so, the plane need to do the steps again to re-connect to the PC. In case the function could not resume, please use the product in other location.**

**Battery requirements transmitter:**  
Power supply : DC 3.7V, 0.3W  
Battery range : 4 x 1.5 V "AAA"/LR03/AM4 (not included)  
Capacity : 120 mAh

**Battery requirements helicopter:**  
Power supply : DC 3.7V, 4.5W  
Battery range : 1 x 3.7 V Li-Po Rechargeable Battery Pack (included)  
Capacity : 120 mAh

**Silverlit®** Silverlit SAS, 80 rue Barthélemy Danjou, 92100 Boulogne-Billancourt / France. © 2015 Silverlit. All rights reserved.

**Part Identification**

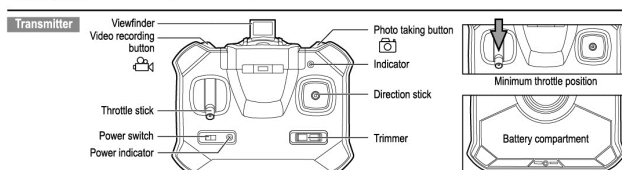
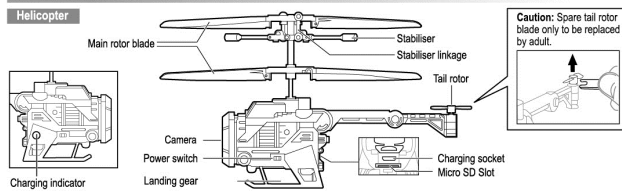

**Battery Installation & Charging the Helicopter**

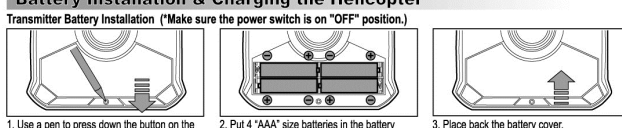

1. Use a pen to press down the button on the transmitter, and then follow the arrow direction to push out the battery cover.  
2. Put 4 "AAA" size batteries in the battery compartment as per the polarity shown inside.  
3. Place back the battery cover.

**Note: The transmitter receives a signal from the helicopter when the battery is low. When the Indicator on the transmitter starts blinking, recharge the helicopter.**

**Charging the Helicopter**  
1. Connect the USB recharge cable to a USB socket. Make sure the computer is turned on. Switch off the helicopter. Insert the charging plug into the charging socket on the helicopter.  
2. The charging process will begin automatically and the charging indicators will light up. Unplug the charging plug after the charging indicator turn off, charging is completed.  
**Note:** 1. The helicopter can operate up to 4 minutes per every 20 - 35 minutes charging.  
2. Before recharging the battery, wait 10 - 15 minutes for it to cool down.

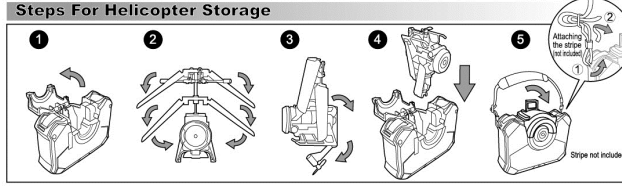

**Tip! Piloting hints**

- For controlling the sticks on transmitter, try not to push the sticks immediately any extreme positions. It should be like steering a bicycle rather than pressing computer game sticks.
- For the novice pilot (after the trimming procedure is completed), it is highly recommended to focus exclusively on learning to control the throttle stick first. If the helicopter turns around by itself, it is important to learn to keep the helicopter at a constant altitude of around 1 meter with very gentle inputs on the throttle stick. Once the pilot masters this, he may start learning to take control with the direction stick.

**Flying Your Helicopter**

**1. Procedure for PAIR / SYNC the Helicopter and Transmitter**  
2.4 GHz technology allows for many helicopters to fly without signal interference. A connection, or pairing, must be made between the helicopter and the transmitter to function. Sometimes, the pairing will happen automatically. If it does not, or if the connection is lost then follow these steps to sync the helicopter and the transmitter.  
1.1 Place the helicopter on the ground with the tail point towards you and the nose pointing away. Make sure the throttle stick is at the minimum position.  
1.2 Turn the Power Switch button to "ON" position both on the Helicopter and Transmitter. Red LED will then flash.  
1.3 The Synchronize/Pairing procedure is automatically COMPLETED when you can see the Red LED light up solid (not blinking) on both Helicopter and transmitter.

**2. Flight environment**  
Choose the place which meets the following condition:  
1. Indoor environment with calm air. Beware of the air circulation from the air-conditioner.  
2. Caution: There must not be any dangerous objects (electric fan, air-conditioner, reading lamp, etc) on the flight path.

**3. Trimming the helicopter:**  
- Gently push the throttle up to raise your helicopter about 0.5 to 1 meter high.

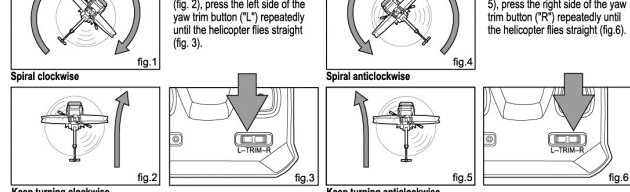

**4. Flight control:**  
**Hover up and down:**  
When the helicopter flies steadily, you can slowly push the throttle stick up to make helicopter fly higher, or lower the stick a bit to make helicopter fly lower. Only small amounts of stick position change are required for smooth flying.

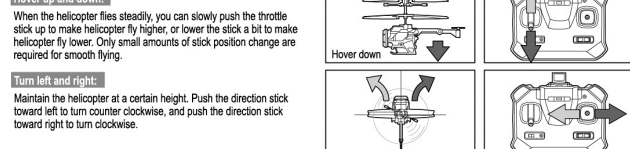

**Turn left and right:**  
Maintain the helicopter at a certain height. Push the direction stick toward left to turn counter clockwise, and push the direction stick toward right to turn clockwise.



**5. Lift-off procedures (after trimming procedure):**  
- Put the helicopter on a smooth surface. Uneven floor surface will affect its lifting off.  
- Slowly increase the throttle.  
- Do not look at the transmitter but focus on the helicopter.  
- As soon as the helicopter leaves ground, reduce the throttle slightly. (In the worst case, helicopter will go back to the floor but that is better than crashing against the ceiling.)  
- Very gently increase the throttle if the helicopter descends.  
- Very gently reduce the throttle if the helicopter ascends.  
- For turning, give short and small inputs to the direction stick. (Most beginners will easily overcontrol the helicopter.)

