

4 ENGLISH

Replacement of propeller

1. Take out the broken or spoiled propeller as photo shown.
2. Check the direction of propeller before replacing a new one.

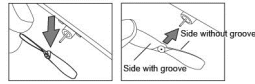
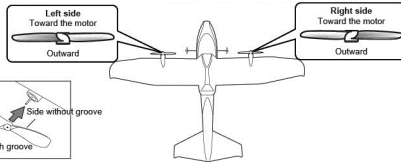

Photos taking / Video recording

Press the photographing button to take photo through the camera on the Aeroplane. The status indicator will flash when a photo is taken. Press the video recording button to start recording video. Press the button again to stop recording. The status indicator will turn on during recording. When the memory card is full, the status indicator flashes continuously. Move the saved data from the internal memory before taking photos again.

Transferring files to computer

Opening stored photos and videos

1. Be sure your Aeroplane has been switched OFF. Remove MicroSD card from aeroplane. Insert it into adaptor and then connect A pop-up window will appear.

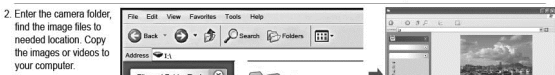
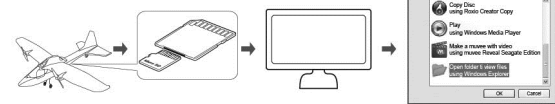

Inserting and removing the MicroSD

1. Open the cover.
2. Insert the MicroSD card (not included) with the gold-colored contacts facing up.
3. Push gently the card until the card disengages from the Aeroplane, and then pull it out of the slot.

Note: Memory card slot : MicroSD card (not included), up to 32GB

Troubleshooting

Symptom	Cause	Correction
The Aeroplane does not response.	- The Aeroplane and/or the transmitter is switch of "OFF". - The battery of the Aeroplane is weak.	- Set the power switch to "ON". - Recharge the battery of the Aeroplane.
The video photo was not recorded.	- The battery of the Aeroplane is weak.	- Recharge the battery of the Aeroplane.
The status indicator flashes continuously.	- The memory card is full.	- Move remove some photos/videos.

2 ENGLISH

Part Identification

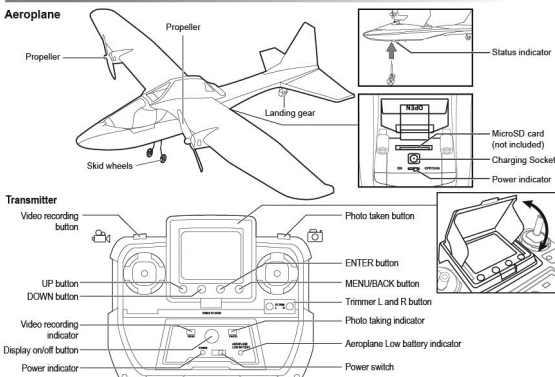

Battery Installation and Charging

Transmitter Battery Installation ("Make sure the power switch is on "OFF" position.)

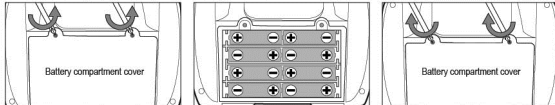

Note: When the Power indicator on the transmitter starts blinking (fast), replace the batteries. The transmitter receives a signal from the Aeroplane when the battery is low. The Charging indicator indicator on the transmitter starts blinking, recharge the Aeroplane.

Charging Aeroplane

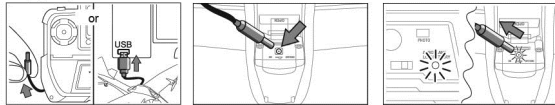

Note: 1. The Aeroplane can operate for about 4 - 5 minutes per every 40 - 50 minutes charging. 2. Before recharging the battery, wait 10 - 15 minutes for it to cool down.

Peregrine Eye RTV

Age classification: not suitable for children under 8 years of age  
 Attention: Ne convient pas aux enfants de moins de 8 ans  
 Categories: Catégorie de jouet: ne convient pas aux enfants de moins de 8 ans  
 Attention: No suitable for children under 8 years  
 Classification de jouet: Ce jouet n'est pas adapté aux enfants de moins de 8 ans  
 Et non jouet, non adatto bambini di età inferiore a 8 anni

ENGLISH 1  
 E3-4109  
 Instruction Manual  
 For ages 10+  
 Ab 10 Jahre  
 A partir de 10 ans  
 Leetväät 10-vuotia  
 A partir de 10 años  
 Da 10 anni in su  
**WARNING!**  
**CHOKING HAZARD - Small Parts.**  
 Not for children under 3 years.

Delivery contents

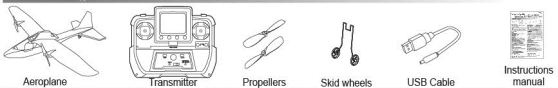

Safety precautions

This product is in compliance with the essential requirements and other relevant provisions of Directive 1999/5/EC.  
 Do not use it to charge any other batteries.

The crossed-out dustbin symbol indicates that batteries, rechargeable batteries, button cells, battery packs, etc. must not be put in the household waste. Batteries are harmful to health and the environment. Please help to protect the environment from health risks. Tell your children to dispose of batteries properly by taking them to the local collecting points. This way batteries are recycled safely.

Special notes to adults:  
 - Only operate the toy outdoors under adult supervision.  
 - Parental guidance is recommended when installing or replacing batteries.

Care and Maintenance:  
 - Always remove batteries from the toy when it is not being used for a long period of time. (Transmitter and/or Receiver)  
 - Wipe the toy gently with a clean cloth.  
 - Keep the toy away from direct heat.  
 - Do not submerge the toy into water that can damage the electronic assemblies.

Battery warnings:  
 - Non-rechargeable batteries are not to be recharged.  
 - Rechargeable batteries are not to be removed before being charged. (Transmitter only)  
 - Different types of batteries or new and used batteries are not to be mixed. (Transmitter only)  
 - Only batteries of the same or equivalent type as recommended are to be used.  
 - Batteries are to be inserted with correct polarity.  
 - Charged batteries are not to be removed from the toy. (Transmitter only)  
 - The supply terminals are not to be short-circuited.  
 - Do not mix old and new batteries. (Transmitter only)  
 - Do not mix alkaline, standard (carbon-zinc) or rechargeable (nickel-cadmium) batteries. (Transmitter only)

This toy is equipped with a LiPo rechargeable battery, please pay attention to the following cautions for safety use:  
 - Do not expose the battery in fire or heat.  
 - Do not use or expose the battery near a heat source such as fire or heater.  
 - Do not strike or throw the battery against hard surface.  
 - Do not disassemble the battery in water, and keep the battery in a cool dry environment.  
 - When recharging, only use the battery charger specifically for that purpose.  
 - Do not connect the battery to an electrical outlet.  
 - Do not directly solder the battery and pierce the battery with a nail or other sharp object.  
 - Do not transport or store the battery together with metal objects such as needles, hairpins, etc.  
 - Do not use the battery after the battery has been damaged.  
 - Charge the battery every 6 months.

Notes:  
 - The toy may malfunction under electrostatic discharge interference. If the toy does not respond, reset it.  
 - This toy may contain batteries in this toy to obtain best performance.  
 - This toy must only be used with the recommended charger.

For glued photo & video function of the plane may be disturbed by Strong Electro Magnetic Interference. If so, simply the plane need to be the steps again to re-connected to the PC. In case the function could not resume, please use the product in other location.

FCC Statements  
 This device complies with part 15 of the FCC rules. Operation is subject to the following two conditions:  
 1) This device may not cause harmful interference, and  
 2) This device must accept any interference received, including interference that may cause undesired operation.  
 NOTE: This equipment has been tested and found to comply with the limits for a Class B digital device, pursuant to part 15 of FCC rules. These limits are designed to provide reasonable protection against harmful interference in a residential installation. This equipment operates, uses and can radiate radio frequency energy and, if not installed and used in accordance with the instructions, may cause harmful interference to radio communications.  
 However, there is no guarantee that interference will not occur in a particular installation. If the equipment does cause harmful interference to radio or television reception, which can be determined by turning the equipment off and on, the user is encouraged to try to correct the interference by one or more of the following measures:  
 - Reorient or relocate the receiving antenna.  
 - Increase the separation between the equipment and receiver.  
 - Connect the equipment into an outlet on a circuit different from that to which the receiver is connected.  
 - Consult the dealer or an experienced radio/TV technician for help.

Waste Electrical and Electronic Equipment (WEEE)  
 When this appliance is out of use, please remove all batteries and dispose of them separately. Bring electrical appliances to the local collecting points for waste electrical and electronic equipment. Other components can be disposed of in domestic refuse.

TP1 Safety hints  
 Never operate the product if it has damaged parts.  
 Do not fly the Aeroplane in the vicinity of water and power lines.  
 Stand during operation in order to get out of the way of the Aeroplane quickly if necessary.  
 - Always switch the Aeroplane and the transmitter off when not operating.  
 - Keep the instructions for use for safe reference!  
 - Before first use: read the user's information together with your child.  
 - Operations and safe use must be explained clearly (preferably by graphical instructions).  
 - Flying the Aeroplane requires skill and children must be trained under the direct supervision of an adult.  
 - For toys intended to be assembled by the child: Check if the toy is assembled as instructed. The assembly shall be performed under the supervision of an adult.  
 - Hands, hair and loose clothes shall be kept away from the propeller (rotor).  
 - Do not change or modify anything on the Aeroplane!  
 - For safe use, the room where the toy is used must sufficiently large. The room must be free from obstacles (such as lamps, loose objects, etc.).  
 - This toy is intended to be used in domestic areas (house and garden) only.  
 - Caution! The Aeroplane should not be started when persons, animals or any objects are within the flying range of the Aeroplane.  
 - Do not throw or hold any objects in the rotating rotor.  
 - Caution: Risk of eye injury! Do not fly near your face to avoid injuries.

Battery requirement (Aeroplane):  
 Power Supply : DC 3.7 V, 9 V  
 Rating : 1.3 x 1.5 V LiPo Rechargeable Battery Pack (included)  
 Batteries : 250 mAh  
 Capacity : Silverlit®  
 Silverlit SAS, Espace Green Parc, Route de Villepêde, 91280 Saint Pierre du Peray / France.  
 ©2012 Silverlit. All rights reserved.

Procedure for PAIR / SYNC the Aeroplane and Transmitter

- 2.4 GHz technology allows for many aeroplanes to fly without signal interference. A connection, or pairing, must then be made between the aeroplane and the transmitter to function. Sometimes, the pairing will happen automatically. If it does not, or if the connection is lost, then follow these steps to sync the Aeroplane and Transmitter.
1. Make sure the throttle stick is at the minimum position.
2. Turn the Power Switch button to 'ON' position both on the Aeroplane and Transmitter. Red LED will then flash.
3. The Synchronizing/Pairing procedure is automatically COMPLETED when you can see the Red LED light up solid (not blinking) on both Aeroplane and Transmitter.

Flying Instructions

1. Set the trim dial to the central position.
2. Point the plane toward the wind blowing direction and throw it out horizontally. Immediately afterwards, push the throttle stick up to the full speed.
3. If the plane turns left involuntarily, turn the trim dial to the right until the Aeroplane flies straight. Likewise, if the plane turns right involuntarily, turn the trim dial to the left.
4. Push the direction stick toward left to turn the plane anticlockwise, and push the direction stick toward right to turn it clockwise. The plane turns depending on the speed difference between the left propellers and the right propellers.
5. Push the throttle stick up to increase the flying speed and push the throttle stick down to decrease the speed.

Throttle stick	Direction stick	Movement
↑	→	Take off or ascending
↓	→	Landing or descending
↔	↶	Turn left
↔	↷	Turn right

6. Pull the throttle stick down slowly to stop the propellers and land the plane.
7. If the plane has been spoiled a little, you can fix it with adhesive tape.

Flying tips

Playing environment and weather:  
 Outdoors: on a sunny day with calm air or slight breeze. Never fly the plane on a windy day. It is recommended to fly the plane over a soft surface, e.g. grass field.  
 Do not fly the plane when it is raining, snowing or near high power cables.

Taking off

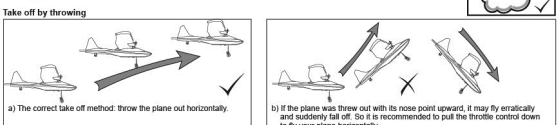

Tips: Always pointing your plane with the nose facing to the wind.

ENGLISH 3