

3. FLIGHT CONTROL

8045596 Sky Fury 2.4GHz R/C Helicopter Manufactured in China Imported by The Source www.thesource.ca Barrie, Ontario, Canada, L4M 4W5 06A16

Hover up and down:

When the helicopter flies steadily, slowly push the throttle stick up to make helicopter fly higher, or lower the stick a bit to make helicopter fly lower. Only small amounts of stick position change are required for smooth flying. (fig. 10 & fig. 11)

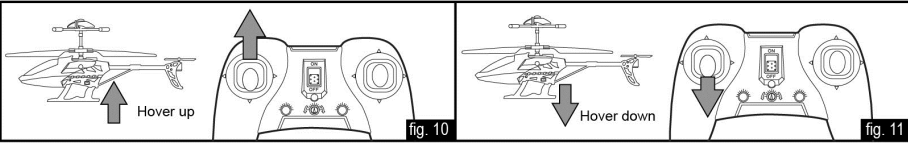

Turn counter clockwise and clockwise:

Maintain the helicopter at a certain height. Push the direction stick toward left to turn the helicopter anticlockwise, and push the direction stick toward right to turn it clockwise. (fig. 12 & fig. 13)

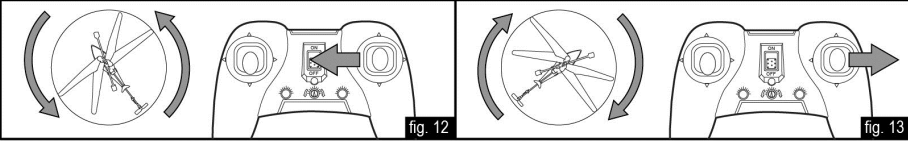

Fly forward and backward:

Maintain the helicopter at a certain height. Push the direction stick upward to fly the helicopter forward. Push it downward to fly the helicopter backward. (fig. 14 & fig. 15)

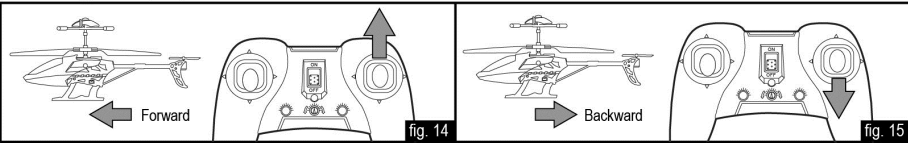

4. LIFT-OFF PROCEDURE LIFT-OFF PROCEDURE (after Trimming procedure):

- Put the helicopter on a smooth surface. Uneven floor surface will affect its lifting off.
- Slowly increase the throttle.
- DO NOT look at the transmitter but focus on the helicopter.
- As soon as the helicopter leaves ground, reduce the throttle slightly.
- Very gently increase the throttle if the helicopter descends.
- Very gently reduce the throttle if the helicopter ascends.
- For turning, give short and small inputs to the direction stick.



Troubleshooting

Table with 3 columns: Symptom, Cause, Correction. Includes issues like Propeller can't move, Power indicator on transmitter blinking, Suddenly stop and drop down when flying, Loss of control.



Become our fan on facebook facebook.com/SilverlitToys

Visit us at: www.Silverlit.com

Parts Identification

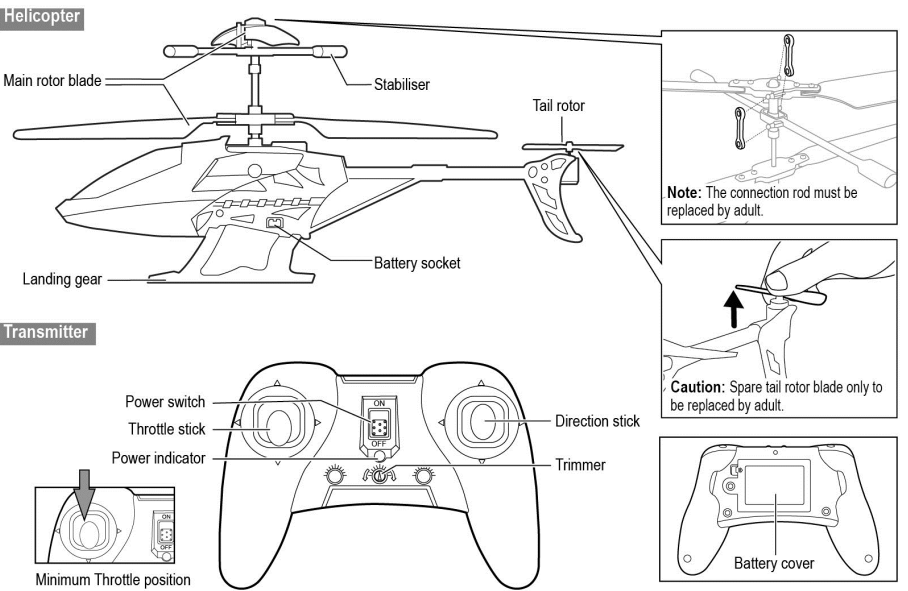

Battery Installation & Charging

Transmitter Battery Installation ("Make sure the power switch is on "OFF" position.)

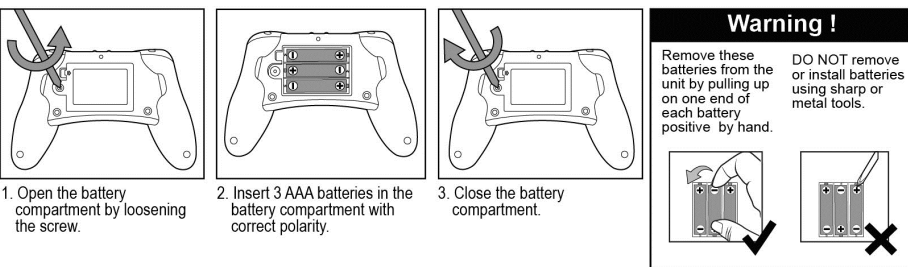

Note: When the LED indicator on the transmitter starts blinking, replace the batteries.

Charging Helicopter

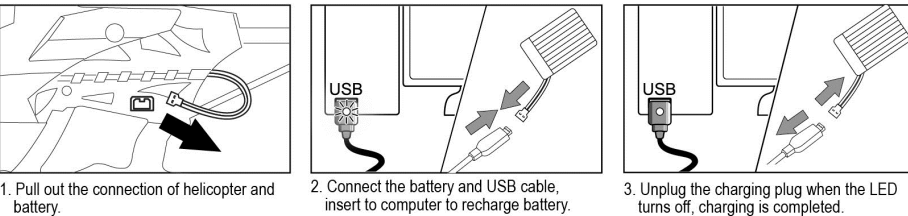

Note: 1. The helicopter can operate for about 5 - 6 minutes per every 50 - 60 minutes charging. 2. Before recharging the battery, wait 10 - 15 minutes for it to cool down.



Delivery contents

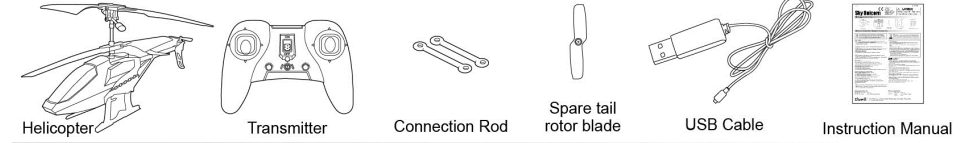

Precautions, Warning & Statement

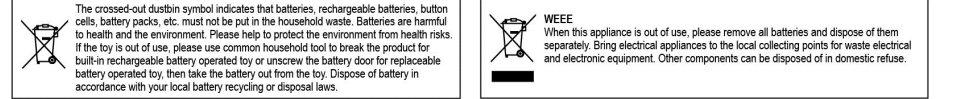

Safety Precautions: Warning: Conversion or modifications to this product not expressly approved by the party responsible for compliance could void the user's authority to operate the product.

Care and Maintenance: - Always remove batteries from the product when it is not being used for a long period of time. (Transmitter only) - Regularly examine for damage to the plug, enclosure and other parts.

Battery Warnings: - Non-rechargeable batteries are not to be recharged. - Rechargeable batteries are not to be removed before being charged. (Transmitter only)

Helicopter is equipped with a LiPo rechargeable battery, please pay attention to the following cautions for safety use:

- Do not dispose the battery in fire or heat.
- Do not use or leave the battery near a heat source such as fire or heater.
- Do not strike or throw the battery against hard surface.
- Do not immerse the battery in water, and keep the battery in a cool dry environment.

Note: - Under the environment with electrostatic discharge, the product may malfunction and require user to reset the product.

FCC Statements: This device complies with part 15 of the FCC rules. Operation is subject to the following two conditions: 1) This device may not cause harmful interference, and 2) This device must accept any interference received, including interference that may cause undesired operation.

- Tip! SAFETY - Do not change or modify anything on the helicopter. - Helicopter piloting requires specific skills and should be learned under direct supervision of an experienced adult.

Special Note: - Please read the operating instructions carefully prior to the first use. - Only operate the product indoor.

The normal function of the product may be disturbed by Strong Electro Magnetic Interference. If so, simply reset the product to resume normal operation by following the instruction manual.

RSS-210 OF INDUSTRY CANADA STANDARD Under Industry Canada regulations, this radio transmitter may only operate using an antenna of a type and maximum (or lesser) gain approved for the transmitter by Industry Canada.

Battery requirements (Transmitter): Power Supply: 4.5 V DC; 0.48 W Rating: 3 x 1.5 V AAA/LR03/AM4 (not included) Batteries: 3 x 1.5 V AAA/LR03/AM4 (not included)

Battery requirements (Helicopter): Power Supply: 3.7 V DC; 10 W Rating: 1 x 3.7 V LiPo battery (included) Capacity: 300 mAh

Silverlit SLT (USA) Inc. 21660 East Copley Drive, Suite 220 Diamond Bar, CA, 91765, U.S.A. Tel: (877) 502-8697 ©2016 Silverlit. All rights reserved. Visit us at: www.silverlit.com

Flying Your Helicopter

Tip! CONTROLLING

- For controlling the sticks on transmitter, try not to push the sticks immediately any extreme positions. It should be like steering a bicycle rather than pressing computer game sticks.
- For the novice pilot (after the trimming procedure is completed), it is highly recommended to focus exclusively on learning to control the throttle stick first.

Procedure for PAIR / SYNC the helicopter and transmitter

2.4 GHz technology allows for many helicopter to fly without signal interference. A connection, PAIR / SYNC, must be made between the helicopter and the transmitter to function. Follow these steps to PAIR/SYNC the helicopter and the transmitter.

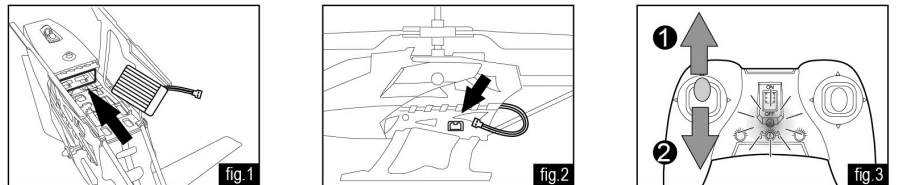

- Place the battery into helicopter (fig. 1). Connect the battery with the power line (fig. 2), and the LED lights on the helicopter will light up. Then place it on the ground.
- Pull the throttle stick of the transmitter to the lowest position. Switch on the transmitter and push the throttle stick to top then pull down to bottom (fig. 3). The power indicator on transmitter will turn light up. The pair procedure is completed.

1. ENVIRONMENT FOR FLIGHT:

- Choose the place which meet the following condition:
1. Indoor environment with calm air condition. Beware of the air circulation from the air-conditioner.
2. Safety area: It is highly recommended that there is no electric fan, air-conditioner, reading lamp or other dangerous objects to flying.

2. TRIMMING THE HELICOPTER:

- Gently push the throttle up to raise your helicopter about 0.5 to 1 meter high.
- When the helicopter spirals (fig. 4) or keeps turning clockwise (fig. 5), turn the yaw-trim dial to the left until the helicopter flies straight (fig. 6).

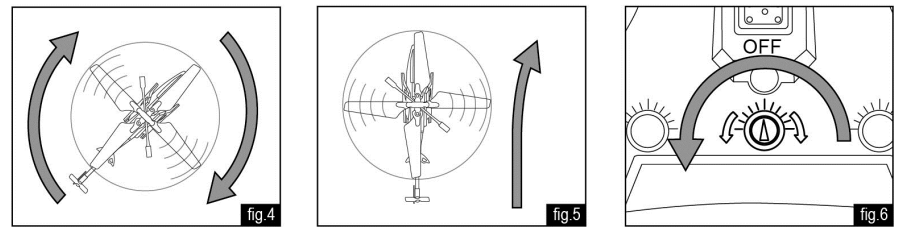

- When the helicopter spirals (fig. 7) or keeps turning anticlockwise (fig. 8), turn the yaw-trim dial to the right until the helicopter flies straight (fig. 9).

