



1 Description

The Hz Memory transmitter enables the individual, group or general command of Simu Hz motors and receivers.

There are two functioning modes: either manual mode or automatic mode:

Manual Mode = OFF: - To use the remote control, press on one of the control buttons (, or). The programming of the automatic mode are de-activated.

Automatic Mode = ON: - To manually use the remote control, press on one of the of the control buttons (, or). The Memory Hz transmitter allows you to memorize up to 3 orders (one each for UP, DOWN, and Intermediate Position) and to repeat them automatically every the 24 hours. (ex: an order memorized at 7:30, will be repeated every day at 7:30).

- The vacation function randomly offsets the programmed orders by 0 to +30 minutes to simulate a presence in your home.

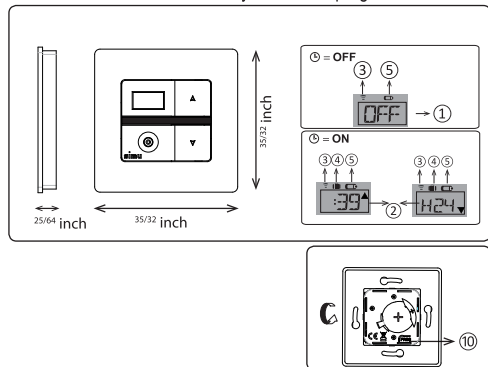

1. Manual mode display: OFF -> The programmed orders of the automatic mode are de-activated.
2. Automatic mode display (ex: 39 min before the next UP order, and 24H before the next DOWN order)
3. Transmission indicator
4. Vacation function active
5. Low battery indicator
6. UP control button ▲
7. STOP control button ■
8. DOWN control button ▼
9. Select button ●
10. Programming button (PROG)

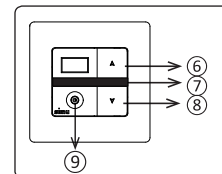

Technical data (Wireless switch/class III):

11. Transmitter range. Radio Frequency (Maximum transmission time: 10 seconds).

12. Protection Index. For indoor use.

13. Operating temperature: 14°F (-10°C) to 140°F (60°C)

Storage temperature: -22°F (-30°C) to 158°F (70°C).

- Frequency: 433.420 MHz

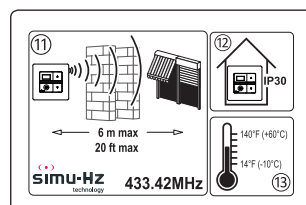

2 Adding the transmitter to an existing installation

= OFF

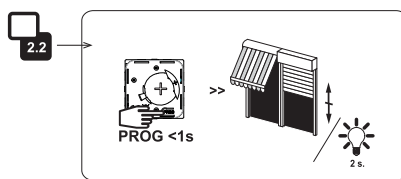
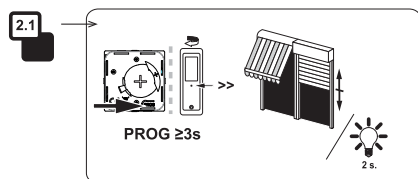

2.1- Press the PROG button (>3 s) on the current individual control transmitter for about 3 seconds. The motor will jog.

2.2- Press the PROG key on the Memory Hz transmitter less than 1 second. The motor will jog. The operation is completed.

- For a group control, with Memory Hz transmitter: repeat operations 2.1 and 2.2 for each motor in the group. (For more complete information about programming, please refer to the instructions of the motors or receivers used).

3 Installation

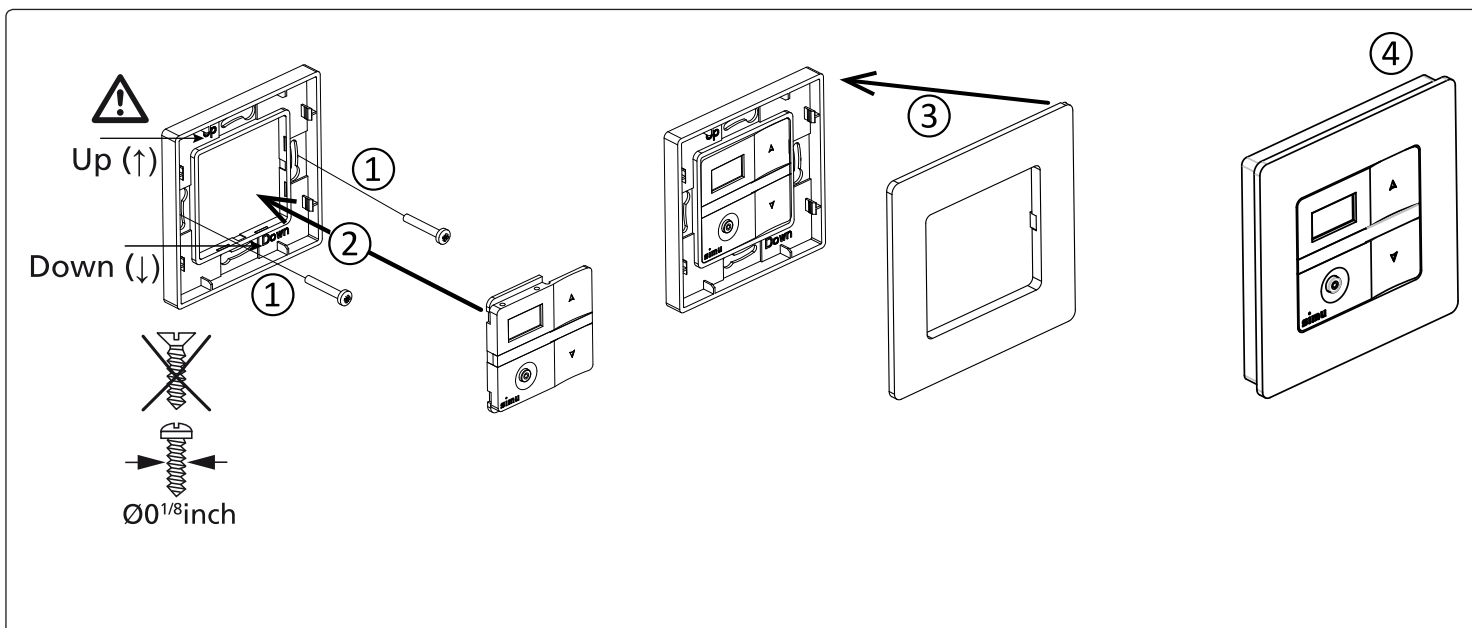

If it is necessary to set the motor (motor direction, end-limits, Intermediate Position, ...), put the control in manual mode.

-Keep out of children's reach. Do not position the transmitter near metal in order to ensure its proper operation and prevent reduced range. A radio appliance using the same frequency (for example: hi-fi radio headphones) may deteriorate our product's performance.

4 Use of the Memory Hz transmitter

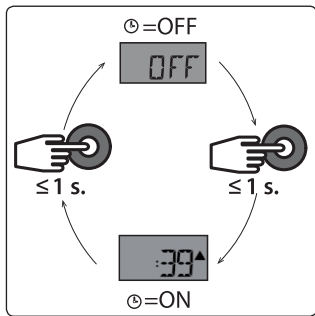

4.1- Manual control: ⊖ = OFF + ⊕ = ON

- Manual control is possible in manual and automatic modes
- Give a short press on key ▲, ■ or ▼ : the order is sent, the screen switch ON for 120s, and the memorized orders display to the screen.

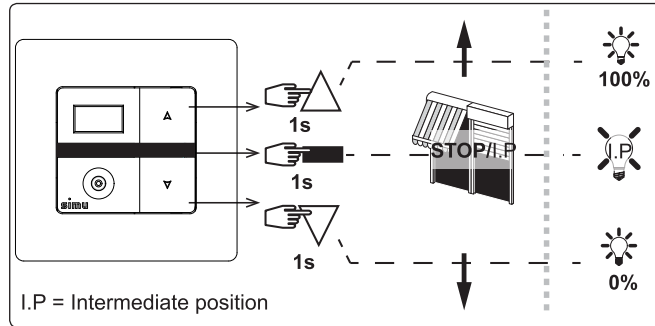

- To switch from manual mode to automatic mode and back, press the select button ●.
- When the screen is OFF, pressing on the channel select button ● will turn ON the screen for 2 min. After each switch to automatic mode, the different orders memorized display to the screen, or each time when the screen switch ON with a short press on the select button ●.

4.2- Memorizing an automatic control (SET): SET ⚠ ⊕ = ON

- At the desired time, press more than 5 seconds a key ▲/▼/ or ■ (■ to set an intermediate position). The 'H24' display indicates that this order will be automatically repeated every 24 hours.
- One automatic command can be set for up ▲, one for down ▼ and one for the intermediate position ■.

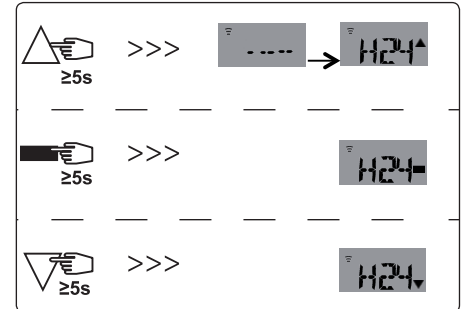

4.3- Deleting an automatic orders (DEL): DEL ⚠ ⊕ = ON

- To delete an UP order-> for more than 5sec press simultaneously keys ● & ▲ : 'DEL ▲' will display to the screen.
- To delete an Intermediate position > for more than 5sec press simultaneously keys ● & ■ : 'DEL ■' will display to the screen.
- To delete an DOWN order- > for more than 5sec press simultaneously keys ● & ▼ : 'DEL ▼' will display to the screen.

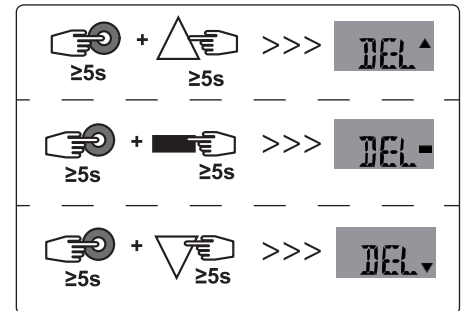

4.4- Deleting all memorized orders (DEL ALL):

Press on the button ● for more than 8 sec : The '--- --' display indicates that all orders are deleted.

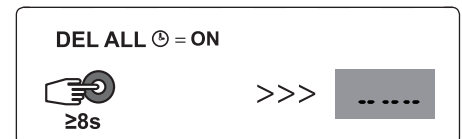

4.5- Vacation mode Activation/De-activation (⚡):

To activate or disable the vacation mode simulation, press both ▲ & ▼ buttons at the same time . The suitcase displayed, (⚡) indicates that the function is active.

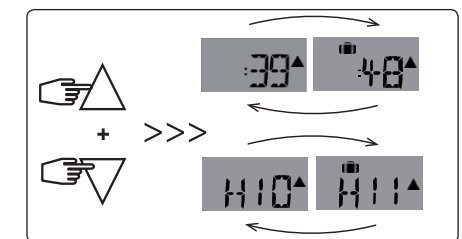

5 Replacing the battery

Replace the batteries when the low battery indicator ② goes on.

Power: 3V lithium battery type CR 2430- battery life: 3 years at 4 presses/day. Do not recharge the battery. Please separate and dispose of the appliance, batteries and used batteries at a recycling location.

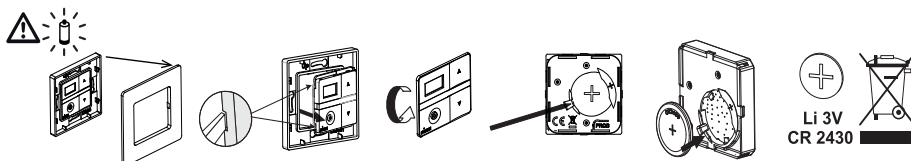

This device complies with Part 15 of the FCC Rules. Operation is subject to the following conditions

- This device may not cause harmful interference and
 - This device must accept any interference received, including interference that may cause undesired operation
- Warning! Changes or modifications not expressly approved by the manufacturer could void the users authority to operate the equipment.