

Kodak

PIXPRO AZ651

Digital Camera



User Manual



BEFORE YOU START

Declaration of Conformity

Responsible Party: JK Imaging Ltd.

Address: 1411 W. 190th Street, Suite 550, Gardena, CA 90248, USA

Company Website: www.kodakpixpro.com

INDUSTRY CANADA

This device complies with Canadian RSS-210.

This device complies with Industry Canada license-exempt RSS standard (s). Operation is subject to the following two conditions: (1) this device may not cause interference, and (2) this device must accept any interference, including interference that may cause undesired operation of the device.

Radiation Exposure Statement:

This product complies with the Canadian portable RF exposure limit set forth for an uncontrolled environment and is safe for intended operation as described in this manual. Additional RF exposure reduction can be achieved if the product can be kept as far as possible from the user body or set the device to lower output power if such function is available.

Industry Canada statement:

Ce dispositif est conforme à la norme CNR-210 d'Industrie Canada applicable aux appareils radio exempts de licence. Son fonctionnement est sujet aux deux conditions suivantes: (1) le dispositif ne doit pas produire de brouillage préjudiciable, et (2) ce dispositif doit accepter tout brouillage reçu, y compris un brouillage susceptible de provoquer un fonctionnement indésirable.

Déclaration d'exposition aux radiations:

Le produit est conforme aux limites d'exposition pour les appareils portables RF pour les Etats-Unis et le Canada établies pour un environnement non contrôlé.

Le produit est sûr pour un fonctionnement tel que décrit dans ce manuel. La réduction aux expositions RF peut être augmentée si l'appareil peut être conservé aussi loin que possible du corps de l'utilisateur ou que le dispositif est réglé sur la puissance de sortie la plus faible si une telle fonction est disponible.

For Customers in Europe



This symbol [crossed-out wheel bin WEEE Annex IV] indicates separate collection of electrical waste and electronic equipment in the European countries. Please do not throw the equipment into domestic refuse. Please use the return and collection systems available in your country for proper, safe disposal of this product.



"CE" mark indicates that this product complies with the European requirements for safety, health, environment and customer protection. "CE" marked cameras are intended for sales in Europe.

Europe – EU Declaration of Conformity

This device complies with the essential requirements of the R&TTE Directive 1999/5/EC. The following test methods have been applied in order to prove presumption of conformity with the essential requirements of the R&TTE Directive 1999/5/EC:

- EN 60950-1: 2006+A11:2009 +A1:2010 +A12:2011

Safety of Information Technology Equipment

- EN 50566: 2013

Product standard to demonstrate compliance of radio frequency fields from handheld and body- mounted wireless communication devices used by the general public (30 MHz — 6 GHz)

- EN 62209-2: 2010

Human exposure to radio frequency fields from handheld and bodymounted wireless communication devices — Human models, instrumentation, and procedures
Part 2: Procedure to determine the specific absorption rate (SAR) for wireless communication devices used in close proximity to the human body (frequency range of 30 MHz to 6 GHz)

- EN 300 328 V1.8.1 : 2012

Electromagnetic compatibility and Radio spectrum Matters (ERM); Wideband Transmission systems; Data transmission equipment operating in the 2.4 GHz ISM band and using spread spectrum modulation techniques; Harmonized EN covering essential requirements under article 3.2 of the R&TTE Directive.

- EN 301 489-1 V1.9.2: 2008C

Electromagnetic compatibility and Radio Spectrum Matters (ERM); Electro Magnetic Compatibility (EMC) standard for radio equipment and services; Part 1: Common technical requirements.

- EN 301 489-17 V2.2.1:2012

Electromagnetic compatibility and Radio spectrum Matters (ERM); Electro Magnetic Compatibility (EMC) standard for radio equipment and services; Part 17: Specific conditions for 2.4 GHz wideband transmission systems and 5 GHz high performance RLAN equipment.

For Customers in the U.S.A.

Federal Communication Commission Interference Statement

This device complies with Part 15 of the FCC Rules. Operation is subject to the following two conditions: (1) This device may not cause harmful interference, and (2) this device must accept any interference received, including interference that may cause undesired operation.

This equipment has been tested and found to comply with the limits for a Class B digital device, pursuant to Part 15 of the FCC Rules. These limits are designed to provide reasonable protection against harmful interference in a residential installation. This equipment generates, uses and can radiate radio frequency energy and, if not installed and used in accordance with the instructions, may cause harmful interference to radio communications. However, there is no guarantee that interference will not occur in a particular installation. If this equipment does cause harmful interference to radio or television reception, which can be determined by turning the equipment off and on, the user is encouraged to try to correct the interference by one of the following measures:

- Reorient or relocate the receiving antenna.
- Increase the separation between the equipment and receiver.
- Connect the equipment into an outlet on a circuit different from that to which the receiver is connected.
- Consult the dealer or an experienced radio/TV technician for help.

FCC Caution: Any changes or modifications not expressly approved by the party responsible for compliance could void the user's authority to operate this equipment.

This transmitter must not be co-located or operating in conjunction with any other antenna or transmitter.

Radiation Exposure Statement:

This product complies with the FCC portable RF exposure limit set forth for an uncontrolled environment and is safe for intended operation as described in this manual. Additional RF exposure reduction can be achieved if the product can be kept as far as possible from the user body or set the device to lower output power if such function is available.

About this Manual

Thank you for purchasing this KODAK PIXPRO digital camera. Please read this manual carefully and keep it in a safe place for future reference.

- JK Imaging Ltd. reserves all rights of this document. No part of this published manual may be reproduced, transmitted, transcribed, stored in a retrieval system or translated into any language or computer language, in any form, by any means, without the prior written permission of JK Imaging Ltd..
- All trademarks mentioned in this manual are used for identification purposes only and are properties of their respective owners.
- This manual provides you with instructions on how to use your new KODAK PIXPRO digital camera. Every effort has been made to ensure that the contents of this manual are accurate, however JK Imaging Ltd. reserves the right to make changes without notice.
- Throughout this manual, the following symbols are used to help you locate information quickly and easily:



Indicates useful information.



Indicates precautions are to be taken while operating the camera.

- In the instructions below, the following symbols may be used throughout this manual on how to operate the camera. This is to facilitate better understanding.

[Item properties] : The optional properties in the camera interface are indicated by the symbol [] .

SAFETY NOTES

Safety notes for this camera

- Do not drop the camera or allow it to hit solid objects.
- Do not attempt to disassemble or repair the camera.
- Do not use or store the camera in dusty places or on a beach to prevent dust or sand from entering the camera, causing possible damage to it.
- Do not use or store the camera in a hot environment or under direct sunlight.
- Do not use or store the camera near a powerful magnetic field, for example near a magnet or transformer.
- Avoid touching the lens of the camera.
- Do not expose the camera to direct sunlight for a long period time.
- To prevent the camera from being damaged by moisture, do not use or store the camera in very humid environments, such as in rain or near bodies of water.
- If water accidentally comes in contact with the camera, turn the camera off, remove the battery and the memory card, and dry it within 24 hours.
- When you take the camera from a cold place to a warmer environment, condensation may occur. Please wait for a reasonable period of time before you turn it on.
- Before you remove the battery and memory card, the camera should be turned off.
- When you clean the body of the camera, do not use abrasive, alcohol-based or organic cleaner.
- Use the professional lens wiping cloth and dedicated cleaner to wipe and clean the lens.
- Download your photos and remove the memory card when you are going to store the camera for a long period of time.
- If this camera is not in use for a long time, please keep it in a dry and clean condition.
- Our company will not pay compensation for any failure of playback of pictures or videos caused by improper operation.

Safety notes for battery

- Please use a battery that is the same type as the one included.
- Please use the attached charger to charge the battery.
- If battery fluid leaks inside the camera, contact our customer service department. If battery fluid leaks onto your skin, rinse your skin with clean water and seek immediate medical attention.
- Disposal of used batteries should be carried out in accordance with the local (national or regional) regulations.
- To prevent the battery from being damaged, do not drop the battery or allow it to hit solid objects or to be scratched by the objects.
- Do not let the battery come in contact with metal objects (including coins) to avoid short circuiting, discharging, excessive heat, or possible leakage.
- Do not attempt to disassemble the battery.
- Do not expose the battery to water. Always keep the battery contacts dry.
- Do not heat the battery or throw it into a fire to avoid a possible explosion.
- Do not store the battery in a hot environment or in direct sunlight.
- If the battery overheats during charging or use, stop charging or use immediately. Turn off the product, remove the battery carefully, and wait until it cools down.
- When the camera is stored for a long period of time, remove the battery and keep it in a dry place that is not accessible to infants and children.
- In a colder environment, the performance of the battery could be noticeably reduced.
- When you install the battery, install it according to the positive and negative markings on the battery compartment. Never force it into the battery compartment.

Safety notes for memory card

- We suggest buying only well-known, name brand memory cards to ensure peak performance.
- Format the memory card using the camera before you use it or insert a new one.
- Do not drop the memory card or allow it to hit solid objects to avoid damaging it.
- Do not attempt to disassemble or repair the memory card.
- Do not expose the memory card to water. Always keep it dry.
- Do not remove the memory card when the camera is turned on. Otherwise, the memory card could be damaged.
- Do not directly edit the data on the memory card. Copy the data to your PC before you edit them.
- When the camera is stored for a long period of time, be sure to download your photos and remove the memory card. Store it in a dry environment.
- Do not modify the name of the files or folders of the memory card using your PC. Modifying the file names may cause the files to not be recognized on the camera or a possible error may occur.
- A photo taken with the camera will be stored in the folder that is automatically generated on the memory card. Do not store photos that are not taken using this camera in these folders as the pictures cannot be recognized during the playback.
- When you insert a memory card, make sure the notch of the card matches the markings on the top of the card slot.

Other Safety Notes

- Do not disconnect the power or turn the camera off during the update process. Doing so may cause incorrect data to be written and the camera may not power on later.
- Do not hang the neck strap of the camera around the neck of a child.
- When using your camera on an airplane, observe the relevant rules specified by the airline.
- Due to the limitations of manufacturing technology, the LCD screen may have a few dead or bright pixels. These pixels do not affect the quality or performance of the camera, photos or video.
- Do not expose the LCD screen to water. In a humid environment, only wipe it with a soft and dry cleaning cloth.
- If the LCD screen is damaged and the liquid crystal comes into contact with your skin, wipe your skin with a dry cloth immediately and rinse it with clean water. If liquid crystal comes into contact with your eyes, wash them with clean water at least for 15 minutes and seek immediate medical attention. If you accidentally swallow liquid crystal, rinse your mouth immediately and seek medical attention.

CONTENTS

BEFORE YOU START.....	1	MODE OVERVIEW	27
SAFETY NOTES	6	LCD Screen Display.....	27
CONTENTS.....	10	Overview of the screen icons in photo shooting mode	27
GETTING READY	14	Overview of the Screen Icons in Movie Mode	29
Accessories Included	14	Overview of the Screen Icons in Playback Mode	30
Install lens cap and neck strap.....	15	How to take pictures.....	31
Part Names	16	Using the Mode Dial.....	32
Installing Battery and Memory Card...	19	Face Beautifier.....	35
Charging Battery	21	Wi-Fi Mode	36
Pivoting LCD Screen.....	22	Scene Mode.....	43
Turning Camera On and Off.....	23	Custom Settings	49
Set your Language, Date/Time	24	BASIC OPERATION.....	51
Set your Language, Date/Time after the first power-on.....	24	Using EVF (Electronic View Finder) ...	51
Resetting your Language.....	25	Using the Zoom Function	52
Resetting Date/Time	26	Display Setting	53

AF Area	55
Macro Mode	56
Self-timer Mode	57
Flash Mode	58
WB (White Balance) Mode	60
Continuous Shot Mode.....	62
Exposure Compensation Functions Setting.....	64
EV Adjustment	64
ISO.....	65
Shutter Speed Adjustment	65
Aperture Adjustment	66
Using Quick Recording	66
i Button Function Menu	67
Using the Lens Function Ring .	68
Zoom/AF Mode	68
Function Ring (Smart) Mode.....	69
MF(Manual Focus) Mode.....	70

PLAYBACK..... 71

Viewing Photos and Videos	71
Thumbnail View.....	72
Using Zoom Playback (for still pictures only).....	73
Continuous Shot Group Playback.....	74
Animation panorama play	75
Slideshow.....	76
Photos and Video Deletion.....	77

USING THE MENUS 78

Shooting Menu	78
Expo Metering.....	79
OIS (Optical Image Stabilization)..	79
Beautifier.....	80
Select Scene.....	80
Shoot Setting1.....	81
Image Size.....	82

Movie Size	83	Touch-up	96
Quality.....	84	Resize	97
MF (Manual Focus) Assist	85	Playback Settings	97
AF Assist Beam	86	Protect	98
Digital Zoom.....	86	Delete	98
Shoot Setting 2.....	87	DPOF (Digital Print Order Format)	99
Date Imprint	88	Trim.....	100
Quick Review.....	88	Play Slide Show.....	100
Cont. AF.....	89	General Settings	101
Face Detection.....	89	Sound Settings	102
Custom Settings	90	Power Saver	102
Function Ring (Smart).....	91	Language.....	103
Playback Menu.....	92	Zone.....	103
Menu.....	92	Date/Time	103
Display Mode	93	LCD Brightness.....	103
Rotate	93	File Settings	104
Color	94	Format	105
HDR.....	95		

Copy to Card.....	106
File Numbering	106
Reset settings	107
Version.....	107

CONNECTION SETTINGS . 108

Connecting to a Computer	108
Setting the USB Mode	108
Transferring files to your computer.....	109
Connecting to a PictBridge Compatible Printer	110
Setting the USB Mode	110
Connecting to your Printer	111
Using the PictBridge Menu.....	112
Print (with Date)	112
Print (without Date)	113
Print Index.....	114
Print DPOF Images.....	115

Exit.....	115
Video System	116
Supported HDMI Connections	117
Connecting HDMI-Ready TV	117
HDMI CEC Control.....	118
Set Eye-Fi SD Card Connection Mode	123

APPENDICES 124

Product Specifications.....	124
Prompts and Warning Messages	129
Troubleshooting	134

GETTING READY

Accessories Included

Your camera box should contain the camera model you purchased along with the following accessories. If anything is missing or appears to be damaged, please contact your retailer. (Based on sales in different countries or regions, the shape of the AC adapter will vary. Please subject to the actual product will prevail.)

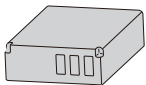

Rechargeable
Li-ion battery

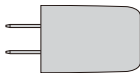

AC adapter

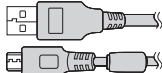

Micro USB cable



Neck strap

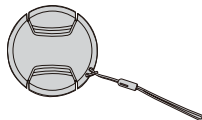

Lens cap with strap

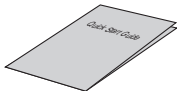

Quick start guide



Warranty card



Service card

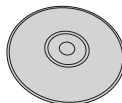

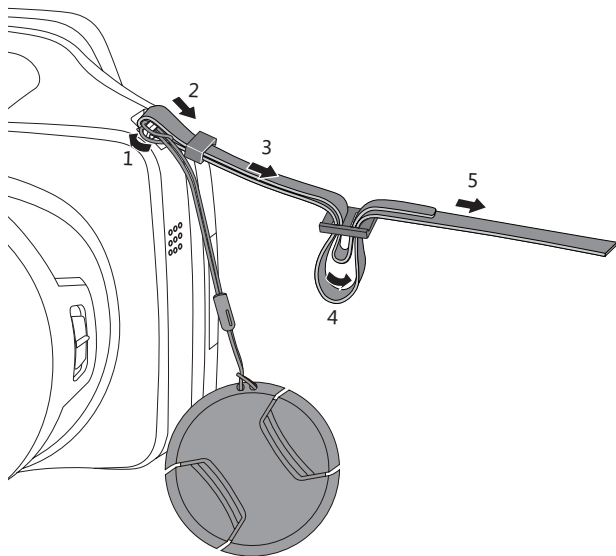

CD-ROM

Install lens cap and neck strap

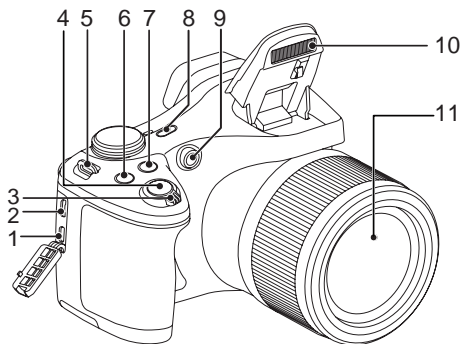

Part Names



1. Micro HDMI Port
2. Micro USB Port
3. Zoom Lever
4. Shutter Button
5. Strap Eyelet
6.  Exposure Compensation Button
7.  Continuous Shot Button
8. Power Button
9. AF Assist Beam/Self-timer Lamp
10. Flash Lamp
11. Lens

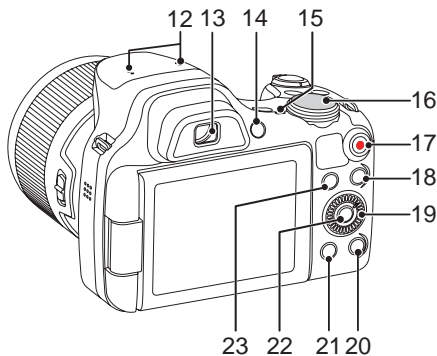

- 12. Microphone
- 13. Electronic View Finder (EVF)
- 14. Electronic View Finding Window/
LCD Screen Button
- 15. LED Indicator Lamp
- 16. Mode Dial
- 17. Fast Video Recording Button
- 18. Menu Button
- 19. Jog Dial
[**AF**] AF Button/Up Button
[] Delete Button/Self-timer
Button/Down Button
[] Macro Button/Left Button
[] Flash Button/Right Button
- 20. Display Button
- 21. Playback Button
- 22. SET Button
- 23. i Button



Rolling the jog dial can be for fast selection instead of pressing the [**AF**]/[]/[]/[] direction button.

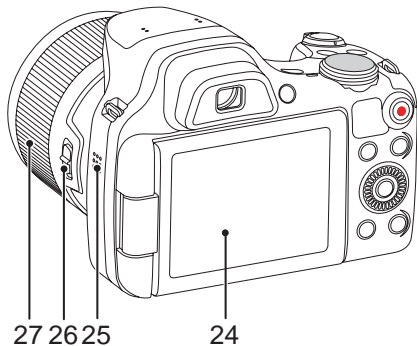

- 24. Pivoting LCD Screen
- 25. Speaker
- 26. Lens Function Ring Lever
- 27. Lens Function Ring
- 28. Battery Cover
- 29. Tripod Socket

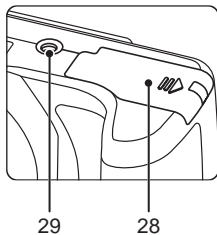

- 28. Battery Cover
- 29. Tripod Socket

Installing Battery and Memory Card

1. Open the battery cover according to the direction of arrow.

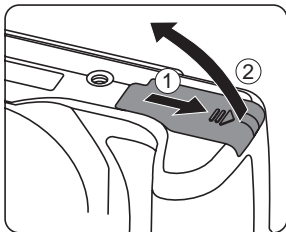

2. Insert the battery into the battery compartment according to the negative and positive directions as illustrated in the picture. Push the battery down until it locks in place.

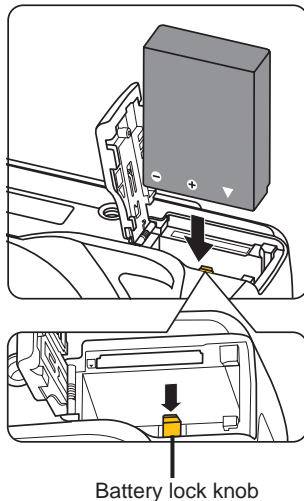

3. Insert the memory card into the memory card slot as shown in the diagram .

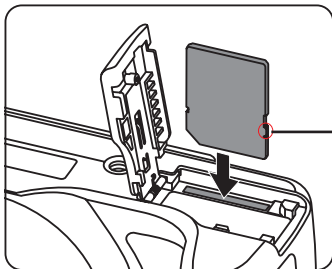

Write
protection
buckle

4. Close the battery cover.

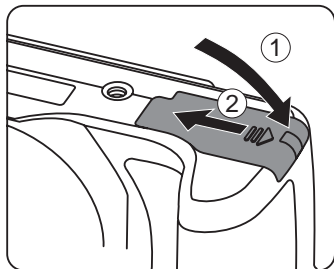

The memory card (SD/SDHC) is optional and not included in all camera packaging. If you have to purchase a memory card, select one with storage capacity between 4GB and 32GB to ensure correct data storage.





To remove your memory card, open the battery cover, gently press the memory card to eject it and remove it carefully.

Charging Battery

Please insert the battery and charge it under shutdown mode.

1. Connect the camera and the power charger using the supplied Micro USB cable.
2. Insert the plug of the power charger into the power outlet to charge the battery.

 After the battery is stored for a long period of time, use the supplied power charger to charge the battery prior to use.

 Charging indicator:
Steady orange: Charging
Steady green: Charging complete
To have maximum battery life, charge the battery for at least 4 hours the first time.

 Please charge the battery indoors between 0°C and 40°C.

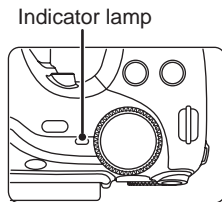
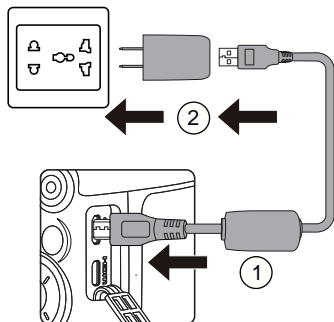

Pivoting LCD Screen

The LCD screen is housed in the camera's body. You may follow the directions shown below to move it as needed:

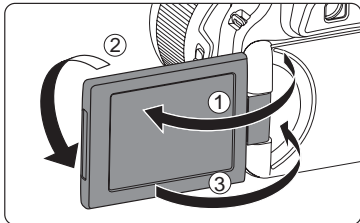

1. Turn on the LCD screen along the direction shown by arrow ①.
2. Available to rotate 180° along the direction shown by arrow ②.
3. Turn off the LCD screen along the direction shown by arrow ③.

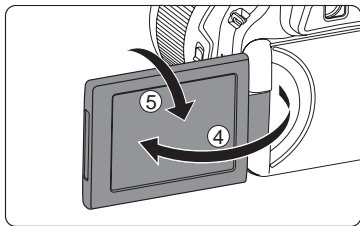

1. Turn on the LCD screen along the direction shown by arrow ④.
2. Available to rotate 90° along the direction shown by arrow ⑤.



Please don't rotate the LCD screen with excessive force to prevent damages.



Please turn off the LCD screen inwards after use to protect it from scratches.

Turning Camera On and Off



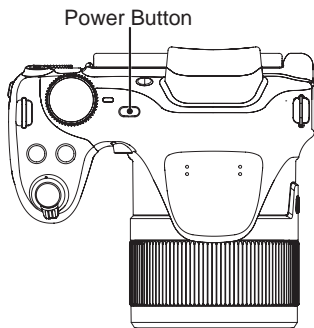





Press the power button to turn the camera on. To turn the camera off, press the power button again.



When the power is off, press and hold the  button to power on and enter playback mode.

Set your Language, Date/Time





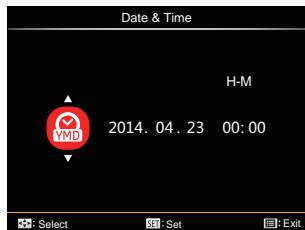

















Set your Language, Date/Time after the first power-on

1. When you turn the camera on for the first time, the language selection screen appears.
2. Press the [**▲AF**]/[**▼**  ] button to select your desired language.
3. After you press the **(SET)** button to confirm the selection, the Date/Time settings screen appears.
4. Press the [**◀**  ]/[**▶**  ] button to select the Date/Time to be adjusted: Time is displayed in yyyy:MM:dd HH:mm.
5. Press the [**▲AF**]/[**▼**  ] button to adjust the value for the selected Date/Time.
6. Press the **(SET)** button to confirm the time settings and the shooting screen appears.



Resetting your Language





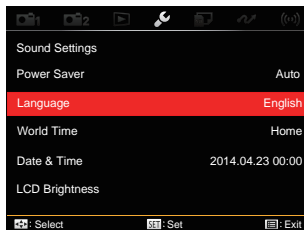





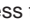







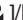

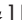



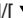

After you set your language for the first time, follow the instructions below to reset your language.

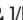
1. Press the  button, press the [ AF]/[  ] button to select , and press the  button to enter the menu.
2. Press the [ ]/[ ] button to select .
3. Press the [ AF]/[  ] button to select [Language] and press the  button to enter the menu.
4. Press the [ AF]/[  ] button to select your desired language and press the  button to confirm.
5. Press the  button and the shooting screen appears.

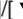

Resetting Date/Time

After you set your Date/Time for the first time, follow the instructions below to reset date and time.

1. Press the  button, press the [ **AF**]/[  ] button to select , and press the  button to enter the menu.
2. Press the [ ]/[ ] button to select .
3. Press the [ **AF**]/[  ] button to select [Date & Time] and press the  button to enter the menu.
4. Press the [ ]/[ ] button to select the Date/Time to be adjusted: Time is displayed in yyyy:MM:dd HH:mm.
5. Press the [ **AF**]/[  ] button to press the value for your selected block. After you finish your settings, press the  button to confirm.
6. Press the  button and the following shooting screen appears.

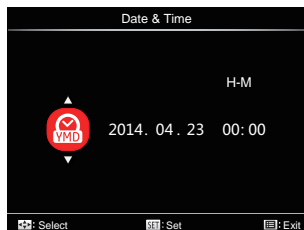
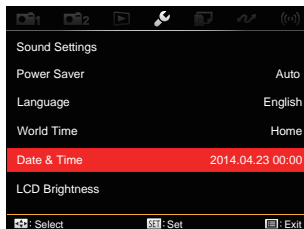

MODE OVERVIEW

LCD Screen Display

Overview of the screen icons in photo shooting mode

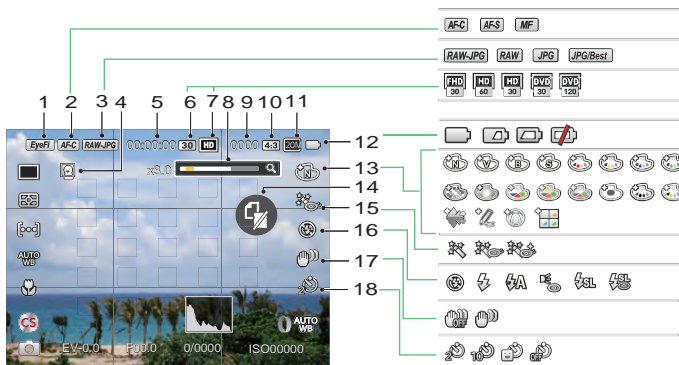

1	Eye-Fi ON (with signal)	7	Video Pixels	13	Color Effect
2	Focus Mode	8	Zoom Display(By turning the Zoom Lever)	14	NO Memory Card Tips
3	Quality	9	Number of Pictures in Static Mode	15	Beautifier
4	Face Detection	10	Ratio of Shooting Pixels	16	Flash Mode
5	Maximum Record Time	11	Image Size	17	OIS
6	Recording Speed (fps)	12	Battery Status	18	Self-timer

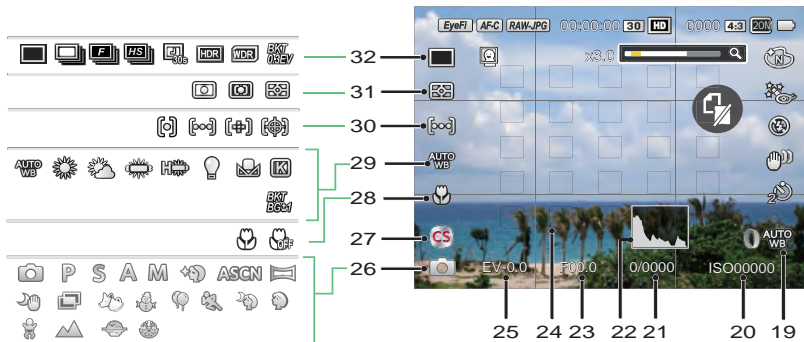

19	Lens Function Ring Custom Settings	24	Focus Frame	29	White Balance
20	ISO Value	25	Exposure Compensation Value	30	AF Area
21	Shutter Speed	26	Shooting Mode	31	Expo Metering
22	Histogram	27	Custom Settings	32	Single / Continuous Shot / HDR / WDR / AE Bracketing
23	Aperture Value	28	Macro Mode		

Overview of the Screen Icons in Movie Mode



1	Battery Status
2	Number of Videos Captured
3	Continuous Recording Time
4	Movie Mode

Overview of the Screen Icons in Playback Mode

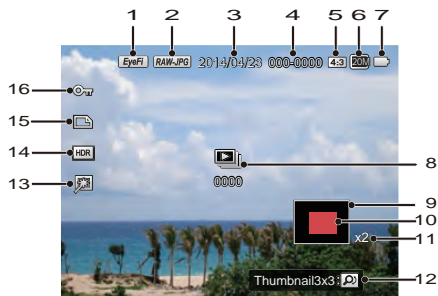

1	Eye-Fi ON (with signal)	9	Image Area
2	Quality	10	Zoom Magnification Area
3	Capture Date	11	Image Zoom Ratio
4	File Name	12	Index Prompt
5	Shooting Pixel Ratio	13	Touch-up
6	Image Size	14	HDR
7	Battery Status	15	DPOF File Icon
8	Continuous Shot Group Playback	16	File Protection Icon

How to take pictures

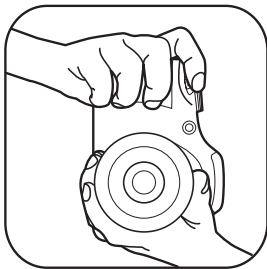
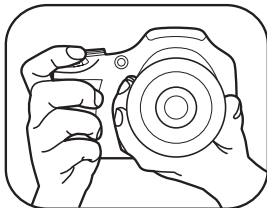



1. Hold the camera with both hands as shown in the figure, not blocking the flash and lens by fingers.
2. Aim the camera at the object and then frame with the LCD screen.
3. Use the zoom lever to select Tele or Wide positions to zoom in or out on your subject.
4. Press the shutter button half way to focus on the subject. When the focus frame turns green, press the shutter button completely down to take the picture.

Using the Mode Dial











This camera provides a convenient mode dial that allows you to manually switch between different modes with ease. The available modes are listed below:

Mode Name	Icon	Description
Auto Mode		In this mode, the optimal conditions for taking pictures will be set based on the subject and environment. It is the most commonly used mode for taking pictures.
Program AE	P	Under different scenes, the user can switch the ISO and EV value according to personal preference, the camera can automatically set the shutter speed and aperture value.
Shutter priority	S	Setting allows you can adjust the shutter speed / EV value and ISO value. The camera automatically sets the aperture value based on the shutter speed and ISO value to get the most appropriate exposure value.
Aperture priority	A	In this mode, you can adjusting the aperture size, EV and ISO values. The large aperture is to highlight the object focused through blurring the background, while the small aperture is for clear focusing on both the background and the object.

Manual Mode	M	For manually setting the aperture, shutter speed and ISO value.
Face Beautifier		This mode automatically enhances facial features with skin softening touches and eye brightening capabilities.
Wi-Fi Mode		Make image transmission and remote control by connecting smart device with Wi-Fi.
Scene Mode	SCN	Choose from 14 different pre-set scene types and effects for your photos.
Movie Mode		Record videos.
Custom Settings	CS	The user can store the frequently used shooting modes and parameters and switch to this mode for quick adjustment.

Please refer to the table below if any nonadjustable options in **PSAM** mode:
(O: Optional X: Not optional)



Mode Options	Aperture	Shutter	EV	ISO
P	x (Display)	x (Display)	o	o
S	x (Display)	o	o	o
A	o	x (Display)	o	o
M	o	o	x (Display)	o

1. Turn the mode dial to select the **PSAM** mode you want.
2. Press the  button to configure settings.
2. Press the [ ] / [ ] button to select an adjustment setting.
3. Press the [ **AF**] / [  ] button to adjust the parameters.
4. Press the  button to confirm the settings and enter the shooting screen.

Face Beautifier

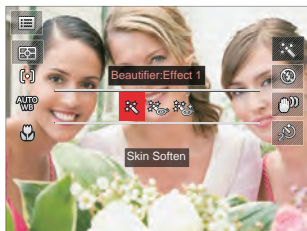
1. Turn the mode dial to select face beautifier mode ().
2. Press the  button and press the [ AF]/[  ] button to select  .
3. Roll the  jog dial to select an option and press the  button to confirm and enter the shooting screen.







-  Effect 1: Skin Soften
-  Effect 2: Skin Soften + Eye Brightening
-  Effect 3: Skin Soften + Eye Brightening + Eye Enlargement

Wi-Fi Mode



Make image transmission and remote control by connecting smart device with Wi-Fi.

Matters needing attention before use:

- Before use, please confirm that your smart device is a smart phone with Android 2.3 or 4.x system, a tablet computer with Android 4.x or is an iOS 6/7 system. If not, please upgrade your smart device before using the APP.
- Please do not use in places having high intensity magnetic field, electrostatic and electric wave interference (for example near a microwave oven), which may cause failure in receiving signals.
- To maintain a connection, please keep the camera within 10 meters (32.8 feet) without signal shielding interference.
- Please do not use Wi-Fi connection functionality on a plane.
- The camera and the smart device can only be connected one to one.

1. Rotate the mode dial to  and then enter the Wi-Fi selection interface.
2. Press the [ ]/[ ] button to select and set options.



-  [Settings] :
Customize the Wi-Fi settings for the camera system.
-  [Station] :
Use the Station Mode to connect to a "Personal Hotspot" created by your mobile device.
-  [AP Mode] :
In AP mode, the camera will act as an access point enabling another Wi-Fi device to connect to it.









Rotate the mode dial to disconnect.

AP Mode

This camera may connect with your smart device through Wi-Fi.

Settings of Camera:

1. Select  and press the  button to enter the setting interface.
2. Press the [ **AF**]/[ ] button to select options to be adjusted, and press the  button to enter the option setting interface.

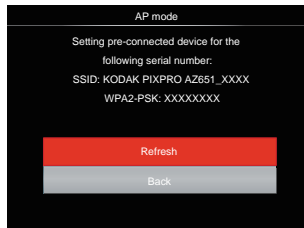

- Refresh: Create a new WPA2 PSK password.
- Back: Back to previous page.

Settings of Smart Device:

1. Enable the Wi-Fi of smart device and then search surrounding wireless devices.
2. Select the name of camera SSID to be connected and then input the eight-digit number password after WPA2-PSK on the camera.
3. Download a dedicated installation package from the application store corresponding to the device (APP name: PIXPRO Remote Viewer) and then install it.

Route of downloading the APP package:

- Android: Search for "PIXPRO Remote Viewer" from Google play and install it.
 - iPhone: Search for "PIXPRO Remote Viewer" from APP Store and install it.
4. Click the icon of the APP  to enable the APP.

Set up completion:

Once the APP is connected to the camera, functional operations can be enabled on the smart device.

Station

Enable image transmission and remote control by connecting the camera with a Wi-Fi access point created by your smart device.

1. Enable the Wi-Fi access point of smart device.
2. Select the  on camera and then press the (SET) button to confirm connection with smart device.
3. Press the [▲ AF]/[▼ ⏻ ⏪] button to select the name of smart device to be connected and then press the (SET) button to confirm. Then, the camera enters the password input interface.



Press the []/[] button to select:

- Scan: Search again surrounding wireless devices.
- : Select the name of device to be connected.
- Back: Back to Wi-Fi mode select screen.

4. Press the []/[]/[]/[] direction button or roll the jog dial to select and then press the button to confirm your selection. Enter the completion of WPA2- PSK after password storage.

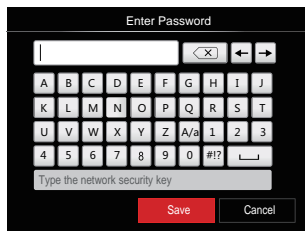

Meanings of Interface Icons:

Icon	Description
	Delete the last letter
	Switch the display of letters in capital and lowercase
	Move the Cursor
	Switch the symbol input
	Input Space

5. Connect to network after storing the password.

- If connected, the LCD screen will display as shown below:



- If connect failed, please check Wi-Fi device and try again.

6. After connection, you may use the dedicated APP installed on smart device to carry out relative operation.

Display of Wi-Fi Connection Status:

The Wi-Fi has successfully connected but APP is not enabled.



The Wi-Fi has successfully connected and APP is enabled.

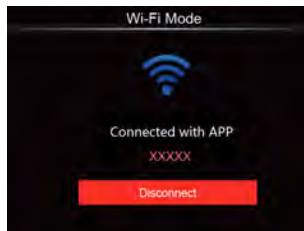

For interrupting the connection:



- No: Keep Wi-Fi connected and back to previous page.
- Yes: Disconnect and back to Wi-Fi mode for interface selection.







The Wi-Fi of smart device interrupts:





- Back: Back to Wi-Fi mode select screen.

Setting

The name of this camera can be changed through key stroking.

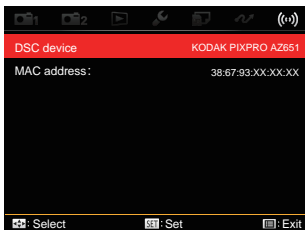
1. Select the  and then press the  button to enter the setting interface.
2. Press the [ AF]/[ ] button to select options to be adjusted and then press the  button to enter the menu.



3. Press the  button to confirm settings and then skip the menu.

DSC Device

The default name of DSC device is [KODAK PIXPRO AZ651] . Change the name of DSC device through key stroking.



For the method of input, please refer to the introduction on password input on page 39.

MAC address

Check the wireless MAC address of this camera.







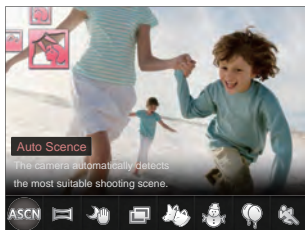







Scene Mode SCN

You can select an appropriate mode from the 14 scene modes according to the type of environment you are shooting. The camera then configures the most appropriate settings automatically.

1. Rotate the mode dial to **SCN** , then the LCD screen will display as below:









2. Press the [◀ 📷]/[▶ ⚡] button to select a scene, and press the (SET) button to confirm.
3. If any need of changing the scene, please press the (MENU) button and then the (SET) button and finally the [◀ 📷]/[▶ ⚡] button to reselect the scene.

Scene	Description
 Auto Scene	The camera automatically detects the most suitable shooting scene.
 Panorama Mode	For shooting 360-degree landscape.
 Handheld Night	Reduce blur when shooting low light/ illuminated scenes.
 Multi Exposure	Take several shots and overlap as a single image.
 Cat/Dog	The camera automatically takes a picture when a dog's face is detected.
 Snow	For subjects in the snow. Reduce underexposure.
 Party	For subjects at night without using a tripod. Capture sharp shots without blur.
 Sport	For fast-moving subjects. Capture sharp action shots without blur.
 Night Portrait	For portraits against night time scenery.
 Portrait	For shooting portraits
 Children	For kids and pets. Flash is disabled for eye protection.
 Landscape	For landscapes. Vivid reproduction of greens and blues.
 Sunset	For sunsets. Capture subjects in strong sunlight.
 Fireworks	For fireworks at night. Slow shutter speed adjusted for brilliant images.

Auto Scene (ASCN)

In “ASCN” scene mode, the camera can detect different environments intelligently and automatically select the best scene and photo settings for you.

“ASCN” can intelligently detect the following scenes:

Mode Name	Description
 Auto	The camera will automatically adjust the exposure and focus to ensure the best possible pictures.
 Landscape	For landscapes, will automatically adjust the exposure to match the background.
 Backlit Portrait	When the sun or any other light source is behind you, will automatically adjust the foreground exposure to produce the best pictures possible.
 Macro	The Macro Setting is ideal for shooting small objects or close-up photos.
 Night Landscape	For night scenes, will automatically increase the ISO value to compensate for low light.
 Portrait	Most suitable for capturing people with focus on their faces.
 Night Portrait	When you take portraits at night, or in low light conditions, will automatically adjust the exposure for people and night scenes.

Panorama Mode

This feature allows you to capture a panoramic view that will have significantly more content than a single photograph. Follow the instruction arrow with a smooth and steady movement of the camera to seamlessly shoot an ultra-wide scene of up to 360 degrees.

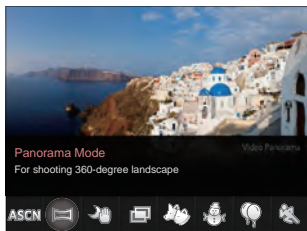

Follow the steps below:

1. Select the panorama mode () and then press the **(SET)** button to confirm.
2. Press the [**▲AF**]/[**▼**]/[**☒**]/[**☺**]/[**◀**]/[**☺**]/[**▶**]/[**⚡**] button to select a shooting direction. (The right direction is used as default if you do not make any choice), 2 seconds later, the camera is ready to take pictures. You can also press the **(SET)** button or half press the shutter button to be ready to take pictures.

3. Compose your shot on the LCD screen and half press the shutter button to focus on the subject. After focusing, fully press the shutter button down to take the first picture. At this time, the process dialog of panorama mode stitching appears on the screen.

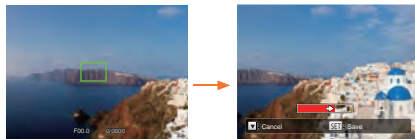

4. Move or rotate the camera according to the set direction. When the range of movement or rotation meets the internal settings of the camera, the progress dialog along the indication arrow partially turns red. When it completely turns red, panorama mode shooting is finished.

 Panoramic image can be played back by the method of flash playing. Please see the animation panoramic playback on page 75.

 During shooting, the flash, self-timer, macro modes and exposure compensation are not available. Focus adjustment is also not available at this time.

 During panorama mode shooting, press the **(SET)** button to interrupt shooting and save the current pictures taken. Press the **[▼ 🗑️ ⏸]** button to cancel shooting and not to save the previously taken pictures.

 During panorama mode shooting, when the moving direction of the camera is wrong or the angle deviates from the internal settings, the LCD screen shows a warning message [Improper alignment. Please try again.] and the current pictures taken are saved.

Multi Exposure

Suitable for shooting moving objects (as many as 6) in the same background.

 Keep camera steady before shooting. Press and hold the shutter button to take 6 photos continuously when it will stop automatically. To stop shooting, release the shutter button in the midway.

 Objects shall be moved only from left to the right in order to be recorded. Objects moving from other directions would not be recorded.

 Shooting effect will be influenced if object is moving too fast or too close.

Functions that can be adjusted in each scene are as below:

Scene	Adjustable Functions
Auto Scene	Flash* ¹ /Self-timer
Panorama Mode	None
Handheld Night	Expo Metering/Self-timer* ²
Multi Exposure	Expo Metering
Cat/Dog	Auto Shooting/Continuous Shot/Expo Metering/Macro
Snow	Continuous Shot/Expo Metering/Flash/Self-timer
Party	Continuous Shot/HDR/Expo Metering/Flash/Self-timer/Macro
Sport	Continuous Shot/Expo Metering
Night Portrait	Single/HDR/Expo Metering/Self-timer
Portrait	Continuous Shot/Expo Metering/Flash/Self-timer/Macro
Children	Continuous Shot/Expo Metering
Landscape	Expo Metering/Self-timer* ²
Sunset	Single/HDR/Expo Metering/Flash/Self-timer* ²
Fireworks	Continuous Shot/Expo Metering/Self-timer* ²

*1 Means the flash as an option of Night Landscape mode in Auto Scene is non-adjustable.

*2 Means self-timer smile is not included in the self-timer.

For continuous shot, there are only [Continuous Shot] and [Time-Lapse] for selection.

Custom Settings CS

The user can store the frequently used shooting modes and parameters and switch to this mode for quick adjustment.

Settings under **CS** mode (unset state or state after reset):

1. Turn the mode dial to select the **CS** mode, and enter the setup screen, as shown in the figure below:

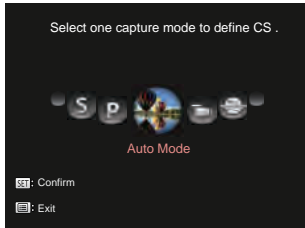

2. As shown in the figure, press the [] / [] button to select a capture mode that you want to define as **CS**, and press the button to enter the shooting screen.
3. As shown in the figure, press the button, and choose whether to continue the **CS** mode setting or rotating the mode dial to skip.

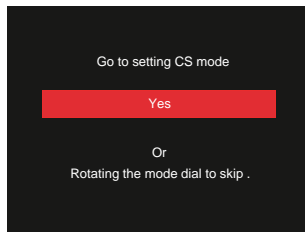

For setting under other modes (use this method to select a different custom setting):

1. Select any mode or scene mode to be stored.
2. Set your desired parameters in the current mode.
3. Press the button, press the [**AF**] / [] button to select , and press the button to enter the menu.
4. Press [] / [] button to select .

5. Press the [▼🗑️🕒] button select [Custom Settings] and press the  button to enter the menu.

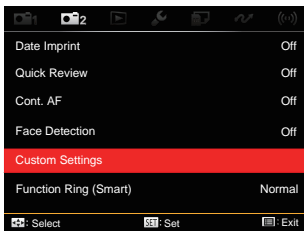

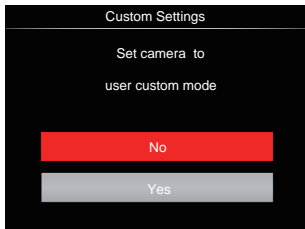

6. Select [Yes] to save or [No] to cancel.



7. Turn the mode dial to switch to the custom settings (**CS**).
8. The photo settings you stored the last time are invoked.

 When the **CS** mode is used for the first time, there is no preset parameter stored in the **CS** mode.

 Under the **CS** mode, if you need to retain or modify the set parameters (except the parameters in ) in restart or all modes. Please enter the [Custom Settings] menu and select [Yes] after setup. Otherwise, the parameter settings are not retained in the case of switching on/off or mode switching.

 If you want to remove the parameter setting of [Custom Settings] , please see the reset function on page 90 to operate.

BASIC OPERATION



Using EVF (Electronic View Finder)

EVF functions as the LCD screen, which can be used to observe the scene and objects and for playback, preview and menu operations.

EVF has the following advantages:

It will not be affected by ambient light and may avoid poor composition due to light reflection on the LCD screen.

Follow the steps below:

1. Turn the camera on and press the  button to switch to the EVF display. At this time, the LCD screen will become black.
2. View the scenes and objects through the EVF.
3. Press the  button again or restart the camera to switch back to the LCD screen display.

Using the Zoom Function

Your camera is equipped with two types of zoom functions: optical zoom and digital zoom. Toggle the zoom lever of the camera to zoom in or out of the subject while taking pictures.

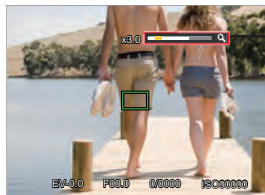
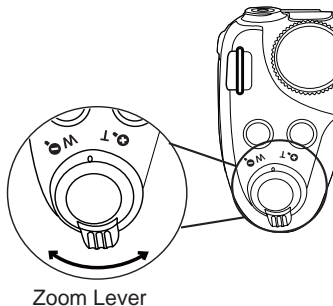

When the optical zoom reaches the threshold as digital zoom, release and turn the zoom lever to T to switch between the optical zoom and digital zoom.

Display Setting

Mode: **PSAM** + **SCN** **CS**

Press the **DISP.** button to switch among 4 screens.

Function Message Display



Display with Grid and Histogram



No Message Display

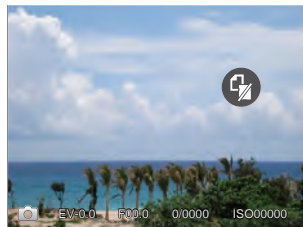

Message Display



Mode: 

Press the  button to enter playback screen, press the  button to switch among 3 screens.

Function Message Display



No Message Display



Detailed Message Display



AF Area

In different photo shooting modes, you can select different focus methods.
(Adjustable in **PSAM** mode)

1. Press the [**▲ AF**] button to display the settings screen.

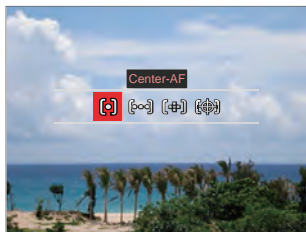

2. Press the [**◀**]/[**▶**] button to select the following 3 modes:

- [**C**] Center-AF
The focus frame appears on the center of the LCD screen to focus on the subject.
- [**M**] Multi-AF
The camera automatically focuses the subject in a wide area to find the focus point.

- [**S**] Spot Focus
Select a single focus point within the scope of focus.

- [**A**] Object Tracking:
Smart tracking of the object in motion under the focusing shooting.

3. Press the [**SET**] button to confirm the settings and enter the shooting screen.

- After enabling spot focus, rolling the jog dial to adjust the position of focus point in the screen.

- The function of object tracking cannot be enabled until successful focus. For tracking the focus, you need to keep the shutter semi-pressed.

Macro Mode

The Macro Setting is ideal for shooting small objects or close-up photos. This mode allows you to focus on subjects very close to the camera.

1. Press the [◀🌸] button to enter the Macro Menu.

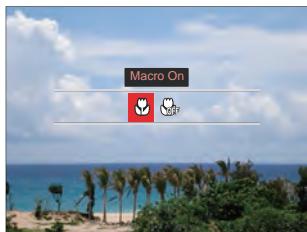

2. Press the [◀🌸]/[▶⚡] button to select the following 2 modes:

- 🌸 Macro On
Select this option to make focusing on the object closer to the lens (At the W side, the shooting distance should be more than 3 cm).
- 🌸 OFF
Select this option to disable Macro.

3. Press the (SET) button to confirm the settings and enter the shooting screen.

Self-timer Mode



Using this function can take photos at regular time. The camera can be set to shoot after 2 seconds, 10 seconds since pressing the shutter or shoot after smile.

1. Press the [▼ 🗑️ 😊] button to enter the self-timer menu.



2. Press [◀ 🗑️]/[▶ 📷] button to select the following 4 modes:

-  Self-timer 2sec
A single picture is shot 2 seconds after the Shutter button is pressed.

-  Self-timer 10sec
A single picture is shot 10 seconds after the shutter button is pressed.
-  Self-timer Smile
Press the shutter button and a picture will be taken immediately after a smile is detected.
-  Self-timer Off
Disables the self-timer.

3. Press the (SET) button to confirm the settings and enter the shooting screen.

-  When enabling the self-timer, pressing the shutter or the [▼ 🗑️ 😊] button can disable the self-timer and return to the shooting screen, and keep the self-timer setting.



When enabling the smile detection, pressing the shutter or the **SET** button can disable the self-timer smile and return to the shooting screen, and keeping the self-timer smile setting.



Self-timer settings will be remained after completion of shooting with self-timer, but which can be canceled in switching modes and on, off the camera.





Flash Mode

The flash is mainly for supplementing light for the scene. The flash is usually used in shooting against the light to highlight the object shot through lightening the object while darkening the background; it is also suitable for metering and shooting in darker scenes through exposure.

1. Press the [] button to enter the flash settings menu.



2. Press the []/[] button to select the following 6 modes:
 - Force Off
Flash is turned off.

-  Fill Flash
The flash will engage with each shot even if there is enough available light to take the photo without flash.
-  Flash Auto
Camera flash goes off automatically based on existing light conditions.
-  Red-Eye Reduction
The camera emits a brief pre-flash before the picture is taken to reduce red-eye effects.
-  Slow Sync.
This allows you to take pictures of people at night that clearly show both your subjects and the night time backdrop. The use of a tripod is recommended when shooting with this setting.
-  Slow Sync.+Red-Eye Reduction
Use this mode for slow synchrony shots with red-eye reduction.

3. Press the  button to confirm the settings and enter the shooting screen.

 After pressing the shutter button half way to make focusing, if the photometric value is less, the flashlight on the top will bounce automatically.

WB (White Balance) Mode







The white balance function allows adjustment of the color temperature for different light sources. (Adjustable in **PSAM** Mode)

Follow the steps below to set white balance of the camera:

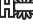

1. Press **(SET)** button to enter white balance menu.



2. Press the **[◀☀]/[▶⚡]** button to select the following 9 modes:

- **AUTO WB** AWB
 -  Daylight
 -  Cloudy
 -  Fluorescent
 -  Fluorescent H
 -  Incandescent
 -  Manual WB
According to the current light source to set WB, Press the **(M)** button to set.
 -  Color Temp. (1900K~10000K)
Press the **(SET)** button to enter and rolling the **(C)** jog dial to adjust the color temperature value.
 - **BKT WB** WB Bracketing
Press the shutter button once to take three photos with different WB settings.
3. Press the **(SET)** button to confirm the settings and enter the shooting screen.

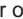
WB Bracketing:

Press the **SET** button to enter options and then press the [**▲ AF**]/[**▼**  ]/[**◀** ]/[**▶** ] directional button to adjust the shift and roll the jog dial to adjust the BKT value (0, 1 and 2).

Rotate clockwise to adjust X axis (B-A).BKT value

Rotate counterclockwise to adjust Y axis (G-M). BKT value

Press the **SET** button to confirm your settings.

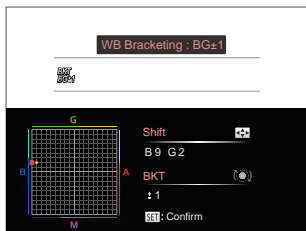

WB bracketing is for setting the bracketing range. Shift to both sides for 3 spaces at most. If at the page border, shift only to the other side and 2 photos can be taken. If no shift, only one photo can be taken.

Continuous Shot Mode

Functions that can be enabled under each mode may be different.

Mode **PSAM** **SCN** **CS**

For setting the single, self-timer, continuous shot, HDR, WDR or AE bracketing functions.





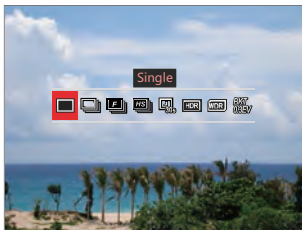

Please follow the following steps to set:





1. Press the  button to enter the continuous shot menu.



2. Press the  button to select the following 8 modes:

-  Single
Capture a single shot only.











-  Continuous Shot
For taking more than one picture continuously.
-  Cont.Shot-Fast (4M)
For continuous shot with 4M pixels.
-  Cont.Shot-High Speed (VGA)
For continuous shot with VGA pixel.
-  Time-Lapse
Take pictures based on the preset interval (30sec/ 1min/ 5min/ 10min). Press the  button to select the interval time.
-  HDR (-1EV, 0EV, +1EV)
This setting is to control the high dynamic image range in taking still pictures, with vivid effect in highlight and that the effect in dark parts can identify the outline and depth of the object. (Use of tripod is recommended)

-  WDR (Wide Dynamic Range)
When the camera detects that there is a big contrast in brightness between scenes and such scenes are against the light, it will automatically adjust the brightness and saturation to capture an image that better represents the scene.
 -  AE Bracketing (0.3EV, 0.7EV, 1.0EV, 1.3EV, 1.7EV, 2.0EV)
The camera will automatically and continuously take three pictures separately with a brightness of original, darker and brighter as long as you press the shutter once. Press the  button to select the range of exposure.
3. Press the  button to confirm the settings and then enter shooting screen.



Exposure Compensation Functions Setting

The EV function menu of the camera includes functions, such as EV adjustment, ISO, shutter adjustment, aperture adjustment, etc. Using the appropriate function settings can improve your pictures.

Please follow the steps below to set:

1. Press the  button to display the settings screen.
4 options in [Exposure Compensation Functions Setting]:
 - EV Adjustment
 - ISO
 - Shutter Speed Adjustment
 - Aperture Adjustment
2. Press the [ ]/[ ] button to select the setting options.
3. Press the [ **AF**]/[  ] button to adjust the option values.
4. Press the  button to complete the setting and enter shooting screen.

EV Adjustment

Set up to adjust the picture brightness. In the case of a very high contrast between the photographed object and the background, the brightness of the picture can be appropriately adjusted. (Adjustable in **PSA**   Mode)

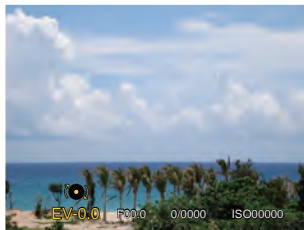

The adjustable range of exposure value is from EV -3.0 to EV+3.0.

ISO

ISO allows you to set the sensitivity of the camera sensor. Please use a higher ISO value in darker places and a lower value in brighter conditions.

(Adjustable in **PSAM** + Mode)

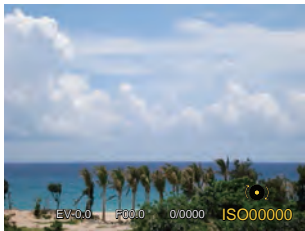

The camera's ISO settings include: automatic, 100, 200, 400, 800, 1600 and 3200.

Shutter Speed Adjustment

For shutter speed, the camera may automatically set the aperture value corresponding to the manually set shutter speed so as to obtain a most suitable exposure value. The movement of object may be shown by adjusting the shutter speed. High shutter value can make you clearly capture the movement of fast moving object while low shutter value can allow you to take a picture for fact moving object with a strong sense of movement.

(Adjustable in **SM** Mode)

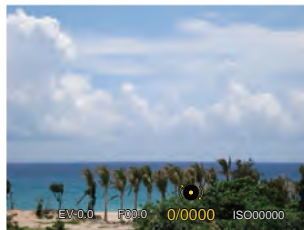

Aperture Adjustment

You can adjust the aperture size value. Selecting a large aperture opening will emphasize the point of focus and show a blurry background and foreground. A small aperture opening will keep both the background and main object in clear focus. (Adjustable in **AM** Mode)

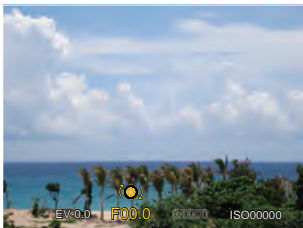

Using Quick Recording

In shooting mode, press the Recording shortcut button  to begin recording video.



15 pictures at most can be taken by pressing the shutter when recording.

The sizes of images taken are as below when playing them back:

FHD -> 2M 

HD -> 1M 

DVD -> VGA 

After recording, press again the  button to save the video and return to the shooting screen.

i Button Function Menu

Functions that can be enabled are different under each mode.



Mode: **PSAM** 



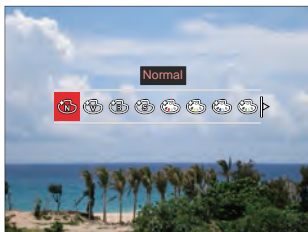



The image color setting allows you to select different color effects.

1. Press the  button to select the Image color setting menu.



2. Press the [ ]/[ ] button to select the image color setting options.

-  Normal
-  Vivid
-  Black and White
-  Sepia

-  Partial Color-Red
-  Partial Color-Yellow
-  Partial Color-Blue
-  Partial Color-Green
-  Dreamy
-  Vignetting
-  Ektachrome
-  Kodachrome
-  Kodacolor
-  Salon
-  Punk
-  Negative
-  Reflection
-  Sketch
-  Fish Eye
-  4 Grids - Stylish(2M)

Using the Lens Function Ring

There is a lens function ring lever in one side of the lens. Moving it up and down can switch among ZOOM/AF, SMART and MF.

Zoom/AF Mode

Rotate the lens function ring for optical zoom.

1. Switch the lens function ring lever to position ZOOM /AF

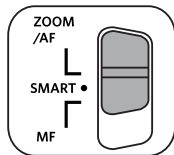

2. Rotate the lens function ring to optically zoom the object.





Rotating the lens function ring in Zoom/AF mode is only for optical zoom.

Function Ring (Smart) Mode

Rotate the lens function ring to set parameters of aperture, shutter, ISO, EV, etc.

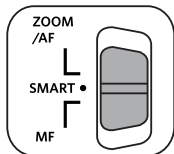

1. Switch the lens function ring lever to position **SMART**.



2. Rotate the lens function ring or rolling the  jog dial to select options needed.



3. Press the  button to complete the setting and enter shooting screen.

 The selection of functions of Function Ring (Smart) in the  menu is needed before using Function Ring (Smart) mode. The default setting is Normal. (See P91 for details)



Options	Referred Pages
Normal	P64
Aperture priority	P66
Shutter priority	P65
EV	P64
ISO	P65
Continuous Shot	P62
Color	P67
White Balance	P60
Image Size	P82
Expo Metering	P79
Flash	P58
AF Area	P55

MF(Manual Focus) Mode

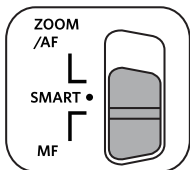

Rotate the lens function ring for manual focus.

1. Switch the lens function ring lever to position **MF**.



If the lens function ring is operated or rolling the  jog dial, the AF enlargement frame will appear on the LCD screen. After clear focus is achieved through manual adjustment, press the  button to close the AF enlargement frame. The camera will return to the normal shooting screen. Semi-pressing the shutter button will have no effect; you need to fully press the shutter button to take a normal photo.







-  The MF assist needs to be enabled with the  button before you need use the manual focus function. (See P85 for details)

PLAYBACK

Viewing Photos and Videos

For viewing taken photos and videos on the LCD screen:





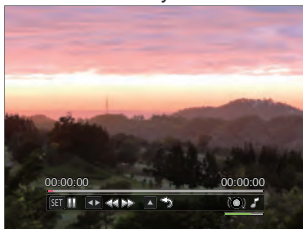

1. After pressing the , the last photo or video clip taken will be displayed on the LCD screen.
2. Use the []/[] button to scroll through the photos or video clips stored in the internal memory or on the memory card.
3. To play a selected video clip, press the  button to enter the movie playback mode. An operation guide appears on the screen when playing back a video. Press the appropriate buttons to enable the corresponding functions.

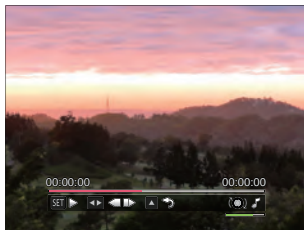



Under Playback











Paused



 	Pause
 	Rewind
 	Fast Forward

	Clockwise Volume Up
	Counterclockwise Volume Down
	Volume
	Mute

 	Play
 	Frame Backward
 	Frame Forward
 	Cancel playback

Thumbnail View

When in playback mode, rotate the zoom lever counter clockwise to the **W** position to display thumbnail images of the photos and videos on the screen.

W Zoom Out ← → T Zoom In

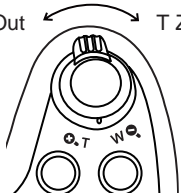

1. Slide the zoom lever to switch between 3x3 and 4x4 thumbnails.

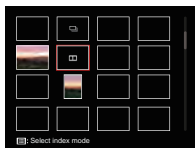
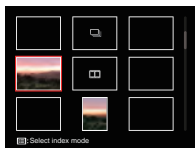

2. Press the arrow buttons to select a picture or video clip to view and press the **SET** button to restore it to the original size.
3. As shown in the picture, press the **SET** button to select index mode.

4 options in [Index Mode] :







- Single Index
- Date Folder
- Cont. Group
- Play Slide Show

 When the icon  appears, it means this is a video file.





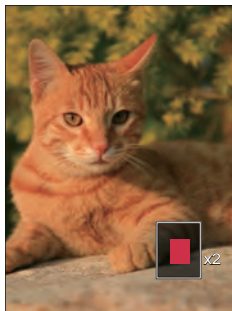
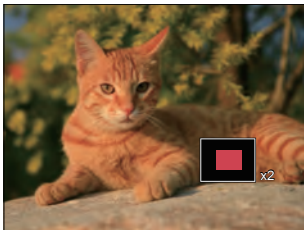

 When the icon  appears, it means this is a continuous group file.

Using Zoom Playback (for still pictures only)

When playing back photos, you can also use the zoom lever to zoom in on the photos 2 to 8 times.

1. Press the  button to switch to playback mode.
2. Press the [ ] / [ ] button to select a picture to be zoomed in.
3. Rotate the zoom lever clockwise to  to zoom in.
4. Rolling the  jog dial clockwise to zoom in and counterclockwise to zoom out.
5. The bottom right corner of the screen will display the number of times and area of the photo zooming operation.







6. Press the [ **AF**] / [  ] / [ ] button to navigate and select a part of the image to be zoomed in.
7. Press the  button to return the image to its original scale.



Movie images cannot be magnified.

Continuous Shot Group Playback

Ultra-high speed (VGA) and high speed (4M) can make Continuous Shot for group image playback.

1. Press the  button to enter playback screen.
2. Press the [][] button to select continuous group.
3. Press the  button to start playback.







Cont. Group







Playing



Pause

 	Pause
 	Cancel Play (back to 1:1 playback for continuous group)





Playing

	Play
	Previous photo (loop available only in continuous group)
	Next photo (loop available only in continuous group)
 	Cancel Play (back to 1:1 playback for continuous group)

Pause

Animation panorama play

Panoramic animation playing is to play full size image in accordance with the shooting direction. After playing, it will automatically return to the static screen of panoramic image.

1. Press the  button to enter playback screen.
2. Press the []/[]/[] button to select animated panoramic photos.
3. Press  button to play in selected shooting direction.





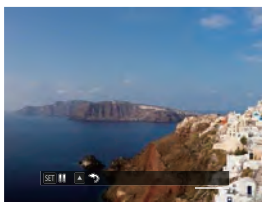

Video Panorama





Playing



Pause

 	Pause
 	Cancel Play

 In the process of panoramic animation playback, press the  button to stop playing and return to the playback screen.

 Picture will not be rotated during panorama play or pause.