

»PRACTICE»PLAY»WIN™



CATAPULT™

SET-UP INSTRUCTIONS



Includes:

- » Catapult Pitching Machine
- » AC Adapter

BEFORE YOU BEGIN:

- » Make sure you have all of the Catapult™ components. Please contact SKLZ customer service toll free at 877-225-7275 x128 if you are missing anything.
- » Read all setup and usage instructions carefully.
- » Adult assembly recommended.

CATAPULT PARTS:

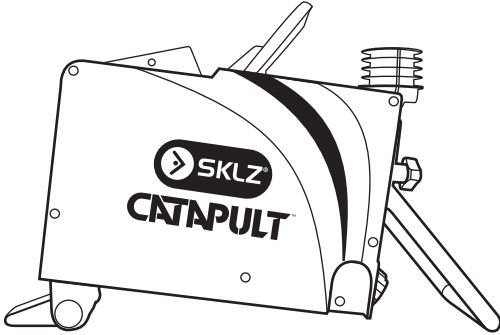

A – Catapult Base

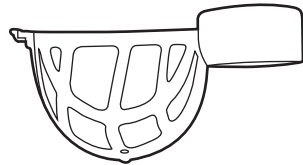

B – Spiral Ball Funnel Top

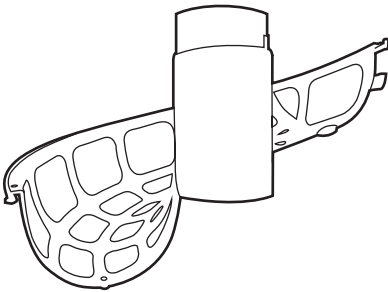

C – Spiral Ball Funnel Mid-Section

D – Spiral Ball Funnel Bottom
(Parts C & D are identical)

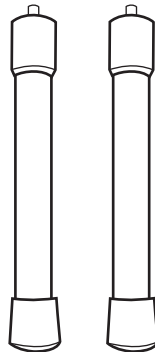

E – Legs (2)

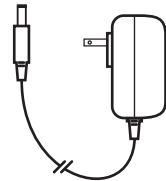

F – AC Adapter

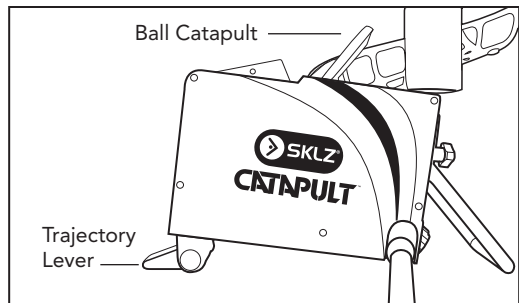
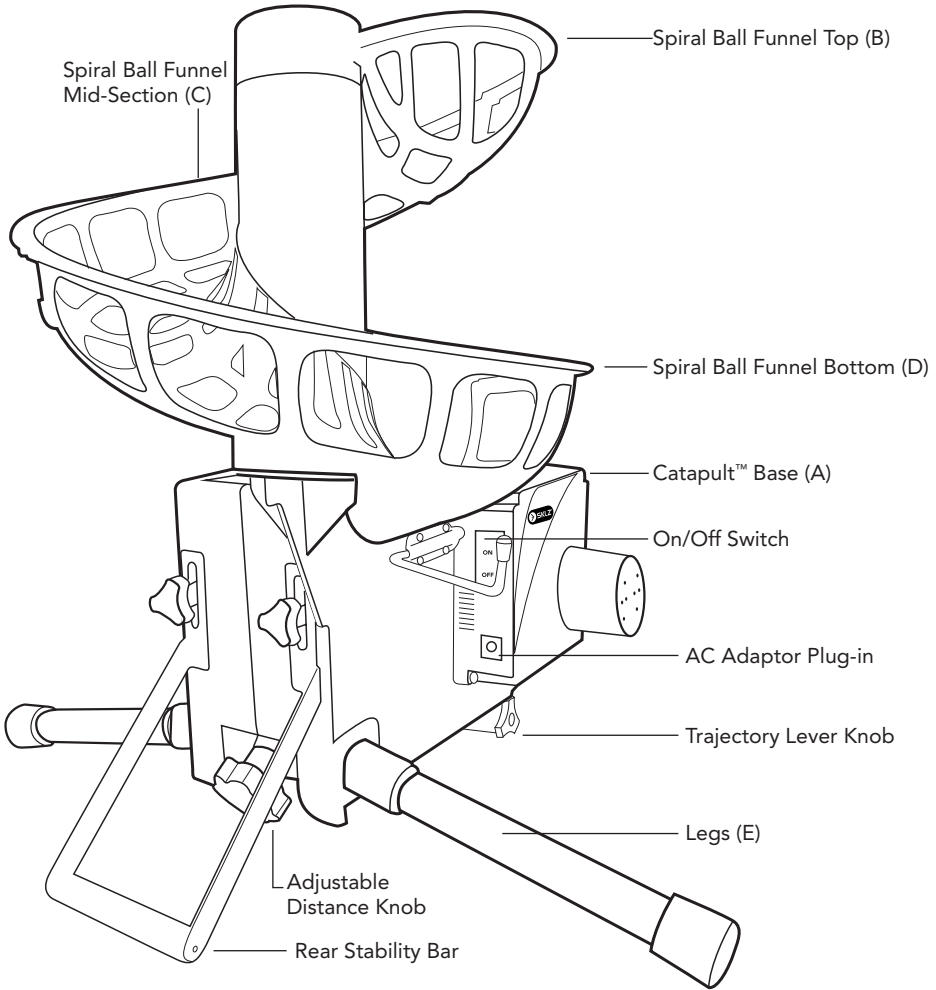

⚠WARNING:

- » Do not put hands or fingers inside the Catapult™ with the power cord plugged in or batteries in the unit.
- » Make sure all persons and pets are clear of the Catapult and the path of the ball before powering on.
- » Make sure Catapult is aimed and functioning properly before allowing a batter to step towards the Catapult and hit balls.
- » The Catapult is designed to use regulation 5-ounce weight and 9-inch circumference baseballs.
- » Always operate under adult supervision.
- » Anyone hitting balls must wear a NOCSAE Approved batting helmet.

CAUTION:

- » Do not power Catapult on without balls in the loader. This can damage the Catapult throw arm.
- » Only operate the Catapult on level surfaces.
- » Adjust the rear stability bar to ensure Catapult is level.
- » Do not position the Catapult directly in front of batter and do not hit balls towards the Catapult. If the Catapult is struck by a ball, permanent damage may occur.
- » Do not allow dirt or moisture to get into the Catapult. Store indoors when not in use.

CATAPULT™ ASSEMBLY:

STEP 1—ATTACH LEGS TO CATAPULT BASE

Attach one Leg (E) to each side of the Catapult Base (A) by screwing into place.

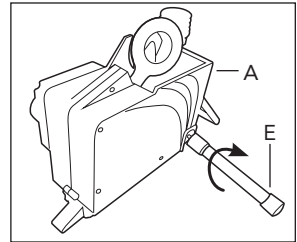

STEP 2—ASSEMBLE SPIRAL BALL FUNNEL

Attach Spiral Ball Funnel Top (B) to Mid-Section (C) by aligning notches. Lock into place by connecting push-thru tab on end of Spiral Ball Funnel. Attach Spiral Ball Funnel Bottom (D) in the same manner.

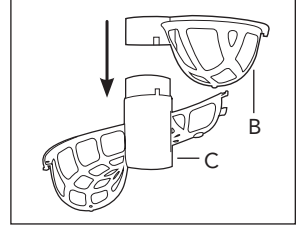

STEP 3—ATTACH SPIRAL BALL FUNNEL TO CATAPULT BASE

Lower center of Spiral Ball Funnel on to cylindrical fitting at top of Catapult Base (A). Align end of funnel with u-shaped opening on Catapult Base (A). Secure by connecting push-thru tab on side of Catapult Base and end of Spiral Ball Funnel.

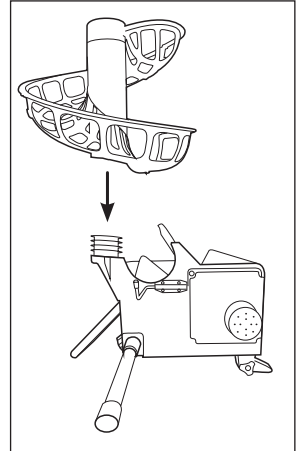

CATAPULT USAGE:

ADD BALLS TO MACHINE

Prior to starting the machine add up to 8 balls to the Spiral Ball Funnel.

ADJUST BALL FLIGHT ANGLE

WARNING: Before adjusting the ball flight angle turn OFF the Catapult.

Loosen the trajectory lever knob at the front of the machine. Adjust leg up or down to adjust the ball flight angle. Tighten trajectory lever knob.

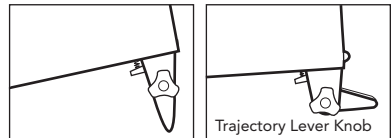

Stabilize Catapult by adjusting the rear stability bar. Unscrew knobs on both sides of the bar and adjust height so that the bar rests on the ground. Secure into place by tightening each knob.

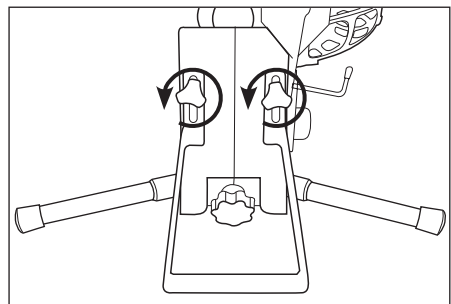

ADJUST BALL THROWING DISTANCE

WARNING: Before adjusting the ball throwing distance turn OFF the Catapult™ so no balls are pitched.

Using the adjustable distance knob, tighten to increase ball throwing distance, loosen slowly to decrease ball throwing distance.

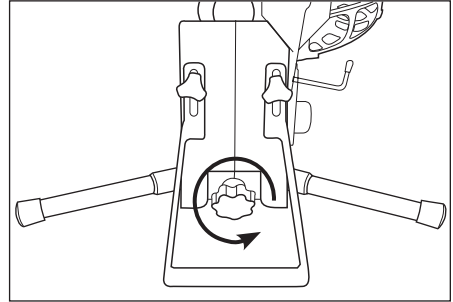

POWER UP MACHINE

The Catapult runs on 4 D Batteries (not included) or with the provided AC Adapter. If using the AC Adapter, connect to the side of Catapult Base below the power switch.

If using batteries flip the Catapult over. Press down on the black tab and slide the battery cover off. Install batteries as shown.

Turn product ON to power up and OFF to power down. Ensure all persons and pets are clear of the Catapult and the path of the ball before powering on.

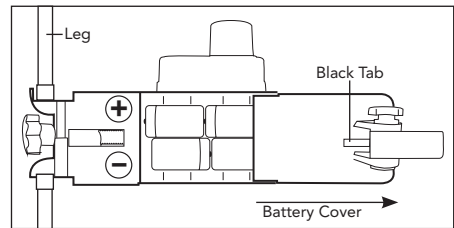

CATAPULT DRILLS:

The Catapult helps you sharpen both your offensive and defensive skills.

SOFT TOSS

Use regulation baseballs for hitting training during practice or pregame warm-up. The Catapult can be used in multiple positions for a variety of drills to improve swing mechanics and timing. Drills can be performed by right or left handed batters.

RECOMMENDED CATAPULT POSITIONING

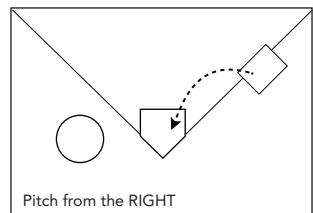
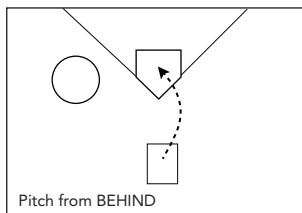
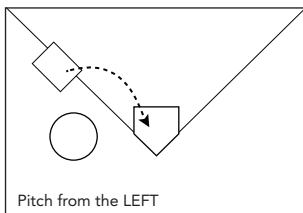

POP FLIES

Use 9-inch plastic balls for pop fly practice. Set the throwing distance and ball flight angle to desired position and begin practice.

DOUBLE PLAYS

Use regulation baseballs to practice footwork and glove-hand ball transfer. Position the Catapult to simulate the preferred double play feed angle (for example, position the Catapult between first and second base to simulate a feed from the second baseman).

Set the throwing distance and ball flight angle to desired position and begin practice.

PERFECT FOR PRACTICE WITH QUICKSTER™ NET

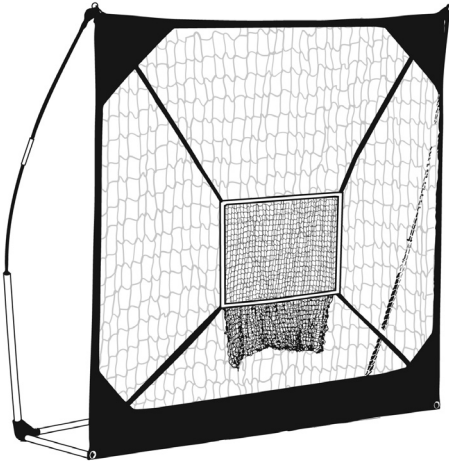

- » Sets up and breaks down in under 90 seconds
- » Sturdy and stable for youth and elite players
- » Ultra-durable design for high-intensity training
- » Lightweight, easy to pack, carry and store
- » Removable pitching target included
- » Available in two sizes: 5' x 5' and 7' x 7'

90-DAY LIMITED WARRANTY – CATAPULT™

Pro Performance Sports (PPS) warrants to the original consumer purchaser of any PPS product it manufactures that the product will be free of defects in materials or workmanship for 90 days (unless specified in alternate warranties) from the date of purchase. If defective, and purchased from a retail store, return the product along with receipt to the retail store where the product was purchased. If the item was purchased from PPS, return the product along with proof of the date of purchase (i.e. the packing slip), postage prepaid to the address below for replacement consideration:

Pro Performance Sports :: 5823 Newton Drive :: Carlsbad, CA 92008 :: Attn: Returns

This warranty does not cover damages resulting from accident, misuse, abuse or lost merchandise. Only valid in the USA. All returns sent to PPS require a Return Merchandise Authorization number (RMA). For returns to PPS and for all other Customer Service inquiries, please call toll free: 1-877-225-7275

Register your product at SKLZ.com to ensure warranty coverage, get new product information and special deals from SKLZ



Like us on Facebook:
facebook.com/SKLZfans



Follow us on Twitter:
@teamSKLZ

DO YOU HAVE A WINNING SPORTS PRODUCT OR IDEA?

Visit our website to learn how to submit a product application for consideration.
It may become our next winning product!

SKLZ.com



Made in China
©2011 Pro Performance Sports.
All rights reserved.
Unauthorized duplication is
a violation of applicable laws.
U.S. Patent Pending

