



Toucan Surveillance Kit 2.0

# Camera & Smart Socket

**USER'S MANUAL**

*Model: TSK200KU*

**[VuPoint]**  
Solutions

# Table of Contents

1.	Key Features	2
2.	What is Included	5
3.	Positioning	8
4.	Toucan Installation	9
5.	Status LED Indicators	13
6.	Specifications	14
7.	Troubleshooting & FAQ	15
8.	Regulations & Compliance	16



**WARNING:** FOR USE ONLY with 120 volt CFL or LED bulb.



**WARNING:** For use in dry or damp locations.



**WARNING:** Toucan camera incompatible with motion security light fixtures.



**CAUTION:** Smart Socket do not exceed 40 watt maximum in CFL or LED load.

# 1. Key Features

## Toucan Camera 2.0

Prevent a Break In, before it happens.



### Easy 3-Steps Installation

- DIY installation in minutes; no need to pull wires



### 2-way communication

- Built-in microphone and high-fidelity speaker for clear audio communication



### Wireless Connectivity

- Built-in WiFi® and Bluetooth® technology



### 100dB Siren Alarm

- Sound the alarm instantly to unwanted visitors



### Wide Angle Adjustable Lens

- Clear FHD LIVE video feed and event recording capture



### Durable Design

- Withstands high humidity and house maintenance year-round



### Passive Infrared Sensor

- Detects change in motion

# 1. Key Features

## Smart Socket

Easy to install the smart socket



### Adapt to lamp fixture

- Simply thread in E26 adapter between fixture and the bulb



### Remote Light Control

- Turn on and off the lights



### Mesh Network Connectivity

- Total security solution for entire home with **Bluetooth® technology**



### USB power adapter

- Provides power to camera



### Schedule dusk-to-dawn

- Timer feature to schedule light to turn on at dusk and off at dawn through cloud system

## Functions on the Kuna Light app

Free app to receive automatic notifications, view live video, and speak directly to those at your door. Events captured up to 2 hours and stored in Cloud Server. Never miss a moment!

### Automatic Notifications

### Live video indicator

### 100dB Siren Alarm

- Sound the alarm instantly to unwanted visitors

### Play Message

- Pre-recorded messages

### LIVE Camera

### View Recorded Videos

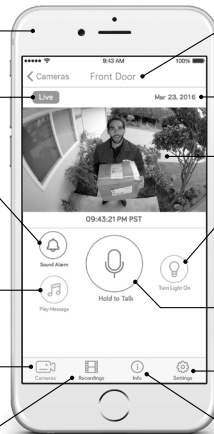

### Toucan Camera Name

- Set up by user

### Date

### Wide Angle LIVE view

### Light control

- Turn ON/OFF the lights

### Hold to talk

- 2-way communication

### Camera setting

### App and Contact Info

\*User interface is subject to change without prior notice.

## 2. What is Included

Before installing Toucan, make sure all parts are present.

If any part is missing, please contact VuPoint Solutions at [support@vupointsolutions.com](mailto:support@vupointsolutions.com).

### Camera Products



#### Toucan Camera 2.0

- Mount camera under light fixture



#### Smart Socket

- Thread in between light fixture and light bulb. USB port provides power to camera.



#### USB cable with Silicon sleeve

- Connect camera to socket for power source. Silicon sleeve protects USB cable when installing lamp sconce on fixture.

### Accessory - Step 2



#### Mount Screws (2pcs)

- Wall mount purpose



#### Washers (2pcs)

- Wall mount purpose



#### Wall Inserts (2pcs)

- Wall mount purpose



#### Positioning Sticker

- Indicator for camera's position on the wall during installation

### Accessory - Step 3



#### Camera Back Plate

- Fix the cable position on back plate



#### Back Plate Cover

- Fix the cable position



#### Conduit Cover

- Fix the conduit and cable position



#### Cable Clips (6pcs)

- Manage the cable on light base plate



#### Conduit

- Manage the cable between cable and light fixture with adjustable length



#### Visor

- Prevents glare from light bulb.



#### Hexagonal Wrench

- Lock and unlock the camera on back plate

## 2. What is Included

### Manual and Labels



User's Manual



Warranty Card



**Power Sticker**  
• Stick on main power switch

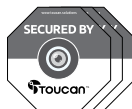

**Secure Stickers (3pcs)**  
• Alert intruder that home is secured by Toucan



5 Stars Care Card



Quick Start Guide

## 3. Positioning

Smart Socket is compatible with standard A15 and A19 light bulbs. If your lamp sconce height is less than 7 inches, or if your light bulb protrudes from your light fixture after threading in Smart Socket and light bulb, please consider changing to a smaller light bulb.

### Lightbulb



A15



A19

### Light fixture with socket

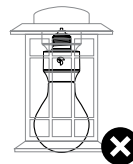
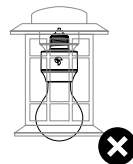
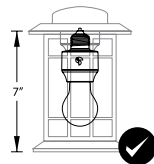

We recommend positioning the camera beneath the light fixture. If the camera is placed approx. 5" beneath the lamp base against the wall, please install the conduit to manage the cables.

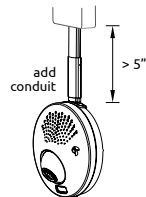
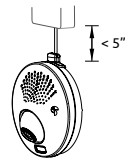

\*Placement recommendations may vary based on different light fixture's designs, style, and size.

## 4. Toucan Installation

Before installation, make sure the power switch is OFF or disconnect power at the fuse.  
Refer to "What Is Included" in Section 2 for part installation for the steps below:

### STEP 1 Socket installation

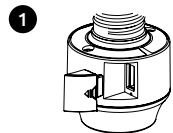

Remove USB cover. Before installing the socket into light fixture, disassemble the lamp sconce if necessary.

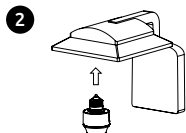

Install **Smart Socket** to fixture.

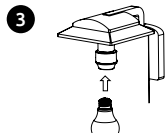

Thread in light bulb.

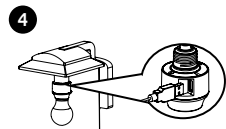

Attach **USB Cable** to **Smart Socket**.

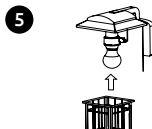

Reattach lamp sconce if necessary.

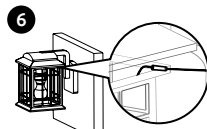

Screw lamp sconce back in and drag out USB cable through the shade then adjust **Silicon sleeve** from USB cable to protect cable.

\* For 2 sockets pack, one socket is for backup purpose.

\*\* Do not over tighten the sconce screw during reattached sconce, it may cause the wire break.

9

### STEP 2 Mounting the camera's back plate

Lens mark for camera positioning and leveler to align and balance back plate. You can use Positioning Sticker (included) to mark placement before adhering to your wall.

Refer to **Option 1** to mount camera to wall with adhesive or **Option 2** to mount camera to wall with screws.

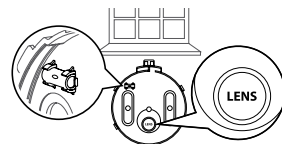

#### OPTION 1 Mounting with adhesive

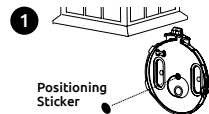

Positioning Sticker

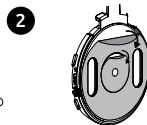

After using the **Leveler** to adjust the orientation of the plate, adhere the **Positioning Sticker** to mark the center of the plate.

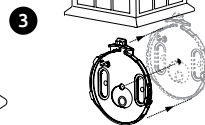

Remove \*adhesives from back plate for a more stable placement of the camera to the wall.

Align back plate with the **Positioning Sticker** on the wall to center the plate.

#### OPTION 2 Mounting with screws

After using the **Leveler** to adjust the orientation of the plate, you can use a pencil to mark the placement for the screws.  
\*\*Drill holes for screws placement. Install **Wall Inserts**.  
Mount back plate with **Washers** and **Screws**.

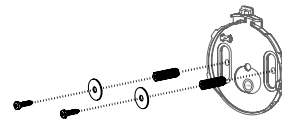

\* This 3M tape is strong and it may peel off wall paint, especially if the paint was not applied properly.

\*\* Usual case in drywall or wooden.

10

# 4. Toucan Installation

## STEP 3 Camera body installation

1

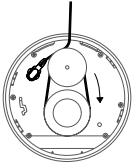

Plug **USB Cable** into the back of the camera and loop the cable around the rings; continue looping the cable if necessary.

2

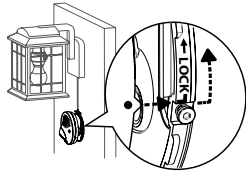

Mount the camera to the back plate and align the white dot to the left of the screw at the tail of the white arrow and rotate camera counter-clockwise to lock.

5



Tighten the security screw with hexagonal wrench. **Do not over-tighten the security screw.**

6

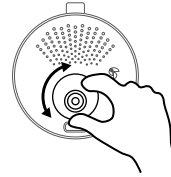

Press lens down with fingers to turn the lens to desired position.

3

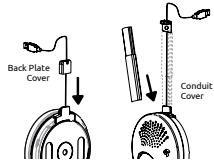

Manage the cable with optional **Conduit**.  
1) Attach the **Back Plate Cover** to the back plate if conduit is not used. 2) Attach conduit then the **Conduit Cover** on top.

4

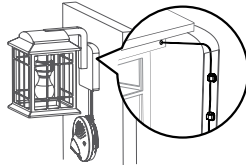

Position camera and use **Cable Clips** to manage the cable if necessary.

7



Attach **Visor** to the top of the camera lens.

## 5. Status LED Indicators

In order to set up your Toucan, please make sure it's successfully installed, and the status LED on the bottom left side of your Toucan camera is flashing red. This means that your Toucan is ready to be set up!

### LED STATUS

### DESCRIPTION

Solid Red	Booting
Flashing Red	Waiting for Wi-Fi Connection
Flashing Yellow	Connected to Wi-Fi Waiting for connection to Kuna Servers
Solid Blue	Connected to Kuna Servers and operating normally
Solid Purple	Firmware updating triggered by user

## 6. Specifications

### Toucan Camera (Model: TC200KU)

Camera	FHD 1080p resolution
Video resolution	1920x1080 at 30 fps. H.264
Field of View	160 degrees (diagonal)
Wi-Fi®	2.4GHz & 5GHz 802.11 a/b/g/n/ac
Bluetooth®	Bluetooth® BLE 4.0
Siren Alarm	100 dB
Lighting Control	On/Off/Scheduling with app
Weatherproof Design	Yes
Dimensions (L×H×W)	4.6" x 4.6" x 1.9"
Microphone	Built-in
Speaker	Built-in
Input Voltage	DC:5V/1.0A
Compatibility	iOS: 5 or above / Android : 4.3 or above
Operating temperature	-40°F - 113°F

### Toucan Smart Socket (Model: TS100WU)

Lamp Base Type	Socket type E26
USB Output	DC5V, 1A
Input	AC120V, 60Hz
Lighting Control	On/Off/Scheduling through BLE Mesh Network
Bluetooth®	Bluetooth® BLE 4.0
Light bulb	Support maximum 40W standard bulb; Recommended 10W LED light bulb. (not included in both)
Dimensions	2" (Dia.) x 3"
Operating temperature:	-40°F - 113°F



## 7. Troubleshooting & FAQ

**Note:** Model Number and Serial Number (S/N) is located on the packaging, instruction manual, or on the product. Please have this information ready before contacting tech support.

### Frequently Asked Questions

- |   |   |  |
|---|---|--|
| 1 | How long will my recordings be available?                               | All Toucan units come standard with a two-hour download and “look back” window. With premium subscription plans, you can “go back in time” to access every event that your Toucan generated for up to 30 days.   |
| 2 | Do I have to leave my light switch on?                                  | Yes, Toucan uses power continuously, so you will have to leave the light switch on. We have provided with your Toucan a “Keep it On” label as a reminder to leave the switch on.   |
| 3 | How many Toucan Cameras can I install at home?                          | There’s no limit. We recommend installing Toucan at all major entry points. You can add multiple cameras to your Kuna Light app and manage each camera all in one app.   |
| 4 | Can I use LED bulb with Toucan?   | Yes, we recommend that you use an LED bulb.  |
| 5 | What is the maximum light bulb wattage I can use with the Smart Socket? | Smart Socket supports up to maximum 40W.   |
| 6 | I do not see any Toucan camera show up in setup screen?                 | Toucan uses Bluetooth® LE 4.0 for setup. You will need to be within about 10 feet of the Toucan and have Bluetooth enabled on your mobile device. Try rebooting your mobile device and launch the Kuna Light app again.  |
| 7 | My Toucan is “offline”?   | <ol style="list-style-type: none"><li>1) <b>Reboot your Toucan:</b> Turn off your Toucan (using the light switch it’s connected to) and wait at least 10 seconds. Then, turn on the light switch back on.</li><li>2) <b>Run through the set-up process:</b> Re-add the Toucan camera again. This may be caused by weak Wi-Fi signal. Improve performance by moving your router closer to your Toucan, or adding a Wi-Fi extender in between.</li></ol> |

**Note:** If you need to change the router or ownership of your Toucan, please contact Kuna Customer Service to reset the Toucan.

## 8. Regulations & Compliance

### SAFETY & OPERATIONS

#### IMPORTANT SAFETY INSTRUCTIONS

Please adhere to the following safety instructions. Failure to follow the instructions outlined in the user’s manual may lead to serious personal injury and possible property damage.



Smart Socket USB power output max. up to 5W.  
The socket must be installed in the listed lampholder.



USB connector use only with the Camera Model: TC200KU.  
Class 2 output connections are not intended for supporting products or appliances.



Use only the USB cable packaged with the Camera Model: TSK200KU. The Smart Socket and USB cable may become warm during normal use. Always allow adequate ventilation around the smart socket and USB cable and use care when handling. Unplug the device if any of the following conditions exist:

- the USB cable or Smart Socket has become frayed or damaged
- the USB connector or Smart Socket is exposed to rain, liquid, or excessive moisture
- the USB cable or Smart Socket has become damaged
- you suspect the USB cable or Smart Socket needs service or repair
- you want to clean the USB cable or Smart Socket

#### SAVE THESE INSTRUCTIONS



# 8. Regulations & Compliance

---

## FCC STATEMENT

Warning: Changes or modifications to this unit not expressly approved by the party responsible for compliance could void the user's authority to operate the equipment.

NOTE: This equipment has been tested and found to comply with the limits for a Class B digital device, pursuant to Part 15 of the FCC Rules. These limits are designed to provide reasonable protection against harmful interference in a residential installation. This equipment generates, uses and can radiate radio frequency energy and, if not installed and used in accordance with the instructions, may cause harmful interference to radio communications.

However, there is no guarantee that interference will not occur in a particular installation. If this equipment does cause harmful interference to radio or television reception, which can be determined by turning the equipment off and on, the user is encouraged to try to correct the interference by one or more of the following measures:

- Reorient or relocate the receiving antenna.
- Increase the separation between the equipment and receiver.
- Connect the equipment into an outlet on a circuit different from that to which the receiver is connected.
- Consult the dealer or an experienced radio/ TV technician for help.

This device complies with Part 15 of the FCC Rules. Operation is subject to the following two conditions:

- (1) This device may not cause harmful interference.
- (2) This device must accept any interference received, including interference that may cause undesired operation.

The transmitter must not be co-located or operated in conjunction with any other antenna or transmitter. This equipment complies with the FCC RF radiation exposure limits set forth for an uncontrolled environment. This equipment should be installed and operated with a minimum distance of 20cm between the radiator and any part of your body.

- (i) the device for operation in the band 5150–5250 MHz is only for indoor use to reduce the potential for harmful interference to co-channel mobile satellite systems;

- (ii) For devices with detachable antenna(s), the maximum antenna gain permitted for devices in the bands 5250-5350 MHz and 5470-5725 MHz shall be such that the equipment still complies with the e.i.r.p. limit;
- (iii) the worst-case tilt angle(s) necessary to remain compliant with the e.i.r.p. elevation mask requirement set forth in Section 6.2.2(3) shall be clearly indicated.

Until further notice, devices subject to this section shall not be capable of transmitting in the band 5600-5650 MHz. This restriction is for the protection of Environment Canada's weather radars operating in this band.

Camera FCC ID: 2ABT4TC200KU

Socket FCC ID: 2ABT4TS100WU

---

## IC CAUTION

This device complies with Industry Canada licence-exempt RSS standard(s).

Operation is subject to the following two conditions:

- (1) This device may not cause interference, and
- (2) This device must accept any interference, including interference that may cause undesired operation of the device.

*Le présent appareil est conforme aux CNR d'Industrie Canada applicables aux appareils radio exempts de licence. L'exploitation est autorisée aux deux conditions suivantes:*

- (1) l'appareil ne doit pas produire de brouillage, et*
- (2) l'utilisateur de l'appareil doit accepter tout brouillage radioélectrique subi, même si le brouillage est susceptible d'en compromettre le fonctionnement.*

Camera IC: 21342-TC200KU

Socket IC: 21342-TS100WU

---

App Store<sup>SM</sup> is a service mark of Apple Inc. Google Play<sup>TM</sup> and Android<sup>TM</sup> are registered trademarks of Google Inc. Wi-Fi<sup>®</sup> is a registered trademark of the Wi-Fi<sup>®</sup> Alliance. Kuna is a registered trademark of Kuna Systems Corporation, Bluetooth<sup>®</sup> word mark and logo are registered trademarks owned by Bluetooth SIG, Inc. Toucan is a registered trademark of VuPoint Solutions, Inc. All trademarks are the property of their respective owner.

U.S. Patent Pending

TSK200KU\_Manual\_16-0831

