

Quick-Start Guide

RemoteLinc™ 2 - INSTEON® Wireless Controller

Model: 2342-2

Model: 2342-3

Introduction

Use the power of INSTEON to control your home with the convenience of a compact and versatile wireless controller.

What's Included

- RemoteLinc 2

Getting Started

It is recommended that you fully charge your RemoteLinc 2 prior to programming. RemoteLinc 2 charges via a USB cable (Type A to Micro-B, sold separately). The red charging LED will turn off once the battery has been fully charged.

To turn on RemoteLinc 2, simply slide the power switch to the on position.

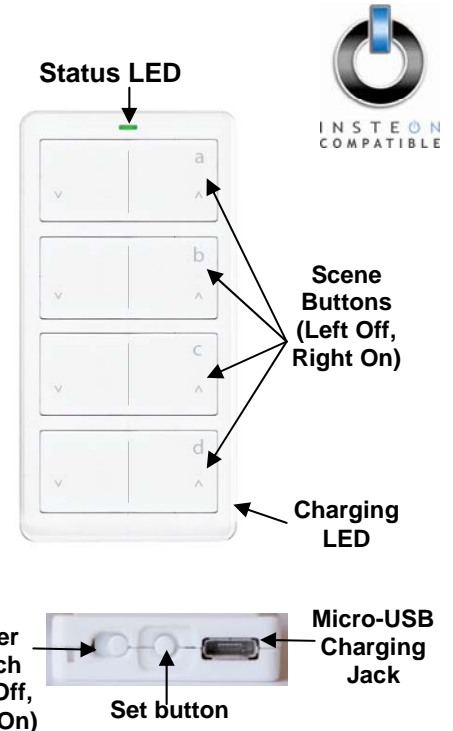

Add RemoteLinc 2 (Button) to a Scene as a Controller

- 1) Tap on "^" on the RemoteLinc 2 scene button of choice
- 2) Adjust the responder to the "state" you want when the scene is activated from RemoteLinc 2¹
- 3) Press & hold RemoteLinc 2's Set button until the RemoteLinc 2 beeps
RemoteLinc 2's LED will begin blinking GREEN
- 4) Press & hold the responder's Set button until the responder beeps (or until LED/Load flashes)
RemoteLinc 2 will double-beep and its LED will stop blinking
Responder's LED will stop blinking (it may also double-beep)
- 5) Confirm that scene addition was successful by tapping on/off on your chosen RemoteLinc 2 button
The responder will toggle between the scene on level and off

¹ If the responder is a multi-scene device, tap the Scene button you wish to control until it's LED is in the desired state (on or off)

Using RemoteLinc 2

RemoteLinc 2 contains four on/off button pairs. Each pair controls its own scene, sending commands to devices linked specifically to the on/off button pair. Dimmable responders may behave differently, depending on whether you tap, double-tap, or press & hold a button to activate/deactivate a scene. Non-dimming responders will only turn full-on or full-off, no matter what method you use.

Tap	Double-tap	Press & hold
Ramp to on-Level or off	Full-bright or full-off instantly	Brighten or dim until released
<i>The RemoteLinc 2 Status LED will flash GREEN once for each ON/BRIGHT command sent and RED once for each OFF/DIM command sent</i>		

Warning: RemoteLinc 2 is permanently sealed. Do not attempt to open case. Doing so will damage the remote.

FCC Compliance

This device complies with FCC Rules Part 15. Operation is subject to two conditions:

- (1) This device may not cause harmful interference, and
- (2) This device must accept any interference that may be received or that may cause undesired operation.

The digital circuitry of this device has been tested and found to comply with the limits for a Class B digital device, pursuant to Part 15 of the FCC Rules. These limits are designed to provide reasonable protection against harmful interference in residential installations. This equipment generates, uses and can radiate radio frequency energy and, if not installed and used in accordance with the instructions, may cause harmful interference to radio and television reception. However, there is no guarantee that interference will not occur in a particular installation. If this device does cause such interference, which can be verified by turning the device off and on, the user is encouraged to eliminate the interference by one or more of the following measures:

- Re-orient or re-locate the receiving antenna of the device experiencing the interference.
- Increase the distance between this device and the receiver.
- Connect the device to an AC outlet on a circuit different from the one that supplies power to the receiver.
- Consult the dealer or an experienced radio/TV technician.

WARNING! Changes or modifications to this device not expressly approved by the party responsible for compliance could void the user's authority to operate the equipment.

Industry Canada Compliance

This device complies with Industry Canada license-exempt RSS standard(s). Operation is subject to the following two conditions: (1) this device may not cause interference, and (2) this device must accept any interference, including interference that may cause undesired operation of that device.

Le présent appareil est conforme aux CNR d'Industrie Canada applicables aux appareils radio exempts de licence. L'exploitation est autorisée aux deux conditions suivantes: (1) l'appareil ne doit pas produire de brouillage, et (2) l'utilisateur de l'appareil doit accepter tout brouillage radioélectrique subi, même si le brouillage est susceptible d'en compromettre le fonctionnement.

Owner's Manual & Tech Support

Owner's Manual: www.smarthome.com/manuals/2444A2xx4.pdf - Phone: 800-762-7845

For the most up-to-date Quick Start Guide visit <http://www.smarthome.com/manuals/2444A2xx4qs.pdf>