

Quick-Start Guide

INSTEON® 240V 30 AMP Load Controller (Dual-Band)

**Models: 2477SA1 – Normally Open Relay
2477SA2 – Normally Closed Relay**



Introduction

Remotely control your appliances that run on voltages between 120 and 240 volts, up to 30 Amps. Weatherproof case allows for use with appliances located outdoors.

Preparation

Because this product involves high voltage levels, it is recommended that installation be performed only by a qualified electrician or by a homeowner who is extremely knowledgeable and familiar with electrical circuitry. Please take an extra level of precaution when installing this product. If you have any questions regarding installation, we suggest consulting an electrician.

Tools Needed

- Screwdriver (to remove cover of junction box)
- Wire cutter / stripper
- Various tools to mount 240V Load Controller to a wall

Installation

- 1) At the circuit breaker or fuse panel, disable the circuit supplying power to the electrical junction box that is wired to the appliance you wish to control with 240V Load Controller
- 2) Remove the cover of the junction box and disconnect the two supply lines coming from the circuit breaker, ensuring that you have 1/2" bare and clean copper wire on the ends.
- 3) See Figure 1 on the next page to properly connect 240V Load Controller to your appliance and the junction box. Connect the 240V Load Controller wires to the wires of the same color on your appliance and junction box wherever possible.
- 4) Ensure that all wire connectors are firmly attached and that there is not exposed copper except for the GROUND wire
- 5) Enable power to the junction box from the circuit breaker or fuse panel
- 6) Test that 240V Load Controller is working properly by pressing the Set button to toggle your appliance off, and then on

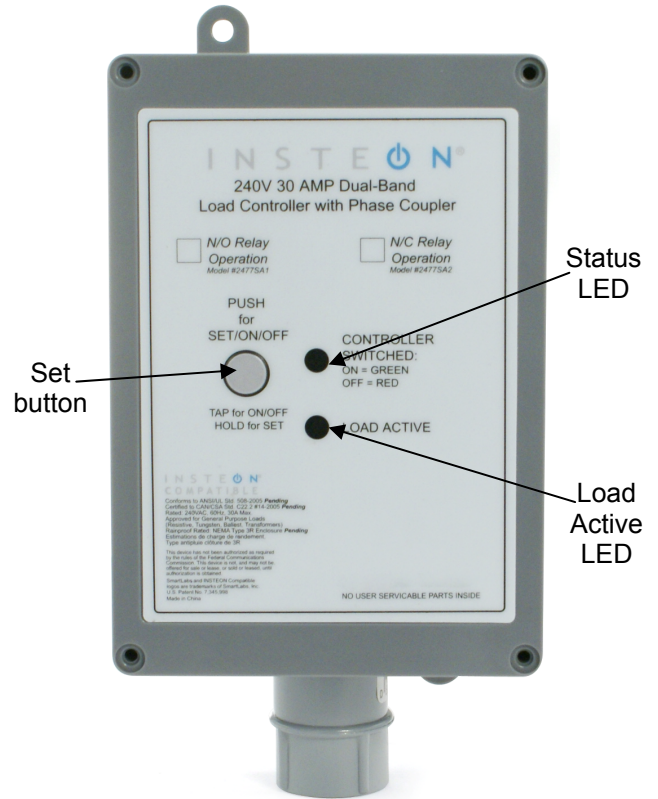

Using 240V Load Controller

Use the Set button on 240V Load Controller to toggle the attached load on and off

The Status LED will be solid green when the attached load is on and solid red when the load is off

The Load Active LED will be solid amber or green as long as the appliance is wired to 240V Load Controller

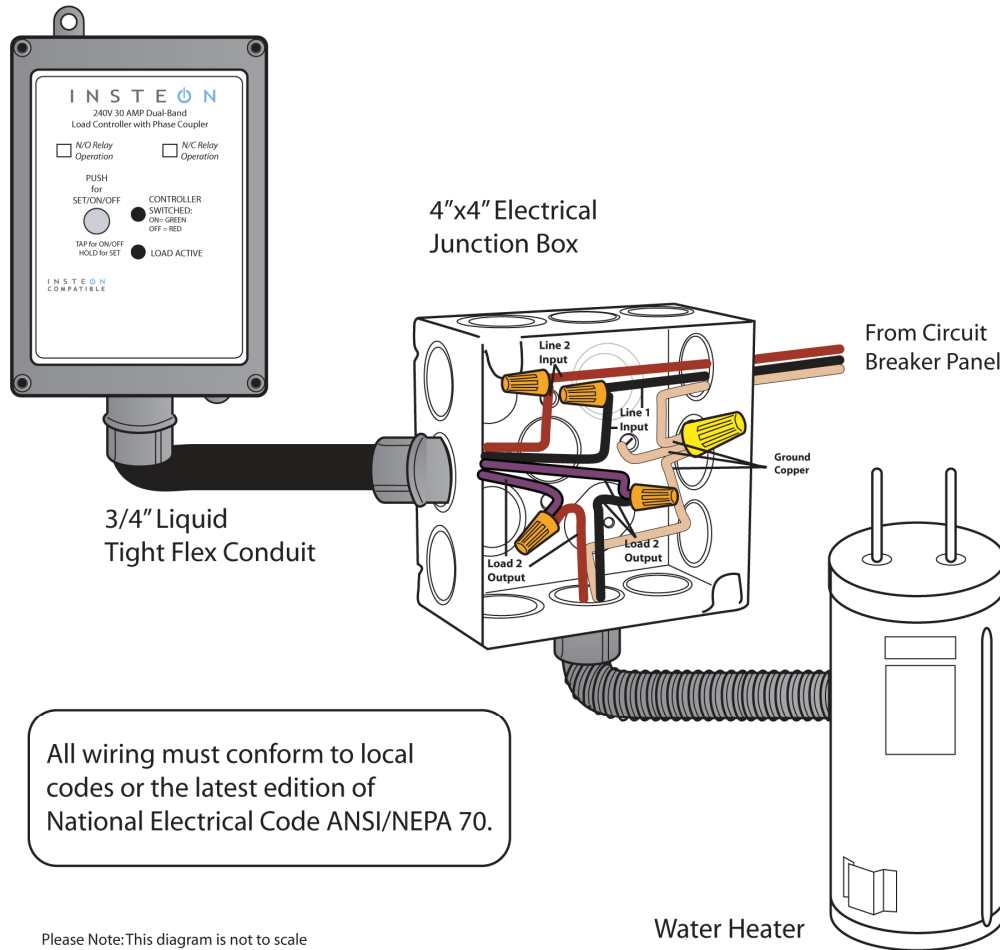

Linking 240V Load Controller as a Responder to an INSTEON Controller

- 1) Select the INSTEON-compatible Controller you would like to use to control 240V Load Controller and set it to Linking Mode. (For most Controllers, press & hold the On or Scene button for 10 seconds, or the Set button for 3 seconds.) You will have 4 minutes to complete the next step.
- 2) Press & hold the Set button on 240V Load Controller until the unit double-beeps (about 3 seconds)
The 240V Load Controller Status LED will turn on solid green if the attached load is on or solid red if the attached load is off
- 3) Test that Linking was successful by tapping the On/Off buttons on your Controller you just Linked to 240V Load Controller
240V Load Controller should respond appropriately

FCC Compliance Statement

This device complies with FCC Rules Part 15. Operation is subject to 2 conditions:

- (1) This device may not cause harmful interference, and
- (2) This device must accept any interference that may be received or that may cause undesired operation. The digital circuitry of this device has been tested and found to comply with the limits for a Class B digital device, pursuant to Part 15 of the FCC Rules. These limits are designed to provide reasonable protection against harmful interference in residential installations. This equipment generates, uses, and can radiate radio frequency energy and, if not installed and used in accordance with the instructions, may cause harmful interference to radio and television reception. However, there is no guarantee that interference will not occur in a particular installation. If this device does cause such interference, which can be verified by turning the device off and on, the user is encouraged to eliminate the interference by one or more of the following measures:
 - Re-orient or re-locate the receiving antenna of the device experiencing the interference
 - Increase the distance between this device and the receiver
 - Connect the device to an AC outlet on a circuit different from the one that supplies power to the receiver
 - Consult the dealer or an experienced radio/TV technician

WARNING! Changes or modifications to this unit not expressly approved by the party responsible for compliance could void the user's authority to operate the equipment.

Complete Instructions, Troubleshooting, and Tech Support

Owner's Manual: http://wiki.smarthome.com/index.php?title=2477SA_Manual

Call: Tech. Support @ 1-800-SMARTHOME (800-762-7846)

Contact Us Online: <http://www.smarthome.com/contactus.html>