



DOG TRAINING COLLAR



Model: OT6

I. Important Safety Information:

WARNING

Not for use with aggressive dogs. Do not use this product if your dog is aggressive or if your dog is prone to aggressive behavior.

Aggressive dogs can cause severe injury to their owner and others. If you are unsure whether this product is appropriate for your dog, please consult your veterinarian or a certified trainer.

- ◆ For use with dogs over 6 months of age and over 5 lbs.
- ◆ **DO NOT** press and hold the Warning Tone Button, Vibration Button and Shock Button for more than 10 seconds constantly to avoid physical or psychological hurt to your dog.
- ◆ Your dog **SHOULD NOT VOCALIZE OR PANIC** when receiving stimulation. If this happens, the stimulation level is too high and you need to go back to the previous level and repeat the process.
- ◆ **DO NOT** charge the device near any flammable substances.
- ◆ For dog use **ONLY**. Not for use on children.
- ◆ This is not a toy, and should only be operated by a responsible adult.

CAUTION

Before your first training, please read and follow the instructions in this manual carefully. The cautions below will help keep your dog safe and comfortable. Millions of dogs are comfortable when they wear stainless steel contacts, while some dogs are sensitive to contact pressure.

- ◆ **It is vitally important that you and your dog remain safe while learning during on-leash training.** Your dog should be on a strong leash (do not attach the leash to the Training Collar), long enough for him to attempt to chase an object, but short enough for him not to reach a road or other hazard. You must also be physically strong enough to restrain your dog when he tries to chase.
- ◆ **Risk of skin damage.** Proper Collar fitment is important. A Collar worn for too long or made too tight on the dog's neck may cause skin damage. Ranging from redness to pressure ulcers; this condition is commonly known as bed sores.
- ◆ **DO NOT leave the Collar on the dog for more than 12 hours per day.**
- ◆ When possible **re-position the Collar on the dog's neck every 1 to 2 hours.**
- ◆ **Check the fit to prevent excessive pressure;** follow the instructions in this manual.
- ◆ **Never connect an extra leash to the Collar;** it will cause excessive pressure on the contacts.
- ◆ **Clean the dog's neck area and the Metal Prongs of the Collar weekly** with a damp cloth.
- ◆ **Examine the contact area daily** for signs of a rash or a sore.
- ◆ **If a rash or sore is found, discontinue use of the Collar** until the skin has healed. If the condition persists beyond 48 hours, see your veterinarian.
- ◆ The Receiver meets IP67 waterproof rating, it can be submerged in water up to 1 meter for up to 30 minutes.
- ◆ This product comes with conductive silicone caps, please ensure they are worn on the Metal Prongs before putting the Receiver on your dog and check for the presence of the Conductive Silicone Caps.

II. Quick Start Guide

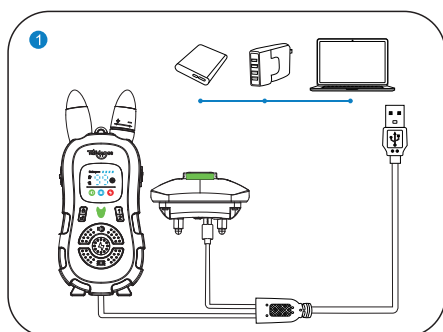

Charge the Receiver and the Remote Transmitter for 2-3 hours with the double-headed Type-C Charging Cable from the package box.

Note: The charger, power bank and other charging devices shown in the above picture are not included in the box.

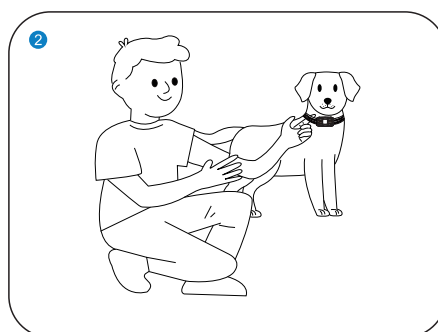

Let your dog stand on four feet or lay down fully. Fit the Receiver to your dog by leaving one finger space between the Collar and your dog's neck. Center the Metal Prongs underneath your dog's neck, touching the skin.

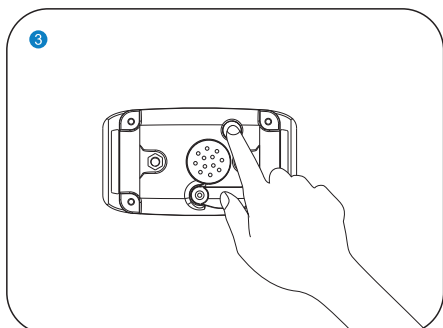

Turn on the Receiver by pressing and holding the Power Button for 2 seconds with a vibration to indicate that the Receiver turns on, and then the green LED Indicator continues to blink regularly.

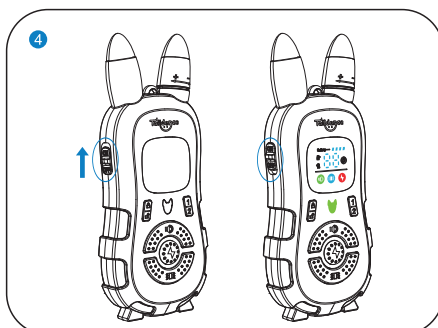

Turn on the Remote Transmitter by turning the On/Off Button to the "ON" side.

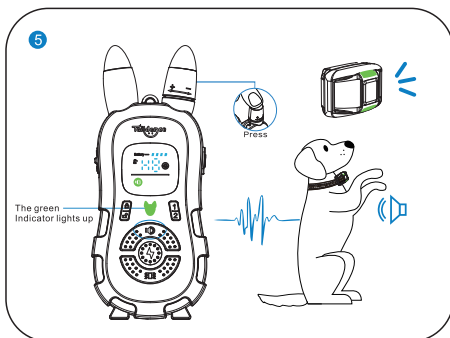

Warning Tone Command: Press the Warning Tone Button, and the green Indicator Light on the Remote Transmitter rapidly lights up. The Receiver will deliver a Warning Tone, and the green LED Indicator light on the Receiver comes up simultaneously.

To adjust the Warning Tone Level, press the Adjustment Knob to select the Warning Tone Mode first, then turn the Adjustment Knob left and right to lower/raise to the desired level, and finally press any button (Ⓢ/Ⓜ/Ⓟ) to confirm the modification.

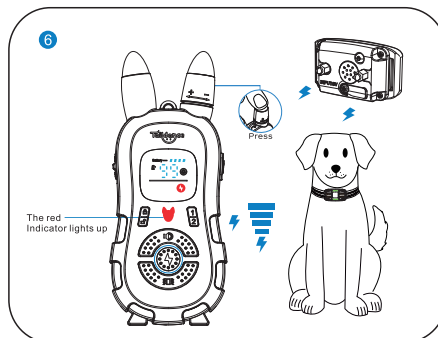

Shock Command: Press the Shock Button, and the red Indicator Light on the Remote Transmitter rapidly lights up. The Receiver will deliver a shock, and the green LED Indicator light on the Receiver comes up simultaneously. To adjust the shock level, press the Adjustment Knob to select the Shock Mode first, then turn the Adjustment Knob left and right to lower/raise to the desired level, and finally press any button (Ⓢ/Ⓜ/Ⓟ) to confirm the modification.

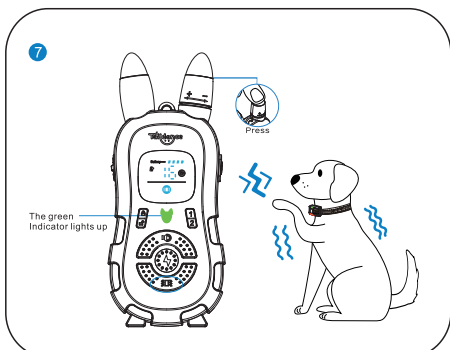

Vibration Command: Press the Vibration Button, and the green Indicator Light on the Remote Transmitter rapidly lights up. The Receiver will deliver Vibration, and the green LED Indicator light on the Receiver comes up simultaneously.

To adjust the Vibration Level, press the Adjustment Knob to select the Vibration Mode first, then turn the Adjustment Knob left and right to lower/raise to the desired level, and finally press any button (Ⓢ/Ⓜ/Ⓟ) to confirm the modification.

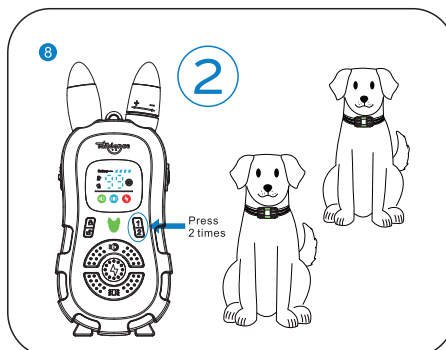

Switch the channel by pressing the Channel Button twice consecutively. This Training Collar can train to 2 dogs.

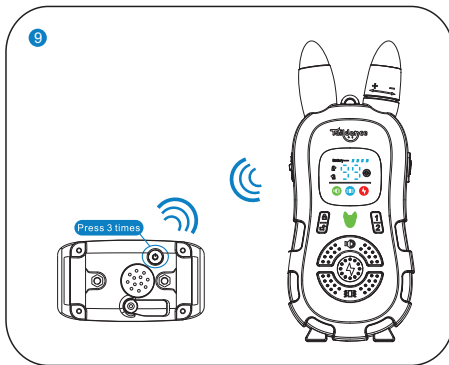

Steps to pair the Remote Transmitter to the Receiver:

1. Press and hold the Power Button on the Receiver for 2 seconds to turn it on. Turn on the Remote Transmitter by turning the On/Off Button to the "ON" side;
2. Press the Power Button on the Receiver 3 times to enter the Pairing Mode. You will hear a beeping tone and the Indicator becomes solid green.
You will now have 10 seconds to finish the pairing;
3. Press the Warning Tone Button, Vibration Button, or Shock Button on the Remote Transmitter, and Receiver will respond correspondingly indicating that the pairing process is completed. Please refer to "VI. Pairing Up" on page 15 for more details.

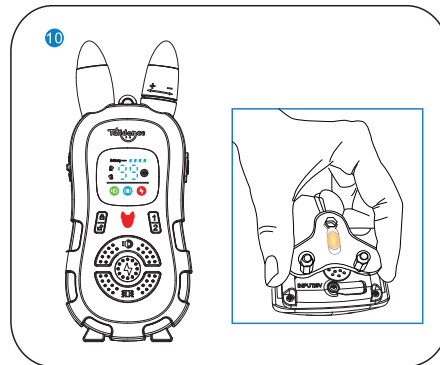

Test the Receiver with the Test Bulb:

1. Turn the Receiver on.
2. Hold the Test Bulb to the Metal Prongs on the Receiver. Make sure the metal wire in the Test Bulb has direct contact with both of the top of the Metal Prongs.
3. Press the Shock Button on the Remote Transmitter.
4. The yellow Test Light will flash if the Receiver works normally. At higher shock levels, the Test Bulb will flash brighter.

Note:

- (1) While you test the Receiver with your fingers, please put your two fingers on the top of the Metal Prongs separately to form a closed loop circle.
- (2) Please always start from the lowest Shock level to avoid accident hurt.

III. Package Content



Remote Transmitter

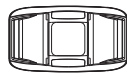

Receiver

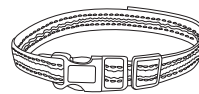

Collar



Wrist Strap



Metal Prongs



Test Bulb



Conductive
Silicone Caps

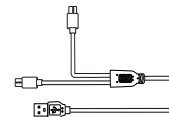

Type-C
Charging Cable



User Manual

IV. Product Overview

Receiver

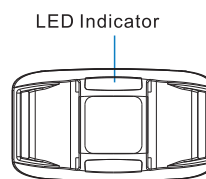
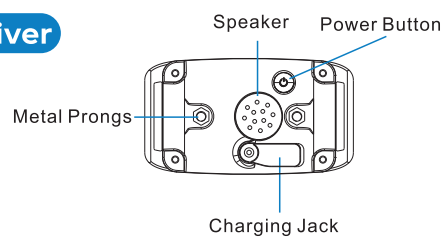

Let your dog stand on four feet or lay down fully. Fit the Receiver to your dog by leaving one finger space between the Collar and your dog's neck. Center the Metal Prongs underneath your dog's neck, touching the skin.

Remote Transmitter

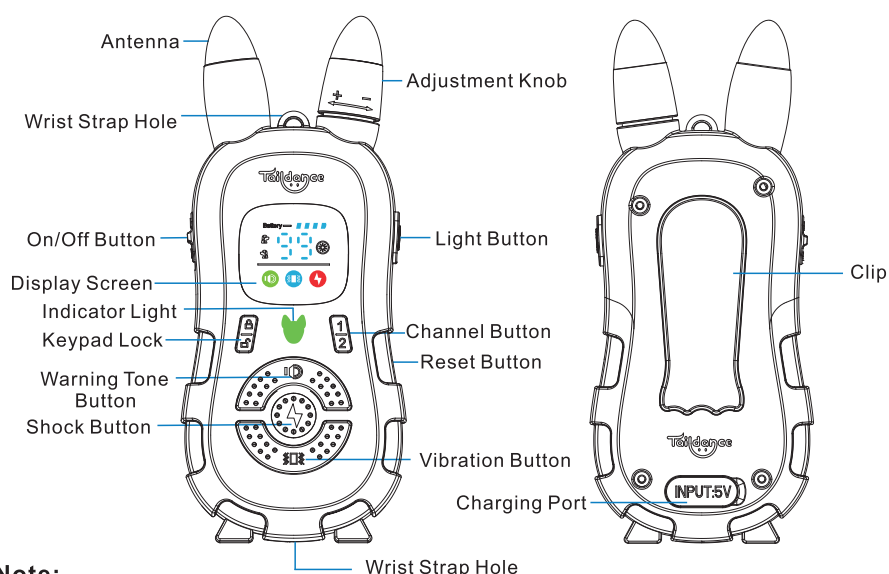

Note:

The Remote Transmitter will go into sleep mode if there is no operation in 20 seconds. The Remote Transmitter will reboot if you trigger the Reset Button, while the parameters of training modes you set are retrained.

Display Screen

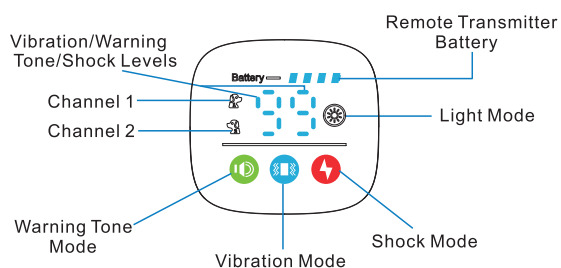

How the system works?

The Remote Training Collar is easy to use with an advanced digital display that tells you the exact stimulation level you are using.

The Remote Training Collar assists you in controlling your dog without a leash. At the push of a button, your Remote Transmitter sends a signal activating your dog's Receiver. He receives a safe but annoying stimulation.

He'll quickly learn the association between his behavior and your correction, and soon you'll have a better-behaved dog.

The Remote Training Collar has been proven safe, comfortable, and effective for both small and large dog breeds.

If using the Remote Training Collar consistently and correctly, any basic obedience commands can be taught and will help correct any misbehavior that your dog exhibits.

V. Setting Up

1. Charge the Product

Charge both the Receiver and Remote Transmitter with the Type-C Charging Cable in the package box until their Indicator becomes solid green which will take around 2-3 hours.

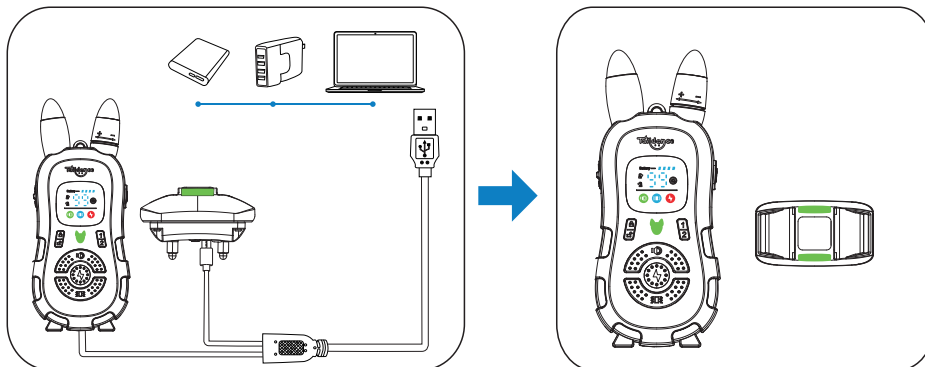

Note:

(1) The charger, power bank and other charging devices shown in the above picture are not included in the package box.

(2) Use the Charging Cable in the package box when charging. Other charging cables may not be suitable for this Receiver and Remote Transmitter, which may cause electric damage.

(3) The Remote Training Collar **ONLY** supports a **5V-rated power source**. If charged with an improper charger:

Receiver—deliver a rapid warning tone and stop charging automatically.

Remote Transmitter—stop charging automatically with the Indicator rapidly blinking in red.

2. Turn On/Off the Product

Turn on the Remote Transmitter by turning the On/Off Button to the "ON" side;

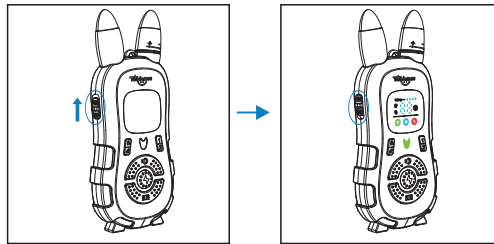

Turn off the Remote Transmitter by turning the On/Off Button to the "OFF" side.

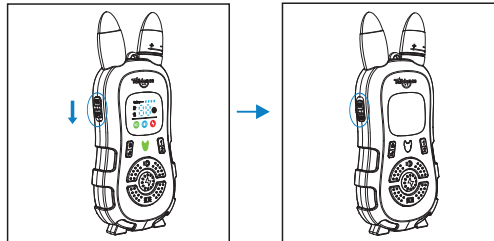

Turn on the Receiver by pressing and holding the Power Button for 2 seconds with vibration, as the green LED Indicator light blinks regularly.



Turn off the Receiver by pressing and holding the Power Button for 2 seconds with a long beeping, as the green LED Indicator light stops blinking.

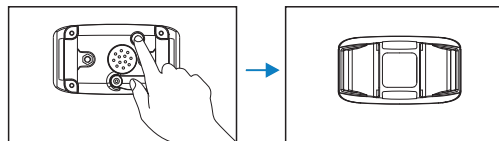

VI. Training Modes

1.Warning Tone Mode

Press the Warning Tone Button and the Receiver will deliver a warning tone. It will cut off automatically if you press and hold the Warning Tone Button for 10 seconds. There is a total of 8 levels of Warning Tone. To adjust the warning tone level, press the Adjustment Knob to select the Warning Tone Mode first, then turn the Adjustment Knob left and right to lower/raise to the desired level, and finally press any button (⏻/⏮/⏭) to confirm the modification.

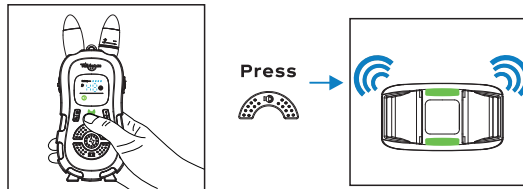

2.Vibration Mode

Press the Vibration Button and the Receiver will deliver a vibration. It will cut off automatically if you press and hold the Vibration Button for 10 seconds. There is a total of 16 levels of Vibration. To adjust the vibration level, press the Adjustment Knob to select the Vibration Mode first, then turn the Adjustment Knob left and right to lower/raise to the desired level, and finally press any button (⏻/⏮/⏭) to confirm the modification.

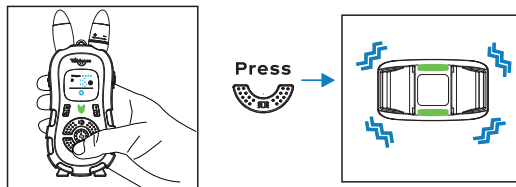

3.Shock Mode

Press the Shock Button and the Receiver will deliver a static shock. It will cut off automatically if you press and hold the Shock Button for 10 seconds. There is a total of 99 levels of Shock. To adjust the shock level, press the Adjustment Knob to select the Shock Mode first, then turn the Adjustment Knob left and right to lower/raise to the desired level, and finally press any button (⏻/⏮/⏭) to confirm the modification.

