



# OUTDOOR SUNIS RTS WIREFREE

## Sun Sensor

### 9020412

EN Installer Manual



www.somfy.com

SOMFY SYSTEMS INC  
SOMFY NA HEADQUARTERS  
121 Herrod Blvd.  
Dayton, NJ 08810  
P: (800) 22-SOMFY (76639)  
NJ: (609) 395-1300  
F: (609) 395-1776

FLORIDA  
6100 Broken Sound Pkwy. N.W.  
Suite 14  
Boca Raton, FL 33487  
P: (800) 22-SOMFY (76639)  
F: (561) 995-7502

CALIFORNIA  
15291 Barranca Parkway  
Irvine, CA 92618-2201  
P: (800) 22-SOMFY (76639)  
F: (949) 727-3775

SOMFY ULC  
SOMFY Canada Division  
5178 Everest Drive  
Mississauga, Ontario L4W2R4  
P: (800) 66-SOMFY (76639)  
CN: (905) 564-6446  
F: (905) 238-1491

**IC statements:**

- This device complies with Industry Canada licence-exempt RSS standard(s). Operation is subject to the following two conditions: (1) this device must not cause interference, and (2) this device must accept any interference, including interference that may cause undesired operation of the device.  
- Le présent appareil est conforme aux CNR d'Industrie Canada applicables aux appareils radio exempts de licence. L'exploitation est autorisée aux deux conditions suivantes : (1) l'appareil ne doit pas produire de brouillage, et (2) l'utilisateur de l'appareil doit accepter tout brouillage radioélectrique subi, même si le brouillage est susceptible d'en compromettre le fonctionnement.



**Introduction:**  
The SUNIS RTS sun sensor provides control of your RTS motorized products based on current sun light levels. It can provide maintenance free service for 5+ years from 2 AA batteries. The precise sun level can easily be selected with 8 possible levels of light sensitivity. The sun function can be enabled/disabled via a Somfy Soliris RTS transmitter or MyLink. **A Somfy Soliris RTS transmitter or MyLink must be provided with each installation to enable/disable the sun function.**

**Overview**

- Wirefree, no electrician required
- Easily select from 8 levels for sun threshold setting
- Long battery life
- DEMO mode for fast and easy testing
- LED feed back for all functions
- Compatible with full range of RTS exterior motors
- Ideal for new and existing installations

**FCC:**  
This device complies with Part 15 of the FCC Rules. Operation is subject to the following conditions:  
- This device may not cause harmful interference and  
- This device must accept any interference received, including interference that may cause undesired operation  
Warning! Changes or modifications not expressly approved by the manufacturer could void the users authority to operate the equipment.

**Safety:**  
Before installing and using this product, please read these instructions carefully.  
Moreover, the installer must comply with current standards and legislation in the country in which the product is being installed, and inform his customers of the operating and maintenance conditions for this product.

Any use outside the field of application specified by Somfy invalidates the warranty and discharges Somfy of all liability, as does any failure to comply with the instructions given herein.

Before installing please check the compatibility of this product with the associated equipment and accessories.  
**Specific safety advice:**

- Never drop, knock, drill or submerge the SUNIS.
- Do not use abrasive products or solvents to clean the SUNIS RTS
- Do not clean it using a water spray or high pressure cleaning methods.
- Ensure that the receiver is kept clean and regularly check if it is operating correctly.

**SUNIS RTS Specifications:**  
Power In: AA Alkaline Battery  
Maximum Range: 65 ft. under optimal conditions  
Operating Temperature: -4°F to 104°F (-20°C to +40°C)  
IP34 rated for direct weather exposure (Must be mounted correctly as per mounting instructions)

- What is in the box:**
1. Sunis RTS sensor with built in mounting base
  2. 2 AA alkaline batteries
  3. 2 mounting screws

## GETTING STARTED

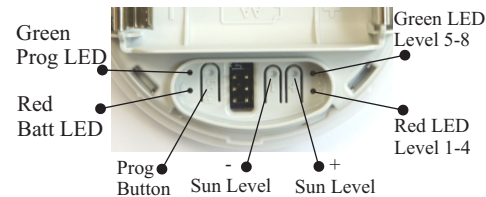

### Opening the Sunis RTS:

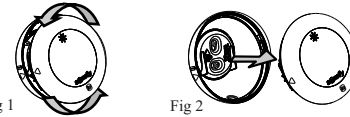

Rotate the top clockwise to align the arrows on the base and sensor top Fig1. This will allow you to open the sensor by lifting the sensor top from the mounting base Fig 2.

### Batteries:

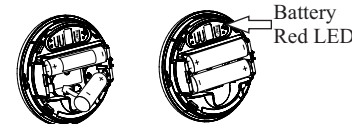

Two AA Alkaline  
Install the batteries paying attention to the polarity shown on the base Fig 2.

If the batteries are good and installed correctly, the RED battery LED will blink just after the batteries are installed.

*Hint:* You can also check if batteries are still good by removing them and reinstalling and confirming the battery LED blinks.

### Installation:

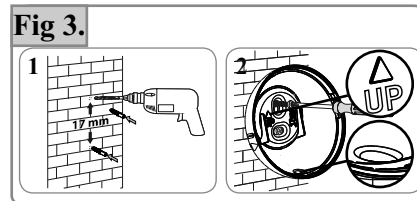

For exterior use, the Sunis RTS must be mounted to a vertical wall.

Drill 2 holes 17mm apart Fig 3.1.

Mount the Sunis RTS base with the up arrow facing up and the drain hole facing directly down Fig 3.2.

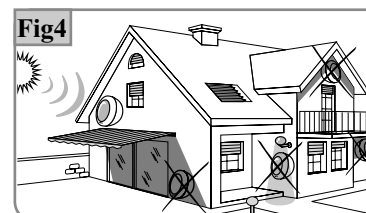

The mounting location is critical Fig 4. Mount the Sunis RTS facing the direction the awning/screen protects from sun. Ensure it is clear from obstruction that could shade it through out the day.

### Programming:

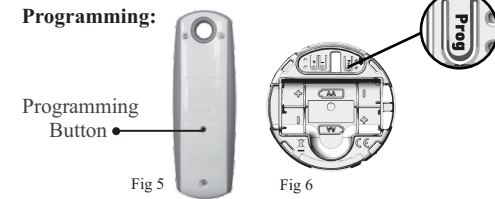

Adding the Sunis RTS to the motor(s):

Step 1: Press the programming button on the RTS transmitter for 3+ sec until the motor jogs. Fig 5  
Step 2: Press the Prog button on the Sunis RTS. Fig 6  
The green Prog LED will light and the motor will jog. The Sunis RTS has been added to the motor.

Deleting the sensor - Repeat steps 1 and 2 above.

### Hints:

**A Soliris transmitter or MyLink must be programmed to the motor(s) to allow the user to Enable/Disable the sun Function.**

If a sensor is removed or damaged, it must be cleared from the motor memory.

To delete all sensors when adding a new sensor, follow steps 1 and 2 above except on step 2 hold the prog button until the motor jogs twice (approx 7 sec). This Will clear all sensors. Repeat steps 1 and 2 normally to add the new sensor.

### Setting Sun Threshold Level:

| Thresholds                | 1   | 2  | 3   | 4    | 5     | 6     | 7     | 8     |
|---------------------------|-----|----|-----|------|-------|-------|-------|-------|
| Sunlight intensity (kLux) | 1   | 5  | 10  | 20   | 40    | 55    | 75    | 100   |
| LED active                | Red |    |     |      | Green |       |       |       |
| Number of flashes         | ☆   | ☆☆ | ☆☆☆ | ☆☆☆☆ | ☆☆☆☆☆ | ☆☆☆☆☆ | ☆☆☆☆☆ | ☆☆☆☆☆ |

↑ Increase Threshold

↓ Decrease Threshold

The Sun Threshold level can be adjusted up or down by a short press of the + or - button. For levels 1-4 the orange LED will blink 1 - 4 times to confirm the level. For levels 5-8 the green LED will blink.

### DEMO Mode:

|             | Time Delays | No Sun | Sun |
|-------------|-------------|--------|-----|
| Normal Mode | 15-30 min   | 2 min  |     |
| Demo Mode   | 15 sec      | 10 sec |     |

Demo mode allows the Sunis RTS to be more easily tested by reducing the delay times. Pressing the + & - together will cause the Sunis to cycle in or out of Demo. The Red and Green LEDs will alternate when entering Demo mode and blink together when exiting. The Sunis Will automatically time out of Demo mode in 3 min.