

Critical Wear Areas & Vacuum Test Locations



NOTE: OE valves are shown in rest position and should be tested in rest position unless otherwise indicated. Test locations are pointed to with an arrow. Springs are not shown for visual clarity. Low vacuum reading indicates wear.

Front Control Valve Body

TCC Regulator Valve

- TCC Slip
- Overheated converter
- Delayed/No Reverse
- Harsh/soft TCC apply
- No lockup

Replace with **Sonnax Part No.**

55211-04K (.437" dia. balance spool)

Requires F-55211-TL4 & VB-FIX

55211-24K (.476" dia. balance spool)

Requires F-55211-TL22 & VB-FIX

AFL Valve

- Low line pressure
- Gear ratio codes
- 2nd Gear starts
- Loss of 4th and 5th
- TCC slip

Replace with **Sonnax Part No.**

55211-01K Requires F-55211-TL & VB-FIX

3-4 Shift Control Valve

- 3-4 Flare
- Clutch distress

Replace with **Sonnax Part No.**

55211-14K Requires F-55211-TL14 & VB-FIX

Safety Mode Valve

- 1-2 Bind-up
- Clutch distress

Replace with **Sonnax Part No.**

55211-14K Requires F-55211-TL14 & VB-FIX

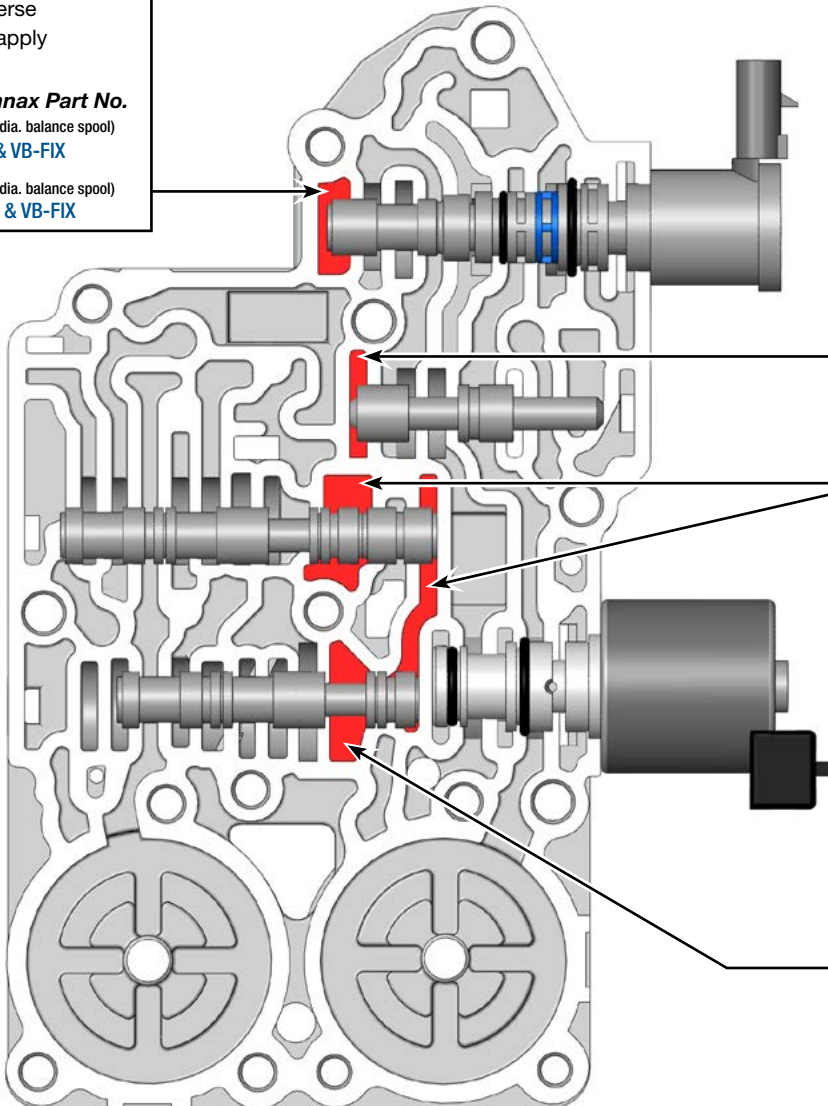

Critical Wear Areas & Vacuum Test Locations



NOTE: OE valves are shown in rest position and should be tested in rest position unless otherwise indicated. Test locations are pointed to with an arrow. Springs are not shown for visual clarity. Low vacuum reading indicates wear.

Rear Control Valve Body

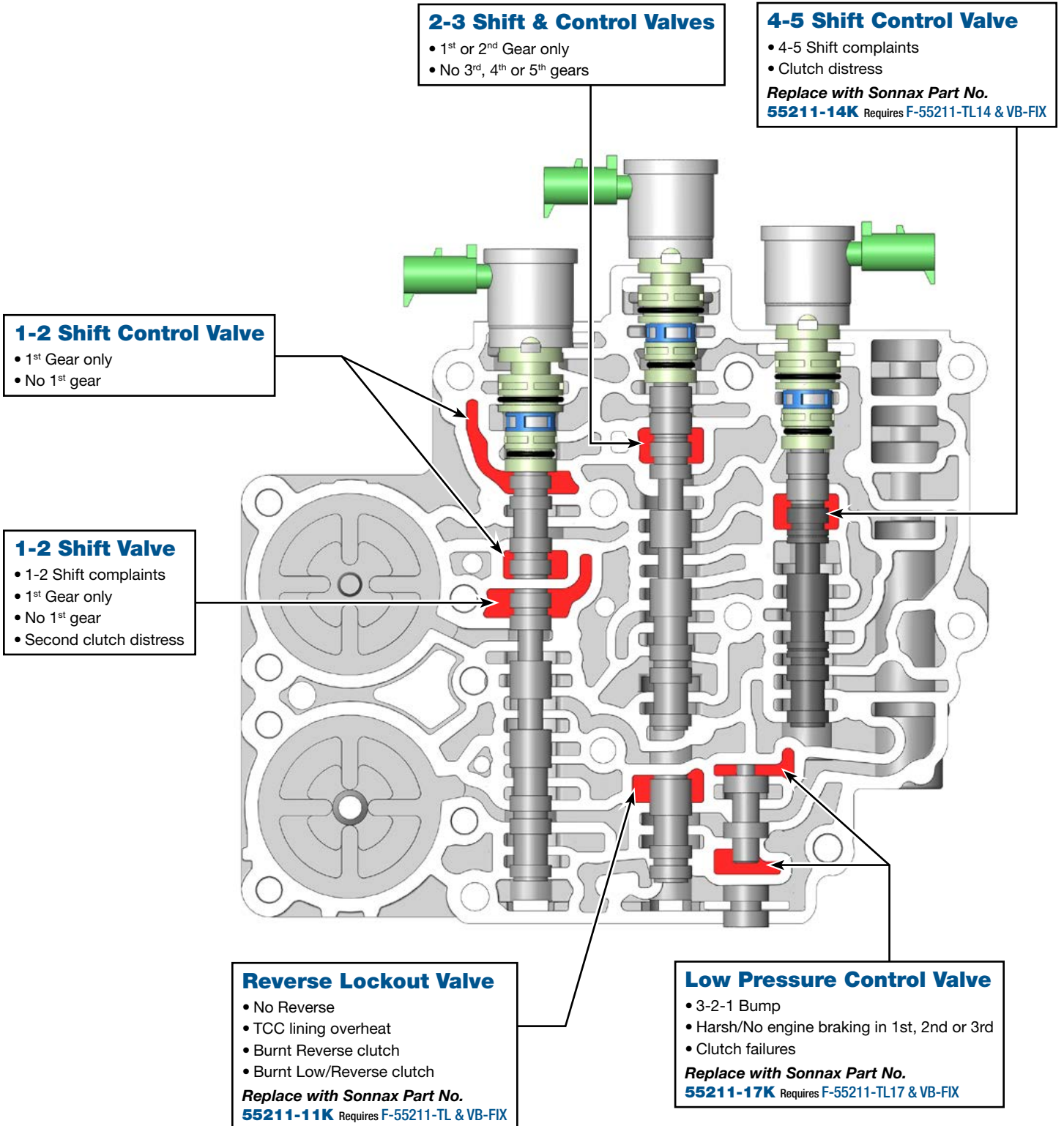

Critical Wear Areas & Vacuum Test Locations



NOTE: OE valves are shown in rest position and should be tested in rest position unless otherwise indicated. Test locations are pointed to with an arrow. Springs are not shown for visual clarity. Low vacuum reading indicates wear.

Fluid Pump Cover Body

Single TCC Valve Pump

Pressure Regulator Valve

- Low line pressure
- Gear ratio codes
- Pump slide wear
- Gear fracture

Replace with **Sonnax Part No. 55211-08K** Requires 55211-TL8

Test: Block orifice in valve with pencil eraser while testing.

Boost Valve Kit

- Low line rise
- High line pressure in Reverse
- Flare shifts
- TCC slip
- Gear ratio codes

Replace with **Sonnax Part No. 55209-01K** Increased Performance
55209-04K OE Ratio

TCC Control Valve

- Incorrect TCC apply & release
- No lockup
- Falling out of lockup hot
- Insufficient lube

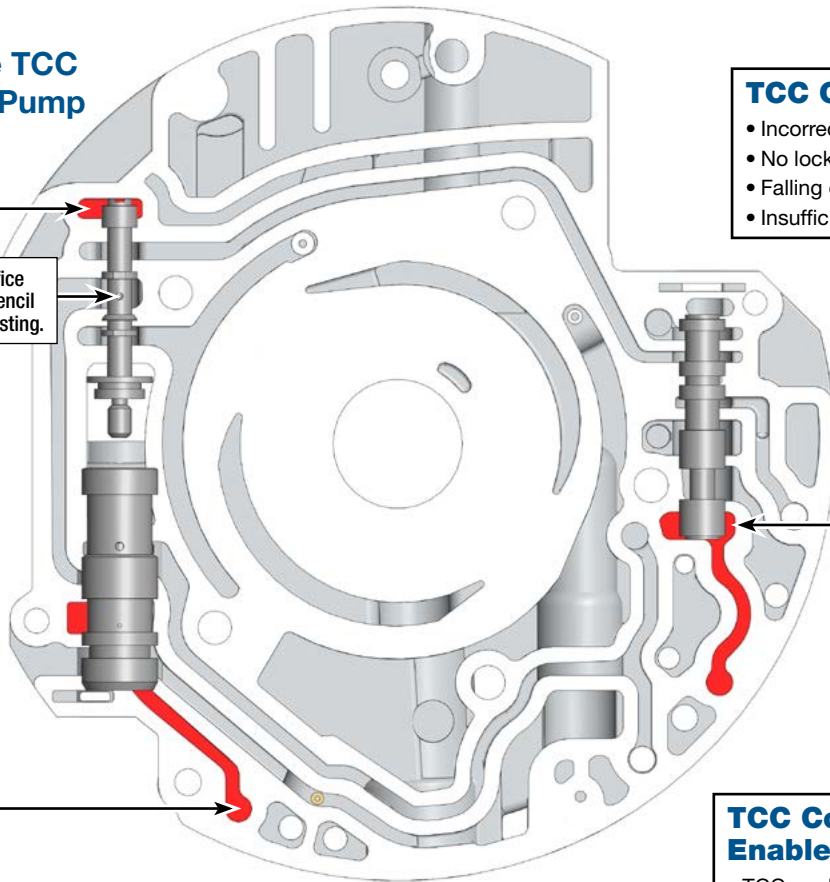

TCC Control & Enable Valve Kit

- TCC apply & release concerns
- No lockup
- Falls out of lockup when hot
- Inadequate lubrication

Replace with **Sonnax Part Nos. 55211-22K** For Dual Valve Pumps Only
Requires F-55211-TL22 & VB-FIX & VB-06

Dual TCC Valve Pump

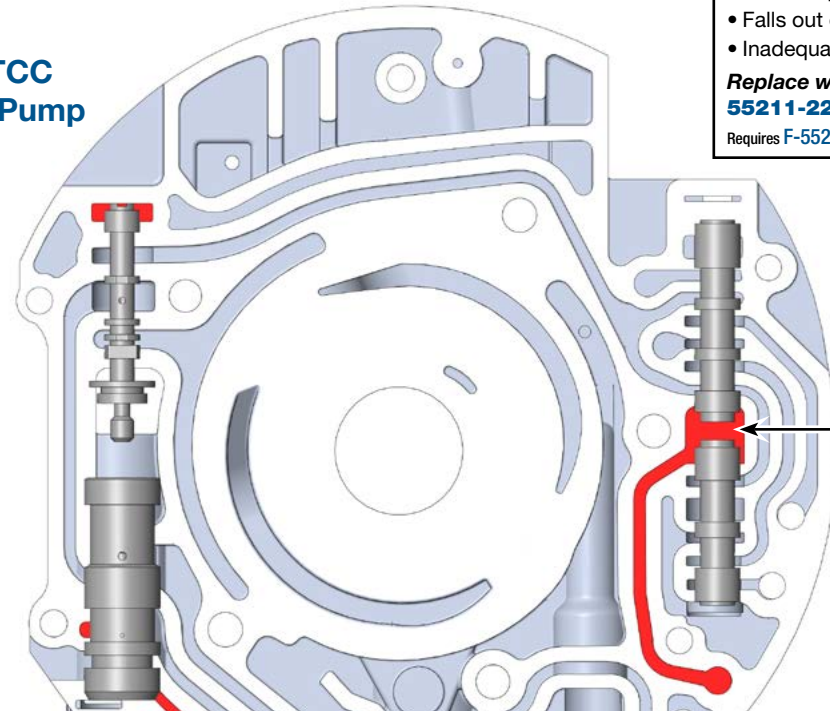

Critical Wear Areas & Vacuum Test Locations

NOTE: OE valves are shown in rest position and should be tested in rest position unless otherwise indicated. Test locations are pointed to with an arrow. Springs are not shown for visual clarity. Low vacuum reading indicates wear.



Accumulator Pistons

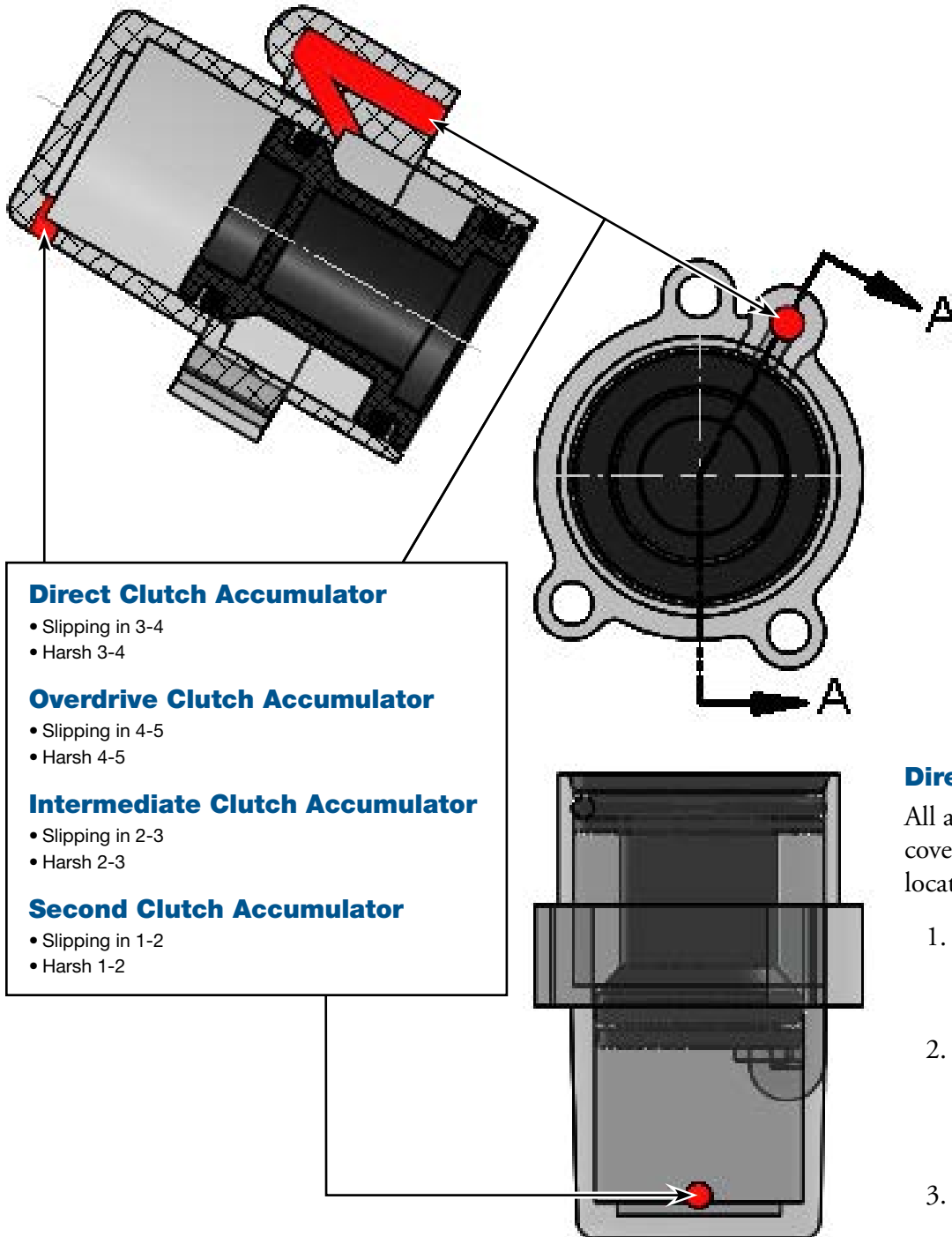

Directions:

All accumulator pistons and covers can be checked at either location indicated.

1. Pull accumulator piston down until flush with cover opening as illustrated.
2. Attach appropriately sized testing tip to vacuum test line and apply vacuum to either port.
3. Leave port not being tested unblocked while testing the other port.

OE Exploded View

Front Control Valve Body

Front Control Valve Body Descriptions

I.D No.	Description
101	TCC Regulator Apply Valve
102	Feed Limit Valve
103	Pressure Control Solenoid Assembly
104	Direct Clutch Accumulator Piston
105	Overdrive Clutch Accumulator Piston
106	Safety Mode Valve
107	3-4 Shift (outboard) & Control (inboard) Valves

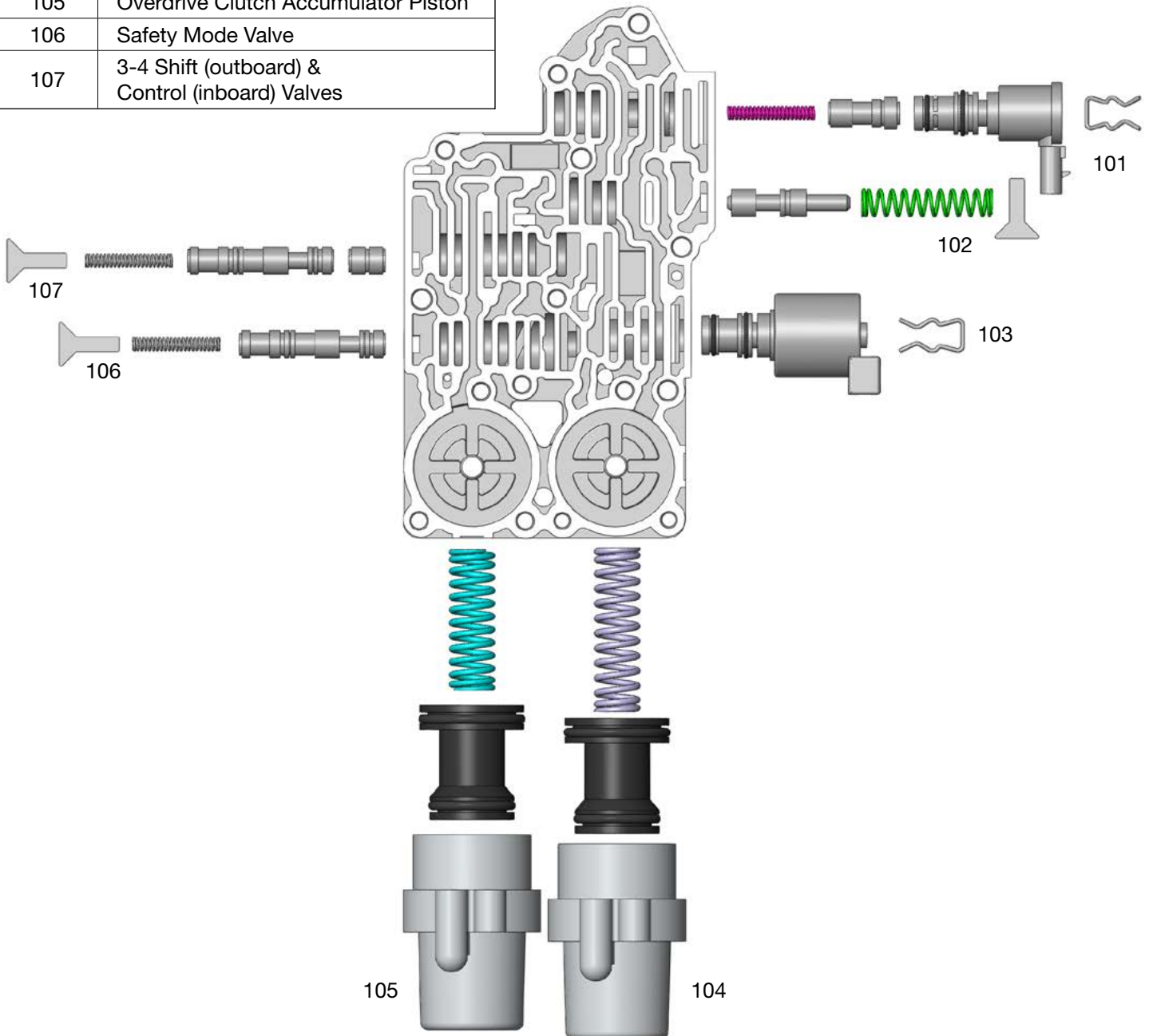

OE Exploded View

Rear Control Valve Body

Rear Control Valve Body Descriptions

I.D. No.	Description
201	1-2 Shift Control Valve
202	2-3 Shift (inboard) & Control (outboard) Valves
203	4-5 Shift (inboard) & Control (outboard) Valves
204	Manual Valve
205	Low Pressure Control Valve
206	Reverse Lockout Valve
207	1-2 Shift Valve
208	Intermediate Clutch Accumulator Piston
209	2nd Clutch Accumulator Piston

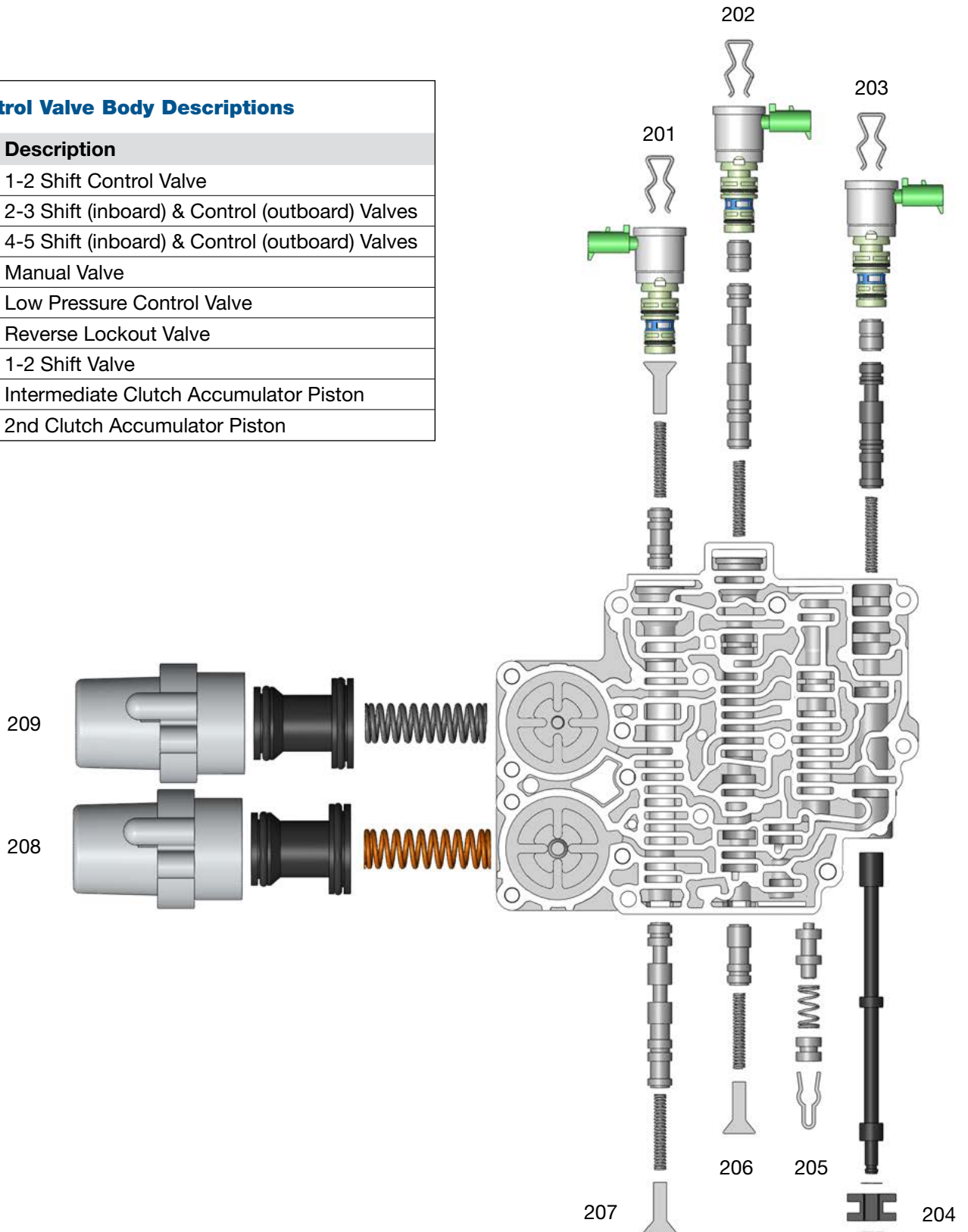

OE Exploded View

Fluid Pump Cover Body

Single TCC Valve Pump

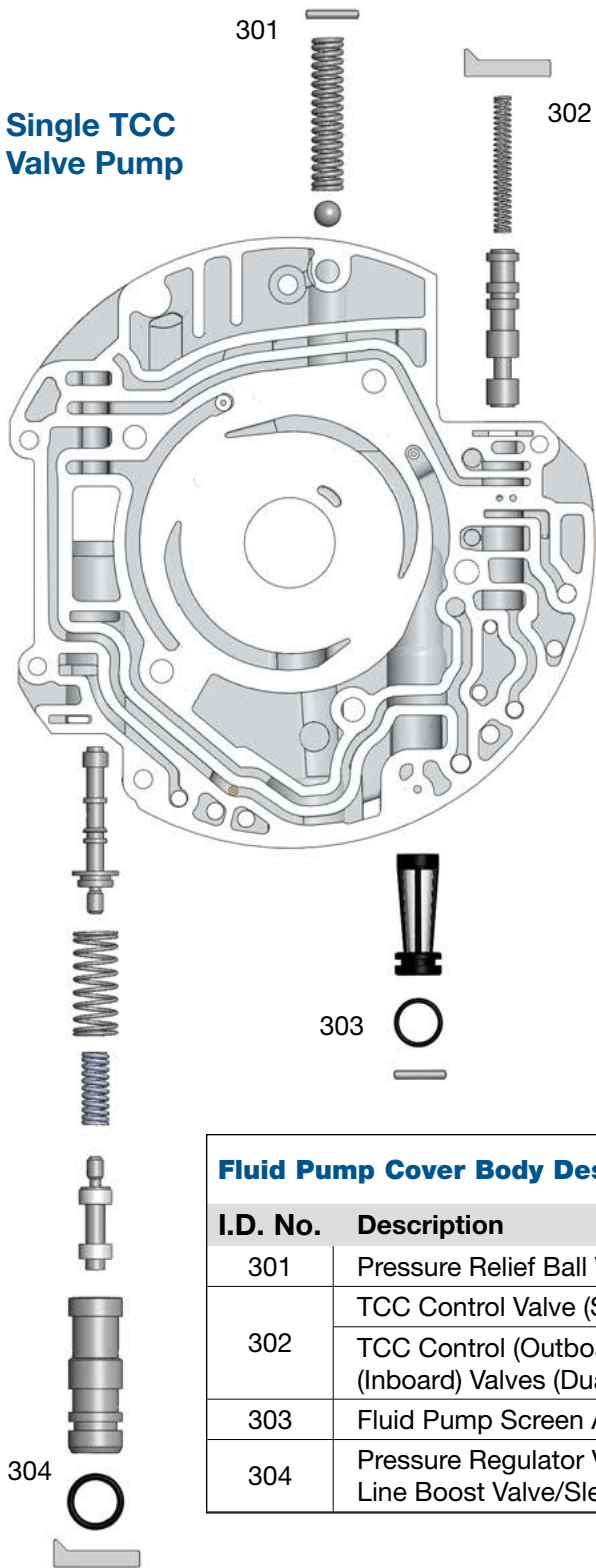

Dual TCC Valve Pump

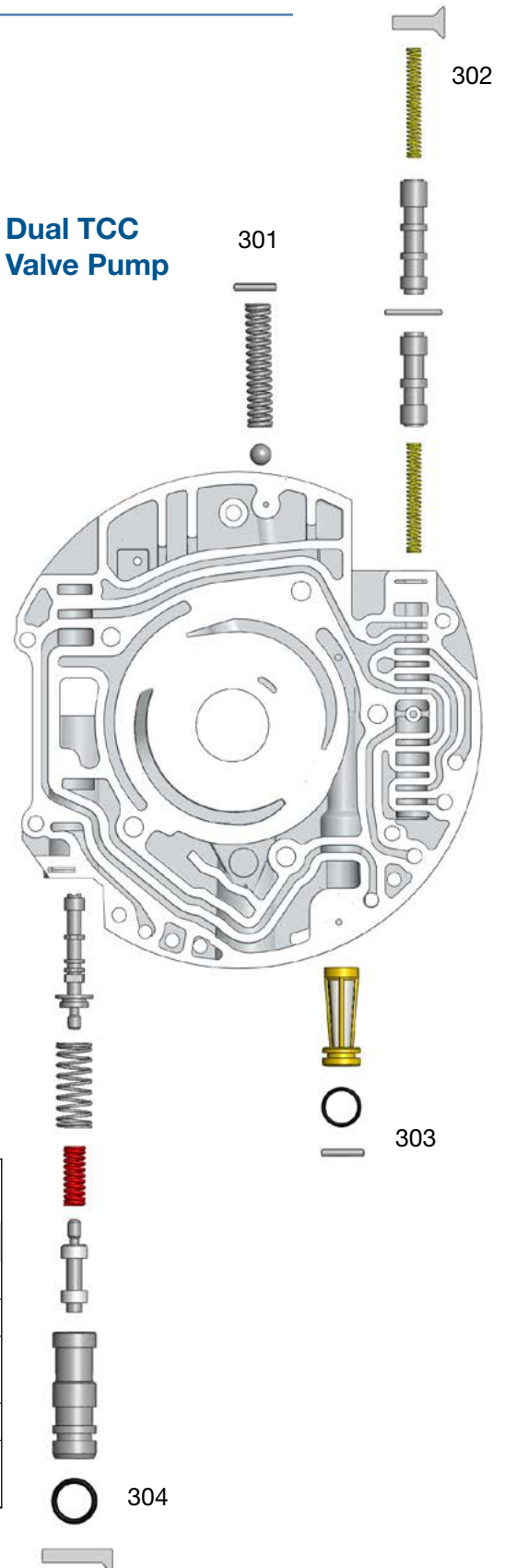

Fluid Pump Cover Body Descriptions	
I.D. No.	Description
301	Pressure Relief Ball Valve Assembly
302	TCC Control Valve (Single TCC Valve Design)
302	TCC Control (Outboard) and TCC Enable (Inboard) Valves (Dual TCC Valve Design)
303	Fluid Pump Screen Assembly
304	Pressure Regulator Valve (Inboard) and Line Boost Valve/Sleeve (Outboard)