

Phonak TVLink II

Simplified User Guide

For latest complete version, please visit www.phonak.com/tvlink



PHONAK
life is on

Contents

1. Welcome	4
2. Getting to know your TVLink II	5
3. Getting started	7
3.1 Selecting the charging slot	7
3.2 Connecting the cables	8
3.3 Pairing TVLink II	16
4. Daily use	18
4.1 Connecting the devices	18
4.2 Adjusting the volume	21
4.3 Switching off device	23
4.4 Understanding the indicator light	24
5. Troubleshooting	25
5.1 Testing the audio transmission	25

6. Service and warranty	28
6.1 Local warranty	28
6.2 International warranty	28
6.3 Warranty limitation	28
7. Compliance information	29
8. Information and explanation of symbols	33
9. Important safety information	37

1. Welcome

Congratulations on choosing the Phonak TVLink II
It expands the way you hear your world by wirelessly
connecting to your TV and other entertainment
or communication devices.

Please read this user guide carefully to discover how
to benefit from all the features of your TVLink II

If you have any questions, please consult
www.phonak.com/tvlink

Phonak – life is on

www.phonak.com



CE mark applied: 2014

2. Getting to know your TVLink II

The intended use of the TVLink II basestation is to connect to a TV or any other audio source. It sends audio signals wirelessly within up to 30 meters (100 ft). It also serves as a charging cradle for the Phonak streamer.

2. Getting to know your TVLink II

2.1 Device description

Buttons

- A Volume down
- B Power on/off and main indicator light
- C Volume up
- D Pairing

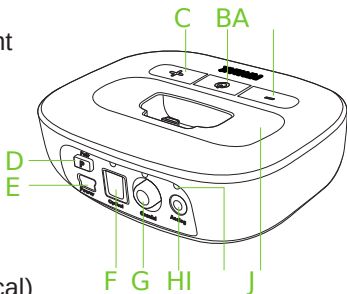

Inputs

- E Power supply
- F Digital audio (optical)
- G Digital audio (coaxial)
- H Analog audio (3.5 mm)

Others

- I Audio indicator lights
- J Exchangable charging slot

3. Getting started

3.1 Selecting the charging slot

The TVLink II is delivered with the charging slot for Phonak ComPilot Air II clip-on streamer. If you have ComPilot or ComPilotII, change the slot using the Phillips head screwdriver no 1.

- * Unscrew the bottom screw. Lift the charging slot as shown.

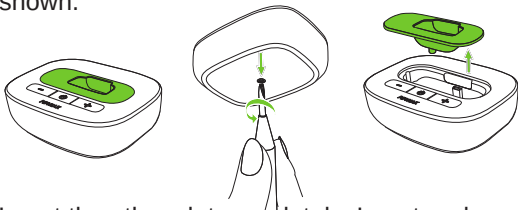

- * Insert the other slot completely. Insert and gently tighten the screw.

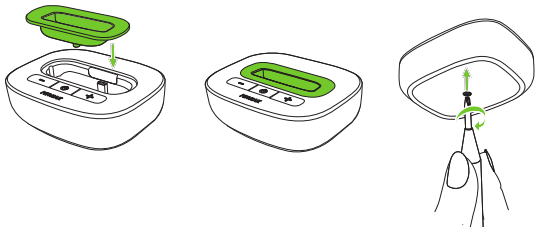

3.2 Connecting the cables

Connect the power supply:

- * Place TVLink II next to your TV or sound source. Connect the mini-USB plug of the power source to the power input of the TVLink II

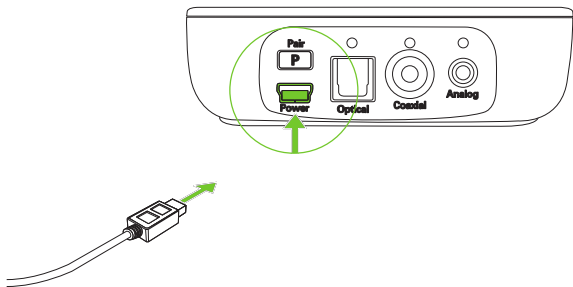

3. Getting started

Supported audio formats

The Phonak TVLink II can be connected to any audio source such as a TV, PC or hi-fi system. It supports 3 different audio input formats.

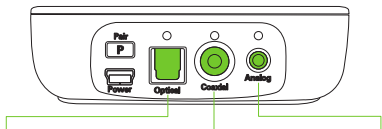

Optical (“Toslink”)

Digital signal
Fiber optic cable

Coaxial

Digital signal
RCA cable

Analog

Analog signal
3.5 mm plug

For best results, we recommend to use the optical or coaxial connection if available on your audio device.

i Please ensure to always connect TVLinkII to the audio **OUT** put!

Signal priorities

Normally it is enough to connect one audio cable. If more than one cable is connected and a signal is present, TVLink II automatically selects the best possible input in the following order:

1. Optical
2. Coaxial
3. Analog

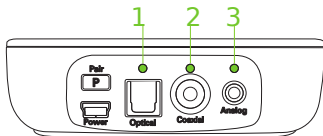

i Even if the optical and coaxial cable is one wire only, the signal is stereo.

TVLinkII shows the selected input by an orange audio indicator light:

Input selected

● ● ● Slow blink orange

Input selected and
audio available

— Solid orange

3. Getting started

Option 1: Connecting via Optical cable

If an optical output is available:

- * Unpack the cable labeled “Optical”.
- * Remove the protection caps from the plugs.
- * Connect one end of the optical cable into the “Optical” input of TVLink II, and the other end into the optical output of your TV.

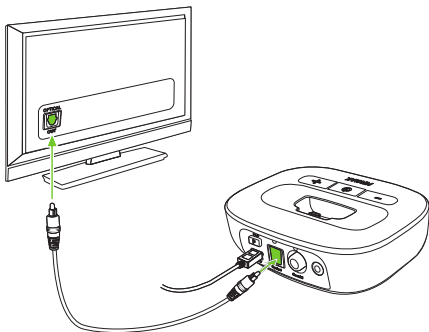

Option 2: Connecting via coaxial cable

If a coaxial output is available:

- * Unpack the cable labeled “Coaxial” (orange plugs).
- * Connect one end of the coaxial cable into the “Coaxial” input of TVLink II, and the other end into the coaxial (also known as “digital out”, “S/P DIF”) output of your TV.

i Ensure not to use red/white analog or yellow video output

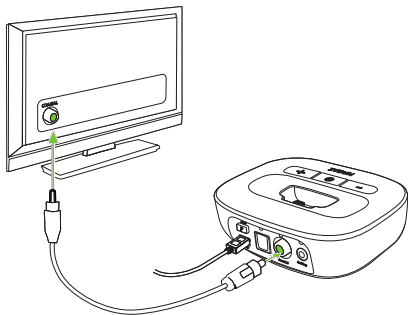

3. Getting started

Option 3: Connecting via RCA / Cinch cable

If an RCA output (red / white) is available:

- * Unpack the cable labeled “Analog RCA / Cinch”.
- * Connect the 3.5 mm plug into the “Analog” input of the TVLink II. Connect the red and white plugs to the matching red and white output sockets on your TV.

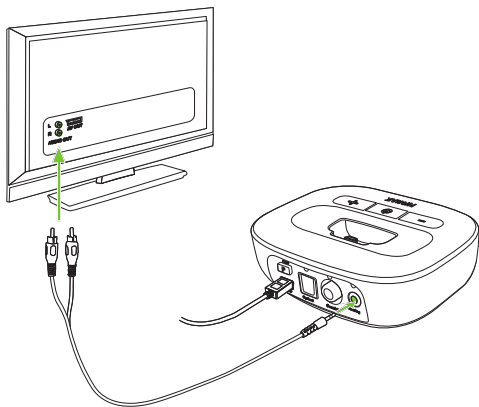

Option 4: Connecting to the headset socket

- * Unpack the cable labeled “Analog 3.5 mm”.
- * Connect the stereo plug into the “Analog” input of the TVLink II. Plug the other end into the headset output socket of your TV.

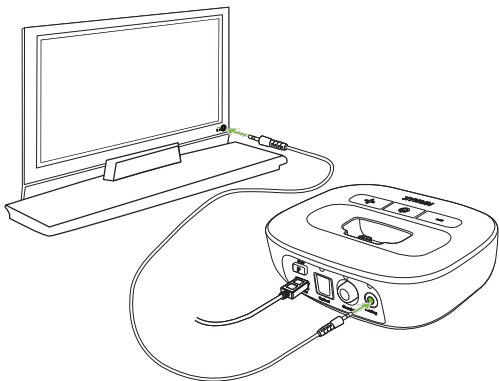

3. Getting started

i When connecting TVLink II to the headset socket of your TV, you are able to adjust the volume via your TV remote control.

i Some TVs will switch off their loudspeakers when using the headset socket – the TV will not be audible for other people.

3. Getting started

3.3 Pairing TVLink II

Put TVLink II into pairing mode

i If TVLinkII has never been paired, it will automatically be in pairing mode after switching on. This is indicated by a rapidly blinking blue main indicator light.

To manually start pairing mode:

- * Switch TVLink II on.
- * Press the pairing **P** button on the back, and the main indicator light will start rapidly blinking blue.
- * Make sure TVLink II and the streamer are within 1 meter (3 ft) range.

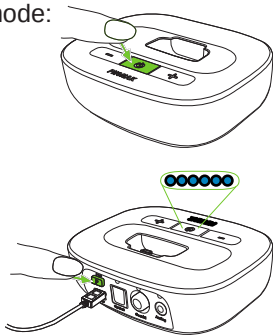

i TVLinkII will remain in pairing mode for two minutes or until the pairing has been completed.

Completion of pairing

Wait until both indicator lights turn solid blue. This can take up to 2 minutes but usually occurs within a few seconds.

- i** The TVLink II basestation can be paired to a maximum of 4 streaming devices. A fifth pairing will replace the first paired device.
- i** Two devices only need to be paired once. They remain paired after switching off and will automatically connect after being switched on again.

4. Daily use of the Phonak TVLink

4.1 Connecting the devices

Each time the devices are switched on, they will automatically connect to each other.

- * Make sure the streamer and TVLink II are within 1 meter (3 ft) range and the audio source (e.g. TV) is on.
- * Switch both devices on.
- * The indicator lights will turn green first.
- * Wait until the indicator lights turn solid blue.

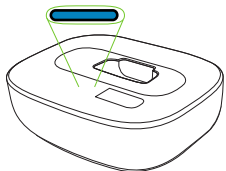
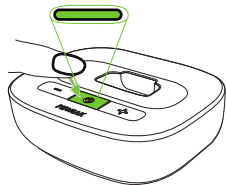

i This may take up to 30 seconds but usually Occurs within a few seconds.

4. Daily use of the Phonak TVLink II

You will hear the sound of the TV directly.

i If you cannot hear the sound, repeat the setup on page 11.

i If no audio input is available, TVLink II automatically stops the Bluetooth audio transmission to the streamer after 5 minutes. Its main indicator light will blink green.

The distance between TVLink II and the streamer can be up to 30 m (100 ft). Line-of-sight between your streamer and the TVLink II is not required. However, interference in the environment by walls or furniture may reduce the operating range.

If the streamer is out of range the wireless audio transmission will be terminated. If the streamer is then moved back into the range, it will automatically resume streaming.

i It may take up to 10 seconds until the streaming resumes. Both streaming light indicators should be solid blue during streaming.

i If the TVLink II main indicator light

- blinks green, make sure the audio input to the TVLink II is properly connected.
- is green, make sure the streamer is switched on and the devices are paired (chapter 3.5).
- blinks blue, you are in paused mode. Press the streamer main  button to resume streaming.

4.2 Adjusting the volume

- * Set the volume of the TV speakers at the level to suit other viewers.
- * Adjust the volume via the TVLink II volume control until the sound is comfortable.

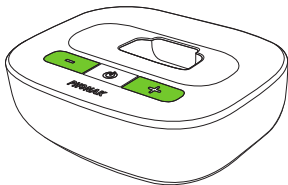

-
- * If your TVLink II is connected to the headphone socket of your TV, you may also use your TV remote control to adjust the volume via the TV directly. Please refer to the TV user guide for more details on setting the TV volume.

i If your TV is connected to a satellite receiver or a set-top box, make sure the volumes of these additional devices are set to a 75% level for best audio quality results.

4. Daily use of the Phonak TVLink II

4.3 Switching off device



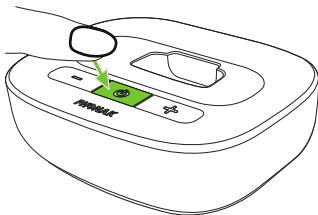



- * To end the transmission of the audio signal, switch off TVLink II by pressing the On / Off button.



4.4 Understanding the indicator light

The TVLinkII main indicator light gives you useful information:



Solid green		Switched On
Blink green		On but no audio input
Rapid blink blue		Pairing mode
Solid blue		Streaming
Blink blue		Pause mode
Multi color blinking		Test mode, see chapter 5.1



For a more detailed explanation of the streamer indicator lights please refer to the streamer's user guide.

5. Troubleshooting



5.1 Testing the audio transmission

If you cannot hear the sound from the audio source (e.g. TV), proceed as follows.

Test the connection of TVLink II

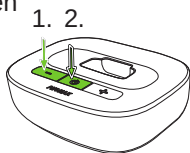
- * Switch on and wear the streamer correctly.
- * Switch off the TVLink II first, then press the basestation volume down and power button simultaneously until the main status light starts to blink in different colors.
- * The streamer and the TVLink II should connect now (blue/green or blue/red blinks), and you hear a sound test melody.



-
- * Use the streamer volume up/down   buttons to change the volume of the test sound.
 - * If no test sound can be heard, start the pairing procedure as described on page 16.
 - * The test sound continues for 2 minutes or until any of the TVLink II buttons is pressed.

Test the cable connections

If you were able to hear the test melody from TVLink II but you cannot hear the sound from the TV, there is a problem with the cable connection.

- * Ensure the audio cable is completely plugged in.
- * Ensure you connected the cable to an OUTput and not an INput.
- * Try a different cable.
- * Try a different output socket of the TV.

The basestation main indicator light gives information during test mode.

The colors alternate to indicate the audio input status as well as the connection status to the streamer.

5. Troubleshooting

Example:

Red/blue/red/blue/etc: Streaming test sound no audio input detected on the TVLink II.

Color codes

Red	No audio input on TVLink II
Green	Audio input detected on TVLinkII
Orange	Searching for streamer
Blue	Streaming test sound to streamer

6. Service and warranty

6.1 Local warranty

Please ask the hearing care professional, where you purchased your devices, about the terms of the local warranty.

6.2 International warranty

Phonak offers a one year limited international warranty, valid as of the date of purchase. This limited warranty covers manufacturing and material defects. The warranty is valid only if proof of purchase is shown.

The international warranty does not affect any legal rights that you might have under applicable national legislation governing sale of consumer goods.

6.3 Warranty limitation

This warranty does not cover damage from improper handling or care, exposure to chemicals, immersion in water or undue stress. Damage caused by third parties Or non-authorized service centers renders the warranty null and void. This warranty does not cover any Services performed by a professional in his/her office.

7. Compliance information

Declaration of Conformity

Hereby Phonak AG declares that this Phonak product is in compliance with the essential requirements of the Radio and Telecommunications Terminal Equipment Directive 1999/5/EC. The full text of the Declaration of Conformity can be obtained from the manufacturer or the local Phonak representative whose address can be taken from the list on www.phonak.com (worldwide locations).

Australia:

Supplier Code Number  N15398

New Zealand:

Supplier Code Number Z1285

Notice 1:

This device complies with Part 15 of the FCC Rules and with RSS-210 of Industry Canada. Operation is subject to the following two conditions:

- 1) this device may not cause harmful interference, and
- 2) this device must accept any interference received, including interference that may cause undesired operation.

Notice 2:

Changes or modifications made to this device not expressly approved by Phonak may void the FCC authorization to operate this device.

Notice 3:

This device has been tested and found to comply with the limits for a Class B digital device, pursuant to Part 15 of the FCC Rules and ICES-003 of Industry Canada.

These limits are designed to provide reasonable protection against harmful interference in a residential installation. This device generates, uses and can radiate radio frequency energy and, if not installed

7. Declaration of Conformity

and used in accordance with the instructions, may cause harmful interference to radio communications. However, there is no guarantee that interference will not occur in a particular installation. If this device does cause harmful interference to radio or television reception, which can be determined by turning the equipment off and on, the user is encouraged to try to correct the interference by one or more of the following measures:

- Reorient or relocate the receiving antenna.
- Increase the separation between the device and receiver.
- Connect the device into an outlet on a circuit different from that to which the receiver is connected.
- Consult the dealer or an experienced radio/TV technician for help.

Notice 4:

Japanese Radio Law and Japanese Telecommunications

Business Law Compliance. This device is granted pursuant to the Japanese Radio Law (電波法) and the Japanese Telecommunications Business Law (電気通信事業法). This device should not be modified (otherwise the granted designation number will become invalid)."

More details can be found in the data sheet which can be downloaded from www.phonak.com/tvlink

8. Information and explanation of symbols



The CE symbol is confirmation by Phonak AG that this Phonak product meets the requirements of the R&TTE Directive 1999/5/EC on Radio and Telecommunication Terminal Equipment. The numbers after the CE symbol are the numbers of consulted certified bodies under the above mentioned directives.

This device is a class 2 device and can be operated in the EU member states without restrictions for indoor use, but must not be operated outdoors in France.



This symbol indicates that it is important for the user to read and take into account the relevant information in this user guide.



Indicates the device manufacturer, as defined in EU Directive 93/42/EEC.



This symbol indicates that it is important for the user to pay attention to the relevant warning notices in this user guide.



Important information for handling and product safety.



EMC and radio communications compliance label Australia.

Operating conditions

The device is designed such that it functions without problems or restrictions if used as intended, unless otherwise noted in this user guide.

8. Information and explanation of symbols



Temperature transport and storage:
–20° to +60° Celsius
(–4° to +140° Fahrenheit).
Temperature operation:
0° to +40° Celsius
(+32° to +104° Fahrenheit).



Keep dry.



Humidity transportation: up to 90%
(non condensing).
Humidity storage: 0% to 70%, if not
in use.
Humidity operation: <90% (non
condensing).



Atmospheric pressure: 500 hPa to
1100 hPa.



The symbol with the crossed-out garbage bin is to make you aware that this device may not be thrown away as normal household waste. Please dispose of old or unused device, at waste disposal sites intended for electronic waste, or give your device to your hearing care professional for disposal. Proper disposal protects the environment and health.







The Bluetooth® word mark and logos are registered trademarks owned by Bluetooth SIG Inc., and any use of such marks by Phonak is under license. Other trademarks and trade names are those of their respective owners.

9. Important safety information

The following pages contain important safety information.

Hazard warnings

-  Keep this device out of reach of children and mentally challenged people or pets.
-  Use only hearing aids that have been specially programmed for you by your hearing care professional.
-  Dispose of electrical components in accordance with your local regulations by Phonak AG.
-  Changes or modifications to any of the devices that were not explicitly approved by Phonak are not permitted.
-  External devices may only be connected if they have been tested in accordance with corresponding IECXXXXX standards. Only use accessories approved by Phonak AG.

-
- ⚠ For safety reasons, only use stabilized chargers with a rating of 5 VDC, min. 500 mA.

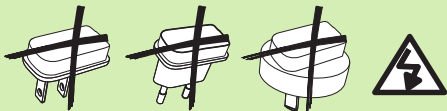

- ⚠ Caution: electric shock. Do not insert plug alone into electrical outlets.
- ⚠ Do not power TVLink II from a PC or laptop USB port. This may damage your equipment.
- ⚠ Do not use the device in explosive areas (mines or industrial areas with danger of explosions, oxygen rich environments or areas where flammable anesthetics are handled) or where electronic equipment is prohibited.
- ⚠ Opening the device might damage it. If problems occur which cannot be resolved by following the remedy guidelines in the troubleshooting section of this user guide, consult your hearing care professional.

9. Important safety information

Product safety information

- ❗ When TVLink II is not in use, switch it off.
- ❗ Protect the device connectors, plugs, charging slot and power supply from dirt and debris.
- ❗ Protect all devices from excessive moisture (bathing or swimming areas) and heat sources (radiator, TV top). Protect devices from excessive shock and vibration.
- ❗ Clean devices using a damp cloth. Never use household cleaning products (washing powder, soap, etc.) or alcohol to clean them. Never use a microwave or other heating devices to dry any of the devices.
- ❗ The digitally coded, inductive transmission technology used in these devices is extremely reliable and experiences virtually no interference from other devices. It should be noted, however, that when operating the system near computer equipment,

larger electronic installation or other strong electromagnetic fields, it may be necessary to be at least 60 cm (24") away from the interfering device to ensure proper operation.

ⓘ X-ray radiation, CT or MRI scans may destroy or adversely affect the correct functioning of the devices.

ⓘ Do not use these devices in areas where electronic equipment is prohibited.

Other important information

ⓘ High-powered electronic equipment, larger electronic installations and metallic structures may impair and significantly reduce the operating range.

Notes



Phonak AG
Laubisrütistrasse 28
CH-8712 Stäfa
Switzerland

www.phonak.com

