

Your hearing care professional

User Guide

inspiro

DISCOVER DYNAMIC FM



029-xxxx-02/V.1.00/2007-12/A+W Printed in Switzerland © Phonak AG All rights reserved



PHONAK

life is on

www.phonak.com

Contents

Welcome	5
inspiro and accessories	7
inspiro key figures	8
Controls	9
Getting Started	11
Charging inspiro	11
Low battery alarms	13
Wearing inspiro	14
Attaching the clip to the inspiro	15
Attaching the lavalier to the inspiro	17
Wearing iLapel	18
iLapel wearing position	19
Wearing iBoom	20
Switch on inspiro	23
Activate the key pad lock	24
Service and warranty	25
Declaration of conformity	26
Phonak distributors worldwide	27

Welcome

inspiro is an FM transmitter ideally suited to the needs of teachers and suitable for use in regular schools as well as special schools.

The outstanding design with its large color display makes this transmitter unique. Soft keys, an alarm clock, wearing options to suit different types of clothing and a wealth of other details reflect Phonak's passion for user friendliness.

Please read this manual carefully to benefit from all the features of your inspiro FM transmitter. Ask your hearing care professional if you have any questions.

Inspiro is a quality product developed by the Swiss company Phonak, the world leader in FM technology, innovation and reliability. With proper care and usage, your inspiro will support your hearing and communication needs for many years.

Phonak – life is on

Further resources:

- Please check www.eSchoolDesk.com, a very detailed website dedicated to supporting teachers especially, but also parents in their use of the inspiro.
- There is a dedicated brochure available for parents and teachers with many useful and practical tips.
- inspiro also provides integrated online help instructions on the large LCD display.

The following symbol appears in this user guide:

 Important notes for all users.

inspiro and accessories

inspiro is delivered with either the iBoom or the iLapel microphone, depending on the customer wish. All the accessories can also be ordered separately.

① inspiro _____



② Microphones: iLapel and iBoom _____



③ inspiro wearing options:

Belt clip and lavalier cord _____



④ Audio cable _____



⑤ Charging unit _____



⑥ Home and travel case _____



7

inspiro key figures

Operating time and charging:

- Operating time if the battery is fully charged:
▷ approx. 12 hours
- Charging time for an 80% charge:
▷ approx. 1 hour
- Charging time for a 100% charge:
▷ approx. 2 hours

Operating range:

- Inside a building:
▷ approx. 50 feet (15 meters)
- Outside:
▷ approx. 130–170 feet (40–50 meters)

⚠ High-powered electronic equipment, larger electronic installations and metallic structures may impair and significantly reduce the operating range.

8

Controls



inspiro

- ① On/Off slider
- ② Color LCD
- ③ Soft Keys
- ④ Keypad lock key
- ⑤ Microphone mute key



- ⑥ 3.5mm audio input
- ⑦ Mini USB for charging

9



- ⑧ Button to attach the belt clip and the lavalier
- ⑨ Cable wrapper



iLapel microphone

- ⑩ Microphone openings (do not cover!)
- ⑪ Wearing clip



iBoom microphone

- ⑫ Adjustable ear loop
- ⑬ Microphone (do not cover!)

10

Getting Started

Charging inspiro

inspiro contains a re-chargeable built-in state-of-the-art lithium polymer battery with fast-charge capability. A fully-discharged battery takes one hour for an 80% charge and two hours for a 100% charge.

Select an easily accessible socket outlet and plug the charging unit into the socket outlet.

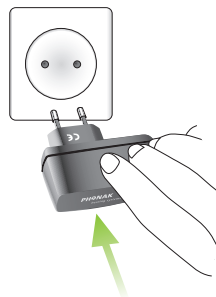

Connect the MiniUSB plug from the charging unit to the inspiro.

⚠ Use only the original Phonak charging unit for inspiro.

The segments in the battery symbol flash during charging. The battery cannot be over-charged.



If the charging unit is removed from the inspiro, the segments in the battery symbol show the actual capacity.



If the battery is fully charged, the battery symbol in the LCD shows four segments.

Getting Started

Low battery alarms

inspiro provides an automatic vibra alarm if the battery is low.

- **Approximately 1 hour before battery is empty:**
A vibra alarm appears. Check the message on the LCD and follow the instructions.
- **Approximately 15 minutes before battery is empty:**
If inspiro has not been charged after the first alarm, the second vibra alarm is automatically activated before the battery is completely exhausted. Check the message on the LCD and follow the instructions. If the battery is not being charged at that time, inspiro switches off automatically after approx. 15 minutes.

If the battery is completely exhausted, there are no segments in the battery symbol anymore and the battery symbol in the LCD changes its color from white to red.

Wearing inspiro

inspiro can either be worn on the belt by using the clip...

...or around the neck by using the lavalier...

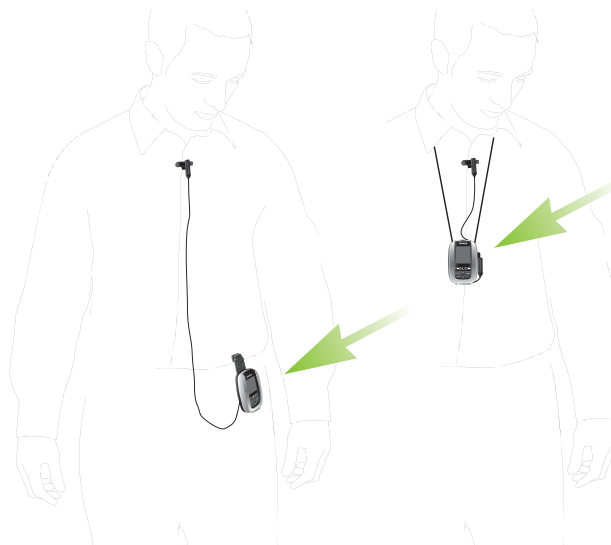

(see page 18)

(see page 20)

Getting Started

Attaching the clip to the inspiro:

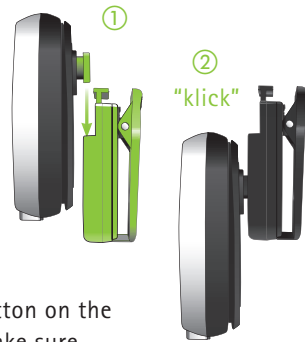

Attach the clip to the button on the backside of the inspiro. Make sure the clip holds securely on the inspiro.

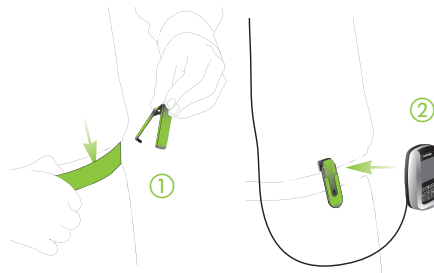

The clip can also be fixed on the belt or trousers before the inspiro is attached. Make sure the clip holds securely on the inspiro.

Fixe the clip on the belt or trousers. Make sure the clip holds securely on the inspiro.

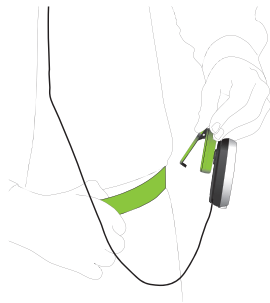

To remove the clip from the inspiro, press the button on the clip and carefully remove the clip from the inspiro.

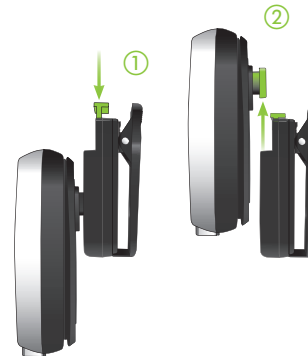

Getting Started

Attaching the lavalier to the inspiro:

Attach the lavalier to the button

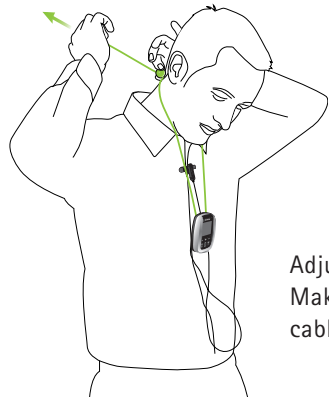

Adjust the lavalier length
Make sure the microphone
cable is unwinded.

17

Wearing iLapel

iLapel is an easy-to-use directional lapel
microphone which provides excellent sound quality.

a) Unwind the iLapel from the inspiro.



b) Fix the iLapel on your
shirt and make sure
the distance between the
microphone and your
mouth is approximately
8 inches (20 cm).

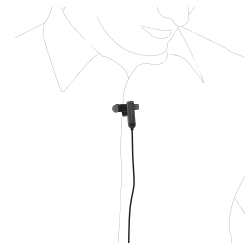

18

Getting Started

iLapel wearing position:



If you are uncertain whether the iLapel is positioned well, activate the Sound check feature in inspiro. Sound check helps to position the iLapel correctly.

Wearing iBoom

iBoom is an ultra-lightweight boom microphone. Extremely comfortable in wear, it can be worn on the left or right ear and adjusts easily to fit all ear and head sizes.

How to fix the iBoom on the ear:

- a) Slightly enlarge the diameter of the ear loop.

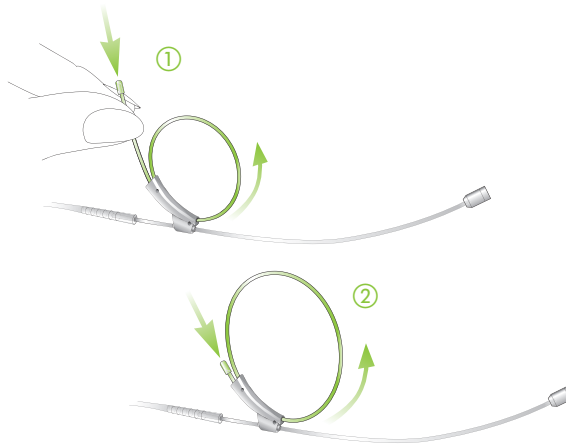

Getting Started

- b) Open the loop carefully and attach the iBoom to the left or right ear.

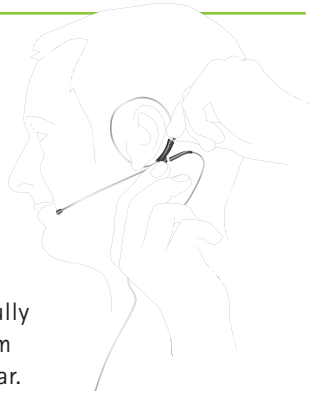

- c) Hold the iBoom with one hand and slightly pull the black nipple with the other hand to reduce the diameter of the ear loop until the iBoom holds securely.

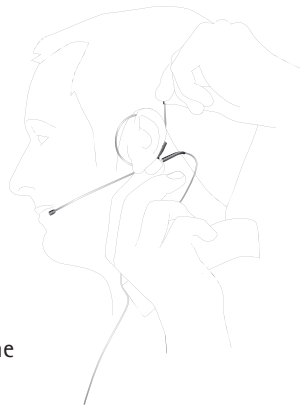

- d) Adjust the boom arm in order to bring the microphone as close to the mouth as possible.

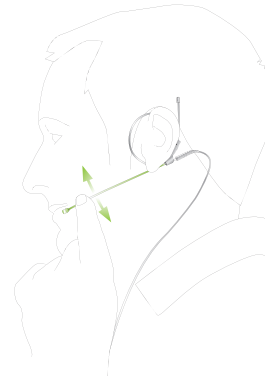

- e) Fix the clip on your clothes as depicted and make sure the cable is not stretched between the clip and the ear.

- ⚠ Do not bend the boom arm!

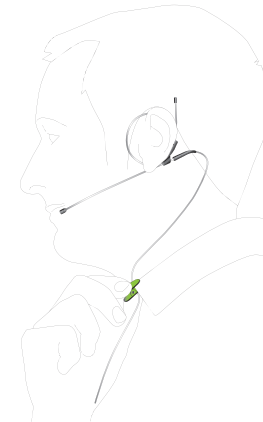

Getting Started

Switch on inspiro

To switch on, push the slider to the left until the green mark appears and the LCD starts up.

To save power, the backlight of the inspiro LCD is switched off after a certain time. Press any button to activate the LCD backlight.

To switch off inspiro, push the slider to the right.



⚠ The inspiro can also be switched off if the keypad is locked!

Activate the key pad lock

It is recommended to activate the key pad lock whenever possible.

To activate the key pad lock, go to the highest menu level as shown above and press the key showing the key symbol, then press OK. A key symbol appears in the status bar.



⚠ If the key pad lock is activated, the six keys are locked. Please note that the on/off slider is never locked and can always be used!

To unlock the keys, proceed the same way.

Service and Warranty

Phonak provides a manufacturer's limited warranty for your inspiro. This covers all manufacturing and material defects. Problems with inspiro arising from improper handling or care and repairs made by an unauthorized party are not covered by the warranty. Please ask at the point of sale for full details of this warranty. The salesperson will note the serial number of your inspiro below. It will be needed in the event of a warranty repair.

Serial number
inspiro:

Date of purchase:

Serial number FM receivers:

Declaration of conformity

Hereby, Phonak Communications AG, declares that the inspiro is in compliance with the essential requirements and other relevant provisions of Directive 1999/5/EC. To obtain a copy of the Declaration of conformity, please contact the local Phonak AG representative whose address can be taken from the list of Phonak distributors worldwide.

This device complies with part 15 and part 95 of the FCC rules and with RSS 210 of Industry Canada.

Operation is subject to the following two conditions:

(1) This device does not cause harmful interference, and (2) this device must accept any interference received, including interference that may cause undesired operation.

⚠ Warning: Changes or modifications made to this equipment not expressly approved by Phonak may void the user's authority to operate the equipment.

Phonak distributors worldwide

Group companies:	(detailed information on www.phonak.com)
Australia	Phonak Australasia Pty. Ltd. Baulkham Hills N. S. W. 2153
Austria	Hansaton Akustische Geräte GmbH 5020 Salzburg
Belgium	Ets Lapperre B.H.A.C. NV B-1702 Groot-Bijgaarden Phonak Belgium NV, B-1700 Dilbeek
Brazil	CAS Produtos Médicos São Paulo – SP 04363-100
Canada	Phonak Canada Limited Mississauga, Ontario L5W 0B3
China	Phonak (Shanghai) Co. Ltd., Shanghai City 200233
Denmark	Phonak Danmark A/S, Nitvej 10 2000 Frederiksberg
France	Phonak France SA, 69500 Bron
Germany	Phonak GmbH, 70736 Fellbach-Oeffingen EC Representative
Italy	Phonak Italia S.r.l., 20159 Milano
Japan	Phonak Japan Co., Ltd., Tokyo 101-0044
Jordan	Phonak Middle East, 11181 Amman
Mexico	Phonak Mexicana, S.A. de C.V. 03920 México, D.F.MEXICO
Netherlands	Phonak B.V., 3439 ME Nieuwegein
New Zealand	Phonak New Zealand Ltd., Takapuna Auckland 9
Norway	Phonak AS, 0105 Oslo
Poland	Phonak Polska Sp. z o.o., 00-567 Warszawa
Russian Federation	Phonak CIS Ltd., Moscow, 115114

Spain	Phonak Ibérica S.A., 03008 Alicante
Sweden	Phonak AB, 117 43 Stockholm
Switzerland	Phonak AG, Phonak Schweiz, 8712 Stäfa
United Kingdom	Phonak UK Limited Warrington, Cheshire WA1 1PP
USA	Phonak LLC, Warrenville, IL 60555-3927

Independent general distributors: A complete list of Phonak distributors is available at Phonak's Internet site: www.phonak.com. Please visit us or ask your hearing care professional for information.

Manufacturer: Phonak AG, Laubisrütistrasse 28
CH-8712 Stäfa, Switzerland



The CE symbol is confirmation by Phonak AG that this Phonak product meets the requirements of the R&TTE Directive 1999/5/EC on Radio and Telecommunication Terminal Equipment. The alert sign means that potential restrictions on its use are applicable in one or more European countries.



This symbol indicates that it is important that the user refers to associated warnings given in this user guide.



The symbol with the crossed out disposal bin indicates that this product shall not be treated as household waste. Please hand over your old or unused product to the applicable collection point for the recycling of electrical and electronic equipment or bring your old product to your hearing care professional for appropriate disposal. By ensuring this product is disposed of correctly, you will help prevent potential negative effects on the environment and human health.

Operating conditions

This product has been designed for trouble-free operation without restrictions when used as intended, unless otherwise stated in this user guide.

Transportation and storage conditions

Temperature should not exceed limits of $-20^{\circ}/60^{\circ}$ Celsius at a relative air humidity of 65% for extended periods during transportation and storage. Air pressure between 500 and 1100 hPa is not detrimental to this device.

